

F.A.P. RTE.	SECTION	COUNTY	TOTAL SHEETS	SHEET NO.
336	112R-N	McHENRY	266	88
STA. 215+50 TO STA. 224+50				
FED. ROAD DIST. NO.		ILLINOIS	FED. AID PROJECT	
CONTRACT NO. 62537				

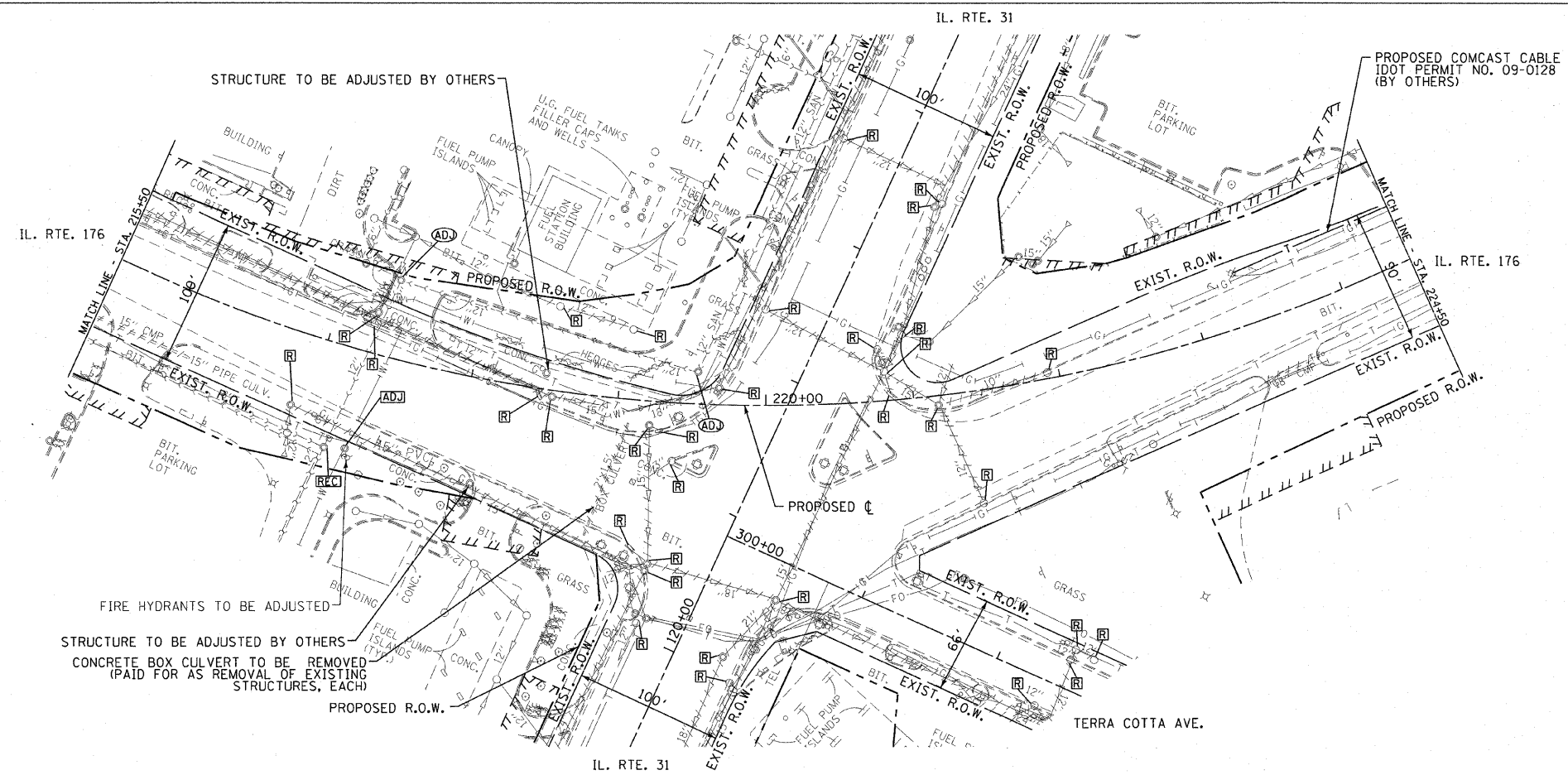

- LEGEND**
- ADJ STRUCTURE TO BE ADJUSTED
  - C STRUCTURE TO BE CLEANED
  - F STRUCTURE TO BE FILLED
  - R STRUCTURE TO BE REMOVED
  - REC STRUCTURE TO BE RECONSTRUCTED
  - REC STRUCTURE TO BE RECONSTRUCTED WITH NEW FRAME AND LID OR GRATE
  - AD STRUCTURE TO BE ADJUSTED WITH NEW FRAME AND LID OR GRATE
  - PIPE REMOVAL
  - PIPE UNDERDRAIN
- STRUCTURE TO BE ADJUSTED BY OTHERS
- FIRE HYDRANTS TO BE ADJUSTED
- STRUCTURE TO BE ADJUSTED BY OTHERS
- CONCRETE BOX CULVERT TO BE REMOVED (PAID FOR AS REMOVAL OF EXISTING STRUCTURES, EACH)

DATE	
BY	
PROJECT	
PLANNING	
DESIGN	
CONSTRUCTION	
NO. OF SHEETS	
NO. OF THIS SHEET	
DATE OF LAST REVISION	
BY	
REVISION	
NO.	

DATE	
BY	
PROJECT	
PLANNING	
DESIGN	
CONSTRUCTION	
NO. OF SHEETS	
NO. OF THIS SHEET	
DATE OF LAST REVISION	
BY	
REVISION	
NO.	

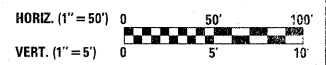
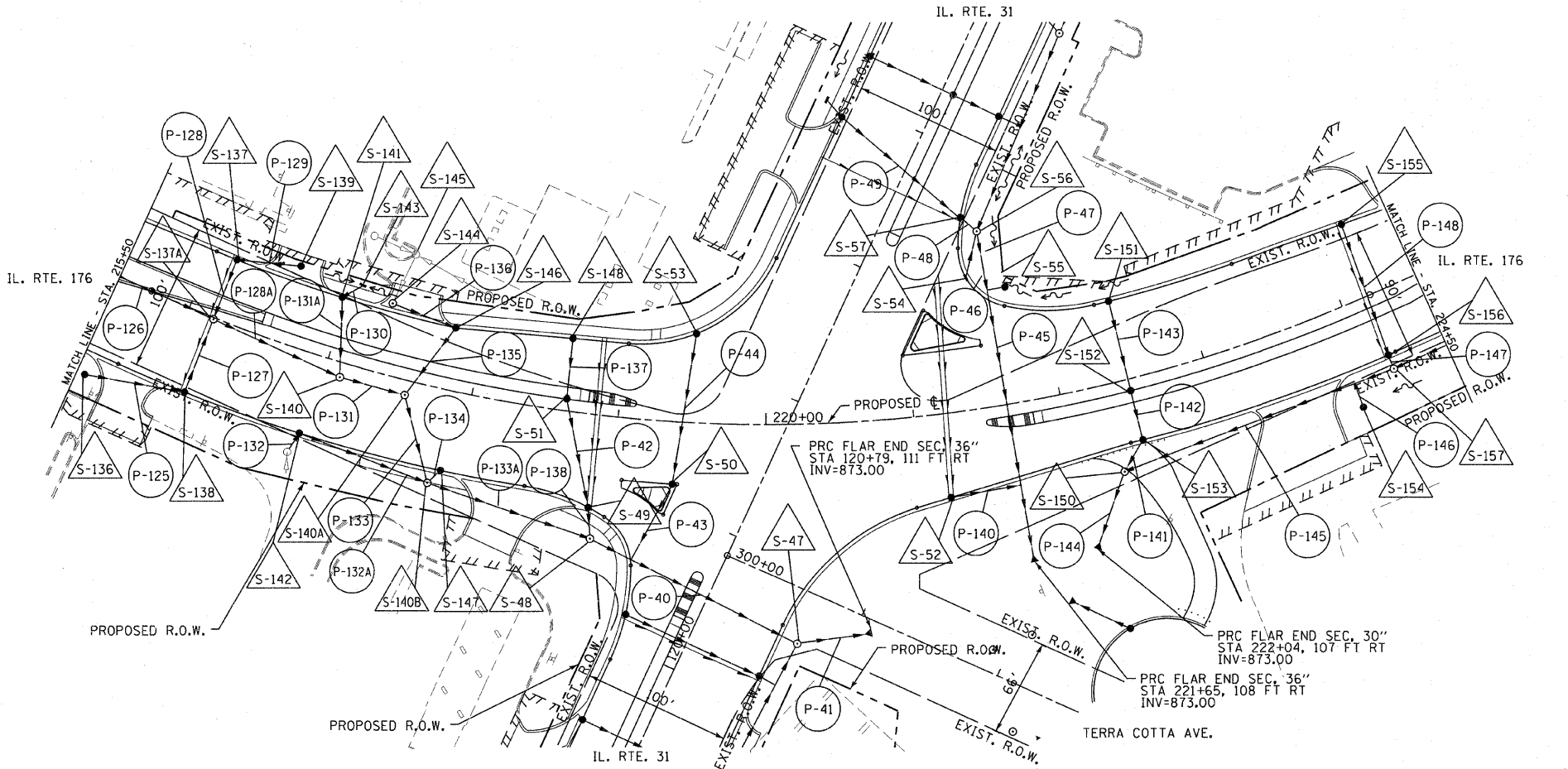

DRAINAGE AND UTILITIES PLAN IL. RTE. 176 STA. 215+50 TO STA. 224+50