

F.A.P. RTE.	SECTION	COUNTY	TOTAL SHEETS	SHEET NO.
336	112R-N	McHENRY	266	33
STA. 236+00 TO STA. 246+00				
FED. ROAD DIST. NO.		ILLINOIS FED. AID PROJECT		
CONTRACT NO. 62537				

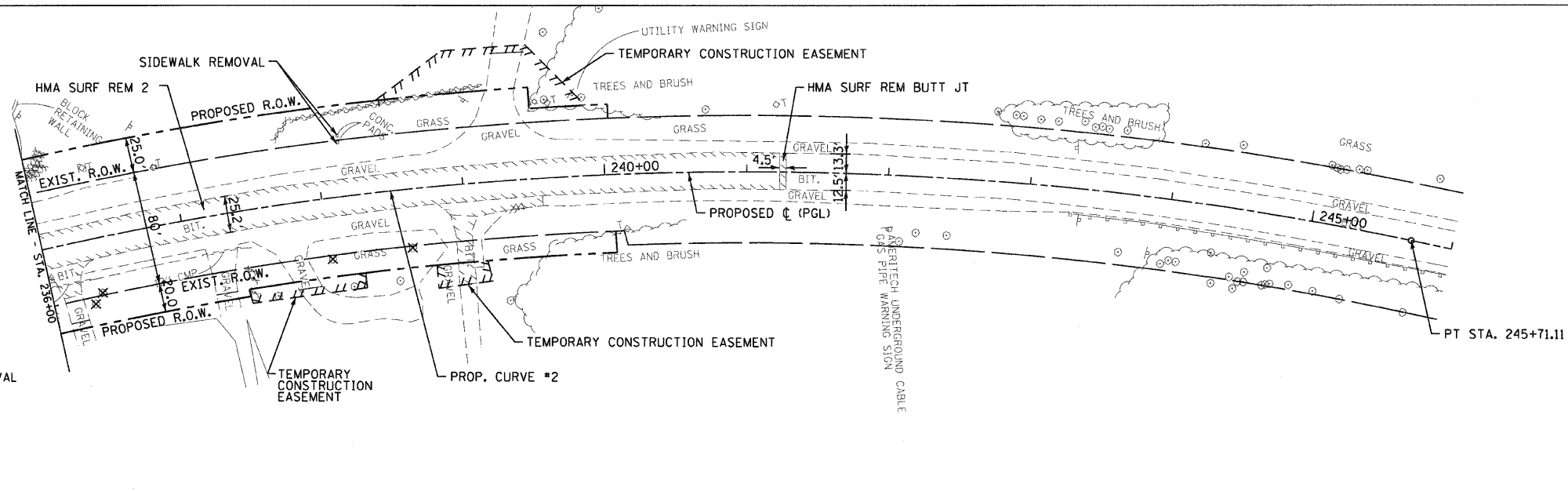

EXISTING ILLINOIS ROUTE 176

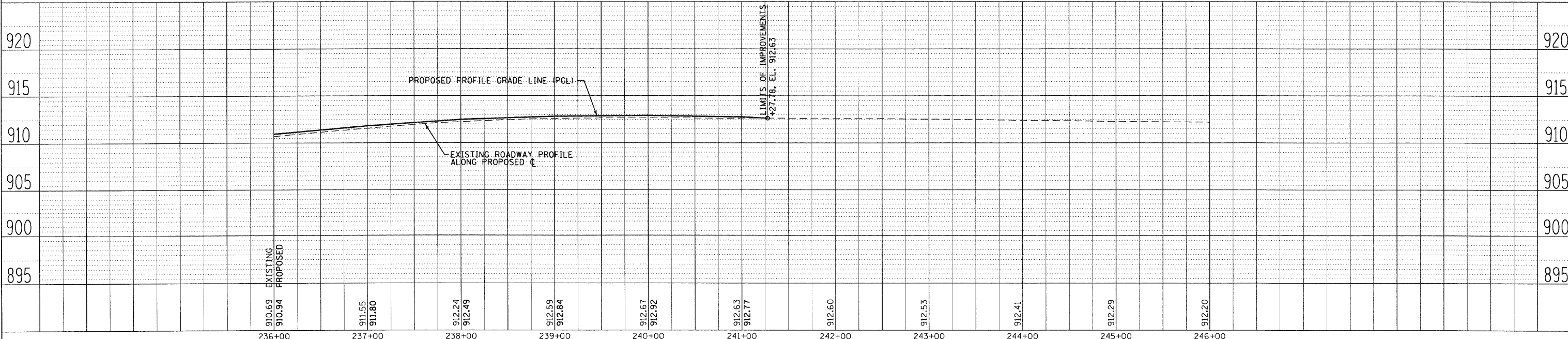
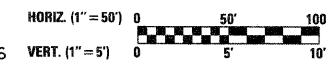
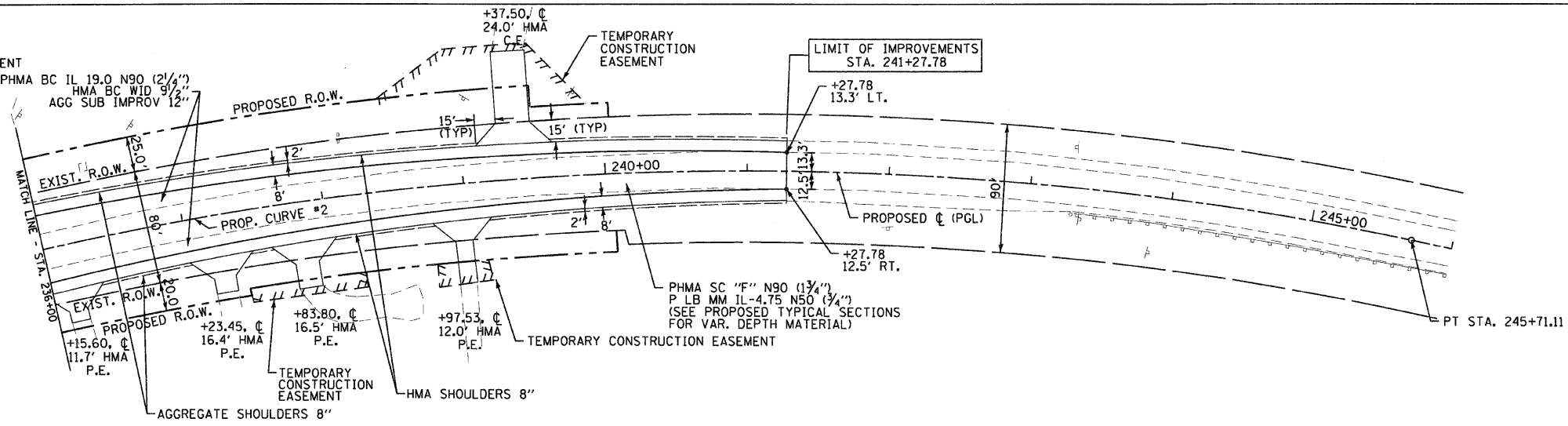

PLAN AND PROFILE IL. RTE. 176 STA. 236+00 TO STA. 246+00

DATE	BY	REVISION

DATE	BY	REVISION