

**GUIDE SIGN SEQUENCE
NUMBERING CODE
EXAMPLE**

- DIRECTION OF TRAFFIC**
- NB - NORTHBOUND I-290 (I-53)
 - SB - SOUTHBOUND I-290 (I-53)
 - R** - RAMP AA - JH
 - THR - THORNDALE AVENUE
 - ROH - ROHLWING ROAD
 - BIE - BIESTERFIELD ROAD
 - HIG - HIGGINS ROAD (IL RT 72)
 - EFR - E FRONTAGE ROAD
 - WOD - WOODFIELD ROAD
 - WFR - W FRONTAGE ROAD
 - GLF - GOLF ROAD (IL RT 58)
 - ALG - ALGONQUIN ROAD (IL RT 62)
 - KIR - KIRCHOFF ROAD
 - HIC - HICKS ROAD
 - EUC - EUCLID ROAD
 - NWH - NORTHWEST HWY (US 14)
 - PAL - PALATINE ROAD
- MOUNTING TYPE**
- TR - TRUSS
 - CL - CANTILEVER
 - TS - TELESCOPING STEEL POST
 - WP - WOOD POST
 - MP - METAL POST
 - PM - POLE MOUNTED
 - GM - GROUND MOUNTED
- Legend:**
- REMOVE AND REPLACE SIGN PANEL
 - EXISTING LUMINAIRE TO BE REMOVED
 - REMOVE SIGN PANEL & SUPPORT (NO REPLACEMENT)
 - * NEW SIGN PANEL AND SUPPORT(S)
 - # REMOVE AND REPLACE SIGN PANEL WITH NEW SUPPORT(S)

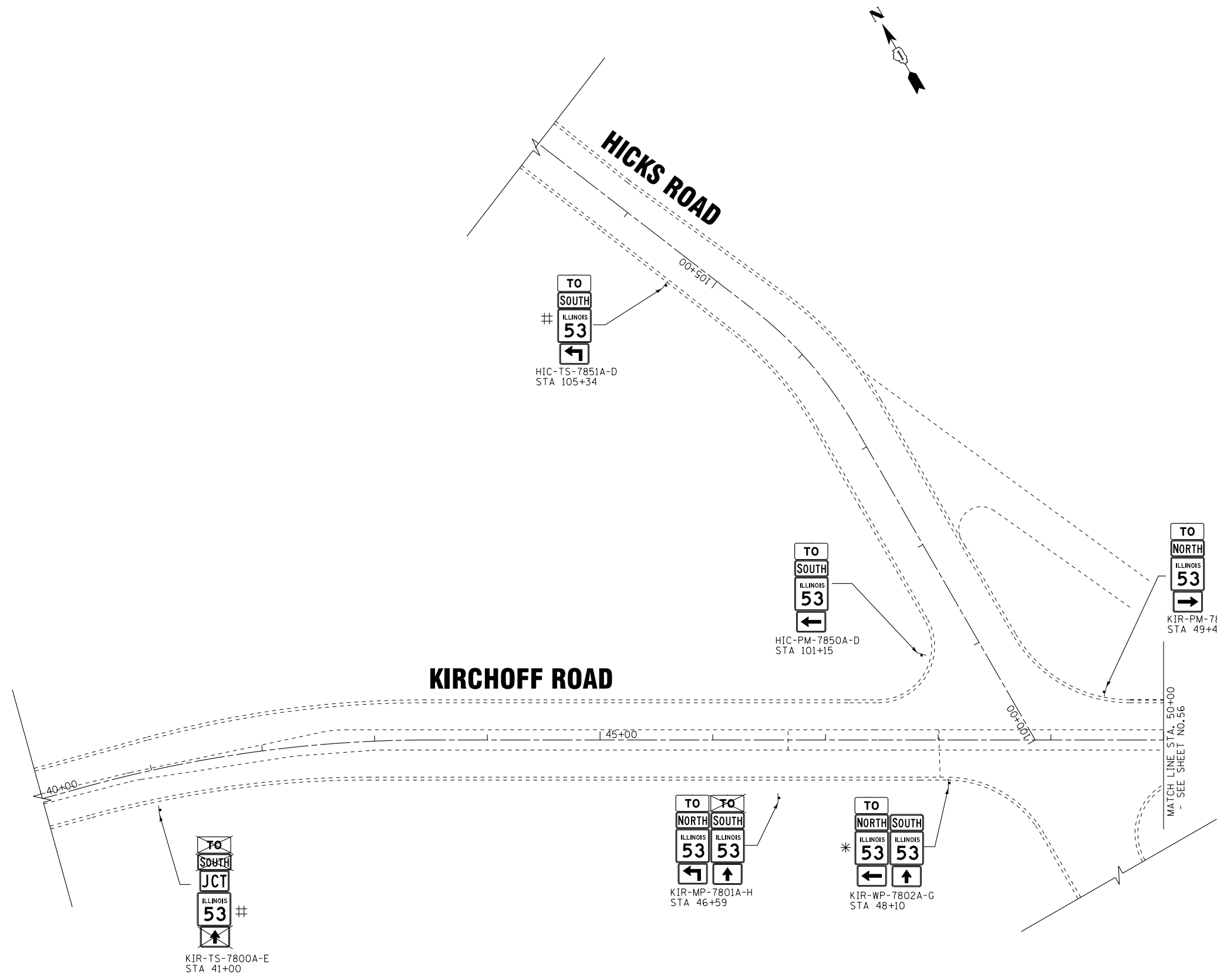

COPYRIGHT 2009, BY BAXTER & WOODMAN, INC. ...Standards\p1\drv\pdef\EDIT.ppt
 STATE OF ILLINOIS PROFESSIONAL DESIGN FIRM
 No. - 1295531 PIR 7/6/2008 kcorp@boxwood.com\projects\crystal\lake\LDOT\000533-40-Design\WP-27 IL-53 Signing\CADD-SURVEY\DRAWINGS\IGNS\010330-sht-plan.dgn
 23UKB

*F.A.I. 290 (INTERSTATE 290)
 *F.A.U. 342 (IL ROUTE 53)



USER NAME = 23lukb	DESIGNED - DJS	REVISED -
DRAWN - UKB	CHECKED - RWL	REVISED -
DATE - 12-13-11		

**STATE OF ILLINOIS
DEPARTMENT OF TRANSPORTATION**

KIRCHOFF ROAD STA. 40+00 TO STA. 50+00	
HICKS ROAD STA. 100+00 TO STA. 107+00	
SCALE: 1" = 50'	SHEET NO. OF SHEETS STA. TO STA.

F.A.I. RTE.	SECTION	COUNTY	TOTAL SHEETS	SHEET NO.
*	2011-024-SG	COOK/DuPAGE	132	57
CONTRACT NO. 60P24			ILLINOIS FED. AID PROJECT	