

THE FOLLOWING ITEMS SHALL BE REMOVED BY THE CONTRACTOR AND SHALL BE DISPOSED OF BY THEM OUTSIDE THE RIGHT-OF-WAY AT THEIR EXPENSE. THE SALVAGE VALUE OF THE REMOVED EQUIPMENT SHALL BE REFLECTED IN THE CONTRACTOR'S BID PRICE.

- 12 EACH SIGNAL HEAD, 1-FACE, 3-SECTION, MAST ARM MOUNTED
- 2 EACH SIGNAL HEAD, 1-FACE, 5-SECTION, BRACKET MOUNTED
- 2 EACH SIGNAL HEAD, 1-FACE, 5-SECTION, MAST ARM MOUNTED
- 2 EACH SIGNAL HEAD, 2-FACE, 3-SECTION, BRACKET MOUNTED
- 14 EACH TRAFFIC SIGNAL BACKPLATE

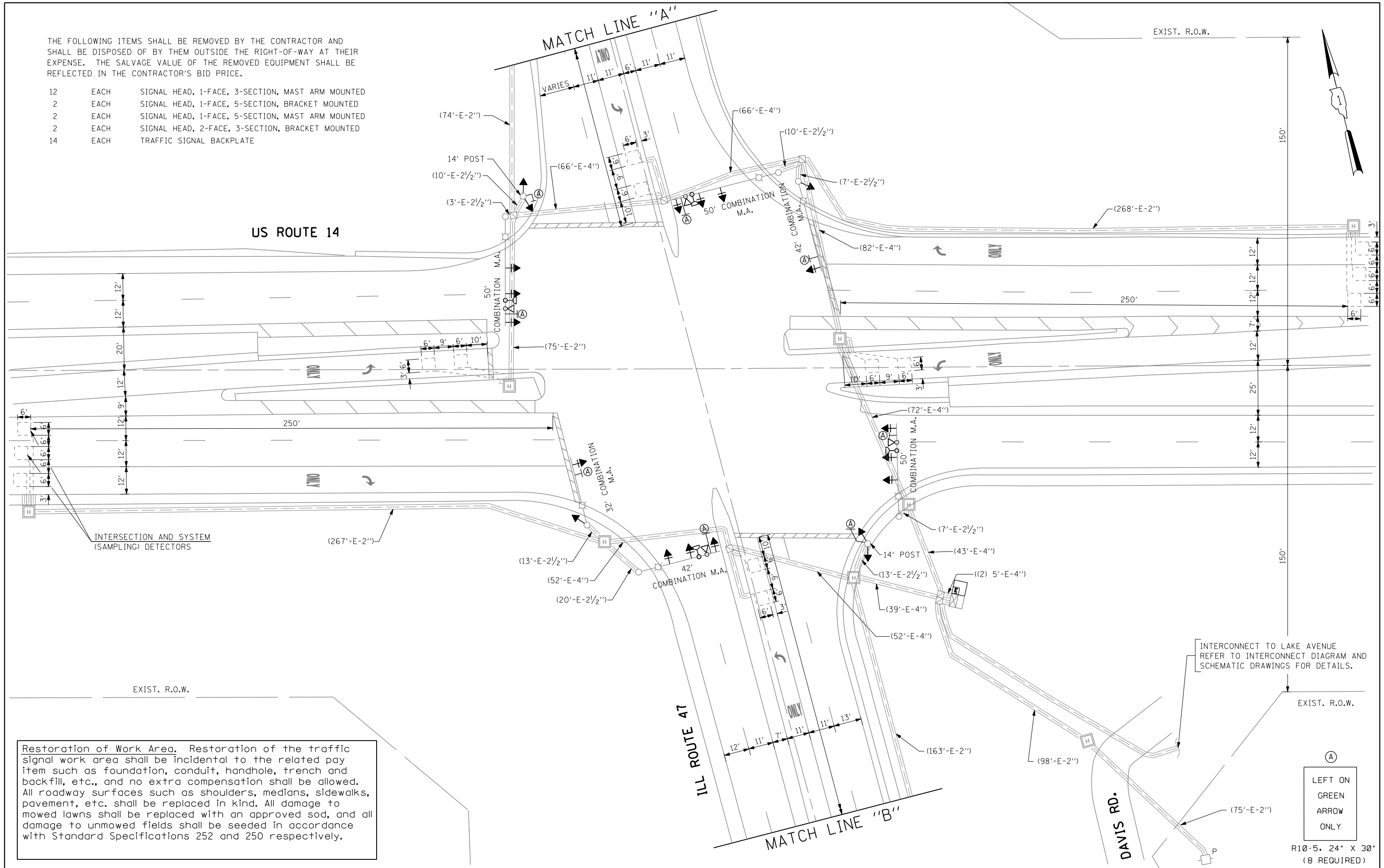

INTERSECTION AND SYSTEM (SAMPLING) DETECTORS

INTERCONNECT TO LAKE AVENUE REFER TO INTERCONNECT DIAGRAM AND SCHEMATIC DRAWINGS FOR DETAILS.

Restoration of Work Area. Restoration of the traffic signal work area shall be incidental to the related pay item such as foundation, conduit, handhole, trench and backfill, etc., and no extra compensation shall be allowed. All roadway surfaces such as shoulders, medians, sidewalks, pavement, etc. shall be replaced in kind. All damage to mowed lawns shall be replaced with an approved sod, and all damage to unmowed fields shall be seeded in accordance with Standard Specifications 252 and 250 respectively.

(A)
LEFT ON GREEN ARROW ONLY
R10-5, 24" X 30"
(8 REQUIRED)

FILE NAME =	USER NAME = \$USER\$	DESIGNED - PKG	REVISED -	STATE OF ILLINOIS DEPARTMENT OF TRANSPORTATION	TRAFFIC SIGNAL MODIFICATION PLAN US ROUTE 14 AT ILL ROUTE 47 (SHEET 1 OF 2)				F.A.P. RTE. 305	SECTION 2011-020-TS	COUNTY MCHENRY	TOTAL SHEETS 20	SHEET NO. 15
\$FILEL\$		DRAWN - EA, MG	REVISED -		SCALE:	SHEET NO.	OF SHEETS	STA.	TO STA.	FED. ROAD DIST. NO. 1 [ILLINOIS] FED. AID PROJECT			
		CHECKED - PKG	REVISED -							CONTRACT NO. 60P15			
		DATE - 06/01/2011	REVISED -										