

04-26-2024 LETTING ITEM 177

INDEX OF SHEETS

1	COVER SHEET
2	TYPICAL SECTION
2	SUMMARY OF QUANTITIES
3-6	PLAN-PROFILE
7-15	CROSS SECTIONS
16-18	ADA DETAILS

STANDARDS:

424001-11
424026-03
606001-08
701006-05
701501-06
701801-06
701901-09
720001-01
720006-04
728001-01

STATE OF ILLINOIS
DEPARTMENT OF TRANSPORTATION
DIVISION OF HIGHWAYS
PLANS FOR PROPOSED
SAFE ROUTES TO SCHOOL (SRTS)
CITY OF SUMNER
PROJECT NO. ZHS0(406)
SECTION 22-00005-00-SW
JOB NO. C-97-036-24
SOUTH CHRISTY AVE, WEST LOCUST STREET
LAWRENCE COUNTY

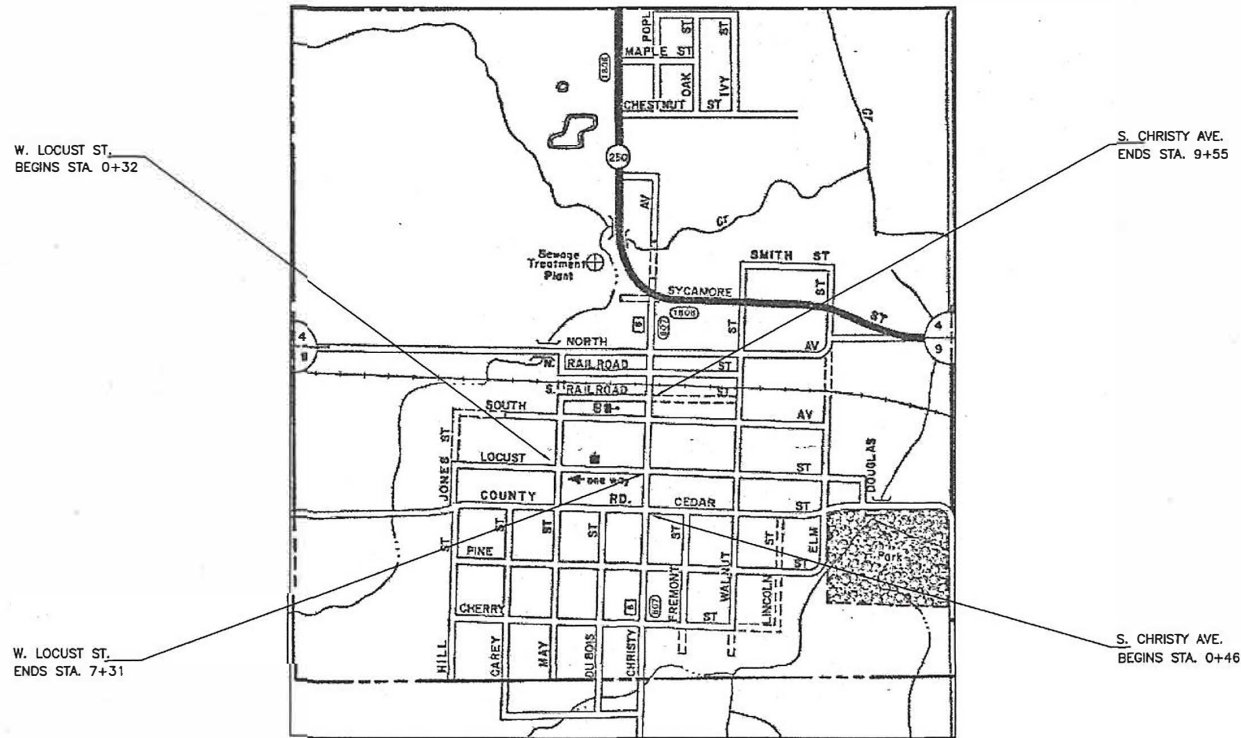

LOCATION MAP
TOTAL LENGTH OF IMPROVEMENT= 1608 FT = 0.305 MILES

STREET	FUNCTIONAL CLASS	ADT	DESIGN SPEED
S. CHRISTY ST.	MAJOR COLLECTOR	2250	30 MPH
W. LOCUST ST.	LOCAL ROAD OR STREET	250	30 MPH

TOLL FREE JOINT UTILITY LOCATING
INFORMATION FOR EXCAVATORS (J.U.L.I.E.)
TELEPHONE NO. 1-800-892-0123



John A. Stone 02/12/2024
ILLINOIS REGISTERED PROFESSIONAL ENGINEER # 55012
LICENSE EXPIRES NOVEMBER 30, 2025
CONNOR & CONNOR, INC.
PROFESSIONAL DESIGN FIRM #184-000832

ILLINOIS DEPARTMENT OF TRANSPORTATION	
APPROVED:	2/15/2024 <i>Billy Brian</i> CITY OF SUMNER
PASSED:	02/27/24 <i>Jeffrey</i> DISTRICT SEVEN ENGINEER OF LOCAL ROADS & STREETS
RELEASING FOR BID BASED ON LIMITED REVIEW	02/27/24 <i>Jeffrey</i> REGION FOUR ENGINEER

Connor & Connor, Inc.
210 East Locust Street
P.O. Box 618
Robinson, Illinois 62454



Phone: (618) 544-8623
Fax: (618) 544-3012
Design Firm #: 184-000832
www.connorengineers.com

PROJECT NAME:
CITY OF SUMNER
SEC. 22-00005-00-SW
SOUTH CHRISTY AVE
WEST LOCUST STREET

COVER SHEET

SHEET NUMBER:
1 OF 18
CONTRACT NUMBER:
95954

SUMMARY OF QUANTITIES			
CODE NO.	ITEM	UNIT	QUANTITY
X2500900	SEEDING, CLASS 1 (SPECIAL)	ACRE	0.2
X7010216	TRAFFIC CONTROL AND PROTECTION, (SPECIAL)	L. SUM	1
42300200	PORTLAND CEMENT CONCRETE DRIVEWAY PAVEMENT 6 INCH	SQ YD	167.4
42400100	PORTLAND CEMENT CONCRETE SIDEWALK 4 INCH	SQ FT	14,045
42400300	PORTLAND CEMENT CONCRETE SIDEWALK 6 INCH	SQ FT	520
42400800	DETECTABLE WARNINGS	SQ FT	410
44000200	DRIVEWAY PAVEMENT REMOVAL	SQ YD	167.4
44000500	COMBINATION CURB AND GUTTER REMOVAL	FOOT	253
44000600	SIDEWALK REMOVAL	SQ FT	12,186
60100905	PIPE DRAINS 4"	FOOT	30
60100945	PIPE DRAINS 12"	FOOT	40
60604400	COMBINATION CONCRETE CURB AND GUTTER, TYPE B-6.18	FOOT	253
67100100	MOBILIZATION	L. SUM	1
* 72000100	SIGN PANEL - TYPE 1	SQ FT	208.6
* 72800100	TELESCOPING STEEL SIGN SUPPORT	FOOT	384
* 78001180	PAINT PAVEMENT MARKING - LINE 24"	FOOT	708

* SPECIALTY ITEM

SIGN PANEL SCHEDULE				
LOCATION	S1-1 SQ FT	S4-3P SQ FT	W16-7P SQ FT	W16-9P SQ FT
RT. STA. 0-200	6.75			2.00
RT. STA. 0+41	6.75		2.00	
LT. STA. 0+52	6.75		2.00	
RT. STA. 0+93	6.75		2.00	
LT. STA. 1+04	6.75		2.00	
RT. STA. 3+40	6.75		2.00	
LT. STA. 3+51	6.75		2.00	
RT. STA. 3+91	6.75		2.00	
LT. STA. 4+02	6.75		2.00	
RT. STA. 5+76	6.75		2.00	
LT. STA. 5+87	6.75		2.00	
RT. STA. 7+37	6.75		2.00	
LT. STA. 7+48	6.75		2.00	
RT. STA. 8+30	6.75		2.00	
LT. STA. 8+41	6.75		2.00	
RT. STA. 9+36	6.75		2.00	
LT. STA. 9+47	6.75		2.00	
LT. STA. 11+47	6.75			2.00
*RT. STA. 1+00	6.75	1.30		
*RT. STA. 2+66	6.75		2.00	
*LT. STA. 2+77	6.75		2.00	
*RT. STA. 4+02	6.75		2.00	
*LT. STA. 4+13	6.75		2.00	
*LT. STA. 7+10	6.75	1.30		
TOTALS	162.00	2.60	40.00	4.00

NOTE: * DENOTES W. LOCUST STREET

CROSSWALK SCHEDULE	
LOCATION	PAINT PVT. MK-LINE 24" FOOT
STA. 0+45	8 LINES @ 6' = 48'
LT. STA. 0+72	4 LINES @ 6' = 24'
RT. STA. 0+72	4 LINES @ 6' = 24'
STA. 0+98	8 LINES @ 6' = 48'
STA. 3+45	8 LINES @ 6' = 48'
LT. STA. 3+70	4 LINES @ 6' = 24'
RT. STA. 3+70	4 LINES @ 6' = 24'
STA. 3+96	8 LINES @ 6' = 48'
STA. 5+81	8 LINES @ 6' = 48'
STA. 7+42	8 LINES @ 6' = 48'
LT. STA. 7+88	7 LINES @ 6' = 42'
RT. STA. 7+88	7 LINES @ 6' = 42'
STA. 8+35	8 LINES @ 6' = 48'
STA. 9+41	8 LINES @ 6' = 48'
*LT. STA. 0+55	4 LINES @ 6' = 24'
*RT. STA. 0+55	4 LINES @ 6' = 24'
*STA. 0+83	4 LINES @ 6' = 24'
*STA. 2+71	6 LINES @ 6' = 36'
*STA. 4+07	6 LINES @ 6' = 36'
TOTALS	118 LINES @ 6' = 708'

NOTE: * DENOTES W. LOCUST STREET

CROSSWALK TYPICAL STRIPING DETAIL

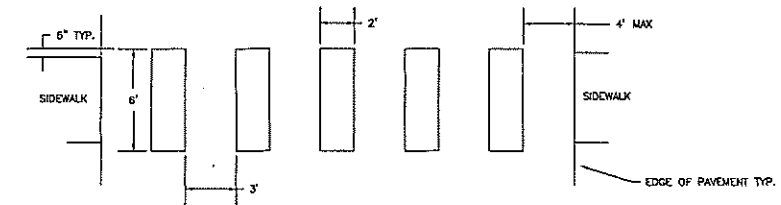

W. LOCUST ST. TYPICAL CROSS SECTION

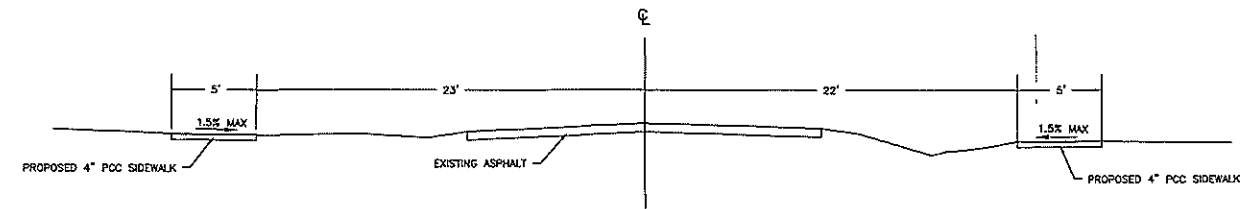

S. CHRISTY AVE. TYPICAL CROSS SECTION

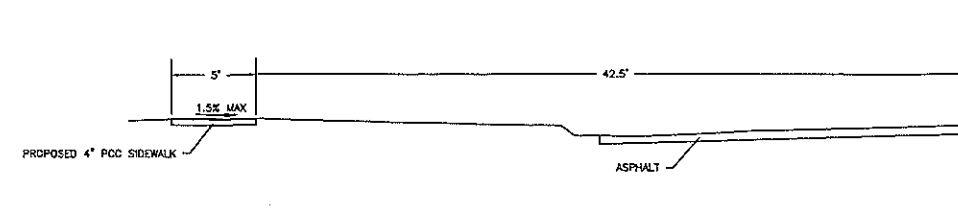

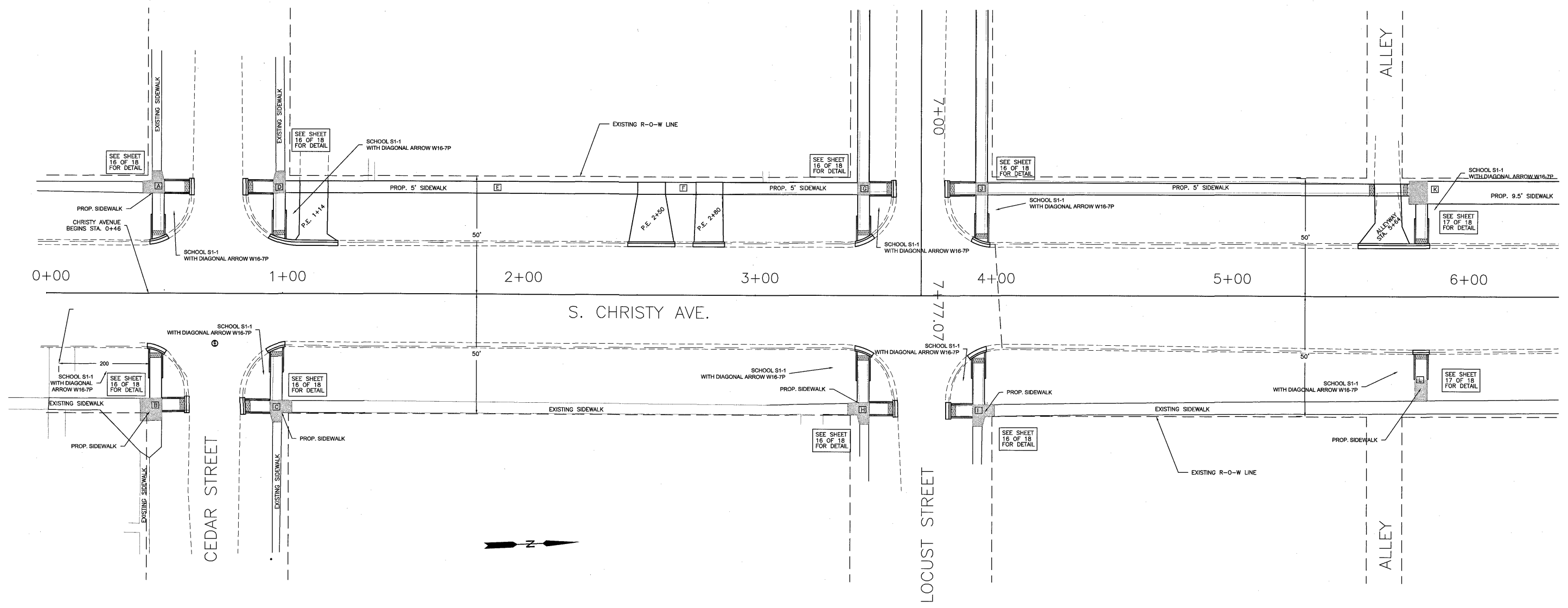

<p>PCC SIDEWALK 4 INCH</p> <ul style="list-style-type: none"> A = 231 SQ FT B = 252 SQ FT C = 242 SQ FT D = 242 SQ FT E = 65 SQ FT F = 468 SQ FT G = 237 SQ FT H = 232 SQ FT I = 1016 SQ FT J = 715 SQ FT K = 108 SQ FT <p>TOTAL = 4456 SQ FT</p>	<p>COMB. CONC. CURB & GUTTER, TYPE B6.18</p> <ul style="list-style-type: none"> RT. STA. 0+44 = 6 FEET LT. STA. 0+44 = 6 FEET RT. STA. 0+60 = 6 FEET LT. STA. 0+60 = 6 FEET RT. STA. 0+86 = 6 FEET LT. STA. 0+86 = 6 FEET RT. STA. 1+00 = 6 FEET LT. STA. 1+00 = 27 FEET RT. STA. 2+50 = 20 FEET LT. STA. 2+80 = 14 FEET RT. STA. 3+46 = 6 FEET LT. STA. 3+46 = 6 FEET RT. STA. 3+59 = 6 FEET LT. STA. 3+59 = 6 FEET RT. STA. 3+83 = 6 FEET LT. STA. 3+83 = 6 FEET RT. STA. 3+96 = 6 FEET LT. STA. 3+96 = 6 FEET RT. STA. 5+82 = 6 FEET LT. STA. 5+82 = 30 FEET <p>TOTAL = 187 FEET</p>	<p>DETECTABLE WARNINGS</p> <ul style="list-style-type: none"> RT. 0+44 = 10 SQ FT LT. 0+44 = 10 SQ FT RT. 0+58 = 10 SQ FT LT. 0+58 = 10 SQ FT RT. 0+88 = 10 SQ FT LT. 0+88 = 10 SQ FT RT. 1+00 = 10 SQ FT LT. 1+00 = 10 SQ FT RT. 3+46 = 10 SQ FT LT. 3+46 = 10 SQ FT RT. 3+57 = 10 SQ FT LT. 3+57 = 10 SQ FT RT. 3+84 = 10 SQ FT LT. 3+84 = 10 SQ FT RT. 3+96 = 10 SQ FT LT. 3+96 = 10 SQ FT RT. 5+80 = 10 SQ FT LT. 5+75 = 10 SQ FT RT. 5+82 = 10 SQ FT LT. 5+82 = 10 SQ FT <p>TOTAL = 200 SQ FT</p>	<p>DRIVEWAY PAVEMENT REMOVAL</p> <ul style="list-style-type: none"> P.E. STA. 1+14 = 33.9 SQ YD P.E. STA. 2+50 = 41.0 SQ YD P.E. STA. 2+80 = 32.7 SQ YD ALLEYWAY STA. 5+64 = 36.0 SQ YD <p>TOTAL = 143.6 SQ YD</p>	<p>COMB. CONC. C&G REMOVAL</p> <ul style="list-style-type: none"> RT. STA. 0+44 = 6 FEET LT. STA. 0+44 = 6 FEET RT. STA. 0+60 = 6 FEET LT. STA. 0+60 = 6 FEET RT. STA. 0+86 = 6 FEET LT. STA. 0+86 = 6 FEET RT. STA. 1+00 = 6 FEET LT. STA. 1+00 = 27 FEET RT. STA. 2+50 = 20 FEET LT. STA. 2+80 = 14 FEET RT. STA. 3+46 = 6 FEET LT. STA. 3+46 = 6 FEET RT. STA. 3+59 = 6 FEET LT. STA. 3+59 = 6 FEET RT. STA. 3+83 = 6 FEET LT. STA. 3+83 = 6 FEET RT. STA. 3+96 = 6 FEET LT. STA. 3+96 = 6 FEET RT. STA. 5+82 = 6 FEET LT. STA. 5+82 = 30 FEET <p>TOTAL = 187 FEET</p>	<p>SIDEWALK REMOVAL</p> <ul style="list-style-type: none"> A = 182 SQ FT B = 229 SQ FT C = 197 SQ FT D = 193 SQ FT E = 645 SQ FT F = 67 SQ FT G = 396 SQ FT H = 190 SQ FT I = 181 SQ FT J = 857 SQ FT K = 671 SQ FT L = 97 SQ FT <p>TOTAL = 3905 SQ FT</p>	<p>PCC DRIVEWAY PAVEMENT 6"</p> <ul style="list-style-type: none"> P.E. STA. 1+14 = 33.9 SQ YD P.E. STA. 2+50 = 41.0 SQ YD P.E. STA. 2+80 = 32.7 SQ YD ALLEYWAY STA. 5+64 = 36.0 SQ YD <p>TOTAL = 143.6 SQ YD</p>
---	--	---	---	--	---	--

Connor & Connor, Inc.
210 East Locust Street
P.O. Box 618
Robinson, Illinois 62454

CONNOR & CONNOR
Consulting Engineers
Land Surveyors

Phone: (618) 544-8623
Fax: (618) 544-3012
Design Firm #: 184-000832
www.connorengineers.com

PROJECT NAME:
CITY OF SUMNER
SEC. 22-00005-00-SW
SOUTH CHRISTY AVE
WEST LOCUST STREET

PLAN-PROFILE
STA. 0+00 TO STA. 6+50
S. CHRISTY STREET

SHEET NUMBER:
3 OF 18
CONTRACT NUMBER:
95954

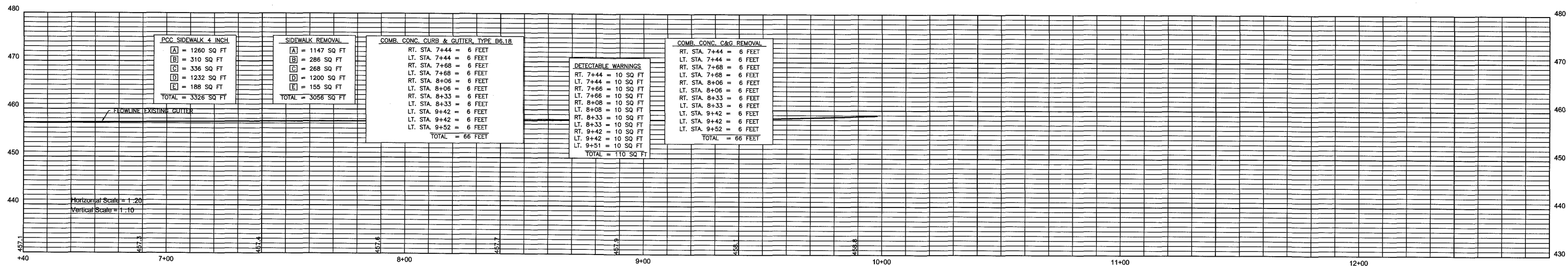
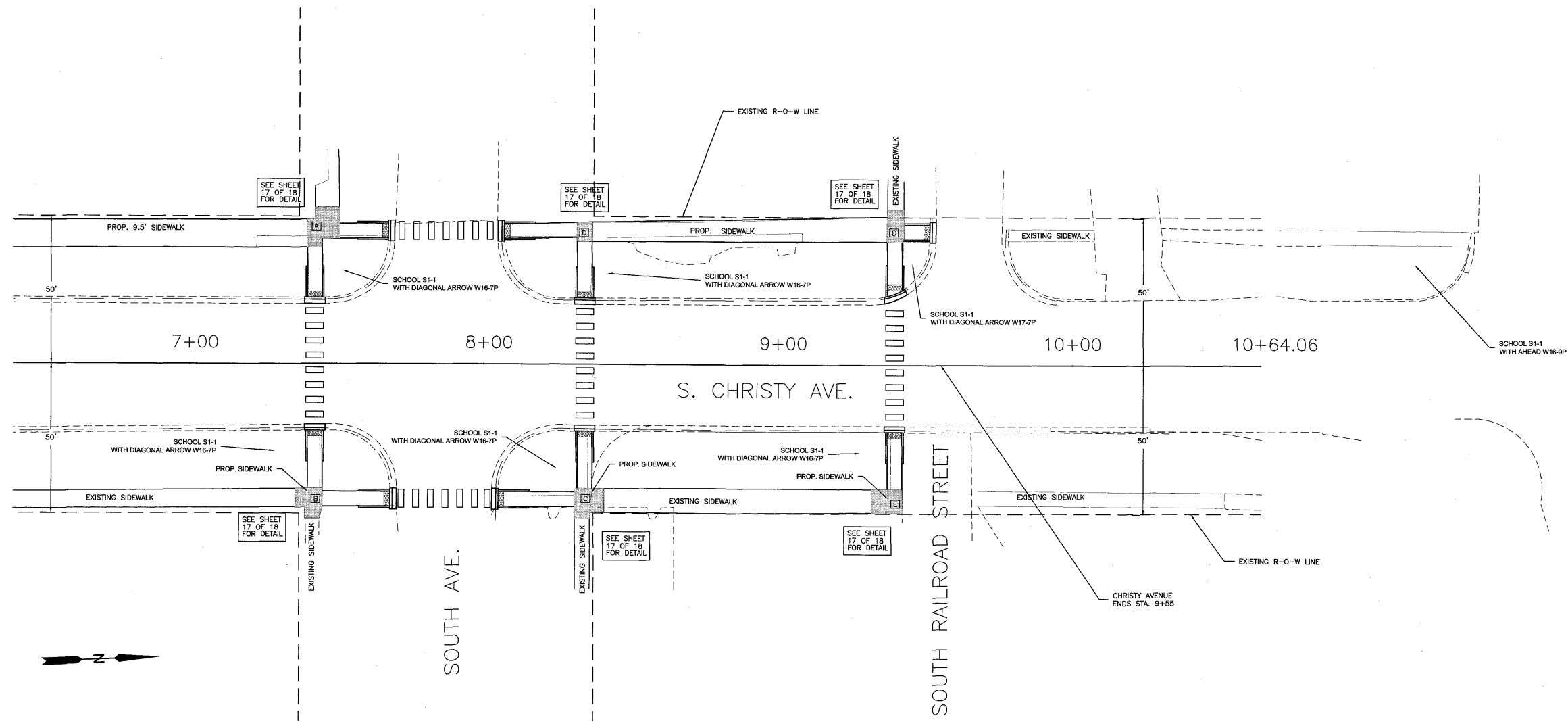

Connor & Connor, Inc.
 210 East Locust Street
 P.O. Box 618
 Robinson, Illinois 62454

CONNOR & CONNOR
 Consulting Engineers
 Land Surveyors

Phone: (618) 544-8623
 Fax: (618) 544-3012
 Design Firm #: 184-000832
 www.connorengineers.com

PROJECT NAME:
 CITY OF SUMNER
 SEC. 22-00005-00-SW
 SOUTH CHRISTY AVE
 WEST LOCUST STREET

PLAN-PROFILE
 STA. 6+50 TO STA. 10+64
 S. CHRISTY STREET

SHEET NUMBER:
 4 OF 18
 CONTRACT NUMBER:
 95954

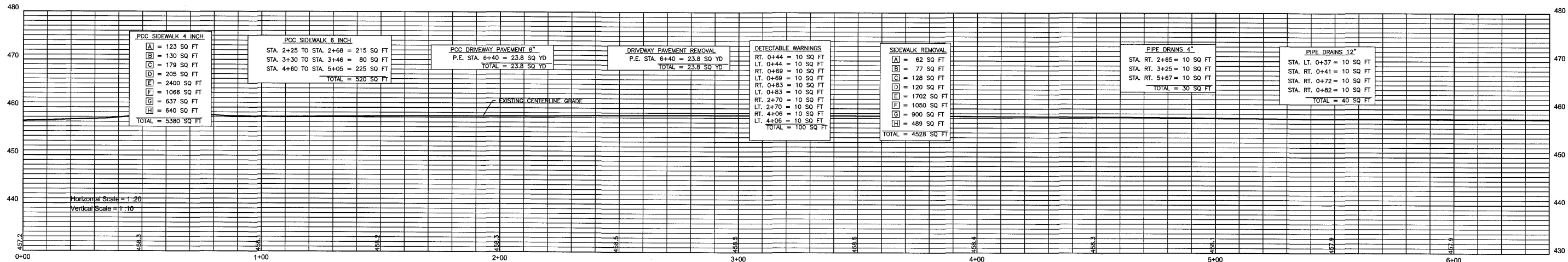
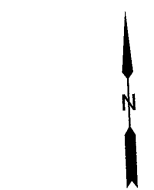
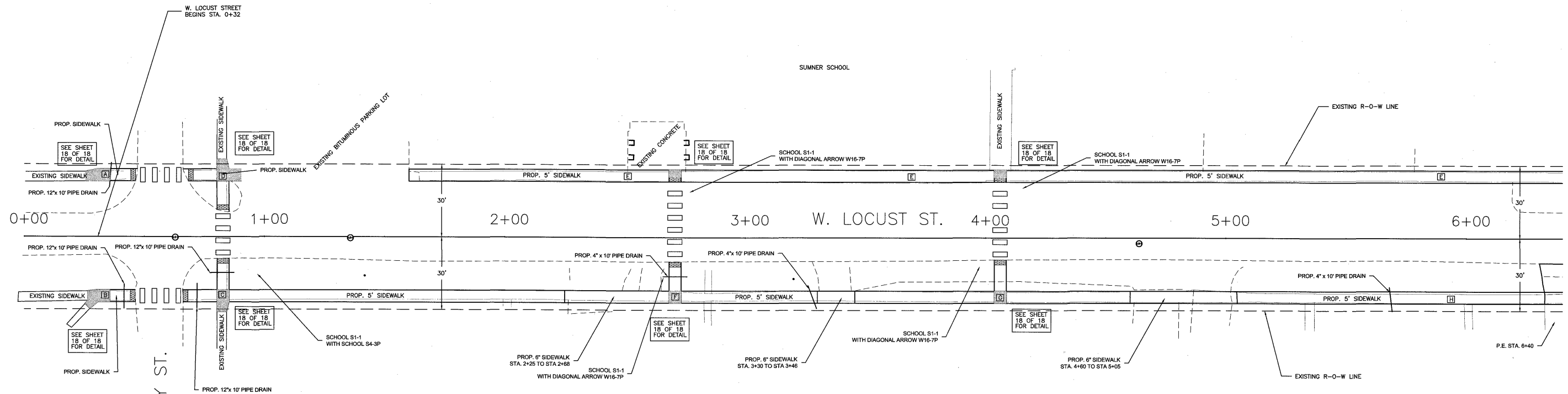

PCC SIDEWALK 4 INCH

A	= 123 SQ FT
B	= 130 SQ FT
C	= 179 SQ FT
D	= 205 SQ FT
E	= 2400 SQ FT
F	= 1066 SQ FT
G	= 637 SQ FT
H	= 640 SQ FT
TOTAL = 5380 SQ FT	

PCC SIDEWALK 6 INCH

STA. 2+25 TO STA. 2+68	= 215 SQ FT
STA. 3+30 TO STA. 3+46	= 80 SQ FT
STA. 4+60 TO STA. 5+05	= 225 SQ FT
TOTAL	= 520 SQ FT

PCC DRIVEWAY PAVEMENT 6"

P.E. STA. 6+40	= 23.8 SQ YD
TOTAL	= 23.8 SQ YD

DRIVEWAY PAVEMENT REMOVAL

P.E. STA. 6+40	= 23.8 SQ YD
TOTAL	= 23.8 SQ YD

DETECTABLE WARNINGS

RT. 0+44	= 10 SQ FT
LT. 0+44	= 10 SQ FT
RT. 0+69	= 10 SQ FT
LT. 0+69	= 10 SQ FT
RT. 0+83	= 10 SQ FT
LT. 0+83	= 10 SQ FT
RT. 2+70	= 10 SQ FT
LT. 2+70	= 10 SQ FT
RT. 4+06	= 10 SQ FT
LT. 4+06	= 10 SQ FT
TOTAL	= 100 SQ FT

SIDEWALK REMOVAL

A	= 62 SQ FT
B	= 77 SQ FT
C	= 128 SQ FT
D	= 120 SQ FT
E	= 1702 SQ FT
F	= 1050 SQ FT
G	= 900 SQ FT
H	= 489 SQ FT
TOTAL	= 4528 SQ FT

PIPE DRAINS 4"

STA. RT. 2+65	= 10 SQ FT
STA. RT. 3+25	= 10 SQ FT
STA. RT. 5+67	= 10 SQ FT
TOTAL	= 30 SQ FT

PIPE DRAINS 12"

STA. LT. 0+37	= 10 SQ FT
STA. RT. 0+41	= 10 SQ FT
STA. RT. 0+72	= 10 SQ FT
STA. RT. 0+82	= 10 SQ FT
TOTAL	= 40 SQ FT

Horizontal Scale = 1:20
Vertical Scale = 1:10

Connor & Connor, Inc.
210 East Locust Street
P.O. Box 618
Robinson, Illinois 62454

CONNOR & CONNOR
Consulting Engineers
Land Surveyors

Phone: (618) 544-8623
Fax: (618) 544-3012
Design Firm #: 184-000832
www.connorengineers.com

PROJECT NAME:
CITY OF SUMNER
SEC. 22-00005-00-SW
SOUTH CHRISTY AVE
WEST LOCUST STREET

PLAN-PROFILE
STA. 0+00 TO STA. 6+50
W. LOCUST ST.

SHEET NUMBER:
5 OF 18
CONTRACT NUMBER:
95954

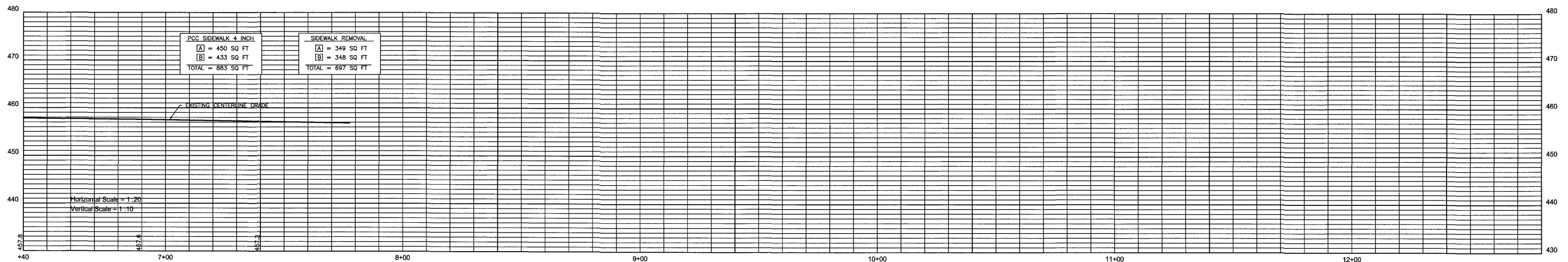
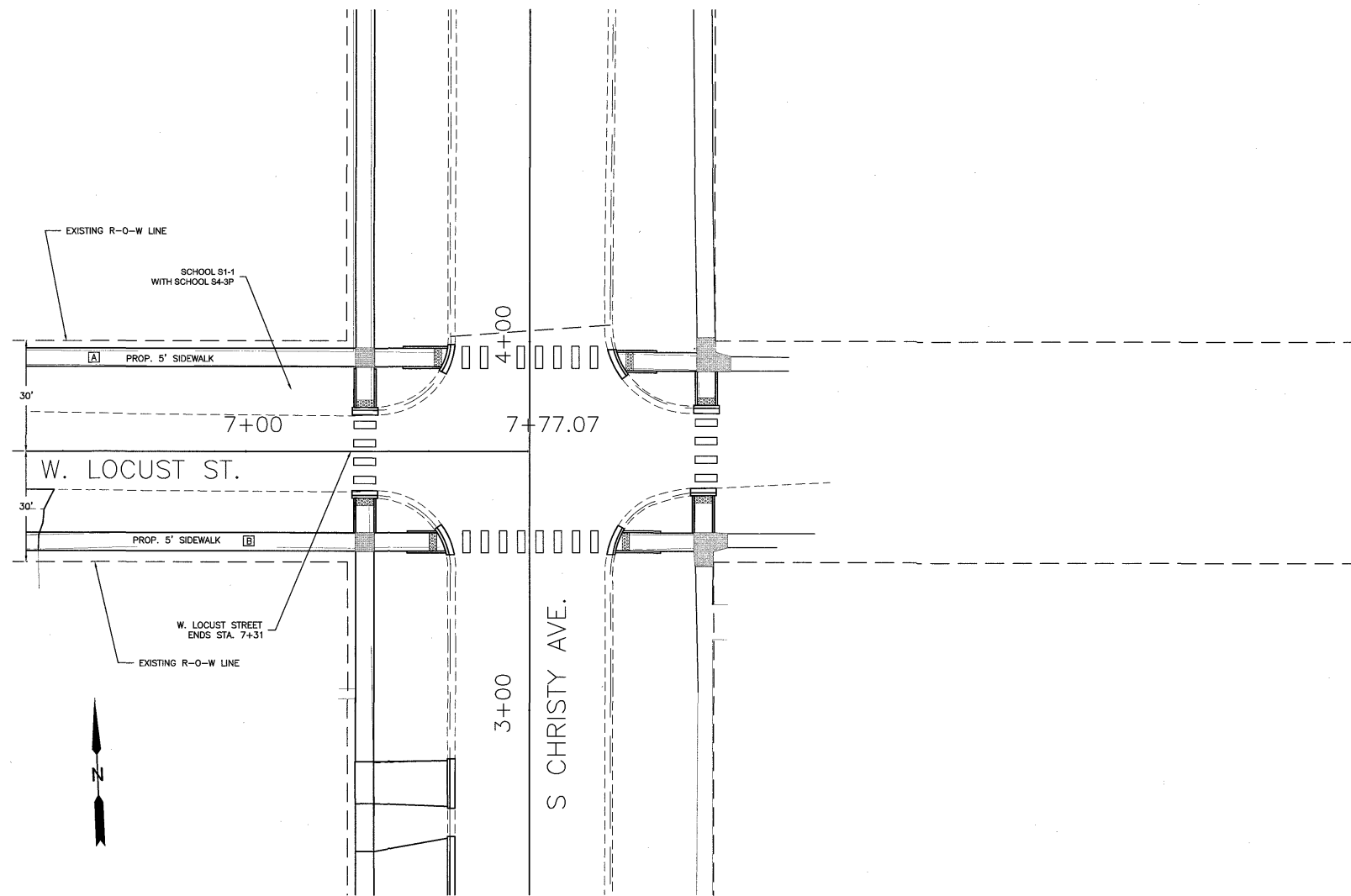

Connor & Connor, Inc.
 210 East Locust Street
 P.O. Box 618
 Robinson, Illinois 62454

CONNOR & CONNOR
 Consulting Engineers
 Land Surveyors

Phone: (618) 544-8623
 Fax: (618) 544-3012
 Design Firm #: 184-000832
 www.connorengineers.com

PROJECT NAME:
 CITY OF SUMNER
 SEC. 22-00005-00-SW
 SOUTH CHRISTY AVE
 WEST LOCUST STREET

PLAN-PROFILE
 STA. 6+50 TO STA. 7+77
 W. LOCUST ST.

SHEET NUMBER:
 6 OF 18
 CONTRACT NUMBER:
 95954

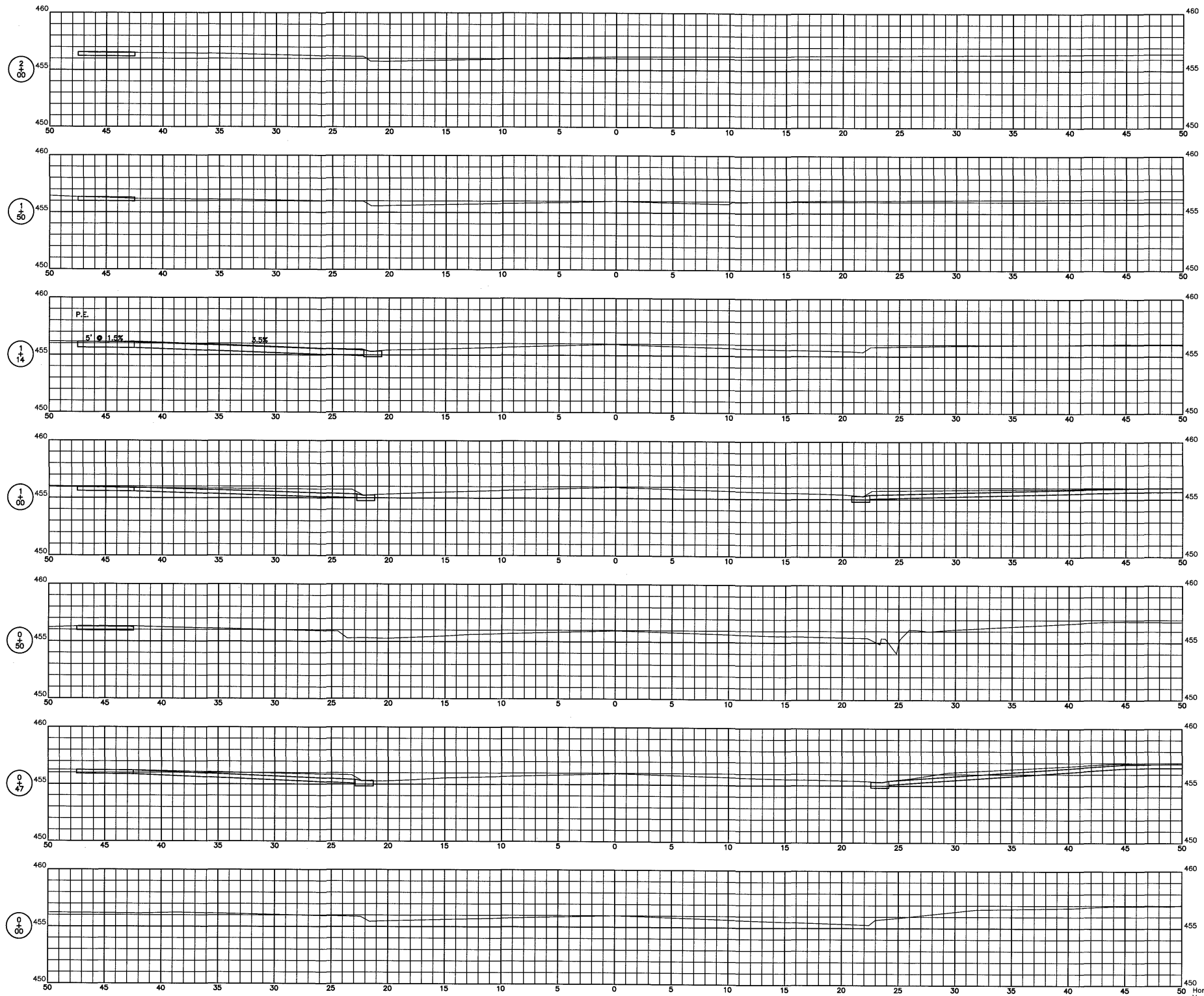

Horizontal Scale 5
Vertical Scale 5

Connor & Connor, Inc.
210 East Locust Street
P.O. Box 618
Robinson, Illinois 62454

CONNOR & CONNOR
Consulting Engineers
Land Surveyors

Phone: (618) 544-8623
Fax: (618) 544-3012
Design Firm #: 184-000832
www.connorengineers.com

PROJECT NAME:
CITY OF SUMNER
SEC. 22-00005-00-SW
SOUTH CHRISTY AVE
WEST LOCUST STREET

CROSS SECTIONS
STA. 0+00 TO STA. 2+00
S. CHRISTY AVE.

SHEET NUMBER:
7 OF 18
CONTRACT NUMBER:
95954

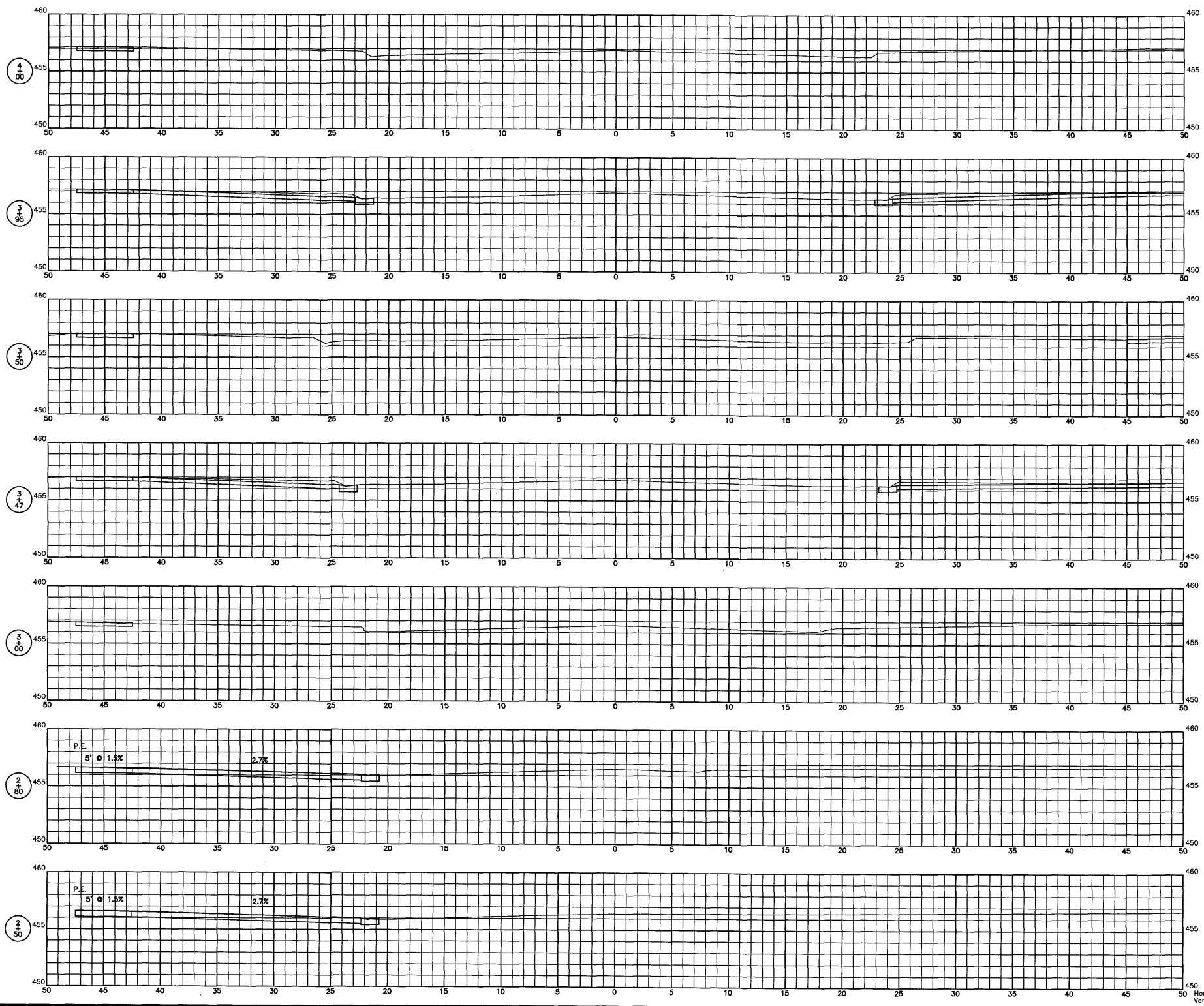

Horizontal Scale 5
Vertical Scale 5

Connor & Connor, Inc.
210 East Locust Street
P.O. Box 618
Robinson, Illinois 62454

CONNOR & CONNOR
Consulting Engineers
Land Surveyors

Phone: (618) 544-8623
Fax: (618) 544-3012
Design Firm #: 184-000832
www.connorengineers.com

PROJECT NAME: CITY OF SUMNER
SEC. 22-00005-00-SW
SOUTH CHRISTY AVE
WEST LOCUST STREET

CROSS SECTIONS
STA. 2+50 TO STA. 4+00
S. CHRISTY AVE.

SHEET NUMBER:
8 OF 18
CONTRACT NUMBER:
95954

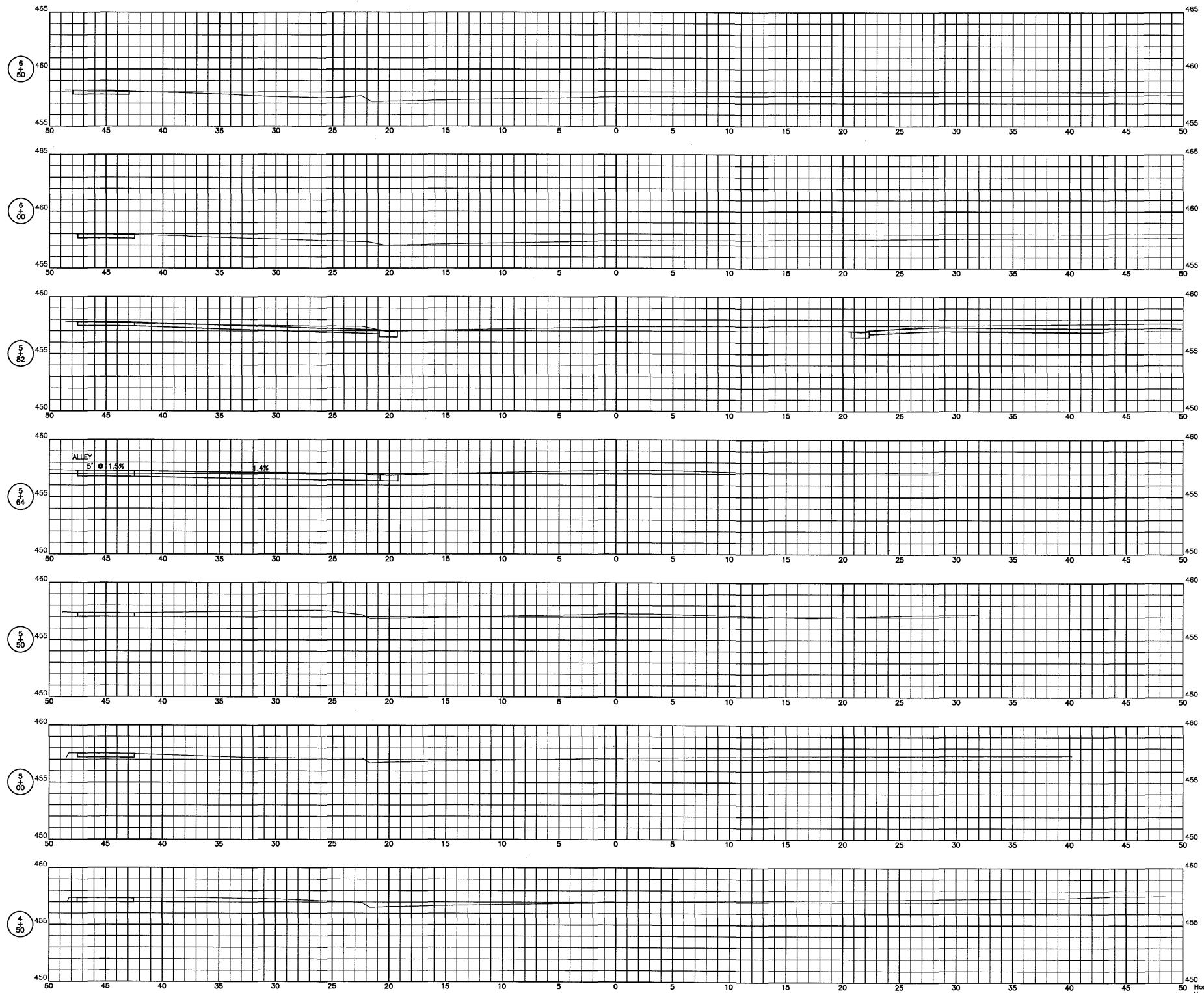

Horizontal Scale 5
Vertical Scale 5

Connor & Connor, Inc.
210 East Locust Street
P.O. Box 618
Robinson, Illinois 62454

CONNOR & CONNOR
Consulting Engineers
Land Surveyors

Phone: (618) 544-8623
Fax: (618) 544-3012
Design Firm #: 184-000832
www.connorengineers.com

PROJECT NAME:
CITY OF SUMNER
SEC. 22-00005-00-SW
SOUTH CHRISTY AVE
WEST LOCUST STREET

CROSS SECTIONS
STA. 4+50 TO STA. 6+50
S. CHRISTY AVE.

SHEET NUMBER:
9 OF 18
CONTRACT NUMBER:
95954

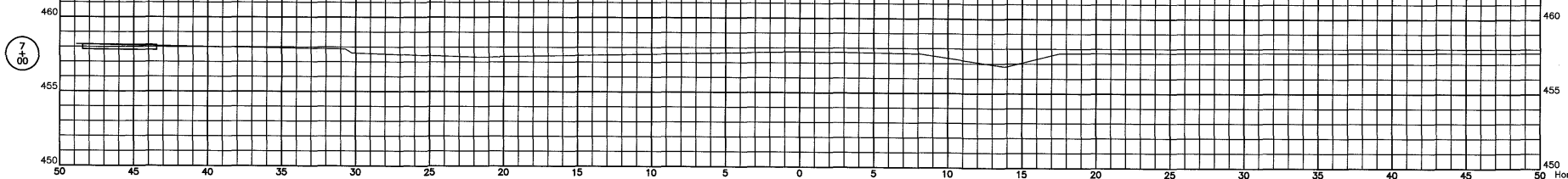
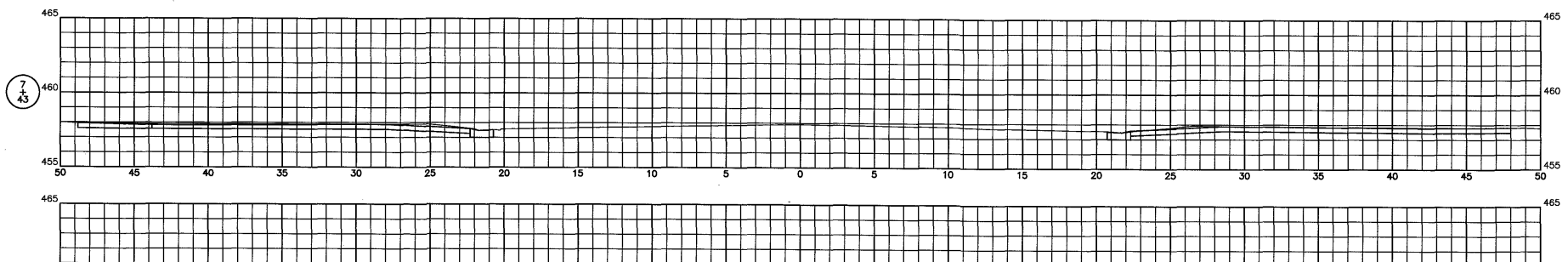
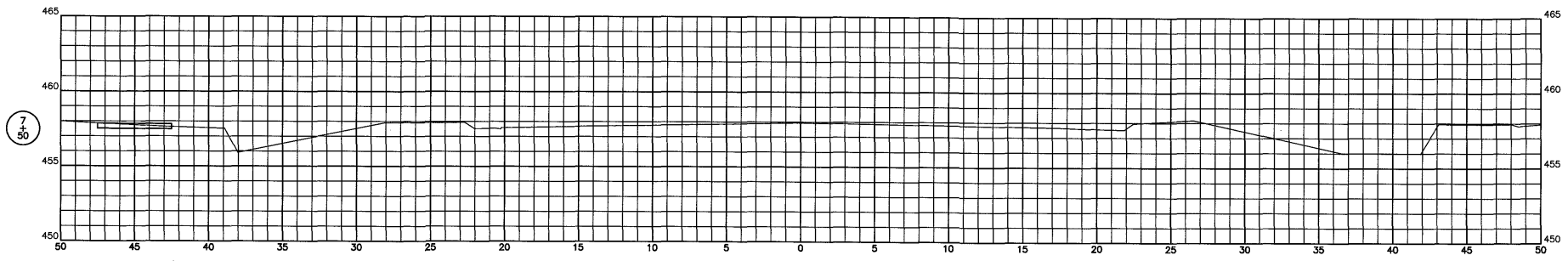
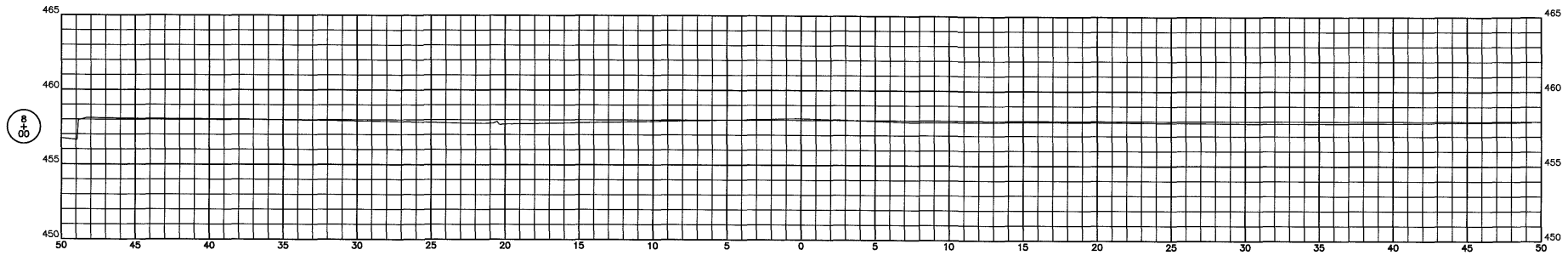
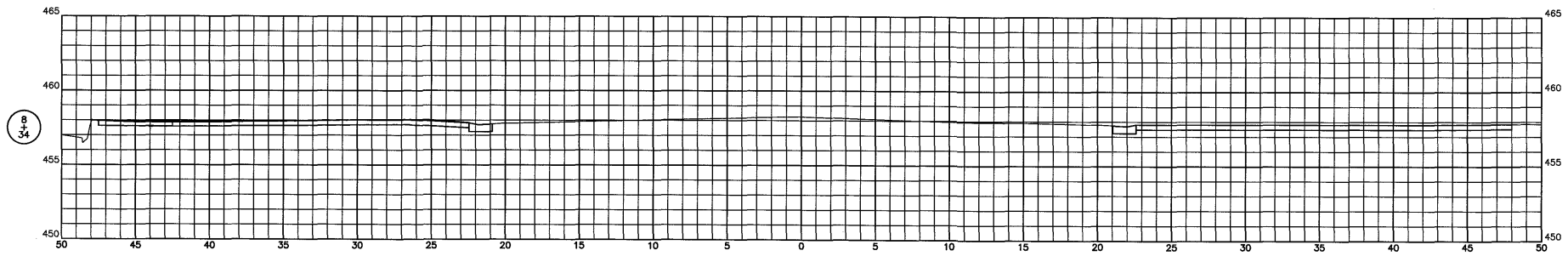
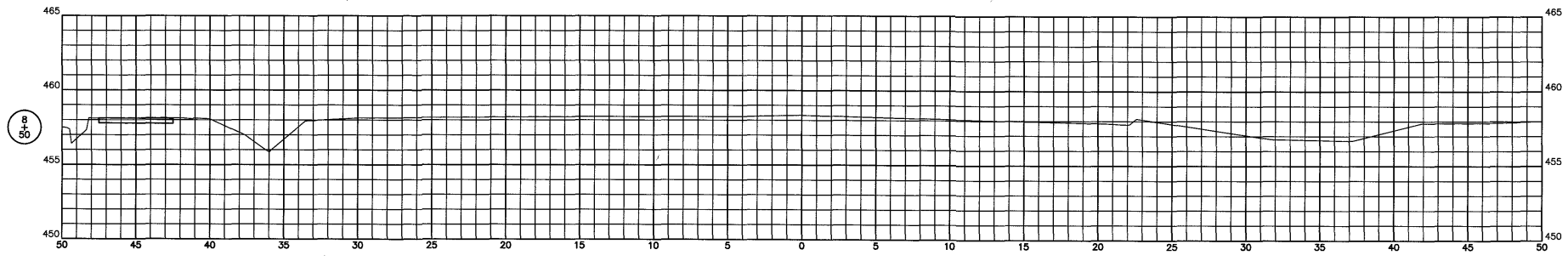

Horizontal Scale 5
Vertical Scale 5

Connor & Connor, Inc.
210 East Locust Street
P.O. Box 618
Robinson, Illinois 62454

CONNOR & CONNOR
Consulting Engineers
Land Surveyors

Phone: (618) 544-8623
Fax: (618) 544-3012
Design Firm #: 184-000832
www.connorengineers.com

PROJECT NAME:
CITY OF SUMNER
SEC. 22-00005-00-SW
SOUTH CHRISTY AVE
WEST LOCUST STREET

CROSS SECTIONS
STA. 7+00 TO STA. 8+50
S. CHRISTY AVE.

SHEET NUMBER:
10 OF 18
CONTRACT NUMBER:
95954

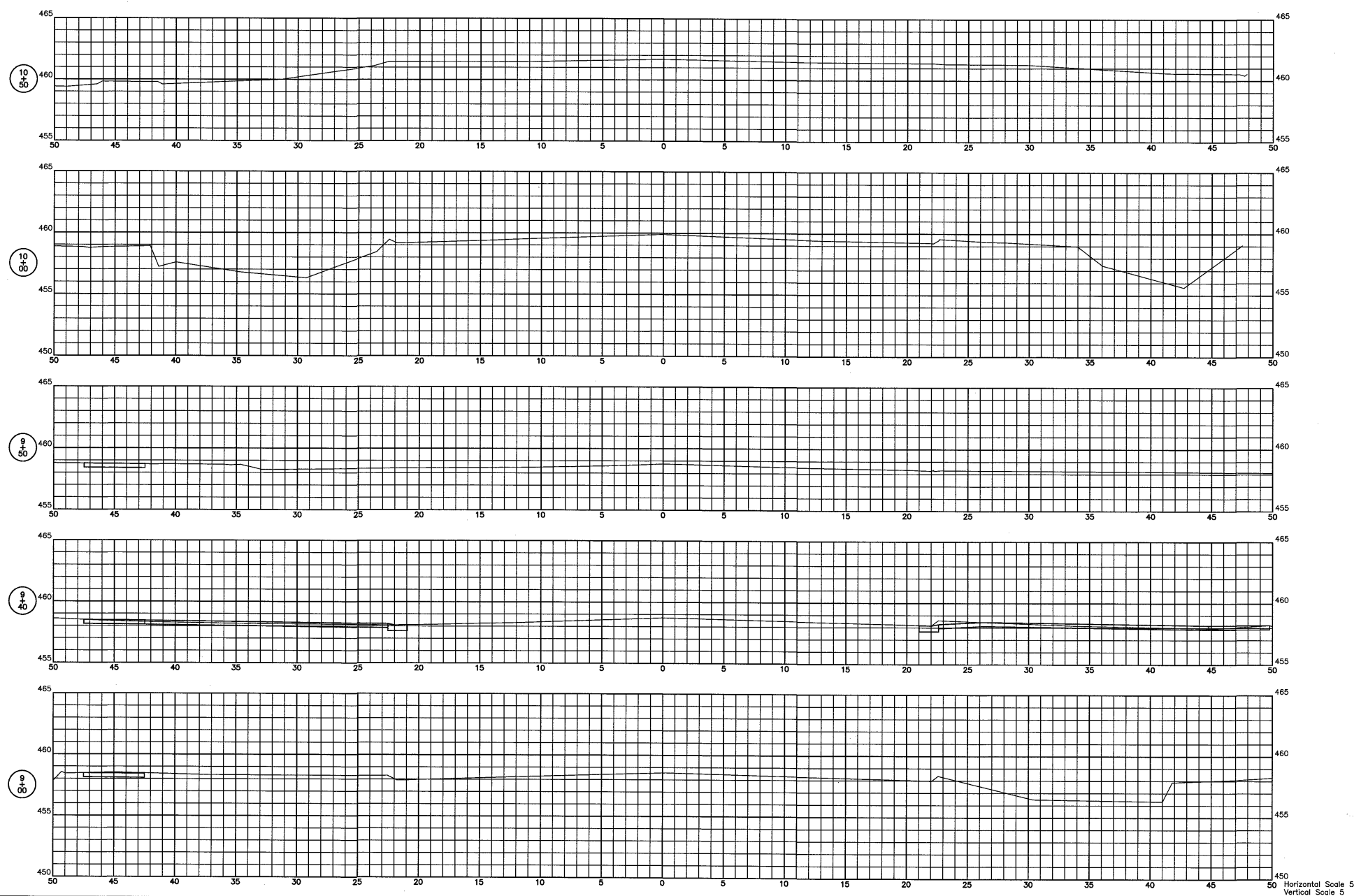

Horizontal Scale 5
Vertical Scale 5

Connor & Connor, Inc.
210 East Locust Street
P.O. Box 618
Robinson, Illinois 62454

CONNOR & CONNOR
Consulting Engineers
Land Surveyors

Phone: (618) 544-8623
Fax: (618) 544-3012
Design Firm #: 184-000832
www.connorengineers.com

PROJECT NAME: CITY OF SUMNER
SEC. 22-00005-00-SW
SOUTH CHRISTY AVE
WEST LOCUST STREET

CROSS SECTIONS
STA. 9+00 TO STA. 10+50
S. CHRISTY AVE.

SHEET NUMBER:
11 OF 18
CONTRACT NUMBER:
95954

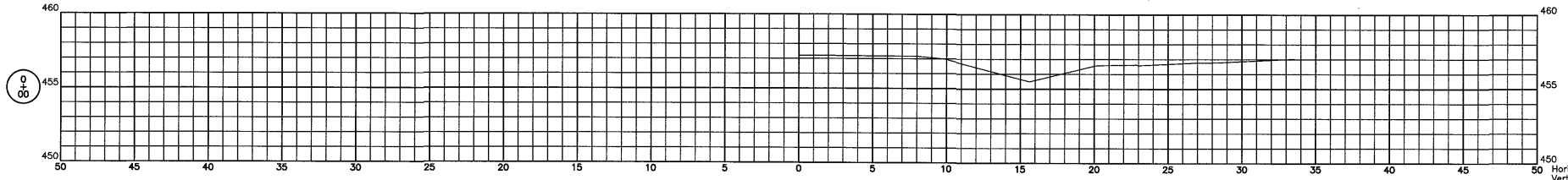
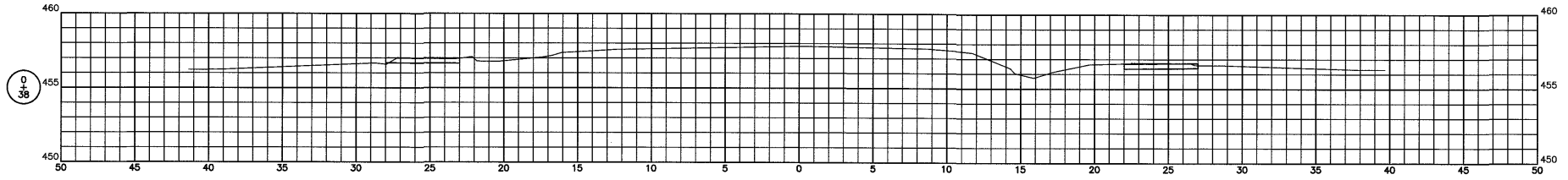
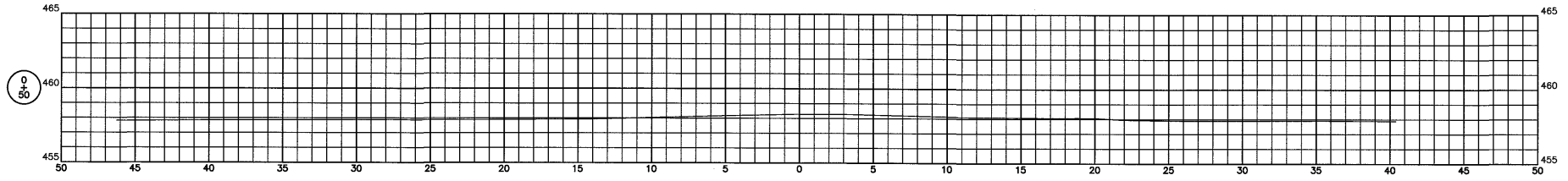
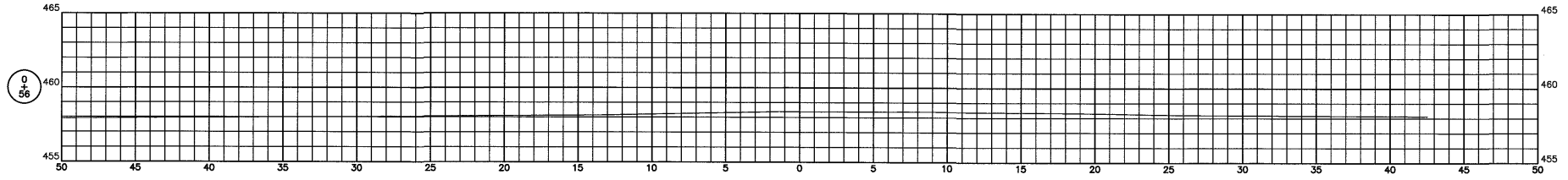
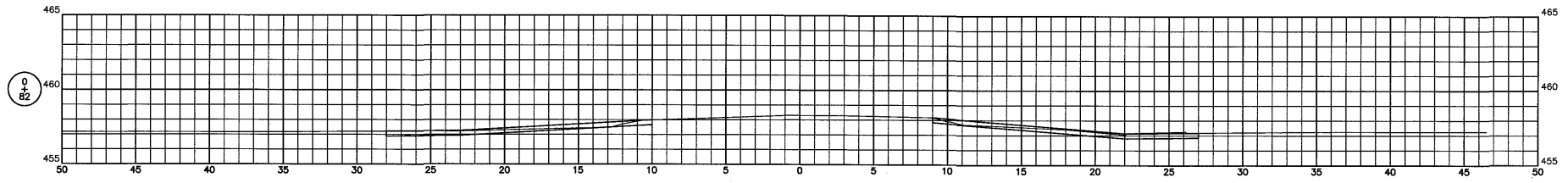
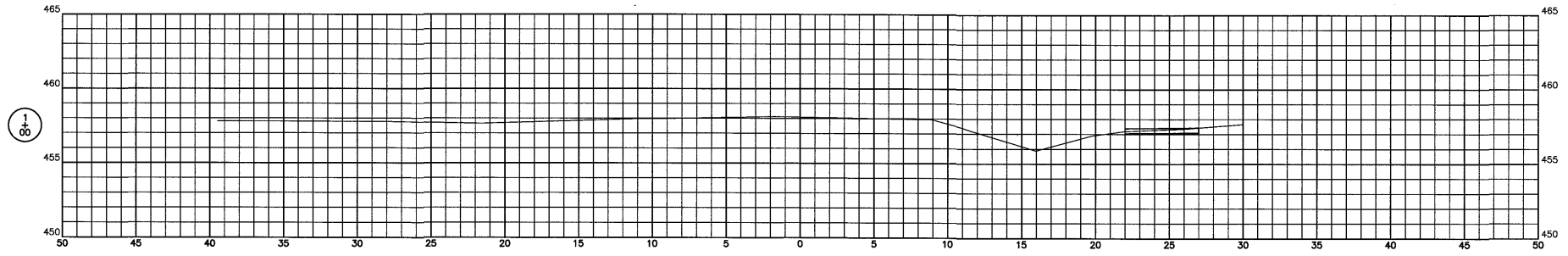
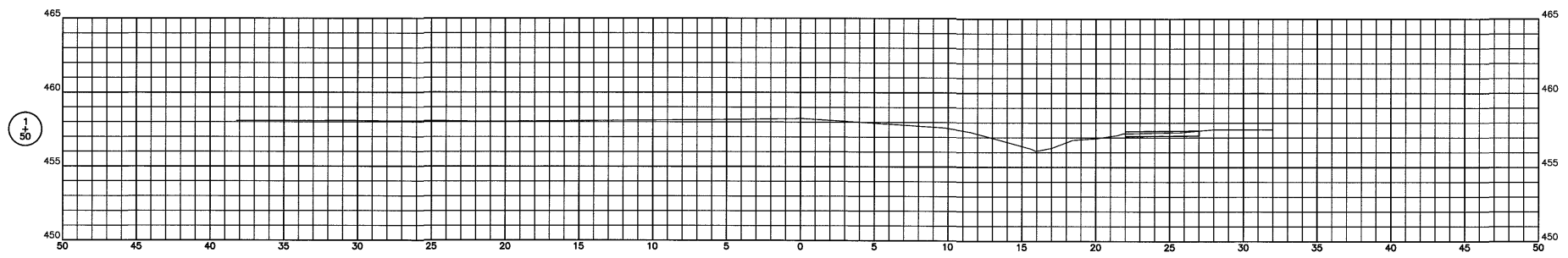

Horizontal Scale 5
Vertical Scale 5

Connor & Connor, Inc.
210 East Locust Street
P.O. Box 618
Robinson, Illinois 62454

CONNOR & CONNOR
Consulting Engineers
Land Surveyors

Phone: (618) 544-8623
Fax: (618) 544-3012
Design Firm #: 184-000832
www.connorengineers.com

PROJECT NAME:
CITY OF SUMNER
SEC. 22-00005-00-SW
SOUTH CHRISTY AVE
WEST LOCUST STREET

CROSS SECTIONS
STA. 0+00 TO STA. 1+50
W. LOCUST ST.

SHEET NUMBER:
12 OF 18
CONTRACT NUMBER:
95954

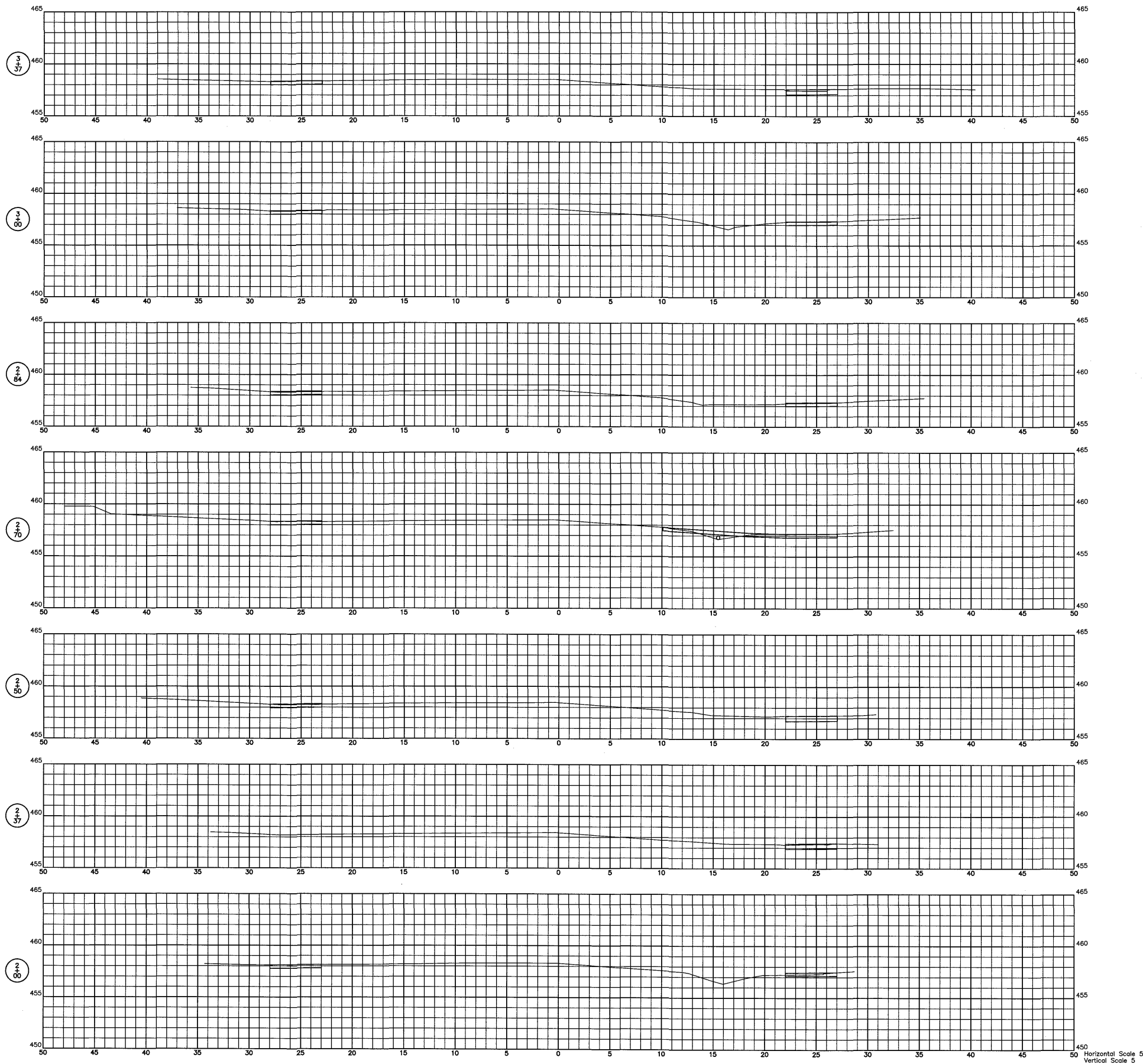

Horizontal Scale 5
Vertical Scale 5

Connor & Connor, Inc.
210 East Locust Street
P.O. Box 618
Robinson, Illinois 62454

CONNOR & CONNOR
Consulting Engineers
Land Surveyors

Phone: (618) 544-8623
Fax: (618) 544-3012
Design Firm #: 184-000832
www.connorengineers.com

PROJECT NAME:
CITY OF SUMNER
SEC. 22-00005-00-SW
SOUTH CHRISTY AVE
WEST LOCUST STREET

CROSS SECTIONS
STA. 2+00 TO STA. 3+37
W. LOCUST ST.

SHEET NUMBER:
13 OF 18
CONTRACT NUMBER:
95954

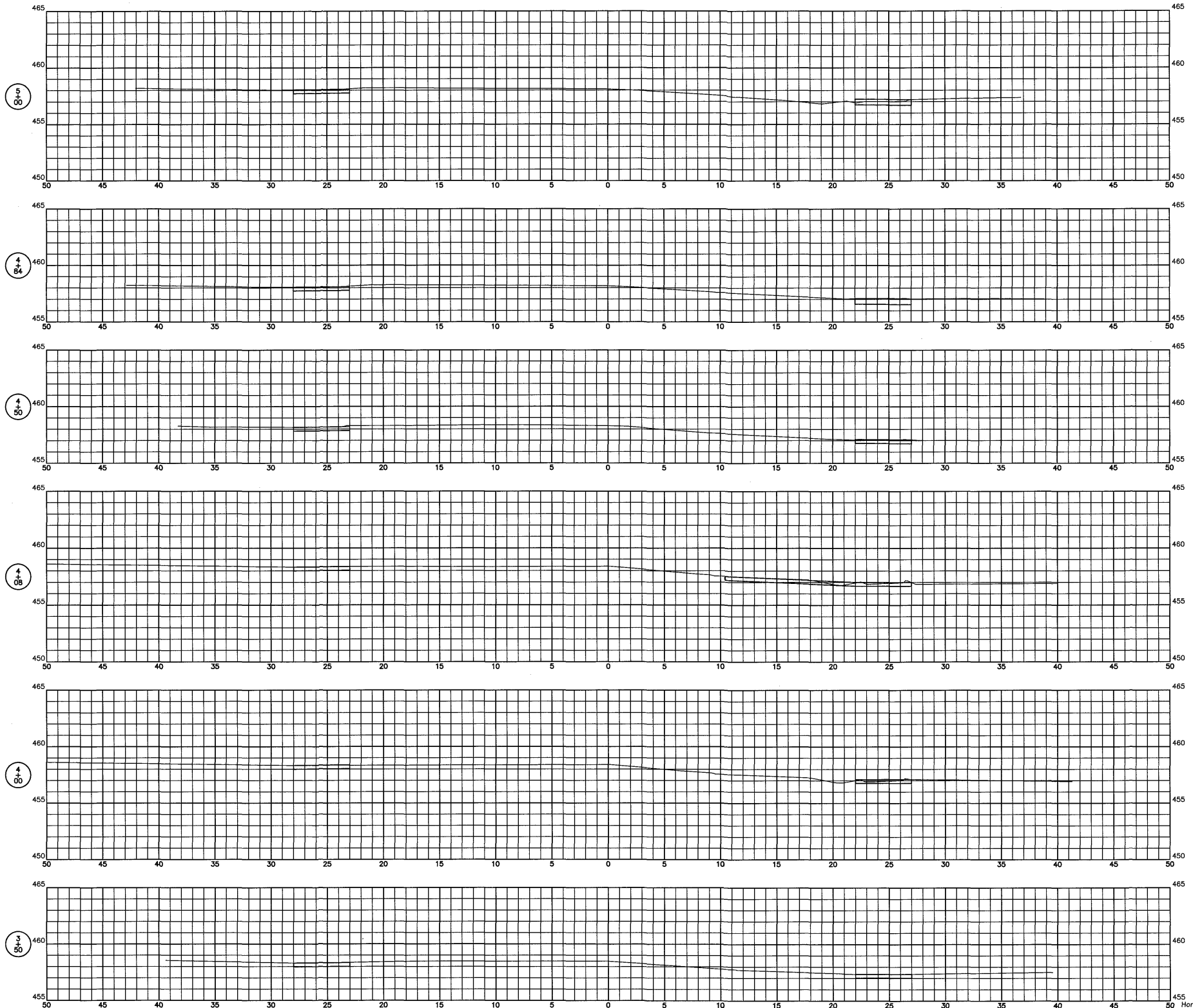

Horizontal Scale 5
Vertical Scale 5

Connor & Connor, Inc.
210 East Locust Street
P.O. Box 618
Robinson, Illinois 62454

CONNOR & CONNOR
Consulting Engineers
Land Surveyors

Phone: (618) 544-8623
Fax: (618) 544-3012
Design Firm #: 184-000832
www.connorengineers.com

PROJECT NAME:
CITY OF SUMNER
SEC. 22-00005-00-SW
SOUTH CHRISTY AVE
WEST LOCUST STREET

CROSS SECTIONS
STA. 3+50 TO STA. 5+00
W. LOCUST ST.

SHEET NUMBER:
14 OF 18
CONTRACT NUMBER:
95954

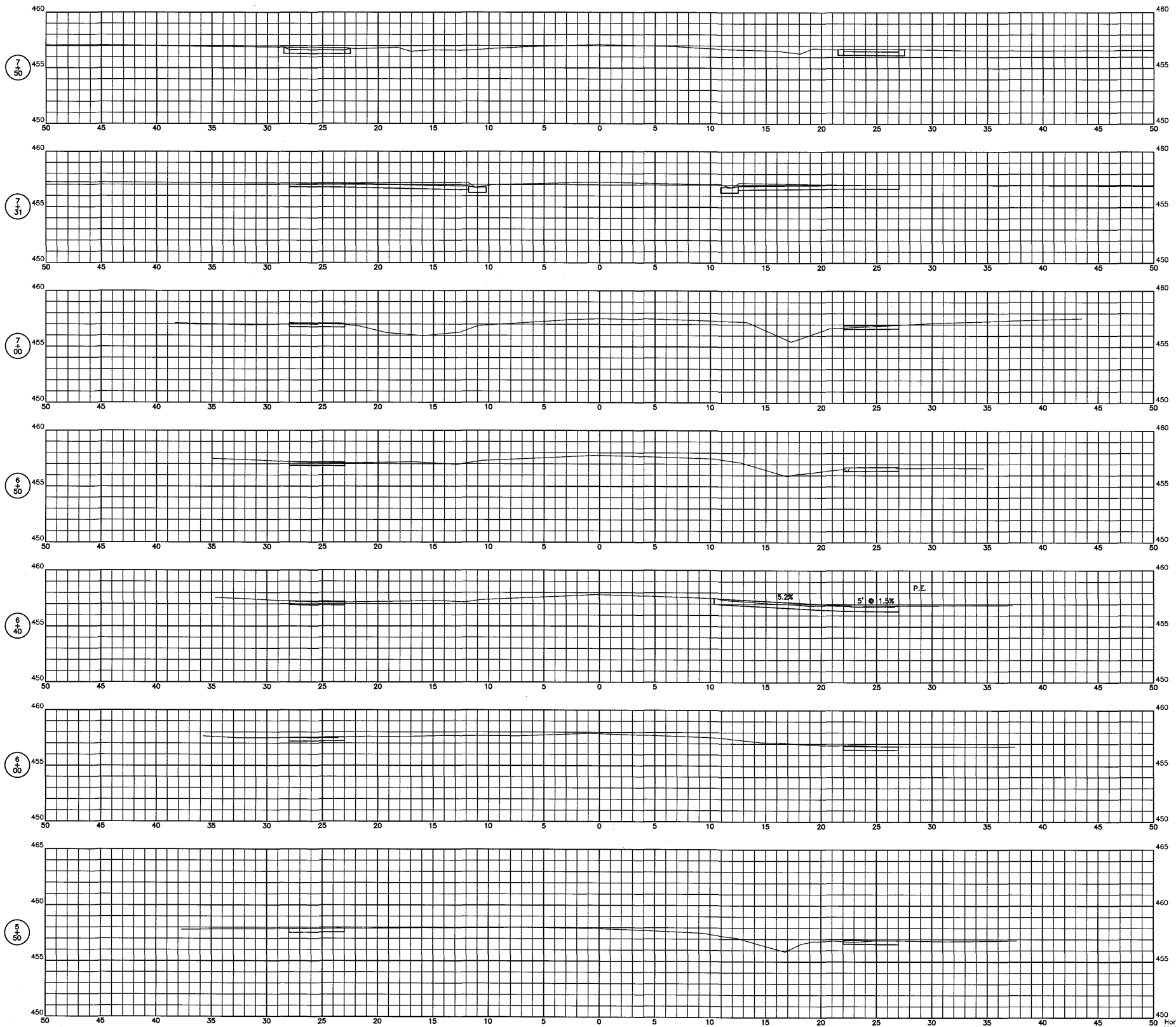

Horizontal Scale 5
Vertical Scale 5

Connor & Connor, Inc.
210 East Locust Street
P.O. Box 618
Robinson, Illinois 62454

CONNOR & CONNOR
Consulting Engineers
Land Surveyors

Phone: (618) 544-8623
Fax: (618) 544-3012
Design Firm #: 184-000832
www.connorengineers.com

PROJECT NAME:
CITY OF SUMNER
SEC. 22-00005-00-SW
SOUTH CHRISTY AVE
WEST LOCUST STREET

CROSS SECTIONS
STA. 5+50 TO STA. 7+50
W. LOCUST ST.

SHEET NUMBER:
15 OF 18
CONTRACT NUMBER:
95954

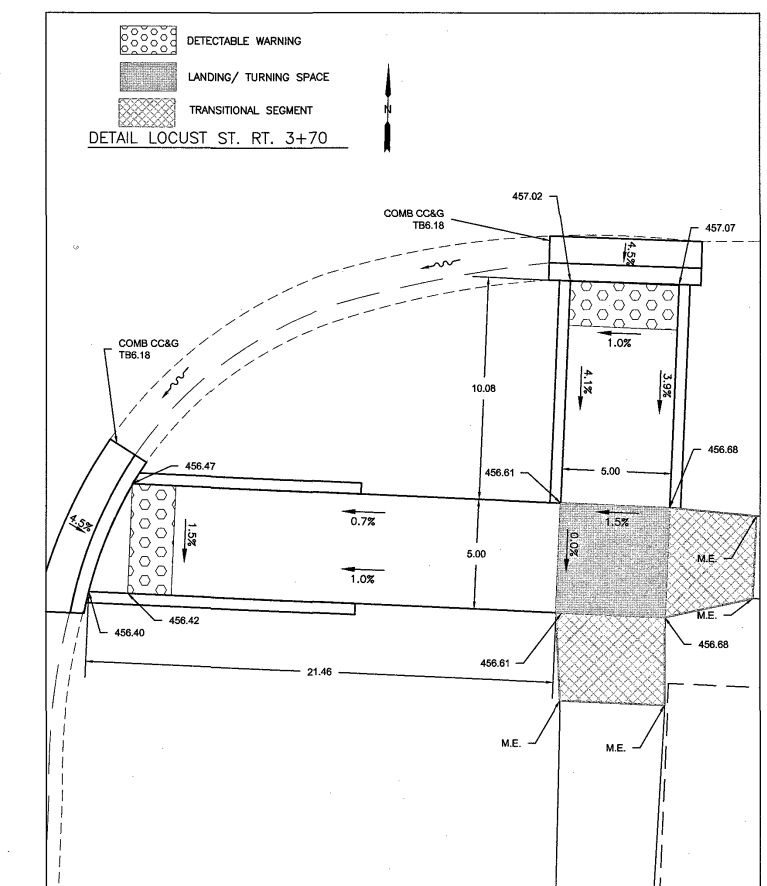
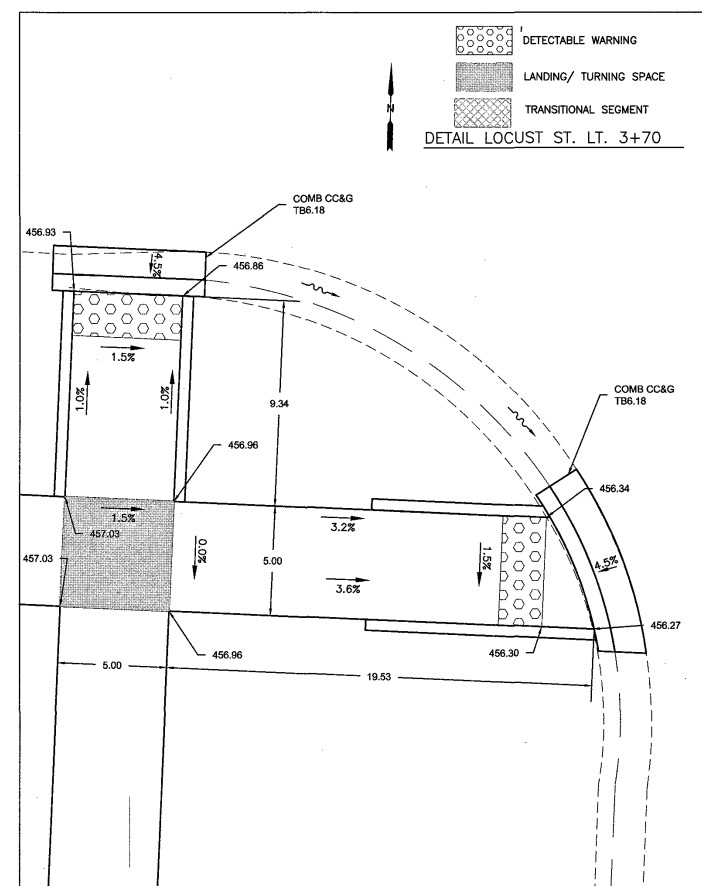
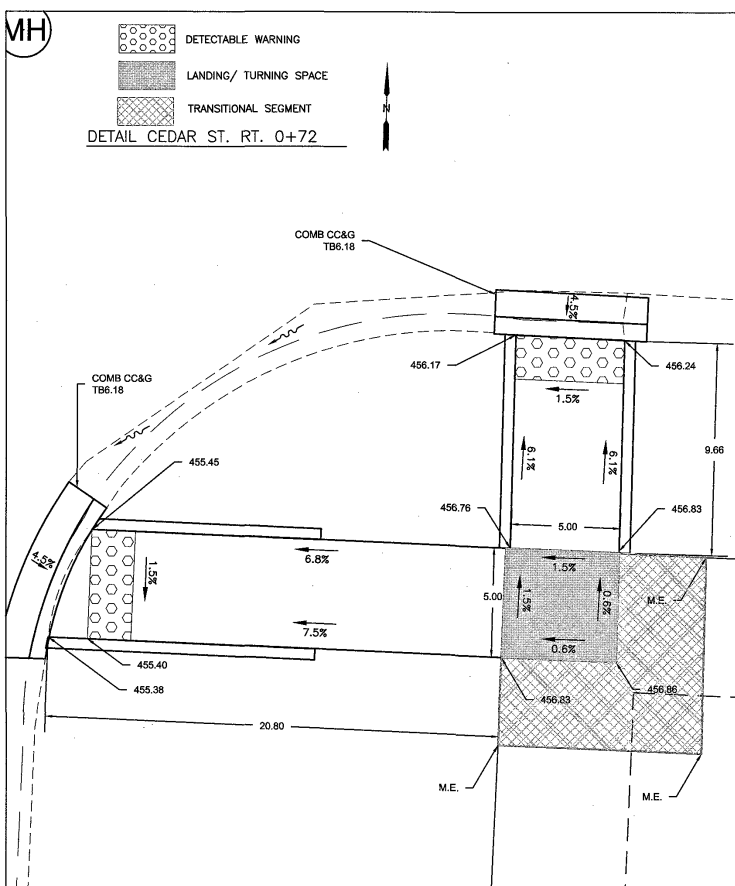
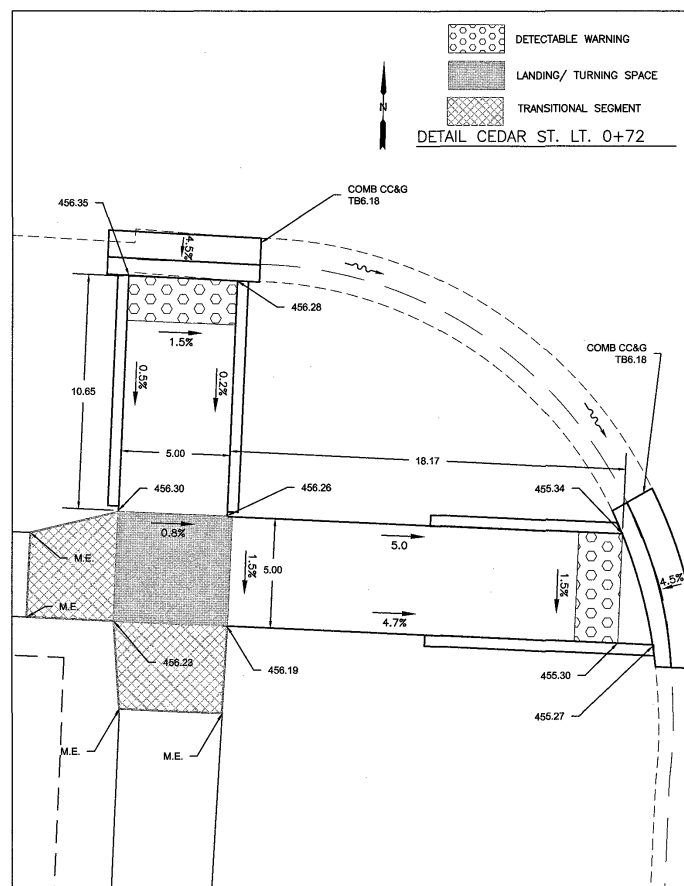
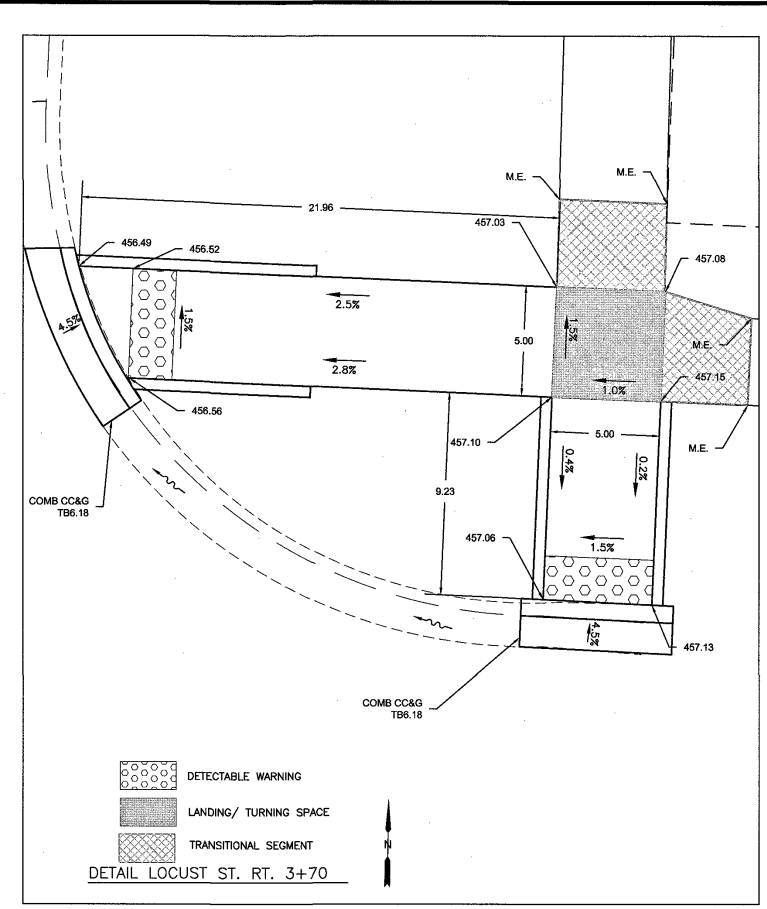
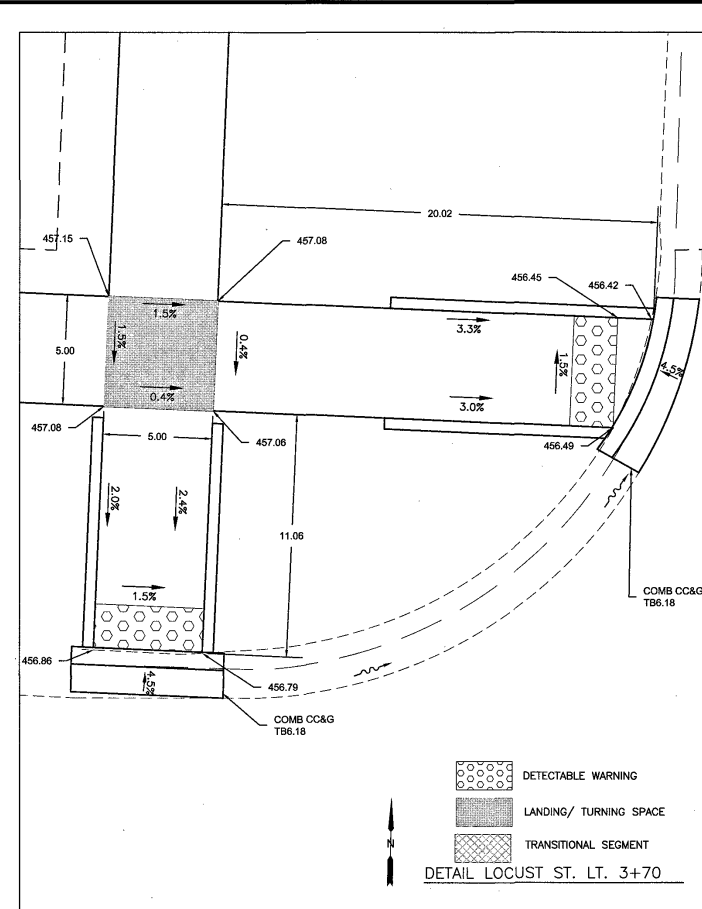
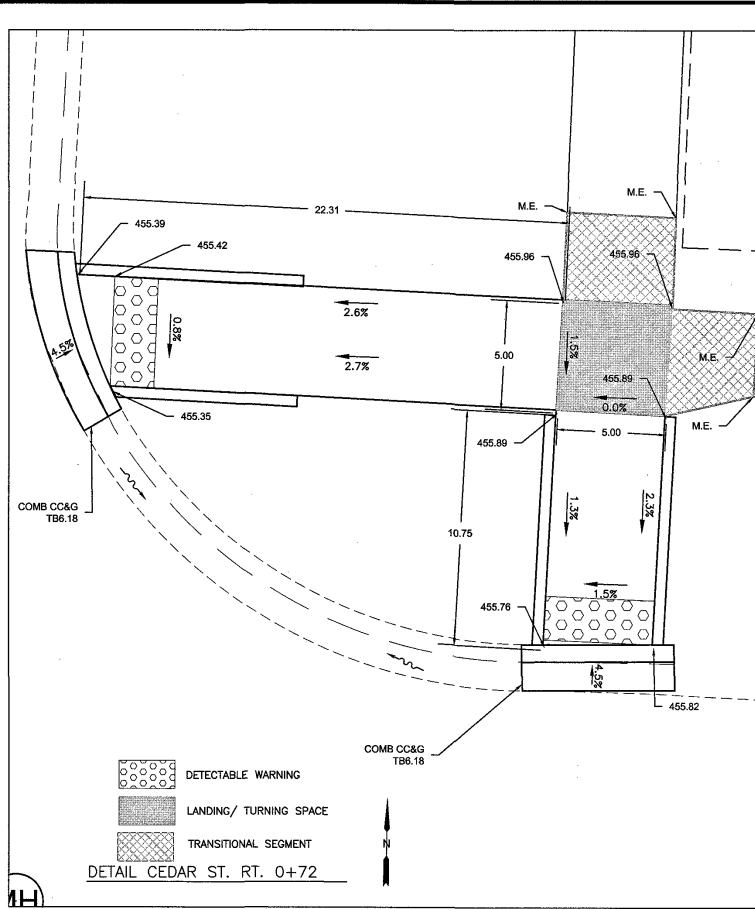
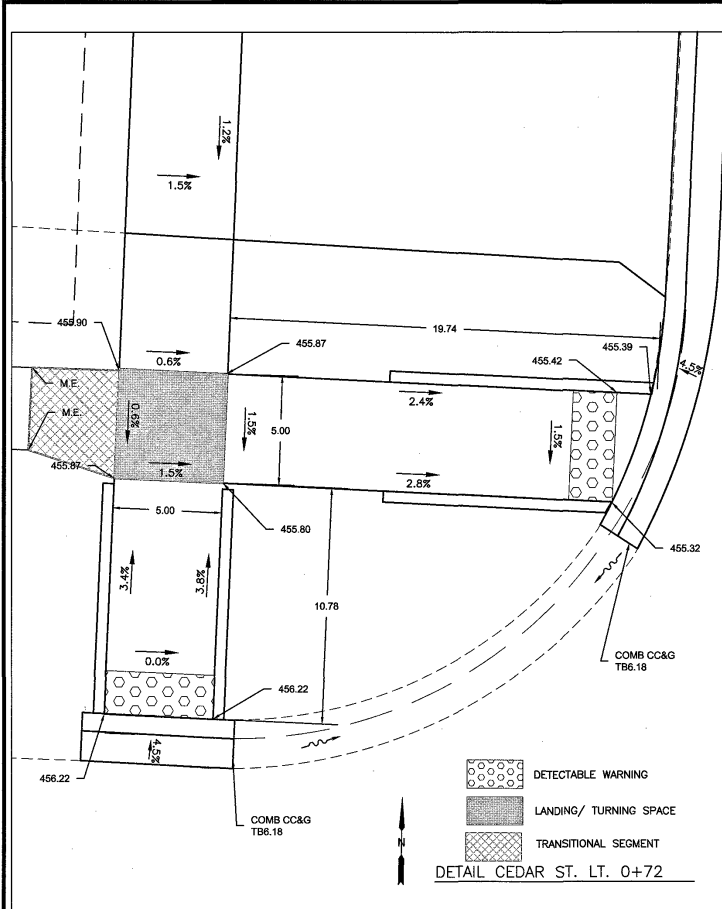

Vertical Scale 5

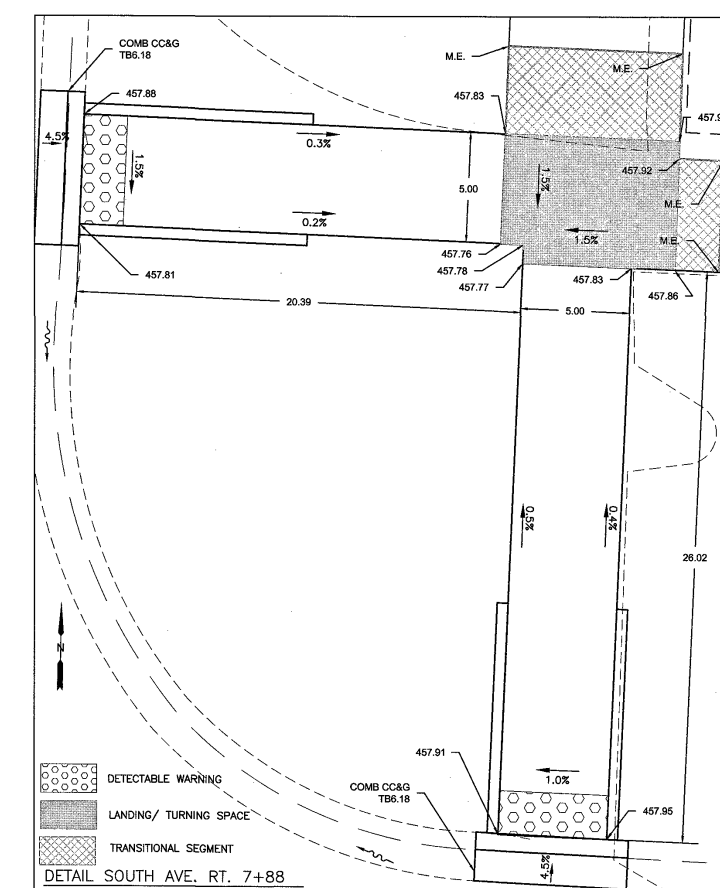
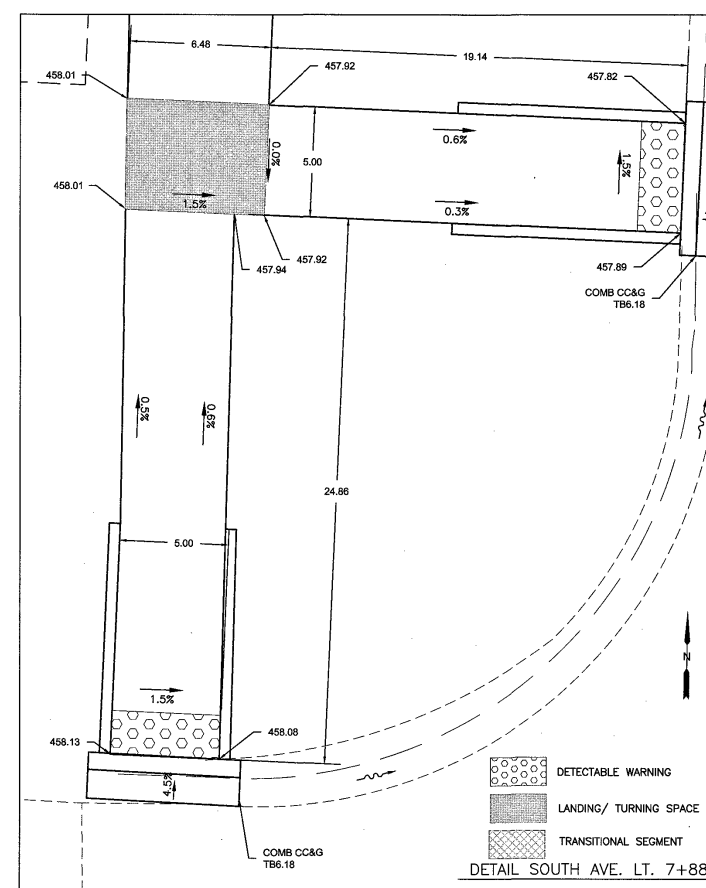
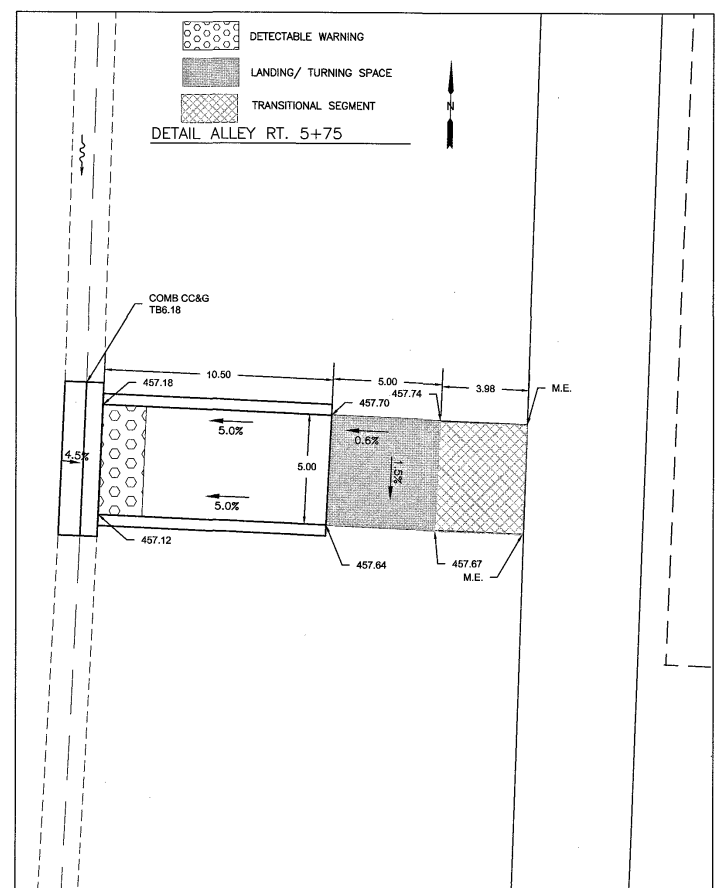
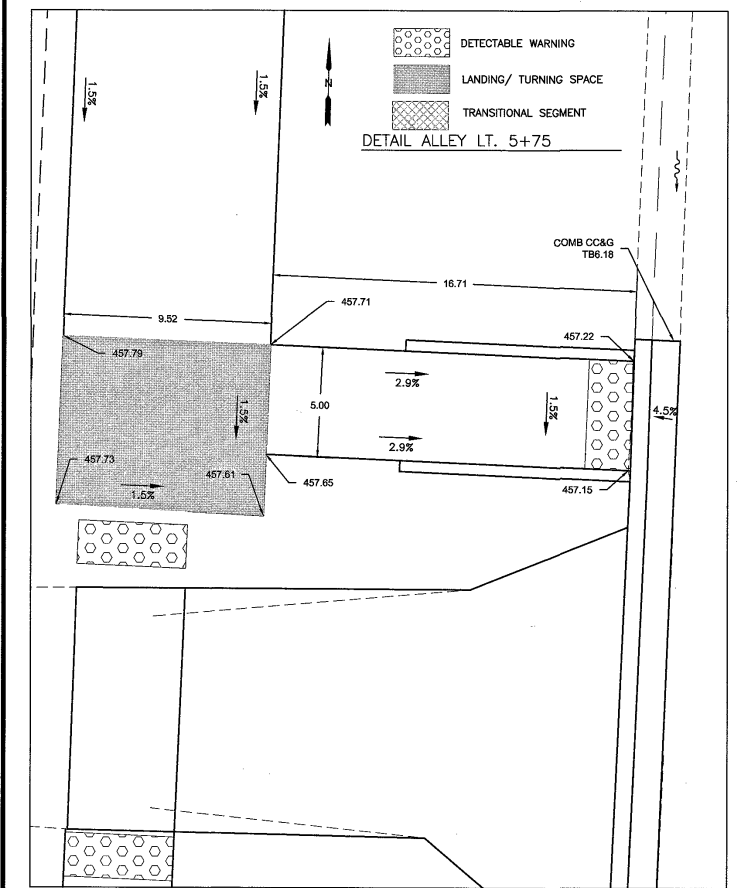
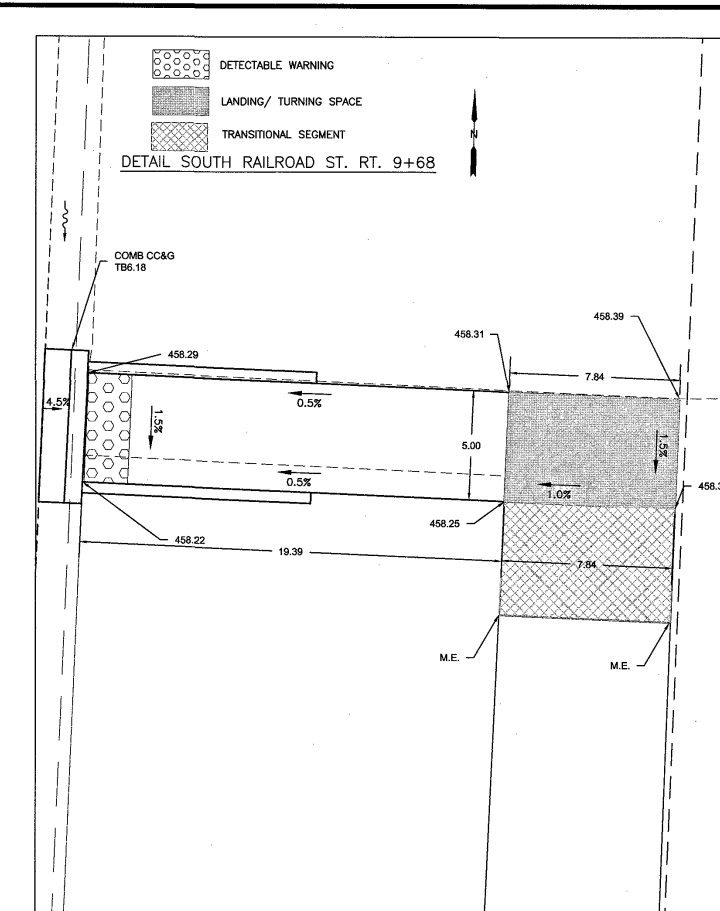
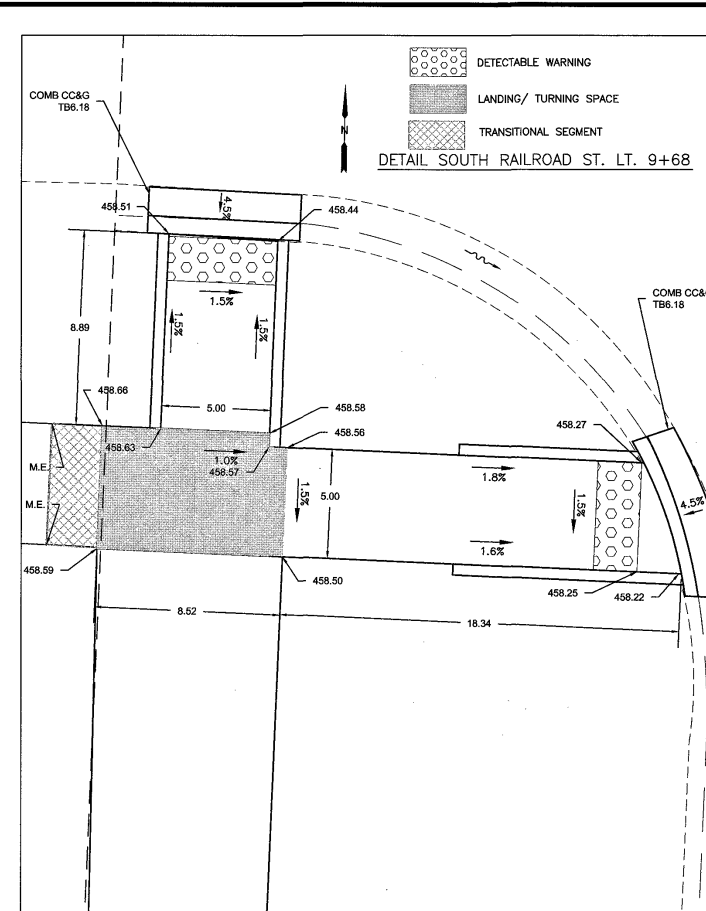
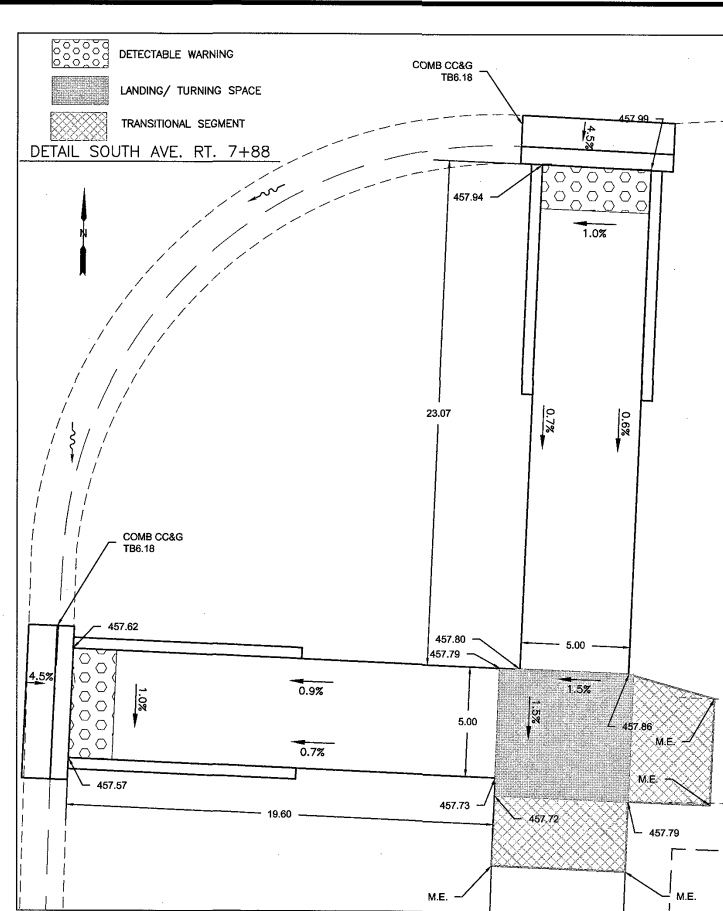
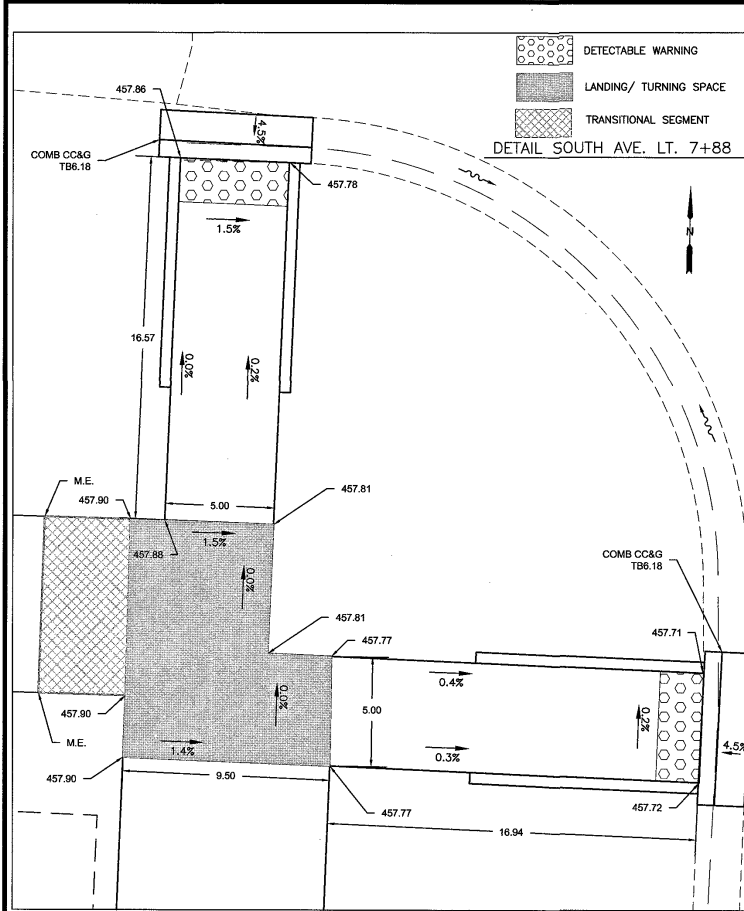

Vertical Scale 5

Connor & Connor, Inc.
210 East Locust Street
P.O. Box 618
Robinson, Illinois 62454

CONNOR & CONNOR
Consulting Engineers
Land Surveyors

Phone: (618) 544-8623
Fax: (618) 544-3012
Design Firm #: 184-000832
www.connorengineers.com

PROJECT NAME:
CITY OF SUMNER
SEC. 22-00005-00-SW
SOUTH CHRISTY AVE
WEST LOCUST STREET

ADA DETAILS
S. CHRISTY AVE.

SHEET NUMBER:
17 OF 18
CONTRACT NUMBER:
95954

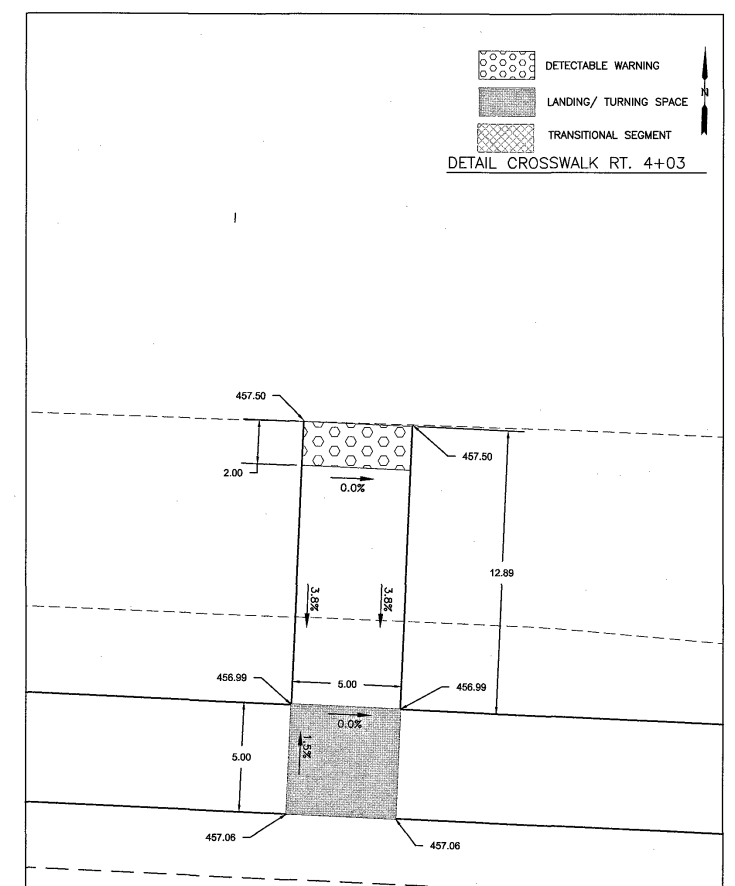
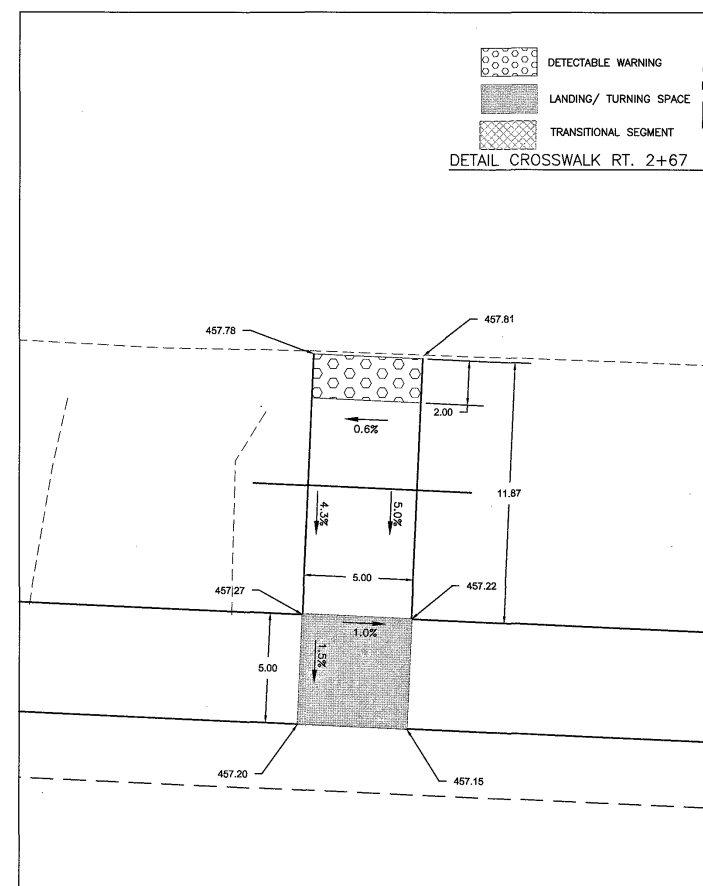
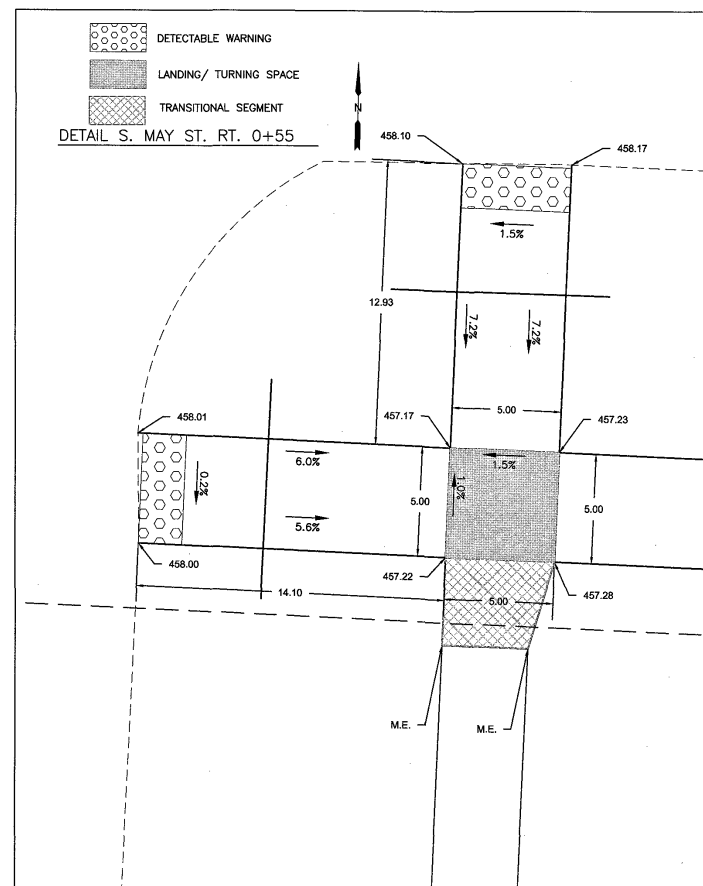
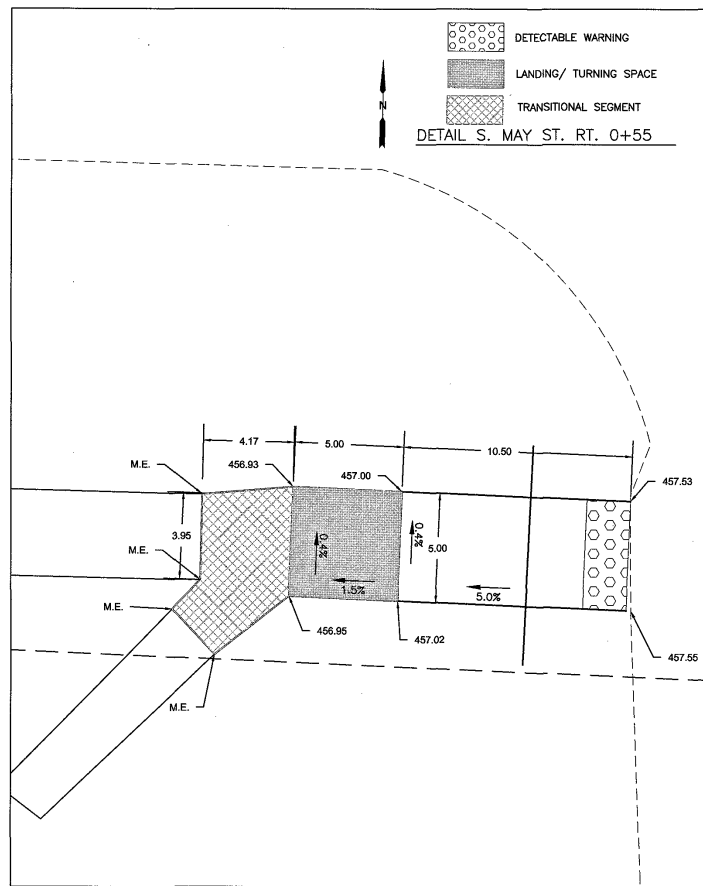
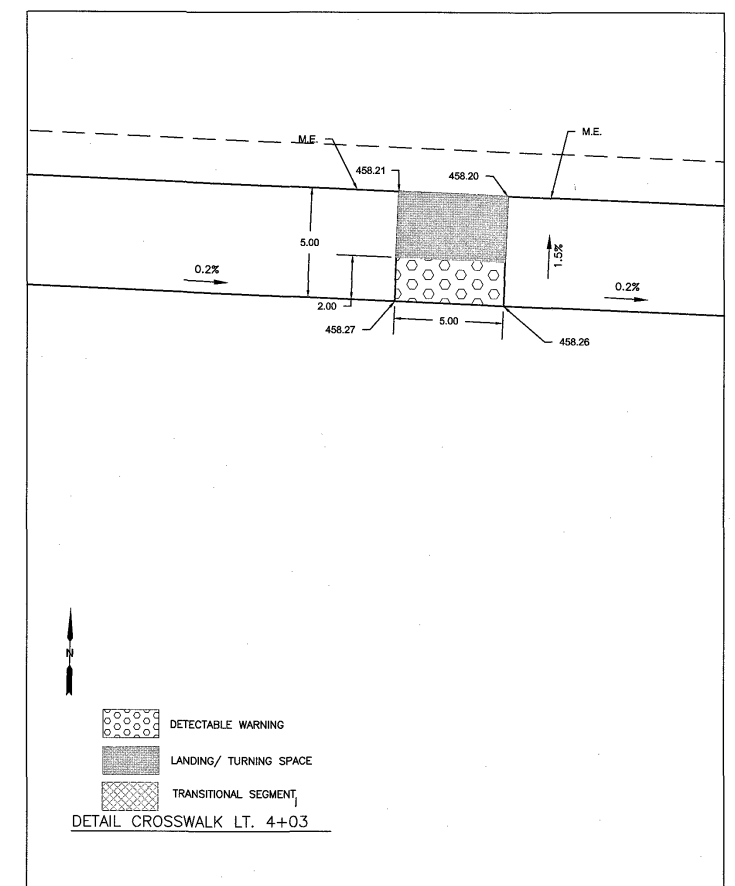
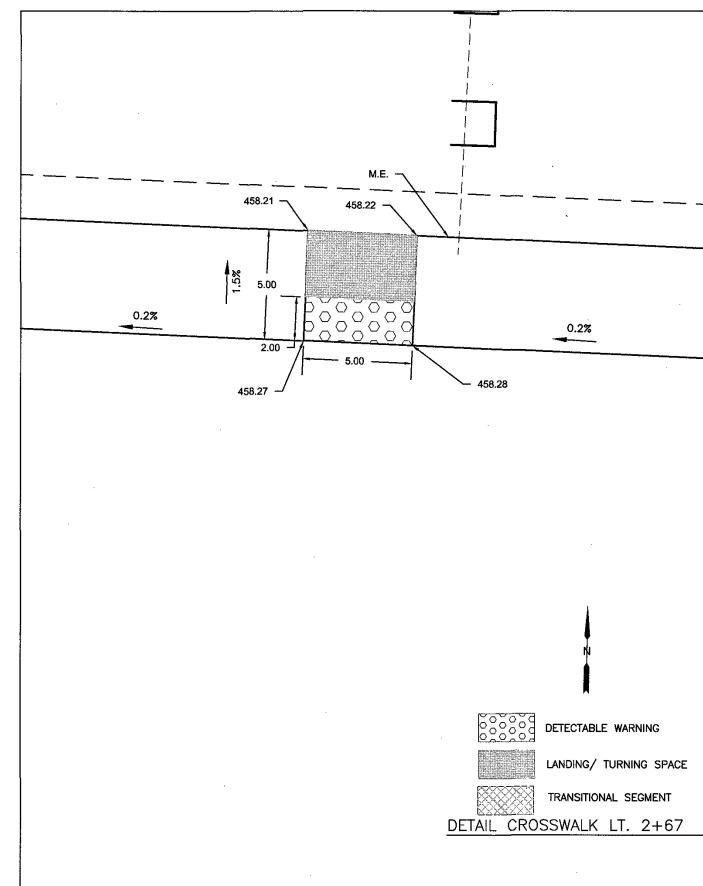
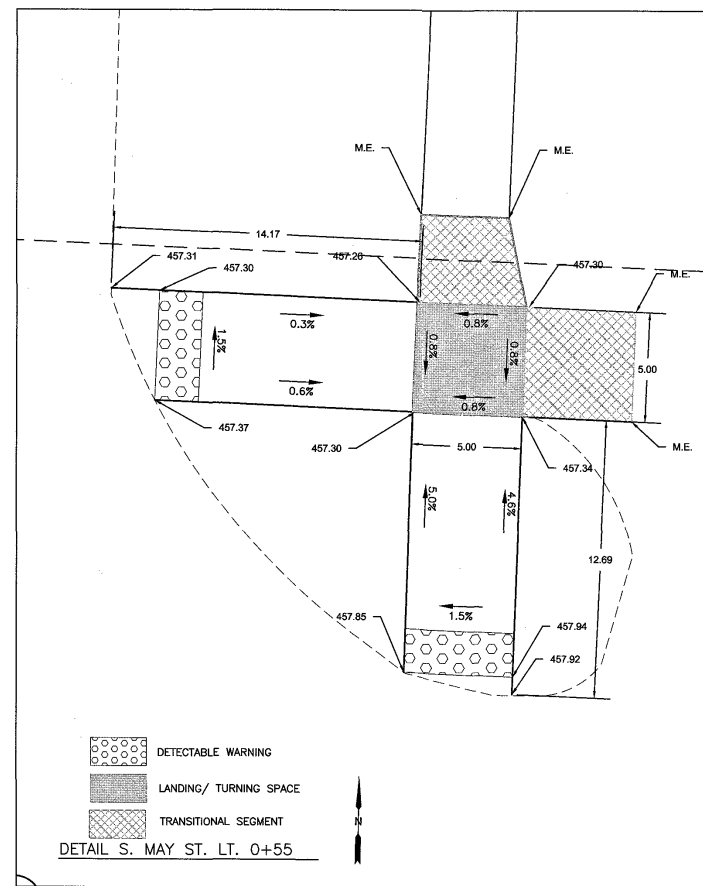
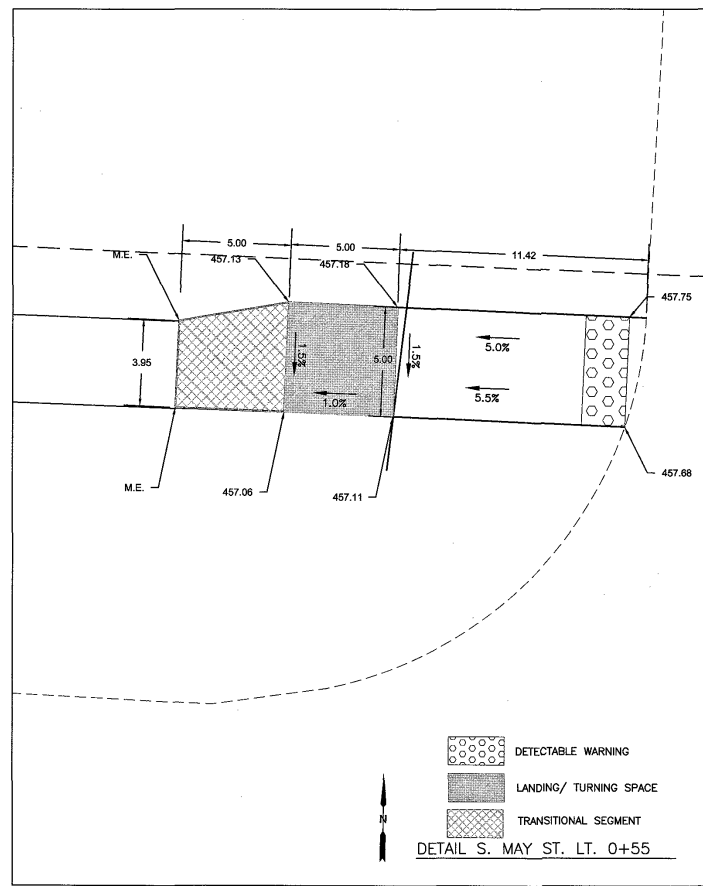

Vertical Scale 5

Connor & Connor, Inc.
 210 East Locust Street
 P.O. Box 618
 Robinson, Illinois 62454

CONNOR & CONNOR
 Consulting Engineers
 Land Surveyors

Phone: (618) 544-8623
 Fax: (618) 544-3012
 Design Firm #: 184-000832
 www.connorengineers.com

PROJECT NAME: CITY OF SUMNER
 SEC. 22-00005-00-SW
 SOUTH CHRISTY AVE
 WEST LOCUST STREET

ADA DETAILS
 W. LOCUST ST.

SHEET NUMBER:
 18 OF 18
 CONTRACT NUMBER:
 95954