

**INDEX OF SHEETS**

- 1 COVER SHEET
- 2 GENERAL NOTES & SUMMARY OF QUANTITIES
- 3 TYPICAL SECTIONS
- 4 SCHEDULES OF QUANTITIES
- 5-9 PLAN SHEETS
- 10-12 DISTRICT 4 STANDARDS

**LIST OF HIGHWAY STANDARDS**

- 000001-08 STANDARD SYMBOLS, ABBREVIATIONS AND PATTERNS
- 642006-01 SHOULDER RUMBLE STRIPS, 8 IN.
- 701006-05 OFF-RD OPERATIONS, 2L, 2W, 15' (4.5 m) TO 24" (600 mm) FROM PAVEMENT EDGE
- 701011-04 OFF-RD MOVING OPERATIONS, 2L, 2W, DAY ONLY
- 701301-04 LANE CLOSURE, 2L, 2W, SHORT TIME OPERATIONS
- 701306-04 LANE CLOSURE, 2L, 2W, SLOW MOVING OPERATIONS DAY ONLY, FOR SPEEDS ≥ 45 MPH
- 701311-03 LANE CLOSURE, 2L, 2W, MOVING OPERATIONS - DAY ONLY
- 701326-04 LANE CLOSURE, 2L, 2W, PAVEMENT WIDENING, FOR SPEEDS ≥ 45 MPH
- 701901-09 TRAFFIC CONTROL DEVICES

**PROPOSED IMPROVEMENT:**  
HOT-MIX ASPHALT SHOULDERS WITH RUMBLE STRIPS AND PAINT PAVEMENT MARKINGS.

**BEGIN IMPROVEMENT**  
**HANNA CITY-GLASFORD RD (CH R34)**  
**STA 100 + 19.22**

**END IMPROVEMENT**  
**HANNA CITY-GLASFORD RD (CH R34)**  
**STA 237 + 33.10**

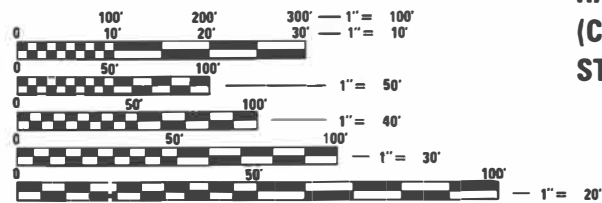

FULL SIZE PLANS HAVE BEEN PREPARED USING STANDARD ENGINEERING SCALES. REDUCED SIZED PLANS WILL NOT CONFORM TO STANDARD SCALES. IN MAKING MEASUREMENTS ON REDUCED PLANS, THE ABOVE SCALES MAY BE USED.

J.U.L.I.E.  
JOINT UTILITY LOCATION INFORMATION FOR EXCAVATION  
1-800-892-0123  
OR 811

**PROJECT MANAGER: SHANE LARSON, P.E.**  
**PROJECT ENGINEER: RYAN BRADLE, P.E., P.T.O.E.**  
**CATALOG 036360-00D**  
**CONTRACT NO. 89831**

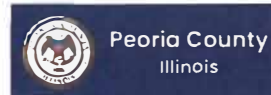

**STATE OF ILLINOIS**  
**DEPARTMENT OF TRANSPORTATION**  
**DIVISION OF HIGHWAYS**  
**PROPOSED**  
**HIGHWAY PLANS**

**HIGHWAY SAFETY IMPROVEMENT PROGRAM**  
**HANNA CITY-GLASFORD RD (CH R34)**  
**(LANCASTER RD TO SMITHVILLE RD)**  
**SECTION 22-00056-00-SP**  
**PROJECT N9LY(312)**  
**SHOULDERS & PAVEMENT MARKINGS**  
**PEORIA COUNTY**

C-94-016-23

R 6 E, 4TH PM

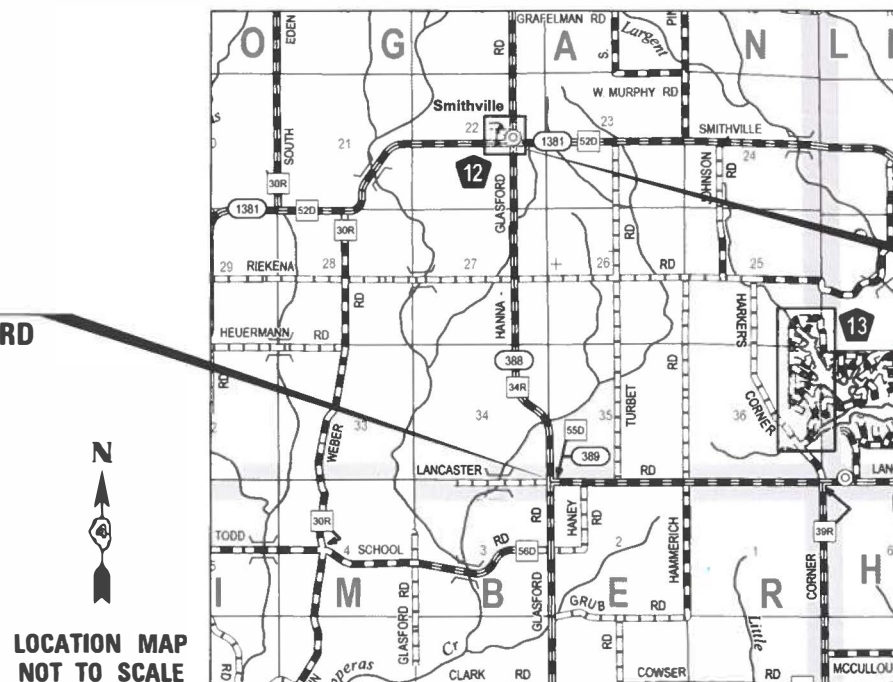

GROSS LENGTH = 13,713.88 FT. = 2.597 MILES  
NET LENGTH = 13,713.88 FT. = 2.597 MILES

F.A.S. RTE.	SECTION	COUNTY	TOTAL SHEETS	SHEET NO.
388A	22-00056-00-SP	PEORIA	12	1
		ILLINOIS	CONTRACT NO. 89831	



**FUNCTIONAL CLASSIFICATION**  
**RURAL MAJOR COLLECTOR**  
2022 ADT = 900  
DESIGN SPEED = 60 MPH  
PV = 88% SU = 7% MU = 5%

APPROVED December 19 2023  
Amy Baska P.H. Esq.  
PEORIA COUNTY ENGINEER

PASSED February 14, 2024  
Tony Cassina (ors)  
DISTRICT FOUR ENGINEER OF LOCAL ROADS & STREETS

Releasing For Bid Based on Limited Review February 16 2024  
Ryan Bradle  
REGION THREE ENGINEER

STATE OF ILLINOIS  
DEPARTMENT OF TRANSPORTATION

SHANE LARSON  
062-051722  
REGISTERED PROFESSIONAL ENGINEER OF ILLINOIS  
EXPIRES: 11/30/25  
Shane Larson  
SIGNATURE  
ENGINEER'S SEAL



**PRINTED BY THE AUTHORITY**  
**OF THE STATE OF ILLINOIS**

## GENERAL NOTES

**COMMITMENTS**

NO COMMITMENTS.

**ENVIRONMENTAL REVIEWS**

PRIOR TO THE USE OF ANY PROPOSED BORROW AREAS, USE AREAS (TEMPORARY ACCESS ROADS, DETOURS, RUN-AROUNDS, ETC...) AND/OR WASTE AREAS, THE CONTRACTOR SHALL FILE THE REQUIRED ENVIRONMENTAL RESOURCE REQUEST SURVEYS ACCORDING TO SECTION 107.22 OF THE STANDARD SPECIFICATIONS. THESE SURVEYS ARE REQUIRED IN ORDER FOR THE DEPARTMENT TO CONDUCT CULTURAL AND BIOLOGICAL RESOURCE SURVEYS FOR THE PROPOSED SITE.

THE REQUIRED ENVIRONMENTAL RESOURCE DOCUMENTATION SHALL INCLUDE THE FOLLOWING:

- BDE FORM 2289 (CULTURAL AND NATURAL RESOURCES REVIEW OF BORROW AREAS)
- BDE FORM 2290 (WASTE/USE AREA REVIEW)
- A LOCATION MAP SHOWING THE SIZE LIMITS AND LOCATION OF THE USE AREA
- COLOR PHOTOGRAPHS DEPICTING THE USE AREA
- BORROW AREA ENTRY AGREEMENT FORM - D4 PI0101

PRIOR TO ANY WASTE MATERIALS BEING REMOVED FROM THE CONSTRUCTION SITE THE REQUIRED ENVIRONMENTAL RESOURCE SURVEYS WILL NEED TO BE OBTAINED AND FILED BY THE CONTRACTOR. EXCESS WASTE PRODUCTS REMOVED FROM THE CONSTRUCTION SITE SHALL BE DISPOSED OF AS REQUIRED IN SECTION 202.03 OF THE STANDARD SPECIFICATIONS.

ANY PROTRUDING METAL BARS SHALL BE REMOVED PRIOR TO THE DISPOSAL OF BROKEN CONCRETE AT APPROVED DISPOSAL SITES.

PLEASE NOTE THAT A MINIMUM OF FOUR WEEKS SHALL BE ALLOWED FOR I.D.O.T. DISTRICT 4 TO OBTAIN THE REQUIRED WASTE SITE ENVIRONMENTAL CLEARANCES AND FIVE WEEKS FOR THE REQUIRED BORROW SITE ENVIRONMENTAL CLEARANCES.

**AGGREGATE FOR DRIVEWAY REPLACEMENT**

THE MATERIAL USED FOR CONSTRUCTION OF PERMANENT AGGREGATE DRIVEWAYS SHALL BE WHITE GRAVEL OR CRUSHED STONE, AS DIRECTED BY THE ENGINEER, TO REPLACE IN KIND THE EXISTING AGGREGATE DRIVEWAYS.

NO ADDITIONAL COMPENSATION SHALL BE PROVIDED FOR THIS REQUIREMENT BUT SHALL BE CONSIDERED AS INCLUDED IN THE COST OF THE PAY ITEM FOR THE AGGREGATE AS SPECIFIED ON THE PLANS.

**HOT-MIX ASPHALT MIXTURE REQUIREMENTS**

MIXTURE USE(s):	HMA - W LANCASTER RD (WEST LEG)		HMA SHOULDER		
	SURFACE (2")	BINDER (3")	SURFACE (2") (SURFACE LIFT)	SURFACE (2") (LOWER LIFT)	BINDER (4")
AC/PG:	PG 64-22	PG 64-22	PG 64-22	PG 64-22	PG 64-22
DESIGN AIR VOIDS:	4% @ N50	4% @ N50	4% @ N50	4% @ N50	4% @ N50
MIXTURE COMPOSITION: (GRADING MIXTURE)	IL 9.5	IL 9.5	IL 9.5	IL 9.5	IL 19.0
FRICTION AGGREGATE	MIX "C"	N/A	MIX "C"	N/A	N/A
QUALITY MANAGEMENT	QC/QA	QC/QA	QC/QA	QC/QA	QC/QA
MATERIAL TRANSFER DEVICE	NO	NO	NO	NO	NO

**NOTES:**

HOT-MIX ASPHALT SHOULDERS SHALL BE PLACED IN 3 LIFTS AS FOLLOWS:

- 1ST LIFT - 4" - HOT-MIX ASPHALT BINDER COURSE
- 2ND LIFT - 2" - HOT-MIX ASPHALT SURFACE COURSE
- 3RD LIFT - 2" - HOT-MIX ASPHALT SURFACE COURSE

FOR DESIGN PURPOSES, MIXTURE WEIGHT FOR ALL MIXES IS DETERMINED TO BE 112.0 LB/SQ YD/IN, UNLESS OTHERWISE NOTED.

SUMMARY OF QUANTITIES				CONSTRUCTION CODE	
				90% HSIP 10% LOCAL ROADWAY	0021 RURAL
CODE NO.	DESCRIPTION	UNIT	TOTAL QUANTITY		
20200500	EARTH EXCAVATION (WIDENING)	CU YD	2735		2735
40200800	AGGREGATE SURFACE COURSE, TYPE B	TON	81		81
40600275	BITUMINOUS MATERIALS (PRIME COAT)	POUND	27941		27941
40600290	BITUMINOUS MATERIALS (TACK COAT)	POUND	5517		5517
40602978	HOT-MIX ASPHALT BINDER COURSE, IL-9.5, N50	TON	24		24
40604050	HOT-MIX ASPHALT SURFACE COURSE, IL-9.5, MIX "C", N50	TON	26		26
48203029	HOT-MIX ASPHALT SHOULDERS, 8"	SQ YD	12191		12191
64200108	SHOULDER RUMBLE STRIPS, 8 INCH	FOOT	27428		27428
67100100	MOBILIZATION	L SUM	1		1
* 78009004	MODIFIED URETHANE PAVEMENT MARKING - LINE 4"	FOOT	39730		39730
X4401198	HOT-MIX ASPHALT SURFACE REMOVAL, VARIABLE DEPTH	SQ YD	94		94
X7010216	TRAFFIC CONTROL AND PROTECTION, (SPECIAL)	L SUM	1		1
Z0013798	CONSTRUCTION LAYOUT	L SUM	1		1

\* SPECIALTY ITEM

MODEL: Default  
FILE NUMBER: V03136 - Hanna City-Glasford Rd - PH L1 (Peoria County)CADD\CADD\_Sheets\045116-1h-2-remots & 500.dgn



USER NAME = Shughes	DESIGNED - WSL	REVISED -
	DRAWN - SRH	REVISED -
PLOT SCALE = 2,000' / in.	CHECKED - WSL	REVISED -
PLOT DATE = 12/13/2023	DATE - 10-26-23	REVISED -



<b>HANNA CITY-GLASFORD RD (CH R34) GENERAL NOTES &amp; SUMMARY OF QUANTITIES</b>			
SCALE: N/A	SHEET 1 OF 1 SHEETS	STA. N/A	TO STA. N/A

F.A.S. RTE. 388A	SECTION 22-00056-00-5P	COUNTY PEORIA	TOTAL SHEETS 12	SHEET NO. 2
ILLINOIS FED. AID PROJECT			CONTRACT NO. 89831	



EARTHWORK			
LOCATION			20200500
EARTH EXCAVATION (WIDENING)			CU YD
STATION	TO	STATION	
W LANCASTER RD (WEST LEG)			22.08
100+19	TO	237+33	2708.91
TOTAL			2730.99
USE			2735

SHOULDER RUMBLE STRIPS, 8 INCH					
STATION TO STATION				64200108	
			SIDE	LENGTH FOOT	
100+19	TO	237+33	LT & RT	27427.8	
TOTAL				27427.8	
USE				27428	

MODIFIED URETHANE PAVEMENT MARKING - LINE 4"							
78009004							
STATION	TO	STATION	SKIP-DASH	SOLID	SOLID	SOLID	SKIP-DASH
			YELLOW	WHITE	YELLOW	WHITE	YELLOW
			PASSING / NO PASSING	EDGE	PASSING / NO PASSING	EDGE	PASSING
			CENTERLINE	LINE	CENTERLINE	LINE	CENTERLINE
NORTHBOUND			SOUTHBOUND			CENTERLINE	
FOOT							
100+19	TO	146+75		4656	4656		
100+19	TO	154+00				5381	5381
146+75	TO	154+00	181		725		
154+00	TO	237+33			8333		8333 2083
SUB-TOTAL			181	4656	13714	5381	13714 2083
TOTAL			39730				
USE			39730				

ENTRANCES & SIDEROADS							
LOCATION		40200800	40602978	40604050	40600275	40600290	X4401198
STATION	SIDE	AGGREGATE SURFACE COURSE, TYPE B (2")	HOT-MIX ASPHALT BINDER COURSE, IL-9.5, N50 (3")	HOT-MIX ASPHALT SURFACE COURSE, IL-9.5, MIX "C", N50 (2")	BITUMINOUS MATERIALS (PRIME COAT) (1 APPLICATION) (0.25 LBS/SQ FT)	BITUMINOUS MATERIALS (TACK COAT) (1 APPLICATION) (0.025 LBS/SQ FT)	HOT-MIX ASPHALT SURFACE REMOVAL, VARIABLE DEPTH
		TON	TON	TON	POUND	POUND	SQ YD
W LANCASTER RD (WEST LEG)			23.5	14.1	285.5	30.1	
105+54.2	LT	1.7					
106+83.2	LT	2.1					
111+81.9	LT	2.5					
112+96.2	LT	1.9					
114+20.4	RT	1.7					
115+56.6	LT	2.0					
116+91.3	LT	2.0					
120+13.0	LT	1.7					
126+87.9	RT	2.3					
131+58.5	RT	2.6					
135+25.3	RT			4.0	76.6		31.7
138+83.9	LT	3.5					
141+69.3	RT	2.0					
142+48.7	LT	2.6					
145+00.6	RT	2.6					
145+93.1	LT	1.9					
146+65.0	LT	1.5					
146+69.4	RT	1.7					
147+82.8	LT	1.6					
148+43.0	LT	2.6					
(W GEIR RD)							
154+32.8	RT	2.5					
156+01.6	RT	4.4					
157+96.1	RT	2.8					
158+05.9	LT	1.9					
171+14.0	RT	2.6					
171+69.5	LT	2.5					
173+04.9	LT	2.1					
184+50.5	LT						
(W RIEKENA RD)							
184+53.6	RT				3.8	72.8	30.0
(W RIEKENA RD)							
195+39.6	LT	1.6					
206+53.5	RT	2.7					
208+82.3	LT	2.3					
211+01.1	LT	2.4					
217+45.8	LT	2.4					
232+73.5	LT	1.7					
236+69.6	RT	8.3					
TOTAL		80.7	23.5	25.9	512.7	30.1	93.9
USE		81	24	26	513	31	94

SHOULDER						
STATION	TO	STATION	SIDE	40600275	40600290	48203029
				BITUMINOUS MATERIALS (PRIME COAT) (1 APPLICATION) (0.25 LBS/SQ FT)	BITUMINOUS MATERIALS (TACK COAT) (2 APPLICATIONS) (0.025 LBS/SQ FT)	HOT-MIX ASPHALT SHOULDERS, 8"
				POUND	POUND	SQ YD
100+19.2	TO	237+33.1	LT	13713.9	2742.8	6095.1
100+19.2	TO	237+33.1	RT	13713.9	2742.8	6095.1
TOTAL				27427.8	5485.6	12190.1
USE				27428	5486	12191

MODEL: D:\h\h\Hanna\_City-Glasford\_Rd\_-\_PH\_Lit\_Peoria\_City\CADD\CADD\_Sheets\045136-CH-4-SC\tables.dgn  
 FILE NUMBER: 045136 - Hanna\_City-Glasford Rd - PH Lit\_Peoria\_City



USER NAME = SHughes	DESIGNED - WSL	REVISED -
DRAWN - SRH	REVISIONS -	
PLOT SCALE = 2,000' / in.	CHECKED - WSL	REVISED -
PLOT DATE = 1/22/2024	DATE - 10-26-23	REVISED -



HANNA CITY-GLASFORD RD (CH R34)			
SCHEDULES OF QUANTITIES			
SCALE: N/A	SHEET 1 OF 1 SHEETS	STA. N/A	TO STA. N/A

F.A.S. RTE. 388A	SECTION 22-00056-00-5P	COUNTY PEORIA	TOTAL SHEETS 12	SHEET NO. 4
CONTRACT NO. 89831			ILLINOIS FED. AID PROJECT	



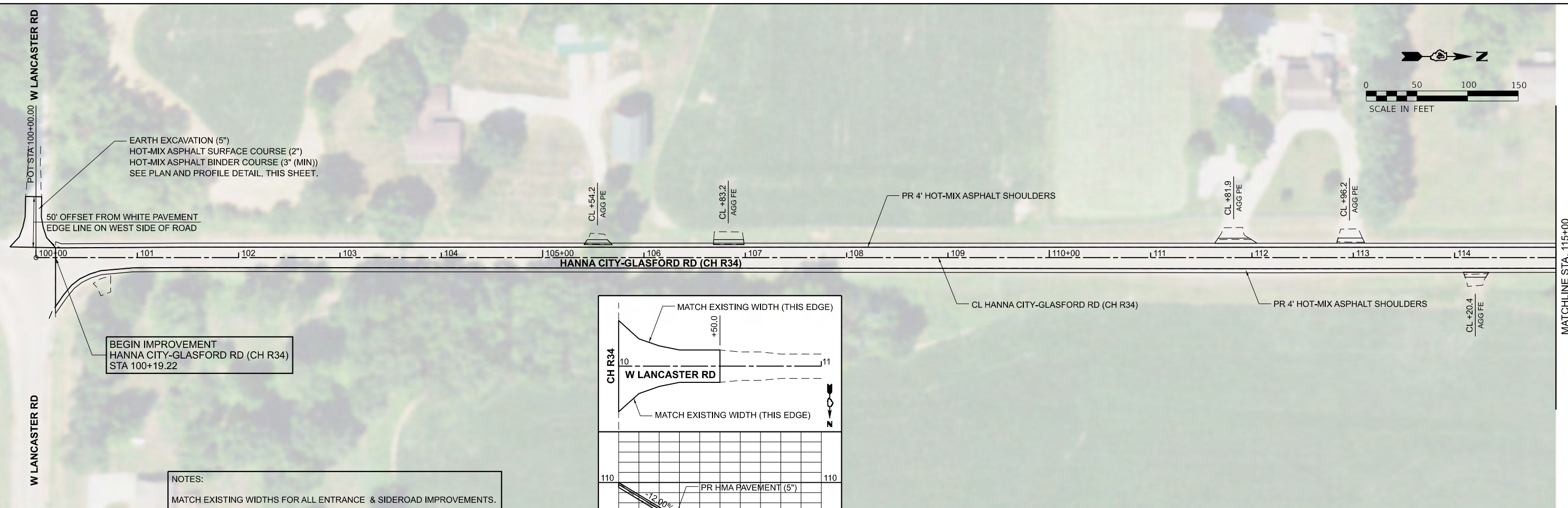
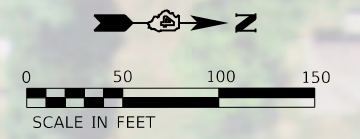

BEGIN IMPROVEMENT  
HANNA CITY-GLASFORD RD (CH R34)  
STA 100+19.22

NOTES:  
MATCH EXISTING WIDTHS FOR ALL ENTRANCE & SIDEROAD IMPROVEMENTS.  
ALL IMPROVEMENTS ARE WITHIN THE EXISTING RIGHT-OF-WAY.  
SEE PLAN SHEET 5 OF 5 FOR ENTRANCE & SIDEROAD DETAILS.

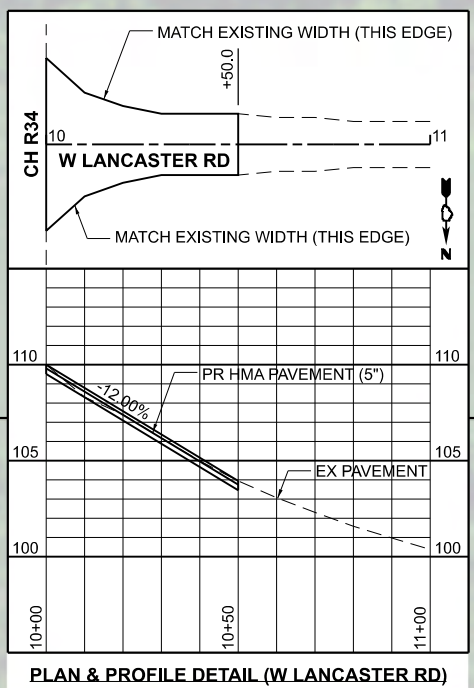

PR CURVE  
PI STA = 125+10.94  
 $\Delta = 54^\circ 41' 14''$  (LT)  
D =  $04^\circ 58' 56''$   
R = 1,150.00'  
T = 594.67'  
L = 1097.64'  
E = 144.65'  
e = \_\_\_\_\_  
TR = \_\_\_\_\_  
SE RUN = \_\_\_\_\_  
PC STA = 119+16.27  
PT STA = 130+13.91

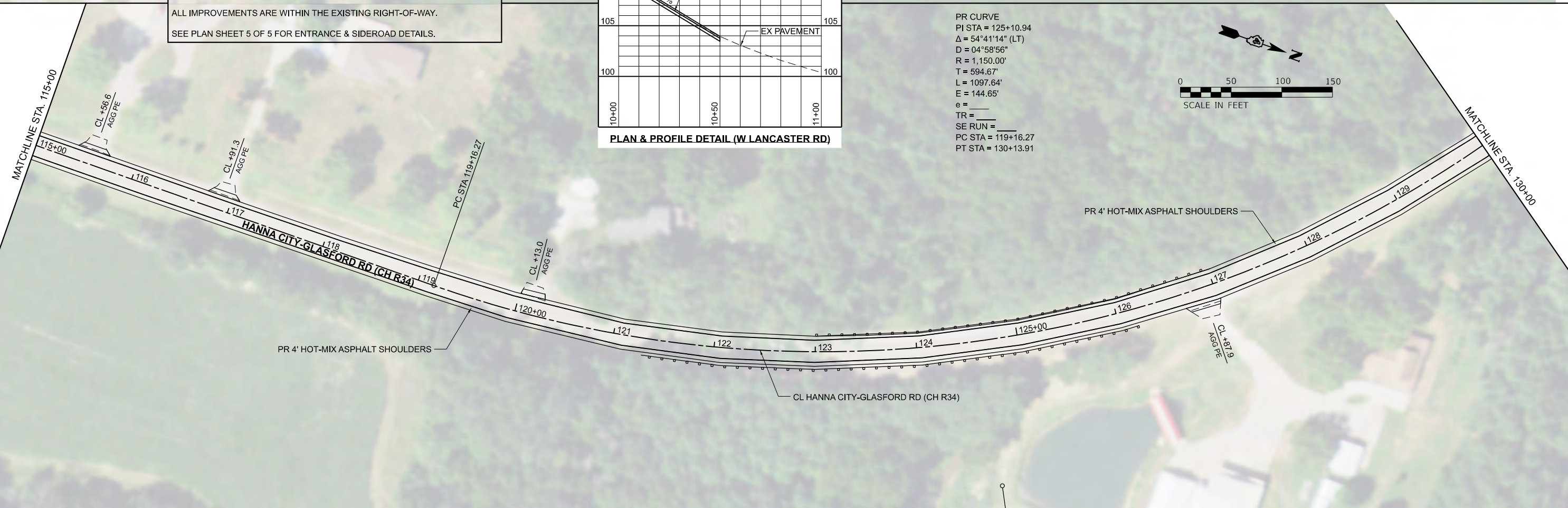
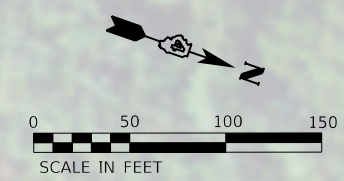

MODEL: PCL-2 - Hanna City-Glasford Rd Plan [Sheet]  
FILE NAME: V33136 - Hanna City-Glasford Rd - P11 L11 [Peoria County\CADD\CADD Sheets\33136-sh1-5-p11.dgn]

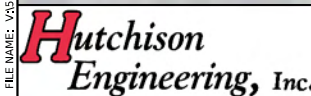

USER NAME = SHughes	DESIGNED - WSL	REVISED -
PLOT SCALE = 0.166666' / in.	DRAWN - SRH	REVISED -
PLOT DATE = 1/19/2024	CHECKED - WSL	REVISED -
	DATE - 10-26-23	REVISED -

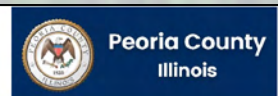

<b>HANNA CITY-GLASFORD RD (CH R34)</b>		
<b>PLAN</b>		
SCALE: H=50 V=5	SHEET 1 OF 5 SHEETS	STA. 100+00 TO STA. 130+00

F.A.S. RTE. 388A	SECTION 22-00056-00-5P	COUNTY PEORIA	TOTAL SHEETS 12	SHEET NO. 5
CONTRACT NO. 89831				
ILLINOIS FED. AID PROJECT				



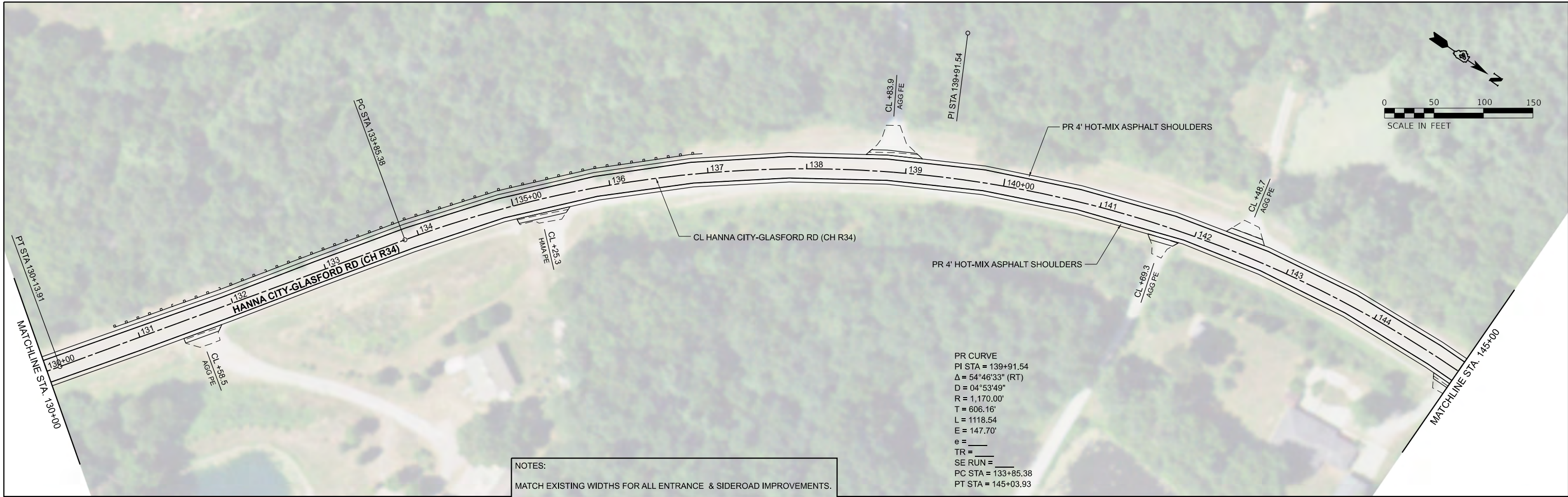

PR CURVE  
 PI STA = 139+91.54  
 $\Delta = 54^\circ 46' 33''$  (RT)  
 $D = 04^\circ 53' 49''$   
 $R = 1,170.00'$   
 $T = 606.16'$   
 $L = 1118.54'$   
 $E = 147.70'$   
 $e =$   
 $TR =$   
 $SE RUN =$   
 PC STA = 133+85.38  
 PT STA = 145+03.93

NOTES:  
 MATCH EXISTING WIDTHS FOR ALL ENTRANCE & SIDEROAD IMPROVEMENTS.  
 ALL IMPROVEMENTS ARE WITHIN THE EXISTING RIGHT-OF-WAY.  
 SEE PLAN SHEET 5 OF 5 FOR ENTRANCE & SIDEROAD DETAILS.

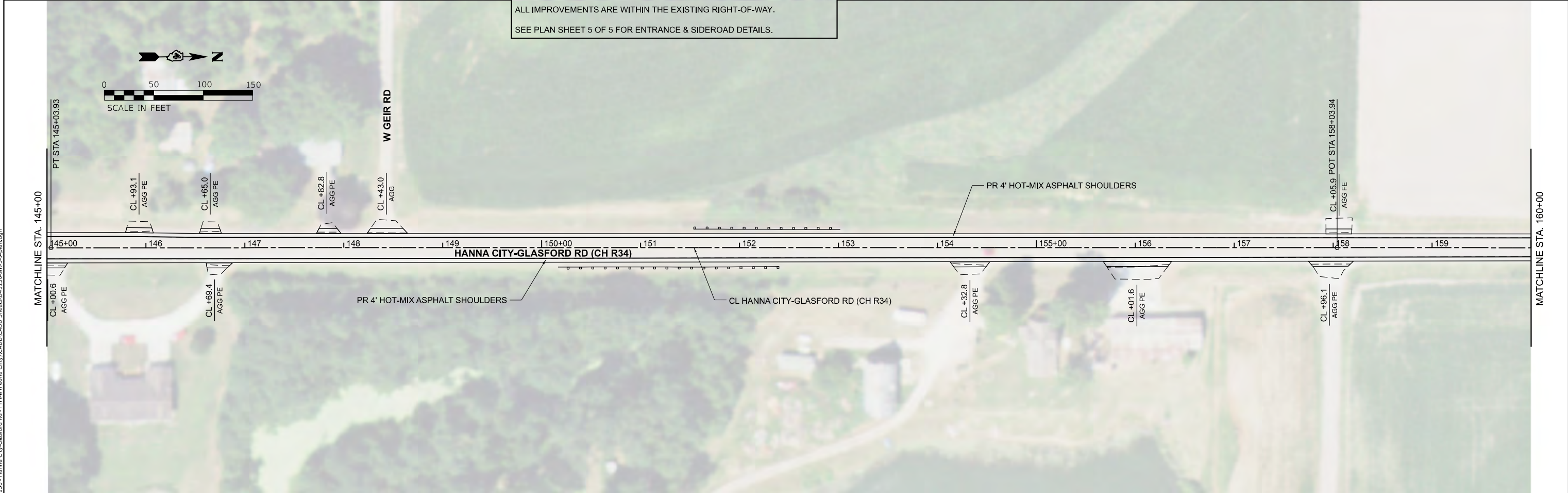

MODEL: PCL-2 - Hanna City-Glasford Rd Plan-2 [Sheet]  
 FILE NAME: V23236 - Hanna City-Glasford Rd - P11 L11 [Peoria County\CADD\CADD Sheets\D45136-sh1-5-p11-plan.dgn]

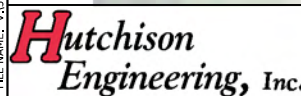

USER NAME = SHughes	DESIGNED - WSL	REVISED -
PLOT SCALE = 0.166666' / in.	DRAWN - SRH	REVISED -
PLOT DATE = 1/19/2024	CHECKED - WSL	REVISED -
	DATE - 10-26-23	REVISED -

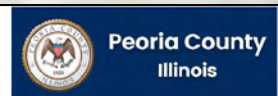

<b>HANNA CITY-GLASFORD RD (CH R34)</b>		
<b>PLAN</b>		
SCALE: H=50 V=5	SHEET 2 OF 5 SHEETS	STA. 130+00 TO STA. 160+00

F.A.S. RTE. 388A	SECTION 22-00056-00-5P	COUNTY PEORIA	TOTAL SHEETS 12	SHEET NO. 6
CONTRACT NO. 89831				
ILLINOIS FED. AID PROJECT				



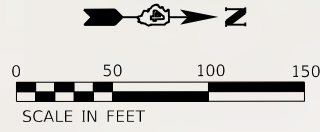

MATCHLINE STA. 160+00

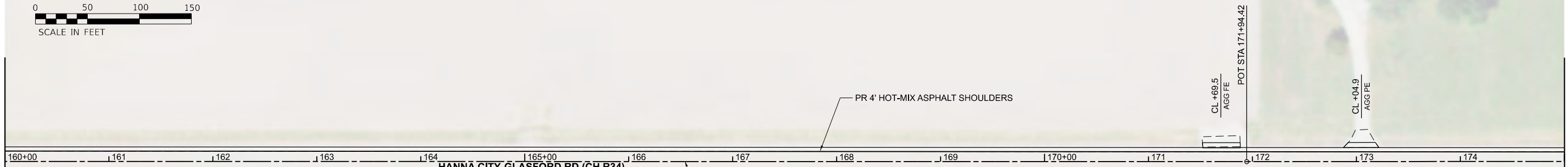

MATCHLINE STA. 175+00

NOTES:  
 MATCH EXISTING WIDTHS FOR ALL ENTRANCE & SIDEROAD IMPROVEMENTS.  
 ALL IMPROVEMENTS ARE WITHIN THE EXISTING RIGHT-OF-WAY.  
 SEE PLAN SHEET 5 OF 5 FOR ENTRANCE & SIDEROAD DETAILS.

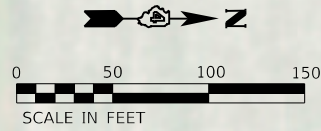

MATCHLINE STA. 175+00

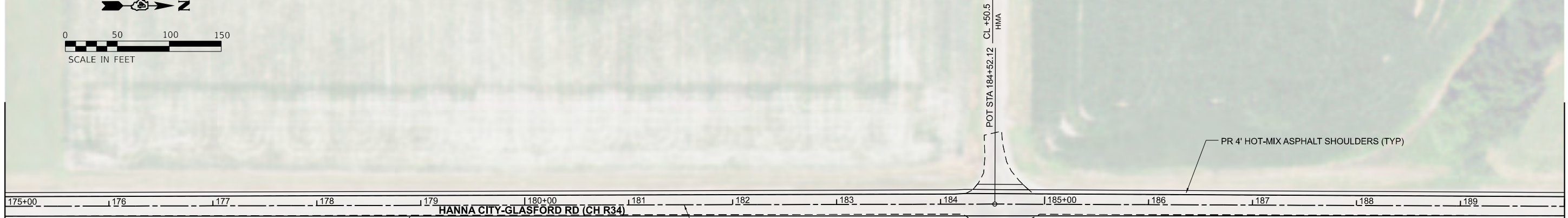

MATCHLINE STA. 190+00

MODEL: PCL-2 - Hanna City-Glasford Rd Plan-4 [Sheet]  
 FILE NAME: V33136 - Hanna City-Glasford Rd - P11 D11 Peoria City/CADD/CADD Sheets/D45136-sh1-5-9-plan.dgn

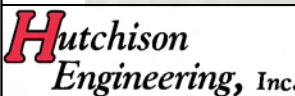

USER NAME = SHughes	DESIGNED - WSL	REVISED -
PLOT SCALE = 0.166666' / in.	DRAWN - SRH	REVISED -
PLOT DATE = 1/19/2024	CHECKED - WSL	REVISED -
	DATE - 10-26-23	REVISED -



**HANNA CITY-GLASFORD RD (CH R34)**  
**PLAN**  
 SCALE: H=50 V=5 SHEET 3 OF 5 SHEETS STA. 160+00 TO STA. 190+00

F.A.S. RTE.	SECTION	COUNTY	TOTAL SHEETS	SHEET NO.
388A	22-00056-00-5P	PEORIA	12	7
CONTRACT NO. 89831				
ILLINOIS FED. AID PROJECT				



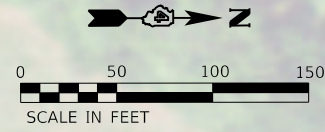

MATCHLINE STA. 190+00

MATCHLINE STA. 205+00

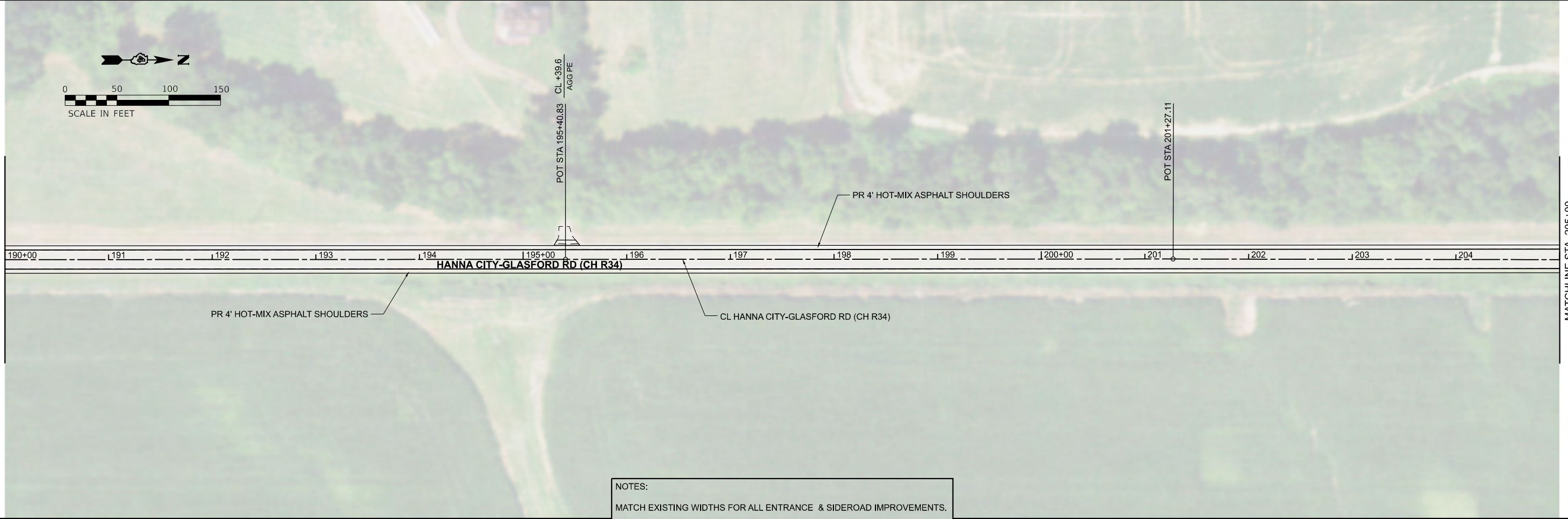

NOTES:  
 MATCH EXISTING WIDTHS FOR ALL ENTRANCE & SIDEROAD IMPROVEMENTS.  
 ALL IMPROVEMENTS ARE WITHIN THE EXISTING RIGHT-OF-WAY.  
 SEE PLAN SHEET 5 OF 5 FOR ENTRANCE & SIDEROAD DETAILS.



MATCHLINE STA. 205+00

MATCHLINE STA. 220+00

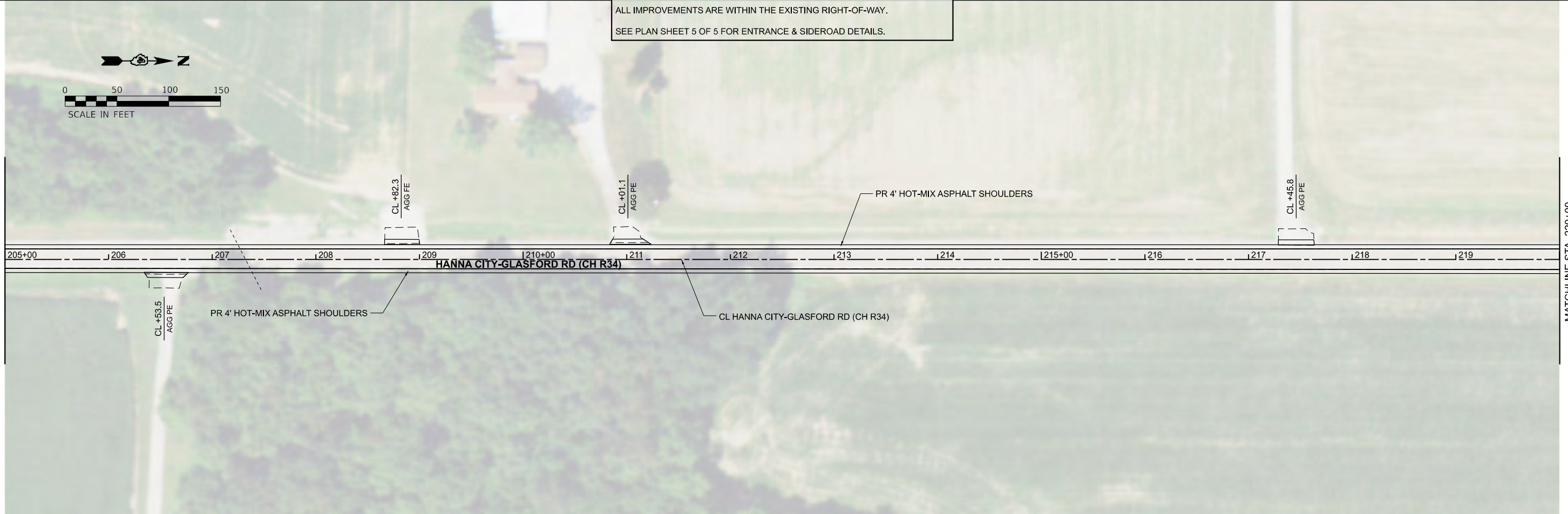

MODEL: PCL-2 - Hanna City-Glasford Rd Plan-6 [Sheet]  
 FILE NAME: V33336 - Hanna City-Glasford Rd - P1 L11 [Peoria City\CADD\CADD Sheets\045136-sh1-5-9-plan.dgn]

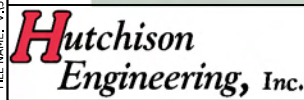

USER NAME = SHughes	DESIGNED - WSL	REVISED -
PLOT SCALE = 0.166666' / in.	DRAWN - SRH	REVISED -
PLOT DATE = 1/19/2024	CHECKED - WSL	REVISED -
	DATE - 10-26-23	REVISED -



<b>HANNA CITY-GLASFORD RD (CH R34)</b>			
<b>PLAN</b>			
SCALE: H=50 V=5	SHEET 4	OF 5 SHEETS	STA. 190+00 TO STA. 220+00

F.A.S. RTE.	SECTION	COUNTY	TOTAL SHEETS	SHEET NO.
388A	22-00056-00-5P	PEORIA	12	8
CONTRACT NO. 89831				
ILLINOIS FED. AID PROJECT				



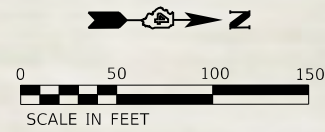

MATCHLINE STA. 220+00

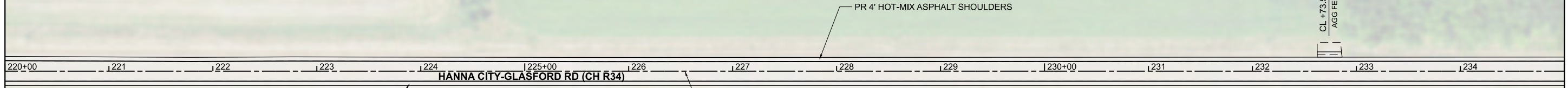

MATCHLINE STA. 235+00

NOTES:  
 MATCH EXISTING WIDTHS FOR ALL ENTRANCE & SIDEROAD IMPROVEMENTS.  
 ALL IMPROVEMENTS ARE WITHIN THE EXISTING RIGHT-OF-WAY.  
 SEE THIS SHEET FOR ENTRANCE & SIDEROAD DETAILS.



MATCHLINE STA. 235+00

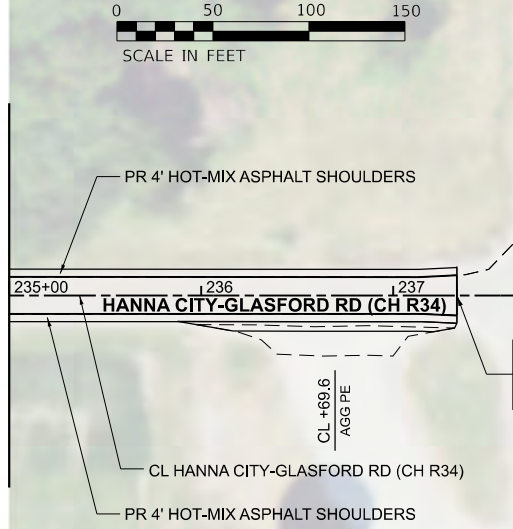

END IMPROVEMENT  
 HANNA CITY-GLASFORD RD (CH R34)  
 STA 237+33.10

W SMITHVILLE RD

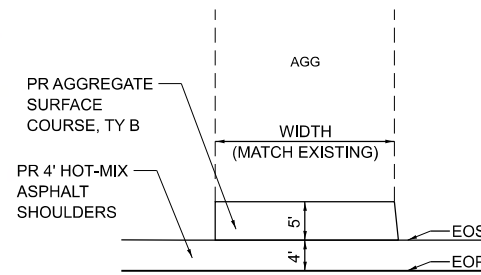

AGGREGATE ENTRANCE

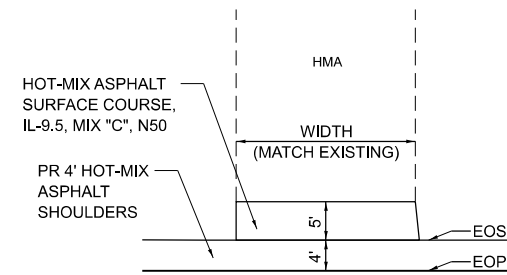

HOT-MIX ASPHALT ENTRANCE

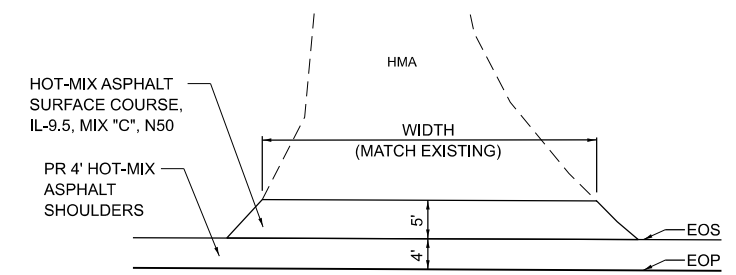

HOT-MIX ASPHALT SIDEROAD

ENTRANCE & SIDEROAD DETAILS

MODEL: PCL-2 - Hanna City-Glasford Rd Plan-8 [Sheet]  
 FILE NAME: V33336 - Hanna City-Glasford Rd - P1111 [Peoria County/CADD/Sheet/D45136-sh1-5-p-plan.dgn]

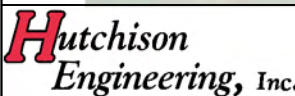

USER NAME = SHughes	DESIGNED - WSL	REVISED -
PLOT SCALE = 0.166666' / in.	DRAWN - SRH	REVISED -
PLOT DATE = 1/19/2024	CHECKED - WSL	REVISED -
	DATE - 10-26-23	REVISED -



<b>HANNA CITY-GLASFORD RD (CH R34)</b>			
<b>PLAN</b>			
SCALE: H=50 V=5	SHEET 5	OF 5 SHEETS	STA. 220+00 TO STA. 237+74.36

F.A.S. RTE. 388A	SECTION 22-00056-00-5P	COUNTY PEORIA	TOTAL SHEETS 12	SHEET NO. 9
CONTRACT NO. 89831				
ILLINOIS FED. AID PROJECT				

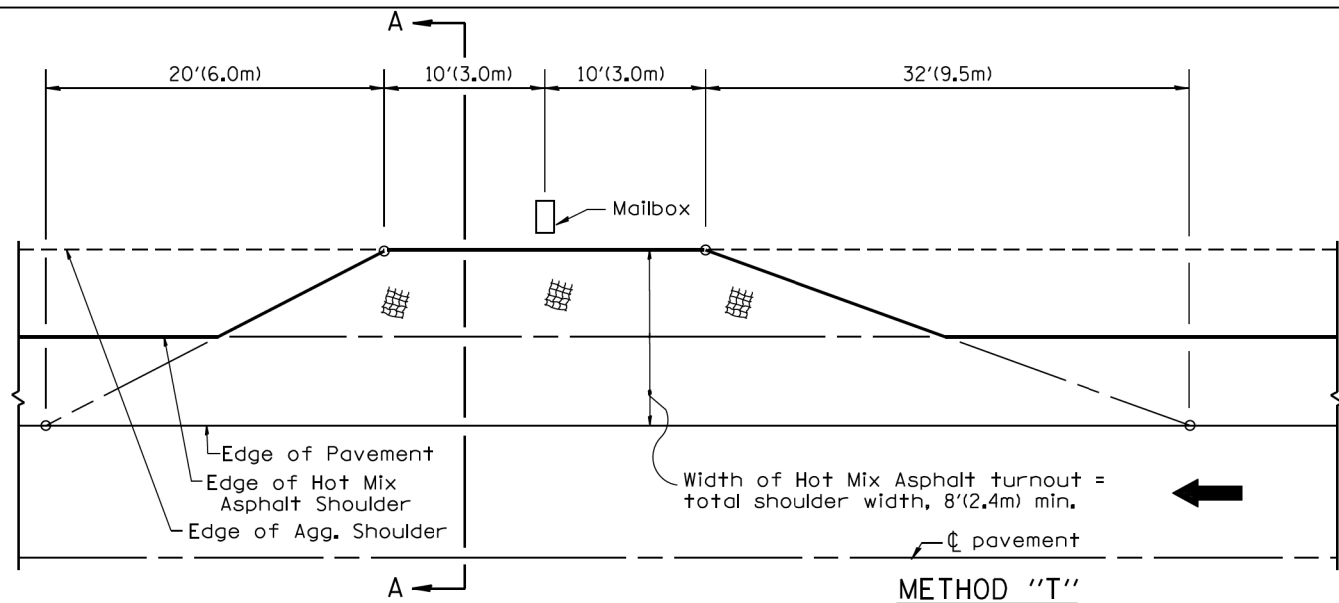

**METHOD "T"**  
Typical Application

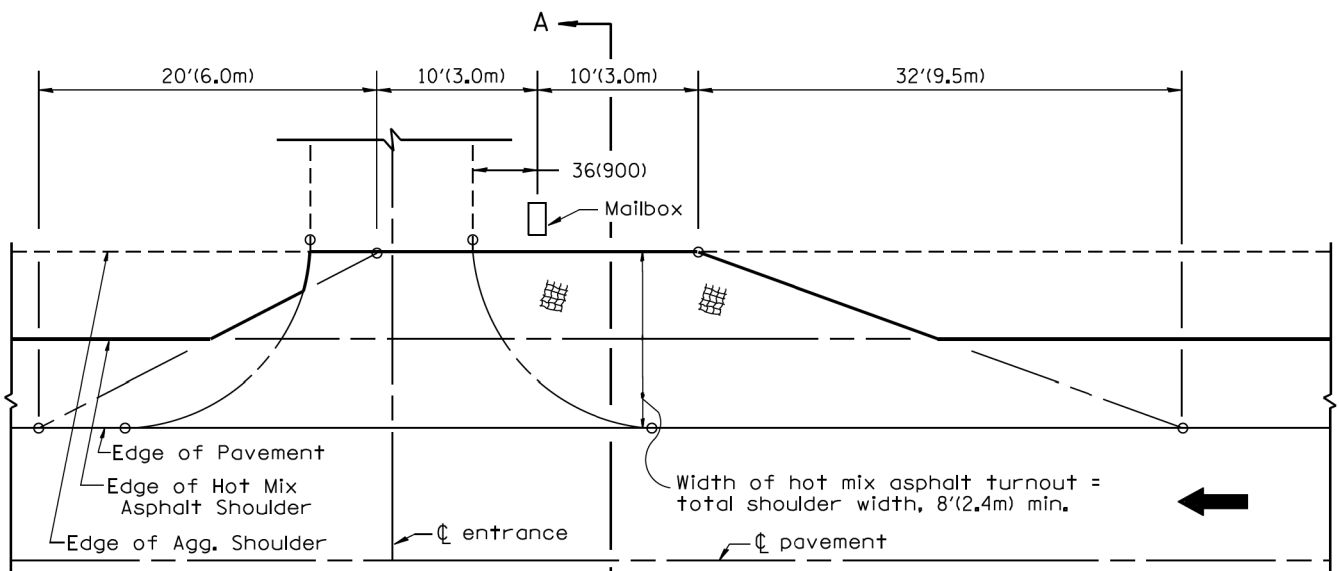

**METHOD "N"**  
Mailbox on near side of entrance

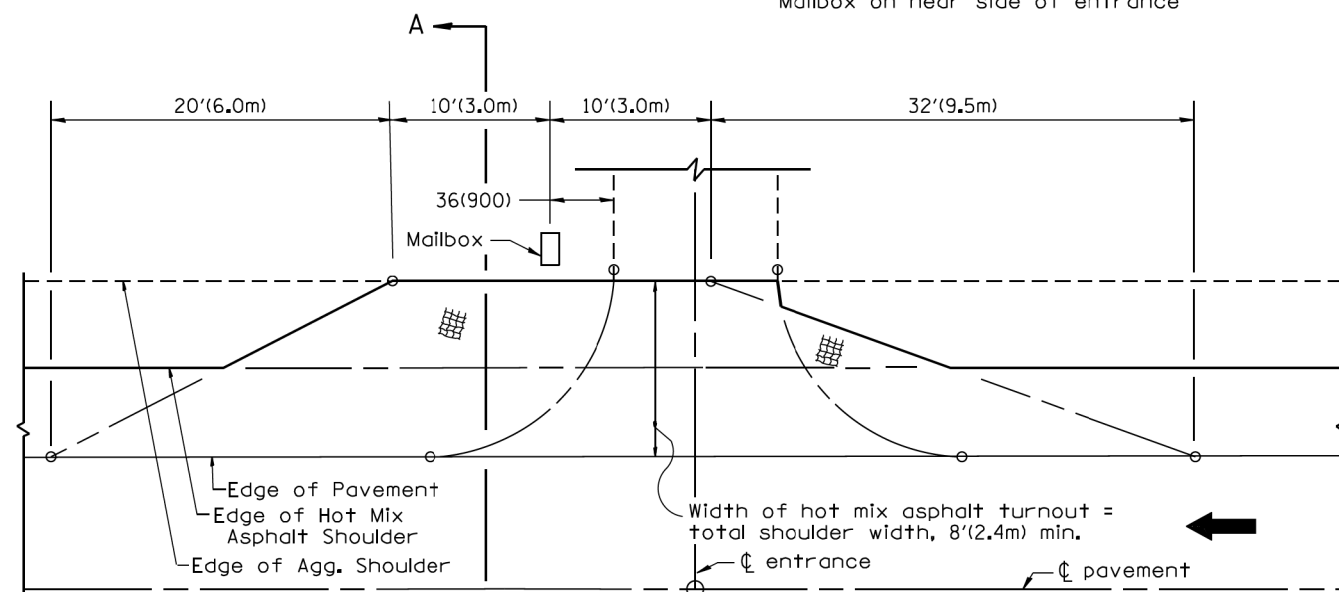

**METHOD "F"**  
Mailbox on far side of entrance

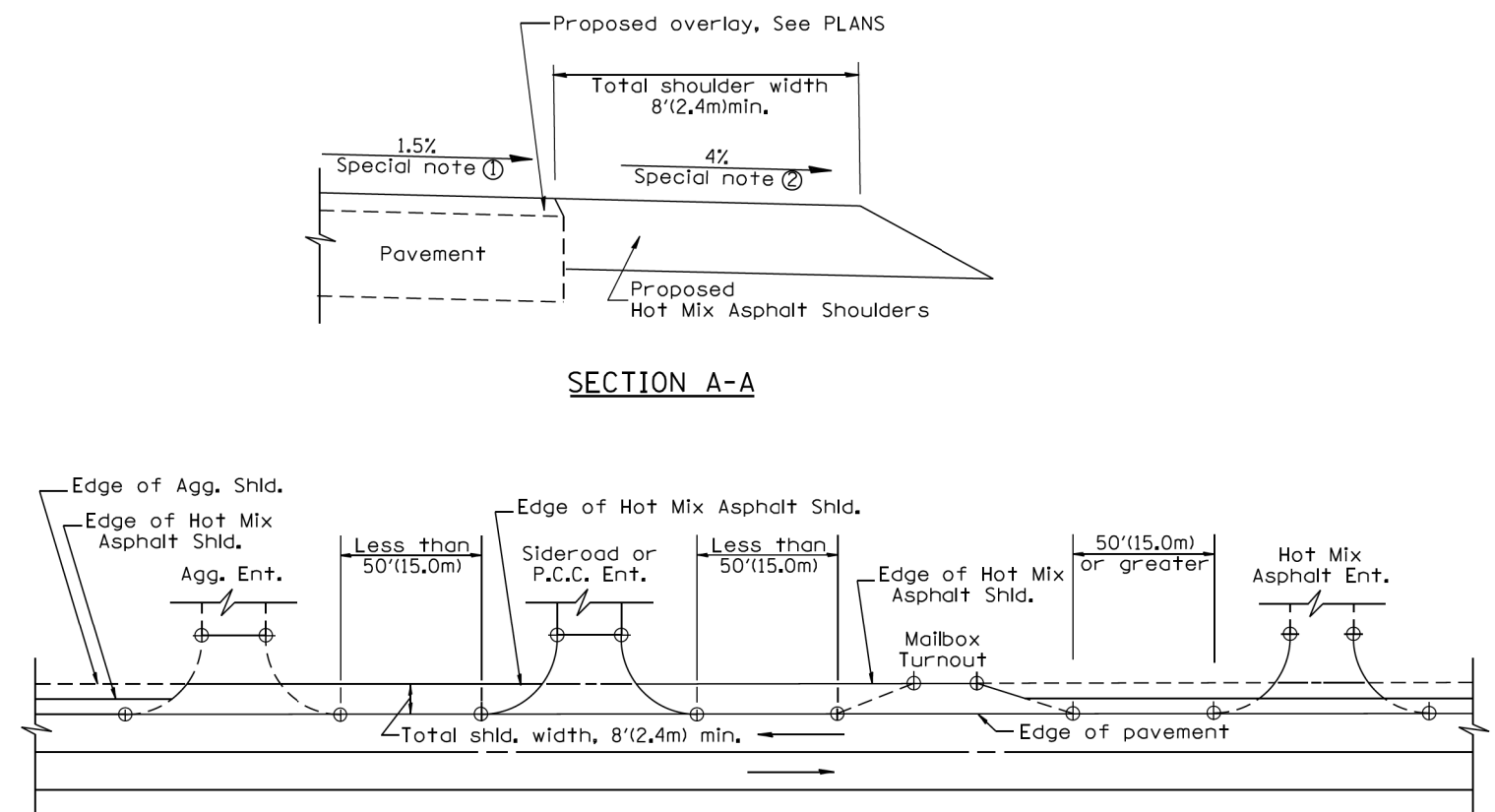

**SHOULDER TREATMENT FOR CLOSELY SPACED SIDEROADS, ENTRANCES, AND/OR MAILBOX TURNOUTS**

**GENERAL NOTES**

- Mailbox turnouts shall slope away from the pavement edge at a rate equal to the shoulder slope. See SECTION A-A.
- The total shoulder width, 8'(2.4m) minimum, shall be paved between sideroads entrances and/or mailbox turnouts at locations where the distance between radius or taper control points is less than 50'(15.0m). See DETAIL A.
- Mailboxes shall be mounted such that the face of the mailbox is 6(150) to 12(300) and the post a minimum of 24(600) from the edge of the turnout surfacing.

**SPECIAL NOTES**

- The mainline pavement cross-slope is 1.5% for tangent alignment. See PLANS for cross-slope on super-elevated horizontal curves.
- The shoulder slope shall control the turnout slope. The standard cross-slope is 4% for tangent alignment. Through super-elevated curves, the maximum pavement-shoulder breakover should not be greater than 10% for shoulders 6'(1.8m) and wider and 12% for shoulders 4'(1.2m) and less. Where 12(300) paved shoulders are provided, the breakover should be at the edge of the paved shoulder rather than at the pavement edge.

All dimensions are in inches (millimeters) unless otherwise noted.

MODEL Default - Hanna City-Glasford Rd - PH L1 (Pavsh City/CADD/CADD Sheets)045136-sh-10-D4-std.dgn



USER NAME = Shughes	DESIGNED - WSL	REVISED -
PLOT SCALE = 2,000' / in.	DRAWN - SRH	REVISED -
PLOT DATE = 12/12/2023	CHECKED - WSL	REVISED -
	DATE - 10-26-23	REVISED -



<b>HANNA CITY-GLASFORD RD (CH R34)</b>				F.A.S. RTE.	SECTION	COUNTY	TOTAL SHEETS	SHEET NO.
<b>DISTRICT 4 STANDARD 406201-D4</b>				388A	22-00056-00-5P	PEORIA	12	10
<b>MAILBOX TURNOUTS</b>				CONTRACT NO. 89831				
SCALE: N/A	SHEET 1	OF 1 SHEETS	STA. N/A	TO STA. N/A	ILLINOIS FED. AID PROJECT			



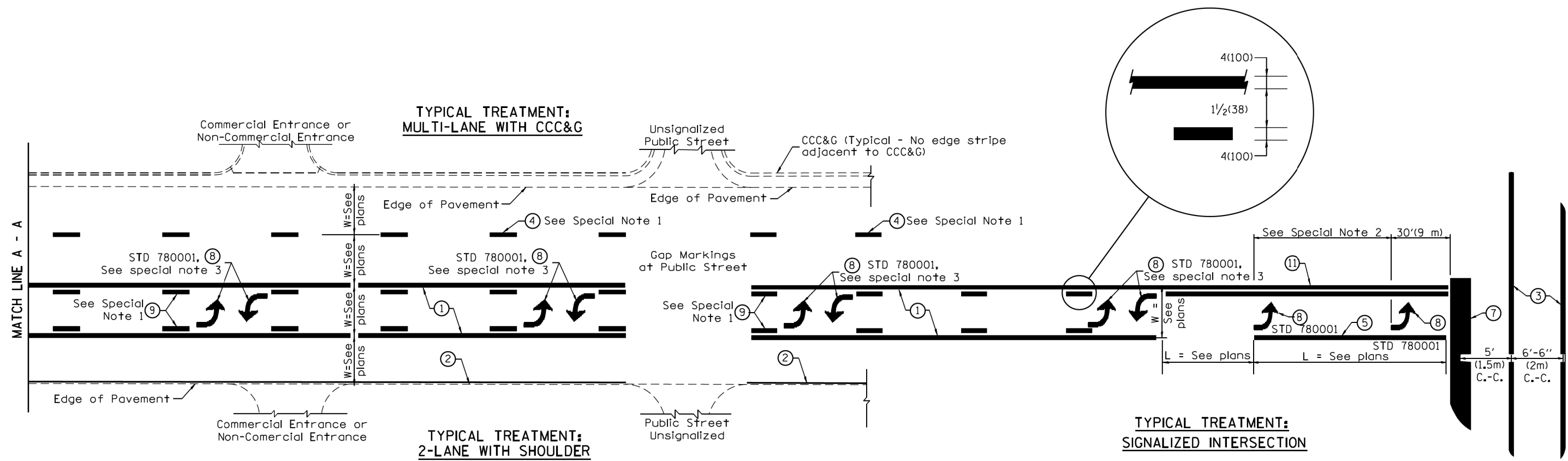

**FLUSH PAVED MEDIAN: TWO-WAY LEFT TURN LANE WITH ONE-WAY LEFT TURN LANE AT SIGNALIZED INTERSECTION**

**TYPICAL PAVEMENT MARKING LEGEND**

(Note: This is a District Standard Legend. Some elements may not apply to specific project.)

- ① 4(100) Solid (Yellow)
- ② 4(100) Solid (White)
- ③ 2-6(150) Crosswalk @ 6'-6" (2m)min C.-C. (White)  
2-8(200) Crosswalk @ 6'-5" (2m)min C.-C. (White) (When traffic signals are present.)
- ④ 6(150) Skip-Dash (White) (See Special Note 1)
- ⑤ 8(200) Solid (White)
- ⑥ 12(300) Diagonal (White) (Item ⑥ is shown on Std. 780001)
- ⑦ 24(600) Stop Bar (White)
- ⑧ Letters & Arrows (See Std. 780001 and Special Notes 2 & 3)
- ⑨ 4(100) Skip-Dash (Yellow) (See Special Note 1)
- ⑩ 12(300) Diagonal (Yellow) (See Table A) (See Table A)
- ⑪ 4(100) Double Solid (Yellow) (See Table A)

**SPECIAL NOTES**

1. Skip-Dash markings will be centered between both ends of city blocks and shall be placed in alignment transversely across the pavement.
2. The following shall apply to arrows located in one-way left turn lanes:
  - A. A minimum of two (2) arrows is required.
  - B. The maximum spacing between arrows is 80' (24 m).
  - C. Arrows shall be evenly spaced if three (3) or more are required.
3. The following shall apply to arrow pairs located in two-way left turn lanes:
  - A. A minimum of two (2) arrow pairs is required.
  - B. The maximum spacing between arrow pairs is 200' (61 m).
  - C. Arrow pairs shall be evenly spaced if three (3) or more are required.
  - D. The spacing between Bi Directional Left Turn Arrows is 33' (10 m).

**GENERAL NOTES**

1. Refer to State Standard 780001 for additional Pavement Markings including letters & arrows.
2. See Plans for Pavement Markings adjacent to curbed islands and medians, and through lane reductions.
3. Refer to Article 780.13 for letter, number and symbol areas (sq. ft.)
4. Areas are grooved 1" beyond each edge for the following symbols:
  - Through Arrow= 14.8 sq. ft.
  - Large Left or Right Arrow= 21.9 sq. ft.
  - 2 Arrow Combination Left (or Right) and Through= 34.9 sq. ft.
  - Wrong Way Arrow= 29.5 sq. ft.
  - Railroad Crossing Symbol= 69.8 sq. ft.
 (For further information, refer to BDE Special Provision: Grooving for Recessed Pavement Markings)

MODEL: Default; FILE NUMBER: 23136 - Hanna City-Glasford Rd. - PH LIT (Peoria County)CADD Sheets(045)116-sh-11-D4-stds.dgn



USER NAME = SHUGHES	DESIGNED - WSL	REVISED -
DRAWN - SRH	REVISED -	
PLOT SCALE = 2,000' / in.	CHECKED - WSL	REVISED -
PLOT DATE = 12/12/2023	DATE - 10-26-23	REVISED -



<b>HANNA CITY-GLASFORD RD (CH R34)</b>			
<b>DISTRICT 4 STANDARD 780001-D4</b>			
<b>TYPICAL PAVEMENT MARKINGS (1 OF 2)</b>			
SCALE: N/A	SHEET 1 OF 1 SHEETS	STA. N/A	TO STA. N/A

F.A.S. RTE.	SECTION	COUNTY	TOTAL SHEETS	SHEET NO.
388A	22-00056-00-5P	PEORIA	12	11
CONTRACT NO. 89831				
ILLINOIS FED. AID PROJECT				

