

STATE OF ILLINOIS
DEPARTMENT OF TRANSPORTATION

F.A.P. RTE.	SECTION	COUNTY	TOTAL SHEETS	SHEET NO.
849	D9 BRIDGE OVERLAY 2023-10	JEFFERSON	16	1
		ILLINOIS	CONTRACT NO. 78A10	

FOR INDEX OF SHEETS, SEE SHEET NO. 3
FOR SUMMARY OF QUANTITIES, SEE SHEET NO. 4-5

PROPOSED HIGHWAY PLANS

FAP 849 (IL 142)
SECTION D9 BRIDGE OVERLAY 2023-10
PROJECT HBFP-CEMX(301)
BRIDGE OVERLAY
JEFFERSON COUNTY

C-99-059-23

TRAFFIC DATA

IL 142 TRAFFIC DATA
2021 ADT = 2850
8% TRUCKS

TOWNSHIPS

PENDLETON

POSTED SPEED : 55 MPH

J.U.L.E.
JOINT UTILITY LOCATION INFORMATION FOR EXCAVATION
1-800-892-0123
OR 811

PROJECT ENGINEER: EHREN KIRBY
PROJECT DESIGNER: DAVID WILSON

CONTRACT NO. 78A10

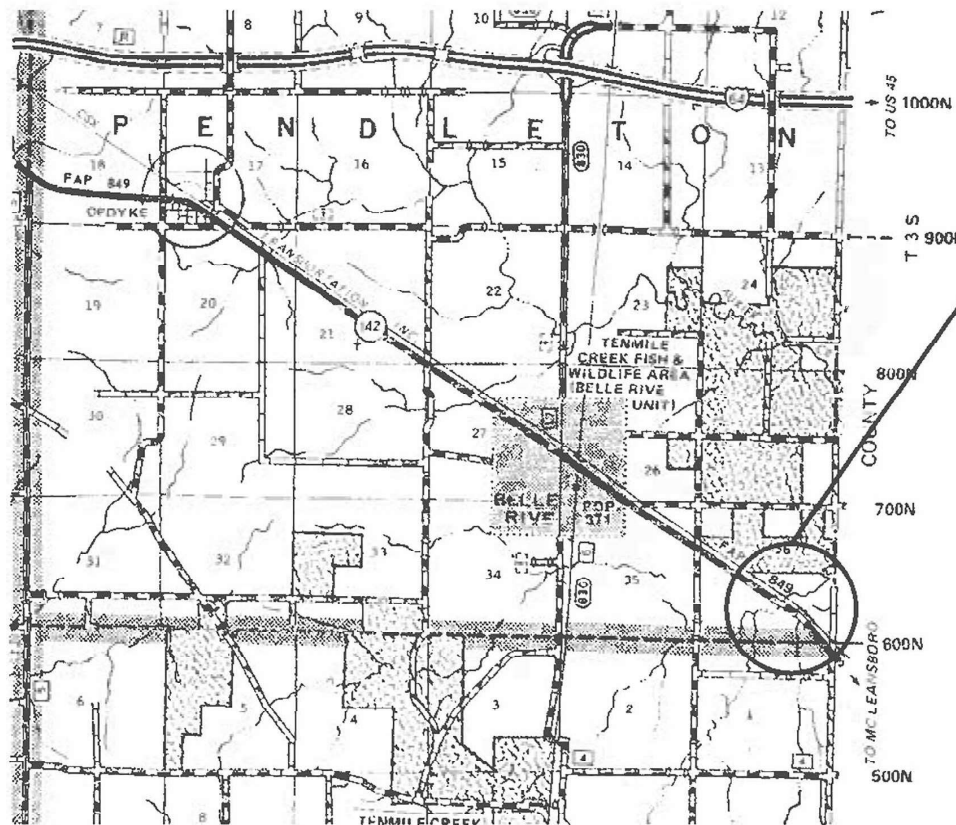

BRIDGE NO. 1
SN 041-0099
JEFFERSON COUNTY
IL 142 OVER ROCKY BRANCH

BRIDGE NO. 2
SN 041-0048
JEFFERSON COUNTY
IL 142 OVER ROCKY BRANCH TRIBUTARY

GROSS LENGTH = 910.3 FT. = 0.17 MILES
NET LENGTH = 910.3 FT. = 0.17 MILES

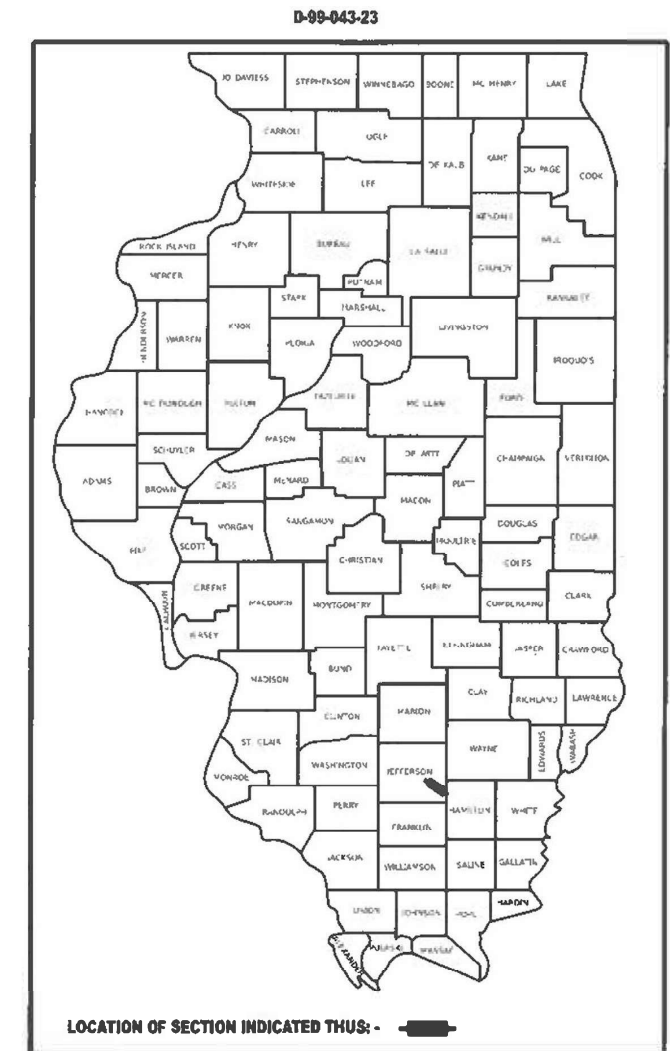

STATE OF ILLINOIS
DEPARTMENT OF TRANSPORTATION

SUBMITTED Jan 24 2024
Ric ATB
REGION FIVE ENGINEER

March 22, 2024 [Signature]
ENGINEER OF DESIGN AND ENVIRONMENT

March 22, 2024 [Signature]
DIRECTOR OF HIGHWAYS PROJECT IMPLEMENTATION

PRINTED BY THE AUTHORITY
OF THE STATE OF ILLINOIS

MODEL: Signature Sheet (Sheet)
FILE NAME: p:\missouri\hollister.com\PM\DOT\Documents\DOT Office\District 9\CD Project\7111\DCAD\Data\CD\8888\2024\10-Sign-Cover_Sig.dgn

Prepared By: _____
DISTRICT STUDIES & PLANS ENGINEER

Examined By: Nancy Hei
DISTRICT LAND ACQUISITION ENGINEER

Examined By: Carrie Nelson
DISTRICT PROGRAM DEVELOPMENT ENGINEER

Examined By: [Signature]
DISTRICT OPERATIONS ENGINEER

Examined By: Doris J. Willis
DISTRICT PROJECT IMPLEMENTATION ENGINEER

Examined By: Doris J. Willis
DISTRICT CONSTRUCTION ENGINEER

Examined By: Aam Hays
DISTRICT MATERIALS ENGINEER

USER NAME	▪ david.s.wilson	DESIGNED	-	REVISED	-
DRAWN	-	REVISIONS	-	REVISIONS	-
PLOT SCALE	▪ 0.16666633 / in.	CHECKED	-	REVISIONS	-
PLOT DATE	▪ 1/23/2024	DATE	-	REVISIONS	-

**STATE OF ILLINOIS
DEPARTMENT OF TRANSPORTATION**

SIGNATURE SHEET

SCALE: SHEET 2 OF 16 SHEETS STA. TO STA.

F.A.P. RTE.	SECTION	COUNTY	TOTAL SHEETS	SHEET NO.
849	D9 BRIDGE OVERLAY 2023-10	JEFFERSON	16	2

ILLINOIS FED. AID PROJECT CONTRACT NO. 78A10

GENERAL NOTES

ON ALL SUPERELEVATED CURVES, THE PROPOSED BASE COURSE WIDENING SHALL BE CONSTRUCTED WITH A SLOPE CONFORMING TO THE RATE OF SUPERELEVATION OF THE EXISTING PAVEMENT.

REMOVAL OF EXISTING HMA AND AGGREGATE SHOULDER SHALL BE INCLUDED IN THE COST OF PAVED SHOULDER REMOVAL.

COMMITMENTS:

BRIDGES ARE STAGED SEPERATELY TO ACCOMODATE ACCESS TO THE FIELD ENTRANCE BETWEEN THE BRIDGES. THIS IS THE ONLY ACCESS TO THAT FIELD.

INDEX OF SHEETS

1	COVER SHEET
2	SIGNATURE SHEET
3	GENERAL NOTES, INDEX OF SHEETS AND STANDARDS
4-5	SUMMARY OF QUANTITIES
6	SCHEDULES
7	GENERAL PLAN AND ELEVATION - SN 041-0099
8	TYPICAL SECTIONS AND STAGING - SN 041-0099
9	SOFFIT PATCHING AND ABUTMENT REPAIR DETAILS - SN 041-0099
10	STAGE I DETAILS - SN 041-0099
11	STAGE II DETAILS - SN 041-0099
12	GENERAL PLAN AND ELEVATION - SN 041-0048
13	TYPICAL SECTIONS AND STAGING - SN 041-0048
14	ABUTMENT REPAIR DETAILS - SN 041-0048
15	STAGE I DETAILS - SN 041-0048
16	STAGE II DETAILS - SN 041-0048

STANDARDS

000001-08	STANDARD SYMBOLS, ABBREVIATIONS AND PATTERNS
420001-10	PAVEMENT JOINTS
001001-02	AREAS OF REINFORCEMENT BARS
001006	DECIMAL OF AN INCH AND OF A FOOT
701001-02	OFF-ROAD OPERATIONS, 2L, 2W, MORE THAN 15' AWAY
701006-05	OFF-ROAD OPERATIONS, 2L, 2W, 15' TO 24" FROM PAVEMENT EDGE
701201-05	LANE CLOSURE, 2L, 2W, DAY ONLY, FOR SPEEDS ≥ 45 MPH
701316-13	LANE CLOSURE, 2L, 2W, BRIDGE REPAIR FOR SPEED > 45 MPH
701326-04	LANE CLOSURE, 2L, 2W, PAVEMENT WIDENING, FOR SPEEDS ≥ 45 MPH
701901-08	TRAFFIC CONTROL DEVICES
780001-05	TYPICAL PAVEMENT MARKINGS
862001-01	UNINTERRUPTABLE POWER SUPPLY (UPS)

REV. - MS

**STATE OF ILLINOIS
DEPARTMENT OF TRANSPORTATION**

**GENERAL NOTES, INDEX OF SHEETS
AND STANDARDS**

SCALE: SHEET 3 OF 16 SHEETS STA. TO STA.

F.A.P. RTE.	SECTION	COUNTY	TOTAL SHEETS	SHEET NO.
849	D9 BRIDGE OVERLAY 2023-10	JEFFERSON	16	3
CONTRACT NO. 78A10				
ILLINOIS FED. AID PROJECT				

MODEL: General Notes_Index of Sheets and Standards (Sheet)
FILE NAME: p:\projects\2023\78A10\DOT\Office\Drawings\DOT\Office\Drawings\78A10\DOT\Standards\Index_GenNotes.dgn

USER NAME = david.a.wilson	DESIGNED -	REVISED -	
	DRAWN -	REVISED -	
PLOT SCALE = 0.16666633' / in.	CHECKED -	REVISED -	
PLOT DATE = 2/28/2024	DATE -	REVISED -	

SUMMARY OF QUANTITIES

COUNTY:	JEFFERSON COUNTY
ROUTE:	FAP 842 (IL 142)
FUNDING:	80% FEDERAL 20% STATE
LOCATION:	RURAL

CODE NUMBER	ITEM DESCRIPTION	UNIT	TOTAL QUANTITY	SN 041-0099	SN 041-0048
				0047	0047
35400500	PORTLAND CEMENT CONCRETE BASE COURSE WIDENING 10"	SQ YD	281	142	139
44004250	PAVED SHOULDER REMOVAL	SQ YD	281	142	139
67000400	ENGINEER'S FIELD OFFICE, TYPE A	CAL MO	3	1.5	1.5
67100100	MOBILIZATION	L SUM	1	0.5	0.5
70100100	TRAFFIC CONTROL AND PROTECTION, STANDARD 701316	EACH	2	1	1
70100450	TRAFFIC CONTROL AND PROTECTION, STANDARD 701201	L SUM	1	0.5	0.5
70100500	TRAFFIC CONTROL AND PROTECTION, STANDARD 701326	L SUM	1	0.5	0.5
70103815	TRAFFIC CONTROL SURVEILLANCE	CAL DA	4	2	2
70106500	TEMPORARY BRIDGE TRAFFIC SIGNALS	EACH	2	1	1
70106700	TEMPORARY RUMBLE STRIPS	EACH	12	6	6
70107025	CHANGEABLE MESSAGE SIGN	CAL DA	28	14	14
70300100	SHORT TERM PAVEMENT MARKING	FOOT	91	45.5	45.5
70300150	SHORT TERM PAVEMENT MARKING REMOVAL	SQ FT	30	15	15
70300221	TEMPORARY PAVEMENT MARKING - LINE 4" - PAINT	FOOT	2,051	1,025.5	1,025.5

MODEL: SUMMARY OF QUANTITIES.rvt (Rev. 4/17)
 FILE NAME: P:\GIS\Projects\78A10\Drawings\DOT\Office\Drawings\DOT\Office\Drawings\78A10\Drawings\78A10-Sum-Qty.dgn

REV. - MS

USER NAME = david.a.wilson PLOT SCALE = 0.16666633 / in. PLOT DATE = 1/23/2024	DESIGNED - DRAWN - CHECKED - DATE -	REVISED - REVISED - REVISED - REVISED -	STATE OF ILLINOIS DEPARTMENT OF TRANSPORTATION	SUMMARY OF QUANTITIES	SCALE:	SHEET 4 OF 16 SHEETS STA. TO STA.	F.A.P. RTE. 849 SECTION D9 BRIDGE OVERLAY 2023-10 COUNTY JEFFERSON TOTAL SHEETS 16 SHEET NO. 4 CONTRACT NO. 78A10 ILLINOIS FED. AID PROJECT
--	--	--	---	------------------------------	--------	-----------------------------------	---

SUMMARY OF QUANTITIES - CONT

COUNTY:	JEFFERSON COUNTY
ROUTE:	FAP 842 (IL 142)
FUNDING:	80% FEDERAL 20% STATE
LOCATION:	RURAL

CODE NUMBER	ITEM DESCRIPTION	UNIT	TOTAL QUANTITY	SN 041-0099	SN 041-0048
				0047	0047
*	78001110 PAINT PAVEMENT MARKING - LINE 4"	FOOT	2,051	1,025.5	1,025.5
	78300200 RAISED REFLECTIVE PAVEMENT MARKER REMOVAL	EACH	1	1	
	78300201 PAVEMENT MARKING REMOVAL - GRINDING	SQ FT	1,368	684	684
*	86200300 UNINTERRUPTABLE POWER SUPPLY, EXTENDED	EACH	2	1	1
	X0322194 POLYMER MODIFIED PORTLAND CEMENT MORTAR	SQ FT	83	83	
	Z0012102 CONCRETE BRIDGE DECK SCARIFICATION 3/8 INCH	SQ YD	644	430	214
	Z0012193 BRIDGE DECK THIN POLYMER OVERLAY 3/8"	SQ YD	644	430	214
	Z0012754 STRUCTURAL REPAIR OF CONCRETE (DEPTH EQUAL TO OR LESS THAN 5 INCHES)	SQ FT	50.8	1.6	49.2

* SPECIALTY ITEM

REV. - MS

MODEL - SUMMARY OF QUANTITIES.r (Rev.4)
 FILE NAME: P:\GIS\PROJECTS\2023-10-10\78410\CADD\Drawings\DOT\Office\8490\Drawings\DOT\78410-D9-Bridge-Overlay-Summary-5.dgn

USER NAME = david.a.wilson PLOT SCALE = 0.16666633 / in. PLOT DATE = 1/23/2024	DESIGNED - DRAWN - CHECKED - DATE -	REVISED - REVISED - REVISED - REVISED -	STATE OF ILLINOIS DEPARTMENT OF TRANSPORTATION	SUMMARY OF QUANTITIES	<table border="1" style="width: 100%; border-collapse: collapse;"> <tr> <th style="width: 5%;">F.A.P. RTE.</th> <th style="width: 35%;">SECTION</th> <th style="width: 10%;">COUNTY</th> <th style="width: 5%;">TOTAL SHEETS</th> <th style="width: 45%;">SHEET NO.</th> </tr> <tr> <td>849</td> <td>D9 BRIDGE OVERLAY 2023-10</td> <td>JEFFERSON</td> <td>16</td> <td>5</td> </tr> <tr> <td colspan="5" style="text-align: center;">CONTRACT NO. 78A10</td> </tr> </table>	F.A.P. RTE.	SECTION	COUNTY	TOTAL SHEETS	SHEET NO.	849	D9 BRIDGE OVERLAY 2023-10	JEFFERSON	16	5	CONTRACT NO. 78A10				
F.A.P. RTE.	SECTION	COUNTY	TOTAL SHEETS	SHEET NO.																
849	D9 BRIDGE OVERLAY 2023-10	JEFFERSON	16	5																
CONTRACT NO. 78A10																				

SCALE: SHEET 5 OF 16 SHEETS STA. TO STA.

ILLINOIS FED. AID PROJECT

PAVEMENT MARKING SCHEDULE

STATION					NOTES	TEMPORARY PAVEMENT MARKING		PAINT PAVEMENT MARKING		PAVEMENT MARKING REMOVAL - GRINDING	SHORT TERM PAVEMENT MARKING	SHORT TERM PAVEMENT MARKING REMOVAL	RAISED REFLECTIVE PAVEMENT MARKER REMOVAL
						LINE - 4" WHITE	LINE - 4" YELLOW	LINE - 4" WHITE	LINE - 4" YELLOW				
						SOLID	SKIP - DASH	SOLID	SKIP - DASH				
						FT	FT	FT	FT	SQ FT	FT	SQ FT	EACH
IL 142													
676+52.5	RT	TO	685+62.8	RT		910.3		910.3		607			
676+52.5		TO	685+62.8		ALONG CENTERLINE		230		230	154	92	31	1
676+52.5	LT	TO	685+62.8	LT		910.3		910.3		607			
TOTALS							2051		2051	1368	92	31	1

MODEL: Schedule (Sheet)
 FILE NAME: P:\MIDOT\Documents\DOT Office\District 9\ORIG Project\78A10\CADData\CAD\Drawings\78A10-SHE-Schedule.dgn

USER NAME = david.a.wilson	DESIGNED -	REVISED -
	DRAWN -	REVISED -
PLOT SCALE = 0.16666633' / in.	CHECKED -	REVISED -
PLOT DATE = 1/23/2024	DATE -	REVISED -

**STATE OF ILLINOIS
DEPARTMENT OF TRANSPORTATION**

SCHEDULES			
SCALE:	SHEET 6	OF 16 SHEETS	STA. TO STA.

F.A.P. RTE.	SECTION	COUNTY	TOTAL SHEETS	SHEET NO.
849	D9 BRIDGE OVERLAY 2023-10	JEFFERSON	16	6
CONTRACT NO. 78A10				
ILLINOIS FED. AID PROJECT				

GENERAL NOTES

Plan dimensions and details relative to existing plans are subject to nominal construction variations. The Contractor shall field verify existing dimensions and details affecting new construction and make necessary approved adjustments prior to construction or ordering materials. Such variations shall not be cause for additional compensation for a change in scope of work, however, the Contractor will be paid for the quantity actually furnished at the unit price bid for the work.

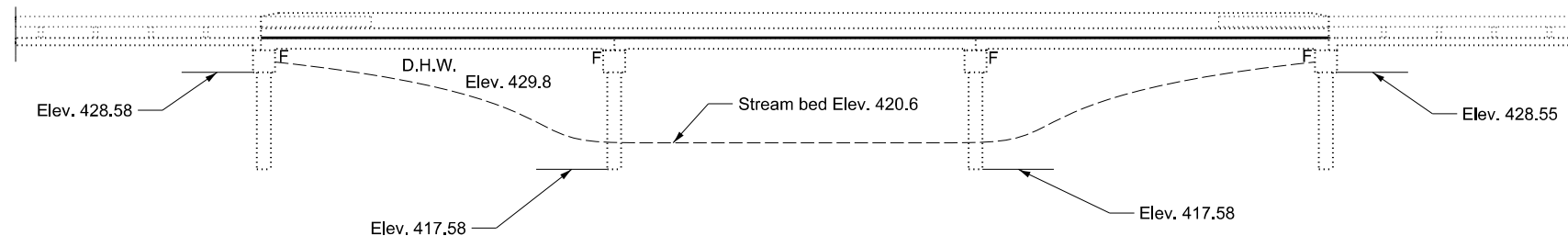

ELEVATION

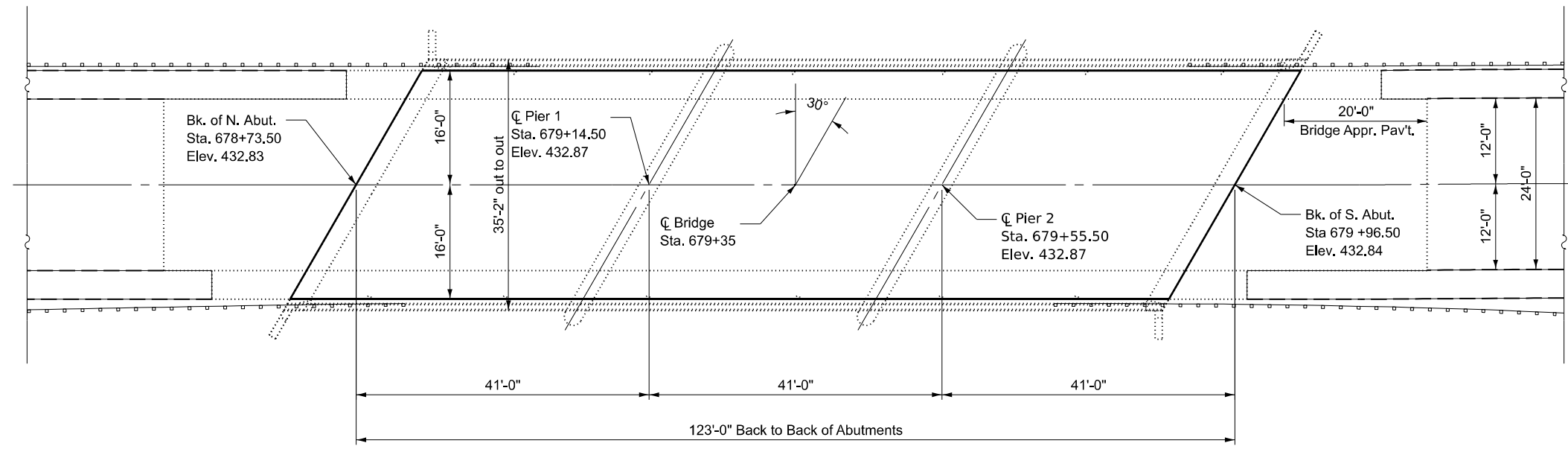
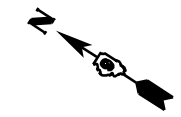

PLAN

BILL OF MATERIALS

ITEM	UNIT	TOTAL
Portland Cement Concrete Base Course Widening 10"	Sq. Yd.	142
Paved Shoulder Removal	Sq. Yd.	142
Polymer Modified Portland Cement Mortar	Sq. Ft.	83
Concrete Bridge Deck Scarification 3/8"	Sq. Yd.	430
Bridge Deck Thin Polymer Overlay 3/8"	Sq. Yd.	430
Structural Repair of Concrete ≤ 5"	Sq. Ft.	1.6

BRIDGE OVERLAY
IL 142 (FAP 849)
OVER ROCKY BRANCH
JEFFERSON COUNTY
D9 BRIDGE OVERLAY 2023-10
SN 041-0099

MODEL: General Plan and Elevation; SN 041-0099 (Sheet)
 FILE NAME: p:\projects\2023\10\JEFFERSON\PROJECTS\BRIDGE\10\CAD\Drawings\DOT\Office\Drawings\DOT\General Plan and Elevation.dgn

USER NAME = david.a.wilson	DESIGNED -	REVISED -
DRAWN -	REVISIONS -	
PLOT SCALE = 0.16666633 / in.	CHECKED -	REVISED -
PLOT DATE = 2/28/2024	DATE -	REVISED -

STATE OF ILLINOIS
DEPARTMENT OF TRANSPORTATION

GENERAL PLAN AND ELEVATION
SN 041-0099

SCALE: SHEET 7 OF 16 SHEETS STA. TO STA.

F.A.P. RTE.	SECTION	COUNTY	TOTAL SHEETS	SHEET NO.
849	D9 BRIDGE OVERLAY 2023-10	JEFFERSON	16	7
			CONTRACT NO. 78A10	
ILLINOIS FED. AID PROJECT				

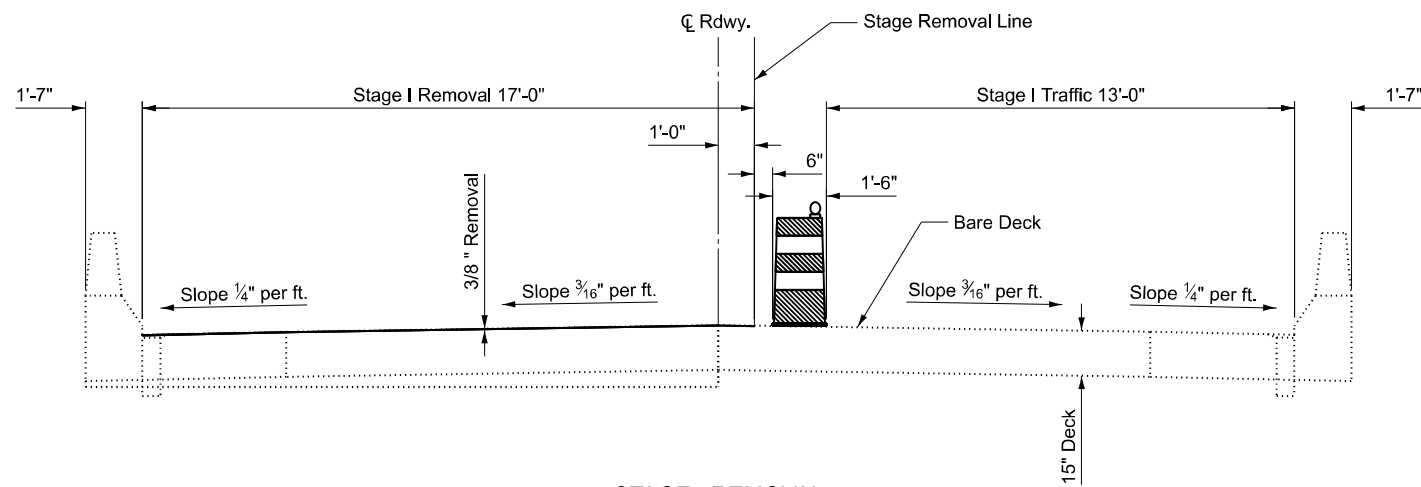

STAGE I REMOVAL
(Looking South)

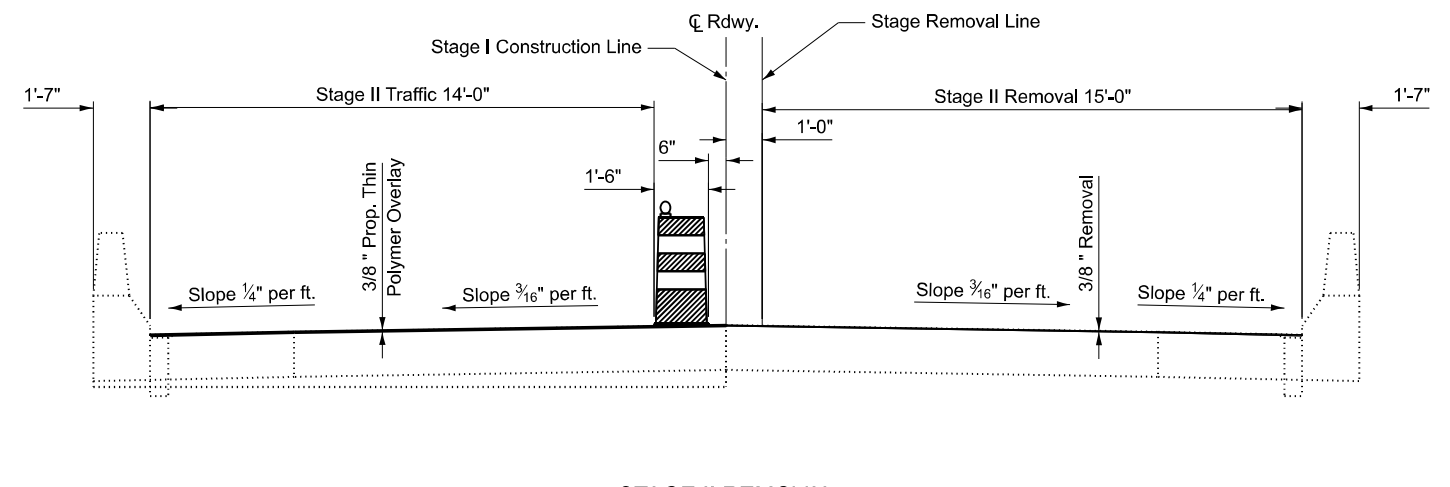

STAGE II REMOVAL
(Looking South)

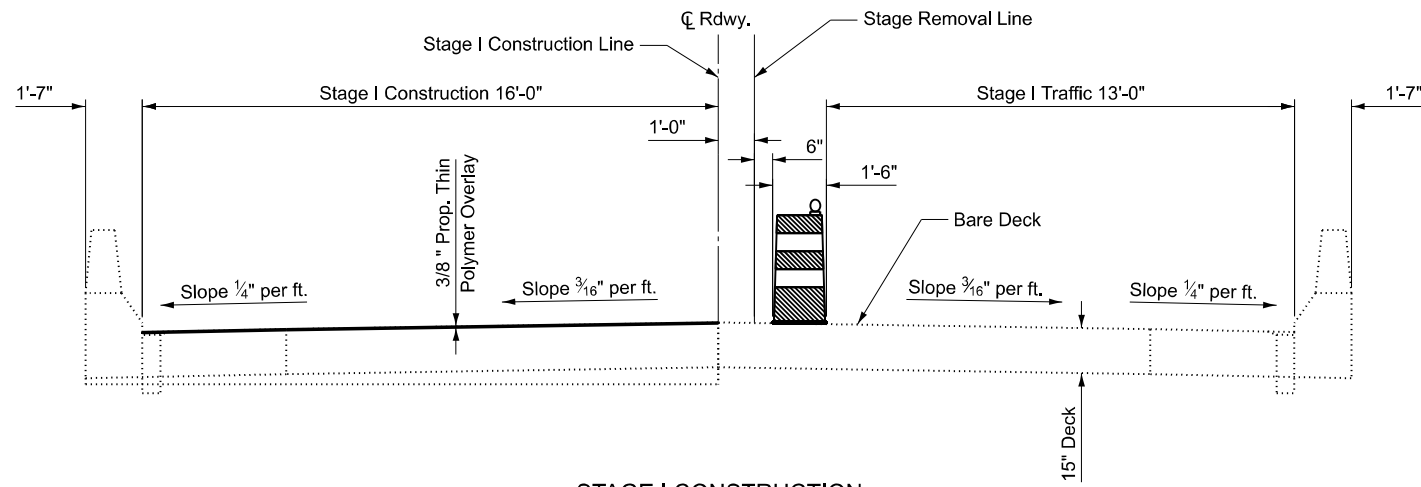

STAGE I CONSTRUCTION
(Looking South)

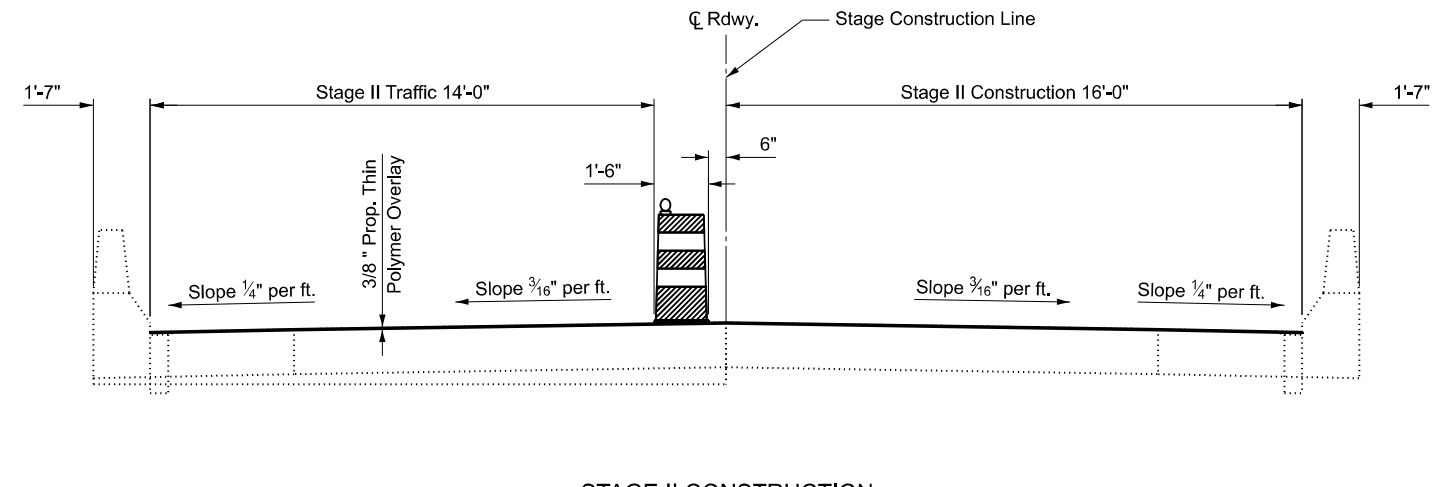

STAGE II CONSTRUCTION
(Looking South)

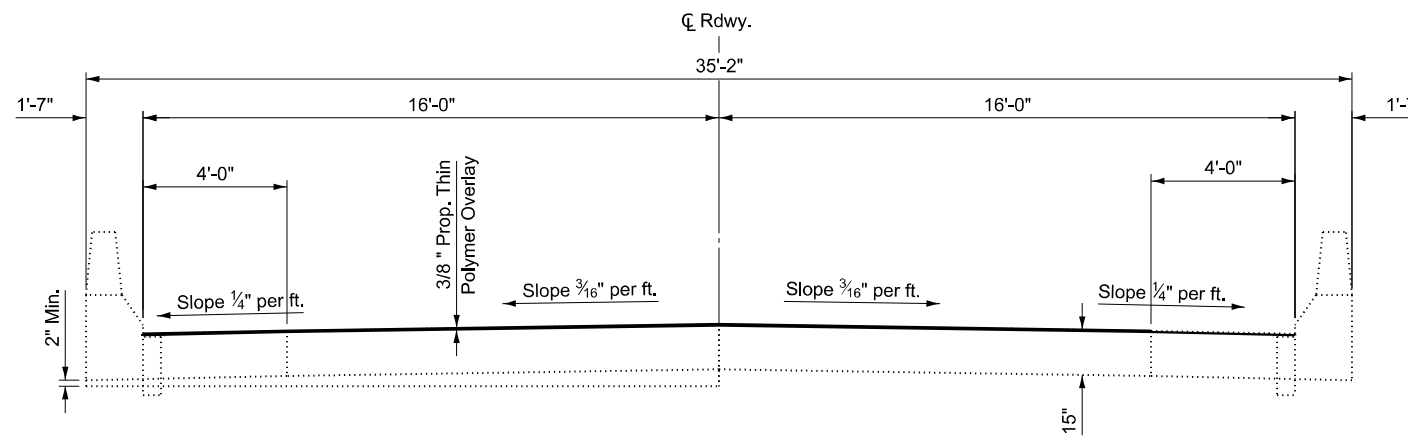

TYPICAL SECTION
(Looking South)

MODEL: Typical Sections and Staging SN 041-0099 (Sheet)
 FILE NAME: P:\Illinois\Projects\78A10\CD\Drawings\DOT\Office\Drawings\DOT\78A10\CD\Drawings\DOT\78A10\CD\Sheet-5-Typical.dwg

USER NAME = david.a.wilson	DESIGNED -	REVISED -
	DRAWN -	REVISED -
PLOT SCALE = 0.16666633 / in.	CHECKED -	REVISED -
PLOT DATE = 1/23/2024	DATE -	REVISED -

STATE OF ILLINOIS
DEPARTMENT OF TRANSPORTATION

TYPICAL SECTIONS AND STAGING
SN 041-0099

SCALE: SHEET 8 OF 16 SHEETS STA. TO STA.

F.A.P. RTE.	SECTION	COUNTY	TOTAL SHEETS	SHEET NO.
849	D9 BRIDGE OVERLAY 2023-10	JEFFERSON	16	8
CONTRACT NO. 78A10				
ILLINOIS FED. AID PROJECT				

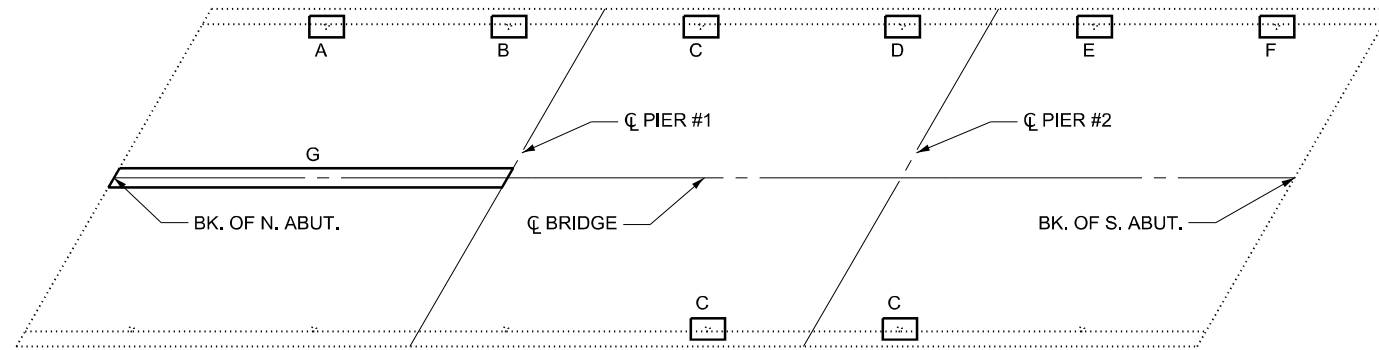
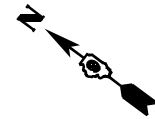

PLAN
(UNDERSIDE OF DECK)

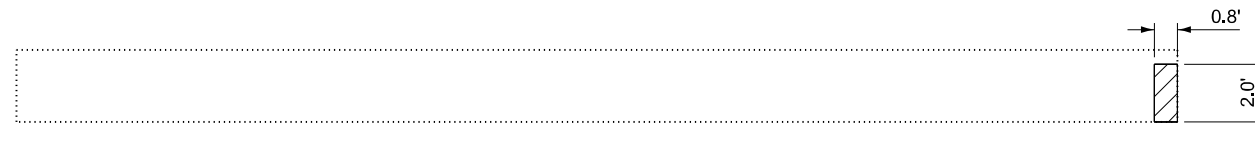
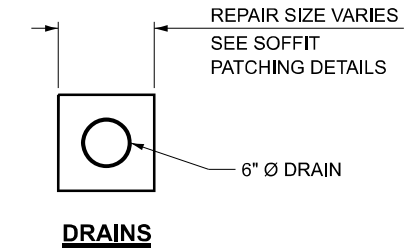

 STRUCTURAL REPAIR OF CONCRETE

SOUTH ABUTMENT LOOKING SOUTH
(NOT TO SCALE)

SOFFIT REPAIR DETAILS

REPAIR	REPAIR SIZE	LOCATIONS	TOTAL SQ FT
A	3.0 x 2.5	1	7.3
B	2.0 x 2.2	1	4.2
C	2.0 x 2.0	3	11.4
D	4.0 x 3.0	1	11.8
E	3.5 x 1.5	1	5.1
F	1.5 x 1.5	1	2.2
G	1.0 x 41.0	1	41.0
TOTAL			83.0

BILL OF MATERIALS

ITEM	UNIT	QUANTITY
Polymer Modified Portland Cement Mortar	Sq. Ft.	83
Structural Repair of Concrete ≤ 5"	Sq. Ft.	1.6

MODEL: Soffit Patching Details (Sheet)
 FILE NAME: P:\Bids\2023\2023-10\2023-10-01\DOT\Documents\DOT Office\District 9\ORIG Project\78A10\CAD\Drawings\DOT\9A10-Soffit Patching.dgn

USER NAME = david.a.wilson	DESIGNED -	REVISED -
PLOT SCALE = 0.16666633' / in.	DRAWN -	REVISED -
PLOT DATE = 2/28/2024	CHECKED -	REVISED -
	DATE -	REVISED -

STATE OF ILLINOIS
DEPARTMENT OF TRANSPORTATION

SOFFIT PATCHING AND ABUTMENT REPAIR DETAILS
SN 041-0099

SCALE: SHEET 9 OF 16 SHEETS STA. TO STA.

F.A.P. RTE.	SECTION	COUNTY	TOTAL SHEETS	SHEET NO.
849	D9 BRIDGE OVERLAY 2023-10	JEFFERSON	16	9
ILLINOIS FED. AID PROJECT			CONTRACT NO. 78A10	

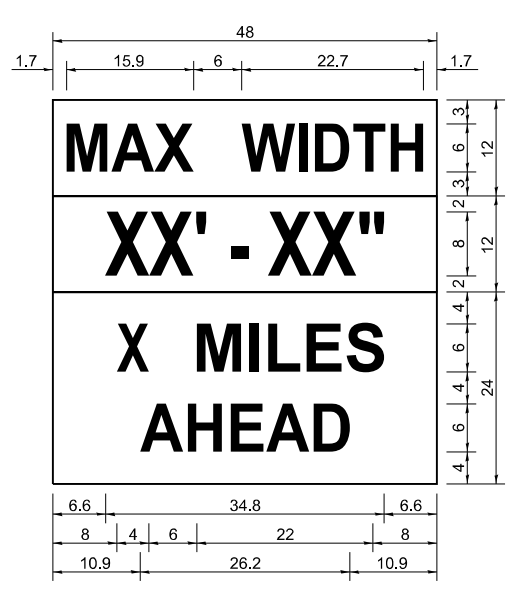
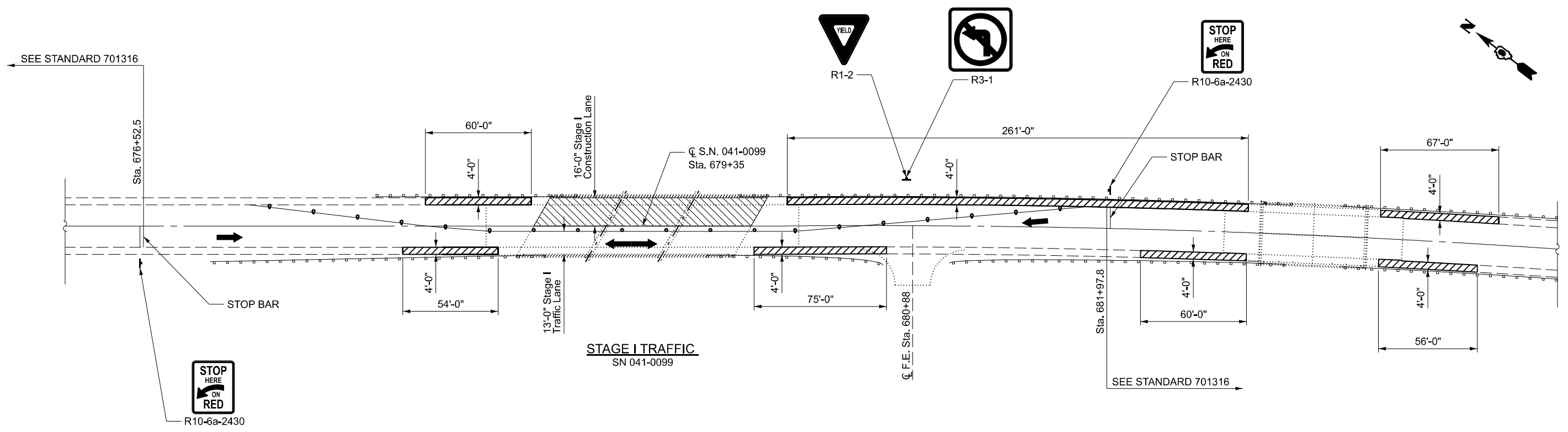

W12-I103 (WIDTH IS 80)
NO BORDER, BLACK ON WHITE:
[MAX WIDTH] D:

NO BORDER, BLACK ON ORANGE:
[XX' - XX"] D:

NO BORDER, BLACK ON WHITE:
[X MILES] D: [AHEAD] D:

ALL DIMENSIONS ARE IN INCHES UNLESS OTHERWISE NOTED.

Notes for Max Width Sign:

1. Install a Max Width Sign each direction on IL 142 to give traffic approaching work zone enough advance notice to change routes if needed. Exact locations as directed by Engineer.
2. The Contractor shall furnish the posts and erect the signs at the location directed by the Engineer. All signs shall be post mounted.
3. The noted work, including signs, posts, hardware, and labor shall be included in the contract unit price, Each, for Traffic Control and Protection, Std. 701316, no other compensation will be allowed.
4. The width shown on the W12-I103 sign shall be 18" less than what is shown in the staged lane widths or as directed by the Engineer.
5. The "X MILES AHEAD" will be determined by the Engineer.

- Proposed PCC Base Course Widening 10" To Be Constructed Prior To Stage I.
- Proposed 3/8" Thin Polymer Overlay

MODEL: Stage I Details SN 041-0099 (Sheet)
 FILE NAME: P:\Projects\2023\849\JEFF\Drawings\DOT\Office\Drawings\DOT\Drawings\849\041-0099\Stage I Details\Stage I Plan.dwg

W12-I103

USER NAME = david.a.wilson	DESIGNED -	REVISED -
PLOT SCALE = 0.16666633 / in.	DRAWN -	REVISED -
PLOT DATE = 2/28/2024	CHECKED -	REVISED -
	DATE -	REVISED -

**STATE OF ILLINOIS
DEPARTMENT OF TRANSPORTATION**

**STAGE I DETAILS
SN 041-0099**

SCALE: SHEET 10 OF 16 SHEETS STA. TO STA.

F.A.P. RTE.	SECTION	COUNTY	TOTAL SHEETS	SHEET NO.
849	D9 BRIDGE OVERLAY 2023-10	JEFFERSON	16	10
CONTRACT NO. 78A10				
ILLINOIS FED. AID PROJECT				

SEE STANDARD 701316

Sta. 676+52.5

STOP BAR



R10-6a-2430

14'-0" Stage II Traffic Lane
16'-0" Stage II Construction Lane

☐ S.N. 041-0099
Sta. 679+35

STAGE II TRAFFIC
SN 041-0099

☐ F.E. Sta. 680+88

Sta. 681+97.8

SEE STANDARD 701316



R1-2



R3-1



R10-6a-2430

STOP BAR

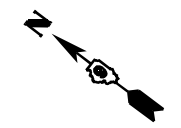

Proposed PCC Base Course Widening 10" to be constructed prior to Stage II.

Proposed 3/8" Thin Polymer Overlay

MODEL: Stage II Details SN 041-0099 (Sheet)
FILE NAME: P:\Bids\2023\2023-10\PROJECTS\78A10\CADD\Drawings\78A10-Stage II Traffic Plan.dgn

USER NAME = david.a.wilson	DESIGNED -	REVISED -
DRAWN -	REVISED -	
PLOT SCALE = 0.16666633' / in.	CHECKED -	REVISED -
PLOT DATE = 2/28/2024	DATE -	REVISED -

STATE OF ILLINOIS
DEPARTMENT OF TRANSPORTATION

STAGE II DETAILS
SN 041-0099

SCALE: SHEET 11 OF 16 SHEETS STA. TO STA.

F.A.P. RTE.	SECTION	COUNTY	TOTAL SHEETS	SHEET NO.
849	D9 BRIDGE OVERLAY 2023-10	JEFFERSON	16	11
ILLINOIS FED. AID PROJECT			CONTRACT NO. 78A10	

GENERAL NOTES

Plan dimensions and details relative to existing plans are subject to nominal construction variations. The Contractor shall field verify existing dimensions and details affecting new construction and make necessary approved adjustments prior to construction or ordering materials. Such variations shall not be cause for additional compensation for a change in scope of work, however, the Contractor will be paid for the quantity actually furnished at the unit price bid for the work.

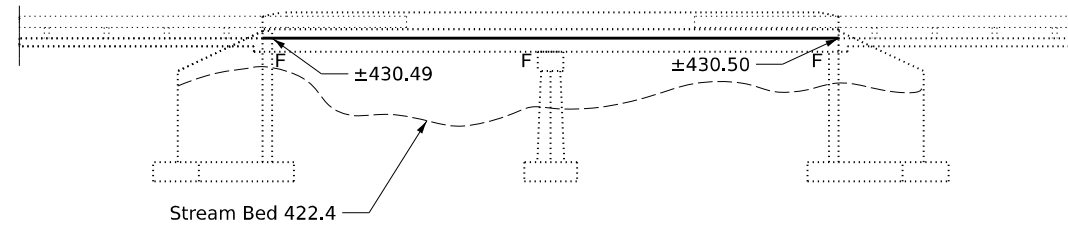

ELEVATION

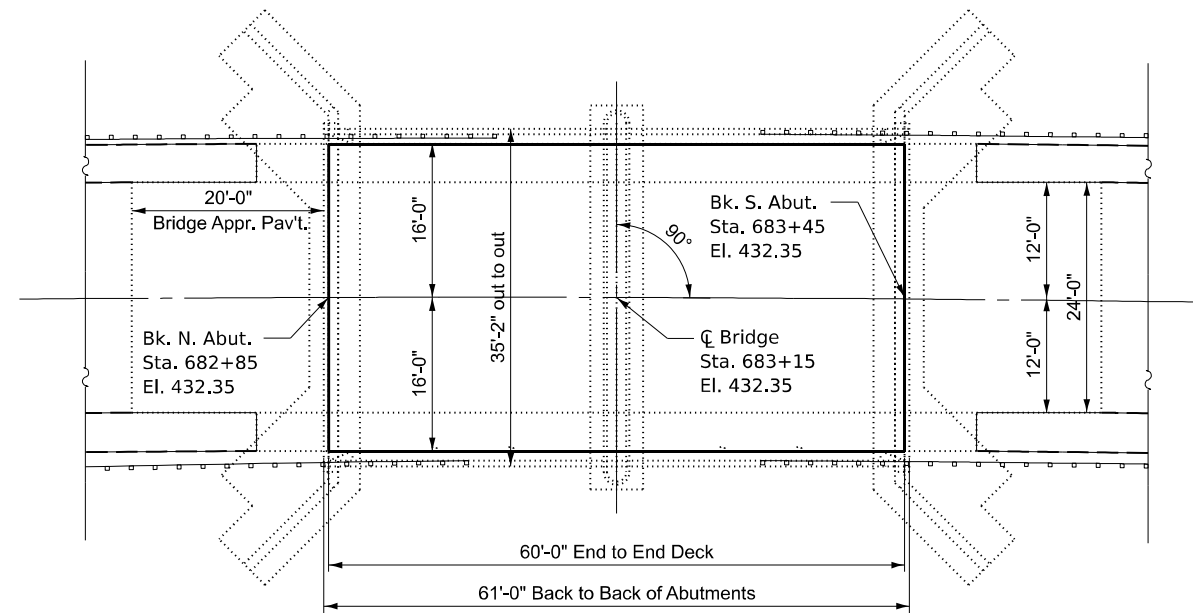
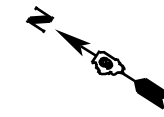

PLAN

BILL OF MATERIALS

ITEM	UNIT	TOTAL
Portland Cement Concrete Base Course Widening 10"	Sq. Yd.	139
Paved Shoulder Removal	Sq. Yd.	139
Concrete Bridge Deck Scarification 3/8"	Sq. Yd.	214
Bridge Deck Thin Polymer Overlay 3/8"	Sq. Yd.	214
Structural Repair of Concrete ≤ 5"	Sq. Ft.	49.2

BRIDGE OVERLAY
IL 142 (FAP 849)
OVER ROCKY BRANCH TRIBUTARY
JEFFERSON COUNTY
D9 BRIDGE OVERLAY 2023-10
SN 041-0048

MODEL: General Plan and Elevation; SN 041-0048 (Sheet)
 FILE NAME: P:\Bids\2023\2023-10\JEFFERSON\DOT\Office\District 9\ORD Project\78A10\CAD\Drawings\DOT\General Plan and Elevation.dgn

USER NAME = david.a.wilson	DESIGNED -	REVISED -
	DRAWN -	REVISED -
PLOT SCALE = 0.16666633' / in.	CHECKED -	REVISED -
PLOT DATE = 1/23/2024	DATE -	REVISED -

STATE OF ILLINOIS
DEPARTMENT OF TRANSPORTATION

GENERAL PLAN AND ELEVATION
SN 041-0048

SCALE: SHEET 12 OF 16 SHEETS STA. TO STA.

F.A.P. RTE.	SECTION	COUNTY	TOTAL SHEETS	SHEET NO.
849	D9 BRIDGE OVERLAY 2023-10	JEFFERSON	16	12
ILLINOIS FED. AID PROJECT			CONTRACT NO. 78A10	

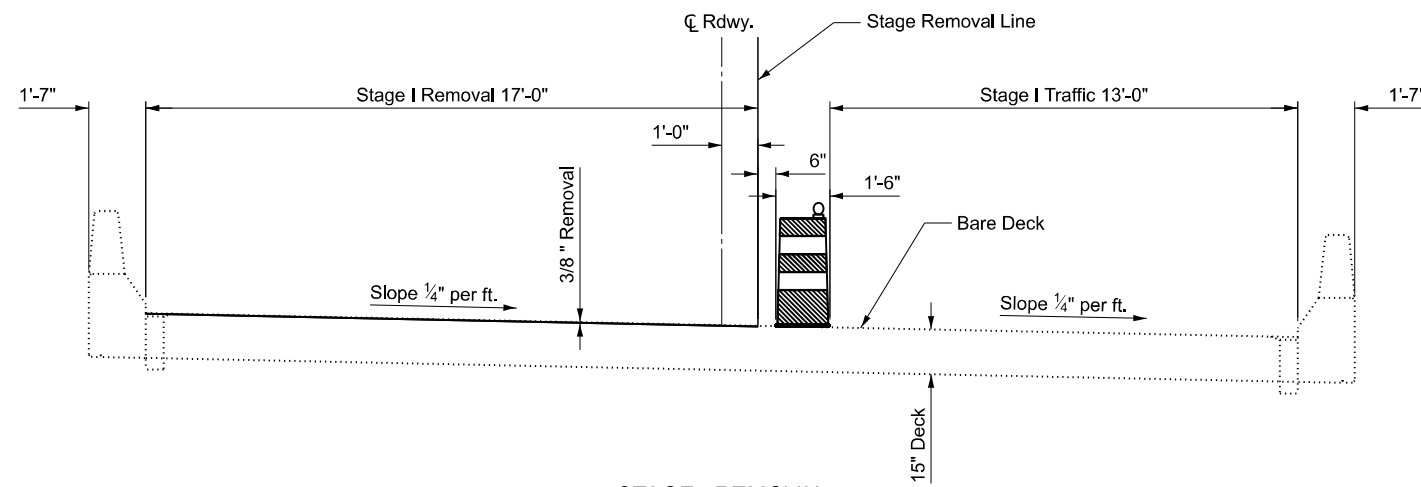

STAGE I REMOVAL
(Looking South)

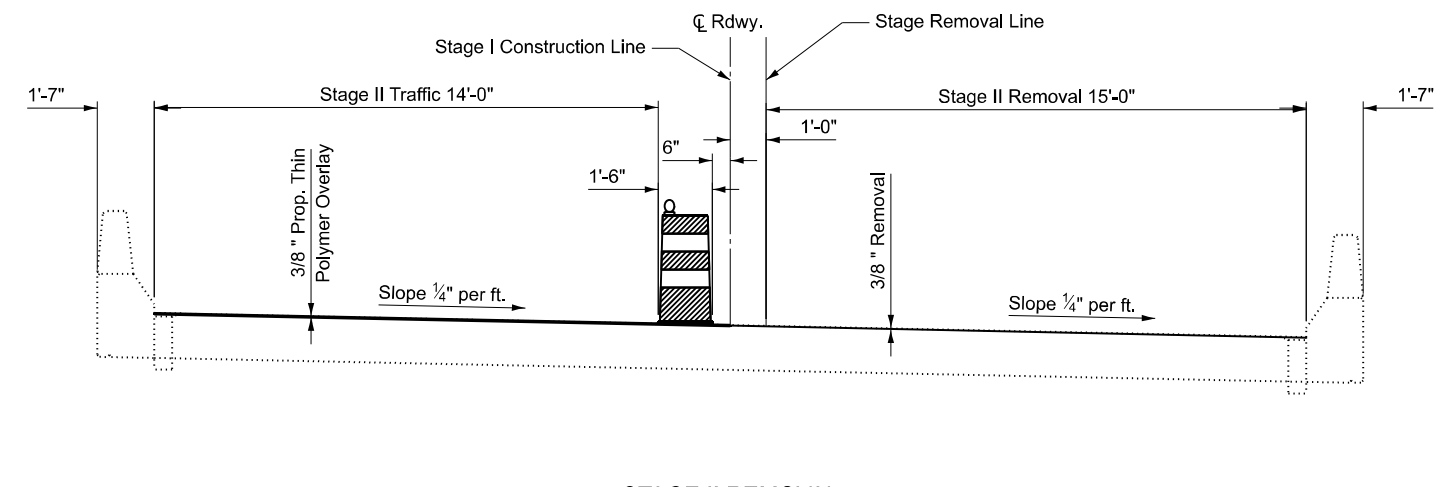

STAGE II REMOVAL
(Looking South)

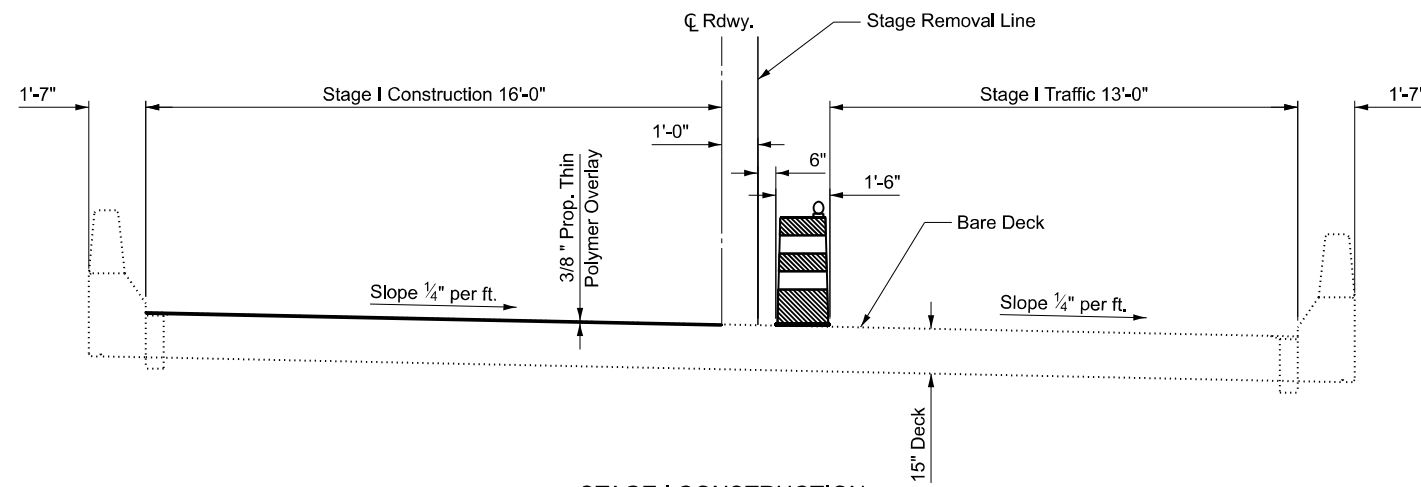

STAGE I CONSTRUCTION
(Looking South)

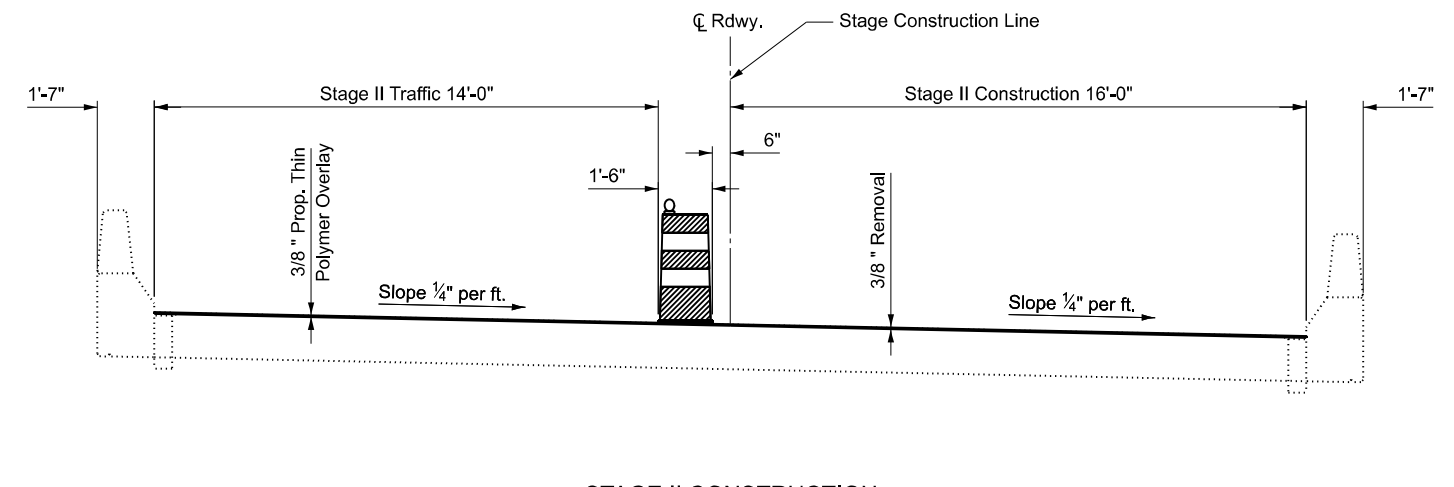

STAGE II CONSTRUCTION
(Looking South)

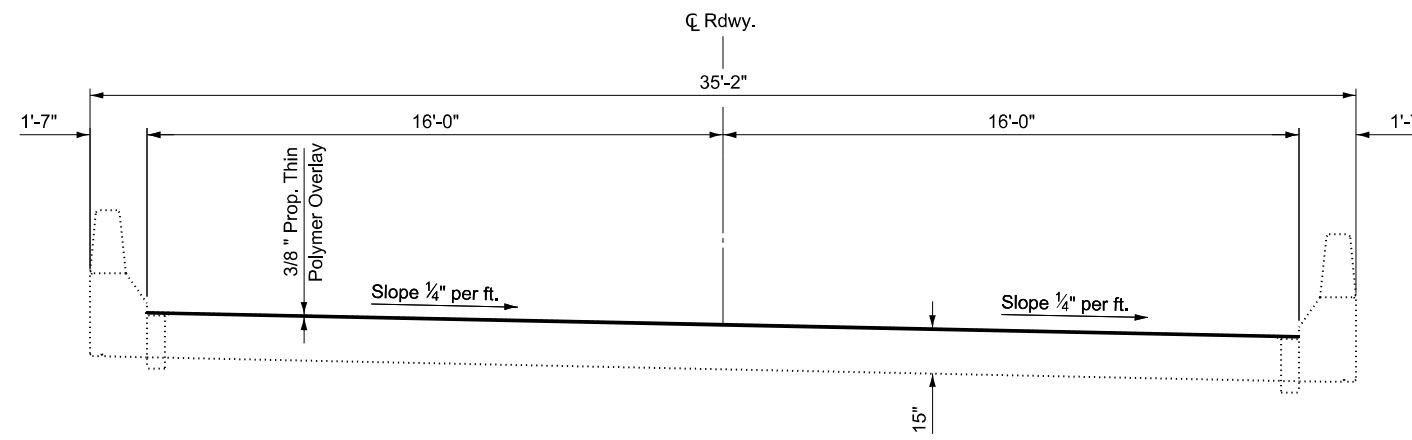

TYPICAL SECTION
(Looking South)

MODEL: Typical Sections and Staging SN 041-0048 (Sheet)
 FILE NAME: P:\Public\Projects\78A10\CAD\Drawings\DOT\Office\Drawings\DOT\78A10\Drawings\DOT\78A10\Sheet-1-Typical.dwg

USER NAME = david.a.wilson	DESIGNED -	REVISED -
DRAWN -	REVISOR -	REVISION -
PLOT SCALE = 0.16666633' / in.	CHECKED -	REVISOR -
PLOT DATE = 1/23/2024	DATE -	REVISION -

STATE OF ILLINOIS
DEPARTMENT OF TRANSPORTATION

TYPICAL SECTIONS AND STAGING
SN 041-0048

SCALE: SHEET 13 OF 16 SHEETS STA. TO STA.

F.A.P. RTE.	SECTION	COUNTY	TOTAL SHEETS	SHEET NO.
849	D9 BRIDGE OVERLAY 2023-10	JEFFERSON	16	13
CONTRACT NO. 78A10			ILLINOIS FED. AID PROJECT	

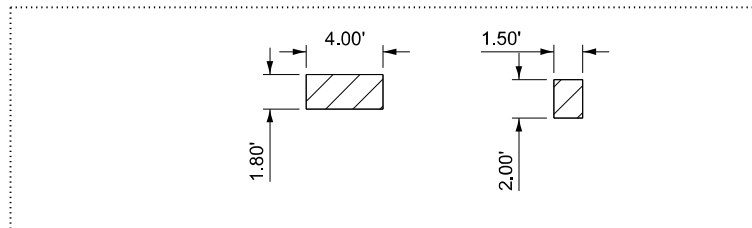

NORTH ABUTMENT LOOKING NORTH

 Structural Repair of Concrete ≤ 5"

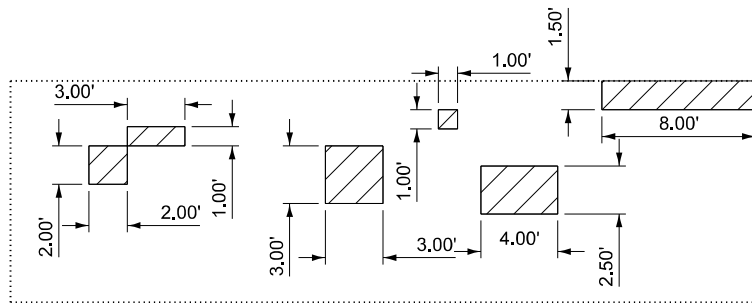

SOUTH ABUTMENT LOOKING SOUTH

BILL OF MATERIALS

ITEM	UNIT	TOTAL
Structural Repair of Concrete ≤ 5"	Sq. Ft.	49.2

MODEL: Structural Repair of Concrete (Sheet)
 FILE NAME: P:\Illinois\Projects\78A10\CAD\Drawings\DOT\Office\Drawings\78A10\CAD\Drawings\DOT\Structural Repair of Concrete.dgn

USER NAME = david.a.wilson	DESIGNED -	REVISED -
	DRAWN -	REVISED -
PLOT SCALE = 0.16666633' / in.	CHECKED -	REVISED -
PLOT DATE = 2/28/2024	DATE -	REVISED -

**STATE OF ILLINOIS
DEPARTMENT OF TRANSPORTATION**

**ABUTMENT REPAIR DETAILS
SN 041-0048**

SCALE: SHEET 14 OF 16 SHEETS STA. TO STA.

F.A.P. RTE.	SECTION	COUNTY	TOTAL SHEETS	SHEET NO.
849	D9 BRIDGE OVERLAY 2023-10	JEFFERSON	16	14
			CONTRACT NO. 78A10	
ILLINOIS FED. AID PROJECT				

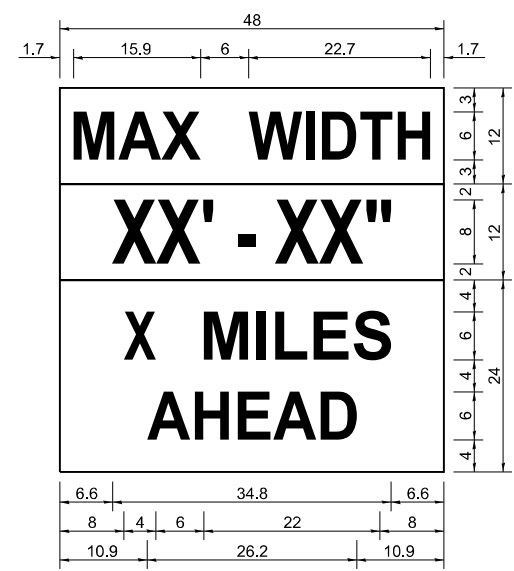
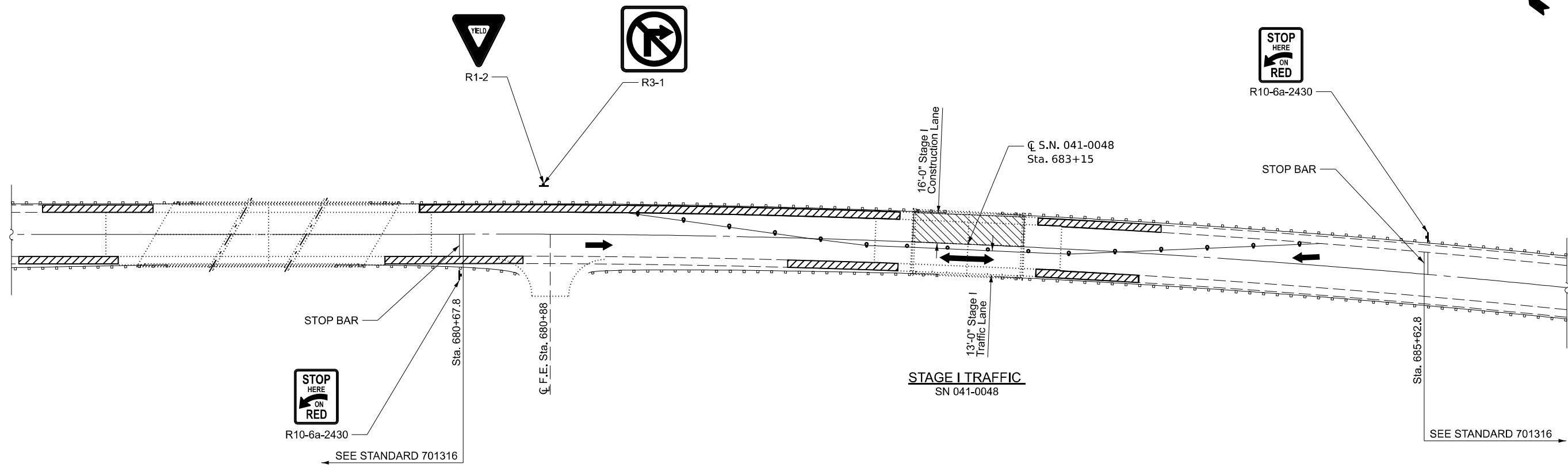
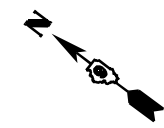

W12-I103

W12-I103 (WIDTH IS 80)
NO BORDER, BLACK ON WHITE:
[MAX WIDTH] D:

NO BORDER, BLACK ON ORANGE:
[XX' - XX"] D:

NO BORDER, BLACK ON WHITE:
[X MILES] D: [AHEAD] D:

ALL DIMENSIONS ARE IN INCHES UNLESS OTHERWISE NOTED.

Notes for Max Width Sign:

1. Install a Max Width Sign each direction on IL 142 to give traffic approaching work zone enough advance notice to change routes if needed. Exact locations as directed by Engineer.
2. The Contractor shall furnish the posts and erect the signs at the location directed by the Engineer. All signs shall be post mounted.
3. The noted work, including signs, posts, hardware, and labor shall be included in the contract unit price, Each, for Traffic Control and Protection, Std. 701316, no other compensation will be allowed.
4. The width shown on the W12-I103 sign shall be 18" less than what is shown in the staged lane widths or as directed by the Engineer.
5. The "X MILES AHEAD" will be determined by the Engineer.

- Proposed PCC Base Course Widening 10" To Be Constructed Prior To Stage I.
- Proposed 3/8" Thin Polymer Overlay

MODEL: Stage I Details SN 041-0048 (Sheet)
FILE NAME: P:\Projects\2023\849\849-D9-Overlay\Drawings\DWG\849-D9-Overlay-Detail-Stage I Details-DWG.dwg

USER NAME = david.a.wilson	DESIGNED -	REVISED -
DRAWN -	REVISED -	
PLOT SCALE = 0.16666633' / in.	CHECKED -	REVISED -
PLOT DATE = 2/28/2024	DATE -	REVISED -

**STATE OF ILLINOIS
DEPARTMENT OF TRANSPORTATION**

**STAGE I DETAILS
SN 041-0048**

SCALE: SHEET 15 OF 16 SHEETS STA. TO STA.

F.A.P. RTE.	SECTION	COUNTY	TOTAL SHEETS	SHEET NO.
849	D9 BRIDGE OVERLAY 2023-10	JEFFERSON	16	15
CONTRACT NO. 78A10				
ILLINOIS FED. AID PROJECT				

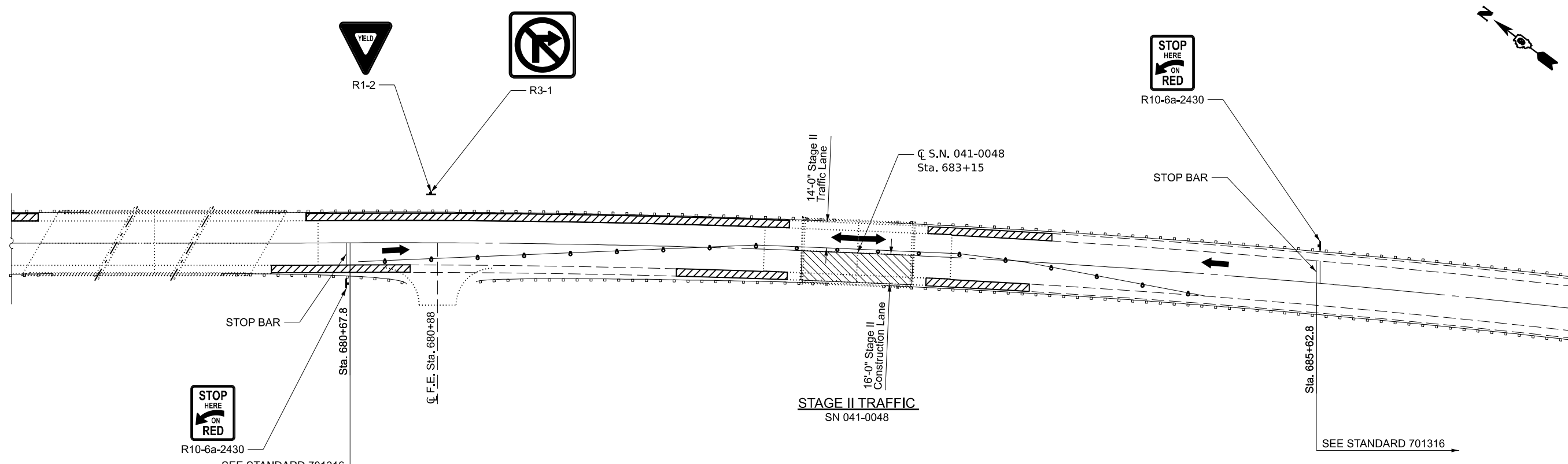
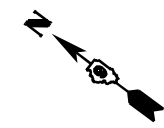

STOP HERE ON RED
R10-6a-2430
SEE STANDARD 701316

STAGE II TRAFFIC
SN 041-0048

- Proposed PCC Base Course Widening 10" To Be Constructed Prior To Stage I.
- Proposed 3/8" Thin Polymer Overlay

MODEL: Stage II Details SN 041-0048 (Sheet)
FILE NAME: P:\Bids\2023\849\PROJECT\849\041-0048\Drawings\849-10-CAD\Drawings\849-10-Stage II Traffic Plan.dgn

USER NAME = david.a.wilson	DESIGNED -	REVISED -
DRAWN -	REVISED -	
PLOT SCALE = 0.16666633' / in.	CHECKED -	REVISED -
PLOT DATE = 2/28/2024	DATE -	REVISED -

**STATE OF ILLINOIS
DEPARTMENT OF TRANSPORTATION**

**STAGE II DETAILS
SN 041-0048**

SCALE: SHEET 16 OF 16 SHEETS STA. TO STA.

F.A.P. RTE.	SECTION	COUNTY	TOTAL SHEETS	SHEET NO.
849	D9 BRIDGE OVERLAY 2023-10	JEFFERSON	16	16
			CONTRACT NO. 78A10	
ILLINOIS FED. AID PROJECT				