

STATE OF ILLINOIS  
DEPARTMENT OF TRANSPORTATION

F.A.U. RTE.	SECTION	COUNTY	TOTAL SHEETS	SHEET NO.
* 9213/9128	28-RS-3, 28-RS-4	ST. CLAIR	13	1
		ILLINOIS	CONTRACT NO. 76T34	

FOR INDEX OF SHEETS, SEE SHEET NO. 2

PROPOSED  
HIGHWAY PLANS

FAU ROUTE 9213/9128  
(COLLINSVILLE RD/9TH ST/FAIRMONT AVE)  
SECTION 29-RS-3, 28-RS-4  
SMART RESURFACING, PATCHING  
ST. CLAIR COUNTY

C-98-095-23

D-98-051-23



LOCATION OF SECTION INDICATED THUS: -

2018 ADT = 2900 (ACTUAL)  
2024 ADT = 2950 (ESTIMATED)  
2044 ADT = 3100 (ESTIMATED)  
SU = 6.6% MU = 6.9%

END PROJECT  
EXCHANGE AVE  
STA: 468 + 68  
LAT: 38.633492  
LONG: -90.139616

BRIDGE OMISSION  
STA. 412 + 29 TO STA. 412 + 61

BEGIN PROJECT  
0.1 MILE WEST OF  
ROSE LAKE DR  
STA: 400 + 00  
LAT: 38.642064  
LONG: -90.119321

2018 ADT = 3600 (ACTUAL)  
2024 ADT = 3650 (ESTIMATED)  
2044 ADT = 3900 (ESTIMATED)  
SU = 6.9% MU = 9.7%

FUNCTIONAL CLASSIFICATION  
MINOR ARTERIAL

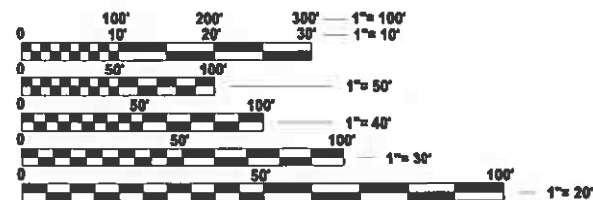

FULL SIZE PLANS HAVE BEEN PREPARED USING STANDARD ENGINEERING SCALES. REDUCED SIZED PLANS WILL NOT CONFORM TO STANDARD SCALES. IN MAKING MEASUREMENTS ON REDUCED PLANS, THE ABOVE SCALES MAY BE USED.

J.U.L.I.E.  
JOINT UTILITY LOCATION INFORMATION FOR EXCAVATION  
1-800-892-0123  
OR 811

PROJECT ENGINEER CHERYL KEPLAR  
PROJECT MANAGER EDISON ZOHFONYI

CONTRACT NO. 76T34

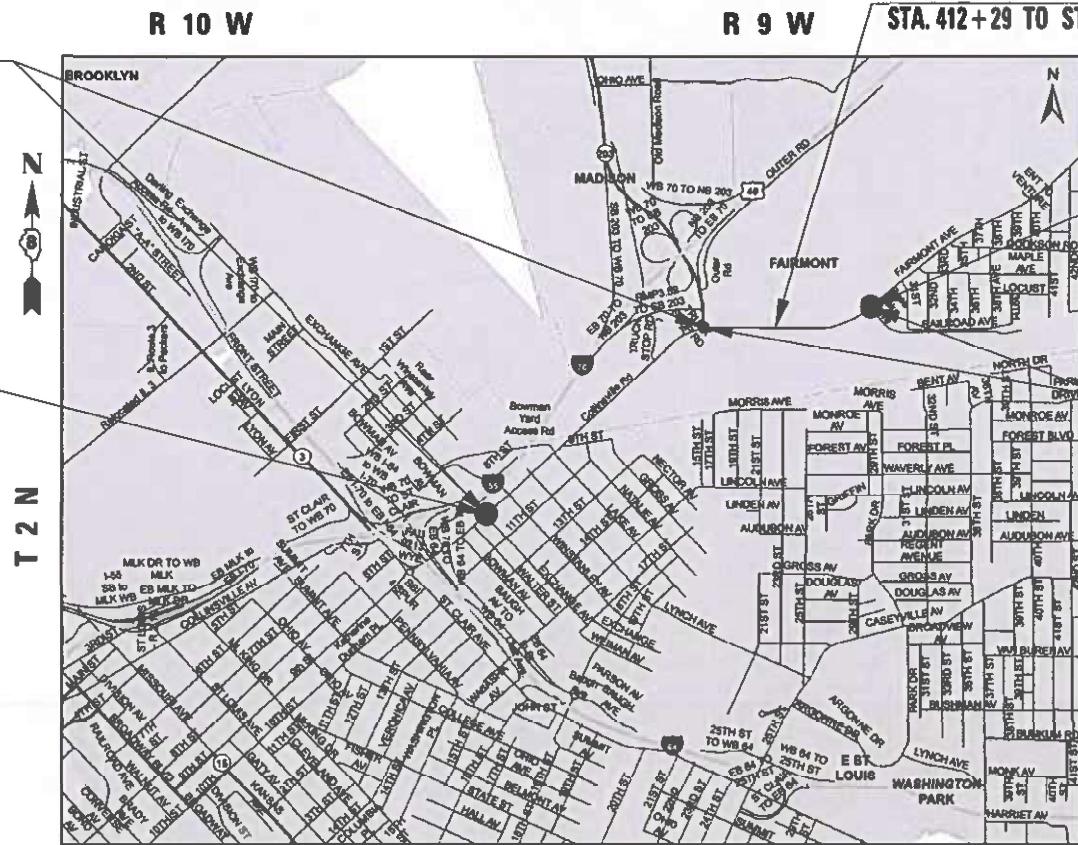

NOT TO SCALE

GROSS LENGTH = 6868 FT. = 1.31 MILE  
NET LENGTH = 6836 FT. = 1.295 MILE

STATE OF ILLINOIS  
DEPARTMENT OF TRANSPORTATION

SUBMITTED Jan 11 2024  
*[Signature]*  
REGIONAL ENGINEER

March 22, 2024  
*[Signature]*  
ENGINEER OF DESIGN AND ENVIRONMENT

March 22, 2024  
*[Signature]*  
DIRECTOR OF HIGHWAYS PROJECT IMPLEMENTATION

PRINTED BY THE AUTHORITY  
OF THE STATE OF ILLINOIS

## INDEX OF SHEETS

1	COVER SHEET
2	INDEX OF SHEETS, HIGHWAY STANDARDS, GENERAL NOTES, MIXTURE REQUIREMENT AND COMMITMENTS
3-5	SUMMARY OF QUANTITIES
6-9	TYPICAL SECTIONS
10-12	SCHEDULE OF QUANTITIES
13	LOCATION MAP

## HIGHWAY STANDARDS

000001-08  
001006  
420001-10  
420701-03  
442101-09  
701011-04  
701201-05  
701301-04  
701306-04  
701426-09  
701501-06  
701601-09  
701701-10  
701901-09  
780001-05  
781001-04

## GENERAL NOTES

- UTILITIES KNOWN TO HAVE FACILITIES WITHIN THE PROJECT AREA:  
AMEREN ILLINOIS  
AT&T ILLINOIS  
CHARTER COMMUNICATIONS, INC.  
ILLINOIS AMERICAN WATER COMPANY  
VERIZON BUSINESS  
METRO EAST SANETARY DISTRICT  
ZAYO GROUP LLC
- NO SURVEY WAS PERFORMED FOR THIS PROJECT AND THE PLANS WERE CREATED USING MICROFILM AND FIELD MEASUREMENTS.
- THE PROPOSED PAVEMENT MARKING SHALL MATCH THE LOCATIONS OF THE EXISTING PAVEMENT MARKING, AS DIRECTED BY THE ENGINEER.
- THREE CHANGEABLE MESSAGE SIGNS SHALL BE REQUIRED FOR THIS PROJECT. THEY SHALL BE PLACED TWO WEEKS PRIOR TO ANY LANE CLOSURE AND SHALL REMAIN UP FOR THE DURATION OF THE PROJECT. THE CHANGEABLE MESSAGE SIGNS SHALL BE PLACED ALONG COLLINSVILLE RD/9TH AND IL 203 OR AT THE DIRECTION OF THE ENGINEER.
- THE DEPARTMENT STRONGLY ENCOURAGES THE PRIME CONTRACTOR AND THEIR APPROVED SUB-CONTRACTORS TO HIRE MINORITY, WOMEN AND DISADVANTAGED INDIVIDUALS FROM ITS FEDERALLY FUNDED HIGHWAY CONSTRUCTION CAREERS TRAINING PROGRAM (HCCTP) TO HELP MEET WORKFORCE AND TRAINEE GOALS. THIS PROGRAM IS TRAINING MINORITIES, WOMEN AND DISADVANTAGED INDIVIDUALS IN HIGHWAY CONSTRUCTION-RELATED SKILLS, E.G., MATH FOR THE TRADES, JOB READINESS, TECHNICAL SKILLS COURSEWORK (CARPENTRY, CONCRETE FLATWORK, BLUEPRINT READING, SITE PLANS, SITE WORK, TOOLS USE, ETC.) AND OSHA 10 HOUR CERTIFICATION TO PREPARE THEM FOR A CAREER IN THE HIGHWAY CONSTRUCTION TRADES. GRADUATES ARE WELL-TRAINED AND READY TO BECOME PRODUCTIVE ENTRY-LEVEL CONSTRUCTION WORKERS. CONTACT THE DISTRICT 8 EEO OFFICE AT 618-346-3360 AND/OR THE HCCTP COORDINATOR AT 618-874-6528 TO LEARN MORE ABOUT THE PROGRAM AND FOR ASSISTANCE IN MEETING WORKFORCE AND TRAINEE GOALS.
- ONLY SHORT TERM PAVEMENT MARKING REMOVAL FROM THE FINAL SURFACE SHALL BE PAID FOR AS "SHORT TERM PAVEMENT MARKING REMOVAL."
- THE CONTRACTOR SHALL BE AWARE THAT THE EXISTING CONCRETE PATCHES WILL BE MILLED ALONG WITH HMA SURFACE. NO ADDITIONAL PAYMENT WILL BE ALLOWED. COST TO BE INCLUDED IN HMA SURFACE REMOVAL, 1 1/2"
- THE TEMPORARY RAMPS USED ON ALL SIDE STREETS AND ENTRANCES SHALL BE 3 FEET IN LENGTH SO AS NOT TO INTERFERE WITH THE THRU TRAFFIC LANES.
- BASED ON STRUCTURAL ANALYSIS CONDUCTED BY IDOT, THE FOLLOWING STRUCTURES CAN BE CROSSED WITH AN EMPTY MTD WITH THW FOLLOWING MAXIMUM GROSS WEIGHT RESTRICTION:
  - 082-2562 (40 TONS)
  - 082-2563 (40 TONS)

DUE TO THE CURRENT LEGAL LOAD RESTRICTION, AN EMPTIED MTD WILL NOT BE ALLOWED OVER THE FOLLOWING STRUCTURE:

  - 082-0031

THE CONTRACTOR WILL HAVE TO WORK FROM ONE SIDE OF THE STRUCTURE ONLY AND THEN HAUL THE MTD AROUND TO THE OTHER SIDE.

## COMMITMENTS

NONE

## MIXTURE REQUIREMENTS

MIXTURE REQUIREMENTS		
	SHOULDER > 8 FT	
MIXTURE USE	SURFACE	SHOULDER (surface)
AC/PG	PG 64-22	PG 64-22
DESIGN AIR VOIDS	4.0% @ Ndes=70	4.0% @ Ndes=30
MIX COMPOSITION (GRADATION)	IL 9.5	IL 9.5L
FRICTION AGG	MIXTURE "C"	
QUALITY MGMT PROGRAM	QCP	QC/QA
MatTranDev Required?	yes	no

STATE OF ILLINOIS  
DEPARTMENT OF TRANSPORTATION

INDEX OF SHEETS, HIGHWAY STANDARDS, GENERAL NOTES  
MIXTURE REQUIREMENTS AND COMMITMENTS

SCALE: SHEET 1 OF 1 SHEETS STA. TO STA.

F.A.U. RTE.	SECTION	COUNTY	TOTAL SHEETS	SHEET NO.
*	29-RS-3, 28-RS-4	ST. CLAIR	13	2
* 9213/9128		CONTRACT NO. 76T34		
ILLINOIS   FED. AID PROJECT				

REV. - MS

				CONSTR. CODE	
				100% STATE	
CODE NO.	ITEM	UNIT	TOTAL QUANTITY	ROADWAY	
				0005	URBAN
40600290	BITUMINOUS MATERIALS (TACK COAT)	POUND	16108	16108	
40600370	LONGITUDINAL JOINT SEALANT	FOOT	18968	18968	
40600990	TEMPORARY RAMP	SQ YD	632	632	
40604052	HOT-MIX ASPHALT SURFACE COURSE, IL-9.5, MIX "C", N70	TON	2747	2747	
44200050	WELDED WIRE REINFORCEMENT	SQ YD	1884	1884	
44000155	HOT-MIX ASPHALT SURFACE REMOVAL, 1 1/2"	SQ YD	35796	35796	
44201003	CLASS B PATCHES, TYPE I, 13 INCH	SQ YD	19	19	
44201007	CLASS B PATCHES, TYPE II, 13 INCH	SQ YD	278	278	
44201011	CLASS B PATCHES, TYPE III, 13 INCH	SQ YD	36	36	
44201013	CLASS B PATCHES, TYPE IV, 13 INCH	SQ YD	1849	1849	
44201299	DOWEL BARS 1 1/2"	EACH	819	819	
44213200	SAW CUTS	FOOT	2712	2712	
44213204	TIE BARS 3/4"	EACH	496	496	
48102100	AGGREGATE WEDGE SHOULDER, TYPE B	TON	278	278	

MODEL: SOQ-1 [Sheet]  
 FILE NAME: c:\p\work\pwr\illinois.gov\_edison.zohfanyi@illinois.gov\d0894755\ID876734-shr-SOQ.dgn

USER NAME = edison.zohfanyi	DESIGNED -	REVISED -
	DRAWN -	REVISED -
PLOT SCALE = 0.16666633' / in.	CHECKED -	REVISED -
PLOT DATE = 12/20/2023	DATE -	REVISED -

**STATE OF ILLINOIS  
DEPARTMENT OF TRANSPORTATION**

**SUMMARY OF QUANTITIES**

SCALE: SHEET 1 OF 3 SHEETS STA. TO STA.

F.A.U RTE.	SECTION	COUNTY	TOTAL SHEETS	SHEET NO.
*	29-RS-3, 28-RS-4	ST. CLAIR	13	3
* 9213/9128		CONTRACT NO. 76T34		
		ILLINOIS	FED. AID PROJECT	

MODEL: SOQ\_2 [Sheet]  
 FILE NAME: c:\pr\_work\pwr\illinois.gov\_edison.zohfanyi@illinois.gov\d0894755\876134-shl-SOQ.dgn

				CONSTR. CODE	
				100% STATE	
CODE NO.	ITEM	UNIT	TOTAL QUANTITY	ROADWAY	
				0005	URBAN
48203100	HOT-MIX ASPHALT SHOULDERS	TON	260	260	
67100100	MOBILIZATION	L SUM	1	1	
70100450	TRAFFIC CONTROL AND PROTECTION, STANDARD 701201	L SUM	1	1	
70100460	TRAFFIC CONTROL AND PROTECTION, STANDARD 701306	L SUM	1	1	
70102620	TRAFFIC CONTROL AND PROTECTION, STANDARD 701501	L SUM	1	1	
70102630	TRAFFIC CONTROL AND PROTECTION, STANDARD 701601	L SUM	1	1	
70102635	TRAFFIC CONTROL AND PROTECTION, STANDARD 701701	L SUM	1	1	
70107025	CHANGEABLE MESSAGE SIGN	CAL DA	315	315	
70300100	SHORT TERM PAVEMENT MARKING	FOOT	2050	2050	
70300150	SHORT TERM PAVEMENT MARKING REMOVAL	SQ FT	342	342	
70300211	TEMPORARY PAVEMENT MARKING LETTERS AND SYMBOLS - PAINT	SQ FT	50	50	
70300221	TEMPORARY PAVEMENT MARKING - LINE 4" - PAINT	FOOT	39737	39737	
* 78000100	THERMOPLASTIC PAVEMENT MARKING - LETTERS AND SYMBOLS	SQ FT	50	50	
* 78000400	THERMOPLASTIC PAVEMENT MARKING - LINE 6"	FOOT	39737	39737	

\* SPECIALTY ITEM

REV. - MS

USER NAME = edison.zohfanyi	DESIGNED -	REVISED -
	DRAWN -	REVISED -
PLOT SCALE = 0.16666633 / in.	CHECKED -	REVISED -
PLOT DATE = 1/11/2024	DATE -	REVISED -

**STATE OF ILLINOIS  
 DEPARTMENT OF TRANSPORTATION**

**SUMMARY OF QUANTITIES**

SCALE: SHEET 2 OF 3 SHEETS STA. TO STA.

FAU RTE.	SECTION	COUNTY	TOTAL SHEETS	SHEET NO.
*	29-RS-3, 28-RS-4	ST. CLAIR	13	4
* 9213/9128		CONTRACT NO. 76T34		
ILLINOIS   FED. AID PROJECT				

MODEL: SOQ-3 (Sheet)  
FILE NAME: c:\p\work\project\illinois.gov\_edison.zohfanyi@illinois.gov\d0894755ID876734-shr-SOQ.dgn

				CONSTR. CODE
				100% STATE
CODE NO.	ITEM	UNIT	TOTAL QUANTITY	ROADWAY
				0005
				URBAN
* 78100100	RAISED REFLECTIVE PAVEMENT MARKER	EACH	235	235
78300200	RAISED REFLECTIVE PAVEMENT MARKER REMOVAL	EACH	235	235
78300202	PAVEMENT MARKING REMOVAL - WATER BLASTING	SQ FT	13298	13298
Z0034105	MATERIAL TRANSFER DEVICE	TON	2747	2747
Ø Z0076604	TRAINEES TRAINING PROGRAM GRADUATE	HOUR	1000	1000

\* SPECIALTY ITEM  
Ø 0042

REV. - MS

USER NAME = edison.zohfanyi	DESIGNED -	REVISED -	<b>STATE OF ILLINOIS DEPARTMENT OF TRANSPORTATION</b>	<b>SUMMARY OF QUANTITIES</b>				F.A.U RTE.	SECTION	COUNTY	TOTAL SHEETS	SHEET NO.
	DRAWN -	REVISED -						*	29-RS-3, 28-RS-4	ST. CLAIR	13	5
PLOT SCALE = 0.16666833' / in.	CHECKED -	REVISED -			SCALE:	SHEET 3	OF 3	SHEETS	STA.	TO STA.	CONTRACT NO. 76T34	
PLOT DATE = 12/13/2023	DATE -	REVISED -			ILLINOIS FED. AID PROJECT							

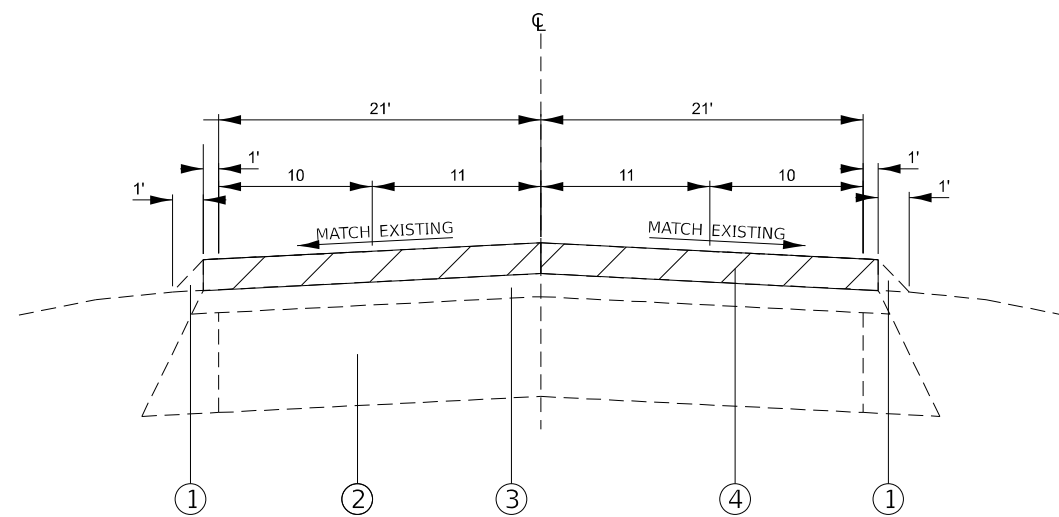

**EXISTING TYPICAL SECTION**

STA. 400+00 TO STA. 415+83

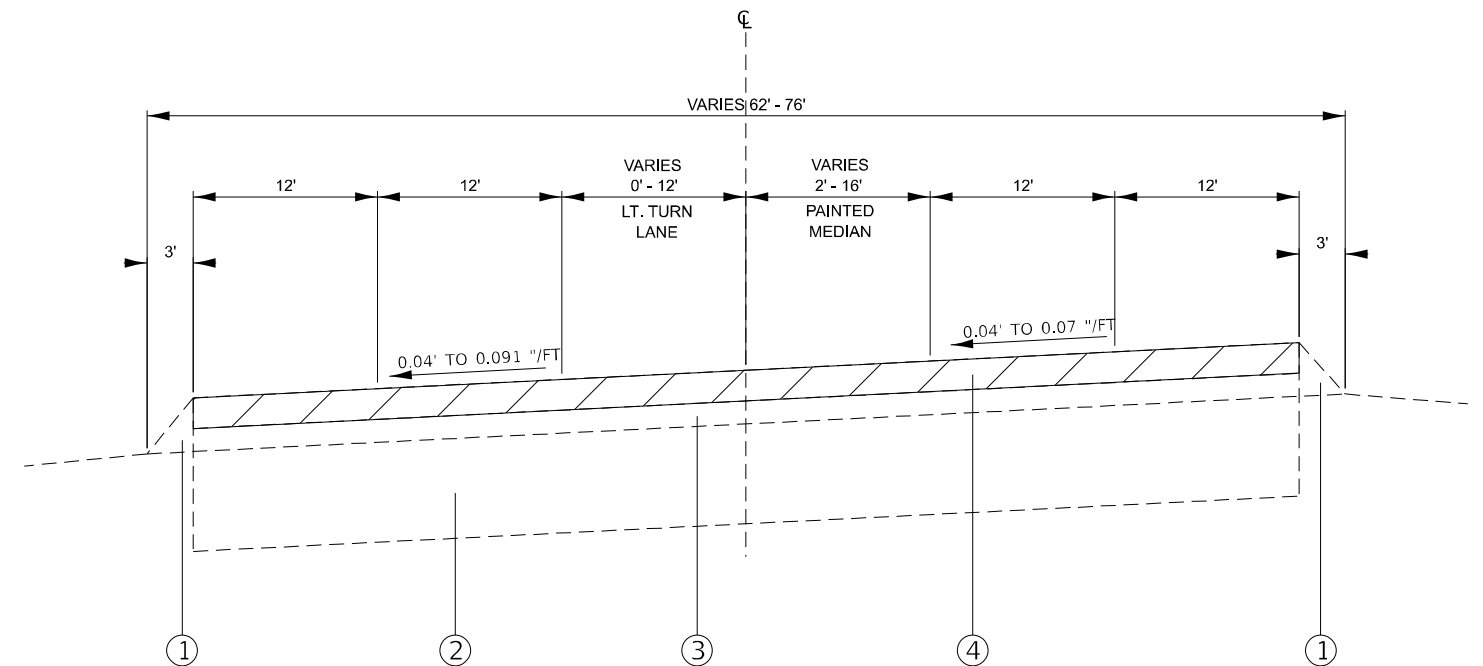

**EXISTING TYPICAL SECTION**

STA. 415+83 TO STA. 428+38  
(SUPERELEVATION)

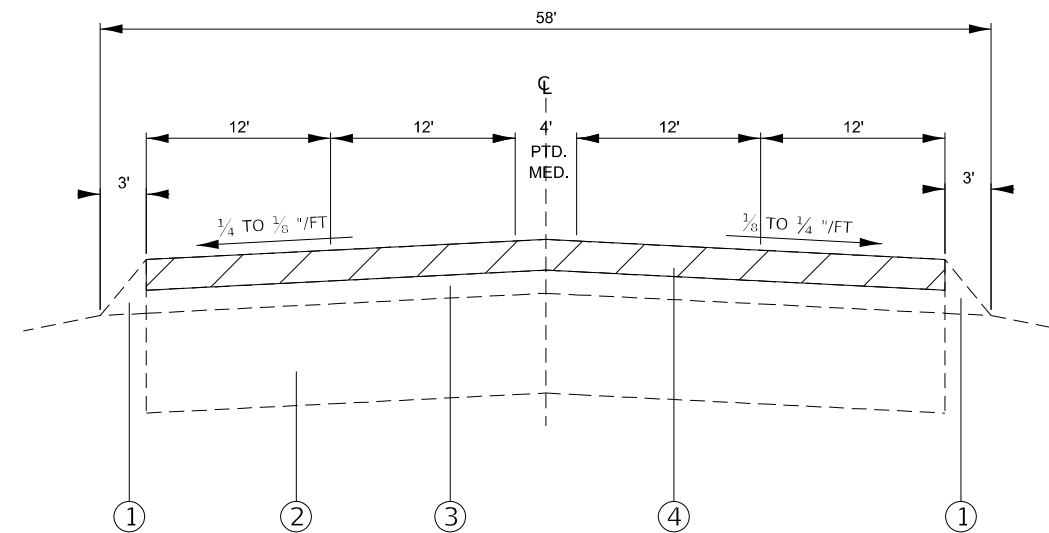

**EXISTING TYPICAL SECTION**

STA. 428+38 TO STA. 435+78

**LEGEND**

- ① EXISTING AGGREGATE SHOULDER
- ② EXISTING CONCRETE PAVEMENT - 13"
- ③ EXISTING HOT-MIX ASPHALT OVERLAY
- ④ EXISTING HOT-MIX ASPHALT SURFACE REMOVAL - 1 1/2"
- ⑤ EXISTING CONCRETE CURB
- ⑥ EXISTING SIDEWALK
- ⑦ PROPOSED BITUMINOUS MATERIAL (TACK COAT)
- ⑧ PROPOSED LONGITUDINAL JOINT SEALANT
- ⑨ PROPOSED HOT-MIX ASPHALT SURFACE COURSE - 1 1/2"
- ⑩ PROPOSED AGGREGATE WEDGE SHOULDER, TYPE B
- ⑪ PROPOSED HOT-MIX ASPHALT SHOULDERS - 1 1/2"

MODEL: existing typical section-1 (Sheet)  
FILE NAME: c:\p\work\pwrtd\illinois.gov\_edison.zohfanyi@illinois.gov\0894758\0876734-shs\typical.dgn

USER NAME = edison.zohfanyi	DESIGNED -	REVISED -
	DRAWN -	REVISED -
PLOT SCALE = 0.16666633' / in.	CHECKED -	REVISED -
PLOT DATE = 12/12/2023	DATE -	REVISED -

**STATE OF ILLINOIS  
DEPARTMENT OF TRANSPORTATION**

**TYPICAL SECTIONS**

SCALE: SHEET 1 OF 4 SHEETS STA. TO STA.

F.A.U. RTE.	SECTION	COUNTY	TOTAL SHEETS	SHEET NO.
*	29-RS-3, 28-RS-4	ST. CLAIR	13	6
* 9213/9128		CONTRACT NO. 76T34		
		ILLINOIS FED. AID PROJECT		

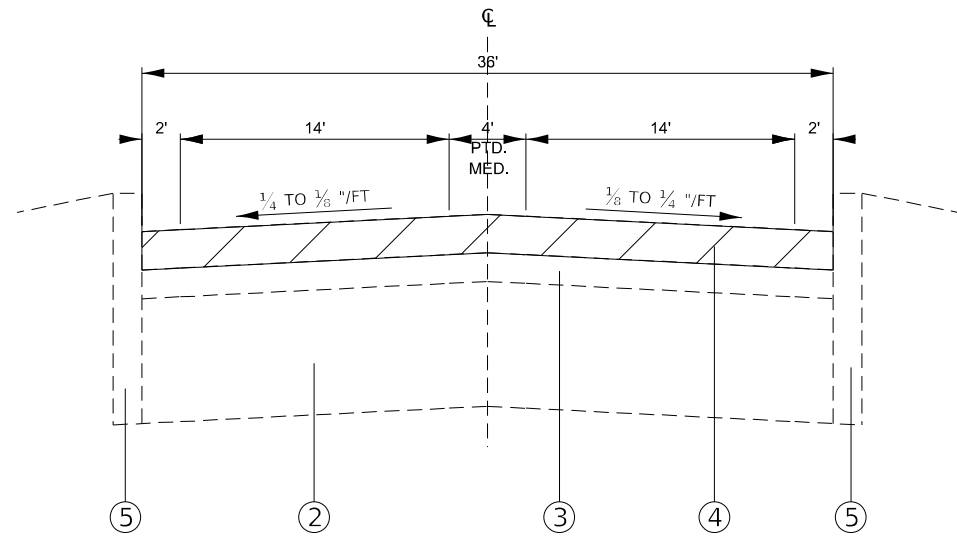

**EXISTING TYPICAL SECTION**

STA. 435+78 TO STA. 446+62  
STA. 450.12 TO STA. 454+78

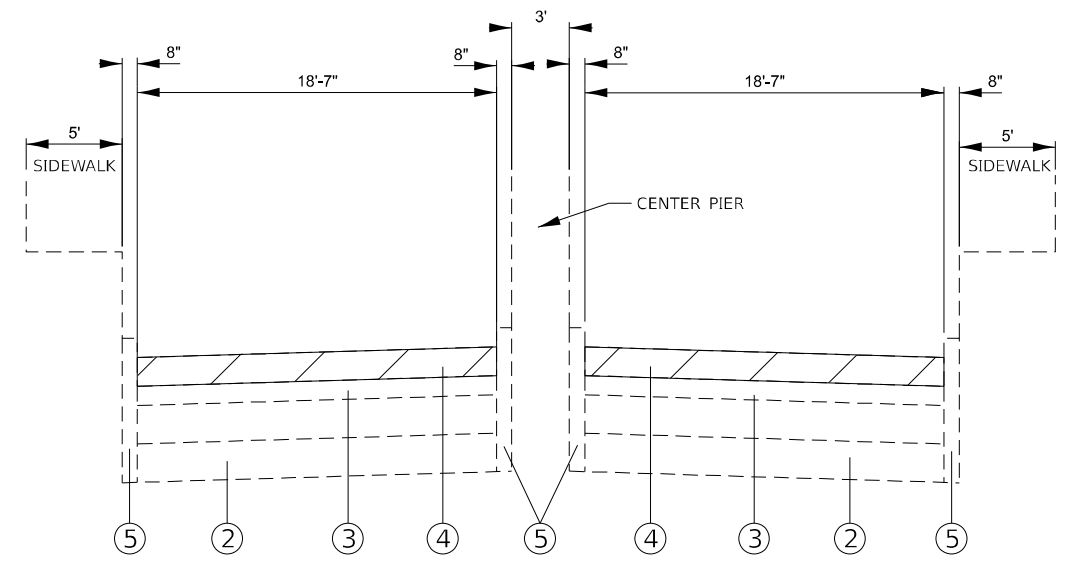

**EXISTING TYPICAL SECTION**

STA. 446+62 TO STA. 450+12

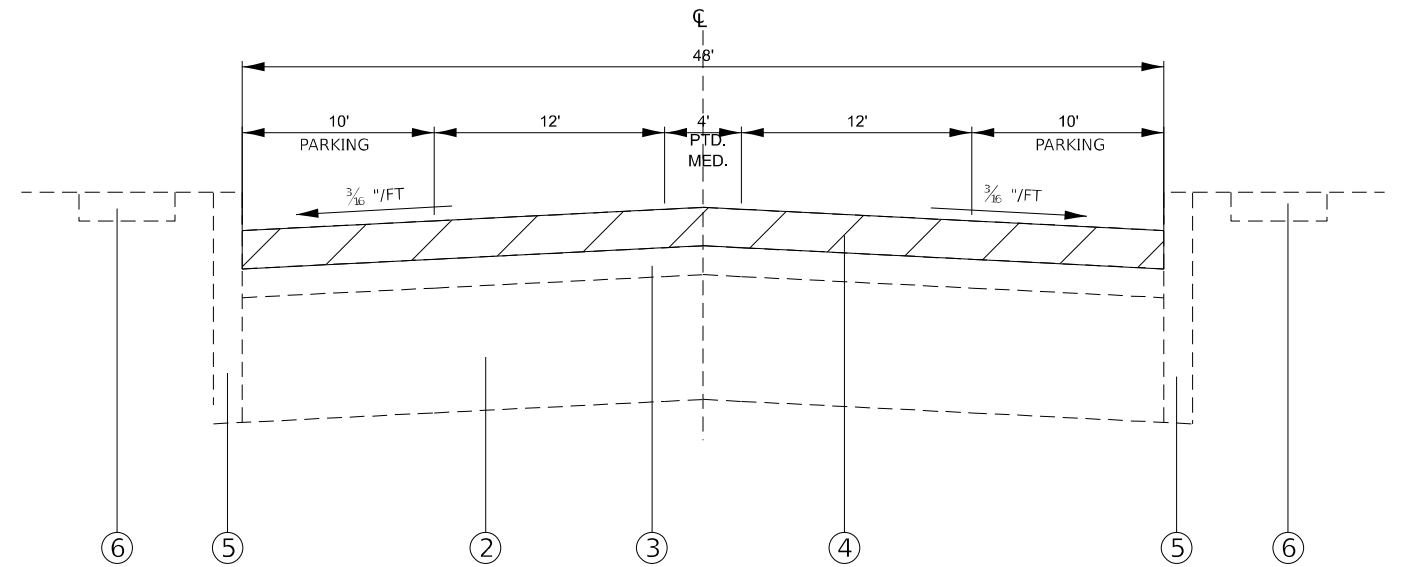

**EXISTING TYPICAL SECTION**

STA. 454+78 TO STA. 468+68

**LEGEND**

- ① EXISTING AGGREGATE SHOULDER
- ② EXISTING CONCRETE PAVEMENT - 13"
- ③ EXISTING HOT-MIX ASPHALT OVERLAY
- ④ EXISTING HOT-MIX ASPHALT SURFACE REMOVAL - 1 1/2"
- ⑤ EXISTING CONCRETE CURB
- ⑥ EXISTING SIDEWALK
- ⑦ PROPOSED BITUMINOUS MATERIAL (TACK COAT)
- ⑧ PROPOSED LONGITUDINAL JOINT SEALANT
- ⑨ PROPOSED HOT-MIX ASPHALT SURFACE COURSE - 1 1/2"
- ⑩ PROPOSED AGGREGATE WEDGE SHOULDER, TYPE B
- ⑪ PROPOSED HOT-MIX ASPHALT SHOULDERS - 1 1/2"

MODEL: existing typical section-2 (Sheet)  
FILE NAME: c:\p\work\pav\illinois.gov\edison.zohfanyi\551D8761734-shs\typical.dgn

USER NAME = edison.zohfanyi	DESIGNED -	REVISED -
	DRAWN -	REVISED -
PLOT SCALE = 0.16666633' / in.	CHECKED -	REVISED -
PLOT DATE = 12/12/2023	DATE -	REVISED -

**STATE OF ILLINOIS  
DEPARTMENT OF TRANSPORTATION**

**TYPICAL SECTIONS**

SCALE: SHEET 2 OF 4 SHEETS STA. TO STA.

F.A.U. RTE.	SECTION	COUNTY	TOTAL SHEETS	SHEET NO.
*	29-RS-3, 28-RS-4	ST. CLAIR	13	7
* 9213/9128		CONTRACT NO. 76T34		
ILLINOIS		FED. AID PROJECT		

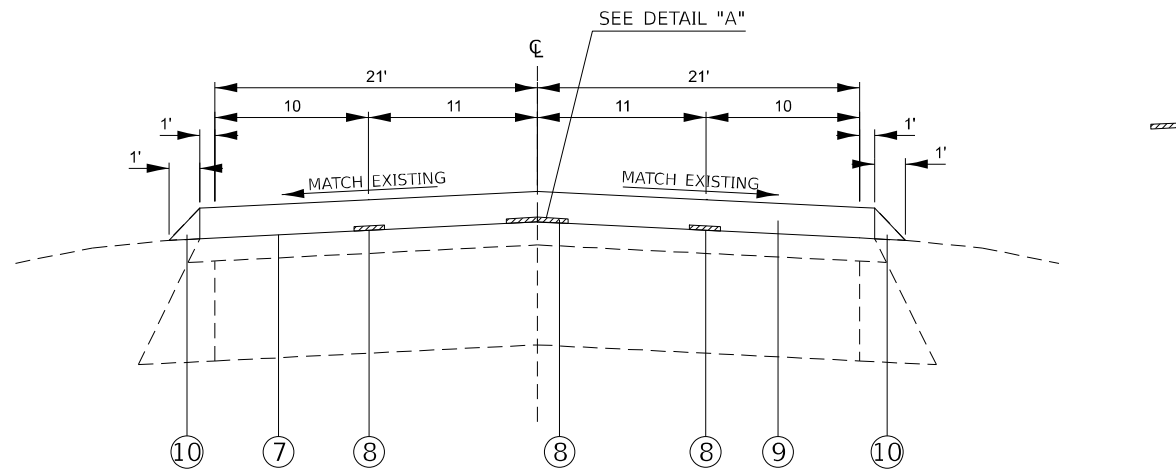

**PROPOSED TYPICAL SECTION**  
 STA. 400+00 TO STA. 415+83  
 BRIDGE OMMISION STA. 412+29 TO STA. 412+61

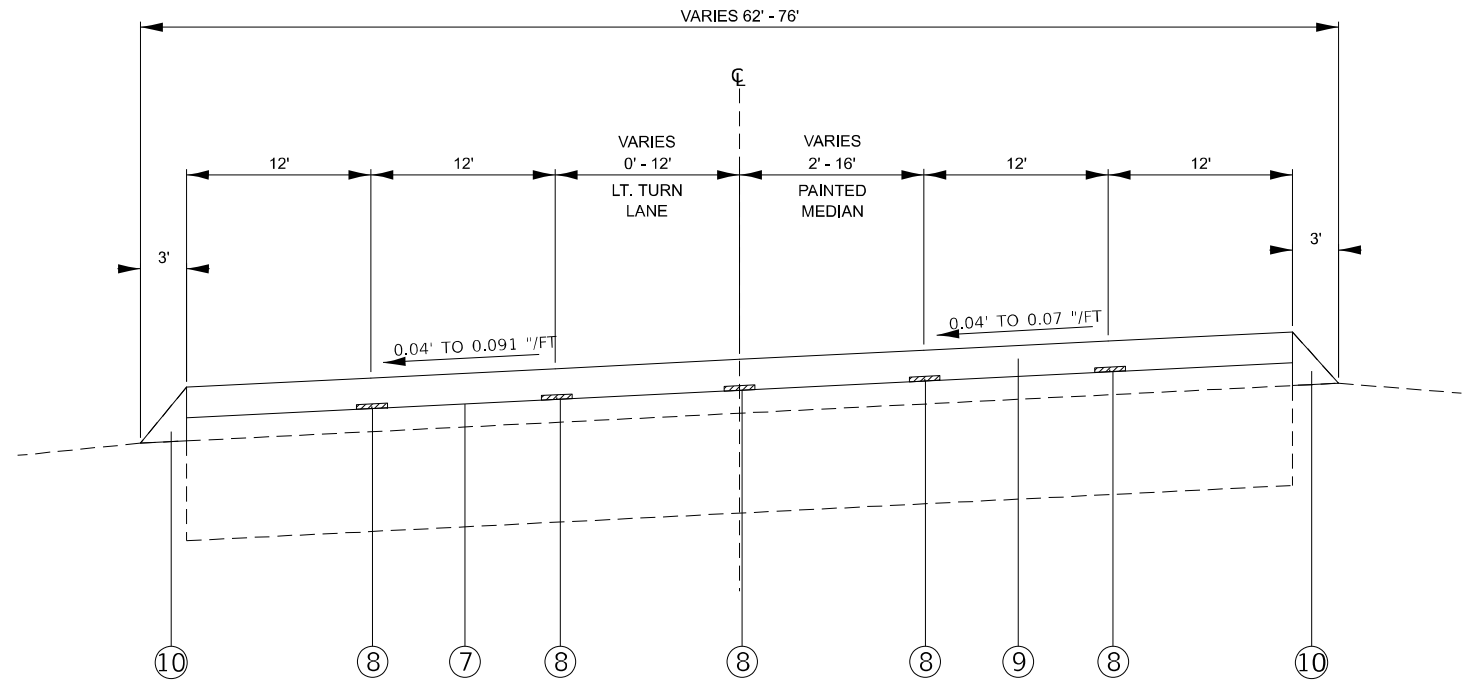

**PROPOSED TYPICAL SECTION**  
 STA. 415+83 TO STA. 428+38  
 (SUPERELEVATION)

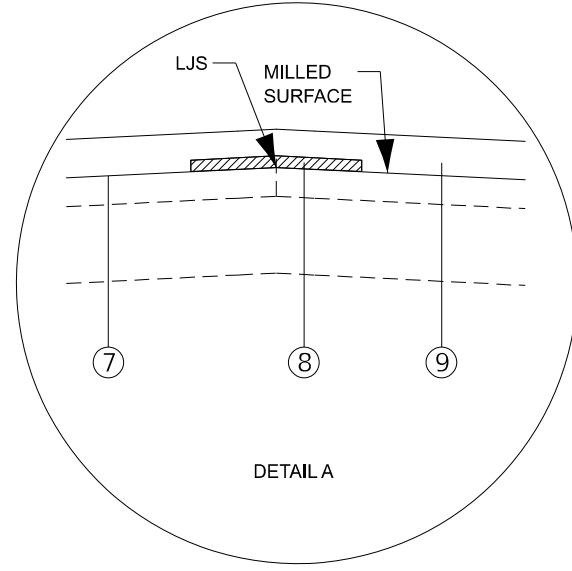

**\*\*DETAIL "A" SHALL BE APPLIED  
 ALONG ALL LANE LINES OF PAVEMENT**

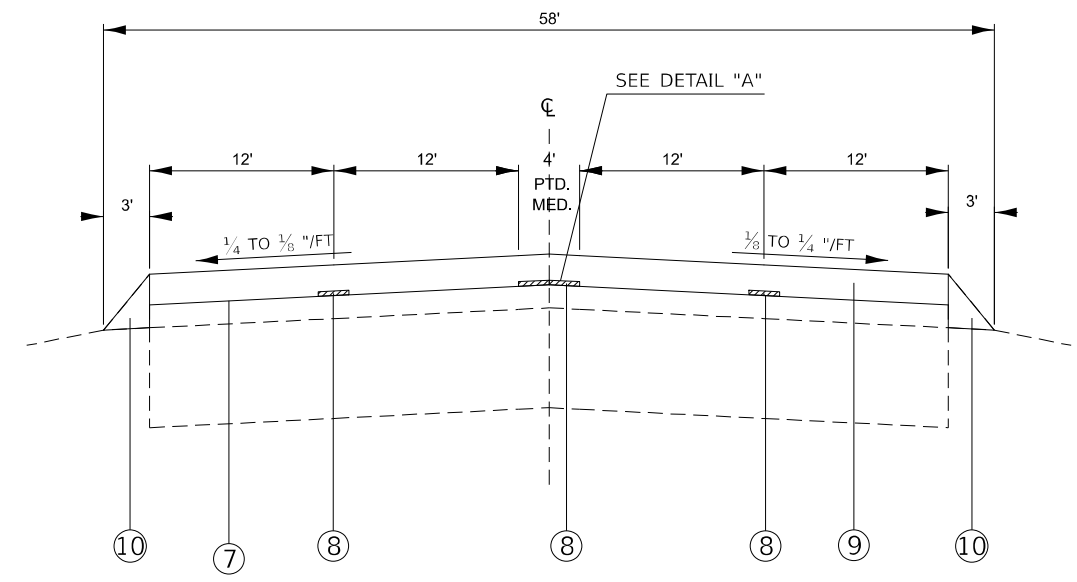

**PROPOSED TYPICAL SECTION**  
 STA. 428+38 TO STA. 435+78

**LEGEND**

- ① EXISTING AGGREGATE SHOULDER
- ② EXISTING CONCRETE PAVEMENT - 13"
- ③ EXISTING HOT-MIX ASPHALT OVERLAY
- ④ EXISTING HOT-MIX ASPHALT SURFACE REMOVAL - 1 1/2"
- ⑤ EXISTING CONCRETE CURB
- ⑥ EXISTING SIDEWALK
- ⑦ PROPOSED BITUMINOUS MATERIAL (TACK COAT)
- ⑧ PROPOSED LONGITUDINAL JOINT SEALANT
- ⑨ PROPOSED HOT-MIX ASPHALT SURFACE COURSE - 1 1/2"
- ⑩ PROPOSED AGGREGATE WEDGE SHOULDER, TYPE B
- ⑪ PROPOSED HOT-MIX ASPHALT SHOULDERS - 1 1/2"

MODEL: proposed typical section-1 (Sheet)  
 FILE NAME: c:\p\work\pav\illinois.gov\edison.zohfanyi\5581D8761734-shs\typical.dgn

USER NAME = edison.zohfanyi	DESIGNED -	REVISED -
PLOT SCALE = 0.16666633' / in.	DRAWN -	REVISED -
PLOT DATE = 1/11/2024	CHECKED -	REVISED -
	DATE -	REVISED -

**STATE OF ILLINOIS  
 DEPARTMENT OF TRANSPORTATION**

**TYPICAL SECTIONS**

SCALE: SHEET 3 OF 4 SHEETS STA. TO STA.

F.A.U. RTE.	SECTION	COUNTY	TOTAL SHEETS	SHEET NO.
*	29-RS-3, 28-RS-4	ST. CLAIR	13	8
* 9213/9128		CONTRACT NO. 76T34		
ILLINOIS		FED. AID PROJECT		



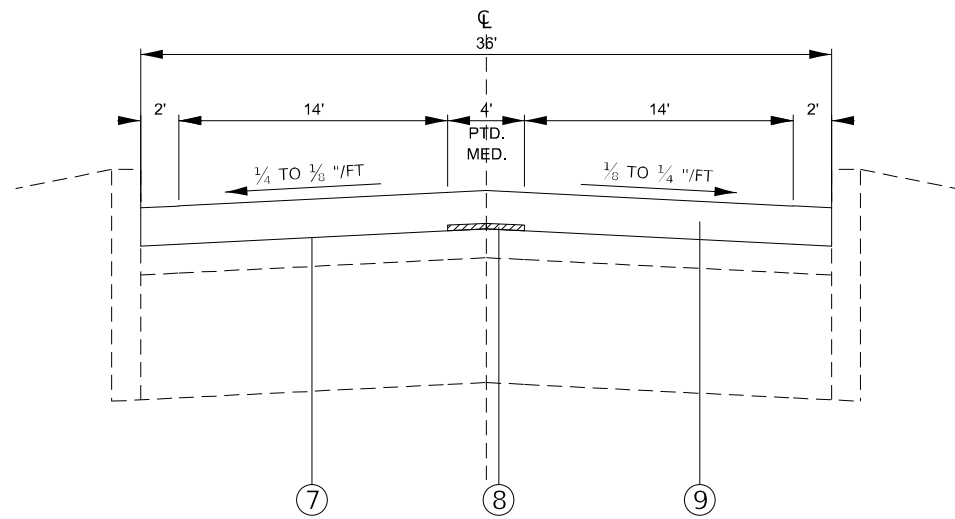

**PROPOSED TYPICAL SECTION**

STA. 435+78 TO STA. 446+62  
 STA. 447+96 TO STA. 448+96  
 STA. 450+12 TO STA. 454+78

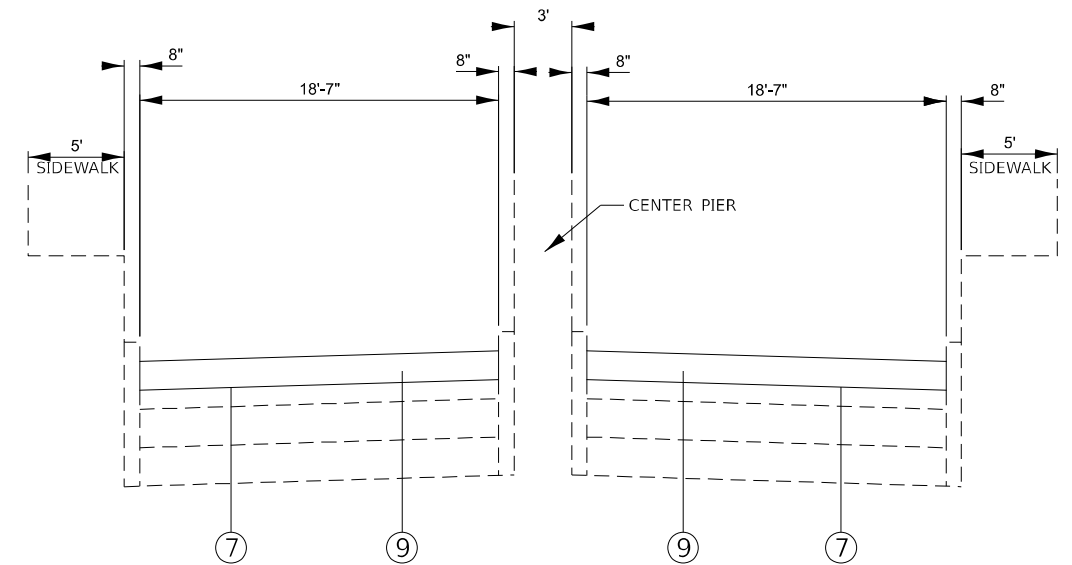

**PROPOSED TYPICAL SECTION**

STA. 446+62 TO STA. 447+96  
 STA. 448+96 TO STA. 450+12

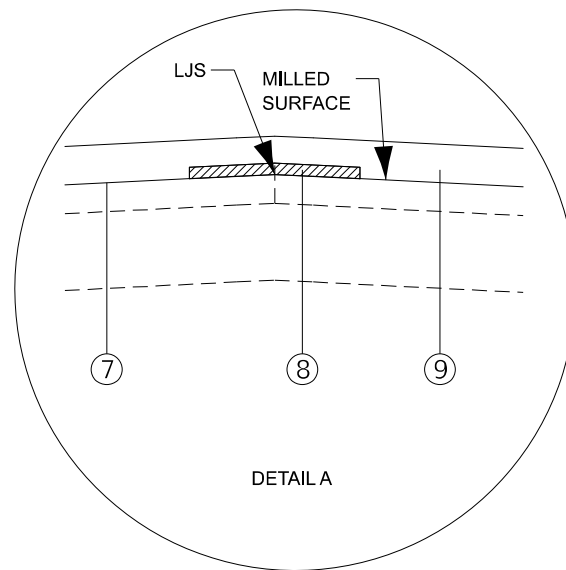

DETAIL A

\*\*DETAIL "A" SHALL BE APPLIED  
 ALONG ALL LANE LINES OF PAVEMENT

**LEGEND**

- ① EXISTING AGGREGATE SHOULDER
- ② EXISTING CONCRETE PAVEMENT - 13"
- ③ EXISTING HOT-MIX ASPHALT OVERLAY
- ④ EXISTING HOT-MIX ASPHALT SURFACE REMOVAL - 1½"
- ⑤ EXISTING CONCRETE CURB
- ⑥ EXISTING SIDEWALK
- ⑦ PROPOSED BITUMINOUS MATERIAL (TACK COAT)
- ⑧ PROPOSED LONGITUDINAL JOINT SEALANT
- ⑨ PROPOSED HOT-MIX ASPHALT SURFACE COURSE - 1½"
- ⑩ PROPOSED AGGREGATE WEDGE SHOULDER, TYPE B
- ⑪ PROPOSED HOT-MIX ASPHALT SHOULDERS - 1½"

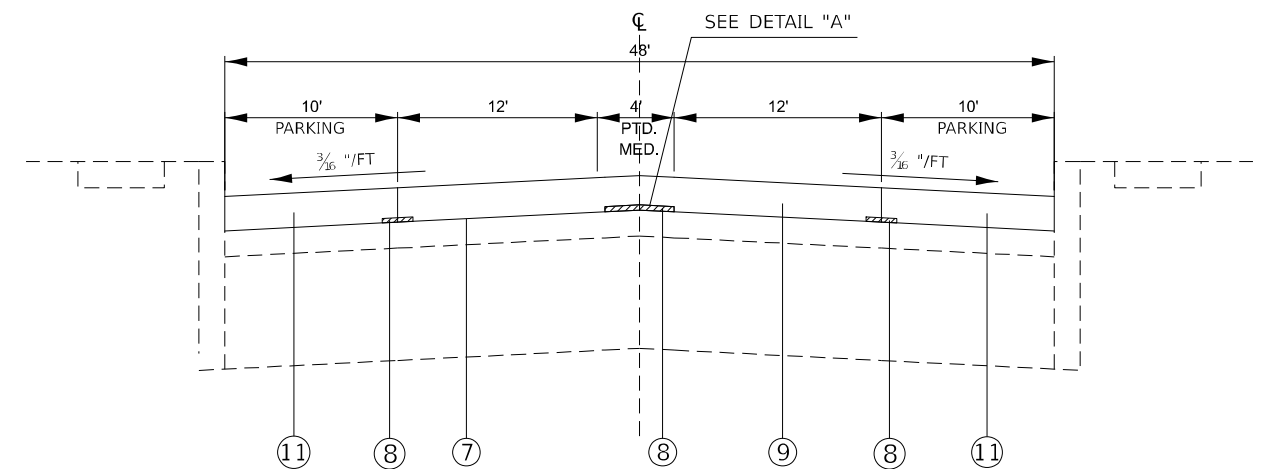

**PROPOSED TYPICAL SECTION**

STA. 454+78 TO STA. 468+68

MODEL: proposed typical section-2 (Sheet)  
 FILE NAME: c:\p\work\pav\illinois.gov\edison.zohfanyi\551D876734-shs\typical.dgn

USER NAME = edison.zohfanyi	DESIGNED -	REVISED -
	DRAWN -	REVISED -
PLOT SCALE = 0.16666633' / in.	CHECKED -	REVISED -
PLOT DATE = 1/11/2024	DATE -	REVISED -

**STATE OF ILLINOIS  
 DEPARTMENT OF TRANSPORTATION**

**TYPICAL SECTIONS**

SCALE: SHEET 4 OF 4 SHEETS STA. TO STA.

F.A.U. RTE.	SECTION	COUNTY	TOTAL SHEETS	SHEET NO.
*	29-RS-3, 28-RS-4	ST. CLAIR	13	9
* 9213/9128		CONTRACT NO. 76T34		
ILLINOIS FED. AID PROJECT				

## RESURFACING SCHEDULE

STATION		DIMENSION		HMA SURFACE REMOVAL 1 1/2"	LONGITUDINAL JOINT SEALANT	BITUMINOUS MATERIALS (TACK COAT)	HMA SURFACE COURSE IL-9.5 "MIX C" N70	MATERIAL TRANSFER DEVICE
		LENGTH	WIDTH					
FROM	TO	FEET	FEET	SQ YD	FEET	POUND	TON	TON
400+00.00	412+29.00	1229.00	44	6008.44	3687.00	2703.8	504.71	504.71
412+29.00	412+61.00	BRIDGE OMISSION - SN 082-0031						
412+61.00	415+83.00	322.00	44	1574.22	966.00	708.4	132.23	132.23
415+83.00	428+38.00	1255.00	64	8924.44	6275.00	4016	749.65	749.65
428+38.00	435+78.00	740.00	52	4275.56	2220.00	1924	359.15	359.15
435+78.00	446+62.00	1084.00	36	4336	1084.00	1951.2	364.22	364.22
446+62.00	447+96.00	134.00	36	536	CENTER PIER OMISSION	241.2	45.02	45.02
447+96.00	448+96.00	100.00	36	400	100.00	180	33.6	33.6
448+96.00	450+12.00	116.00	36	464	CENTER PIER OMISSION	208.8	38.98	38.98
450+12.00	454+78.00	466.00	36	1864	466.00	838.8	156.58	156.58
454+78.00	468+68.00	1390.00	28	4324.44	4170.00	1946	363.25	363.25
TOTAL				32707	18968.00	14718	2747.40	2747.40

## PAVEMENT MARKING SCHEDULE

LOCATION		THERMOPLASTIC AND TEMPORARY PAVEMENT MARKING					PAVEMENT MARKING REMOVAL - WATER BLASTING	SHORT TERM PAVEMENT MARKING	SHORT TERM PAVEMENT MARKING REMOVAL	RAISED REFLECTIVE PAVEMENT MARKER		RAISED REFLECTIVE PAVEMENT MARKER REMOVAL
STATION		LINE - 6" THERMOPLASTIC / LINE - 4" TEMPORARY				LETTERS AND SYMBOLS				SQ FT	SQ FT	
FROM	TO	WHITE SOLID	WHITE SKIP-DASH	DOUBLE YELLOW SOLID	YELLOW PAINTED MEDIAN		FEET	FEET	FEET			FEET
		FEET	FEET	FEET	FEET	SQ FT	SQ FT	FEET	SQ FT	EACH	EACH	EACH
400+00.00	412+29.00	2458	620	2458			1846	360	60	30	15	45
412+29.00	412+61.00	BRIDGE OMISSION - SN 082-0031										
412+61.00	415+83.00	644	180	644			490	90	15	8	4	12
415+83.00	421+54.00	1142	300		2284		1242	300	50	14	14	28
421+54.00	422+84.00	168	80				83	100	17	4	4	8
422+84.00	428+43.00	1633	280		2236	50	1433	180	30	14	14	28
428+43.00	434+43.00	1200	300		2400		1300	120	20	8	16	24
434+43.00	437+26.00	566	160		1132		620	30	5	4	8	12
437+26.00	468+68.00	6284			12568		6284	870	145		78	78
TOTAL		14095	1920	3102	20620	50	13298	2050	342	82	153	235

MODEL: schedule of quantities-1 [Sheet]  
 FILE NAME: c:\p\work\pav\illinois.gov\edison.zohfanyi\551D876734-shs-schedule.dgn

USER NAME = edison.zohfanyi	DESIGNED -	REVISED -
	DRAWN -	REVISED -
PLOT SCALE = 0.16666633' / in.	CHECKED -	REVISED -
PLOT DATE = 1/11/2024	DATE -	REVISED -

**STATE OF ILLINOIS  
DEPARTMENT OF TRANSPORTATION**

### SCHEDULE OF QUANTITIES

SCALE: SHEET 1 OF 3 SHEETS STA. TO STA.

F.A.U RTE.	SECTION	COUNTY	TOTAL SHEETS	SHEET NO.
*	29-RS-3, 28-RS-4	ST. CLAIR	13	10
*9213/9128		CONTRACT NO. 76T34		
		ILLINOIS FED. AID PROJECT		

## TEMPORARY RAMP SCHEDULE

CL OF ENTRANCE OR SIDEROAD	LOCATION	LENGTH	WIDTH	TEMPORARY RAMP	REMARKS
		FEET	FEET	SQ YD	
400+00.00		5	44	25	BEGIN PROJECT
412+29.00		3	42	14	BRIDGE
412+61.00		3	42	14	BRIDGE
422+48.00	R	3	200	67	IL 203
425+94.00	R	3	50	17	
427+59.00	R	3	250	84	BP GAS STATION
429+06.00	R	3	50	17	
435+55.00	R	3	49	17	
442+02.00	R	3	119	40	RACEWAY BLVD
453+03.00	L	3	124	42	N 9TH STREET
454+55.00	R	3	107	36	N 7TH STREET
454+81.00	L	3	48	16	LAKE AVE
455+68.00	R	3	40	14	
456+46.00	R	3	40	14	
456+96.00	L	3	35	12	
457+20.00	R	3	32	11	
457+35.00	L	3	14	5	
458+86.00	R	3	52	18	
459+74.00	R	3	43	15	LYNCH ST
459+74.00	L	3	62	21	LYNCH ST
460+78.00	L	3	27	9	
461+72.00	R	3	13	5	
462+22.00	R	3	26	9	
462+22.00	L	3	22	8	
463+03.00	L	3	14	5	
464+31.00	L	3	12	4	
464+66.00	R	3	57	19	WINSTANLEY AVE
464+66.00	L	3	57	19	
467+10.00	R	3	30	10	
467+15.00	L	3	29	10	
468+30.00	R	3	22	8	
468+68.00		5	48	27	END PROJECT
TOTAL				632	

## HMA SHOULDER SCHEDULE

STATION		DIMENSION		HMA SURFACE REMOVAL 1 1/2"	BITUMINOUS MATERIALS (TACK COAT)	HMA SHOULDER COURSE IL 9.5L N30
		LENGTH	WIDTH			
FROM	TO	FEET	FEET	SQ YD	POUND	TON
454+78.00	468+68.00	1390.00	10	3088.89	1390	259.47
TOTAL				3089	1390.00	260

## AGGREGATE WEDGE SHOULDER, TYPE B

STATION		DEPTH	LENGTH	WIDTH	AGGREGATE WEDGE SHOULDER, TYPE B
FROM	TO	INCH	FEET	FEET	TON
400+00.00	415+83.00	2	1583	3	123.12
415+83.00	428+38.00	2	1255	3	97.61
428+38.00	435+78.00	2	740	3	57.56
TOTAL					278

MODEL: schedule of quantities-2 [Sheet]  
FILE NAME: c:\p\work\project\illinois.gov\_edison.zohfanyi@illinois.gov\0894755\0876734-sh-schedule.dgn

USER NAME = edison.zohfanyi	DESIGNED -	REVISED -
	DRAWN -	REVISED -
PLOT SCALE = 0.16666633' / in.	CHECKED -	REVISED -
PLOT DATE = 12/13/2023	DATE -	REVISED -

**STATE OF ILLINOIS  
DEPARTMENT OF TRANSPORTATION**

### SCHEDULE OF QUANTITIES

SCALE: SHEET 2 OF 3 SHEETS STA. TO STA.

F.A.U. RTE.	SECTION	COUNTY	TOTAL SHEETS	SHEET NO.
*	29-RS-3, 28-RS-4	ST. CLAIR	13	11
*9213/9128		CONTRACT NO. 76T34		
		ILLINOIS FED. AID PROJECT		

## PATCHING SCHEDULE

PATCH NO.	STATION	EB / WB	LENGTH	WIDTH	AREA	CLASS B PATCHES				WELDED WIRE REINFORCEMENT	DOWEL BARS 1 1/2"	TIE BARS 3/4"	SAW CUTS
						13 INCHES							
						TYPE I	TYPE II	TYPE III	TYPE IV				
FEET	FEET	SQ YD	SQ YD	SQ YD	SQ YD	SQ YD	SQ YD	SQ YD	EACH	EACH	FOOT		
1	405+32.00	WB PL	6	12	8		8				20		42
2	405+32.00	EB DL	6	12	8		8				20		42
3	415+88.00	WB DL	8	12	11		11				20		44
4	415+88.00	WB PL	8	12	11		11				20		44
5	415+88.00	WB LT	8	12	11		11				20		44
6	415+88.00	PTD. MED.	8	16	15			15		15	28		56
7	415+88.00	EB PL	8	12	11		11				20		44
8	415+88.00	EB DL	8	12	11		11				20		44
9	421+16.00	WB PL	25	12	34				34	34	20	12	61
10	421+16.00	EB DL	25	12	34				34	34	20	12	61
11	421+16.00	WB PL	8	12	11		11				20		44
12	426+35.00	WB DL	20	12	27				27	27	20	9	56
13	426+44.00	WB DL	8	12	11		11				20		44
14	426+44.00	WB PL	8	12	11		11				20		44
15	431+72.00	WB PL	6	12	8		8				20		42
16	433+04.00	WB DL	6	12	8		8				20		42
17	434+36.00	WB	12	12	16			16		16	20		48
18	437+00.00	WB	6	12	8		8				20		42
19	439+64.00	EB	8	12	11		11				20		44
20	442+28.00	WB	6	18	12		12				32		60
21	442+28.00	EB	6	18	12		12				32		60
22	446+62.00	WB	400	17	756				756	756	30	199	451
23	450+12.00	EB	400	17	756				756	756	30	199	451
24	451+25.60	EB	6	8	6		6				12		30
25	452+84.00	EB	6	6	4	4					8		24
26	452+84.00	EB	6	6	4	4					8		24
27	452+84.00	EB	6	8	6		6				12		30
28	452+84.00	EB	6	6	4	4					8		24
29	452+84.00	EB	6	6	4	4					8		24
30	458+12.00	WB	8	14	13		13				24		50
31	458+12.00	EB	8	14	13		13				24		50
32	463+40.00	WE	6	14	10		10				24		48
33	463+40.00	EB	6	14	10		10				24		48
34	466+04.00	WE	6	14	10		10				24		48
35	466+04.00	EB	6	14	10		10				24		48
SUBTOTAL						16	241	31	1607	1638	712	431	2358
15% ANTICIPATED FAILURES						3	37	5	242	246	107	65	354
TOTAL						19	278	36	1849	1884	819	496	2712

MODEL: schedule of quantities-3 [Sheet]  
 FILE NAME: c:\p\work\revitol\illinois.gov\_edison.zohfanyi@d0894755\ID8761734-sh-schedule.dgn

USER NAME = edison.zohfanyi	DESIGNED -	REVISED -
	DRAWN -	REVISED -
PLOT SCALE = 0.16666833' / in.	CHECKED -	REVISED -
PLOT DATE = 12/13/2023	DATE -	REVISED -

**STATE OF ILLINOIS  
DEPARTMENT OF TRANSPORTATION**

**SCHEDULE OF QUANTITIES**

SCALE: SHEET 3 OF 3 SHEETS STA. TO STA.

F.A.U. RTE.	SECTION	COUNTY	TOTAL SHEETS	SHEET NO.
*	29-RS-3, 28-RS-4	ST. CLAIR	13	12
*9213/9128		CONTRACT NO. 76T34		
		ILLINOIS FED. AID PROJECT		

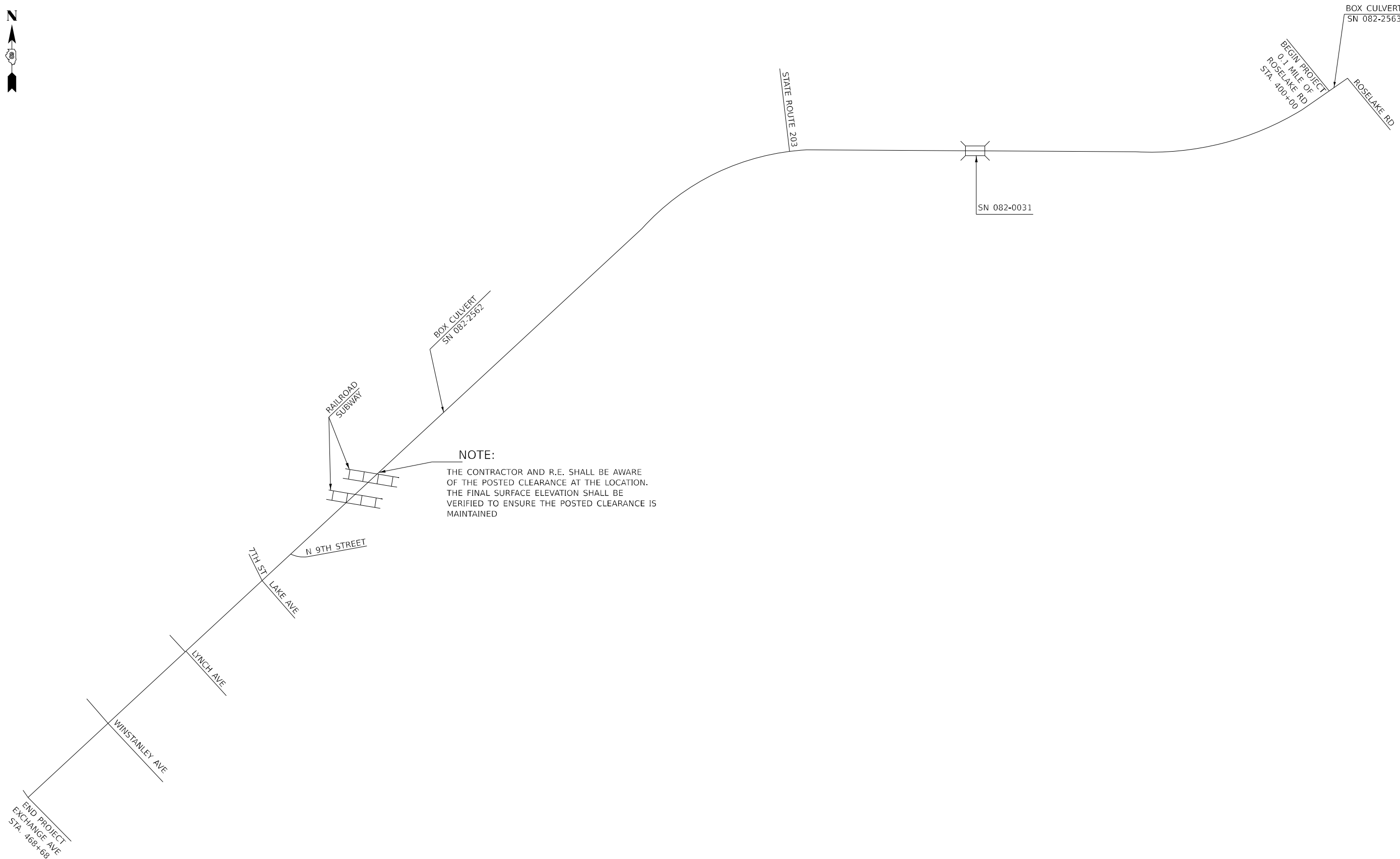

MODEL: location map-1 [Sheet]  
 FILE NAME: c:\p\work\pwrtd\illinois.gov\edison.zohfonyi@illinois.gov\0894756\0876734-shr-plan.dgn

NOT TO SCALE

USER NAME = edison.zohfonyi	DESIGNED -	REVISED -
	DRAWN -	REVISED -
PLOT SCALE = 0.16666833' / in.	CHECKED -	REVISED -
PLOT DATE = 12/7/2023	DATE -	REVISED -

**STATE OF ILLINOIS  
 DEPARTMENT OF TRANSPORTATION**

**LOCATION MAP**

SCALE: SHEET 1 OF 1 SHEETS STA. TO STA.

F.A.U. RTE.	SECTION	COUNTY	TOTAL SHEETS	SHEET NO.
*	29-RS-3, 28-RS-4	ST. CLAIR	13	13
* 9213/9128		CONTRACT NO. 76T34		
		ILLINOIS	FED. AID PROJECT	