

STATE OF ILLINOIS
DEPARTMENT OF TRANSPORTATION

F.A. RTE.	SECTION	COUNTY	TOTAL SHEETS	SHEET NO.
VAR		VARIOUS	6	1
		ILLINOIS	CONTRACT NO. 74C86	

* D7 SEAL COAT 2024-1

FOR INDEX OF SHEETS, SEE SHEET NO. 2

**PROPOSED
HIGHWAY PLANS**

**VARIOUS ROUTES
SECTION D7 SEAL COAT 2024-1
A-2 SEAL COAT
CLARK COUNTY**

C-97-026-24

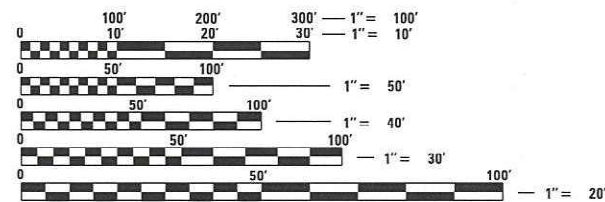
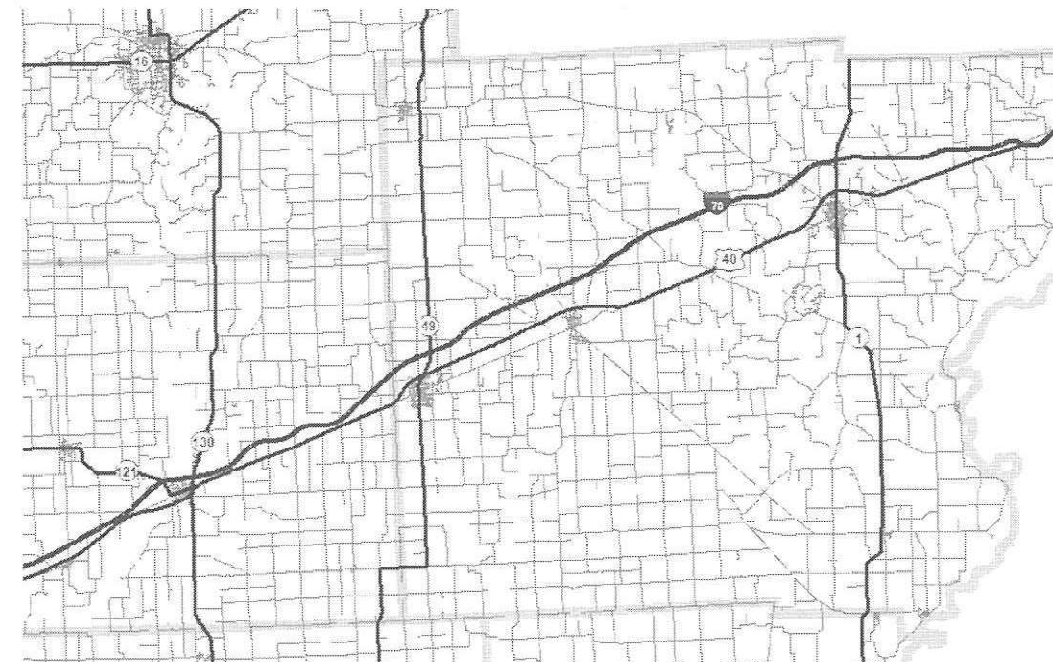
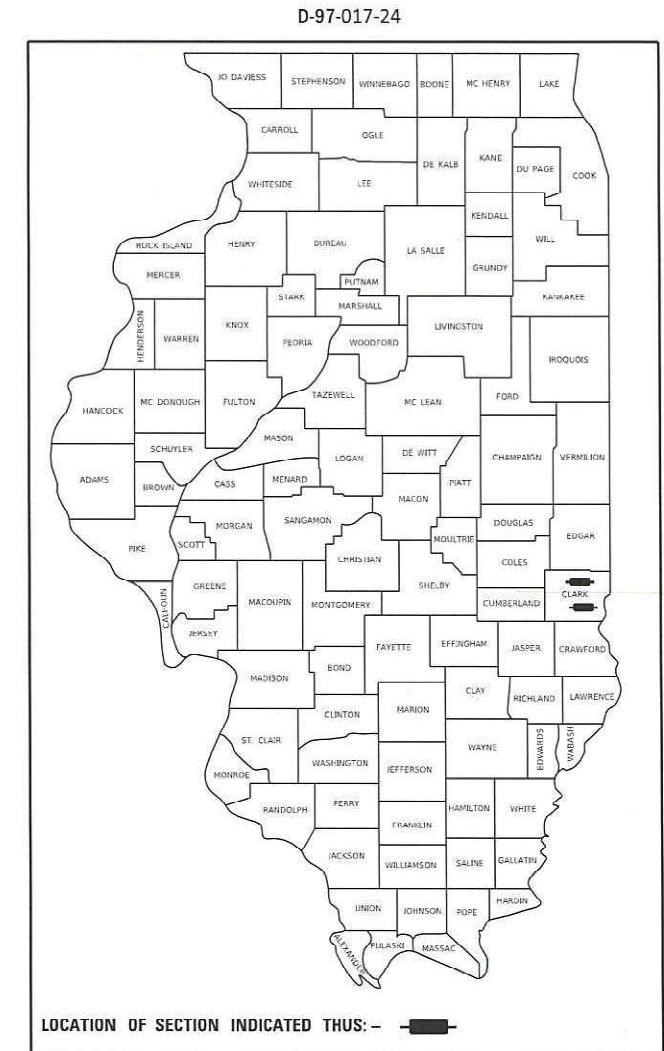

FULL SIZE PLANS HAVE BEEN PREPARED USING STANDARD ENGINEERING SCALES. REDUCED SIZED PLANS WILL NOT CONFORM TO STANDARD SCALES. IN MAKING MEASUREMENTS ON REDUCED PLANS, THE ABOVE SCALES MAY BE USED.

J.U.L.I.E.
JOINT UTILITY LOCATION INFORMATION FOR EXCAVATORS
1-800-892-0123
OR 811

PROJECT ENGINEER BRIAN LEWIS
PROJECT MANAGER JAYSON PORTER

CONTRACT NO. 74C86

STATE OF ILLINOIS
DEPARTMENT OF TRANSPORTATION

SUBMITTED February 22, 2024
Jafay P. Myer REGIONAL ENGINEER

March 22, 2024 [Signature]
ENGINEER OF DESIGN AND ENVIRONMENT

March 22, 2024 [Signature]
DIRECTOR OF HIGHWAYS PROJECT IMPLEMENTATION

**PRINTED BY THE AUTHORITY
OF THE STATE OF ILLINOIS**

GENERAL NOTES

THIS SECTION SHALL BE CONSTRUCTED IN ACCORDANCE WITH THE PLANS; THE "STANDARD SPECIFICATIONS FOR ROAD AND BRIDGE CONSTRUCTION" ADOPTED JANUARY 1, 2024; THE "SUPPLEMENTAL SPECIFICATIONS AND RECURRING SPECIAL PROVISIONS" INDICATED ON THE CHECK SHEET, AND "THE SPECIAL PROVISIONS" INCLUDED IN THIS PROPOSAL.

THE PROPOSED WORK IS LOCATED ON VARIOUS ROUTES IN CLARK COUNTY. THE WORK IN THIS SECTION CONSISTS OF POTHOLE PATCHING, CONSTRUCTION OF SEAL COAT FOR BITUMINOUS SURFACE TREATMENT CLASS A-2, TRAFFIC CONTROL, AND ANY OTHER WORK NECESSARY TO COMPLETE THIS SECTION PER THE STANDARD SPECIFICATIONS.

ESTIMATED QUANTITIES OF HOT-MIX ASPHALT FOR POTHOLE PATCHING (COLD MIX), PREPARATION OF BASE, AND AGGREGATE BASE REPAIR HAVE BEEN INCLUDED FOR ANY NECESSARY POTHOLE PATCHING OR BASE REPAIR. THE QUANTITY AND LOCATIONS OF POTHOLE PATCHING AND BASE REPAIR WILL BE DETERMINED BY THE RESIDENT ENGINEER IN THE FIELD.

RATES OF APPLICATIONS USED TO CALCULATE THE QUANTITIES FOR THE BITUMINOUS SURFACE TREATMENTS ARE AS FOLLOWS:

BITUMINOUS MATERIALS (FOG SEAL)	0.05 LBS/SQ FT
---------------------------------	----------------

INDEX OF SHEETS

<u>SHEET NO.</u>	<u>ITEM</u>
1	TITLE SHEET
2	INDEX OF SHEETS & GENERAL NOTES
3	SUMMARY OF QUANTITIES
4	SCHEDULES OF QUANTITIES
5-6	PLAN SHEETS

THE FOLLOWING STANDARDS ARE A PART OF THESE PLANS AND ARE INCLUDED FOLLOWING THE LAST NUMBERED SHEET OF THE PLANS

<u>STD. NO.</u>	<u>DESCRIPTION</u>
000001-08	STANDARD SYMBOLS, ABBREVIATIONS AND PATTERNS
001006	DECIMAL OF AN INCH AND OF A FOOT
701001-02	OFF-RD OPERATIONS, 2L, 2W, MORE THAN 15' FROM PAVEMENT EDGE
701006-05	OFF-RD OPERATIONS, 2L, 2W, 15' TO 24" FROM PAVEMENT EDGE
701011-04	OFF-RD MOVING OPERATIONS, 2L,2W, DAY ONLY
701201-05	LANE CLOSURE, 2L, 2W, DAY ONLY, FOR SPEEDS ≥ 45 MPH
701301-04	LANE CLOSURE, 2L, 2W, SHORT TIME OPERATIONS
701306-04	LANE CLOSURE, 2L, 2W, SLOW MOVING OPERATIONS DAY ONLY, FOR SPEEDS ≥ 45 MPH
701901-09	TRAFFIC CONTROL DEVICES

REV. - MS

MODEL: D:\default\pwworkspace\benley.com\pwworkspace\DOT_Offices\District_7\Projects\74C86\CAD\Drawings\DOT_74C86-shi-general.dgn

USER NAME = jessica.hille	DESIGNED -	REVISED -	STATE OF ILLINOIS DEPARTMENT OF TRANSPORTATION	INDEX OF SHEETS, HIGHWAY STANDARDS, & GENERAL NOTES	F.A.P. RTE.	SECTION	COUNTY	TOTAL SHEETS	SHEET NO.
DRAWN -	REVISED -	VAR.			D7 SEAL COAT 2024-1	CLARK	6	2	
PLOT SCALE = 100.0000' / in.	CHECKED -	REVISED -			CONTRACT NO. 74C86				
PLOT DATE = 2/22/2024	DATE -	REVISED -			ILLINOIS FED. AID PROJECT				
				SCALE:	SHEET	OF	SHEETS	STA.	TO STA.

LOCATION DESCRIPTIONS

Location	Main Route	Frontage Road Number/ M.P.	Length Feet	Width Feet	SQ. YD.
1	US40	0.10	600	21	1400.00
2	US40	0.15	900	18	1800.00
3	US40	16.49	1670	20	3711.11
4	US40	16.88	265	16	471.11
5	US 40	17.83	300	22	733.33
6	US40	17.84	533	16	947.56
7	US40	20.19	2070	16	3680.00
8	IL 1	OR24	581	18	1162.00
9	SBI 1 Spur	3.78	1526	20	3391.11
10	SBI 1 Spur	2.58	3200	20	7111
11	SBI 1 Spur	2.21	756	18	1512.00
12	1-70	27.61	1210	20	2688.89
TOTAL SQ YD					28609

LOCATION	LENGTH	WIDTH	AREA	BITUMINOUS MATERIALS (FOG SEAL)	BITUMINOUS SURFACE TREATMENT, A2	HMA FOR PATCHING POTHOLES (COLD MIX)
	FEET	FEET	SQ. YD.	POUND	SQ YD	TON
1	600	21	1400	630.0	1400.0	0.5
2	900	18	1800	810.0	1800.0	0.5
3	1670	20	3711	1670.0	3711.1	1.0
4	265	16	471	212.0	471.1	0.5
5	300	22	733	330.0	733.3	0.5
6	533	16	948	426.4	947.6	0.5
7	2070	16	3680	1656.0	3680.0	2.0
8	581	18	1162	522.9	1162.0	0.5
9	1526	20	3391	1526.0	3391.1	4.0
10	3200	20	7111	3200.0	7111.1	4.0
11	756	18	1512	680.4	1512.0	2.0
12	1210	20	2689	1210.0	2688.9	1.0
TOTALS			28609	12874	28609	17

MODEL: Default
 FILE: Mainfile: p:\ultra-cw-bead\paw.com\PIV\DOT\Documents\DOT Office\Dir\dir: 7\Project\74C86\CADD\DATA\CAD\Sheet\DOT\74C86-sht-schedule.dgn

USER NAME = jessica.hille	DESIGNED -	REVISED -
	DRAWN -	REVISED -
PLOT SCALE = 100,0000 ' / in.	CHECKED -	REVISED -
PLOT DATE = 2/22/2024	DATE -	REVISED -

**STATE OF ILLINOIS
DEPARTMENT OF TRANSPORTATION**

SCHEDULE OF QUANTITIES			
SCALE:	SHEET	OF	SHEETS
		STA.	TO STA.

F.A.P. RTE.	SECTION	COUNTY	TOTAL SHEETS	SHEET NO.
VAR.	D7 SEAL COAT 2024-1	CLARK	6	4
			CONTRACT NO. 74C86	
		ILLINOIS FED. AID PROJECT		

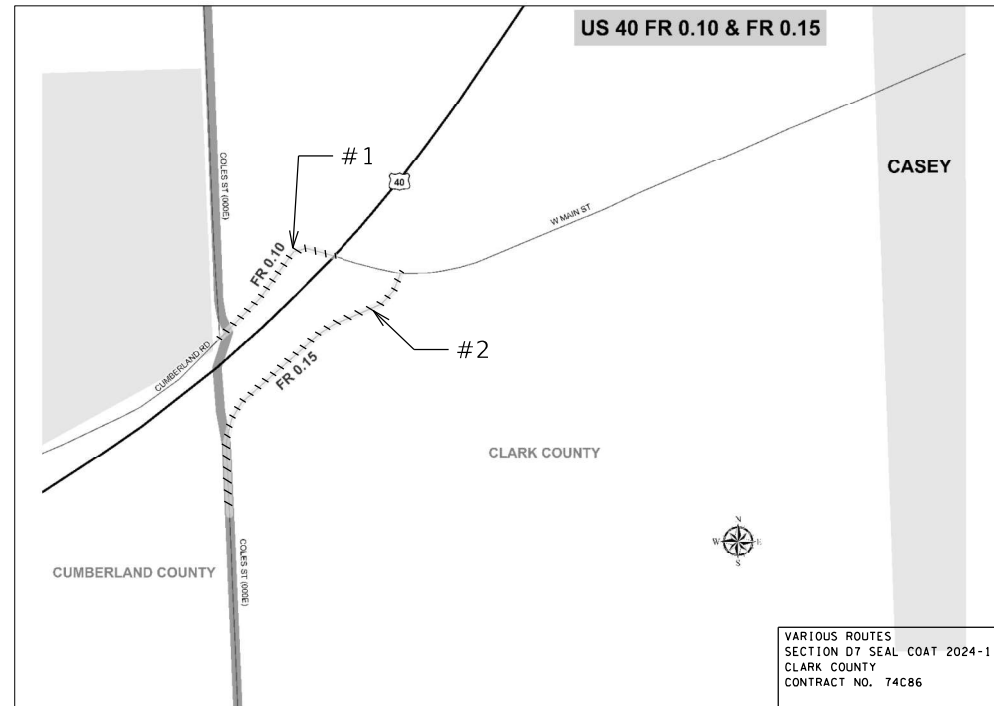

LOCATIONS 1 & 2

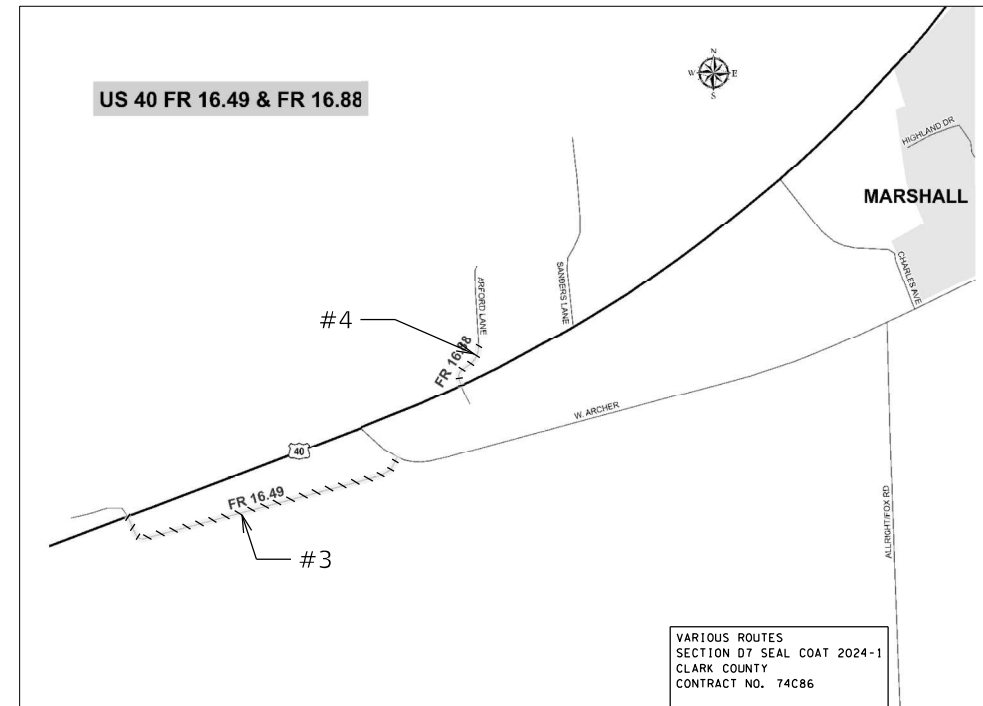

LOCATIONS 3 & 4

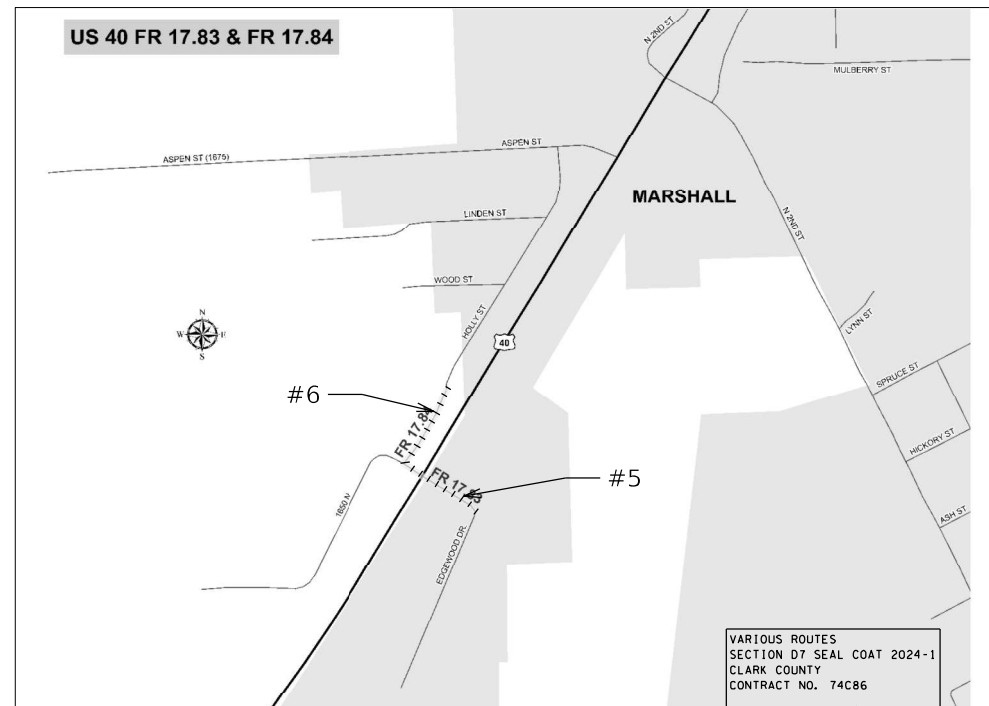

LOCATIONS 5 & 6

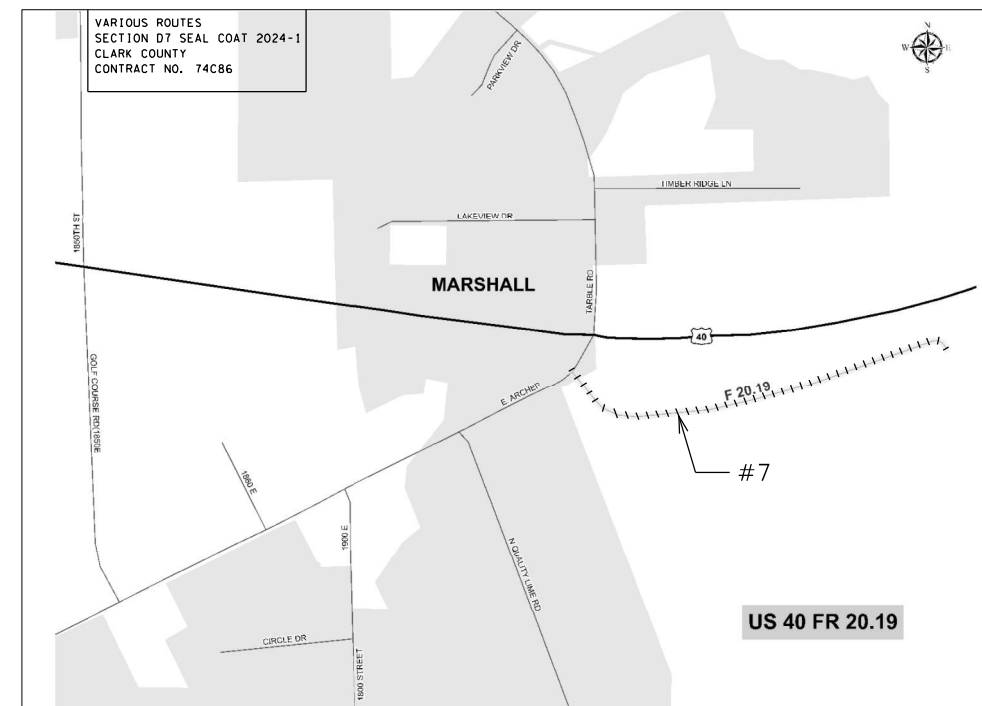

LOCATION 7

MODEL: Default
FILE: \\marc-pc\public\paw_benefay.com\PIV\DOT\Documents\DOT_Offices\District_7\Project\74C86\CADD\Drawings\CD\Sheets\D74C86-sht-410n.dwg

USER NAME = jessica.hille	DESIGNED -	REVISED -
PLOT SCALE = 100,0000' / in.	DRAWN -	REVISED -
PLOT DATE = 2/22/2024	CHECKED -	REVISED -
	DATE -	REVISED -

**STATE OF ILLINOIS
DEPARTMENT OF TRANSPORTATION**

CLARK COUNTY VARIOUS LOCATIONS

SCALE: SHEET OF SHEETS STA. TO STA.

F.A.P. RTE.	SECTION	COUNTY	TOTAL SHEETS	SHEET NO.
VAR.	D7 SEAL COAT 2024-1	CLARK	6	5
			CONTRACT NO. 74C86	
ILLINOIS FED. AID PROJECT				

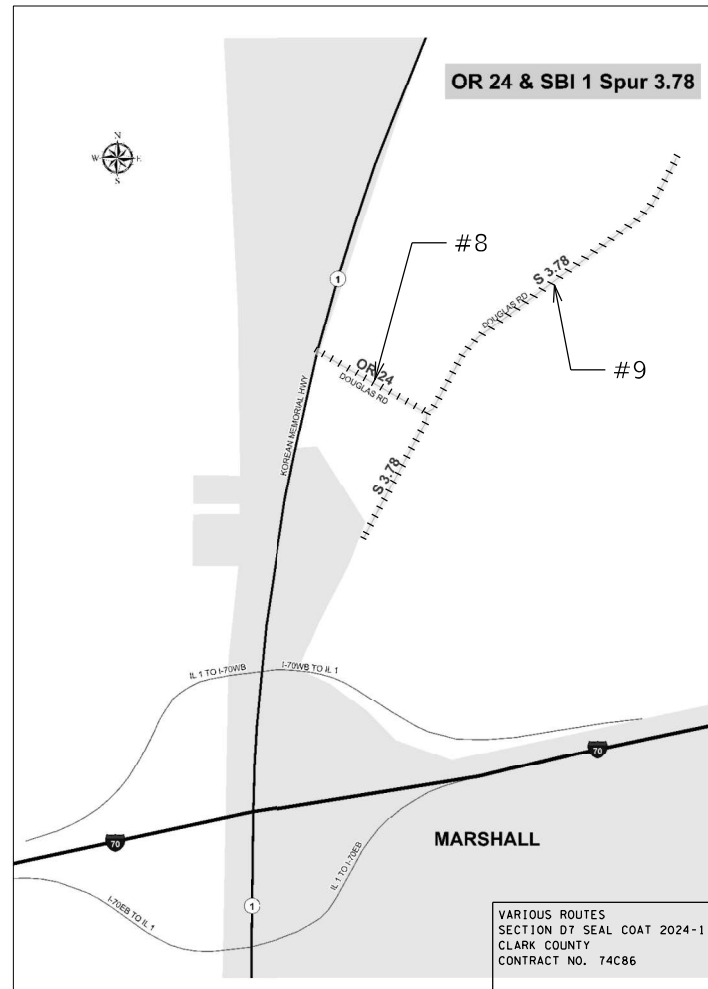

LOCATIONS 8 & 9

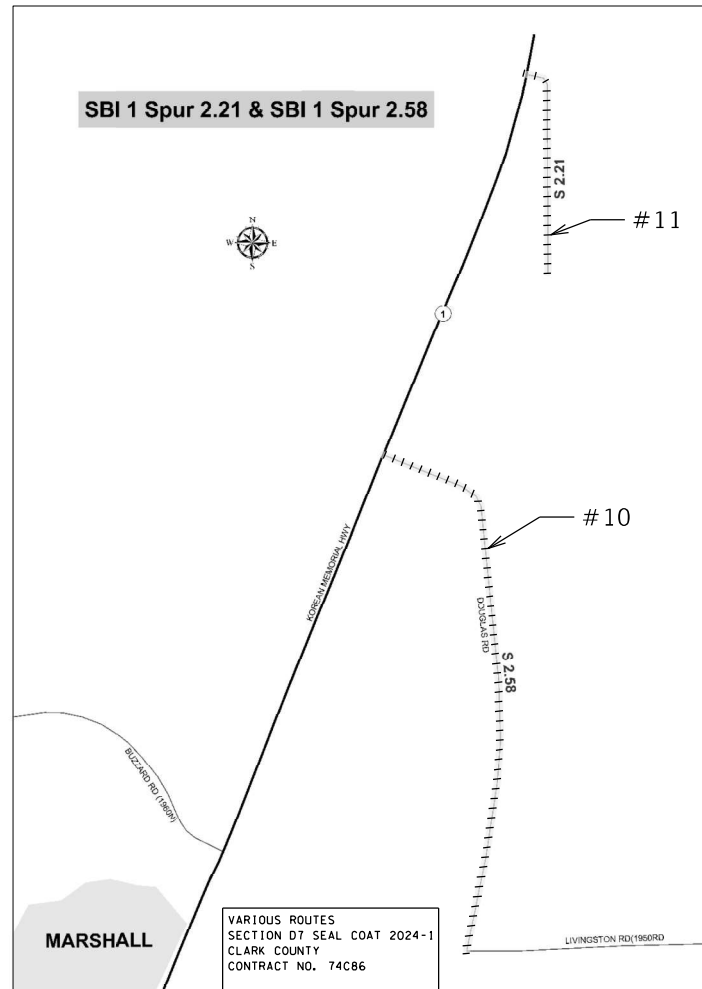

LOCATIONS 10 & 11

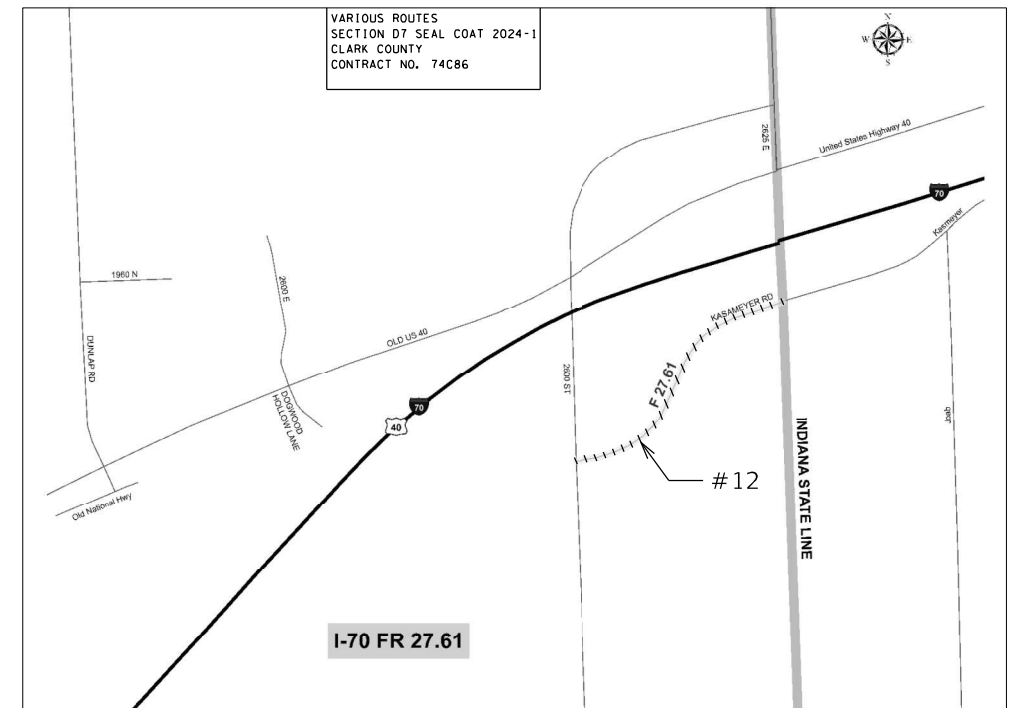

LOCATION 12

MODEL: Default
 FILE: \\marl-cw-beadley.com\P\INDOT\Documents\DOT Offices\District 7\Project\74C86\CADD\Drawings\DOT\Drawings\74C86-ehb-pln.dwg

USER NAME = jessica.hille	DESIGNED -	REVISED -
PLOT SCALE = 100,0000' / in.	DRAWN -	REVISED -
PLOT DATE = 2/22/2024	CHECKED -	REVISED -
	DATE -	REVISED -

STATE OF ILLINOIS
DEPARTMENT OF TRANSPORTATION

CLARK COUNTY VARIOUS LOCATIONS			
SCALE:	SHEET	OF SHEETS	STA. TO STA.

F.A.P. RTE.	SECTION	COUNTY	TOTAL SHEETS	SHEET NO.
VAR.	D7 SEAL COAT 2024-1	CLARK	6	6
ILLINOIS FED. AID PROJECT			CONTRACT NO. 74C86	