

STATE OF ILLINOIS
DEPARTMENT OF TRANSPORTATION

F.A.P. RTE.	SECTION	COUNTY	TOTAL SHEETS	SHEET NO.
774	D7 CAPE SEAL 2024-1	VARIOUS	9	1
		ILLINOIS	CONTRACT NO. 74C43	

D-97-086-23



LOCATION OF SECTION INDICATED THUS: - [Black Box] -

PROPOSED HIGHWAY PLANS

FAP ROUTE 774 (ILL 128)
SECTION D7 CAPE SEAL 2024-1
PROJECT STP-GQ18(368)
CAPE SEAL
FAYETTE, EFFINGHAM COUNTY

C-97-117-23

FOR INDEX OF SHEETS, SEE SHEET NO. 2

ADT: 2700 (2021)

STATION EQUATIONS:

STA. 756+46.00 (BK) = STA. 757+02.64 (AH)
STA. 810+67.20 (BK) = STA. 811+63.20 (AH)

FAP ROUTE 774 (ILL 128)
SECTION D7 CAPE SEAL 2024-1
FAYETTE, EFFINGHAM COUNTY
BEGINS STA. 733+00

FAP ROUTE 774 (ILL 128)
SECTION D7 CAPE SEAL 2024-1
FAYETTE, EFFINGHAM COUNTY
ENDS STA. 859+61

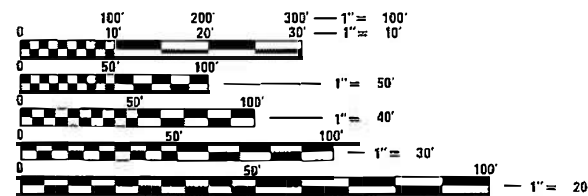
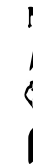
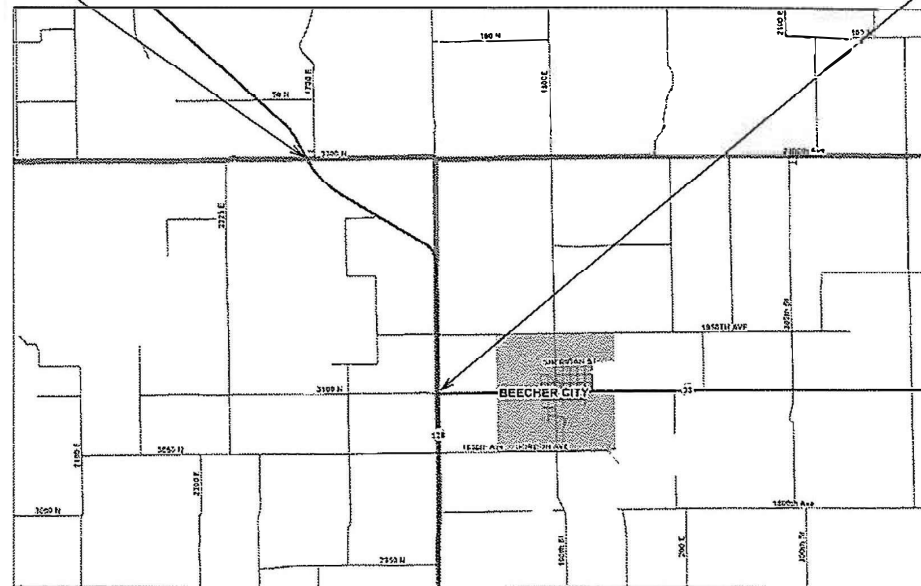

FULL SIZE PLANS HAVE BEEN PREPARED USING STANDARD ENGINEERING SCALES, REDUCED SIZED PLANS WILL NOT CONFORM TO STANDARD SCALES. IN MAKING MEASUREMENTS ON REDUCED PLANS, THE ABOVE SCALES MAY BE USED.

J.U.L.I.E.
JOINT UTILITY LOCATION INFORMATION FOR EXCAVATORS
1-800-892-0123
OR 811

PROJECT ENGINEER: MATT BOWER
PROJECT MANAGER: DESTINY WILLIAMS

CONTRACT NO. 74C43

GROSS LENGTH = 12,508.36 FT. = 2.369 MILES
NET LENGTH = 12,508.36 FT. = 2.369 MILES

STATE OF ILLINOIS
DEPARTMENT OF TRANSPORTATION

SUBMITTED January 31 2024
Jeffrey P. Myerka
REGIONAL ENGINEER

March 22, 2024
[Signature]
ENGINEER OF DESIGN AND ENVIRONMENT

March 22, 2024
[Signature]
DIRECTOR OF HIGHWAYS PROJECT IMPLEMENTATION

PRINTED BY THE AUTHORITY
OF THE STATE OF ILLINOIS

GENERAL NOTES

THE PROPOSED WORK IS LOCATED ON ILL 128 IN FAYETTE AND EFFINGHAM COUNTY FROM SHELBY COUNTY LINE TO ILL 33.

THE WORK INCLUDED IN THIS SECTION CONSISTS OF APPLYING CAPE SEAL TO ILL 128, PLUS ANY OTHER NECESSARY WORK TO COMPLETE THE SECTION.

FOR CAPE SEAL, THE AGGREGATE GRADATION FOR THE A-1 BITUMINOUS SURFACE TREATMENT SHALL BE CRUSHED STONE, CA 16, AND FRICTION AGGREGATE MIXTURE D.

PAVEMENT MARKING SHALL BE APPLIED IN ACCORDANCE WITH SECTION 780 OF THE STANDARD SPECIFICATIONS. SHORT TERM PAVEMENT MARKING SHALL BE APPLIED TO THE A-1 TREATMENT AND THE MICROSURFACE. THE CENTERLINE STRIPES FOR SHORT TERM PAVEMENT MARKING SHALL BE PAINT AND CONSIST OF 10 FEET LONG AT 40 FEET CENTERS. THE TEMPORARY PAVEMENT MARKING SHALL BE APPLIED DIRECTLY OVER THE SHORT TERM PAVEMENT MARKING. FINAL PAVEMENT MARKING SHALL BE PLACED AFTER A CURE TIME OF 30 DAYS.

THE EXISTING ROADWAY STATIONS SHALL BE COVERED PRIOR TO THE CAPE SEAL AND/OR THE MICRO-SURFACING. THE COVER SHALL BE REMOVED AFTER WORK IS COMPLETED. THIS WORK SHALL BE INCLUDED IN THE COST OF THE "TRAFFIC CONTROL AND PROTECTION STANDARDS."

INDEX OF SHEETS

SHEET NO. DESCRIPTION

- 1 COVER SHEET
- 2 INDEX OF SHEETS & GENERAL NOTES
- 3 SUMMARY OF QUANTITIES
- 4 TYPICAL SECTIONS
- 5 SCHEDULE OF QUANTITIES
- 6-9 DETAILS

THE FOLLOWING STANDARDS ARE A PART OF THESE PLANS AND ARE INCLUDED FOLLOWING SHEET NUMBER SHEET NO. 5.

- 000001-08 STANDARD SYMBOLS, ABBREVIATIONS, AND PATTERNS
- 001006 DECIMAL OF AN INCH AND OF A FOOT
- 667101-02 PERMANENT SURVEY MARKERS
- 701001-02 OFF-ROAD OPERATIONS, 2L, 2W, MORE THAN 15' AWAY
- 701006-05 OFF-ROAD OPERATIONS, 2L, 2W, 15' TO 24" FROM PAVEMENT EDGE
- 701301-04 LANE CLOSURE, 2L, 2W, SHORT TIME OPERATIONS
- 701306-04 LANE CLOSURE, 2L, 2W, SLOW MOVING OPERATIONS DAY ONLY, FOR SPEEDS >= 45 MPH
- 701311-03 LANE CLOSURE, 2L, 2W, MOVING OPERATIONS DAY ONLY
- 701901-09 TRAFFIC CONTROL DEVICES
- 780001-05 TYPICAL PAVEMENT MARKINGS
- 781001-04 TYPICAL APPLICATIONS OF RAISED REFLECTIVE PAVEMENT MARKERS

REV. - MS

MODEL: Default
 FILE NAME: p:\ulidect-cw-bentley.com\PROJECTS\DOT Offices\District 7\Projects\74C43\CADD\data\CAD\sheet\74C43-sh-genote.dgn

USER NAME = jessica.hille	DESIGNED -	REVISED -	STATE OF ILLINOIS DEPARTMENT OF TRANSPORTATION	INDEX OF SHEETS AND GENERAL NOTES		F.A.P. RTE.	SECTION	COUNTY	TOTAL SHEETS	SHEET NO.
DRAWN -	REVISED -	774				D7 CAPE SEAL 2024-1	VARIOUS	9	2	
PLOT SCALE = 100.0000' / in.	CHECKED -	REVISED -				CONTRACT NO. 74C43				
PLOT DATE = 1/25/2024	DATE -	REVISED -		SCALE:	SHEET OF SHEETS	STA. TO STA.	ILLINOIS FED. AID PROJECT			

80% FED
20% STATE

SUMMARY OF QUANTITIES			TOTAL QUANTITIES	CONSTRUCTION TYPE CODE	
CODE NO	ITEM	UNIT		0005 FAYETTE COUNTY	0005 EFFINGHAM COUNTY
40500061	CAPE SEAL	SO YD	33356	20484	12872
67100100	MOBILIZATION	L SUM	1	0.6	0.4
70100460	TRAFFIC CONTROL AND PROTECTION, STANDARD 701306	L SUM	1	0.6	0.4
70107025	CHANGEABLE MESSAGE SIGN	CAL DA	28	14	14
70300100	SHORT TERM PAVEMENT MARKING	FOOT	1251	768	483
70300221	TEMPORARY PAVEMENT MARKING - LINE 4" - PAINT	FOOT	28596	17283	11313
* 78001110	PAINT PAVEMENT MARKING - LINE 4"	FOOT	28596	17283	11313
* 78100100	RAISED REFLECTIVE PAVEMENT MARKER	EACH	246	168	78
78300200	RAISED REFLECTIVE PAVEMENT MARKER REMOVAL	EACH	241	169	72
Z0049799	PROTECTING OR RESETTING SURVEY MARKERS	EACH	7	2	5

* SPECIALTY ITEM

MODEL: Default
FILE NAME: p:\ultra-cw-bead-fy.com\PIV\DOT\Documents\DOT Office\Dir\drf_7\Project\74C43\CADDData\CAD\Sheet\74C43-sh-500.dgn

USER NAME = jessica.hille	DESIGNED -	REVISED -
PLOT SCALE = 100,0000 ' / in.	DRAWN -	REVISED -
PLOT DATE = 1/25/2024	CHECKED -	REVISED -
	DATE -	REVISED -

STATE OF ILLINOIS
DEPARTMENT OF TRANSPORTATION

SUMMARY OF QUANTITIES

SCALE: SHEET 3 OF 6 SHEETS STA. TO STA.

F.A.P. RTE.	SECTION	COUNTY	TOTAL SHEETS	SHEET NO.
774	D7 CAPE SEAL 2024-1	VARIOUS	9	3
			CONTRACT NO. 74C43	
			ILLINOIS FED. AID PROJECT	

TYPICAL CROSS SECTION

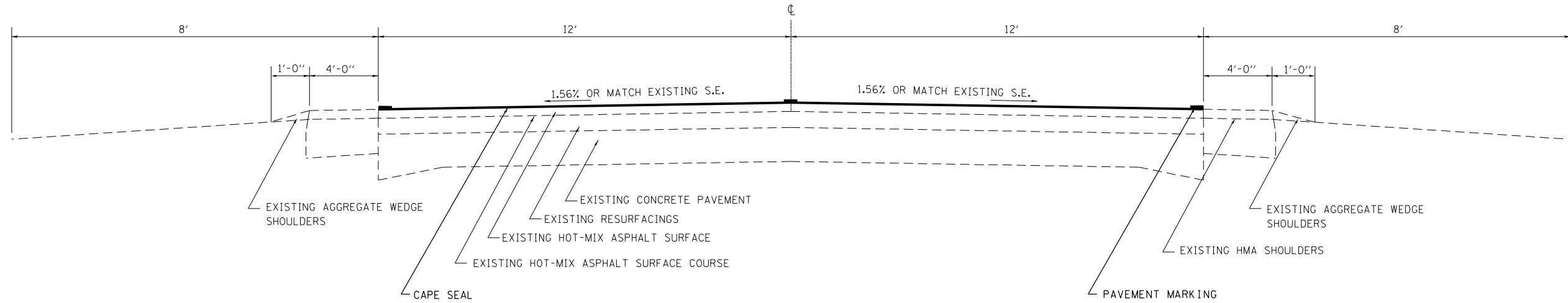

ILL 128
 STA 733+00.00 TO STA 756+46.00
 STA 757+02.64 TO STA 810+67.20
 STA 811+63.20 TO STA 859+61.00

NOTE: NOT DRAWN TO SCALE

MODEL: Default
 FILE: \\mupc-pw-bentley.com\P\INDOT\Documents\DOT Offices\Director_7\Projects\74C43\CADDData\CAD\Sheets\74C43-sht-typical.dgn

USER NAME = jessica.hille	DESIGNED -	REVISED -
	DRAWN -	REVISED -
PLOT SCALE = 100,0000' / in.	CHECKED -	REVISED -
PLOT DATE = 1/25/2024	DATE -	REVISED -

**STATE OF ILLINOIS
 DEPARTMENT OF TRANSPORTATION**

TYPICAL SECTION

SCALE: SHEET 4 OF 6 SHEETS STA. TO STA.

F.A.P. RTE.	SECTION	COUNTY	TOTAL SHEETS	SHEET NO.
774	D7 CAPE SEAL 2024-1	VARIOUS	9	4
			CONTRACT NO. 74C43	
ILLINOIS FED. AID PROJECT				

SCHEDULE OF QUANTITIES								
STATION TO STATION			LENGTH	WIDTH	CAPE SEAL	SHORT TERM PAVEMENT MARKING	PAINT PAVEMENT MARKING - YELLOW	PAINT PAVEMENT MARKING - WHITE
			(FOOT)	(FOOT)	(SQ YD)	(FOOT)	(FOOT)	(FOOT)
FAYETTE COUNTY								
733+00.00	TO	756+46.00	2,346.0	24	6,256.0	234.6	586.5	4,692.0
757+02.64	TO	810+38.00	5,335.4	24	14,227.6	533.5	1,333.8	10,670.7
FAYETTE TOTALS=			7,681.4		20,483.6	768.1	1,920.3	15,362.7
EFFINGHAM COUNTY								
810+38.00	TO	810+67.20	29.2	24	77.9	2.9	7.3	58.4
811+63.20	TO	859+61.00	4,797.8	24	12,794.1	479.8	1,199.5	9,595.6
855+09.00	TO	859+61.00		24	0	0	452	0
EFFINGHAM TOTALS=			4,827.0		12,872.0	482.7	1,658.8	9,654.0
GRAND TOTAL=			12,508.4		33,356	1,251	3,579	25,017

*NOTE: NO PASSING ZONE SBL

SURVEY MARKER SCHEDULE					
POINT NO.	NORTHING	EASTING	STATION	OFFSET	DESCRIPTION
101	928,854.90	844,812.01	733+86.50	0	PC - MAG NAIL IN CL
102	927,209.40	846,318.30	756+46.00 BK = 757+02.64 AH	0	PT STA/EQ - MAG NAIL IN CL
103	923,502.30	850,475.43	817+29	0	IP WITH CAP - NE Corner of Sec. 25, T9N, R4E
104	923,417.22	850,474.43	818+14.23	0	IP WITH ALUMINUM CAP IN VAULT - NW Corner of Sec 30, T9N, R4E
105	920,861.48	850,446.42	843+70	8.7' RT	5/8 BENT PIN, BURIED 6 INCHES, NO VAULT - E 1/4 Corner of Sec 25, T9N, R3E
106	920,800.49	850,446.79	844+31	8.5' RT	IP WITH ALUM CAP IN VAULT - W 1/4 Corner of Sec. 30, T9N, R4E
107	919,731.80	850,446.79	855+00.00	0	POT - ALUM VAULT UNABLE TO OPEN

RAISED REFLECTIVE PAVEMENT MARKER SCHEDULE								
STATION TO STATION			LENGTH	RAISED REFLECTIVE PAVEMENT MARKER REMOVAL	RAISED REFLECTIVE PAVEMENT MARKER	SBL EOP RAISED REFLECTIVE PAVEMENT MARKER	NBL EOP RAISED REFLECTIVE PAVEMENT MARKER	CENTERLINE RAISED REFLECTIVE PAVEMENT MARKER
			(FOOT)	(EACH)	(EACH)	(EACH)	(EACH)	(EACH)
FAYETTE COUNTY								
733+00.00	TO	756+46.00	2,346.0	29	29	0	0	0
757+02.64	TO	798+67.00	4,164.4	52	52	0	0	0
798+67.00	TO	810+38.00	1,171.0	88	0	29	29	29
FAYETTE TOTALS=			7,681.4	169	81	29	29	29
EFFINGHAM COUNTY								
810+38.00	TO	810+67.20	29.2	3	0	1	1	1
811+63.20	TO	813+06.00	142.8	15	0	5	5	5
813+06.00	TO	859+61.00	4,655.0	54	60	0	0	0
EFFINGHAM TOTALS=			4,827.0	72	60	6	6	6
GRAND TOTAL=			12,508.4	241	141	35	35	35

*SPACING SHALL BE 40'

*SPACING SHALL BE 40'

*SPACING SHALL BE 40'

MODEL: Default
FILE: \\blmfe-pw-beadley.com\P\INDOT\Documents\DOT_Offices\Director_7\Projects\74C43\CADD\Drawings\CD\SheetS\74C43-43-1-Sched.scd.dwg

USER NAME = matthew.bower	DESIGNED -	REVISED -
	DRAWN -	REVISED -
PLOT SCALE = 100,0000' / in.	CHECKED -	REVISED -
PLOT DATE = 3/6/2024	DATE -	REVISED -

STATE OF ILLINOIS
DEPARTMENT OF TRANSPORTATION

SCHEDULES			
SCALE:	SHEET	OF SHEETS	STA. TO STA.

F.A.P. RTE.	SECTION	COUNTY	TOTAL SHEETS	SHEET NO.
774	DY CAPE SEAL 2024-01	VARIOUS	9	5
CONTRACT NO. 74C43				
ILLINOIS FED. AID PROJECT				

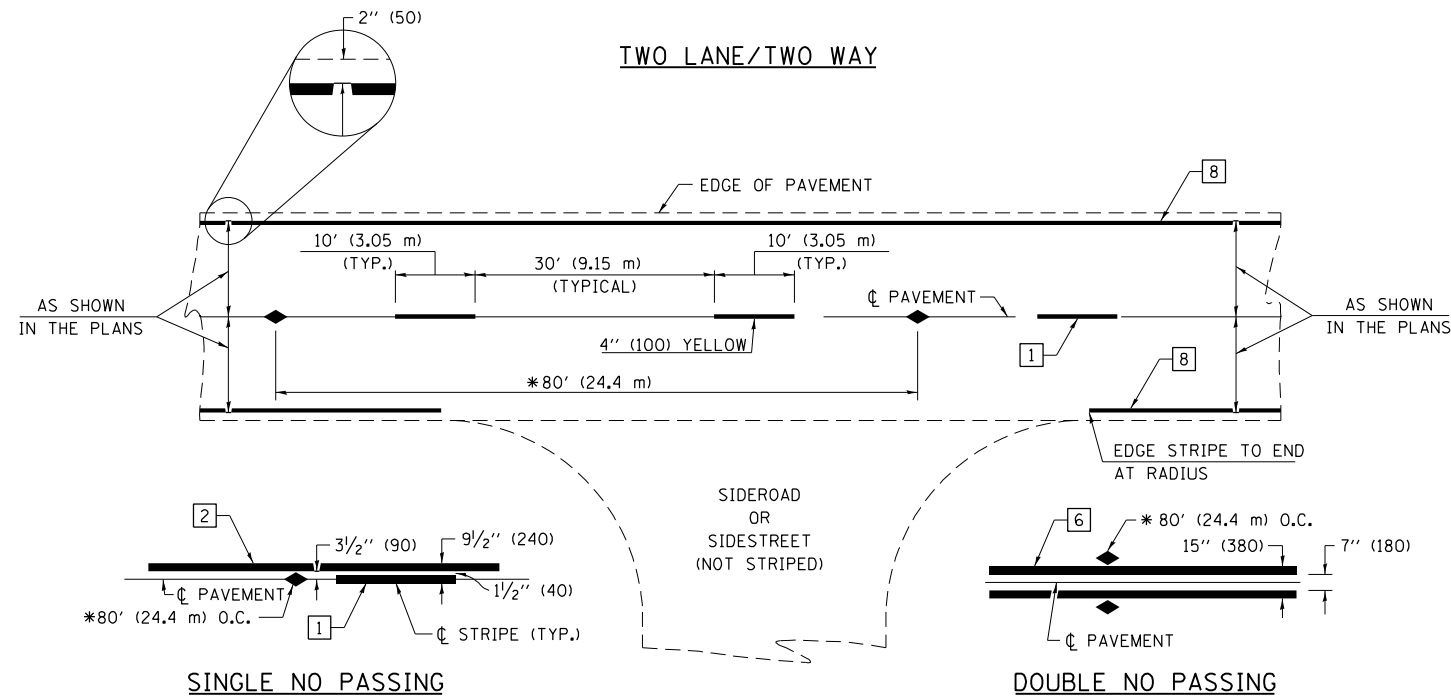

* REDUCE TO 40' (12.2 m) O.C. ON CURVES WITH POSTED OR ADVISORY SPEEDS OF 45 mph (70 km/h) OR LESS.

PAVEMENT MARKING LEGEND

- 1 4" (100) SKIP-DASH (YELLOW)
- 2 4" (100) SOLID (YELLOW)
- 3 12" (300) DIAGONAL (YELLOW)
- 4 4" (100) DOUBLE YELLOW (NARROW)
- 5 12" (300) SOLID WHITE
- 6 4" (100) DOUBLE YELLOW (WIDE)
- 7 6" (150) SKIP-DASH (WHITE)
- 8 4" (100) SOLID (WHITE)
- 9 12" (300) DIAGONAL (WHITE)
- 10 6" (150) SOLID (WHITE)
- 11 24" (600) STOP BAR (WHITE)
- 12 8" (200) SOLID (WHITE)
- 13 4" (100) PARKING WHITE

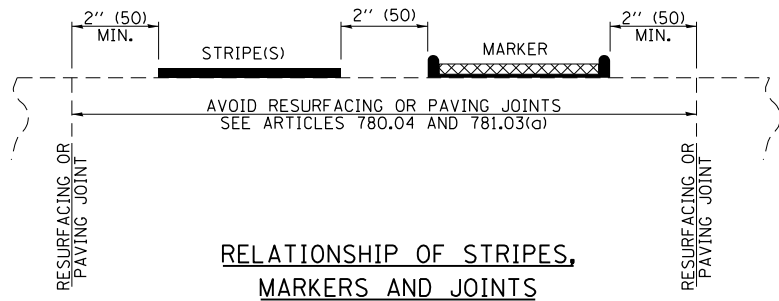

RELATIONSHIP OF STRIPES, MARKERS AND JOINTS

TYPICAL PAVEMENT MARKERS LEGEND

- ◆ TWO-WAY AMBER MARKER
- ▶ ONE-WAY AMBER MARKER
- ▷ ONE-WAY CRYSTAL MARKER

RAISED REFLECTIVE PAVEMENT MARKERS

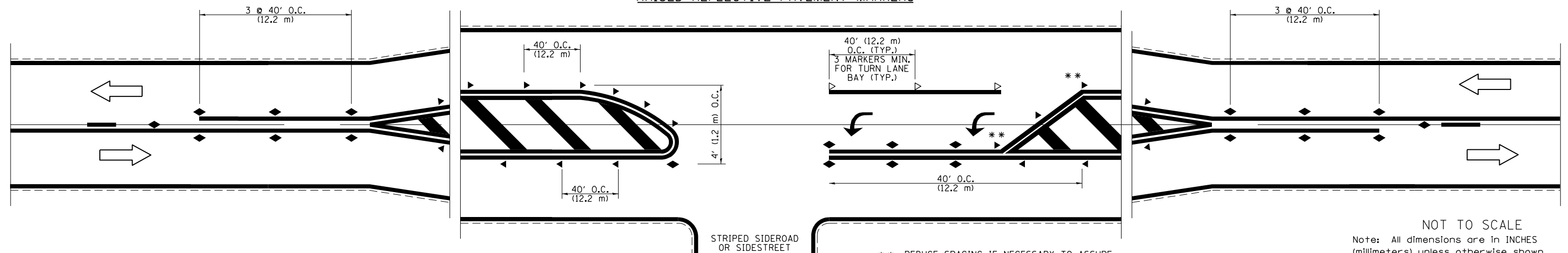

** REDUCE SPACING IF NECESSARY TO ASSURE MARKERS AT CORNER POINTS.

NOT TO SCALE
Note: All dimensions are in INCHES (millimeters) unless otherwise shown.

DISTRICT 7 DETAIL NO. 78000001

FILE NAME =	USER NAME = jessica.hille	DESIGNED -	REVISED - NAS 06/22
pw:\ilidot-pw\bentley.com\PWIDOT\Documents\IDOT Offices\District 7\Projects\74C43\CADD\Drawings\Drawings\74C43-sht-details.dgn		CHECKED -	REVISED -
PLOT SCALE = 100.0000' / in.		DATE -	REVISED -
PLOT DATE = 1/25/2024			

**STATE OF ILLINOIS
DEPARTMENT OF TRANSPORTATION**

**PAVEMENT MARKING AND RAISED REFLECTIVE PAVEMENT MARKERS
(RURAL & URBAN APPLICATIONS)**

SCALE: SHEET NO. 1 OF 4 SHEETS STA. TO STA.

F.A.P. RTE.	SECTION	COUNTY	TOTAL SHEETS	SHEET NO.
774	D7 CAPE SEAL 2024-1	VARIOUS	9	6
CONTRACT NO. 74C43				
ILLINOIS FED. AID PROJECT				

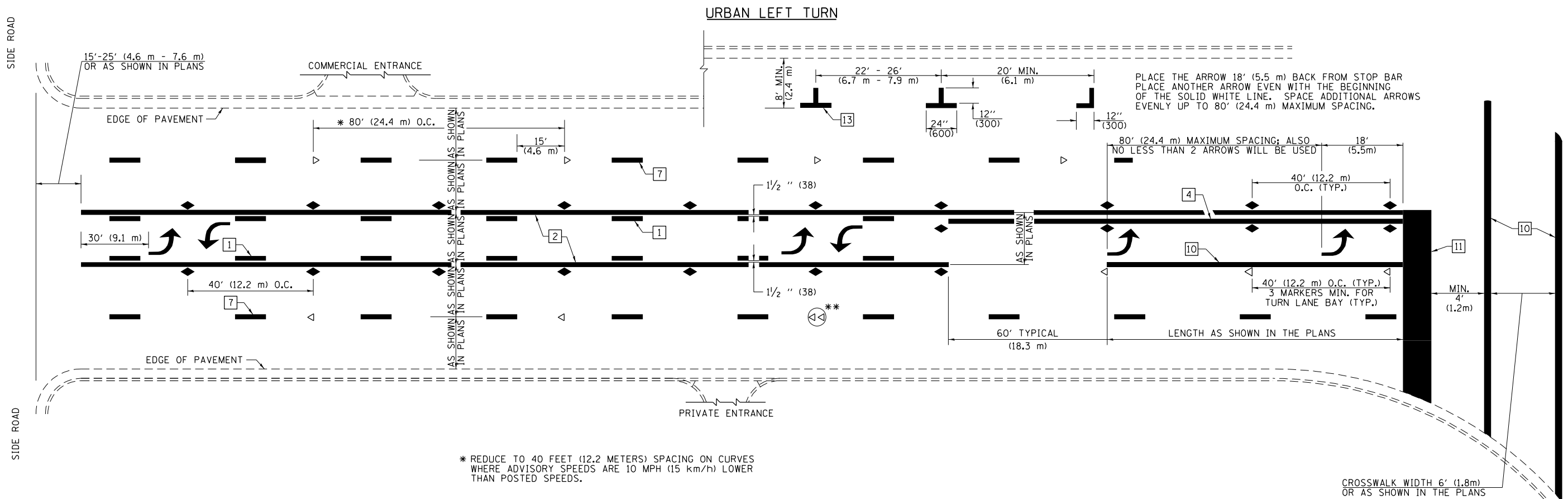

* REDUCE TO 40 FEET (12.2 METERS) SPACING ON CURVES WHERE ADVISORY SPEEDS ARE 10 MPH (15 km/h) LOWER THAN POSTED SPEEDS.

** DOUBLE LANE LINE MARKERS SHALL BE SPECIFIED AND SPACED AS SHOWN IN HIGHWAY STANDARD 781001 FOR MULTI-LANE DIVIDED AND UNDIVIDED HIGHWAYS.

PAVEMENT MARKING LEGEND

- 1 4" (100) SKIP-DASH (YELLOW)
- 2 4" (100) SOLID (YELLOW)
- 3 12" (300) DIAGONAL (YELLOW)
- 4 4" (100) DOUBLE YELLOW (NARROW)
- 5 12" (300) SOLID WHITE
- 6 4" (100) DOUBLE YELLOW (WIDE)
- 7 6" (150) SKIP-DASH (WHITE)
- 8 4" (100) SOLID (WHITE)
- 9 12" (300) DIAGONAL (WHITE)
- 10 6" (150) SOLID (WHITE)
- 11 24" (600) STOP BAR (WHITE)
- 12 8" (200) SOLID (WHITE)
- 13 4" (100) PARKING WHITE

GENERAL NOTES

1. TURN ARROW PAIRS SHALL BE PLACED AT 250' (75 m) INTERVALS AND SHALL BE EVENLY SPACED BETWEEN BOTH ENDS OF THE BIDIRECTIONAL LEFT TURN LANE. USE A MINIMUM OF TWO PAIRS PER BLOCK.
2. THE SOLID YELLOW PAVEMENT MARKINGS [2] SHOULD GENERALLY START OR END NEAR THE RADIUS POINT OF EACH STREET RETURN EXCEPT WHERE ONE OR BOTH ENDS WOULD INCLUDE STOP BARS.
3. THE SKIP-DASH PAVEMENT MARKINGS [1] OR [7] SHOULD BE CENTERED BETWEEN BOTH ENDS OF EACH CITY BLOCK AND SHALL BE PLACED SO THEY LINE UP ACROSS FROM EACH OTHER.
4. USE LARGE ARROW SIZE FOR BOTH RURAL AND URBAN LOCATIONS. (SEE SECTION 780 FOR SYMBOLS TABLE)
5. LANE LINE EXTENSIONS SHALL BE THE SAME COLOR AND WIDTH AS THE LANE LINE BEING EXTENDED.
6. ALL WHITE SKIP-DASH LINES SHALL BE 6" IN WIDTH.

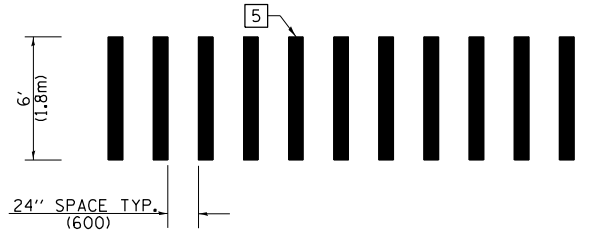

**CROSSWALK DETAIL
(DECATUR CITY LIMITS ONLY)**

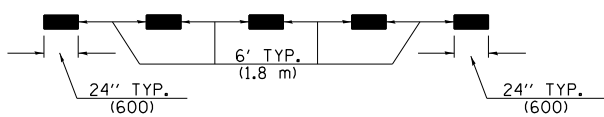

LANE LINE EXTENSIONS

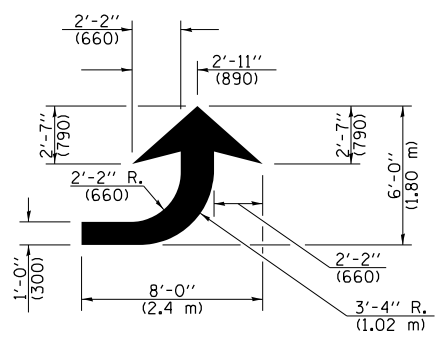

LEFT ARROW
REVERSE FOR RIGHT ARROW
AREA = 15.6 SQ. FT. (1.47 m²)
(WHITE)

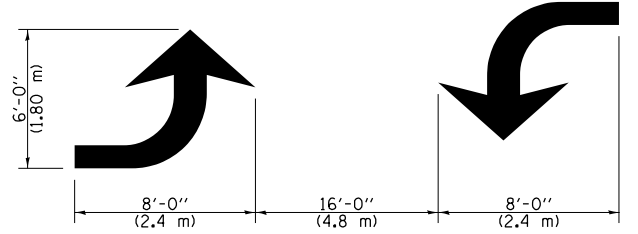

**TYPICAL DOUBLE
TURN ARROWS (WHITE)**

NOT TO SCALE

Note: All dimensions are in INCHES (millimeters) unless otherwise shown.

DISTRICT 7 DETAIL NO. 7800001

FILE NAME =	USER NAME = jessica.hille	DESIGNED -	REVISED - NAS 06/22
pw:\idot-pw\bentley.com\PWIDOT\Documents\IDOT Offices\District 7\Projects\74C43\CADD\Drawings\74C43-sht-details.dgn		CHECKED -	REVISED -
PLOT SCALE = 100.0000' / in.		DATE -	REVISED -
PLOT DATE = 1/25/2024			

**STATE OF ILLINOIS
DEPARTMENT OF TRANSPORTATION**

**PAVEMENT MARKING AND RAISED REFLECTIVE PAVEMENT MARKERS
(RURAL & URBAN APPLICATIONS)**

SCALE: SHEET NO. 2 OF 4 SHEETS STA. TO STA.

F.A.P. RTE.	SECTION	COUNTY	TOTAL SHEETS	SHEET NO.
774	D7 CAPE SEAL 2024-1	VARIOUS	9	7
CONTRACT NO. 74C43				
ILLINOIS FED. AID PROJECT				

ISLANDS

OPTION 1

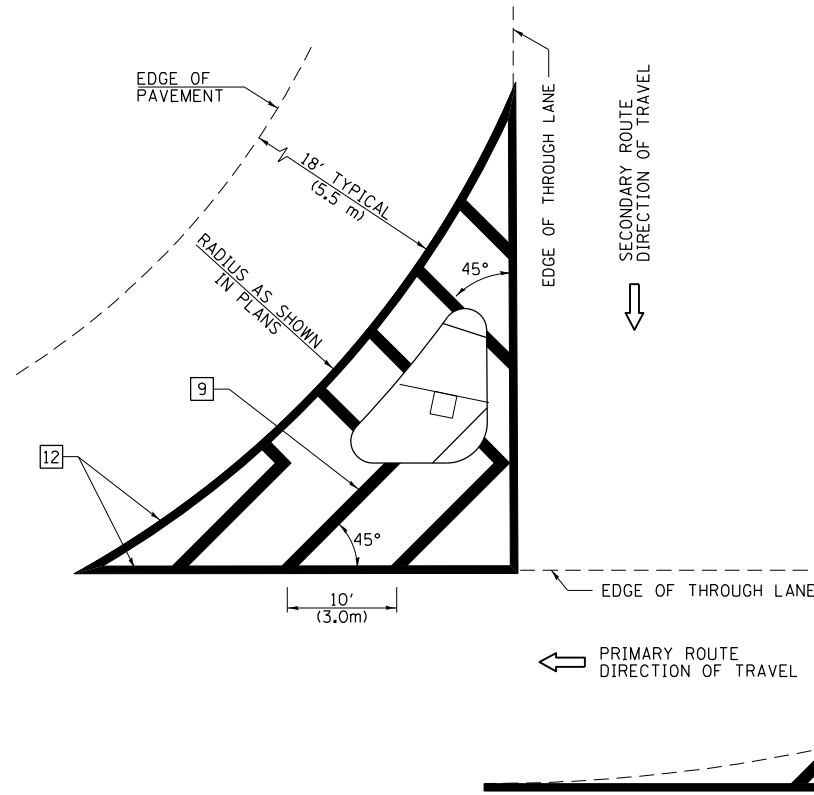

GENERAL NOTES

1. RAISED AND CORRUGATED MEDIANS SHALL BE OUTLINED WITH [2].
2. SOME OF THE INFORMATION INCLUDED WITH THIS DETAIL MAY NOT BE APPLICABLE TO THIS IMPROVEMENT.
3. PAVEMENT MARKINGS ARE TO BE EXTENDED THROUGH OMISSIONS WHEN APPLICABLE.
4. FINAL PAVEMENT MARKINGS SHALL BE IN PLACE PRIOR TO PLACING ANY RAISED REFLECTIVE PAVEMENT MARKERS.
5. THE FOLLOWING CRITERIA SHALL BE USED FOR SELECTING THE DIAGONAL PAVEMENT MARKING SPACING:

< 30 MPH (< 50 km/h)	15' (4.5 m)
30-45 MPH (50-75 km/h)	20' (6.0 m)
> 45 MPH (> 75 km/h)	30' (9.0 m)
6. THE USE OF ISLAND STRIPING OPTION 1 OR OPTION 2 SHALL BE AS SHOWN ON THE PLANS.

PAVEMENT MARKING LEGEND

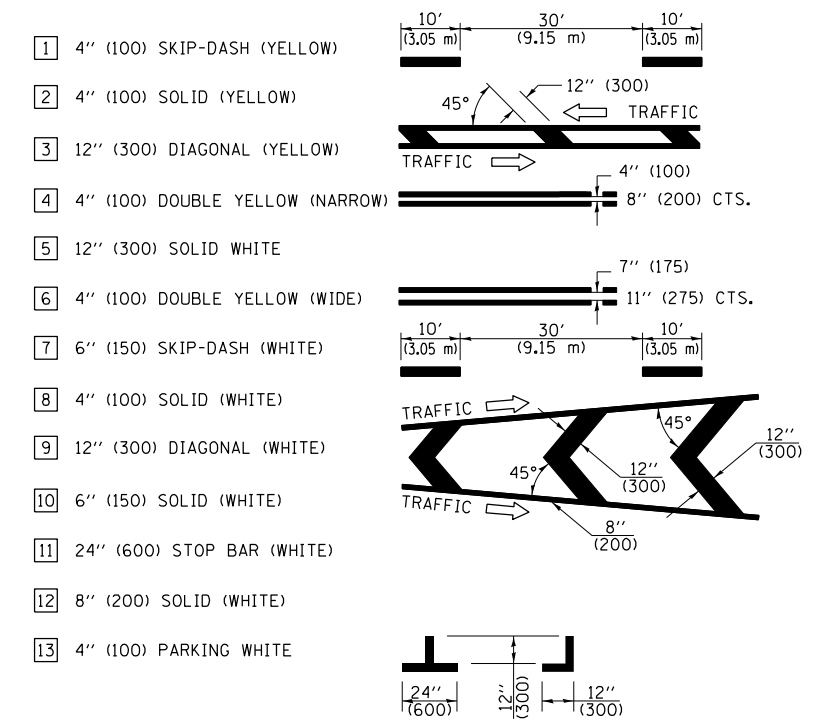

OPTION 2

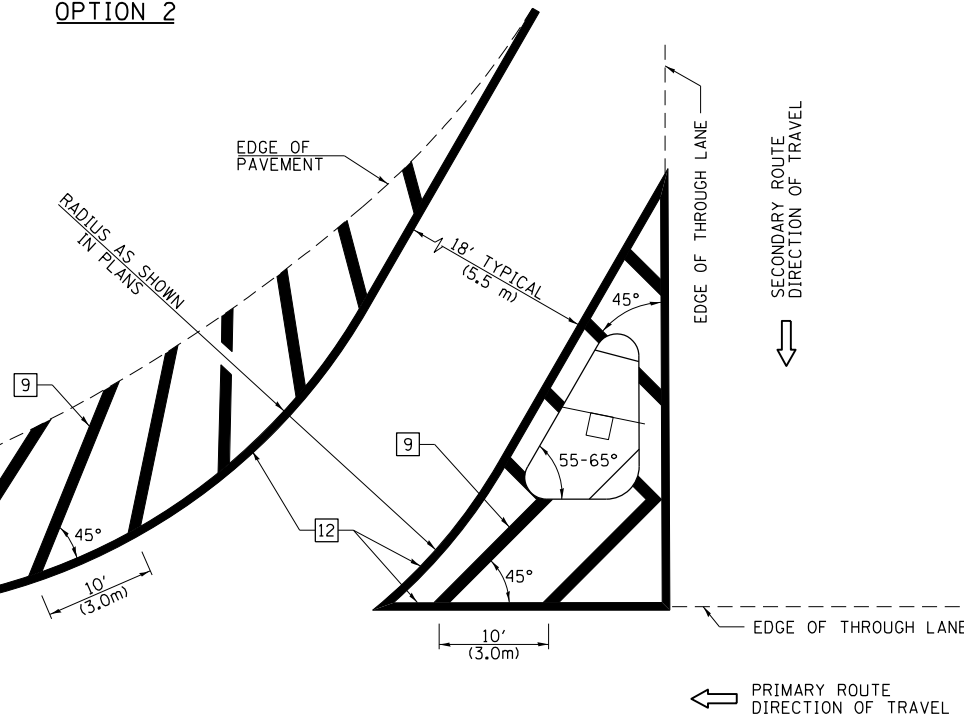

RURAL LEFT TURN STRIPING

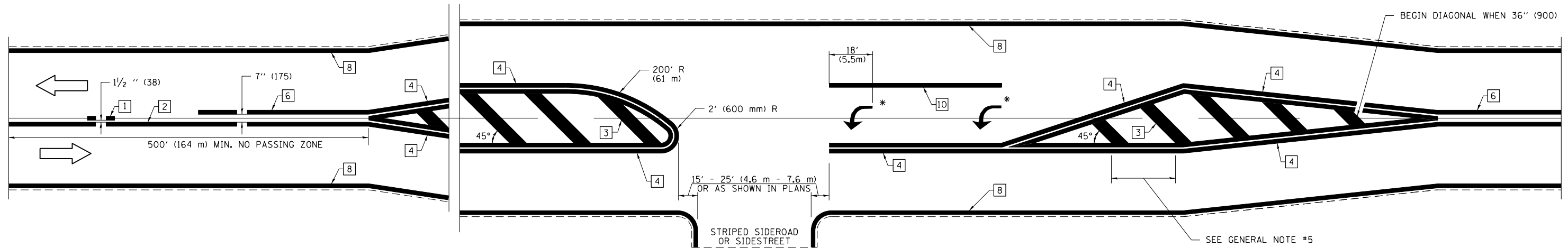

* PLACE AN ARROW 18' (5.5 m) BACK FROM END OF THE SOLID WHITE LINE. PLACE ANOTHER ARROW EVEN WITH THE BEGINNING OF THE SOLID WHITE LINE. SPACE ADDITIONAL ARROWS EVENLY UP TO 80' (24.4 m) MAXIMUM SPACING. USE MINIMUM OF 2 ARROWS.

NOT TO SCALE

Note: All dimensions are in INCHES (millimeters) unless otherwise shown.

DISTRICT 7 DETAIL NO. 78000001

FILE NAME =	USER NAME = jessica.hille	DESIGNED -	REVISED - NAS 06/22
p:\dot-pw-bentley.com\PWIDOT\Documents\DOT Offices\District 7\Projects\74C43\CADD\Drawings\Drawings\74C43-sht-details.dgn		CHECKED -	REVISED -
		DATE -	REVISED -

**STATE OF ILLINOIS
DEPARTMENT OF TRANSPORTATION**

**PAVEMENT MARKING AND RAISED REFLECTIVE PAVEMENT MARKERS
(RURAL & URBAN APPLICATIONS)**

SCALE: SHEET NO. 3 OF 4 SHEETS STA. TO STA.

F.A.P. RTE.	SECTION	COUNTY	TOTAL SHEETS	SHEET NO.
774	D7 CAPE SEAL 2024-1	VARIOUS	9	8
CONTRACT NO. 74C43				
ILLINOIS FED. AID PROJECT				

SUPPLEMENTAL PAVEMENT MARKING TREATMENT FOR RAILROAD-HIGHWAY GRADE CROSSING

PAVEMENT MARKING LEGEND

- 1 4" (100) SKIP-DASH (YELLOW)
 - 2 4" (100) SOLID (YELLOW)
 - 3 12" (300) DIAGONAL (YELLOW)
 - 4 4" (100) DOUBLE YELLOW (NARROW)
 - 5 12" (300) SOLID WHITE
 - 6 4" (100) DOUBLE YELLOW (WIDE)
 - 7 6" (150) SKIP-DASH (WHITE)
 - 8 4" (100) SOLID (WHITE)
 - 9 12" (300) DIAGONAL (WHITE)
 - 10 6" (150) SOLID (WHITE)
 - 11 24" (600) STOP BAR (WHITE)
 - 12 8" (200) SOLID (WHITE)
 - 13 4" (100) PARKING WHITE
-

PAVEMENT MARKINGS AT RAILROAD-HIGHWAY GRADE CROSSING

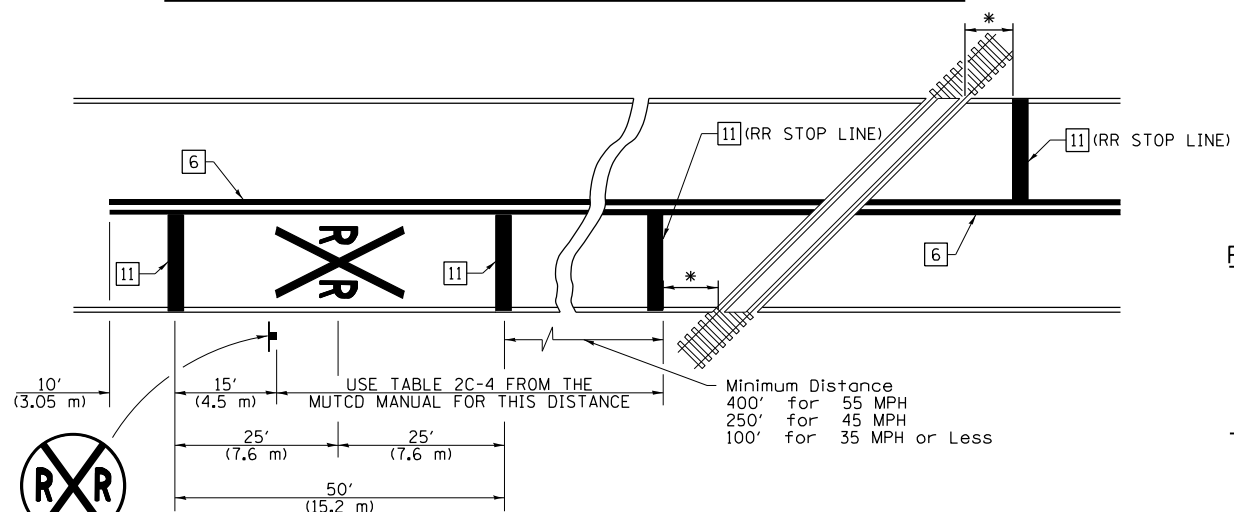

RAILROAD CROSSING WITH NON-SIGNALIZED INTERSECTION

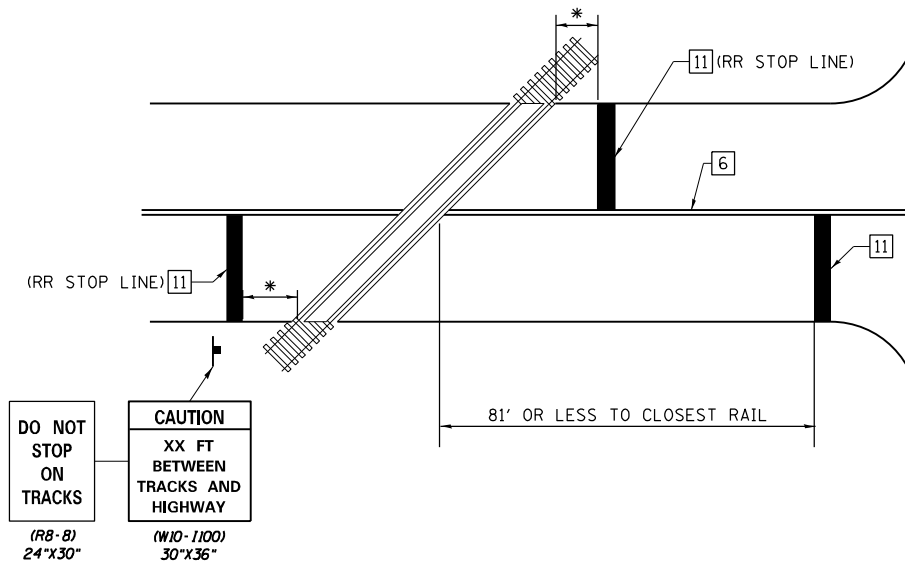

RAILROAD CROSSING WITH INTERCONNECT AND PRE-SIGNALS

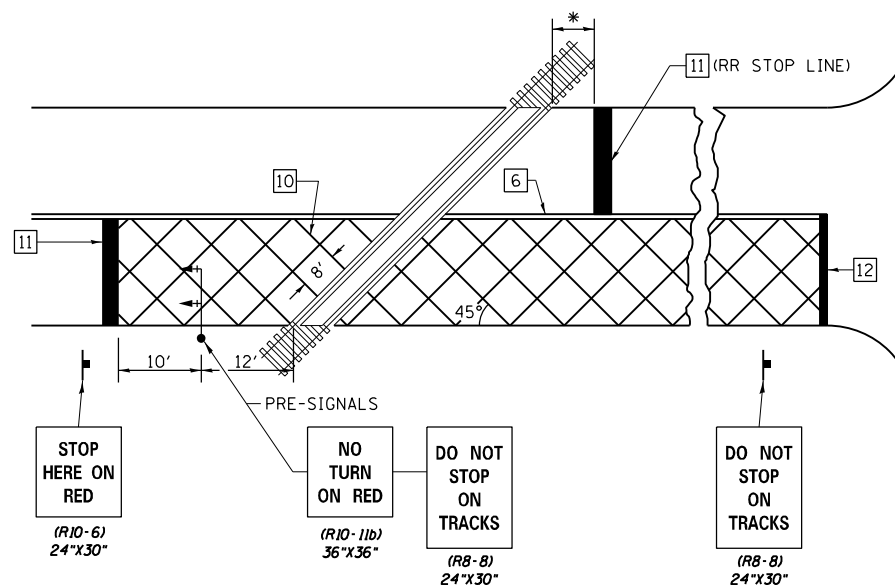

RAILROAD CROSSING WITH INTERCONNECT ONLY

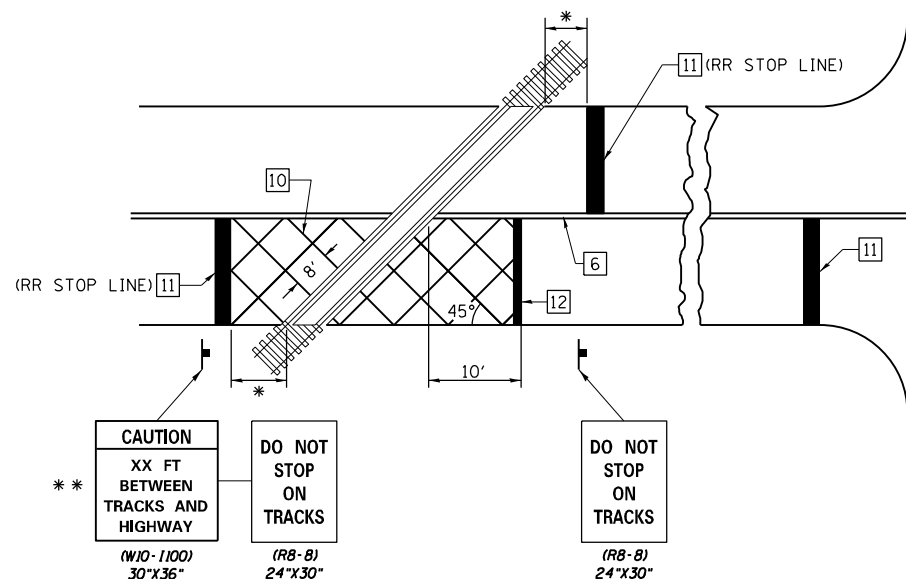

NOTES

THE TRAVERSE SPREAD OF THE "X" MAY VARY ACCORDING TO LANE WIDTH.

ON MULTI-LANE ROADS, THE STOP LINES SHALL EXTEND ACROSS ALL APPROACH LANES AND SEPARATE RRR SYMBOLS SHALL BE PLACED ADJACENT TO EACH OTHER IN EACH LANE.

WHEN THE PAVEMENT MARKING SYMBOL IS USED, A PORTION OF THE SYMBOL SHOULD BE LOCATED DIRECTLY ADJACENT TO THE ADVANCE WARNING SIGN (W10-1) AS PLACED BY TABLE II-1, CONDITION B OF THE MUTCD.

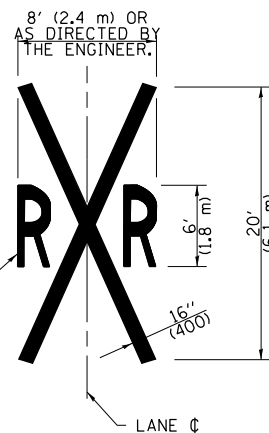

GENERAL NOTES

- SUPPLEMENTAL PAVEMENT MARKINGS TO BE INSTALLED ONLY ON APPROACHES TO INTERSECTIONS CONTROLLED BY TRAFFIC SIGNALS WHICH ARE INTERCONNECTED WITH THE RAILROAD WARNING SIGNALS.
- EXTEND PAVEMENT MARKINGS TO THE INTERSECTION ONLY WHERE PRE-SIGNALS ARE USED.
- WHEN PEDESTRIAN SIGNALS ARE PRESENT WITH INTERCONNECTED SIGNALS, WARNING SIGN W10-1101 (18"X24") SHALL BE PLACED NEAR EACH PEDESTRIAN SIGNAL HEAD. COUNTDOWN PEDESTRIAN SIGNAL HEADS SHALL NOT BE UTILIZED ALONG WITH INTERCONNECTED SIGNALS.
- PLEASE REFER TO THE IDOT BUREAU OF OPERATION MEMO OPS T-06 DATED DECEMBER 1, 2020 FOR ADDITIONAL INFORMATION.

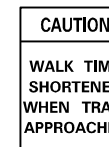

* 15' FROM NEAR RAIL OR 8' FROM AND PARALLEL TO GATE IF PRESENT

** WARNING SIGN W10-1100 SHALL BE USED AS AN INTERIM MEASURE AT INTERCONNECTED SIGNAL LOCATIONS WHERE PRE-SIGNALS ARE TO BE INSTALLED IN THE FUTURE. THIS SIGN SHALL BE REMOVED WHEN THE PRE-SIGNALS ARE INSTALLED AND THE PAVEMENT MARKINGS ARE EXTENDED TO THE INTERSECTION.

NOT TO SCALE
Note: All dimensions are in INCHES (millimeters) unless otherwise shown.

DISTRICT 7 DETAIL NO. 7800001

FILE NAME : ps\idot-ps-bentley.com\PIDOT\Documents\IDOT Offices\District 7\Projects\74C43\CADD\Drawings\Sheet\0774C43-sht-details.dgn	USER NAME : jessica.hille	DESIGNED - REVISOR -	REVISIONS - REVISOR -	DATE - DATE -	STATE OF ILLINOIS DEPARTMENT OF TRANSPORTATION	PAVEMENT MARKING AND RAISED REFLECTIVE PAVEMENT MARKERS (RURAL & URBAN APPLICATIONS)	F.A.P. RTE. 774	SECTION D7 CAPE SEALING 2024-1	COUNTY VARIOUS	TOTAL SHEETS 9	SHEET NO. 9
PLOT SCALE = 100.0000' / 1" =					SCALE: SHEET NO. 4 OF 4 SHEETS STA. TO STA.		CONTRACT NO. 74C43				
PLOT DATE = 1/25/2024					ILLINOIS FED. AID PROJECT						