

STATE OF ILLINOIS  
DEPARTMENT OF TRANSPORTATION

F.A.P. RTE.	SECTION	COUNTY	TOTAL SHEETS	SHEET NO.
304	(1BR)BDR,BRR,BJR,I	PIKE	23	1
		ILLINOIS	CONTRACT NO. 72223	

FOR LIST OF HIGHWAY STANDARDS, SEE SHEET NO. 2

INDEX OF SHEETS

- 1 COVER SHEET
- 2 GENERAL NOTES, COMMITMENTS, AND LIST OF STANDARDS
- 3 - 4 SUMMARY OF QUANTITIES
- 5 TYPICAL SECTIONS
- 6 SCHEDULES OF QUANTITIES
- 7 HORIZONTAL ALIGNMENT
- 8 ROADWAY PLAN
- 9 STAGING PLANS
- 10 STAGING CROSS SECTION
- 11 WIDTH RESTRICTION SIGNING DETAIL
- 12 - 20 STRUCTURE PLANS
- 21 APPROACH SLABS GUARDRAIL / INLET PLAN
- 22 - 23 ENTRANCE AND MAILBOX TURNOUT DETAILS

PROPOSED  
HIGHWAY PLANS

FAP ROUTE 304 (IL 96)  
SECTION (1BR)BDR,BRR,BJR,I  
PROJECT HBFP-NSTQ(006)  
BRIDGE DECK OVERLAY  
PIKE COUNTY

D-96-088-22

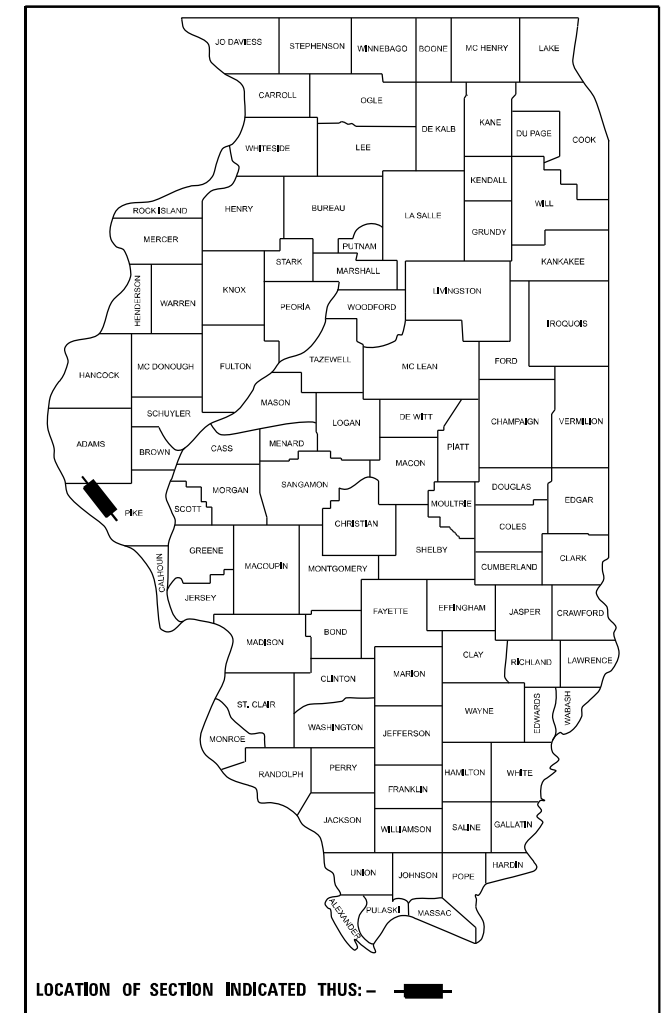

FUNCTIONAL CLASSIFICATION  
MINOR ARTERIAL

ADT (2021) = 1,250  
S.U. = 4.80% M.U. = 3.20%

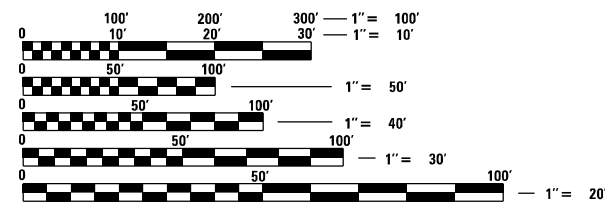

FULL SIZE PLANS HAVE BEEN PREPARED USING STANDARD ENGINEERING SCALES. REDUCED SIZED PLANS WILL NOT CONFORM TO STANDARD SCALES. IN MAKING MEASUREMENTS ON REDUCED PLANS, THE ABOVE SCALES MAY BE USED.

J.U.L.I.E.  
JOINT UTILITY LOCATION INFORMATION FOR EXCAVATION  
1-800-892-0123  
OR 811

PROJECT LOCATION:  
EXISTING BRIDGE SN 075-0036  
OVER HADLEY CREEK

C-96-030-23

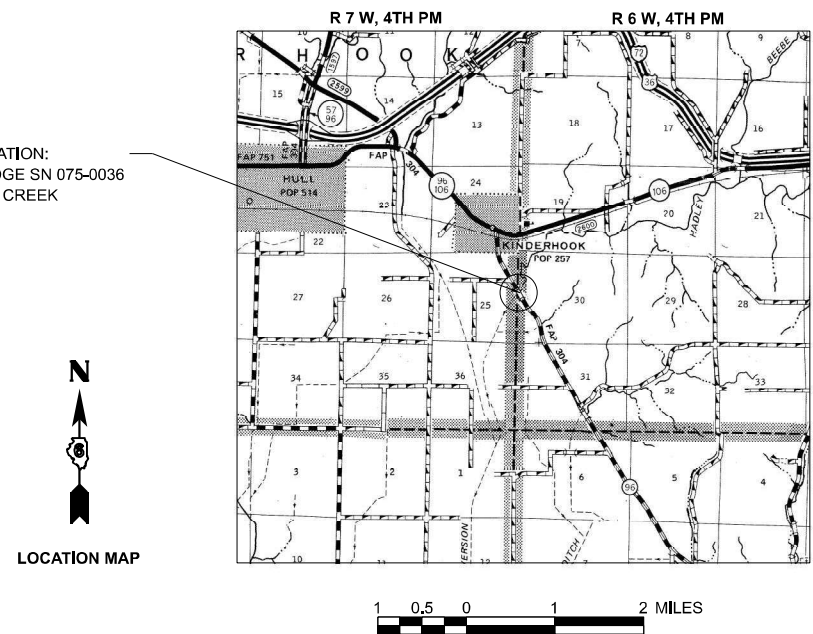

DATE: FEBRUARY 8 20 24  
EXPIRES: NOVEMBER 30 20 25

PROJECT ENGINEER JONATHAN KELLEY 217-785-2739  
PROJECT MANAGER ED KERN 217-524-7547

GROSS LENGTH = 758.00 FT. = 0.144 MILE  
NET LENGTH = 758.00 FT. = 0.144 MILE



CONTRACT NO. 72223

STATE OF ILLINOIS  
DEPARTMENT OF TRANSPORTATION

SUBMITTED February 13 20 24

*John P. Meyer*  
REGIONAL ENGINEER

March 22, 2024  
*Scott A. Etkin*  
ENGINEER OF DESIGN AND ENVIRONMENT

March 22, 2024  
*Stephen M. Smith*  
DIRECTOR OF HIGHWAYS PROJECT IMPLEMENTATION

PRINTED BY THE AUTHORITY  
OF THE STATE OF ILLINOIS

**GENERAL NOTES**

- ALL SAW CUTS NECESSARY TO COMPLETE THE WORK DETAILED IN THESE PLANS SHALL BE INCLUDED IN THE COST FOR THE VARIOUS PAY ITEMS INVOLVED
- THE FOLLOWING RATES OF APPLICATION HAVE BEEN USED TO CALCULATE PLAN QUANTITIES:
 

BITUMINOUS MATERIALS (TACK COAT)	0.05 LBS/SQ FT (ON EXISTING HMA, MILLED SURFACE, CONCRETE, MILLED/TINED CONCRETE)
BITUMINOUS MATERIALS (PRIME COAT)	0.25 LBS/SQ FT (ON AGGREGATE)
BITUMINOUS MATERIALS (TACK COAT)	0.025 LBS/SQ FT (BETWEEN HMA LIFTS, IL-4.75, BRICK)
HOT-MIX ASPHALT MATERIAL	0.056 TONS/SQ YD PER 1"
AGGREGATE MATERIAL	1.60 TONS/CU YD
- AREAS OF DECK REPAIRS SHOWN ARE ESTIMATED. THE ENGINEER SHALL SHOW ACTUAL LOCATIONS OF DECK REPAIRS ON AS-BUILT PLANS.
- THE CONTRACTOR SHALL SUBMIT A SEQUENCE OF CONSTRUCTION FOR APPROVAL TO THE RESIDENT ENGINEER BEFORE THIS PROJECT IS STARTED.
- IDOT DISTRICT 6 OPERATIONS TRAFFIC SIGNAL SECTION SHALL BE CONTACTED AT (217) 558-6718 FOR CONTROLLER PROGRAMMING AND TIMING APPROVAL PRIOR TO ACTIVATING THE TEMPORARY BRIDGE TRAFFIC SIGNALS.
- SYNTHETIC FIBERS ARE NOT REQUIRED FOR THE BRIDGE DECK MICROSILICA CONCRETE OVERLAY.
- ALL GUARDRAIL SHALL HAVE A PRELIMINARY LAYOUT. GUARDRAIL POSTS SHALL BE ADJUSTED TO MISS ANY SHOULDER DRAINS, INLETS, PIPE CULVERTS, STORM SEWER OR ANY OTHER HAZARD THAT MAY INTERFERE WITH GUARDRAIL CONSTRUCTION.
- ALL TEMPORARY PAVEMENT MARKING TAPE THAT IS TO REMAIN IN PLACE LONGER THAN 14 DAYS SHALL BE TYPE IV TAPE.
- FOR HORIZONTAL CONTROL AND CENTERLINE ALIGNMENT METADATA, PLEASE CONTACT IDOT DISTRICT 6 CHIEF OF SURVEYS AT 217-782-8707.
- THE CONTRACTOR MUST CONTACT IDOT DISTRICT 6 BUREAU OF OPERATIONS (217-785-5306) 21 DAYS IN ADVANCE OF IMPLEMENTING ANY WIDTH RESTRICTION SIGNING AND 3 WEEKS IN ADVANCE OF PLACING ANY TRAFFIC CONTROL.

**LIST OF STANDARDS**

000001-08	STANDARD SYMBOLS, ABBREVIATIONS AND PATTERNS
001001-02	AREAS OF REINFORCEMENT BARS
001006	DECIMAL OF AN INCH AND OF A FOOT
420001-10	PAVEMENT JOINTS
542401-04	METAL FLARED END SECTION FOR PIPE
610001-09	SHOULDER INLET WITH CURB
630001-13	STEEL PLATE BEAM GUARDRAIL
630301-09	SHOULDER WIDENING FOR TYPE 1 (SPECIAL) GUARDRAIL TERMINALS
631031-18	TRAFFIC BARRIER TERMINAL, TYPE 6
701001-02	OFF-ROAD OPERATIONS, 2L, 2W, MORE THAN 15' (4.5 M) AWAY
701006-05	OFF-ROAD OPERATIONS, 2L, 2W, 15' (4.5 M) TO 24" (600 MM) FROM PAVEMENT EDGE
701201-05	LANE CLOSURE, 2L 2W, DAY ONLY, FOR SPEEDS >= 45 MPH
701301-04	LANE CLOSURE, 2L, 2W, SHORT TIME OPERATIONS
701311-03	LANE CLOSURE, 2L, 2W, MOVING OPERATIONS-DAY ONLY
701321-18	LANE CLOSURE, 2L, 2W, BRIDGE REPAIR WITH BARRIER
701901-09	TRAFFIC CONTROL DEVICES
725001-01	OBJECT AND TERMINAL MARKERS
704001-08	TEMPORARY CONCRETE BARRIER
780001-05	TYPICAL PAVEMENT MARKINGS
782006-01	GUARDRAIL AND BARRIER WALL REFLECTOR MOUNTING DETAILS

**COMMITMENTS**

THERE ARE NO COMMITMENTS.

THE FOLLOWING MIXTURE REQUIREMENTS FOR THIS PROJECT:

MIXTURE USE(S)	HMA SURFACE CSE	HMA SHOULDERS	HMA SHOULDERS LOWER LIFTS
AC/PG	PG 64-22	PG 64-22	PG 64-22
DESIGN AIR VOIDS	4.0% @ N50	4.0% @ N50	4.0% @ N50
MIX COMPOSITION (GRADATION MIXTURE)	IL-9.5	IL-19.0	IL-19.0
FRICTION AGGREGATE	MIX "C"	N/A	N/A
QUALITY MANAGEMENT	QC/QA	QC/QA	QC/QA
SUBLOT SIZE	N/A	N/A	N/A

**STATE OF ILLINOIS  
DEPARTMENT OF TRANSPORTATION  
DIVISION OF HIGHWAYS  
DISTRICT 6**

EXAMINED January, 24 20 24

*[Signature]*  
ENGINEER OF OPERATIONS

EXAMINED January, 19 20 24

*[Signature]*  
ENGINEER OF PROJECT IMPLEMENTATION

EXAMINED January, 26 20 24

*[Signature]*  
ENGINEER OF PROGRAM DEVELOPMENT

REV. - MS

MODEL: Sheet FILE NAME: I:\21046.09 IDOT D6 - P18 198-030 - W09 - Pike County 72223\CA01bna\CA01bna\0612223\_sht Gen Note.dgn



USER NAME = msutheard	DESIGNED -	REVISED -
PLOT SCALE = 0.16666633 1/in.	DRAWN -	REVISED -
PLOT DATE = 2/9/2024	CHECKED -	REVISED -
	DATE -	REVISED -

**STATE OF ILLINOIS  
DEPARTMENT OF TRANSPORTATION**

**GENERAL NOTES, COMMITMENTS, AND  
LIST OF STANDARDS**

SCALE: SHEET OF SHEETS STA. TO STA.

F.A.P. RTE.	SECTION	COUNTY	TOTAL SHEETS	SHEET NO.
304	(1BR)BDR,BRR,BJR,I	PIKE	23	2
CONTRACT NO. 72223				
ILLINOIS FED. AID PROJECT				

CODE NO.	ITEM	UNIT	TOTAL QUANTITY	CONSTRUCTION CODE
				6-01069-0000
				BFP 80% FED. 20% STATE
				BRIDGE
0047				
075-0036				
20800150	TRENCH BACKFILL	CU YD	6	6
40600290	BITUMINOUS MATERIALS (TACK COAT)	POUND	516	516
40600982	HOT-MIX ASPHALT SURFACE REMOVAL - BUTT JOINT	SQ YD	498	498
40600990	TEMPORARY RAMP	SQ YD	84	84
40604050	HOT-MIX ASPHALT SURFACE COURSE, IL-9.5, MIX "C", N50	TON	48	48
48102100	AGGREGATE WEDGE SHOULDER, TYPE B	TON	24	24
48203042	HOT-MIX ASPHALT SHOULDERS, 11 1/4"	SQ YD	426	426
48203100	HOT-MIX ASPHALT SHOULDERS	TON	44	44
50102400	CONCRETE REMOVAL	CU YD	11.8	11.8
50105220	PIPE CULVERT REMOVAL	FOOT	170	170
50300255	CONCRETE SUPERSTRUCTURE	CU YD	14.2	14.2
50300260	BRIDGE DECK GROOVING	SQ YD	1214	1214
50300300	PROTECTIVE COAT	SQ YD	1300	1300
50800205	REINFORCEMENT BARS, EPOXY COATED	POUND	1380	1380

CODE NO.	ITEM	UNIT	TOTAL QUANTITY	CONSTRUCTION CODE
				6-01069-0000
				BFP 80% FED. 20% STATE
				BRIDGE
0047				
075-0036				
50800515	BAR SPLICERS	EACH	16	16
52000110	PREFORMED JOINT STRIP SEAL	FOOT	88	88
542D0217	PIPE CULVERTS, CLASS D, TYPE 1 12"	FOOT	170	170
54262712	METAL FLARED END SECTIONS 12"	EACH	4	4
60500060	REMOVING INLETS	EACH	4	4
61000335	TYPE G INLET BOX, STANDARD 610001	EACH	4	4
* 63000001	STEEL PLATE BEAM GUARDRAIL, TYPE A, 6 FOOT POSTS	FOOT	100	100
* 63100085	TRAFFIC BARRIER TERMINAL, TYPE 6	EACH	4	4
* 63100167	TRAFFIC BARRIER TERMINAL, TYPE 1 (SPECIAL) TANGENT	EACH	4	4
63200310	GUARDRAIL REMOVAL	FOOT	500	500
67000400	ENGINEER'S FIELD OFFICE, TYPE A	CAL MO	6	6
67100100	MOBILIZATION	L SUM	1	1
70100405	TRAFFIC CONTROL AND PROTECTION, STANDARD 701321	EACH	1	1
70100450	TRAFFIC CONTROL AND PROTECTION, STANDARD 701201	L SUM	1	1

\* SPECIALTY ITEM

MODEL SHEET  
 FILE NAME: S:\21046.09\DOT D6 - PTB 198-030 - W09 - Pike County 72223\CA01\sheet0672223\_sht\_500.dgn

REV. - MS



USER NAME = myoung	DESIGNED -	REVISED -
PLOT SCALE = 0.16666633 1/16"	DRAWN -	REVISED -
PLOT DATE = 2/9/2024	CHECKED -	REVISED -
	DATE -	REVISED -

**STATE OF ILLINOIS**  
**DEPARTMENT OF TRANSPORTATION**

**SUMMARY OF QUANTITIES**

SCALE: SHEET OF SHEETS STA. TO STA.

F.A.P. RTE.	SECTION	COUNTY	TOTAL SHEETS	SHEET NO.
304	(1BR)BDR,BRR,BJR,I	PIKE	23	3
ILLINOIS FED. AID PROJECT			CONTRACT NO. 72223	

CODE NO.	ITEM	UNIT	TOTAL QUANTITY	CONSTRUCTION CODE
				6-01069-0000
				BFP 80% FED. 20% STATE
				BRIDGE
				0047
				075-0036
70106500	TEMPORARY BRIDGE TRAFFIC SIGNALS	EACH	1	1
70106700	TEMPORARY RUMBLE STRIPS	EACH	6	6
70107025	CHANGEABLE MESSAGE SIGN	CAL DA	300	300
70300100	SHORT TERM PAVEMENT MARKING	FOOT	116	116
70300150	SHORT TERM PAVEMENT MARKING REMOVAL	SQ FT	39	39
70400100	TEMPORARY CONCRETE BARRIER	FOOT	538	538
70400200	RELOCATE TEMPORARY CONCRETE BARRIER	FOOT	538	538
70600260	IMPACT ATTENUATORS, TEMPORARY (FULLY REDIRECTIVE, NARROW), TEST LEVEL 3	EACH	2	2
70600332	IMPACT ATTENUATORS, RELOCATE (FULLY REDIRECTIVE, NARROW), TEST LEVEL 3	EACH	2	2
* 72501000	TERMINAL MARKER - DIRECT APPLIED	EACH	4	4
* 78009005	MODIFIED URETHANE PAVEMENT MARKING - LINE 5"	FOOT	1766	1766
* 78200005	GUARDRAIL REFLECTORS, TYPE A	EACH	16	16
* 78200011	BARRIER WALL REFLECTORS, TYPE C	EACH	10	10
78300202	PAVEMENT MARKING REMOVAL - WATER BLASTING	SQ FT	560	560

CODE NO.	ITEM	UNIT	TOTAL QUANTITY	CONSTRUCTION CODE
				6-01069-0000
				BFP 80% FED. 20% STATE
				BRIDGE
				0047
				075-0036
X1200030	FILLING INLETS, TEMPORARY	EACH	2	2
X2020060	EXCAVATING AND GRADING EXISTING SHOULDER, (SPECIAL)	UNIT	8	8
X7200201	WIDTH RESTRICTION SIGNING	L SUM	1	1
Z0001800	APPROACH SLAB REPAIR (PARTIAL DEPTH)	SQ YD	13	13
Z0001905	STRUCTURAL STEEL REPAIR	POUND	310	310
Z0012130	BRIDGE DECK SCARIFICATION 3/4"	SQ YD	1261	1261
Z0012164	BRIDGE DECK MICROSILICA CONCRETE OVERLAY 2 1/2"	SQ YD	1261	1261
Z0013798	CONSTRUCTION LAYOUT	L SUM	1	1
∅ Z0076600	TRAINEES	HOURL	500	500
Z0015500	DEBRIS REMOVAL	L SUM	1	1
∅ Z0076604	TRAINEES TRAINING PROGRAM GRADUATE	HOURL	500	500
Z0016002	DECK SLAB REPAIR (FULL DEPTH, TYPE II)	SQ YD	80	80

\* SPECIALTY ITEM

∅ 0042

REV. - MS

MODEL: Sheet 2  
FILE NAME: S221046.09 IDOT D6 - PTB 198-030 - W09 - Pike County 72223 CADDrawnCADsheets0672223\_sht\_500.dgn



USER NAME = msutheard  
DESIGNED -  
DRAW N -  
PLOT SCALE = 0.16666633 1/in.  
PLOT DATE = 2/9/2024

REVISD -  
REVISD -  
REVISD -  
REVISD -

DATE -

STATE OF ILLINOIS  
DEPARTMENT OF TRANSPORTATION

SUMMARY OF QUANTITIES  
SCALE: SHEET OF SHEETS STA. TO STA.

F.A.P. RTE.	SECTION	COUNTY	TOTAL SHEETS	SHEET NO.
304	(1B R)B DR,B RR,B JR,I	PIKE	23	4
CONTRACT NO. 72223			ILLINOIS FED. AID PROJECT	



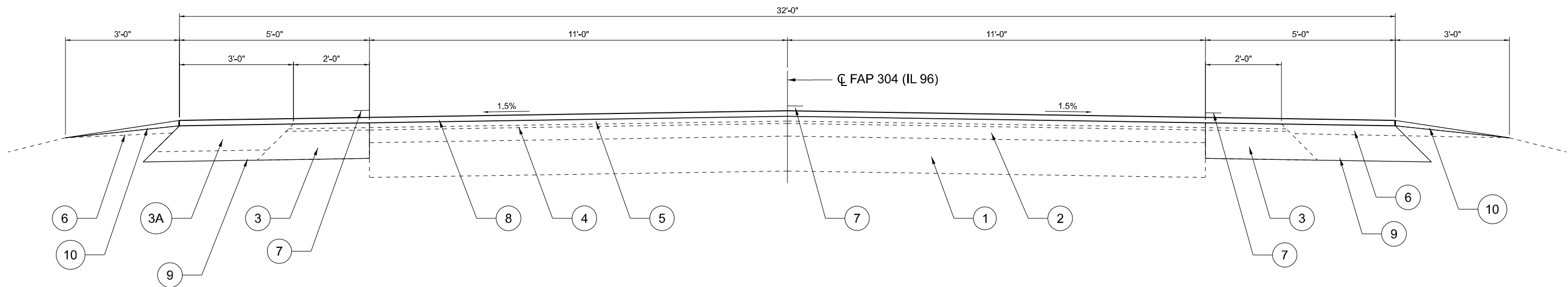

**TYPICAL SECTION (SN 075-0036)**

STA. 34+00 TO STA. 41+48  
 BRIDGE & APPROACH PAVEMENT  
 STA. 35+67 TO STA. 39+91

- ① EXISTING AGGREGATE BASE COURSE - 11"
- ② EXISTING BITUMINOUS RESURFACING - 4"
- ③ EXISTING BITUMINOUS CONCRETE BASE COURSE WIDENING, 9"
- ③A EXISTING BITUMINOUS SHOULDER - 8"
- ④ EXISTING BITUMINOUS LEVELING BINDER - 3/4"
- ⑤ EXISTING BITUMINOUS SURFACE COURSE, MIXTURE C. - 1 1/2"
- ⑥ EXISTING AGGREGATE SHOULDER
- ⑦ PROPOSED MODIFIED URETHANE PAVEMENT MARKING LINE - 5"
- ⑧ PROPOSED HMA SURF. COURSE, IL 9.5, MIX "C", N50 ( 1 3/4")
- ⑨ PROPOSED HMA SHOULDERS, 11 1/4"
- ⑩ PROPOSED AGGREGATE WEDGE SHOULDER

MODEL SHEET  
 FILE NAME: \\21310465.09\DOT\DG-PTB-199-030-1\09-PRG County 72223\CADD\Bids\CAD\Sheets\072223\_sht\_Typical.dgn



USER NAME = msutheard	DESIGNED -	REVISED -
PLOT SCALE = 0.16666633 1/16 in.	DRAWN -	REVISED -
PLOT DATE = 2/9/2024	CHECKED -	REVISED -
	DATE -	REVISED -

**STATE OF ILLINOIS  
 DEPARTMENT OF TRANSPORTATION**

SCALE:		TYPICAL SECTIONS	
		SHEET OF SHEETS	STA. TO STA.

F.A.P. RTE. 304	SECTION (1BR)BDR,BRR,BJR,I	COUNTY PKE	TOTAL SHEETS 23	SHEET NO. 5
CONTRACT NO. 72223			ILLINOIS FED. AID PROJECT	

PAVEMENT MARKING SCHEDULE

LOCATION	COMMENT	SHORT TERM PAVEMENT MARKING	SHORT TERM PAVEMENT MARKING REMOVAL	MODIFIED URETHANE PAVEMENT MARKING - LINE 5"		PAVEMENT MARKING REMOVAL WATER BLASTING
				WHITE	YELLOW	
				70300100	70300150	
STATION TO STATION		FOOT	SQ FT	FOOT	FOOT	SQ FT
34+97	35+67	MILLED BUTT JOINT	8	3		
32+73	42+84	FINAL SURFACE	100	33	1516	250
39+91	40+61	MILLED BUTT JOINT	8	3		
32+73	42+84	CENTERLINE				104
34+00	35+67	LT EDGE LINE				70
39+91	41+58	LT EDGE LINE				70
34+00	41+58	RT EDGE LINE				316
SUBTOTAL					1516	250
TOTAL			116	39	1766	560

INLET SCHEDULE

LOCATION	TRENCH BACKFILL	PIPE CULVERT REMOVAL	PIPE CULVERTS, CLASS D, TYPE 1 12"	METAL FLARED END SECTIONS 12"	REMOVING INLETS	TYPE G INLET BOX, STANDARD 610001	FILLING INLETS, TEMPORARY
STATION	CU YD	FOOT	FOOT	EACH	EACH	EACH	EACH
35+75 LT	1.5	42.0	42.0	1	1	1	
36+02 RT	1.5	26.0	26.0	1	1	1	1
39+55 LT	1.5	47.0	47.0	1	1	1	
39+81 RT	1.5	55.0	55.0	1	1	1	1
TOTAL	6	170	170	4	4	4	2

GUARDRAIL SCHEDULE

LOCATION	COMMENT	STEEL PLATE BEAM GUARDRAIL, TYPE A, 6 FOOT POSTS	TRAFFIC BARRIER TERMINAL, TYPE 6	TRAFFIC BARRIER TERMINAL, TYPE 1 (SPECIAL) TANGENT	GUARDRAIL REMOVAL	TERMINAL MARKER - DIRECT APPLIED	GUARDRAIL REFLECTORS, TYPE A						
								63000001	63100085	63100167	63200310	72501000	78200005
								FOOT	EACH	EACH	FOOT	EACH	EACH
STATION TO STATION													
34+77	36+02	NE	25	1	1	125.0	1	4					
34+90	36+27	NW	37.5	1	1	137.5	1	4					
39+30	40+43	SE	12.5	1	1	112.5	1	4					
39+66	40+91	SW	25	1	1	125.0	1	4					
TOTAL			100	4	4	500.0	4	16					

PAVING SCHEDULE

LOCATION	WIDTH	LENGTH	BITUMINOUS MATERIALS (TACK COAT)	HOT-MIX ASPHALT SURFACE REMOVAL - BUTT JOINT	TEMPORARY RAMP	HOT-MIX ASPHALT SURFACE COURSE, 1L-9.5, MIX "C", N50
STATION TO STATION			POUND	SQ YD	SQ YD	TON
34+97	35+67	32.00	70.00		249.0	
34+97	35+97.5	32.00	100.50	160.0		
34+97	35+97.5	22.00	100.50			24.0
34+97	35+97.5	32.00	2 @ 5.83		42.0	
39+61.3	40+61	32.00	99.70	160.0		
39+61.3	40+61	22.00	99.70			24.0
39+91	40+61	32.00	70.00		249.0	
39+61.3	40+61	32.00	2 @ 5.83		42.0	
TOTAL			320	498	84	48

SHOULDER SCHEDULE

LOCATION	LENGTH	SHLDR WIDTH	AREA	BITUMINOUS MATERIALS (TACK COAT)	AGGREGATE WEDGE SHOULDER, TYPE B	HOT-MIX ASPHALT SHOULDERS, 1 1/4"	HOT-MIX ASPHALT SHOULDERS	EXCAVATING AND GRADING EXISTING SHOULDER (SPECIAL)
STATION TO STATION				POUND	TON	SQ YD	TON	UNIT
34+00	35+70 LT	170	850	44		95	10	2
34+00	35+84 LT				6			
34+00	35+96 RT	196	980	50		109	11	2
34+00	36+11 RT				6			
39+48	41+58 RT				6			
39+62	41+58 LT	196	784	58		127	13	2
39+75	41+58 RT				6			
39+88	41+58 RT	170	850	44		95	10	2
TOTAL				196	24	426	44	8

BARRIER WALL SCHEDULE

LOCATION	TEMPORARY CONCRETE BARRIER	RELOCATE TEMPORARY CONCRETE BARRIER	IMPACT ATTENUATORS, TEMPORARY (FULLY REDIRECTIVE, NARROW), TEST LEVEL 3	IMPACT ATTENUATORS, RELOCATE (FULLY REDIRECTIVE, NARROW), TEST LEVEL 3
STAGE	FOOT	FOOT	EACH	EACH
SN 075-0036	1	537.5	2	
	2		537.5	2
TOTAL	538	538	2	2

MODEL SHEET  
FILE NAME: \\12110465.09\DOT\06-PTB-199-030-1\W09-Pike County 72223\CADD\Info\CADDsheets\0672223\_sht\_Schedules.dgn



USER NAME = msutheard  
DESIGNED -  
DRAWN -  
CHECKED -  
DATE -  
PLOT SCALE = 0.16666633 1/16"  
PLOT DATE = 3/8/2024

REVISOR -  
REVISOR -  
REVISOR -  
REVISOR -

STATE OF ILLINOIS  
DEPARTMENT OF TRANSPORTATION

SCHEDULES OF QUANTITIES

SCALE: SHEET OF SHEETS STA. TO STA.

F.A.P. RTE.	SECTION	COUNTY	TOTAL SHEETS	SHEET NO.
304	(1BR)BDR,BRR,BJR,I	PIKE	23	6

CONTRACT NO. 72223  
ILLINOIS FED. AID PROJECT

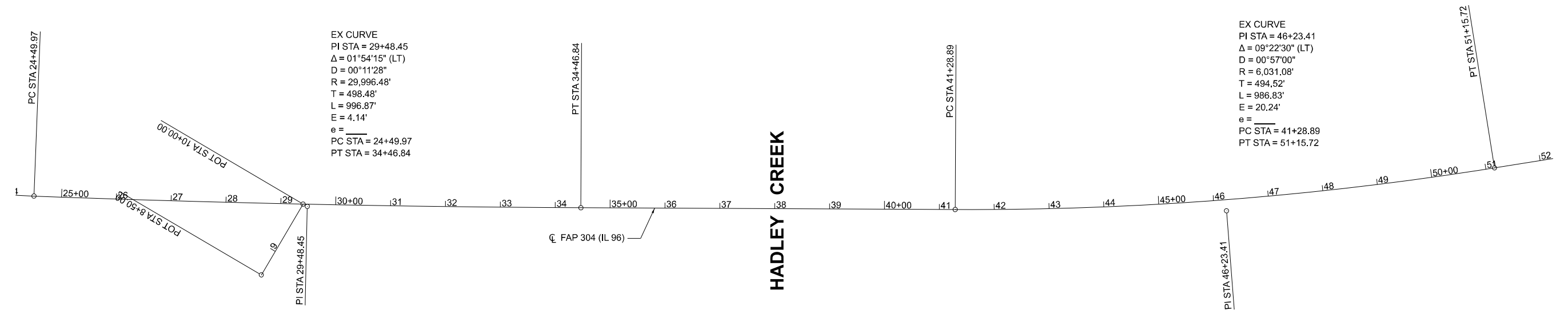
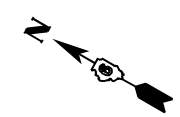

HORIZONTAL COORDINATES			
POINT	NORTHING	EASTING	STATION
PC	1104529.146	2019528.246	24+49.97
PI	1104088.295	2019760.910	29+48.45
PT	1103655.418	2020008.094	34+46.84
PC	1103063.130	2020346.305	41+28.89
PI	1102633.692	2020591.526	46+23.41
PT	1102249.935	2020903.424	51+15.72

MODEL SHEET  
 FILE NAME: J:\210465.09\DOT D6 - PTB 199-030 - W09 - Pike County 72223\CADD\B1\CADD\sheet\067223\_sht\_07B.dgn



USER NAME = msutheard  
 PLOT SCALE = 0.16666633 1/in.  
 PLOT DATE = 2/9/2024

DESIGNED -  
 DRAWN -  
 CHECKED -  
 DATE -

REVISED -  
 REVISED -  
 REVISED -  
 REVISED -

**STATE OF ILLINOIS**  
**DEPARTMENT OF TRANSPORTATION**

**HORIZONTAL ALIGNMENT**  
 SCALE: SHEET OF SHEETS STA. TO STA.

F.A.P. RTE.	SECTION	COUNTY	TOTAL SHEETS	SHEET NO.
304	(1BR)BDR,BRR,BJR,I	PIKE	23	7
CONTRACT NO. 72223				
ILLINOIS FED. AID PROJECT				

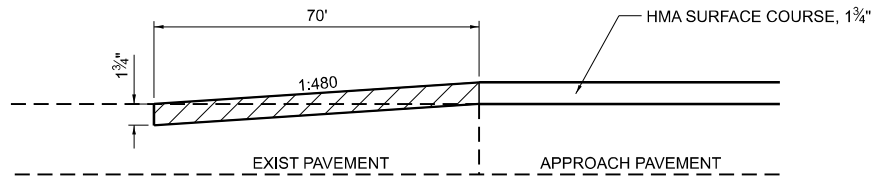

PE NOTE: CONSTRUCT PE / MB TURNOUT WITH HMA SHOULDER 11 1/4"



GUARDRAIL REMOVAL  
TRAFFIC BARRIER TERMINAL, TYPE 6  
STEEL PLATE BEAM GUARDRAIL, TYPE A, 6' POSTS  
TRAFFIC BARRIER TERMINAL, TYPE 1, (SPECIAL) TANGENT

GUARDRAIL REMOVAL  
TRAFFIC BARRIER TERMINAL, TYPE 6  
STEEL PLATE BEAM GUARDRAIL, TYPE A, 6' POSTS  
TRAFFIC BARRIER TERMINAL, TYPE 1, (SPECIAL) TANGENT

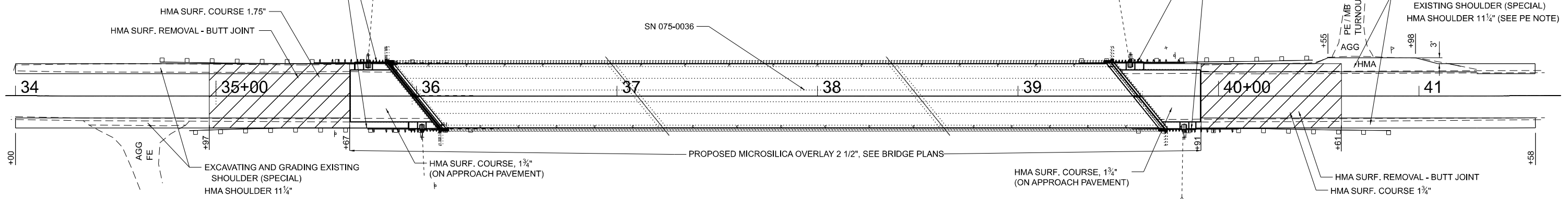

NOTE: REPAIR AREAS ARE FOR INFORMATION ONLY

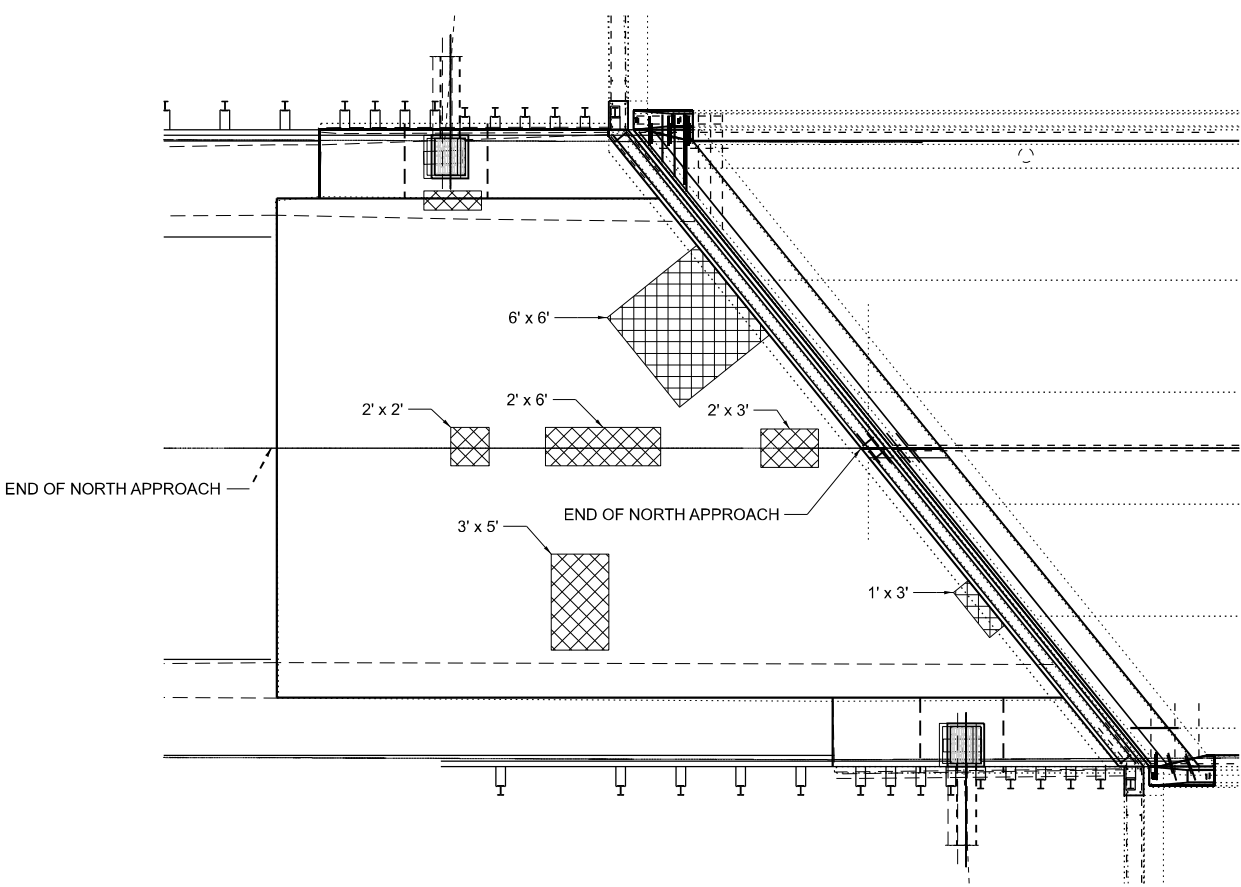

**NORTH APPROACH PAVEMENT PATCHING PARTIAL DEPTH**

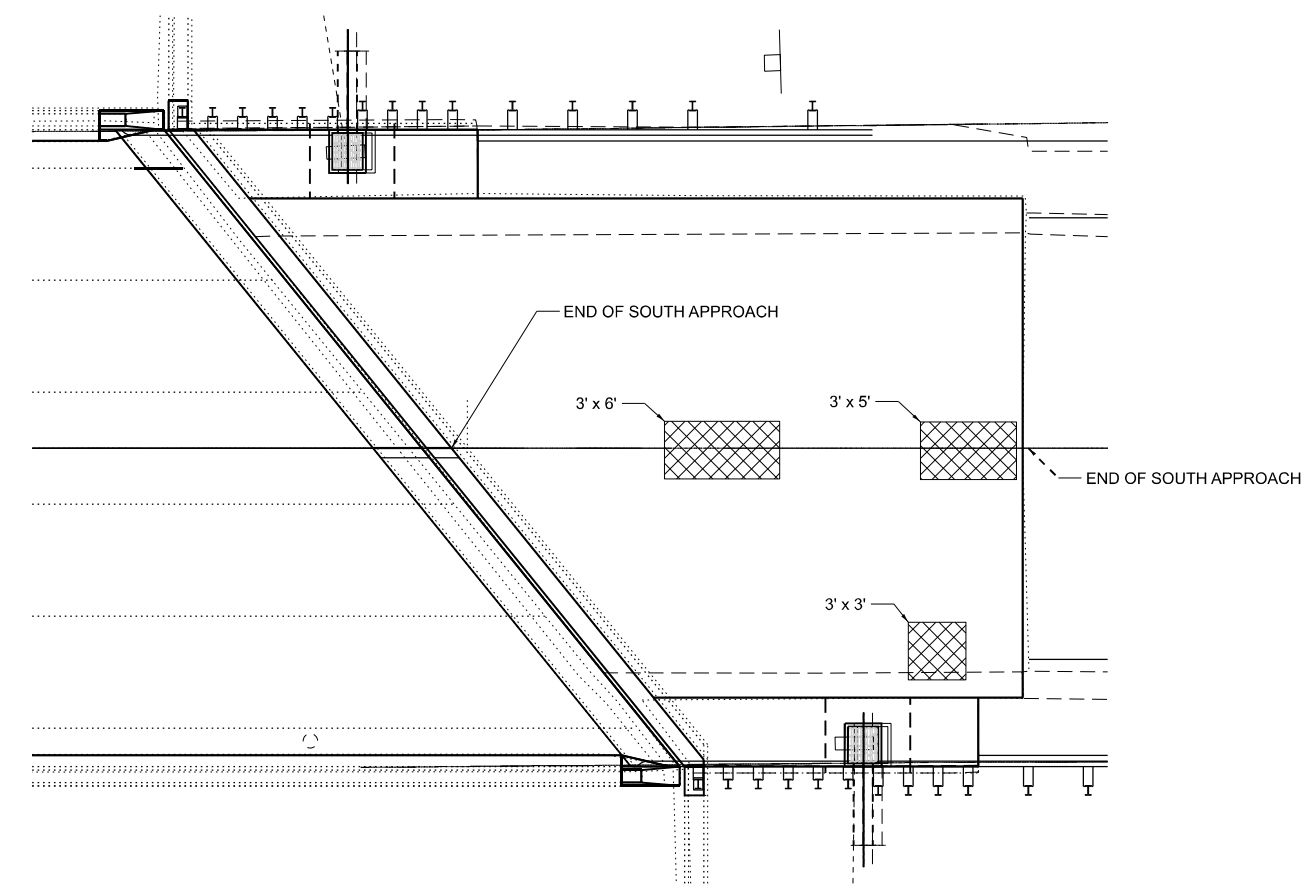

**SOUTH APPROACH PAVEMENT PATCHING PARTIAL DEPTH**

MODEL: Sheet  
FILE NAME: \\2121046.09\DOT\06-PTB-19A-030-W09-Rke County 72223\CADD\Bids\CAD\Drawings\0672223\_sht\_Roadway\_Plan.dgn



USER NAME = msutheard	DESIGNED -	REVISED -
PLOT SCALE = 0.16666633 1/16"	DRAWN -	REVISED -
PLOT DATE = 2/9/2024	CHECKED -	REVISED -
	DATE -	REVISED -

**STATE OF ILLINOIS  
DEPARTMENT OF TRANSPORTATION**

<b>ROADWAY PLAN</b>	
SCALE:	SHEET OF SHEETS STA. TO STA.

F.A.P. RTE. 304	SECTION (1BR)BDR,BRR,BJR,I	COUNTY PKE	TOTAL SHEETS 23	SHEET NO. 8
CONTRACT NO. 72223				
ILLINOIS FED. AID PROJECT				

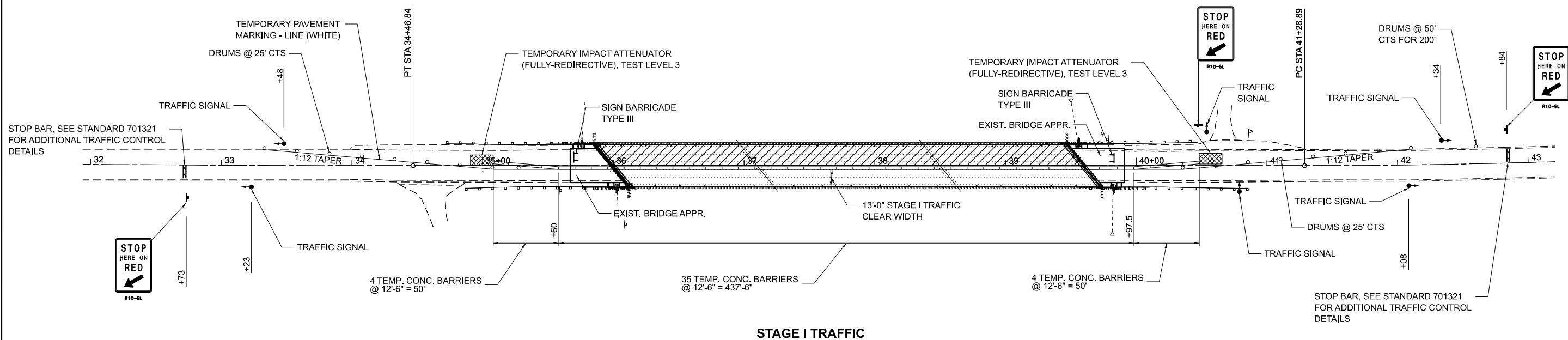
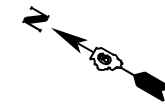

**STAGE I TRAFFIC**

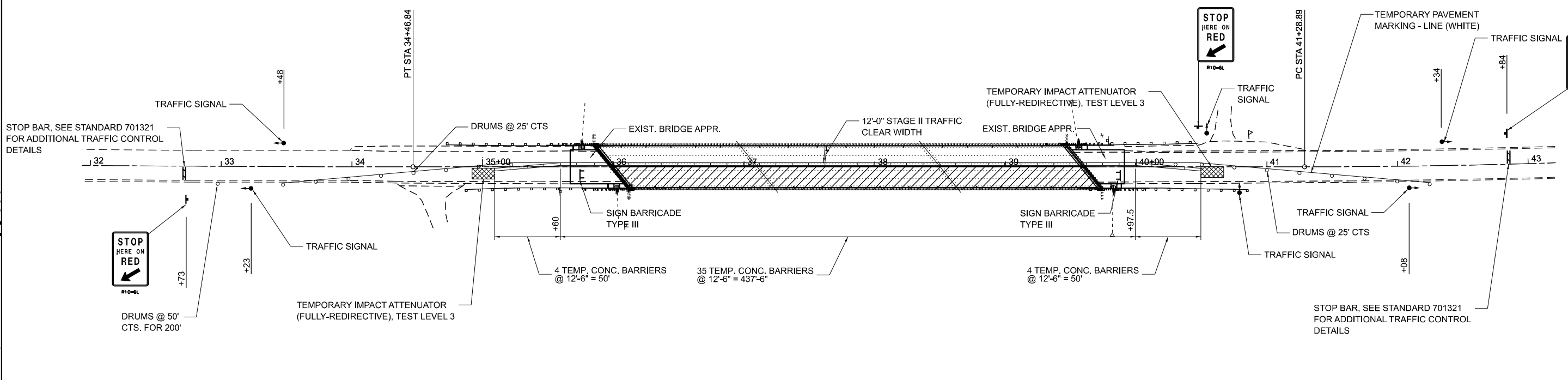

**STAGE II TRAFFIC**

NOTE: TEMPORARY PAVEMENT MARKING FOR TRAFFIC CONTROL MUST BE TYPE IV TAPE.

MODEL: Sheet  
 FILE NAME: J:\210465.09\DOT D6 - PTB 199-030 - W09 - Pike County 72223\CADD\Drawings\072223\_sht\_Staging.dgn  
 Professional Design Firm No. 184-006516



USER NAME = msutheard	DESIGNED -	REVISED -
PLOT SCALE = 0.16666633 1/16"	DRAWN -	REVISED -
PLOT DATE = 2/9/2024	CHECKED -	REVISED -
	DATE -	REVISED -

**STATE OF ILLINOIS  
DEPARTMENT OF TRANSPORTATION**

SCALE:		SHEET		OF SHEETS		STA.	TO STA.
		304	304	304	304		

**STAGING**

F.A.P. RTE.	SECTION	COUNTY	TOTAL SHEETS	SHEET NO.
304	(1BR)BDR,BRR,BJR,I	PIKE	23	9
CONTRACT NO. 72223				
ILLINOIS FED. AID PROJECT				

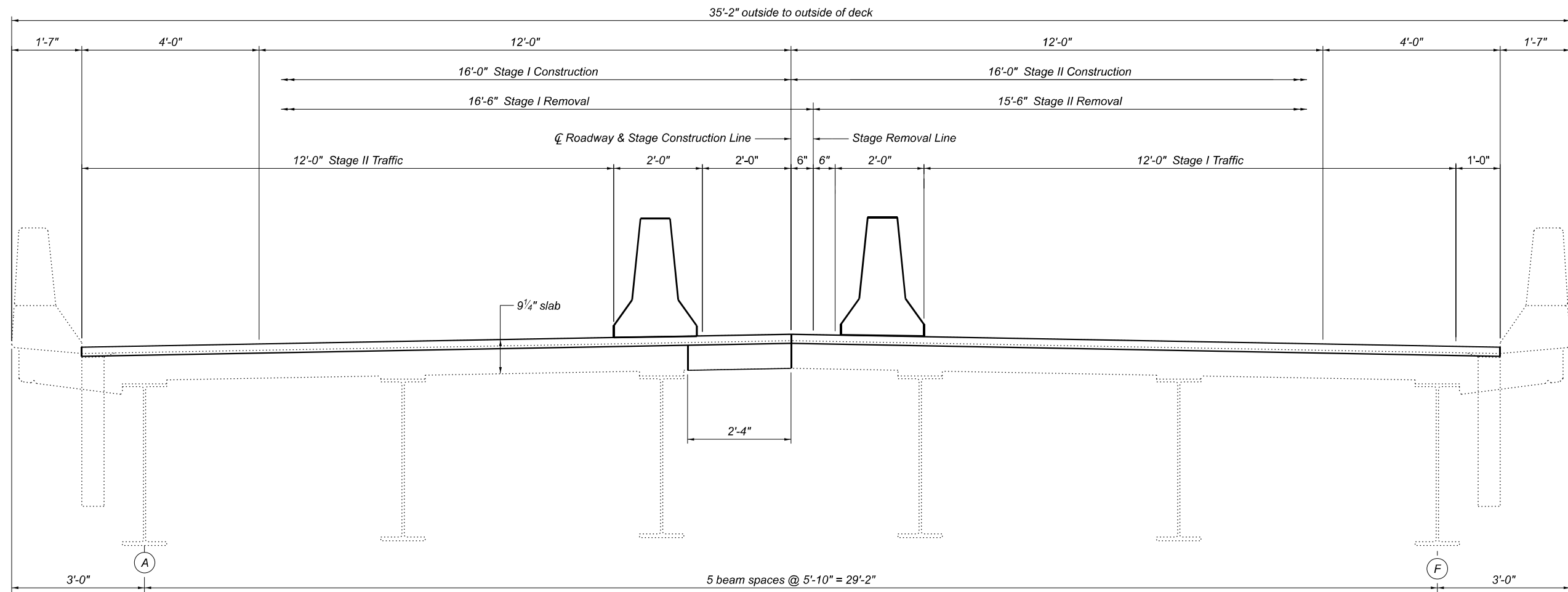

**STAGING CROSS SECTION**  
(Looking South)

MODEL: Sheet  
 FILE NAME: J:\21046.09\DOT\06-PTB-199-030-W09-Rke County 72223\CADD\Bids\CADD\Bids\062223\_sht\_Rdwy\_Staging\_Sec.dgn

**KT** KUHN & TRELLO  
 CONSULTING ENGINEERS  
 A Limited Liability Company  
 109 N. 7th Street, 3rd Floor  
 Springfield, IL 62701  
 Phone: 217-619-0044  
 Professional Design Firm No. 184-006516

USER NAME	= msutheard
PLOT SCALE	= 0.16666633 1/1 in.
PLOT DATE	= 2/9/2024

DESIGNED	-
DRAWN	-
CHECKED	-
DATE	-

REVISED	-
REVISED	-
REVISED	-
REVISED	-

**STATE OF ILLINOIS**  
**DEPARTMENT OF TRANSPORTATION**

**STAGING CROSS SECTION**  
**STRUCTURE NO. 075-0036**

SCALE:	SHEET	OF	SHEETS	STA.	TO STA.
--------	-------	----	--------	------	---------

F.A.P. RTE.	SECTION	COUNTY	TOTAL SHEETS	SHEET NO.
304	(1BR)BDR,BRR,BJR,I	PKI	22	10
CONTRACT NO. 72223				
ILLINOIS FED. AID PROJECT				



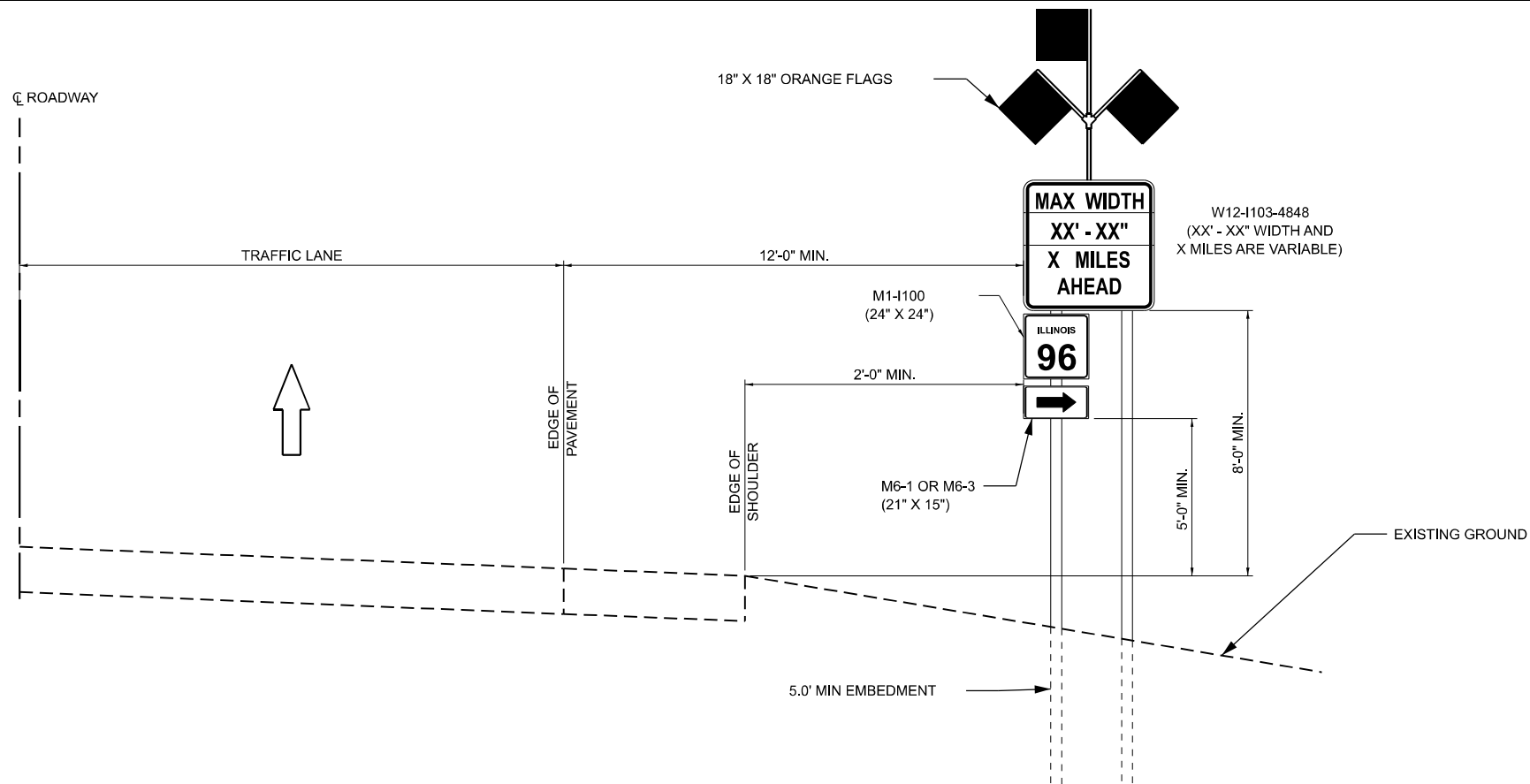
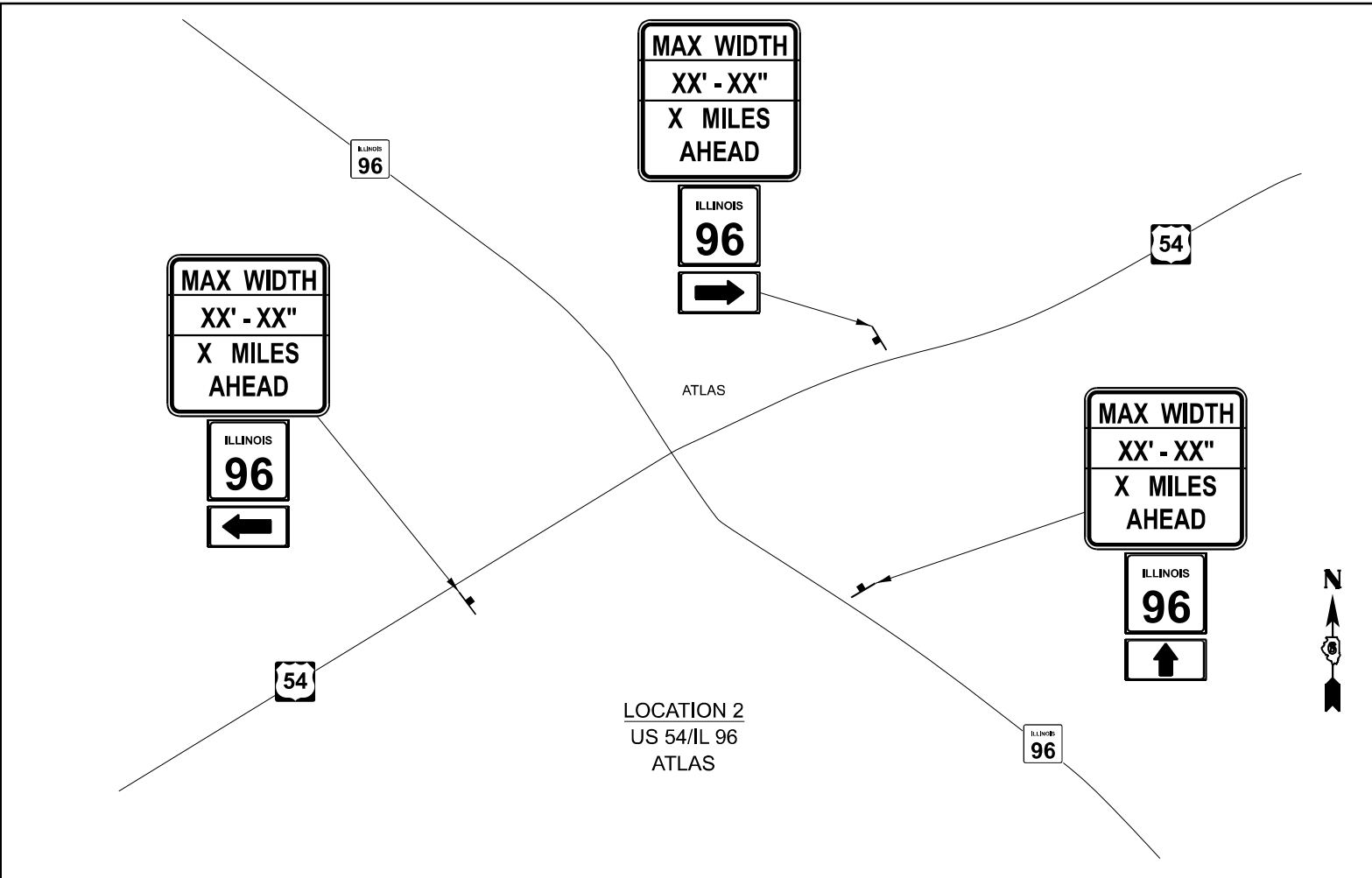
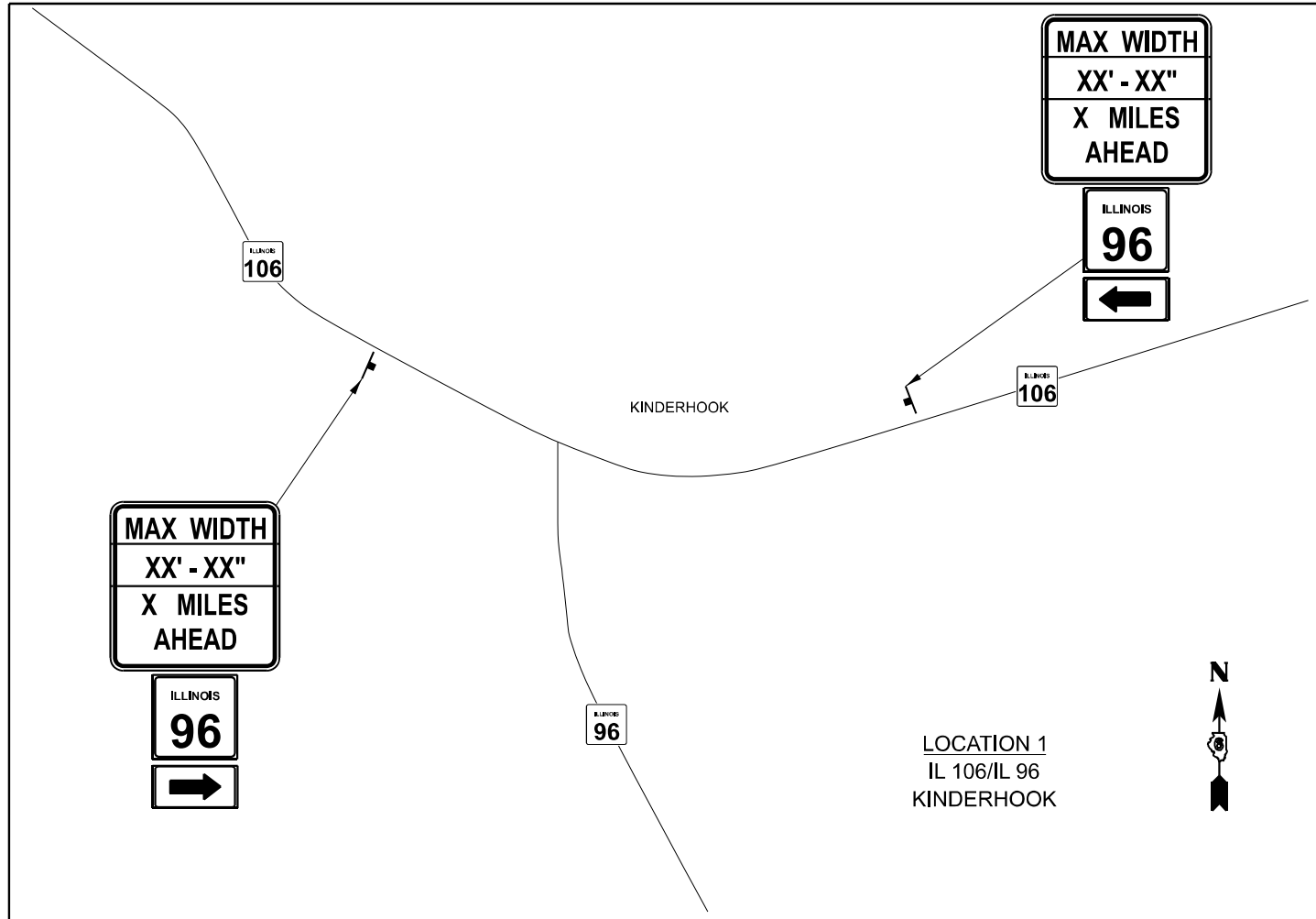

**WIDTH RESTRICTION SIGN  
CONVENTIONAL ROADWAYS**

MODEL SHEET  
 FILE NAME: \\12110465.09\DOT\06-PTB-199-030-W09-Rike County 72223\CADD\06\06\72223\_sht\_Sign.dgn



USER NAME = msutheard	DESIGNED -	REVISED -
PLOT SCALE = 0.16666633 1/16 in.	DRAWN -	REVISED -
PLOT DATE = 2/9/2024	CHECKED -	REVISED -
	DATE -	REVISED -

**STATE OF ILLINOIS  
DEPARTMENT OF TRANSPORTATION**

**WIDTH RESTRICTION SIGNING DETAIL**  
 SCALE: SHEET OF SHEETS STA. TO STA.

F.A.P. RTE.	SECTION	COUNTY	TOTAL SHEETS	SHEET NO.
304	(1BR)BDR,BRR,BJR,I	PKE	23	11
CONTRACT NO. 72223				
ILLINOIS FED. AID PROJECT				

**DESIGN SPECIFICATIONS**

New Construction:  
 2002 AASHTO Standard Specifications  
 for Highway Bridges, 17th Edition  
 Existing Construction:  
 1989 AASHTO 1984 thru 1988 Interims  
**LOADING HS-20-44 (EXISTING)**  
 No future wearing surface

**DESIGN STRESSES**

**FIELD UNITS**  
 New Construction  
 $f_c = 4,000$  psi (Superstructure)  
 $f_c = 3,500$  psi (Substructure)  
 $f_y = 60,000$  psi (Reinforcement)  
 $f_y = 50,000$  psi (M270 Grade 50)  
 Existing Construction  
 $f_c = 3,500$  psi  
 $f_y = 60,000$  psi (Reinf.)  
 $f_y = 50,000$  psi (Struct.) M 223 Gr. 50  
 $f_y = 36,000$  psi (Struct.) M 183

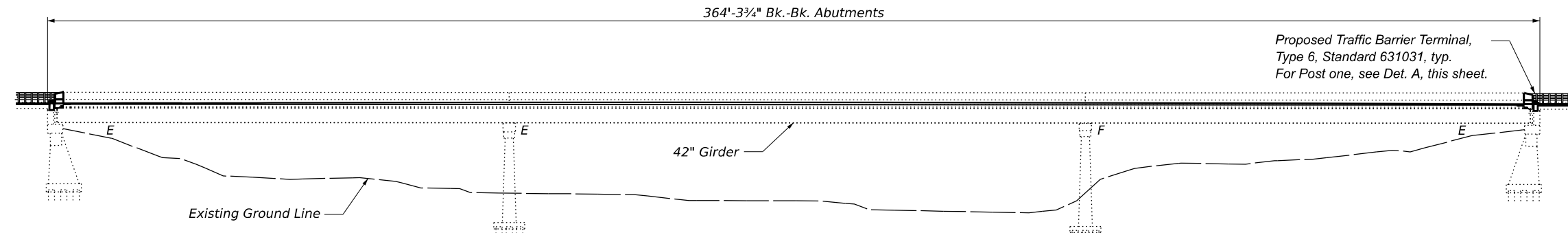
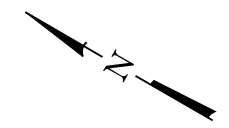

**ELEVATION**

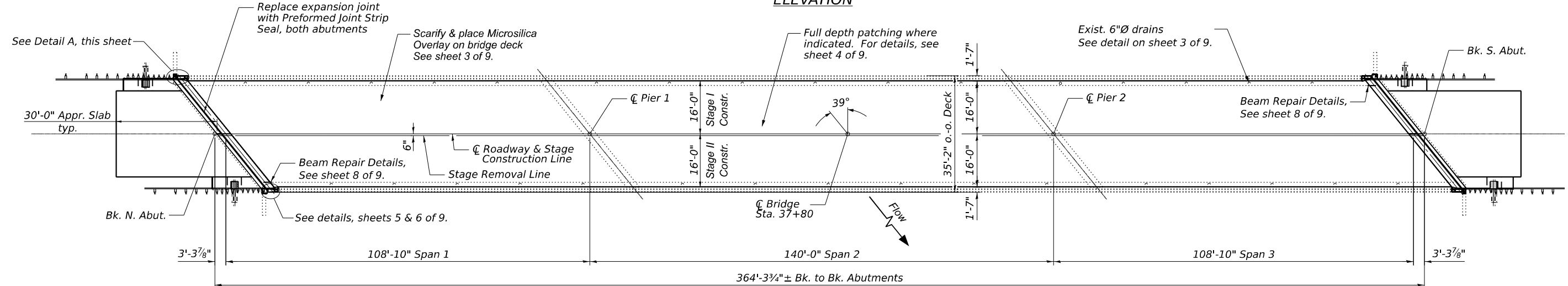

**PLAN**

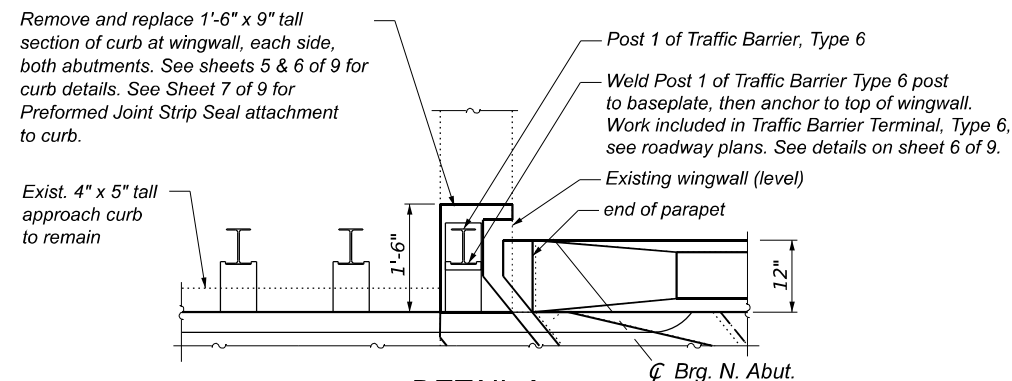

**DETAIL A**

(East end of N. Abut. shown. West end of S. Abut. similar.  
 For other ends see details on sheets 5 & 6 of 9.)

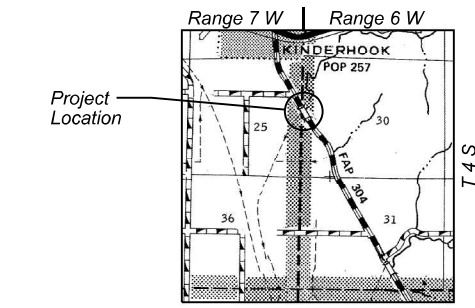

**LOCATION SKETCH**

**BRIDGE REPAIRS**  
**ILLINOIS ROUTE 96 OVER**  
**HADLEY CREEK**  
**F.A.P. RTE. 304**  
**SECTION (1BR)BDR,BRR,BJR,I**  
**PIKE COUNTY**  
**STA. 37+80.00**  
**STRUCTURE NUMBER 075-0036**

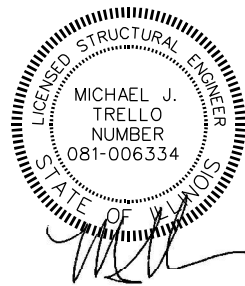

Date: March 6, 2024  
 Expires: November 30, 2024

MODEL: Sheet  
 FILE NAME: I:\211046.09\DOT.D6 - PTB-198-A30 - W09 - Pike County 72223\CADD\Bridges\CADD\Sheet075\075-0036-001-09RE.dgn



USER NAME	= myoung
PLOT SCALE	= 0.16666633 1/16"
PLOT DATE	= 3/6/2024

DESIGNED	- MJT
DRAWN	- KTCE
CHECKED	- JS
DATE	- 11-01-2023

REVISED	-
REVISED	-
REVISED	-
REVISED	-

**STATE OF ILLINOIS**  
**DEPARTMENT OF TRANSPORTATION**

**GENERAL PLAN & ELEVATION**  
**STRUCTURE NO. 075-0036**  
 SHEET 1 OF 9 SHEETS

F.A.P. RTE.	SECTION	COUNTY	TOTAL SHEETS	SHEET NO.
304	(1BR)BDR,BRR,BJR,I	PIKE	23	12
CONTRACT NO. 72223				
ILLINOIS FED. AID PROJECT				

**SHEET INDEX**

- 1 General Plan & Elevation
- 2 General Data
- 3 Staging Details & Cross Sections
- 4 Deck Patching Plan
- 5 Joint Removal & Replacement Plan
- 6 Joint Removal & Replacement Details
- 7 Preformed Joint Strip Seal
- 8 Steel Repair Details
- 9 Bar Splicers

**GENERAL NOTES**

Plan dimensions and details relative to existing plans are subject to nominal construction variations. The Contractor shall field verify existing dimensions and details affecting new construction and make necessary approved adjustments prior to construction or ordering of materials. Such variations shall not be cause for additional compensation for a change in scope of the work, however, the Contractor will be paid for the quantity actually furnished at the unit price bid for the work.

Reinforcement bars designated (E) shall be epoxy coated.

Areas of deck slab repair and concrete curb removal shown are estimated. The Engineer shall show actual locations of deck repairs on As-Built plans.

The Contractor shall use extreme care during concrete removal so as not to damage the steel beam.

Joint openings shall be adjusted according to Article 520.04 of the Standard Specifications when the deck is poured at an ambient temperature other than 50° F.

Protective coat to be applied to areas of new concrete only, including bridge deck concrete overlay.

**SCOPE OF WORK**

- 1. Perform bridge scarification.
- 2. Perform Deck Slab Repair , removal of deck ends at abutments, parapets, hatch blocks and top of wingwall (curb) at abutments.
- 3. Repair steel girder ends.
- 4. Cast deck ends, parapet ends and hatch blocks.
- 5. Place preformed joint strip seal at joints at abutments.
- 6. Adjust drains.
- 7. Place bridge deck microsilica concrete overlay 2½".
- 8. Perform bridge deck grooving.
- 9. Apply Protective Coat.

**TOTAL BILL OF MATERIAL**

ITEM	UNIT	QUANTITY
Concrete Removal	Cu. Yd.	11.8
Concrete Superstructure	Cu. Yd.	14.2
Bridge Deck Grooving	Sq. Yd.	1214
Protective Coat	Sq. Yd.	1300
Structural Steel Repair	Pound	310
Reinforcement Bars, Epoxy Coated	Pound	1380
Bar Splicers	Each	16
Preformed Joint Strip Seal	Foot	88
Bridge Deck Scarification, ¾"	Sq. Yd.	1261
Bridge Deck Microsilica Concrete Overlay, 2½"	Sq. Yd.	1261
Deck Slab Repair (Full Depth, Type II)	Sq. Yd.	80

MODEL SHEET: 1211046.09 IDOT D6 - PTB 19A-030 - W09 - Pike County 72223 CAD Datab CAD sheets 0750036 72223-002-Gen-datas.dgn



USER NAME = myoung	DESIGNED - MJT	REVISED -
	DRAWN - KTCE	REVISED -
PLOT SCALE = 0.16666633 1/1 in.	CHECKED - JS	REVISED -
PLOT DATE = 3/7/2024	DATE - 11-01-2023	REVISED -

**STATE OF ILLINOIS  
DEPARTMENT OF TRANSPORTATION**

**GENERAL DATA  
STRUCTURE NO. 075-0036**

SHEET 2 OF 9 SHEETS

F.A.P. RTE.	SECTION	COUNTY	TOTAL SHEETS	SHEET NO.
304	(1BR)BDR,BRR,BJR,I	PIKE	23	13
CONTRACT NO. 72223				
ILLINOIS FED. AID PROJECT				

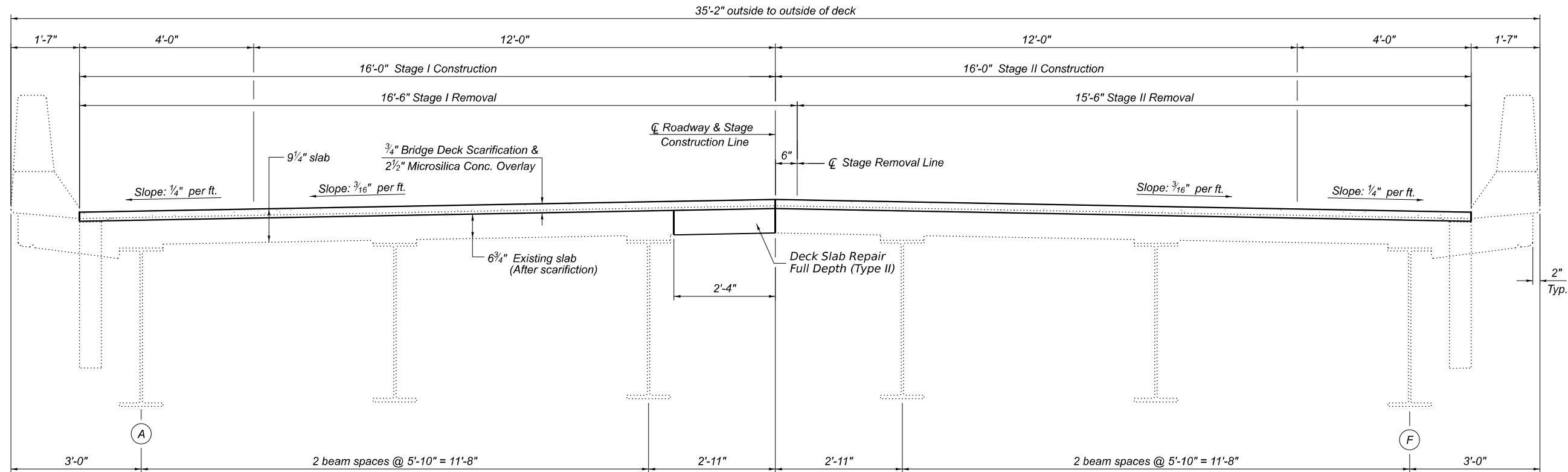

**CROSS SECTION AT MID SPANS**  
(Looking South)

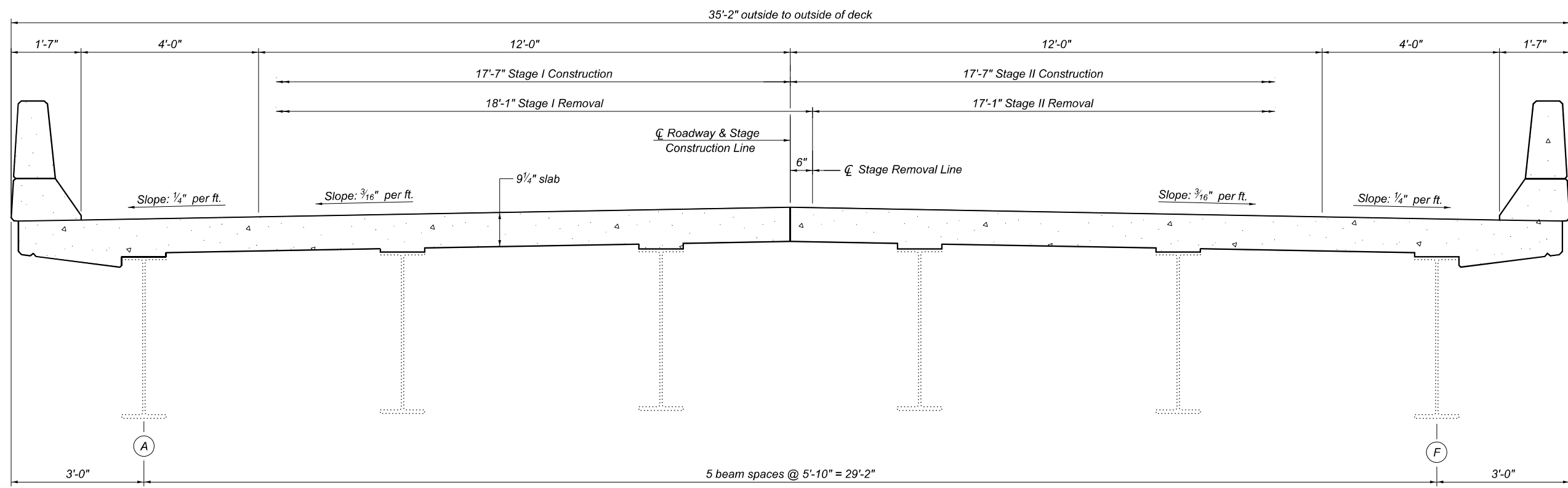

**CROSS SECTION AT JOINT REPLACEMENT LOCATIONS**  
(Looking South)

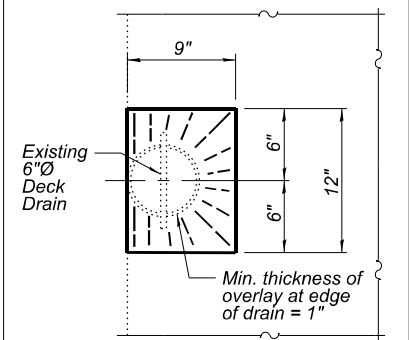

**OVERLAY TREATMENT AT DRAINS**

MODEL: Sheet  
 FILE NAME: J:\21046.09\DOT D6 - PTB 199-030 - W09 - Pike County 72223\CADD\Bids\CADD\Sheet\0750036\72223-03-Stage-Const.dgn  
 Professional Design Firm No. 184-006516



USER NAME = myoung  
 PLOT SCALE = 0.16666633 1/16 in.  
 PLOT DATE = 2/28/2024

DESIGNED - MJT  
 DRAWN - KTCE  
 CHECKED - JS  
 DATE - 11-01-2023

REVISED -  
 REVISED -  
 REVISED -  
 REVISED -

**STATE OF ILLINOIS**  
**DEPARTMENT OF TRANSPORTATION**

**STAGING DETAILS & CROSS SECTION**  
**STRUCTURE NO. 075-0036**  
 SHEET 3 OF 9 SHEETS

F.A.P. RTE.	SECTION	COUNTY	TOTAL SHEETS	SHEET NO.
304	(1BR)BDR,BRR,BJR,I	PIKE	23	14
CONTRACT NO. 72223				
ILLINOIS   FED. AID PROJECT				

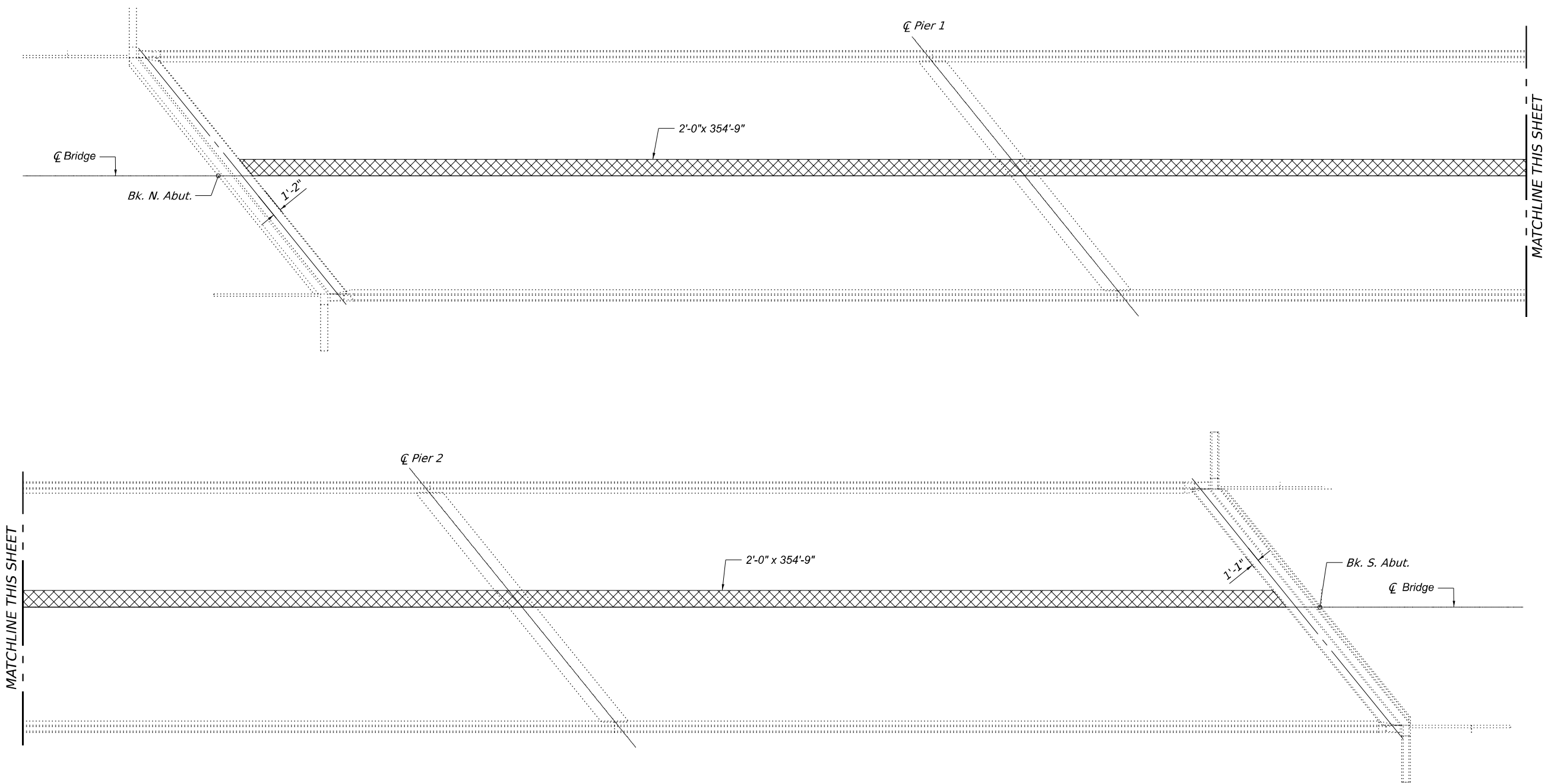
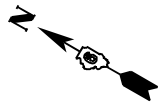

**DECK PATCHING REPAIR PLAN**

Deck Slab Repair (Full Depth, Type II)

**SUPERSTRUCTURE  
BILL OF MATERIAL**

ITEM	UNIT	QUANTITY
Deck Slab Repair Full Depth (Type II)	Sq. Yd.	80

MODEL: Sheet1  
 FILE NAME: J:\21046.09\DOT D6 - PTB 19A-030 - W09 - Pike County 72223\CADD\Drawings\075036\72223-04-518\Repair.dgn  
 Professional Design Firm No. 184-006516

**KUHN & TRELLO**  
 CONSULTING ENGINEERS  
 A Limited Liability Company  
 109 N. 7th Street, 3rd Floor  
 Springfield, IL 62701  
 Phone: 217-619-0044

USER NAME = myoung	DESIGNED - MJT	REVISED -
	DRAWN - KTCE	REVISED -
PLOT SCALE = 0.16666633 1/16 in.	CHECKED - JS	REVISED -
PLOT DATE = 3/6/2024	DATE - 11-01-2023	REVISED -

**STATE OF ILLINOIS  
DEPARTMENT OF TRANSPORTATION**

**DECK PATCHING PLAN  
STRUCTURE NO. 075-0036**  
 SHEET 4 OF 9 SHEETS

F.A.P. RTE.	SECTION	COUNTY	TOTAL SHEETS	SHEET NO.
304	(1BR)BDR,BRR,BJR,I	PIKE	23	15
CONTRACT NO. 72223				
ILLINOIS   FED. AID PROJECT				

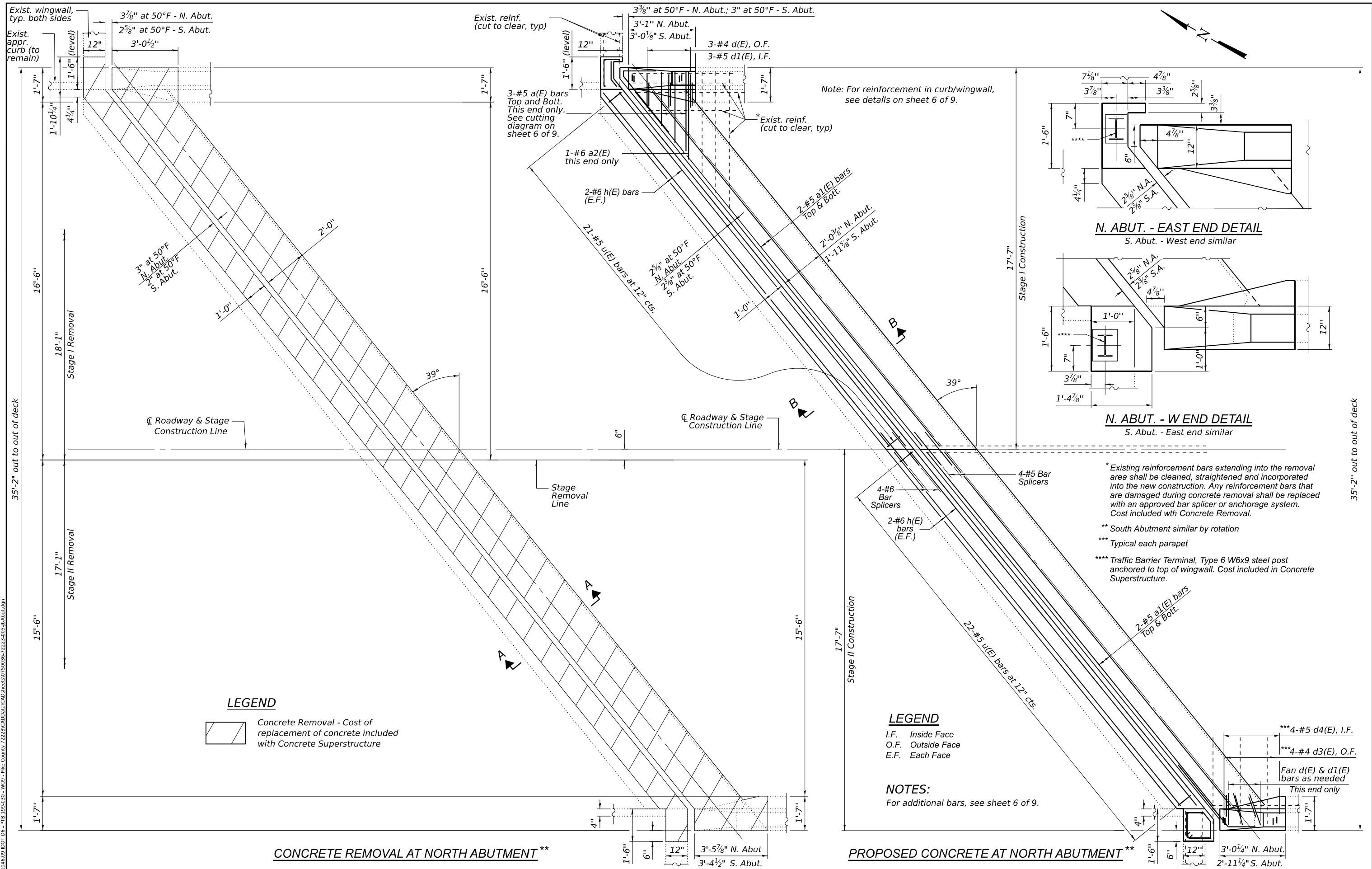

**N. ABUT. - EAST END DETAIL**  
S. Abut. - West end similar

**N. ABUT. - W END DETAIL**  
S. Abut. - East end similar

**LEGEND**  
 Concrete Removal - Cost of replacement of concrete included with Concrete Superstructure

**LEGEND**  
 I.F. Inside Face  
 O.F. Outside Face  
 E.F. Each Face

**NOTES:**  
 For additional bars, see sheet 6 of 9.

\* Existing reinforcement bars extending into the removal area shall be cleaned, straightened and incorporated into the new construction. Any reinforcement bars that are damaged during concrete removal shall be replaced with an approved bar splicer or anchorage system. Cost included with Concrete Removal.  
 \*\* South Abutment similar by rotation  
 \*\*\* Typical each parapet  
 \*\*\*\* Traffic Barrier Terminal, Type 6 W6x9 steel post anchored to top of wingwall. Cost included in Concrete Superstructure.

**CONCRETE REMOVAL AT NORTH ABUTMENT\*\***

**PROPOSED CONCRETE AT NORTH ABUTMENT\*\***

MODEL: Sheet  
 FILE NAME: J:\210465.09\DOT.D6 - PTB-199-030 - W09 - Pike County 72223\CADD\Drawings\0750036\72223-005-16-Abut.fgp  
 Professional Design Firm No. 184-006516

**KT**  
**KUHN & TRELLO**  
 CONSULTING ENGINEERS  
 A Limited Liability Company  
 109 N. 7th Street, 3rd Floor  
 Springfield, IL 62701  
 Phone: 217-619-0044

USER NAME	= myoung
PLOT SCALE	= 0.167"/in.
PLOT DATE	= 3/6/2024

DESIGNED	- MJT
DRAWN	- KTCE
CHECKED	- JS
DATE	- 11-01-2023

REVISED	-
REVISED	-
REVISED	-
REVISED	-

**STATE OF ILLINOIS**  
**DEPARTMENT OF TRANSPORTATION**

**JOINT REMOVAL AND REPLACEMENT DETAILS AT ABUTMENTS**  
**STRUCTURE NO. 075-0036**

SHEET 5 OF 9 SHEETS

F.A.P. RTE.	SECTION	COUNTY	TOTAL SHEETS	SHEET NO.
304	(1BR)BDR,BRR,BJR,I	PIKE	23	16
CONTRACT NO. 72223			ILLINOIS FED. AID PROJECT	



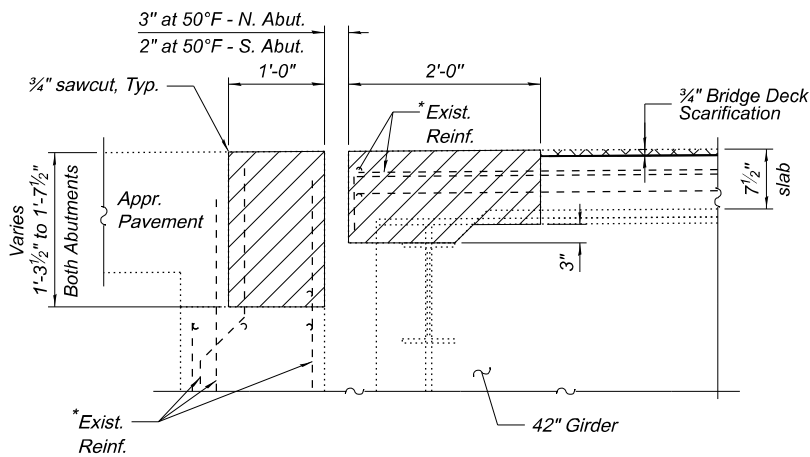

**SECTION A-A**

**Notes:**  
 Cross Hatched areas indicate Concrete Removal. Cost of replacement of concrete included with Concrete Superstructure.  
 The existing expansion joint system shall be removed completely, as well as any foreign material that has accumulated or been placed in the joint openings. The cost for this work is included in Concrete Removal and no additional compensation will be allowed.

\* Existing reinforcement bars extending into the removal area shall be cleaned, straightened and incorporated into the new construction. Any reinforcement bars that are damaged during concrete removal shall be replaced with an approved bar splicer or anchorage system. Cost included with concrete removal.

\*\* South Abutment similar.

\*\*\* Cast curb after hatchblock.

\*\*\*\* Traffic Barrier Terminal, Type 6 W6x9 steel post anchored to top of wingwall. Cost included in Concrete Superstructure.

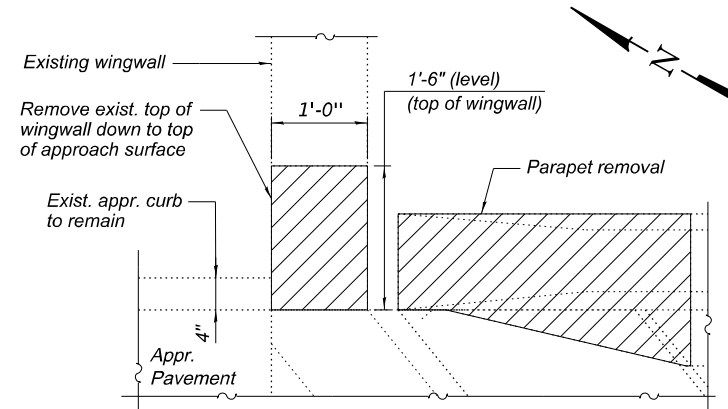

**N. ABUT. PARTIAL WINGWALL REMOVAL PLAN**

(E. corner of N. Abut. shown, typical S. Abut. W. corner)

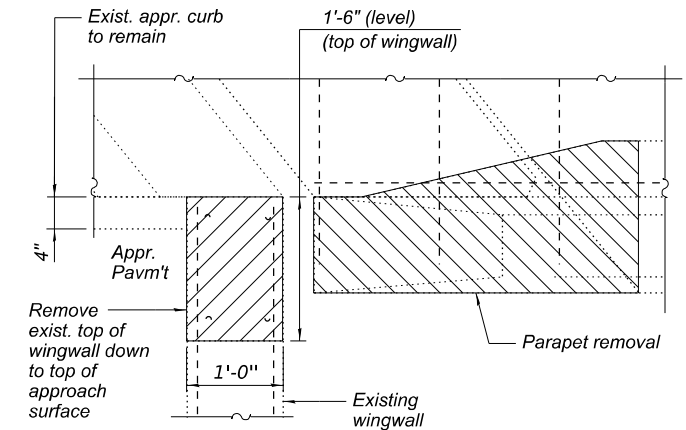

**S. ABUT. PARTIAL WINGWALL REMOVAL PLAN**

(E. corner of N. Abut. shown, Typical four corners)

**LEGEND**

I.F. Inside Face  
 O.F. Outside Face

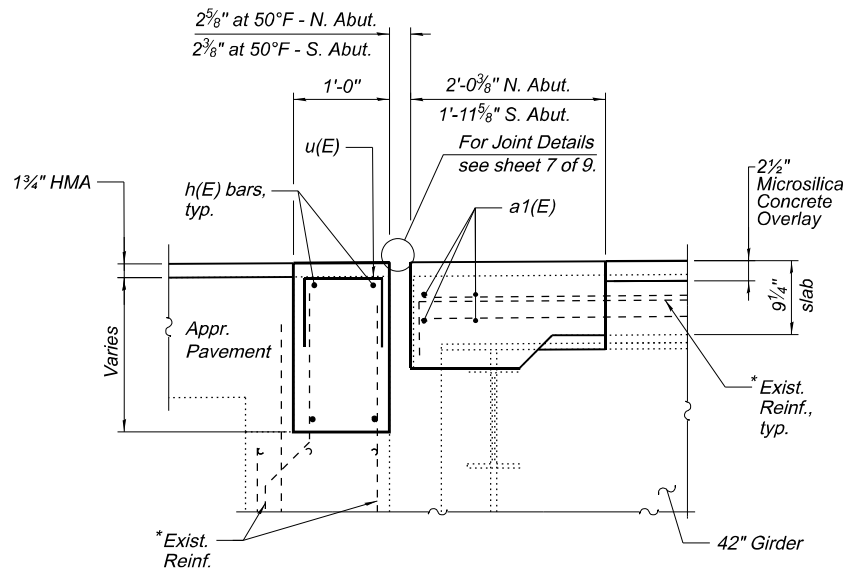

**SECTION B-B**

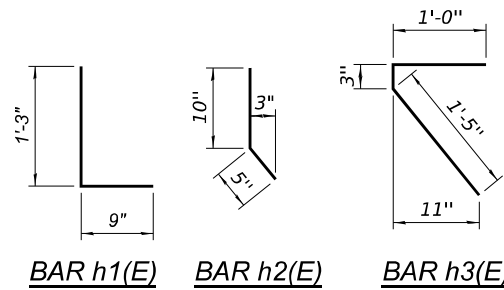

**BAR h1(E) BAR h2(E) BAR h3(E)**

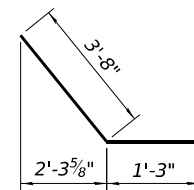

**BAR h4(E)**

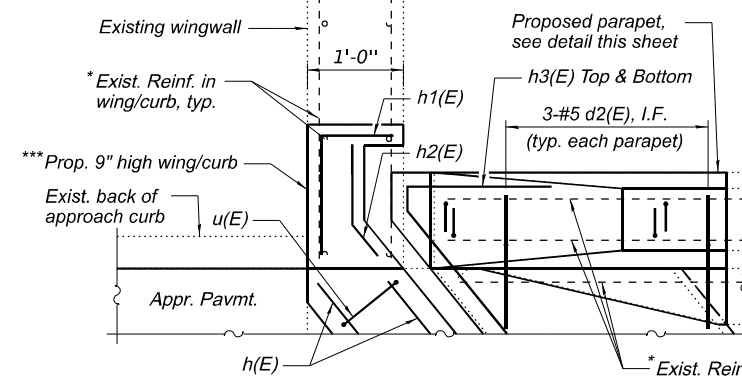

**N. ABUT. PARTIAL WINGWALL PROPOSED PLAN**

(E. corner of N. Abut. shown, typical S. Abut. W. corner)

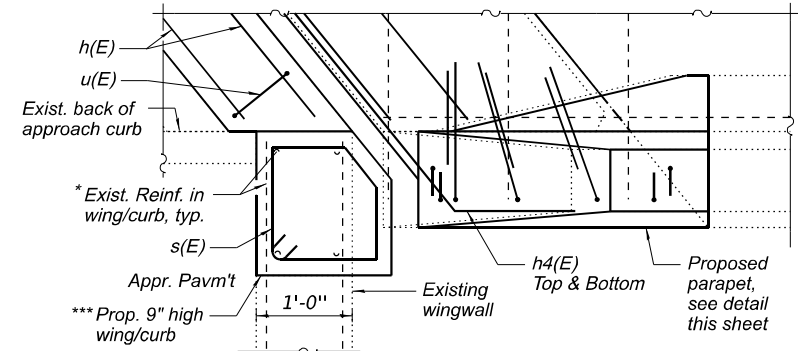

**S. ABUT. PARTIAL WINGWALL PROPOSED PLAN**

(W. corner of N. Abut. shown, Typical S. Abut. E. corner)

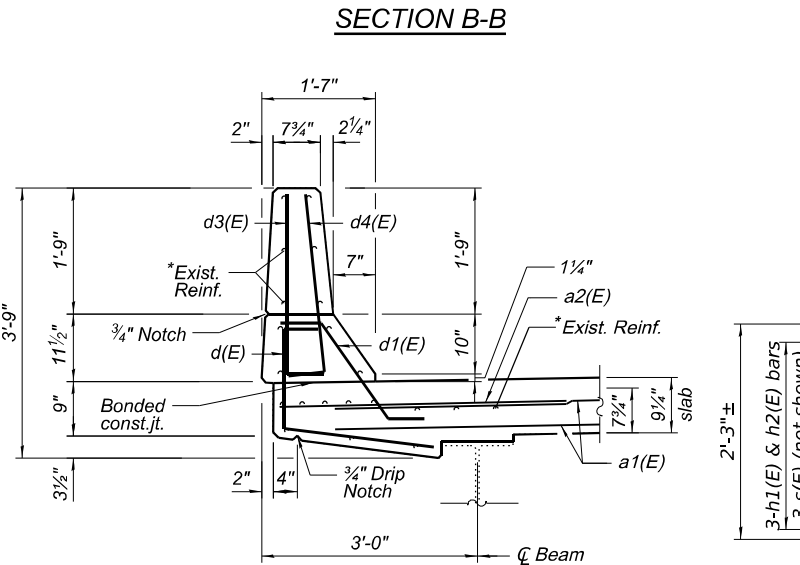

**TYPICAL SECTION THRU BRIDGE PARAPET**

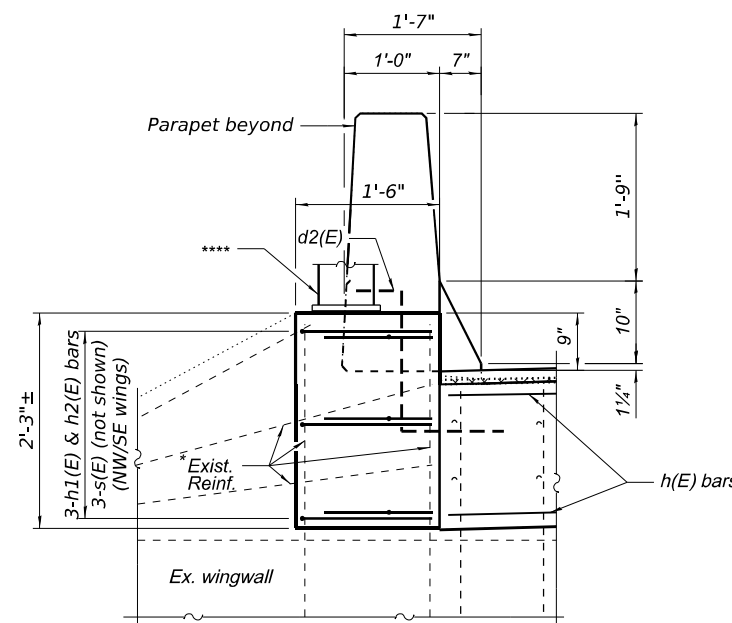

**TYPICAL SECTION THRU APPROACH WINGWALL/CURB**

(E. corner of N. Abut. shown, typical S. Abut. W. corner)

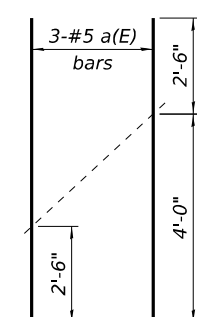

**BAR a(E)**

Order a(E) bars top and bottom full length. Cut as shown and use remainder in opposite end.

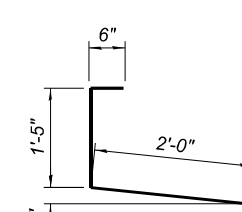

**BAR d(E)**

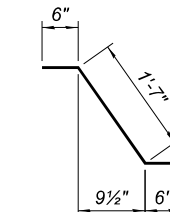

**BAR d1(E)**

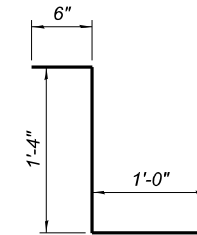

**BAR d2(E)**

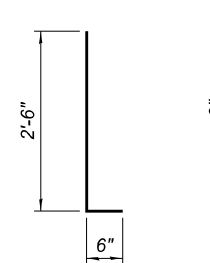

**BARS d3(E) & d4(E)**

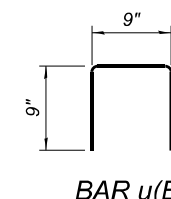

**BAR u(E)**

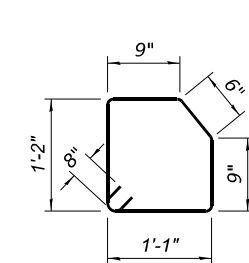

**BAR s(E)**

**BILL OF MATERIAL TWO ABUTMENTS**

Bar	No.	Size	Length	Shape
a(E)	6	#5	6'-6"	—
a1(E)	16	#5	21'-1"	—
a2(E)	2	#6	4'-0"	—
d(E)	12	#4	3'-11"	└
d1(E)	12	#5	2'-7"	└
d2(E)	12	#5	2'-10"	└
d3(E)	16	#4	3'-0"	└
d4(E)	16	#5	3'-0"	└
h(E)	16	#6	21'-0"	—
h1(E)	6	#5	2'-0"	└
h2(E)	6	#5	1'-3"	└
h3(E)	4	#5	2'-8"	└
h4(E)	4	#5	4'-11"	└
s(E)	6	#5	5'-7"	□
u(E)	86	#5	2'-3"	└
Concrete Removal			Cu. Yd.	11.8
Concrete Superstructure			Cu. Yd.	14.2
Reinforcement Bars, Epoxy Coated			Pound	1380
Bar Splicers			Each	16

MODEL SHEET  
 FILE NAME: 221204E09 IDOT.D6 - PTB 198A-030 - W09 - Pike County 72223 CAD.Dwg CAD:RHEETS:075003672223-04-04-04.dwg  
 Professional Design Firm No. 184-006516

**KT**  
 KUHN & TRELLO  
 CONSULTING ENGINEERS  
 A Limited Liability Company  
 109 N. 7th Street, 3rd Floor  
 Springfield, IL 62701  
 Phone: 618-698-0044

USER NAME = myoung	DESIGNED - MJT	REVISED -
PLOT SCALE = 0.167"/in.	DRAWN - KTCE	REVISED -
PLOT DATE = 3/6/2024	CHECKED - JS	REVISED -
	DATE - 11-01-2023	REVISED -

**STATE OF ILLINOIS  
 DEPARTMENT OF TRANSPORTATION**

**JOINT REMOVAL AND REPLACEMENT DETAILS  
 STRUCTURE NO. 075-0036**

SHEET 6 OF 9 SHEETS

F.A.P. RTE. 304	SECTION (1BR)BDR,BRR,BJ,R,I	COUNTY PIKE	TOTAL SHEETS 23	SHEET NO. 17
			CONTRACT NO. 72223	
ILLINOIS FED. AID PROJECT				

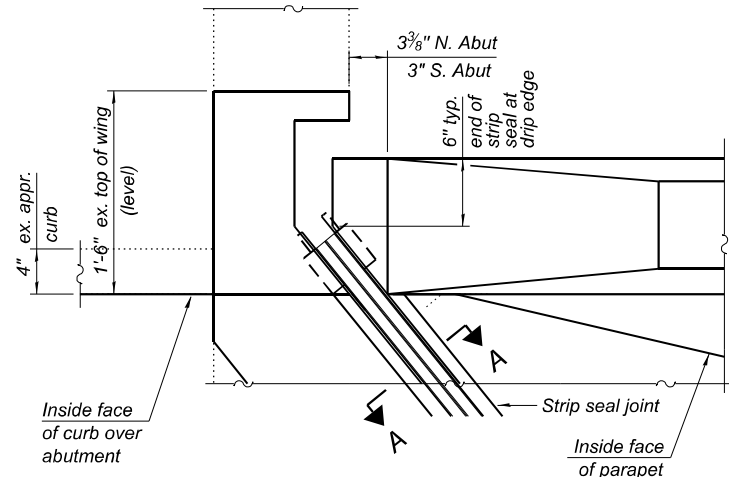

**PLAN AT ABUTMENT**

(East end of N. Abut shown.  
S. Abut. similar by opposite hand)  
(For detail of NW and SE corners, see sheet 5 of 9)

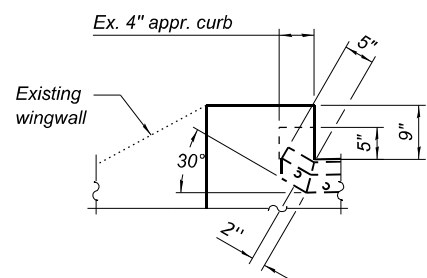

**SECTION AT WINGWALL**

**SECTION AT WINGWALL**

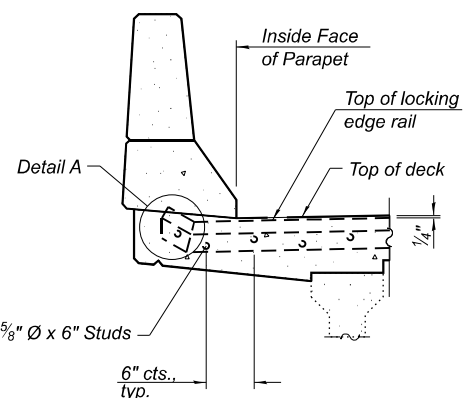

**SECTION AT PARAPET (ABUT. END)**

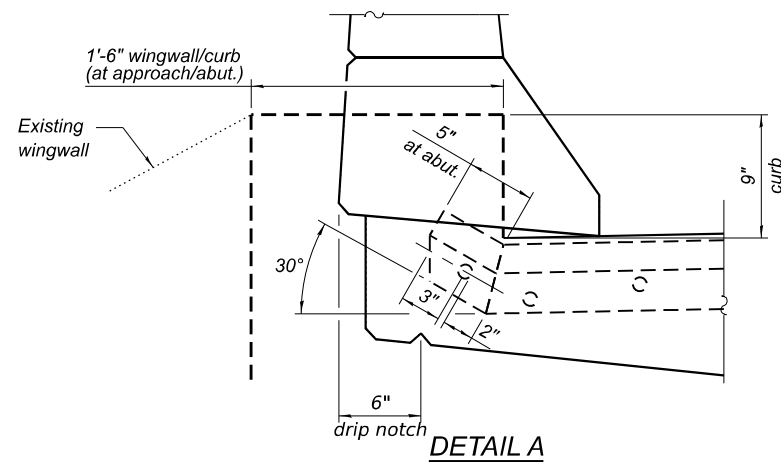

**DETAIL A**

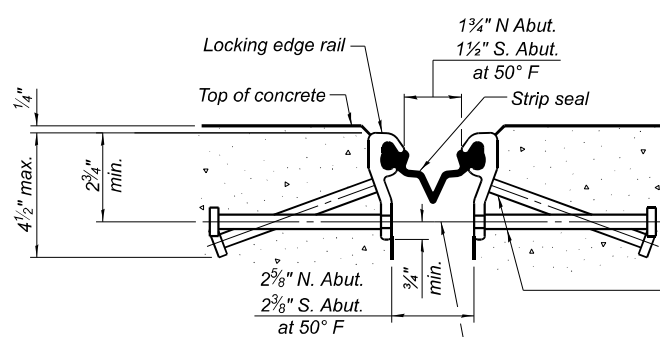

**SHOWING ROLLED RAIL JOINT**

\* 5/8" Ø x 6" studs @ 6" cts. (alternate angled/bent studs with horizontal studs)

3/8" φ threaded rods in 7/16" φ holes at ±4'-0" cts. for holding the proper joint opening based on the temperature during the deck pour. Place to miss studs. All rods shall be burned, or sawed off flush with the plates after concrete is set.

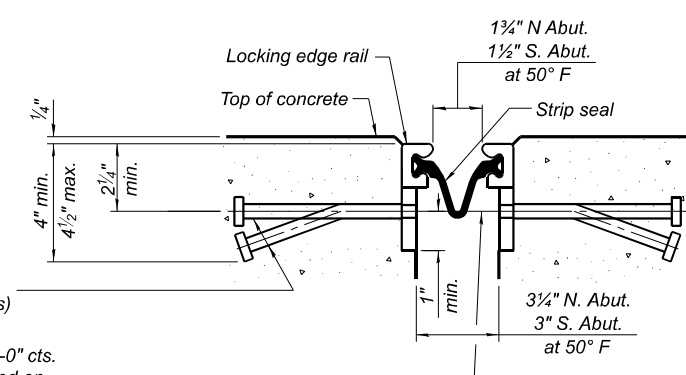

**SHOWING WELDED RAIL JOINT**

\* Granular or solid flux filled headed studs conforming to Article 1006.32 of the Std. Specs., automatically end welded.

**SECTION A-A**

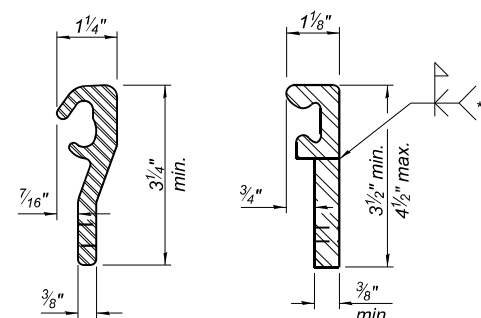

**LOCKING EDGE RAILS**

\*\* Back gouge not required if complete joint penetration is verified by mock-up.

**LOCKING EDGE RAIL SPLICE**

The inside of the locking edge rail groove shall be free of weld residue. Rolled rail shown, welded rail similar.

**BILL OF MATERIAL**

Item	Unit	Total
Preformed Joint Strip Seal	Foot	88

**Notes:**

The strip seal shall be made continuous and shall have a minimum thickness of 1/4". The configuration of the strip seal shall match the configuration of the locking edge rails. Open or "webbed" strip seal gland configurations are not permitted. The gland shall be sized for a maximum rated movement of 4 inches.

The locking edge rails depicted are configured for typical applications and are conceptual only. The actual configuration of the locking edge rails and matching strip seal may vary from manufacturer to manufacturer provided they fit the application and meet the minimum anchorage shown. Flanged edge rails, however, will not be allowed. Locking edge rails may exceed the 4 1/2" maximum depth provided the anchorage system is revised according to the manufacturer's recommendation.

The manufacturer's recommended installation methods shall be followed.

All steel components shall be galvanized after fabrication according to Article 520.03 of the Standard Specifications.

The Maximum space between locking edge rail segments shall be 3/16" and sealed with a suitable sealant; however, any rail joint within 10' measured perpendicular to the face of the curb or parapet shall be welded as shown in the locking edge rail splice detail.

Cost of parapet sliding plates, embedded plates, and anchorage studs included with Preformed Joint Strip Seal.

The concrete opening below the strip seal will vary based on the locking edge rail chosen by the Contractor. Deck and parapet lengths shown elsewhere in the plans are dimensioned to the concrete opening, not the joint opening, and are based on the rolled locking edge rail. If the Contractor elects to use a different locking edge rail, dimensional adjustments may be required. One exception to this would be the strip seal joint at the end of the precast bridge approach slab. For these cases the pavement connector length shall be adjusted, not the length of the bridge approach slab.

MODEL: 2D Sheet H  
 FILE NAME: 222223CADD001B01075036272223-007-1855.dgn  
 PROJECT: 222223CADD001B01075036272223-007-1855.dgn  
 Professional Design Firm No. 184-006516

**KT**  
 KUHN & TRELLO  
 CONSULTING ENGINEERS  
 A Limited Liability Company  
 109 N. 7th Street, 3rd Floor  
 Springfield, IL 62701  
 Phone: 217-619-0044

USER NAME = myoung	DESIGNED - MJT	REvised -
PLOT SCALE = 0.16666633 1/16"	DRAWN - KTCE	REvised -
PLOT DATE = 3/7/2024	CHECKED - JS	REvised -
	DATE - 11-01-2023	REvised -

**STATE OF ILLINOIS  
 DEPARTMENT OF TRANSPORTATION**

**PREFORMED JOINT STRIP SEAL  
 STRUCTURE NO. 075-0036**

SHEET 7 OF 9 SHEETS

F.A.P. RTE. 304	SECTION (1BR)BDR,BRR,BJR,I	COUNTY PKE	TOTAL SHEETS 23	SHEET NO. 18
			CONTRACT NO. 72223	
ILLINOIS FED. AID PROJECT				

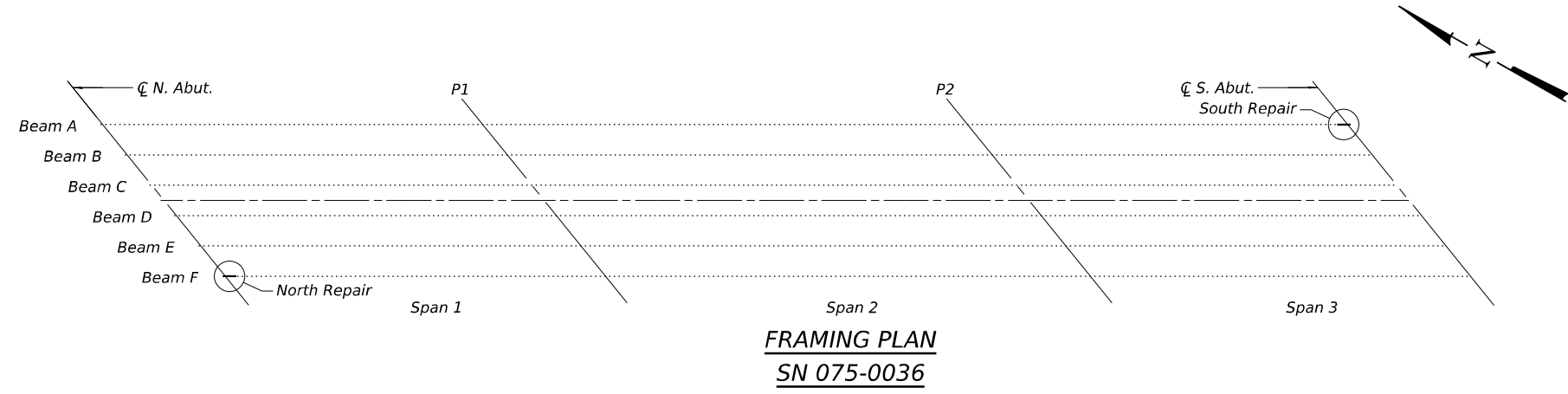

**GENERAL NOTES**

All structural steel shall conform to AASTHO Classification M-270 Gr. 50, unless otherwise noted.

Plan dimensions and details relative to existing plans are subject to nominal construction variations. The contractor shall field verify existing dimensions and details affecting new construction and make necessary approved adjustments prior to construction or ordering of materials. Such variations shall not be cause for additional compensation for a change in scope of the work, however, the Contractor will be paid for the quantity actually furnished at the unit price bid for the work.

Fasteners shall be high strength bolts. Bolts  $\frac{3}{4}$ " $\varnothing$ , open holes  $1\frac{3}{16}$ " $\varnothing$ , unless otherwise noted.

All structural steel, connection bolts, nuts and washers shall be hot dip galvanized according to Special Provision "Hot Dip Galvanizing for Structural Steel". Cost included with Structural Steel Repair.

Existing structural steel that will be in contact with new structural steel shall be cleaned and painted prior to erection as required by the special provision "Cleaning and Painting Contact Surface Areas of Existing Steel Structures". Cost included with Structural Steel Repair.

Use holes in new steel as template to field drill holes in existing steel.

Cut existing top bearing plate bolts flush with the top of existing bottom flange.

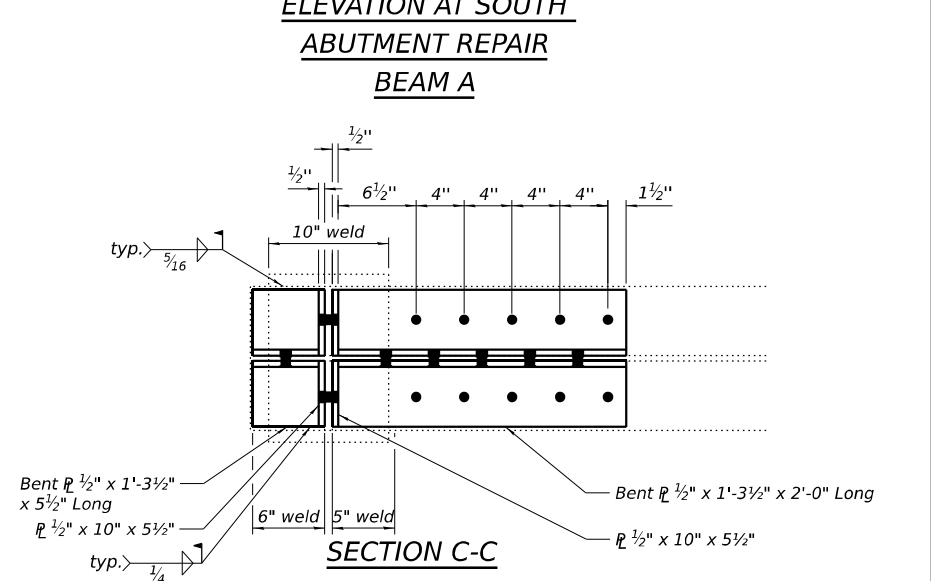
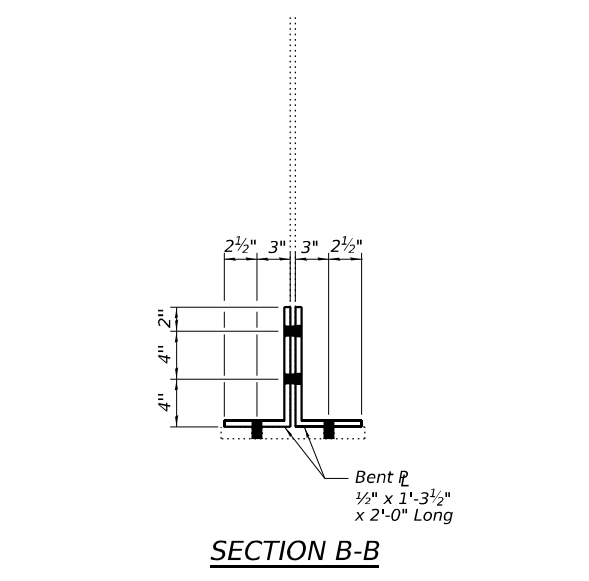
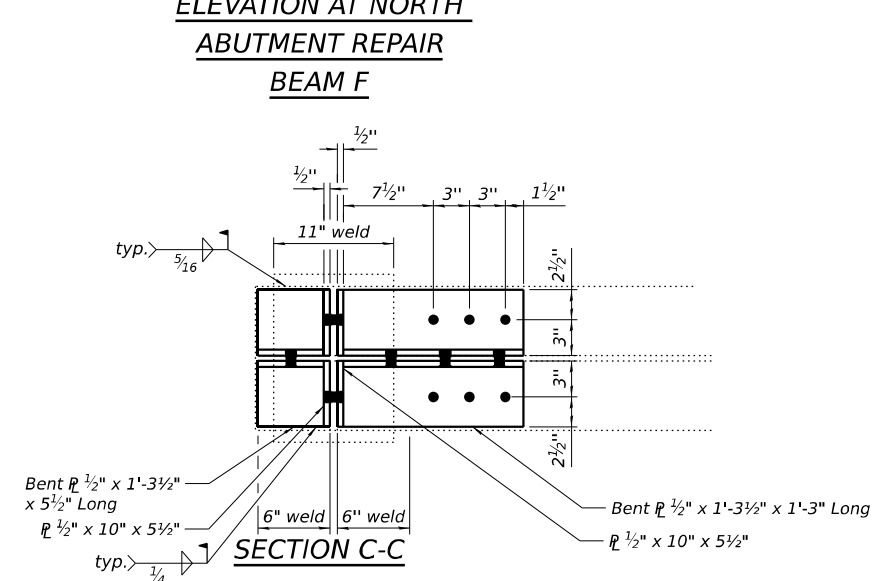
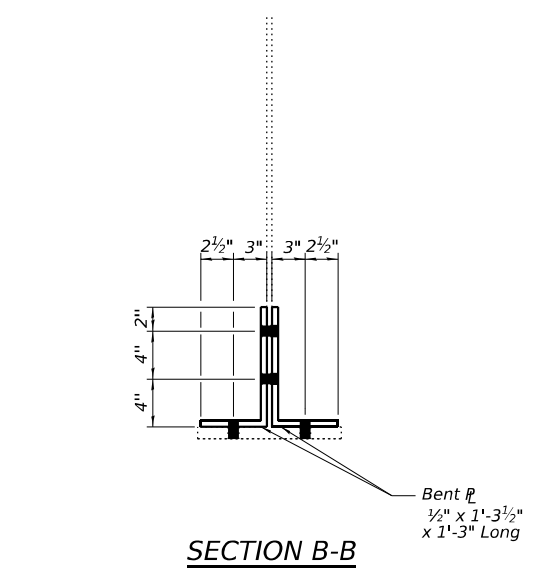
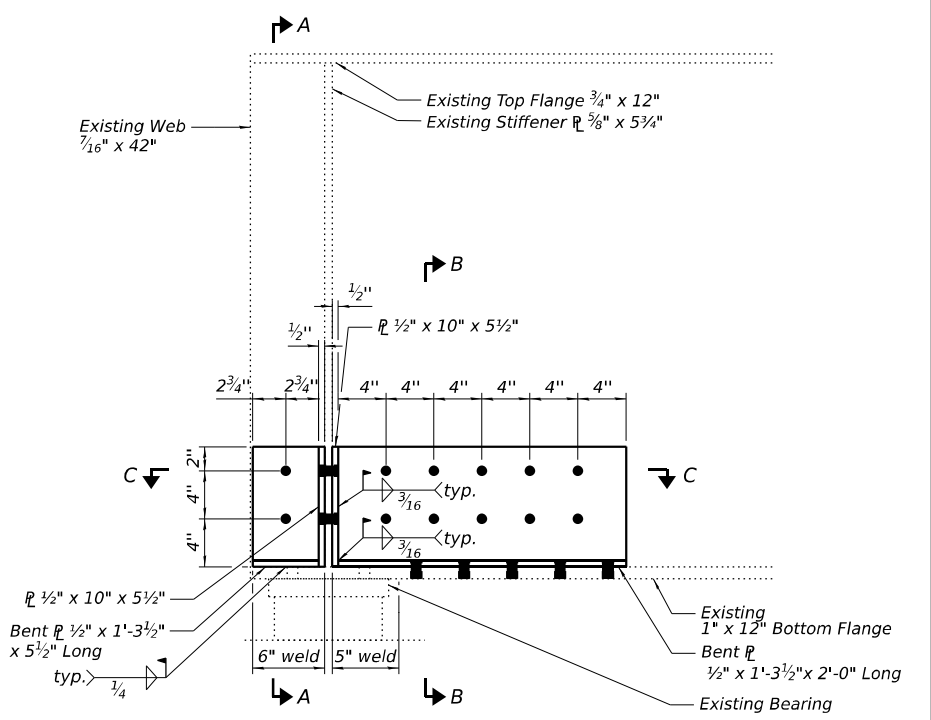
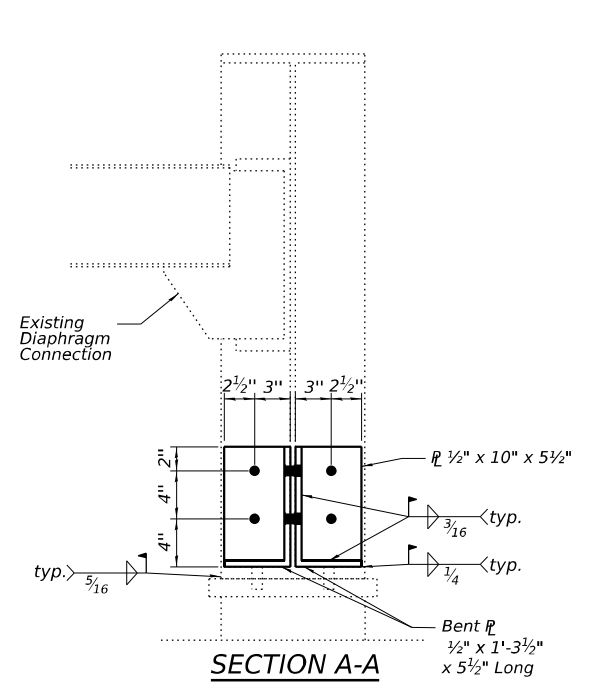
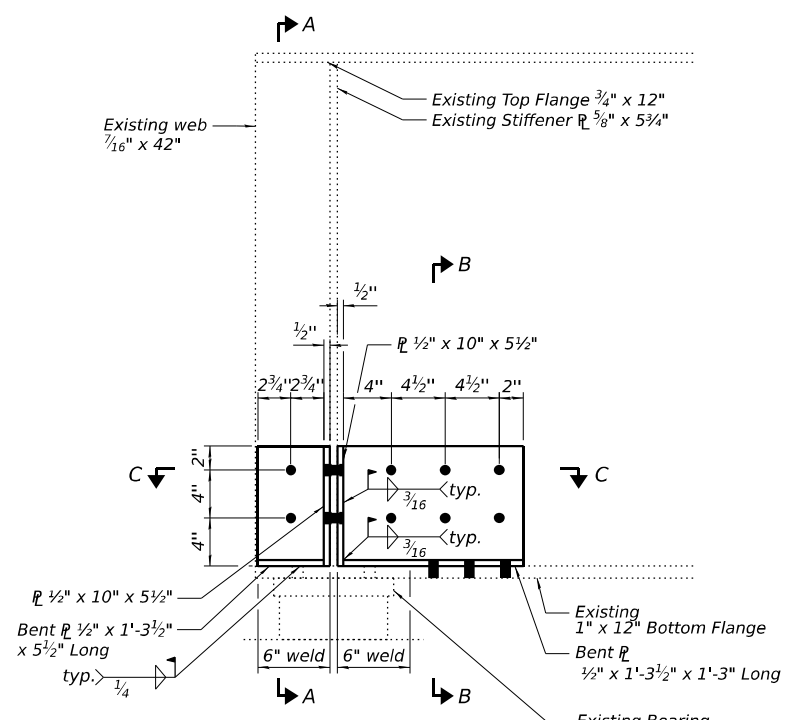
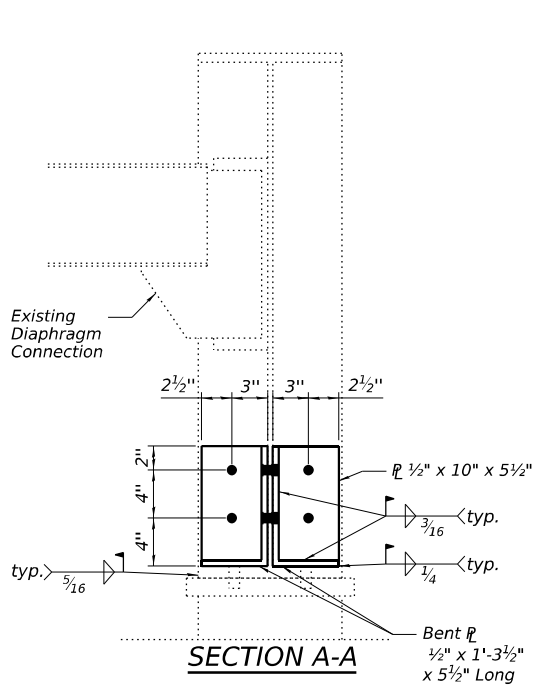

MODEL: Sheet  
 FILE NAME: J:\210465.09\DOT D6 - FTB 199-A30 - W09 - Pike County 72223\CADD\Bids\CAD\Sheet\0750036\72223-008-SR-Rev.dgn  
 Professional Design Firm No. 184-006516



USER NAME = myoung  
 PLOT SCALE = 0:2" = 1' / in.  
 PLOT DATE = 3/6/2024

DESIGNED - MJT  
 DRAWN - KTCE  
 CHECKED - JS  
 DATE - 11-01-2023

REVISED -  
 REVISED -  
 REVISED -  
 REVISED -

**STATE OF ILLINOIS**  
**DEPARTMENT OF TRANSPORTATION**

**STEEL REPAIR**  
**STRUCTURE NO. 075-0036**  
 SHEET 8 OF 9 SHEETS

F.A.P. RTE.	SECTION	COUNTY	TOTAL SHEETS	SHEET NO.
304	(1BR)BDR,BRR,BJR,I	PIKE	23	19
CONTRACT NO. 72223				
ILLINOIS FED. AID PROJECT				

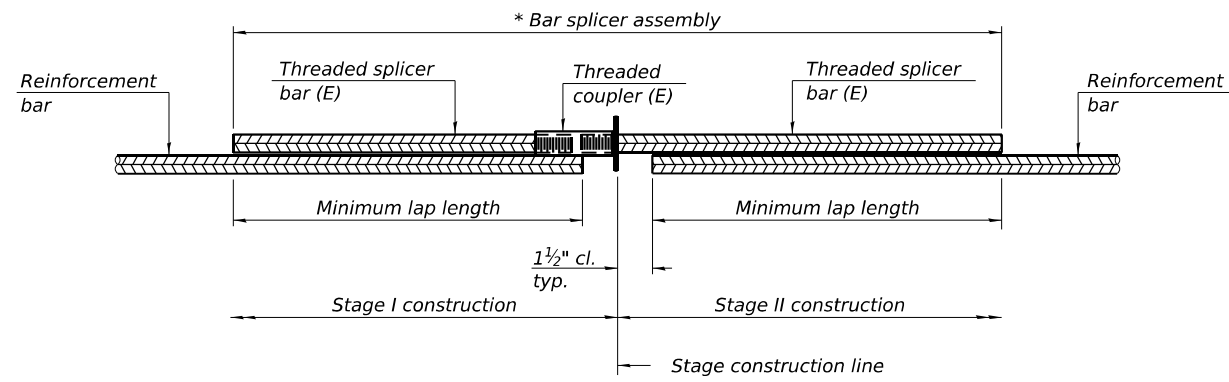

**STANDARD BAR SPLICER ASSEMBLY PLAN**

Only bar splicer assemblies as presented on the approved QPL list may be used.

Threaded splicer bar length = min. lap length + 1 1/2" + thread length

\* Epoxy not required on Bar Splicer Assembly components used in conjunction with black bars.

Location	Bar size	No. assemblies required	Minimum lap length
N. & S. Abut. - Deck	#5	8	3'-6"
N. & S. Abut. - (Block out)	#6	8	4'-0"

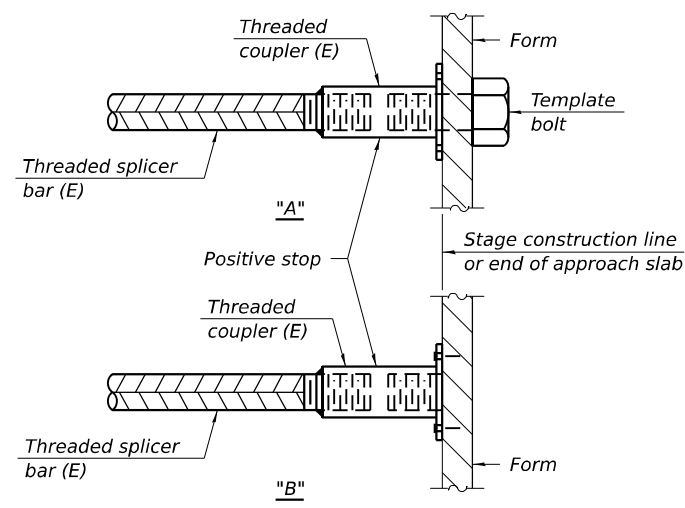

**INSTALLATION AND SETTING METHODS**

"A" : Set bar splicer assembly by means of a template bolt.  
 "B" : Set bar splicer assembly by nailing to wood forms or cementing to steel forms.  
 (E) : Indicates epoxy coating.

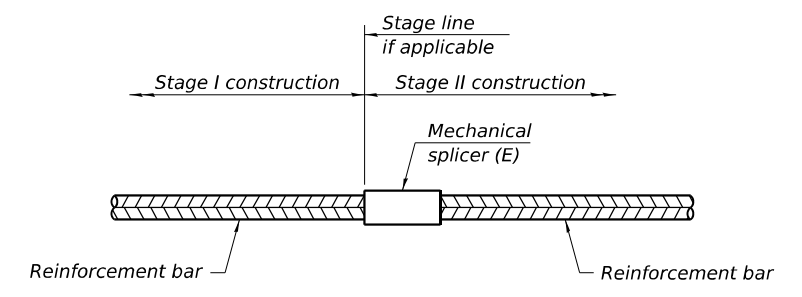

**STANDARD MECHANICAL SPLICER**

Location	Bar size	No. assemblies required

**Notes:**  
 Splicer bars shall be deformed with threaded ends and have a minimum 60 ksi yield strength.  
 All reinforcement shall be lapped and tied to the splicer bars.  
 Bar splicer assemblies shall be epoxy coated according to the requirements for reinforcement bars. See Section 508 of the Standard Specifications.  
 See approved list of bar splicer assemblies and mechanical splicers for alternatives.

MODEL: 2D Sheet 1  
 FILE NAME: 20230609 IDOT DE-PTB 19A-030-W09-R18a County 72223\CADD\Drawings\0750036\72223-09-09-Bar-splicer.dgn

BSD-1

5-15-2023



USER NAME = myoung	DESIGNED - MJT	REVISED -
DRAWN - KTCE	REVISIONS -	
PLOT SCALE = 0.16666633 1/1 in.	CHECKED - JS	REVISED -
PLOT DATE = 2/9/2024	DATE - 11-01-2023	REVISED -

**STATE OF ILLINOIS**  
**DEPARTMENT OF TRANSPORTATION**

**BAR SPLICER ASSEMBLY AND MECHANICAL SPLICER DETAILS**  
**STRUCTURE NO. 075-0036**

F.A.P. RTE.	SECTION	COUNTY	TOTAL SHEETS	SHEET NO.
304	(1BR)BDR,BRR,BJR,I	PKI	23	20
CONTRACT NO. 72223				
ILLINOIS FED. AID PROJECT				

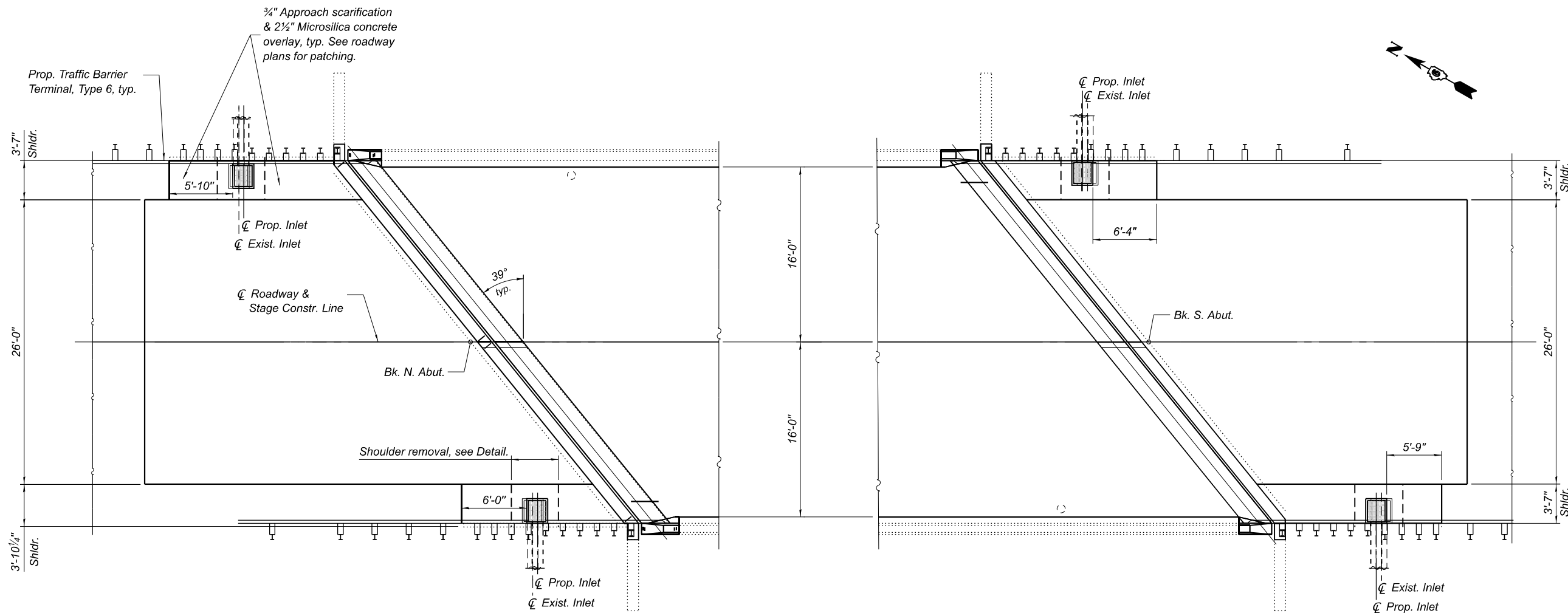

**NORTH APPROACH PLAN**

**SOUTH APPROACH PLAN**

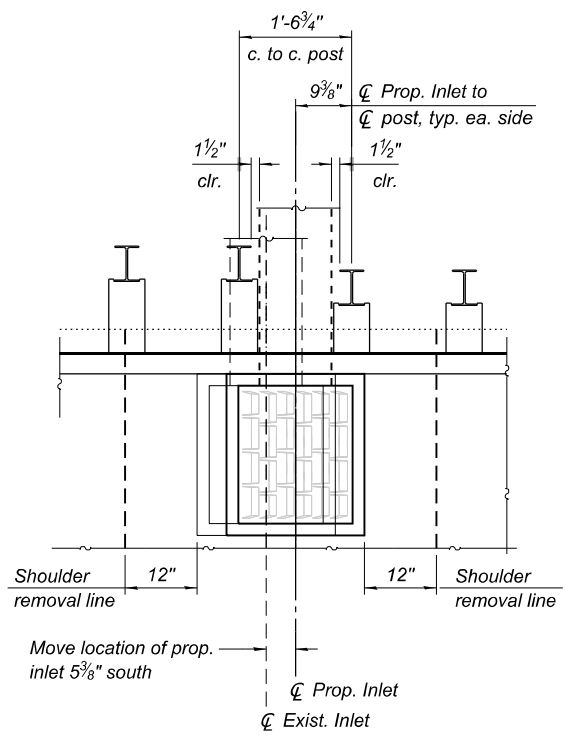

**NORTH EAST INLET DETAIL**  
(All Inlets similar - direction as noted)

- Notes:
- Any Proposed P.C.C. Slab placed within 5' of  $\varnothing$  Inlet will be paid as incidental to Inlet Type G.
  - Resident Engineer to field verify location of proposed inlets to avoid conflicts with Proposed Traffic Barrier Terminal, Type 6 posts.
  - See Schedules sheet for quantities.
  - No curb allowed beyond 18' from parapet.

MODEL SHEET: 1045.09 IDOT DE - PTB 19A-030 - W09 - Pike County 72223 CAD/DBA/CAD/Sheet/072223\_sht\_inlet\_Plan.dgn  
 FILE NAME: 1045.09 IDOT DE - PTB 19A-030 - W09 - Pike County 72223 CAD/DBA/CAD/Sheet/072223\_sht\_inlet\_Plan.dgn  
 Professional Design Firm No. 184-006516



USER NAME = msltheard	DESIGNED -	REVISED -
DRAWN -	REVISOR -	REVISOR -
PLOT SCALE = 0.16666633 1/16"	CHECKED -	REVISOR -
PLOT DATE = 2/9/2024	DATE -	REVISOR -

**STATE OF ILLINOIS**  
**DEPARTMENT OF TRANSPORTATION**

**APPROACH SLABS GUARDRAIL/INLET PLAN**  
**STRUCTURE NO. 075-0036**

SCALE: SHEET 1 OF 1 SHEETS STA. TO STA.

F.A.P. RTE. 304	SECTION (1BR)BDR,BRR,BJR,I	COUNTY PKE	TOTAL SHEETS 23	SHEET NO. 21
CONTRACT NO. 72223			ILLINOIS FED. AID PROJECT	

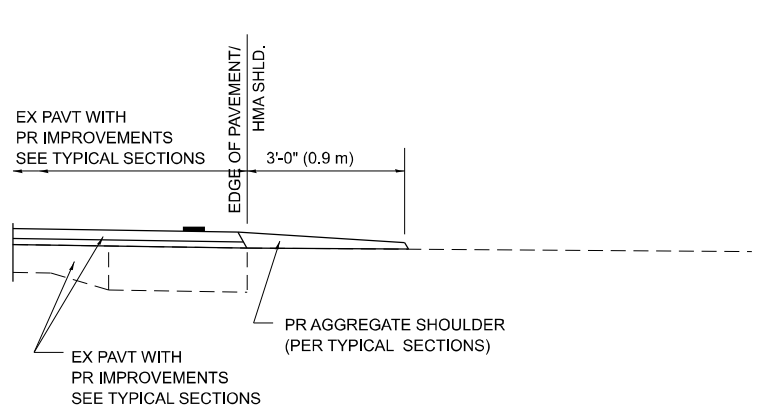

**SECTION A-A FOR EX EARTH/AGGREGATE FE**

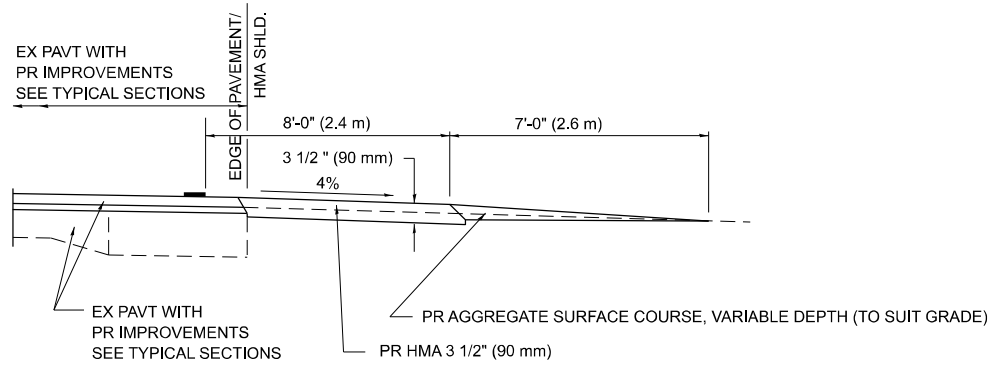

**SECTION A-A FOR EX EARTH/AGGREGATE PE**

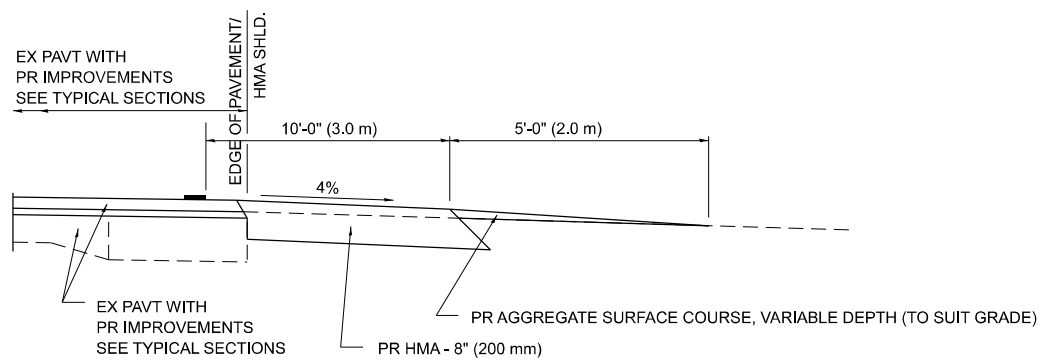

**SECTION A-A FOR EX EARTH/AGGREGATE CE & SIDE ROAD**

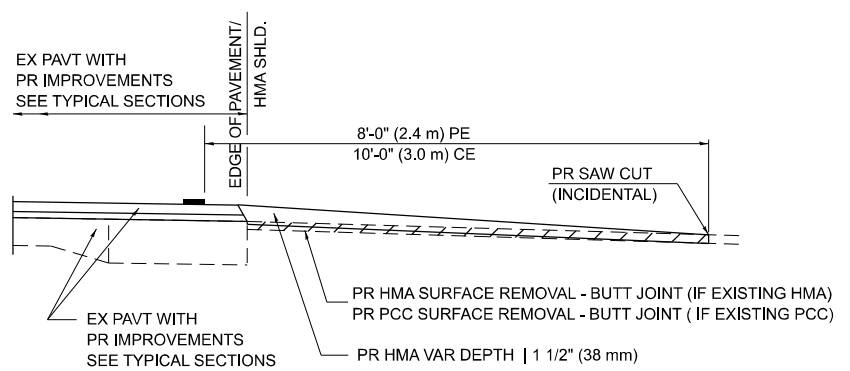

**SECTION A-A FOR EX HMA/PC CONCRETE PE, CE & SIDE ROAD**

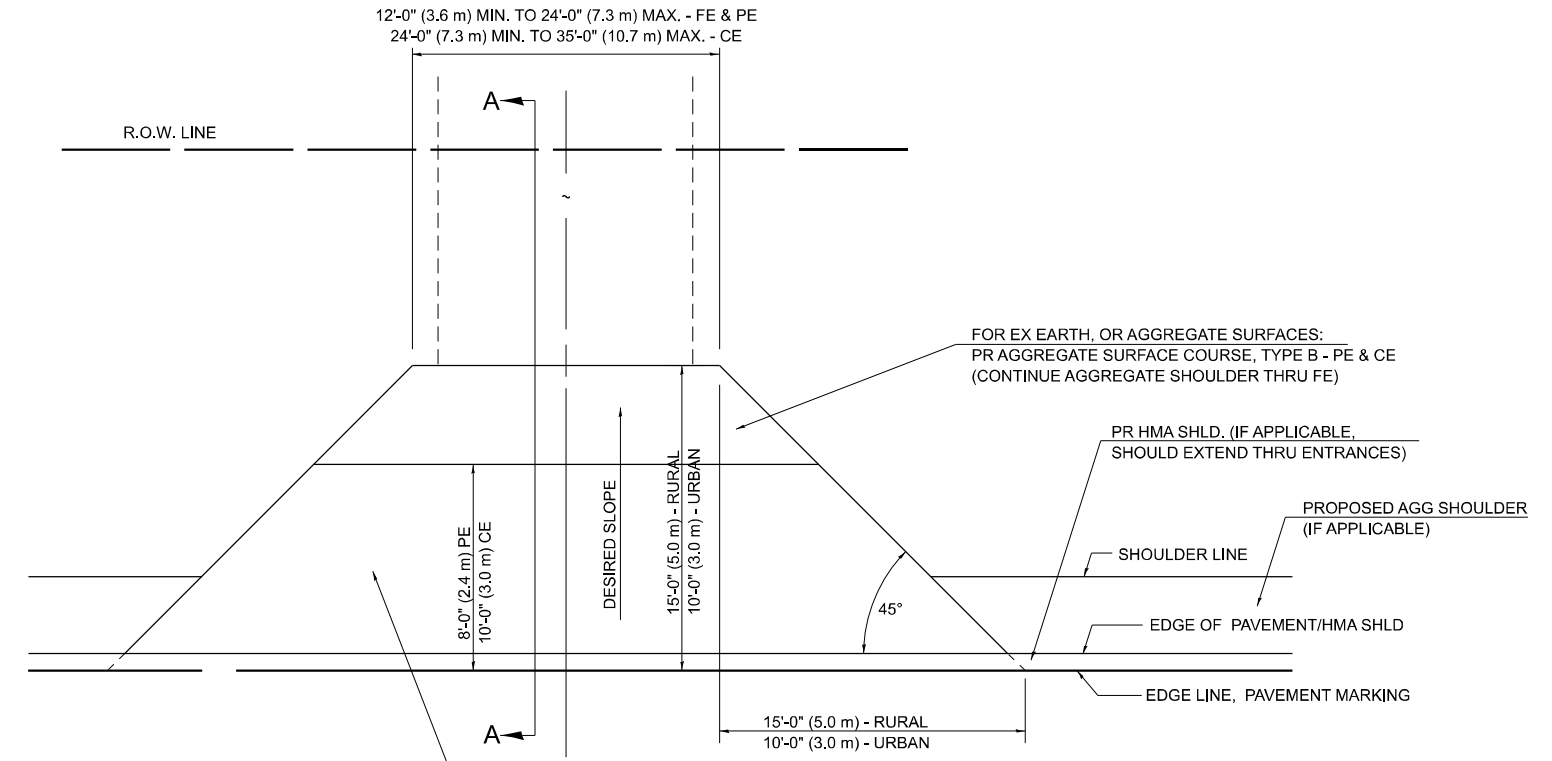

FOR EX EARTH OR AGGREGATE SURFACES:  
 PR HMA SURFACE REMOVAL (IF APPLICABLE)  
 PR AGGREGATE SHOULDER THRU - FE  
 PR HMA CONCRETE 3 1/2" (90 mm) - PE  
 PR HMA CONCRETE 8" (200 mm) - CE

FOR EX HMA CONCRETE SURFACES:  
 PR HMA SURFACE REMOVAL-BUTT JOINT

FOR EX PCC SURFACES:  
 PR PCC SURFACE REMOVAL-BUTT JOINT

**GENERAL NOTES:**

THE RESIDENT ENGINEER WILL DETERMINE THE EXACT TYPE OF IMPROVEMENT TO BE COMPLETED FOR ALL ENTRANCES, SIDEROADS AND MAILBOX TURNOUTS ON THIS PROJECT.

THE PLAN DETAILS AND SCHEDULES SHOULD BE USED AS A GUIDE FOR THE ENGINEER TO IMPLEMENT THE FINAL DESIGN. THE ENGINEER MAY DECIDE TO SALVAGE PORTIONS OF THE EXISTING ENTRANCE PAVEMENT STRUCTURE; THEREFORE, REDUCING PAY ITEM QUANTITIES. NO ADDITIONAL PAYMENT WILL BE ALLOWED FOR THIS REDUCTION IN QUANTITIES.

ANY WORK THE ENGINEER REQUIRES WHICH IS NOT COVERED BY A PAY ITEM CONTAINED IN THE PLANS WILL BE PAID FOR IN ACCORDANCE WITH ARTICLE 109.04 OF THE STANDARD SPECIFICATIONS.

HMA CONCRETE REQUIRED TO CONSTRUCT THE ENTRANCES SHALL BE IN ACCORDANCE WITH THE APPLICABLE PORTIONS OF SECTION 406 AND 408 OF THE STANDARD SPECIFICATIONS AND AS DIRECTED BY THE ENGINEER.

WHEN THE HMA CONCRETE PROPOSED FOR THE IMPROVEMENT IS THICKER THAN 3 INCHES (75 mm) AND REQUIRE PLACEMENT IN MORE THAN ONE LIFT. THE BOTTOM LIFT(S) SHALL MEET THE REQUIREMENTS OF HMA BASE COURSE IN SECTION 406 OF THE STANDARD SPECIFICATIONS AND THE TOP LIFT OF 2 INCHES (50 mm) SHALL MEET THE REQUIREMENTS OF HMA CONCRETE SURFACE COURSE, SUPERPAVE.

THIS WORK WILL BE PAID FOR IN ACCORDANCE WITH SECTIONS 351, 358, 408, 423 AND 440 OF THE STANDARD SPECIFICATIONS.

ALL DIMENSIONS ARE IN INCHES (MILLIMETERS) UNLESS OTHERWISE SHOWN.

NOTE: IF HMA SHLDS ARE PROPOSED THEY SHOULD NOT EXTEND THROUGH SIDEROADS

USE THIS SHEET IN CONJUNCTION WITH ROADWAY PLAN SHEET AND AS DIRECTED BY THE ENGINEER.

MODEL SHEET  
 FILE NAME: \\1210465.09\DOT\06-PTB-199-030-1\W09-Rike County 72223\CADD\BDR\CADD\BDR\072223\_sht\_Details\_PE-1.dgn



USER NAME = msutheard	DESIGNED -	REVISED -
PLOT SCALE = 0.16666633 1/16"	DRAWN -	REVISED -
PLOT DATE = 2/9/2024	CHECKED -	REVISED -
	DATE -	REVISED -

**STATE OF ILLINOIS  
DEPARTMENT OF TRANSPORTATION**

**DISTRICT 6 DETAILS FOR RURAL /URBAN ENTRANCE &  
MAILBOX TURNOUT W/O CONC GUTTER (3R - PROJECTS)**

F.A.P. RTE. 304	SECTION (1BR)BDR,BRR,BJR,I	COUNTY PKE	TOTAL SHEETS 23	SHEET NO. 22
CONTRACT NO. 72223				
ILLINOIS FED. AID PROJECT				

SCALE: SHEET 1 OF 1 SHEETS STA. TO STA.



**DETAILS OF MAILBOX TURNOUTS**

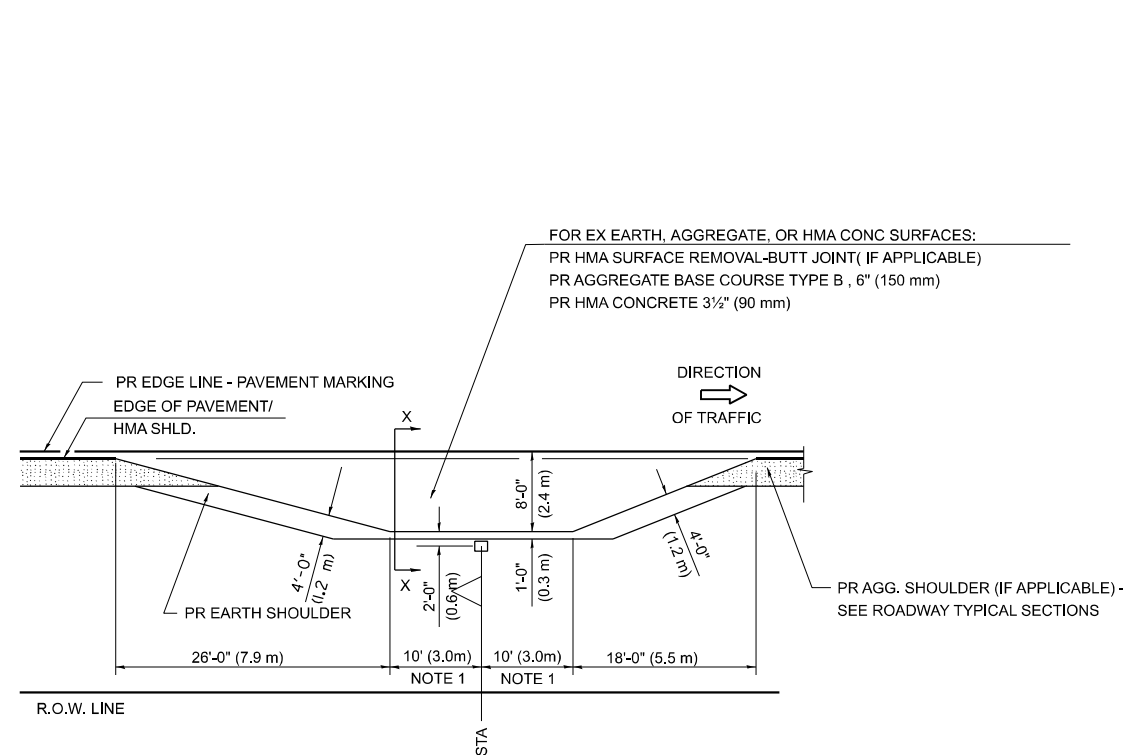

**PLAN - MAILBOX TURNOUTS**

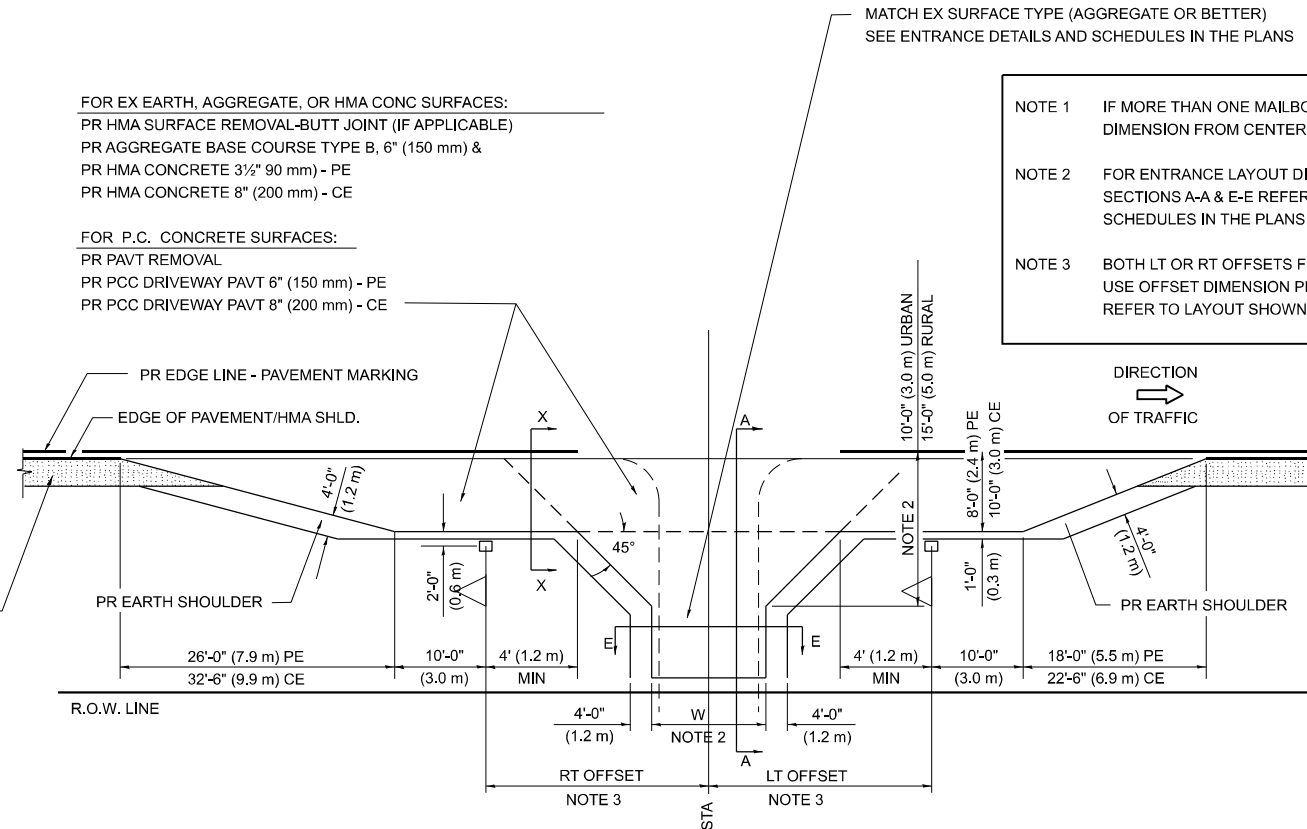

**PLAN - COMBINED MAILBOX TURNOUT WITH TRAILING OR LEADING ENTRANCE**

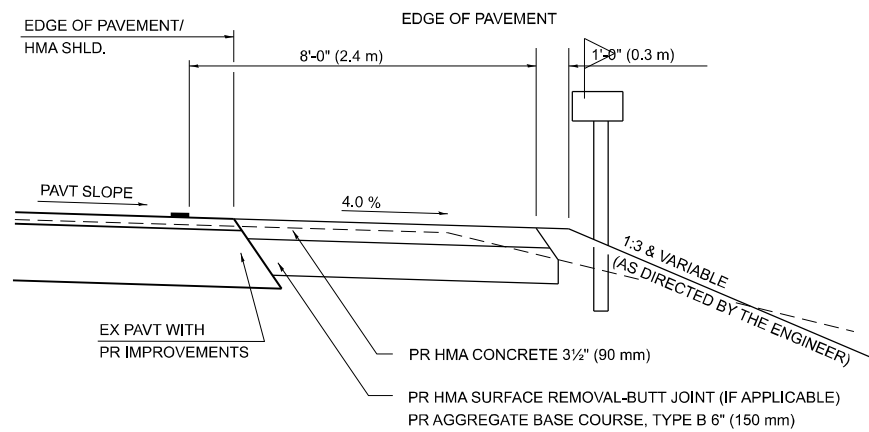

**SECTION X-X THRU MAILBOX TURNOUT  
 ALSO APPLIES TO MAILBOX TURNOUTS COMBINED WITH  
 EX EARTH, AGGREGATE, OR HMA PE & FE**

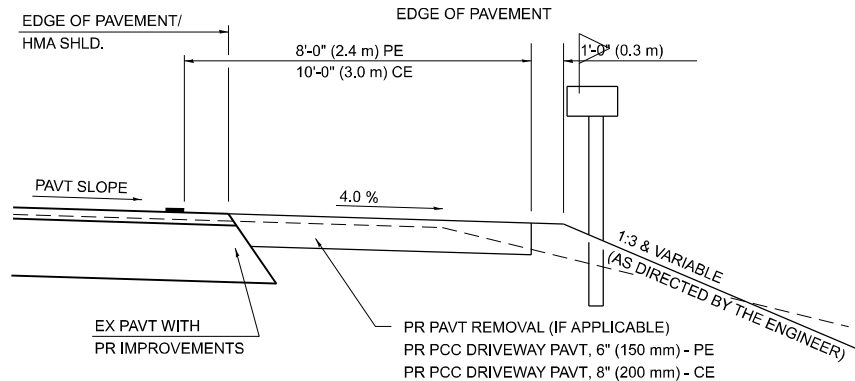

**SECTION X-X THRU MAILBOX TURNOUT  
 COMBINED WITH EX CONC PE OR CE**

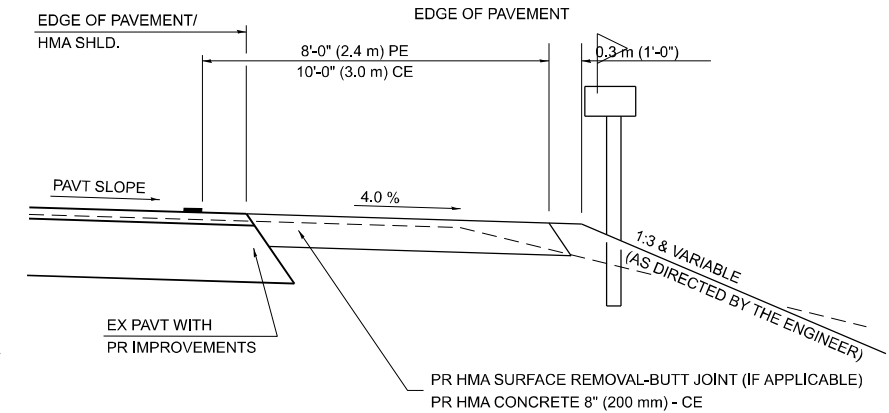

**SECTION X-X THRU MAILBOX TURNOUT  
 COMBINED WITH EX EARTH, AGGREGATE, OR HMA CE**

USE THIS SHEET IN CONJUNCTION WITH ROADWAY PLAN SHEET  
 AND AS DIRECTED BY THE ENGINEER.

MODEL SHEET: 1211046.09 IDOT D6 - PTB 19A-030 - W09 - Pike County 72223 CAD/Details/072223\_sht\_Details\_PE-2.dgn  
 FILE NAME: 1211046.09 IDOT D6 - PTB 19A-030 - W09 - Pike County 72223 CAD/Details/072223\_sht\_Details\_PE-2.dgn



USER NAME = msutheard	DESIGNED -	REVISED -
PLOT SCALE = 0.16666633 1/16"	DRAWN -	REVISED -
PLOT DATE = 2/9/2024	CHECKED -	REVISED -
	DATE -	REVISED -

**STATE OF ILLINOIS  
 DEPARTMENT OF TRANSPORTATION**

**DISTRICT 6 DETAILS FOR RURAL /URBAN ENTRANCE &  
 MAILBOX TURNOUT W/O CONC GUTTER (3R - PROJECTS)**

SCALE: SHEET 1 OF 1 SHEETS STA. TO STA.

F.A.P. RTE.	SECTION	COUNTY	TOTAL SHEETS	SHEET NO.
304	(1BR)BDR,BRR,BJR,I	PIKE	23	23
CONTRACT NO. 72223				
ILLINOIS FED. AID PROJECT				