

04-26-2024 LETTING ITEM 068

INDEX OF SHEETS

- 1 COVER SHEET
- 2 GENERAL NOTES AND COMMITMENTS
- 3 SUMMARY OF QUANTITIES
- 4 SCHEDULE OF QUANTITIES
- 5 PLAN AND PROFILE SHEET
- 6 CULVERT PLAN SHEET
- 7 CULVERT END SECTION DETAIL
- 8 CULVERT LINING DETAIL
- 9 TRAIL SIGNING

HIGHWAY STANDARDS

- 701411-09 LANE CLOSURE MULTILANE AT ENTRANCE OR EXIT RAMP FOR SPEEDS GREATER THAN OR EQUAL TO 45 MPH
- 701901-09 TRAFFIC CONTROL DEVICES

STATE OF ILLINOIS
DEPARTMENT OF TRANSPORTATION

PROPOSED
HIGHWAY PLANS

FAP ROUTE 318 (IL ROUTE 6)
SECTION (72-7-3)CLV
STATE 0-02178-4024
CONTRACT MAINTENANCE
PEORIA COUNTY

F.A.P. RTE.	SECTION	COUNTY	TOTAL SHEETS	SHEET NO.
318	(72-7-3)CLV	PEORIA	9	1
		ILLINOIS	CONTRACT NO. 68H83	

D-94-002-24

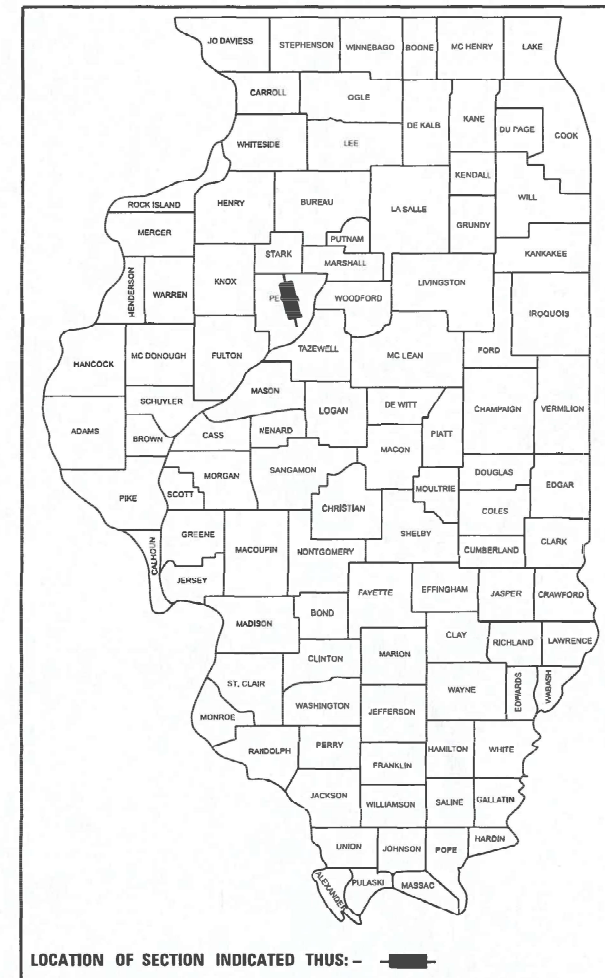

DESCRIPTION OF PROJECT:
THIS PROJECT CONSISTS CONCRETE LINING OF THE PIPE INVERT FOR THE EAST CULVERT PIPE.

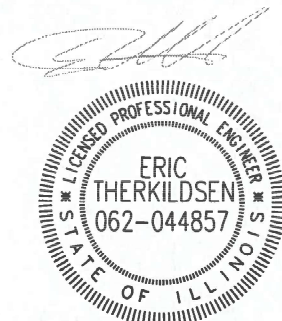

DATE SIGNED : 11/07/2023
LIC. EXP. DATE : 11/30/2025

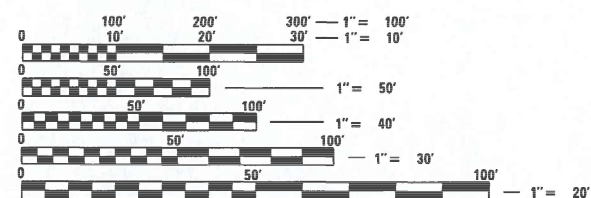

FULL SIZE PLANS HAVE BEEN PREPARED USING STANDARD ENGINEERING SCALES. REDUCED SIZED PLANS WILL NOT CONFORM TO STANDARD SCALES. IN MAKING MEASUREMENTS ON REDUCED PLANS, THE ABOVE SCALES MAY BE USED.

J.U.L.I.E.
JOINT UTILITY LOCATION INFORMATION FOR EXCAVATION
1-800-892-0123
OR 811

PROJECT ENGINEER: BEN TELLEFSON (309) 671-4477
PROJECT MANAGER: MARK ECKHOFF (309) 671-4463

CONTRACT NO. 68H83
CATALOG NO. 036449-00D



C-94-002-24

S.N. 072-2012
DOUBLE CMP
BENEATH
IL RTE 6

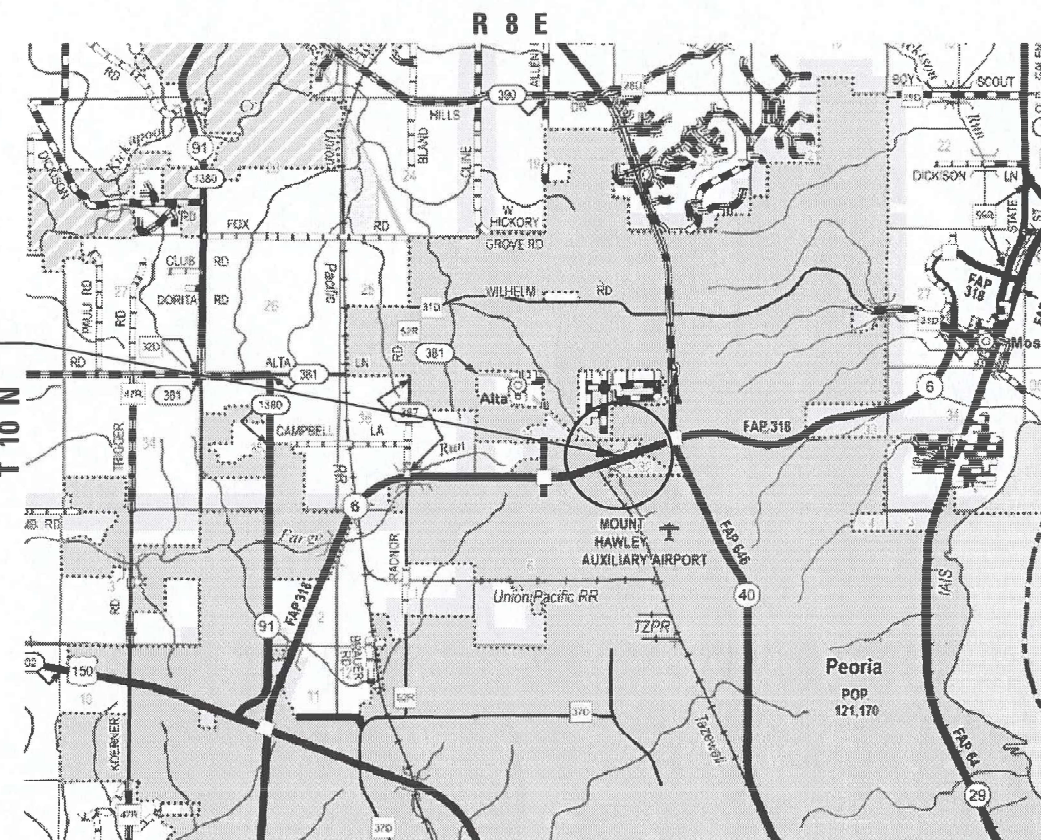

GROSS LENGTH = 500.00 FT. = 0.095 MILE
NET LENGTH = 500.00 FT. = 0.095 MILE

STATE OF ILLINOIS
DEPARTMENT OF TRANSPORTATION

SUBMITTED February 2, 2024
Ronda Jones
REGIONAL ENGINEER

March 22, 2024
S. E. A. Etk
ENGINEER OF DESIGN AND ENVIRONMENT

March 22, 2024
Stephen M. Smith
DIRECTOR OF HIGHWAYS PROJECT IMPLEMENTATION

PRINTED BY THE AUTHORITY
OF THE STATE OF ILLINOIS

GENERAL NOTES:

ENVIRONMENTAL REVIEWS

PRIOR TO THE USE OF ANY PROPOSED BORROW AREAS, USE AREAS (TEMPORARY ACCESS ROADS, DETOURS, RUN-AROUNDS, ETC.) AND/OR WASTE AREAS, THE CONTRACTOR SHALL FILE THE REQUIRED ENVIRONMENTAL RESOURCE REQUEST SURVEYS ACCORDING TO SECTION 107.22 OF THE STANDARD SPECIFICATIONS. THESE SURVEYS ARE REQUIRED IN ORDER FOR THE DEPARTMENT TO CONDUCT CULTURAL AND BIOLOGICAL RESOURCE SURVEYS FOR THE PROPOSED SITES.

THE REQUIRED ENVIRONMENTAL RESOURCE DOCUMENTATION SHALL INCLUDE THE FOLLOWING:

- BDE FORM 2289 (BORROW SITE REVIEW)
- BDE FORM 2290 (WASTE/USE AREA REVIEW)
- A LOCATION MAP SHOWING THE SIZE LIMITS AND LOCATION OF THE USE AREA
- COLOR PHOTOGRAPHS DEPICTING THE USE AREA
- BORROW AREA ENTRY AGREEMENT FORM-D4 PI0101

PRIOR TO ANY WASTE MATERIALS BEING REMOVED FROM THE CONSTRUCTION SITE THE REQUIRED ENVIRONMENTAL RESOURCE SURVEYS SHALL BE OBTAINED AND FILED BY THE CONTRACTOR. EXCESS WASTE PRODUCTS REMOVED FROM THE CONSTRUCTION SITE SHALL BE DISPOSED OF AS REQUIRED IN SECTION 202.03 OF THE STANDARD SPECIFICATIONS.

ANY PROTRUDING METAL BARS SHALL BE REMOVED PRIOR TO THE DISPOSAL OF BROKEN CONCRETE AT APPROVED DISPOSAL SITES.

PLEASE NOTE THAT A MINIMUM OF FOUR WEEKS SHALL BE ALLOWED FOR THE DISTRICT TO OBTAIN THE REQUIRED WASTE SITE ENVIRONMENTAL CLEARANCES AND SIX WEEKS FOR THE REQUIRED BORROW SITE ENVIRONMENTAL CLEARANCES.

PLAN ELEVATIONS & COORDINATES -

ALL ELEVATIONS SHOWN REFER TO U.S.G.S. DATUM AT MEAN SEA LEVEL (UNLESS OTHERWISE NOTED).

SUPPLEMENTAL TRAFFIC CONTROL

THE DEPARTMENT RESERVES THE RIGHT AT ANY TIME TO ADD ADDITIONAL TRAFFIC CONTROL SYSTEMS OR DEVICES WITHIN THE ACTIVE CONTRACT LIMITS, BY MEANS OF AN ADDITIONAL CONTRACT. ALL TERMS OF ARTICLE 105.08 OF THE STANDARD SPECIFICATIONS SHALL BE FOLLOWED BY EACH CONTRACTOR.

COMMITMENTS

COMMITMENTS ARE NOT TO BE ALTERED WITHOUT THE WRITTEN APPROVAL OF ALL PARTIES TO WHICH THE COMMITMENT WAS MADE.

THE ROCK ISLAND GREENWAY BIKE TRAIL MAY BE CLOSED AS SHOWN IN THE PLANS FOR NO MORE THAN 30 CALENDAR DAYS. THE PEORIA PARK DISTRICT SHALL BE NOTIFIED A MINIMUM OF 7 CALENDAR DAYS PRIOR TO CLOSING THE TRAIL AT (309) 682-1200.

NO CONSTRUCTION TRAFFIC OF ANY KIND CAN BE DRIVEN ON ANY PORTION OF THE ROCK ISLAND GREEWAY BIKE TRAIL AT ANY TIME, INCLUDING THE CLOSED SECTION.

ALL ACCESS TO THE SITE WILL BE FROM IL ROUTE 6 SOUTHBOUND. THE CONTRACTOR IS RESPONSIBLE FOR RESTORING ANY DAMAGE, INCLUDING BUT NOT LIMITED TO REGRADING THE SLOPE, APPLICATION OF SEED, FERTILIZER AND EROSION CONTROL BLANKET.

MODEL: Default FILE NAME: D:\Illuminaty\p\hantley.com\laramas\p\01\Documents\Projects\2022\22-128 IDOT DA Work Order\22-29-001 DA Three Structures\CADD Data\Sheet\07-2012 IL 6 DN CMP\22182021-072012-SHT-GENNOTE.dgn



USER NAME = brennas	DESIGNED - BKR	REVISED -
	DRAWN - BKR	REVISED -
PLOT SCALE = 2.000' / in.	CHECKED - CEM	REVISED -
PLOT DATE = 1/22/2024	DATE - 2023/11/01	REVISED -

**STATE OF ILLINOIS
DEPARTMENT OF TRANSPORTATION**

**GENERAL NOTES AND COMMITMENTS
SN 072-2012 IL 6 DOUBLE CMP**

SCALE: SHEET OF SHEETS STA. TO STA.

F.A.P. RTE.	SECTION	COUNTY	TOTAL SHEETS	SHEET NO.
0318	(72-7-3)CLV	PEORIA	9	2
CONTRACT NO. 68H83			ILLINOIS FED. AID PROJECT	

MODEL: Default FILE NAME: \\server\engineering\j... Documents\Projects\2022\22-129 IDOT DA Work Orders\22-129\01 DA Three Structures\CADD Data\Sheet072-2012-IL 6 DN CMP\2162021-072012-SHT-BCO.dgn

100% STATE

CONST. CODE
CULVERT
SN 072-2012
0013
URBAN

ITEM NO.	DESCRIPTION	UNIT	TOTAL QUANTITY
50300225	CONCRETE STRUCTURES	CU YD	49.3
50800105	REINFORCEMENT BARS	POUND	1174
60920108	PIPE CULVERTS TO BE CLEANED 108"	FOOT	428
67100100	MOBILIZATION	L SUM	1
X5021507	DEWATERING	L SUM	1
X7010210	TRAFFIC CONTROL AND PROTECTION, STANDARD 701411 (SPECIAL)	EACH	1
Z0016702	DETOUR SIGNING	L SUM	1



USER NAME = brennas	DESIGNED - BKR	REVISED -
PLOT SCALE = 50,000' / in.	DRAWN - BKR	REVISED -
PLOT DATE = 1/24/2024	CHECKED - CEM	REVISED -
	DATE - 2023/11/01	REVISED -

STATE OF ILLINOIS DEPARTMENT OF TRANSPORTATION

SUMMARY OF QUANTITIES SN 072-2012 IL 6 DOUBLE CMP

SCALE: SHEET 1 OF 1 SHEETS STA. TO STA.

F.A.P. RTE.	SECTION	COUNTY	TOTAL SHEETS	SHEET NO.
0318	(72-7-3)CLV	PEORIA	9	3
ILLINOIS FED. AID PROJECT			CONTRACT NO. 68H83	

MODEL: Default
 FILE NAME: \\s:\s\manning\c\h\h\com\manning\p\01\Documents\Projects\2022\22-129 IDOT DA Work Orders\22-129-021 DA Three Structures\CADD Data\Sheets\072-2012 IL 6 DN CMP\22182021-072012-SHT-SCHED.dgn

STRUCTURES							
LOCATION	50300225	50800105	60920108	67100100	X5021507	X7010210	Z0016702
	CONCRETE STRUCTURES	REINFORCEMENT BARS	PIPE CULVERTS TO BE CLEANED, 108"	MOBILIZATION	DEWATERING	TRAFFIC CONTROL AND PROTECTION, STANDARD 701411 (SPECIAL)	DETOUR SIGNING
	CU YD	POUND	FOOT	L SUM	L SUM	EACH	L SUM
STA. 903+50.00	49.3	1174	428	1	1	1	1
TOTAL	49.3	1174	428	1	1	1	1



USER NAME = brennas	DESIGNED - BKR	REVISED -
	DRAWN - BKR	REVISED -
PLOT SCALE = 2.000' / in.	CHECKED - CEM	REVISED -
PLOT DATE = 1/24/2024	DATE - 2023/11/01	REVISED -

**STATE OF ILLINOIS
 DEPARTMENT OF TRANSPORTATION**

**SCHEDULE OF QUANTITIES
 SN 072-2012 IL 6 DOUBLE CMP**

SCALE: SHEET 1 OF 1 SHEETS STA. TO STA.

F.A.P. RTE.	SECTION	COUNTY	TOTAL SHEETS	SHEET NO.
0318	(72-7-3)CLV	PEORIA	9	4
ILLINOIS FED. AID PROJECT			CONTRACT NO. 68H83	

TION - R8E-4PM
SEC. 32

TION - R8E-4PM
SEC. 31

ROUTE NO.	SECTION	COUNTY
FA 405 72-7-3		PEORIA
STA. 890+00		STA. 910+00
FED. ROAD DIST. NO. 4		

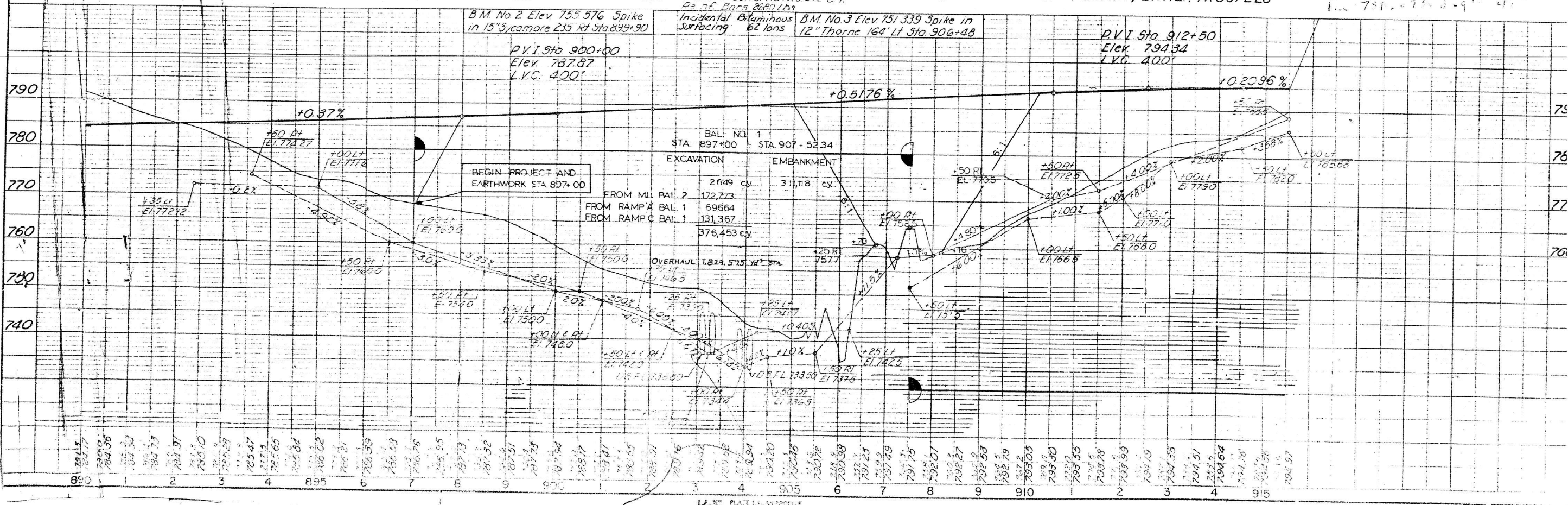
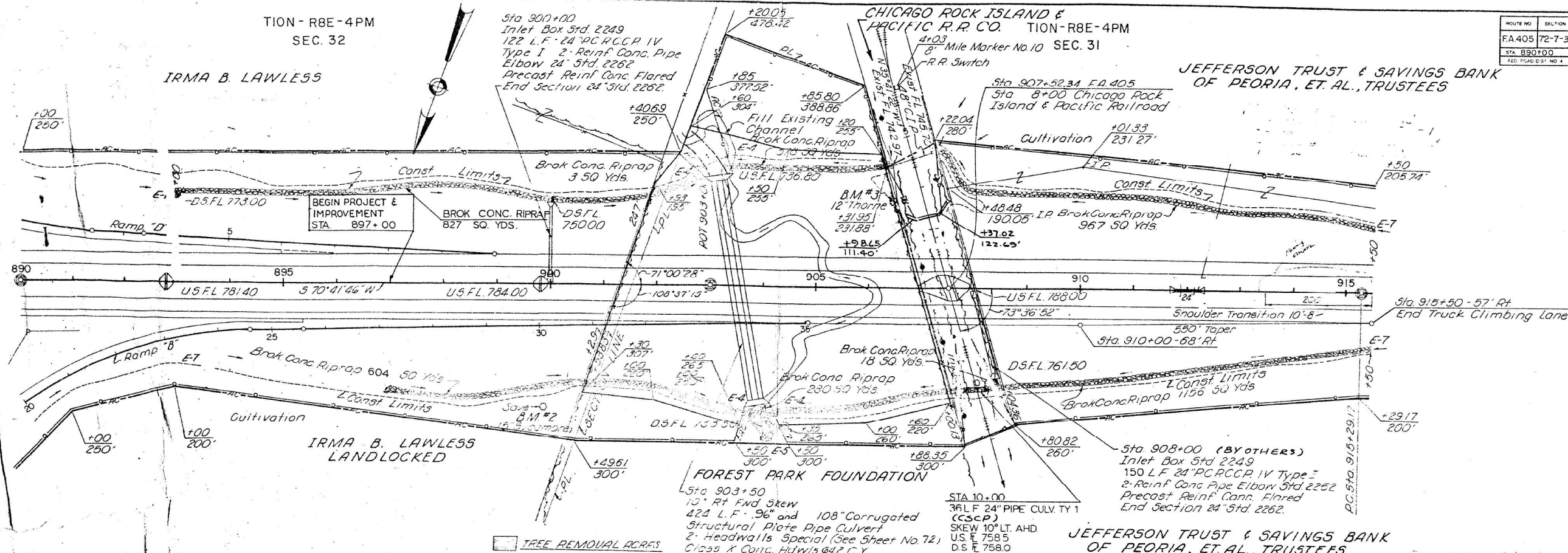

FOR INFORMATION ONLY

	USER NAME = brennas	DESIGNED - BKR	REVISED -	STATE OF ILLINOIS DEPARTMENT OF TRANSPORTATION	PLAN AND PROFILE SN 072-2012 IL 6 DOUBLE CMP			F.A.P. RTE. 0318	SECTION (72-7-3)CLV	COUNTY PEORIA	TOTAL SHEETS 9	SHEET NO. 5
	PLOT SCALE = 2,000' / in.	CHECKED - CEM	REVISED -		SCALE:	SHEET	OF	SHEETS	STA.	TO	STA.	ILLINOIS
	PLOT DATE = 1/22/2024	DATE - 2023/11/01	REVISED -								CONTRACT NO. 68H83	

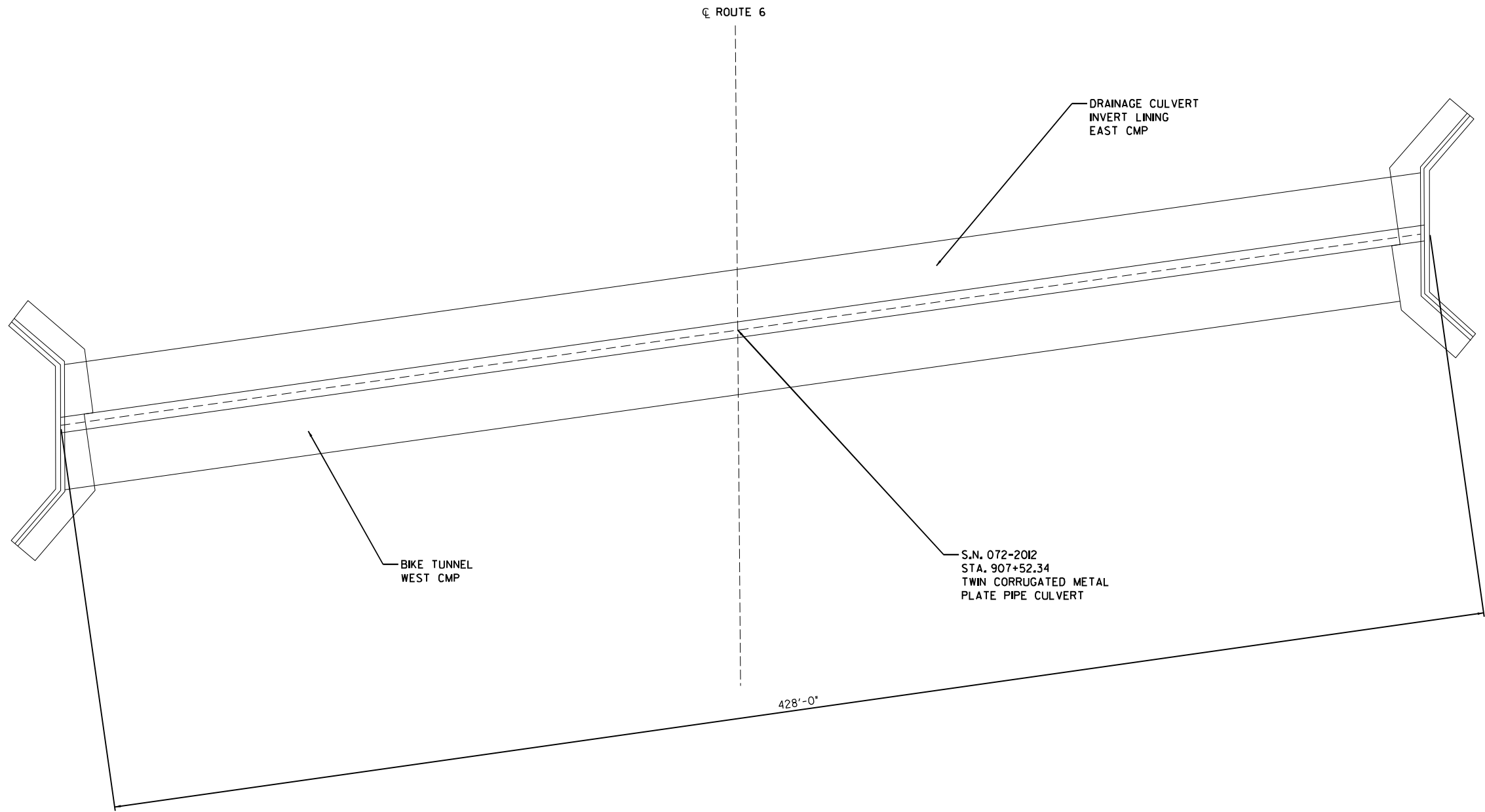
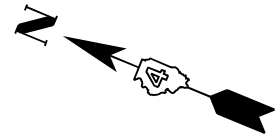

PLAN

MODEL: D:\data\Terra\Illinois\Projects\2022\22-23 IDOT D4 Work Order\22-23\2021 D4 Three Structures\CADD Data\Sheet\072-2012 IL 6 DN\CMP\213002-4372012-SHT-CULV.PLAN.dgn
 FILE NAME: \\server\poc\hobby\com\user\poc\41\Documents\Projects\2022\22-23 IDOT D4 Work Order\22-23\2021 D4 Three Structures\CADD Data\Sheet\072-2012 IL 6 DN\CMP\213002-4372012-SHT-CULV.PLAN.dgn



USER NAME = brennas	DESIGNED - BKR	REVISED -
PLOT SCALE = 2,000' / in.	DRAWN - BKR	REVISED -
PLOT DATE = 1/22/2024	CHECKED - CEM	REVISED -
	DATE - 2023/11/01	REVISED -

STATE OF ILLINOIS
DEPARTMENT OF TRANSPORTATION

CULVERT PLAN
SN 072-2012 IL 6 DOUBLE CMP

SCALE: SHEET 1 OF 1 SHEETS STA. TO STA.

F.A.P. RTE. 0318	SECTION (72-7-3)CLV	COUNTY PEORIA	TOTAL SHEETS 9	SHEET NO. 6
CONTRACT NO. 68H83			ILLINOIS FED. AID PROJECT	

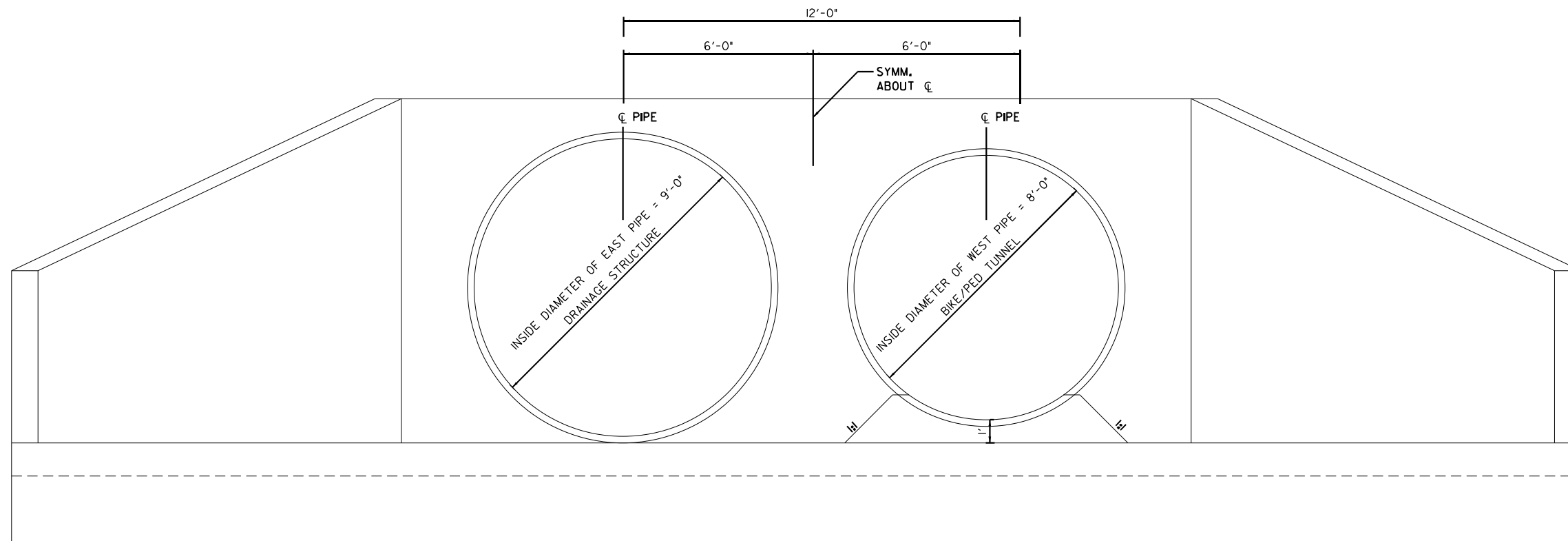

END ELEVATION (TYPICAL BOTH ENDS OF CMP'S)

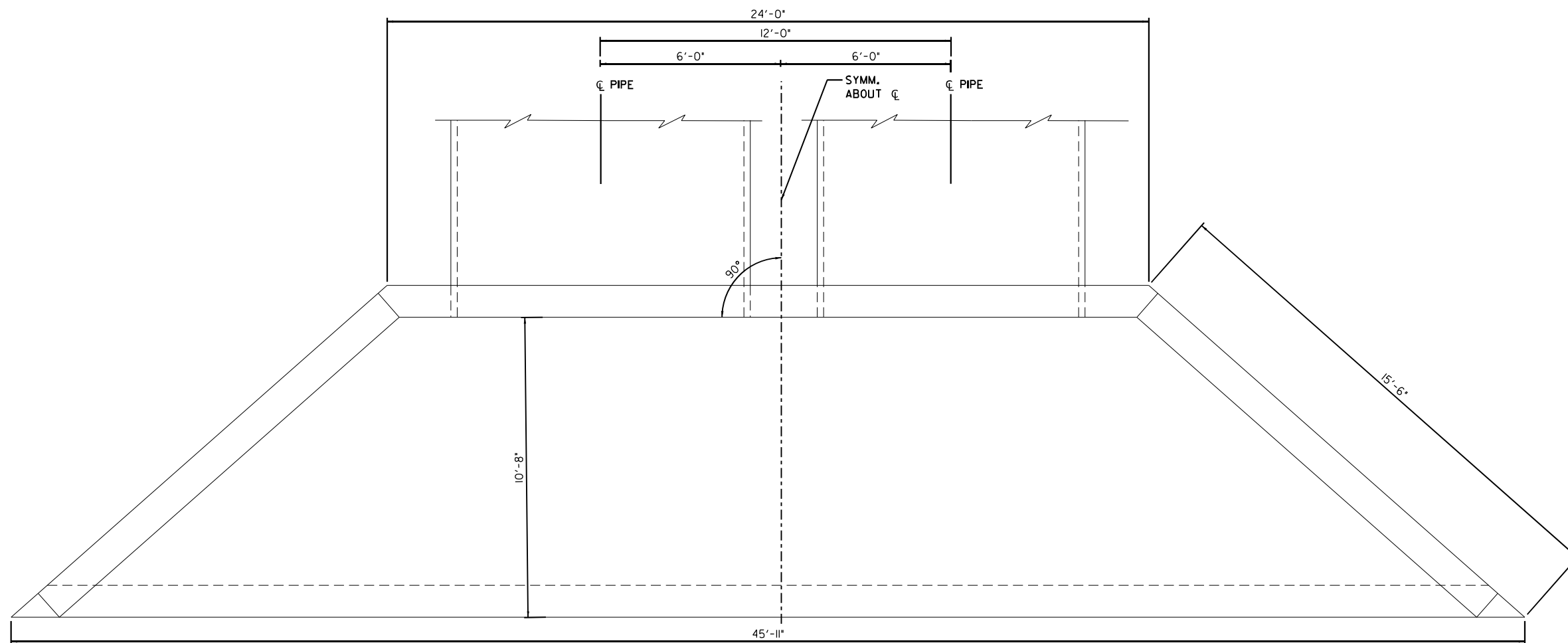

PLAN

MODEL: D:\info\...
 FILE NAME: ...
 USER: brennas
 DATE: 1/22/2024



USER NAME	= brennas
PLOT SCALE	= 2,000' / 1" =
PLOT DATE	= 1/22/2024

DESIGNED	- BKR
DRAWN	- BKR
CHECKED	- CEM
DATE	- 2023/11/01

REVISED	-
REVISED	-
REVISED	-
REVISED	-

STATE OF ILLINOIS
DEPARTMENT OF TRANSPORTATION

CULVERT HEADWALL DETAIL
SN 072-2012 IL 6 DOUBLE CMP

SCALE: SHEET 1 OF 1 SHEETS STA. TO STA.

F.A.P. RTE.	SECTION	COUNTY	TOTAL SHEETS	SHEET NO.
0318	(72-7-3)CLV	PEORIA	9	7
CONTRACT NO. 68H83				
ILLINOIS FED. AID PROJECT				

LOCATION	PIPE LENGTH (L)	DIAMETER (D)	ARC LENGTH (X)	CORRIGATED RIB DEPTH (h)	CONCRETE STRUCTURES	REINFORCEMENT BARS
	FT	FT	FT	IN	CU YD	LBS
EAST CULVERT	428	9	9.4	2	49.3	1,174

NOTE:
PIPES SHALL BE CLEANED AND DEWATERED TO THE SATISFACTION OF THE ENGINEER PRIOR TO PLACING CULVERT LINING SYSTEM. SEE SPECIAL PROVISIONS. CLEANING SHALL BE PAID FOR AS PIPE CULVERTS TO BE CLEANED AND DEWATERING SHALL BE PAID FOR AS DEWATERING.

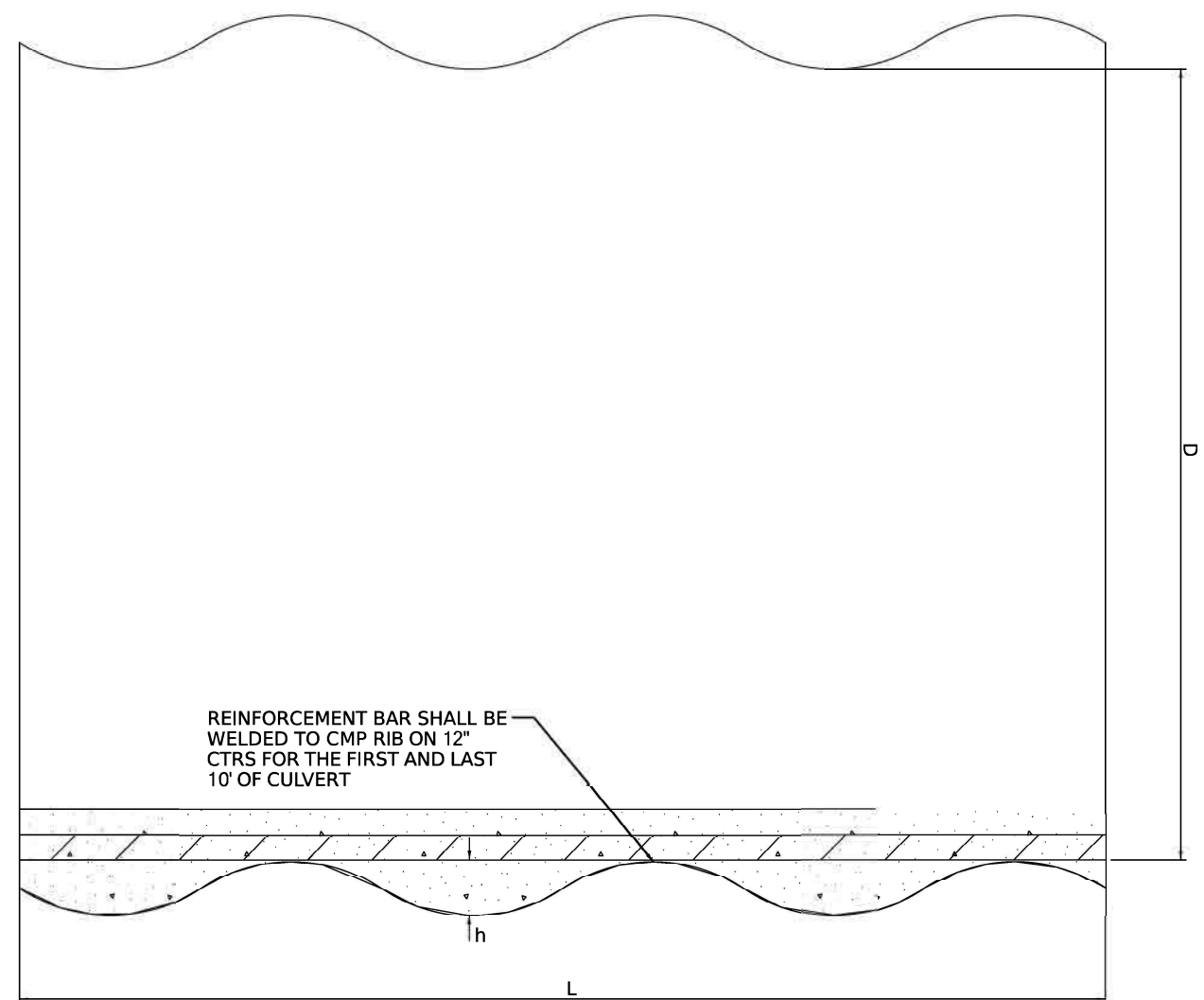
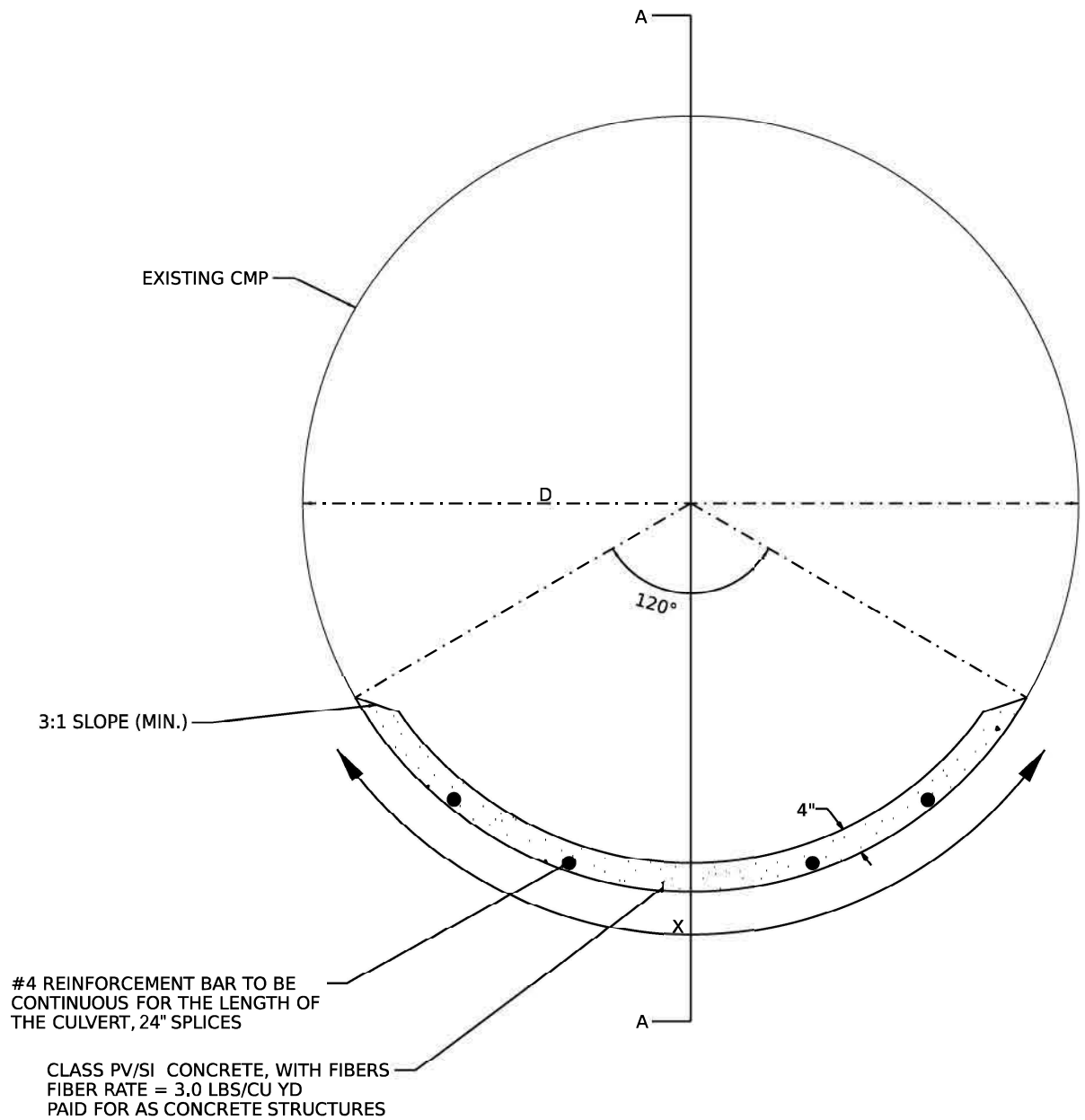

SECTION A-A

DRAWING NOT TO SCALE
ACTUAL FIELD LOCATIONS AND
MEASUREMENTS SHALL BE VERIFIED

MODEL: Detail; FILE NAME: \\s:\bentley\project\2023\22-129\DOT\DWG\072-2012\IL6\DN\CMP\213001-0722012-SHT-CULVERT LINING DETAIL-01



USER NAME = brennas	DESIGNED - BKR	REVISED -
PLOT SCALE = 2.000 /in.	DRAWN - BKR	REVISED -
PLOT DATE = 1/24/2024	CHECKED - CEM	REVISED -
	DATE = 2023/1 /01	REVISED -

STATE OF ILLINOIS
DEPARTMENT OF TRANSPORTATION

CULVERT LINING DETAILS
SN 072-2012 IL 6 DOUBLE CMP

SCALE: SHEET 1 OF 1 SHEETS STA. TO STA.

F.A.P. RTE. 0318	SECTION (72-7-3)CLV	COUNTY PEORIA	TOTAL SHEETS 9	SHEET NO. 8
CONTRACT NO. 68H83				
ILLINOIS FED. AID PROJECT				

MODEL: D:\hsh\...
 FILE NAME: ...
 ...

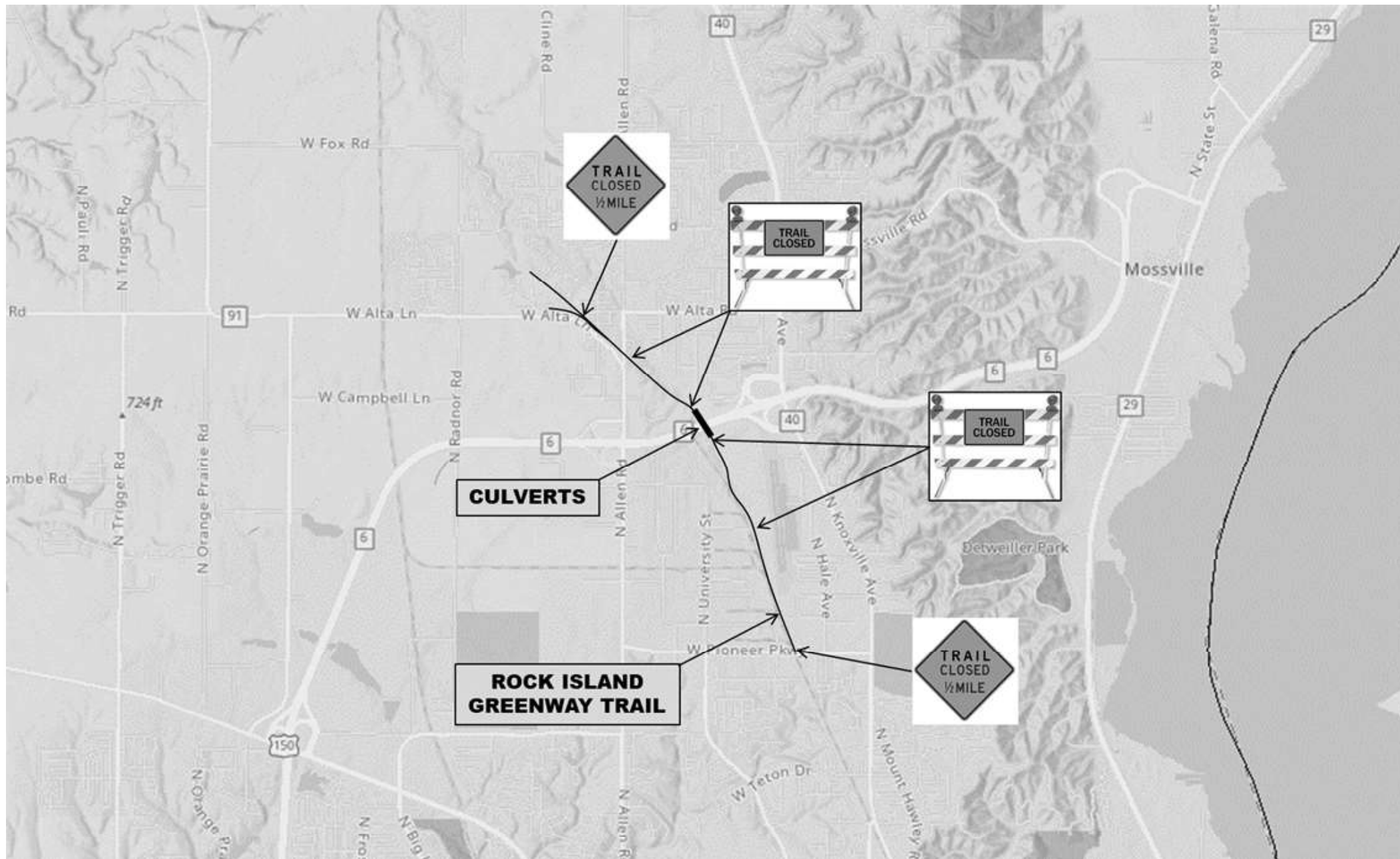

30" X 30"



24" X 18"

TRAIL CLOSED SIGN SHALL BE MOUNTED ON A SINGLE TYPE III BARRICADE, 8' WIDTH, AT EACH CLOSURE LOCATION



USER NAME = brennas	DESIGNED - BKR	REVISED -
	DRAWN - BKR	REVISED -
PLOT SCALE = 2,000' / in.	CHECKED - CEM	REVISED -
PLOT DATE = 1/24/2024	DATE = 2023/11/01	REVISED -

**STATE OF ILLINOIS
 DEPARTMENT OF TRANSPORTATION**

**TRAIL SIGNING
 SN 072-2012 IL 6 DOUBLE CMP**

SCALE: SHEET 1 OF 1 SHEETS STA. TO STA.

F.A.P. RTE.	SECTION	COUNTY	TOTAL SHEETS	SHEET NO.
0318	(72-7-3)CLV	PEORIA	9	9
ILLINOIS FED. AID PROJECT			CONTRACT NO. 68H83	