

STATE OF ILLINOIS
DEPARTMENT OF TRANSPORTATION

F.A.S. RTE.	SECTION	COUNTY	TOTAL SHEETS	SHEET NO.
1252	(22B-1)BRR	BUREAU	24	1
		ILLINOIS	CONTRACT NO. 66N53	

INDEX OF SHEETS

- 1 COVER SHEET
- 2 GENERAL NOTES
- 3-5 SUMMARY OF QUANTITIES
- 6 TYPICAL SECTIONS
- 7 SCHEDULE OF QUANTITIES
- 8 ROADWAY PLAN
- 9 WIDTH RESTRICTION SIGNING DETAILS
- 10 TEMPORARY INFORMATION SIGNING DETAIL
- 11-12 STAGING DETAILS
- 13 GENERAL PLAN AND ELEVATION
- 14 DECK & APPROACH PAVEMENT DETAILS
- 15 AS-BUILT DETAILS
- 16-17 REMOVAL DETAILS
- 18 CONSTRUCTION DETAILS - DECK
- 19 CONSTRUCTION DETAILS - ABUTMENTS
- 20 PREFORMED JOINT STRIP SEAL
- 21 BAR SPLICER ASSEMBLY AND MECHANICAL SPLICER DETAILS
- 22 RIPRAP DETAIL
- 23-24 EXISTING STRUCTURE PLANS (FOR INFORMATION ONLY)

STANDARDS

- 000001-08 STANDARD SYMBOLS, ABBREVIATIONS AND PATTERNS
- 001001-02 AREAS OF REINFORCEMENT BARS
- 001006 DECIMAL OF AN INCH AND OF A FOOT
- 482006-03 HMA SHOULDER ADJACENT TO RIGID PAVEMENT
- 630001-13 STEEL PLATE BEAM GUARDRAIL
- 631031-18 TRAFFIC BARRIER TERMINAL, TYPE 6
- 701001-02 OFF-ROAD OPERATIONS, 2L, 2W, MORE THAN 15' AWAY
- 701006-05 OFF-ROAD OPERATIONS, 2L, 2W, 15' TO 24" FROM PAVEMENT EDGE
- 701201-05 LANE CLOSURE, 2L, 2W, DAY ONLY, FOR SPEEDS ≥ 45 MPH
- 701301-04 LANE CLOSURE, 2L, 2W, SHORT TIME OPERATIONS
- 701306-04 LANE CLOSURE, 2L, 2W, SLOW MOVING OPERATIONS DAY ONLY FOR SPEEDS ≥ 45 MPH
- 701311-03 LANE CLOSURE, 2L, 2W, MOVING OPERATIONS - DAY ONLY
- 701321-18 LANE CLOSURE, 2L, 2W, BRIDGE REPAIR, WITH BARRIER
- 701326-04 LANE CLOSURE, 2L, 2W, PAVEMENT WIDENING, FOR SPEEDS ≥ 45 MPH
- 701901-09 TRAFFIC CONTROL DEVICES
- 704001-08 TEMPORARY CONCRETE BARRIER
- 782006-01 GUARDRAIL AND BARRIER WALL REFLECTOR MOUNTING DETAILS

**PROPOSED
HIGHWAY PLANS**

**FAS ROUTE 1252 (IL 26/29)
SECTION (22B-1)BRR
BRIDGE REPAIR
BUREAU COUNTY**

C-93-089-23

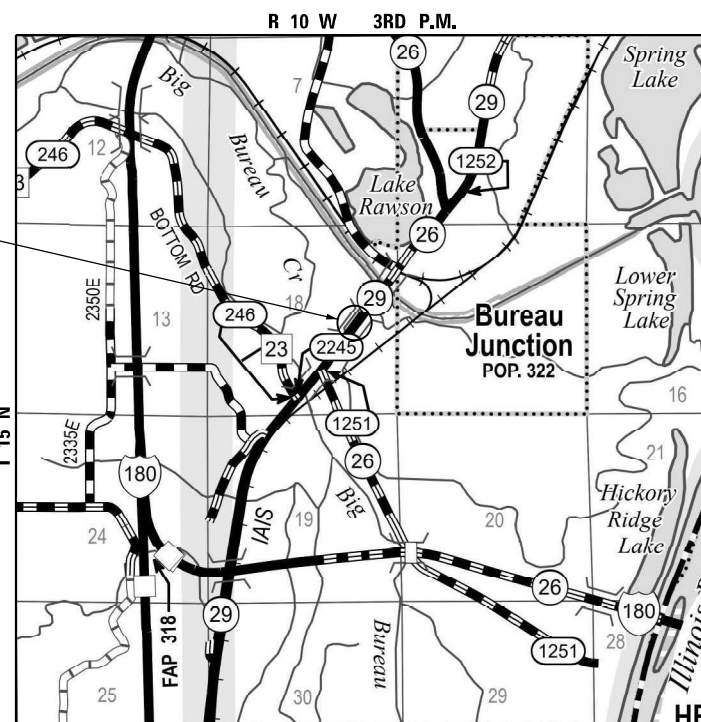
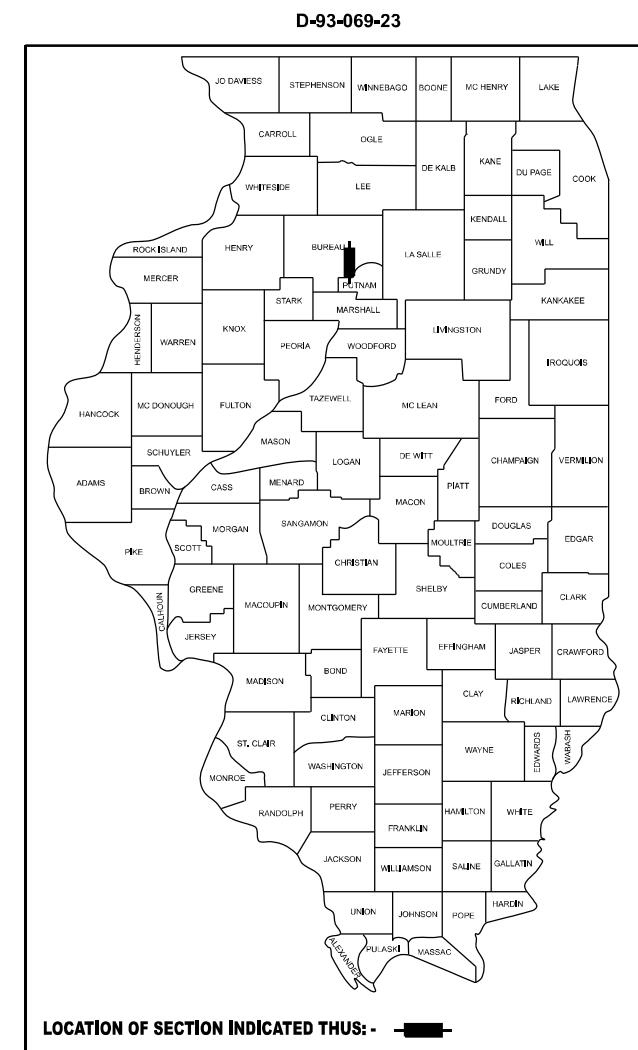

PROJECT LOCATION
STR. NO. 006-0083
(STA. 435 + 96.01)
CARRYING FAS 1252 (IL 26/29)
OVER BUREAU CREEK OVERFLOW
0.3 MI. NORTHEAST OF THE
IL 26 & IL 29 JUNCTION

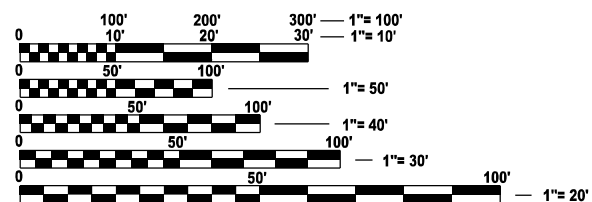

FULL SIZE PLANS HAVE BEEN PREPARED USING STANDARD ENGINEERING SCALES. REDUCED SIZED PLANS WILL NOT CONFORM TO STANDARD SCALES. IN MAKING MEASUREMENTS ON REDUCED PLANS, THE ABOVE SCALES MAY BE USED.

J.U.L.I.E.
JOINT UTILITY LOCATION INFORMATION FOR EXCAVATION
1-800-892-0123
OR 811

PROJECT ENGINEER: YOGESH J. PATEL, P.E.
PROJECT MANAGER: RON WOODSHANK
DISTRICT 3 NO. (815) 434-6131
CONTRACT NO. 66N53

GROSS LENGTH = 366.33 FT. = 0.069 MILE
NET LENGTH = 366.33 FT. = 0.069 MILE



Kevin L. Kuhn

DATE: FEBRUARY 8 20 24
EXPIRES: NOVEMBER 30 20 25



KUHN & TRELLO
CONSULTING ENGINEERS
A Limited Liability Company
100 N. 7th Street, 2nd Floor
Springfield, IL 62701
Phone: 317-623-9000
Professional Design Firm No. 184-00536

FUNCTIONAL CLASSIFICATION

MAJOR COLLECTOR
FAS ROUTE 1252 (IL 26/29)
2021 ADT = 1250
P.V. = 91.2% S.U. = 0.0% M.U. = 8.8%

STATE OF ILLINOIS
DEPARTMENT OF TRANSPORTATION

SUBMITTED February 9, 20 24
Stephen M. Harris REGIONAL ENGINEER

March 22, 2024
Scott A. Etk ENGINEER OF DESIGN AND ENVIRONMENT

March 22, 2024
Stephen M. Harris DIRECTOR OF HIGHWAYS PROJECT IMPLEMENTATION

**PRINTED BY THE AUTHORITY
OF THE STATE OF ILLINOIS**

GENERAL NOTES

THE ENGINEER WILL BE THE SOLE JUDGE CONCERNING CURING TIME FOR THE VARIOUS HMA LIFTS.

ALL EXCAVATED MATERIAL, WHICH INCLUDES DIGGING OR GRADING OF ANY SOIL OR FILL MATERIAL, WITH THE EXCEPTION OF AGGREGATE FILLS, MUST BE INCORPORATED WITHIN THE IDOT RIGHT OF WAY.

THE FOLLOWING RATES OF APPLICATION HAVE BEEN USED IN CALCULATING PLAN QUANTITIES:

GRANULAR MATERIALS	2.05	TONS / CU YD
HMA RESURFACING	112	LBS / SQ YD / IN

COMMITMENTS

THE ENGINEER SHALL RECORD THE DECK SLAB REPAIR LOCATIONS, PATCH SIZE AND QUANTITIES ON THE DECK SLAB REPAIR "AS-BUILT" PLAN DETAILS. WHEN RECORDED, THE ENGINEER SHALL FORWARD THE DECK SLAB REPAIR "AS-BUILT" PLAN DETAILS TO THE BRIDGE OFFICE IN A TIMELY MANNER. BRIDGE OFFICE CONTACT PERSON IS ADRIAN HALLOWAY. PHONE (217) 524-8624. EMAIL: Adrian.Halloway@illinois.gov
 THE ENGINEER SHALL NOTIFY THE DEPARTMENT'S DESIGN AND PLANNING SECTION WHEN THE "AS-BUILT" DECK SLAB REPAIR PLAN HAS BEEN SENT TO THE BRIDGE OFFICE.
 CONTACT PERSON IS YOGESH PATEL. PHONE (815) 434-8418
 EMAIL: Yogesh.Patel@illinois.gov

HMA MIXTURE REQUIREMENT TABLE		
LOCATIONS:	HOT-MIX ASPHALT	
	SHOULDERS	
MIXTURE USE(S):	HMA BINDER BOTTOM LIFTS	HMA SURFACE TOP LIFT
BINDER GRADE (PG):	PG 64-22	PG 64-22
DESIGN AIR VOIDS:	4% @ N50	4% @ N50
MIXTURE COMPOSITION: (MIXTURE GRADATION):	IL 19.0	IL 9.5
FRICTION AGGREGATE:		MIXTURE C
MIXTURE WEIGHT:	112.0 LB/SY/IN	112.0 LB/SY/IN
QUALITY MANAGEMENT PROGRAM:	QC/QA	QC/QA
SUBLOT SIZE:	N/A	N/A
DENSITY TEST METHOD:	CORES / NUCLEAR	CORES / NUCLEAR

STATE OF ILLINOIS
 DEPARTMENT OF TRANSPORTATION
 DISTRICT 3
 AS-BUILT INFORMATION

SUPERVISING CONSTRUCTION FIELD ENGINEER

RESIDENT ENGINEER / TECHNICIAN

START & END DATES
 OF CONSTRUCTION: _____

INSPECTORS: _____

MODEL: SHT PLAN
 FILE NAME: I:\2022\22069.02 IDOT D3 - PTB_205-023 - W02 - Bureau County 66N53\CAD\Drawings\Sheet Borders\Sheet Borders\66N53_Sheet Borders.dgn



USER NAME = msulheard
 PLOT SCALE = 0.16666833"/in.
 PLOT DATE = 12/28/2023

DESIGNED -
 DRAWN -
 CHECKED -
 DATE -

REVISED -
 REVISED -
 REVISED -
 REVISED -

STATE OF ILLINOIS
 DEPARTMENT OF TRANSPORTATION

GENERAL NOTES

SCALE: SHEET 1 OF 1 SHEETS STA. TO STA.

F.A.S. RTE.	SECTION	COUNTY	TOTAL SHEETS	SHEET NO.
1252	(22B-1)BRR	BUREAU	24	2
CONTRACT NO. 66N53			ILLINOIS FED. AID PROJECT	

MODEL: SHT PLAN
 FILE NAME: I:\2022\22069.02\DOT D3 - PTB_205-023 - W02 - Bureau County 66N53\CAD\Sheet Borders\Sheet Borders\66N53_Sheet Borders.dgn

CODE NO.	ITEM	UNIT	TOTAL QUANTITY	CONSTR. CODE
				CONTRACT MAINTENANCE 100% STATE BRIDGE 0047 S.N. 006-0083
28100807	STONE DUMPED RIPRAP, CLASS A4	TON	1780	1780
28200200	FILTER FABRIC	SQ YD	1217	1217
40600290	BITUMINOUS MATERIALS (TACK COAT)	POUND	160	160
44004250	PAVED SHOULDER REMOVAL	SQ YD	350	350
48203033	HOT-MIX ASPHALT SHOULDERS, 9"	SQ YD	350	350
50102400	CONCRETE REMOVAL	CU YD	12.1	12.1
50104650	SLOPE WALL REMOVAL	SQ YD	985	985
50300255	CONCRETE SUPERSTRUCTURE	CU YD	12.1	12.1
50300300	PROTECTIVE COAT	SQ YD	30.1	30.1
50800205	REINFORCEMENT BARS, EPOXY COATED	POUND	1380	1380
50800515	BAR SPLICERS	EACH	24	24
52000110	PREFORMED JOINT STRIP SEAL	FOOT	76	76
59000200	EPOXY CRACK INJECTION	FOOT	62	62
67100100	MOBILIZATION	L SUM	1	1

KT KUHN & TRELLO
 CONSULTING ENGINEERS
 A Limited Liability Company
 109 N. 7th Street, 3rd Floor
 Springfield, IL 62761
 Phone: 217-681-0014
 Professional Design Firm No. 184-006516

USER NAME = msulheard
 PLOT SCALE = 0.16666833"/in.
 PLOT DATE = 12/28/2023

DESIGNED -
 DRAWN -
 CHECKED -
 DATE -

REVISED -
 REVISED -
 REVISED -
 REVISED -

**STATE OF ILLINOIS
 DEPARTMENT OF TRANSPORTATION**

SUMMARY OF QUANTITIES

SCALE: SHEET 1 OF 3 SHEETS STA. TO STA.

F.A.S. RTE. 1252	SECTION (22B-1)BRR	COUNTY BUREAU	TOTAL SHEETS 24	SHEET NO. 3
CONTRACT NO. 66N53			ILLINOIS FED. AID PROJECT	

MODEL: SHT PLAN
 FILE NAME: I:\2022\22069.02 IDOT D3 - PTB 205-023 - W02 - Bureau County 66N53\CADData\CADsheets\Sheet Borders\66N53_Sheet Borders.dgn

CODE NO.	ITEM	UNIT	TOTAL QUANTITY	CONSTR. CODE
				CONTRACT MAINTENANCE 100% STATE BRIDGE 0047 S.N. 006-0083
70100405	TRAFFIC CONTROL AND PROTECTION, STANDARD 701321	EACH	1	1
70100450	TRAFFIC CONTROL AND PROTECTION, STANDARD 701201	L SUM	1	1
70100500	TRAFFIC CONTROL AND PROTECTION, STANDARD 701326	L SUM	1	1
70106500	TEMPORARY BRIDGE TRAFFIC SIGNALS	EACH	1	1
70400100	TEMPORARY CONCRETE BARRIER	FOOT	475	475
70400200	RELOCATE TEMPORARY CONCRETE BARRIER	FOOT	475	475
70600251	IMPACT ATTENUATORS, TEMPORARY (NON- REDIRECTIVE, NARROW), TEST LEVEL 3	EACH	2	2
70600352	IMPACT ATTENUATORS, RELOCATE (NON- REDIRECTIVE, NARROW), TEST LEVEL 3	EACH	2	2
* 78009004	MODIFIED URETHANE PAVEMENT MARKING - LINE 4"	FOOT	6618	6618
* 78009006	MODIFIED URETHANE PAVEMENT MARKING - LINE 6"	FOOT	440	440
* 78009012	MODIFIED URETHANE PAVEMENT MARKING - LINE 12"	FOOT	70	70
78300202	PAVEMENT MARKING REMOVAL - WATER BLASTING	SQ FT	1251	1251
X2700001	TEMPORARY RUMBLE STRIPS (SPECIAL)	EACH	5	5
X7200201	WIDTH RESTRICTION SIGNING	L SUM	1	1

* SPECIALTY ITEM



USER NAME = msulheard
 PLOT SCALE = 0.16666833"/in.
 PLOT DATE = 12/28/2023

DESIGNED -
 DRAWN -
 CHECKED -
 DATE -

REVISED -
 REVISED -
 REVISED -
 REVISED -

**STATE OF ILLINOIS
 DEPARTMENT OF TRANSPORTATION**

SUMMARY OF QUANTITIES

SCALE: SHEET 2 OF 3 SHEETS STA. TO STA.

F.A.S. RTE.	SECTION	COUNTY	TOTAL SHEETS	SHEET NO.
1252	(22B-1)BRR	BUREAU	24	4
ILLINOIS FED. AID PROJECT			CONTRACT NO. 66N53	

CONSTR. CODE
CONTRACT MAINTENANCE
100% STATE
BRIDGE
0047
S.N. 006-0083

CODE NO.	ITEM	UNIT	TOTAL QUANTITY	
Z0001800	APPROACH SLAB REPAIR (PARTIAL DEPTH)	SQ YD	23	23
Z0016001	DECK SLAB REPAIR (FULL DEPTH, TYPE I)	SQ YD	1.0	1.0
Z0016002	DECK SLAB REPAIR (FULL DEPTH, TYPE II)	SQ YD	5.0	5.0
Z0016200	DECK SLAB REPAIR (PARTIAL)	SQ YD	8.7	8.7
Z0030850	TEMPORARY INFORMATION SIGNING	SQ FT	42	42
* Z0054515	ROCK FILL - EMBANKMENT	TON	20	20

*= SPECIALTY ITEM

MODEL: SHT PLAN
FILE NAME: I:\2022\22069.02 IDOT D3 - PTB 205-023 - W02 - Bureau County 66N53\CADData\CADsheets\Sheet Borders\66N53_Sheet Borders.dgn



USER NAME = msulheard	DESIGNED -	REVISED -
PLOT SCALE = 0.16666833"/in.	DRAWN -	REVISED -
PLOT DATE = 12/28/2023	CHECKED -	REVISED -
	DATE -	REVISED -

**STATE OF ILLINOIS
DEPARTMENT OF TRANSPORTATION**

SUMMARY OF QUANTITIES			
SCALE:	SHEET 3	OF 3 SHEETS	STA. TO STA.

F.A.S. RTE.	SECTION	COUNTY	TOTAL SHEETS	SHEET NO.
1252	(22B-1)BRR	BUREAU	24	5
ILLINOIS FED. AID PROJECT			CONTRACT NO. 66N53	

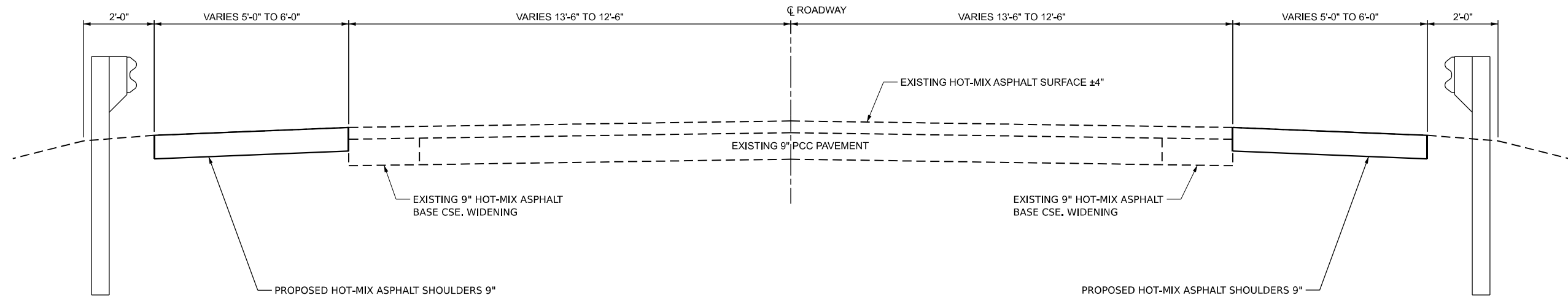

TYPICAL SECTION

SEE SCHEDULES

MODEL: SHT PLAN
 FILE NAME: I:\2022\22069.02\DOT D3 - PTB_205-023 - W02 - Bureau County 66N53\CAD\data\CAD\sheet\Sheet Borders\66N53_Sheet Borders.dgn



USER NAME = msulheard	DESIGNED -	REVISED -
PLOT SCALE = 0.16666833' / in.	DRAWN -	REVISED -
PLOT DATE = 12/28/2023	CHECKED -	REVISED -
	DATE -	REVISED -

**STATE OF ILLINOIS
 DEPARTMENT OF TRANSPORTATION**

TYPICAL SECTION			
SCALE:	SHEET 1	OF 1 SHEETS	STA. TO STA.

F.A.S. RTE. 1252	SECTION (22B-1)BRR	COUNTY BUREAU	TOTAL SHEETS 24	SHEET NO. 6
CONTRACT NO. 66N53				
ILLINOIS FED. AID PROJECT				

SHOULDER SCHEDULE							
LOCATION		LENGTH	SHLDR WIDTH	AREA	BITUMINOUS MATERIALS (TACK COAT)	PAVED SHOULDER REMOVAL	HOT-MIX ASPHALT SHOULDERS, 9"
STATION TO STATION		FT	FT	SQ FT	POUND	SQ YD	SQ YD
432+78	434+08 RT	130	5	650	32	72	72
432+85	434+15 LT	130	6	780	40	87	87
437+77	439+33 RT	156	6	936	48	104	104
437+84	439+14 LT	130	6	780	40	87	87
TOTAL					160	350	350

NOTE: BITUMINOUS MATERIALS (TACK COAT) QUANTITY IS 2 APPLICATIONS @ 0.025 POUNDS/SQ FT

SLOPE WALL / RIPRAP SCHEDULE				
LOCATION	STONE RIPRAP, CLASS A4	FILTER FABRIC	SLOPE WALL REMOVAL	ROCK FILL - EMBANKMENT
	TON	SQ YD	SQ YD	TON
SOUTH ABUTMENT	448	493	493	10
SOUTH ABUTMENT TOE	278	116		
PIER 1	111			
PIER2	107			
PIER 3	111			
NORTH ABUTMENT	447	492	492	10
NORTH ABUTMENT TOE	278	116		
TOTAL	1,780	1,217	985	20

PAVEMENT MARKING SCHEDULE									
LOCATION		COMMENT	APPLICATIONS	LENGTH	MODIFIED URETHANE PAVEMENT MARKING - LINE 4"		MODIFIED URETHANE PAVEMENT MARKING - LINE 6"	MODIFIED URETHANE PAVEMENT MARKING - LINE 12"	PAVEMENT MARKING REMOVAL WATER BLASTING
STATION	TO STATION			FOOT	WHITE FOOT	YELLOW FOOT	YELLOW FOOT	YELLOW FOOT	SQ FT
430+40	440+70	LEFT EDGE LINE	2	1030	2060				343
430+40	440+70	RIGHT EDGE LINE	2	1030	2060				343
432+30	440+70	SKIP DASHES	2	840			440		110
430+40	437+19	NPZ WB	2	679		1358			227
430+40	432+30	NPZ WB TAPER	2	190		380			64
430+40	432+30	NPZ EB	2	190		380			64
430+40	432+30	NPZ EB TAPER	2	190		380			64
430+40	431+70	DIAGONALS	2	35				70	35
SUB TOTAL					4120	2498			
TOTAL					6618		440	70	1251

MODEL: SHT PLAN
FILE NAME: I:\2022\22069.02\DOT D3 - PTB_205-023 - W02 - Bureau County 66N53\CADData\CADsheets\Sheet Borders\66N53_Sheet Borders.dgn



USER NAME = msulheard
DESIGNED -
DRAWN -
CHECKED -
DATE -
PLOT SCALE = 0.16666833"/in.
PLOT DATE = 12/28/2023

REVISOR -
REVISIONS -
REVISOR -
REVISIONS -

STATE OF ILLINOIS
DEPARTMENT OF TRANSPORTATION

SCHEDULE OF QUANTITIES

SCALE: SHEET OF SHEETS STA. TO STA.

F.A.S. RTE.	SECTION	COUNTY	TOTAL SHEETS	SHEET NO.
1252	(22B-1)BRR	BUREAU	24	7
CONTRACT NO. 66N53				
ILLINOIS FED. AID PROJECT				

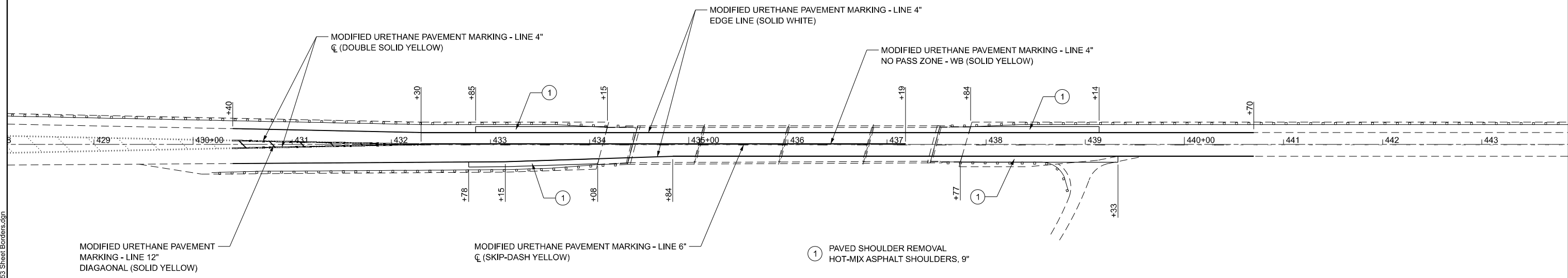
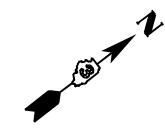

MODEL: SHT PLAN
 FILE NAME: I:\2022\22069.02\DOT D3 - PTB_205-023 - W02 - Bureau County 66N53\CAD\data\CAD\sheet\Sheet Borders\66N53_Sheet Borders.dgn

KT
KUHN & TRELLO
 CONSULTING ENGINEERS
 A Limited Liability Company
 109 N. 7th Street, 3rd Floor
 Springfield, IL 62761
 Phone: 217-681-0014
 Professional Design Firm No. 184-006516

USER NAME = msulheard	DESIGNED -	REVISED -
DRAWN -	REVISED -	
PLOT SCALE = 0.16666833' / in.	CHECKED -	REVISED -
PLOT DATE = 12/28/2023	DATE -	REVISED -

STATE OF ILLINOIS
DEPARTMENT OF TRANSPORTATION

ROADWAY PLAN			
SCALE: 1" = 100'	SHEET 1	OF 1 SHEETS	STA. TO STA.

F.A.S. RTE. 1252	SECTION (22B-1)BRR	COUNTY	TOTAL SHEETS 24	SHEET NO. 8
CONTRACT NO. 66N53			ILLINOIS FED. AID PROJECT	

MODEL: SHT PLAN
 FILE NAME: I:\2022\22069.02\DOT D3 - PTB_205-023 - W02 - Bureau County 66N53\CAD\data\CAD\sheet\Sheet Borders\66N53_Sheet Borders.dgn

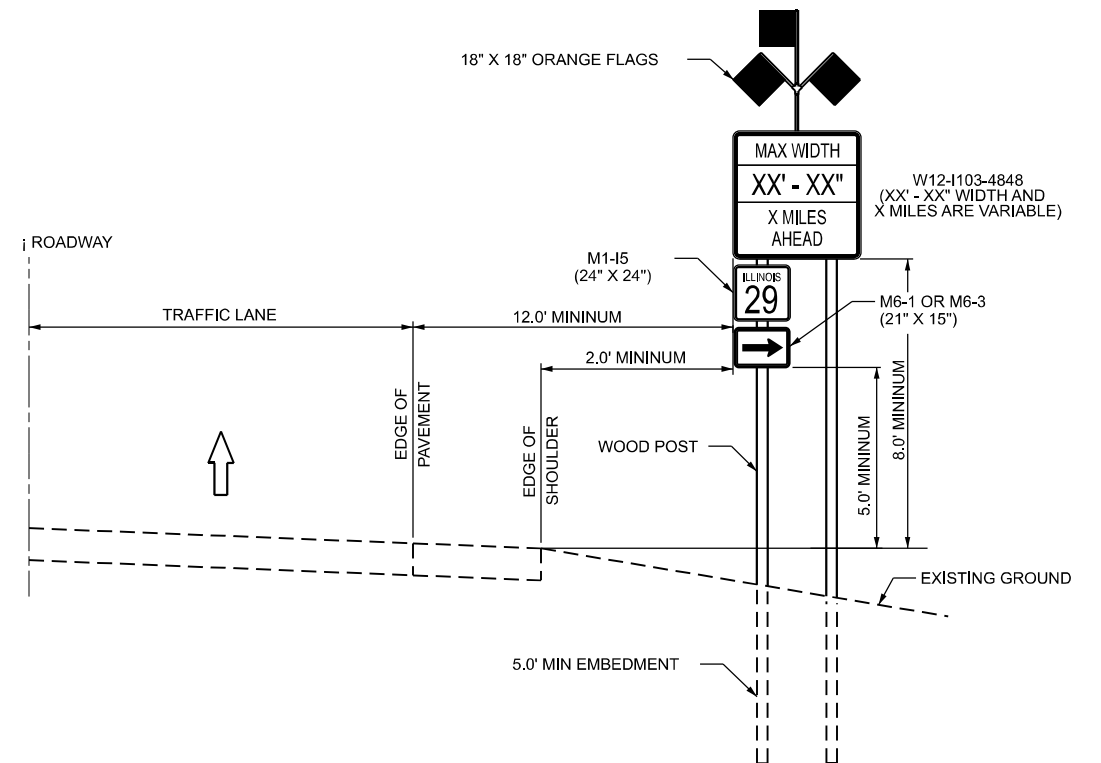
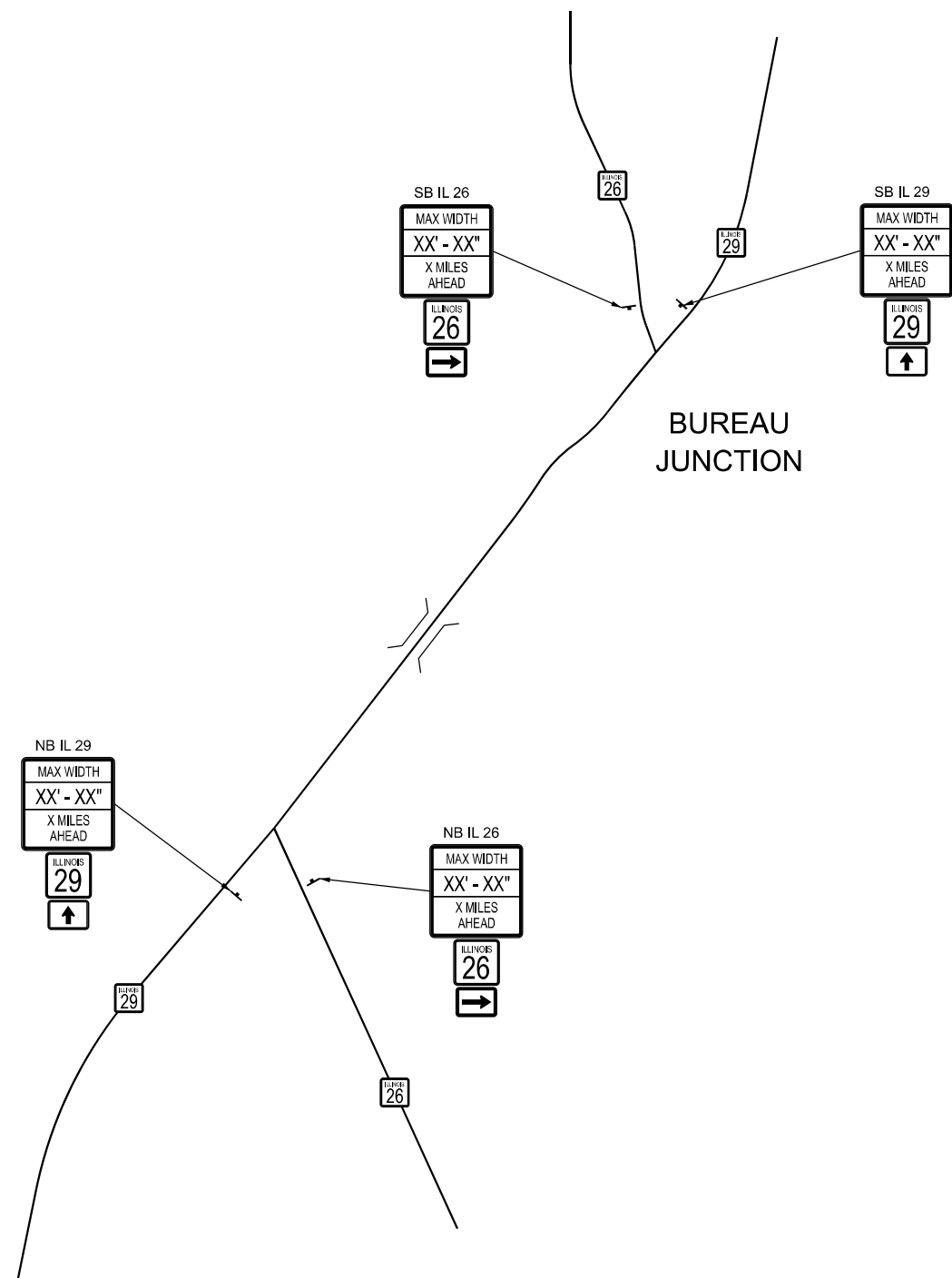

**WIDTH RESTRICTION SIGN
 CONVENTIONAL ROADWAYS**

USE THIS DETAIL IN CONJUNCTION WITH SPECIAL PROVISION

KT KUHN & TRELLO
 CONSULTING ENGINEERS
 A Limited Liability Company
 109 N. 7th Street, 3rd Floor
 Springfield, IL 62761
 Phone: 217-678-0044
 Professional Design Firm No. 284-006516

USER NAME = msulheard	DESIGNED -	REVISED -
DRAWN -	REVISED -	
PLOT SCALE = 0.16666833"/in.	CHECKED -	REVISED -
PLOT DATE = 12/28/2023	DATE -	REVISED -

**STATE OF ILLINOIS
 DEPARTMENT OF TRANSPORTATION**

WIDTH RESTRICTION SIGNING DETAIL			
SCALE:	SHEET 1	OF 1 SHEETS	STA. TO STA.

F.A.S. RTE.	SECTION	COUNTY	TOTAL SHEETS	SHEET NO.
1252	(22B-1)BRR	BUREAU	24	9
CONTRACT NO. 66N53				
ILLINOIS FED. AID PROJECT				

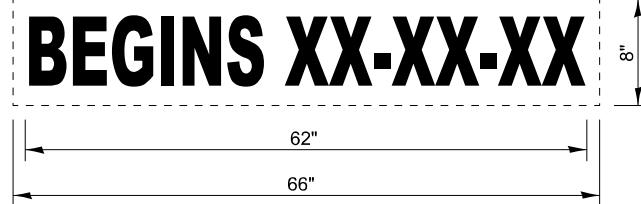
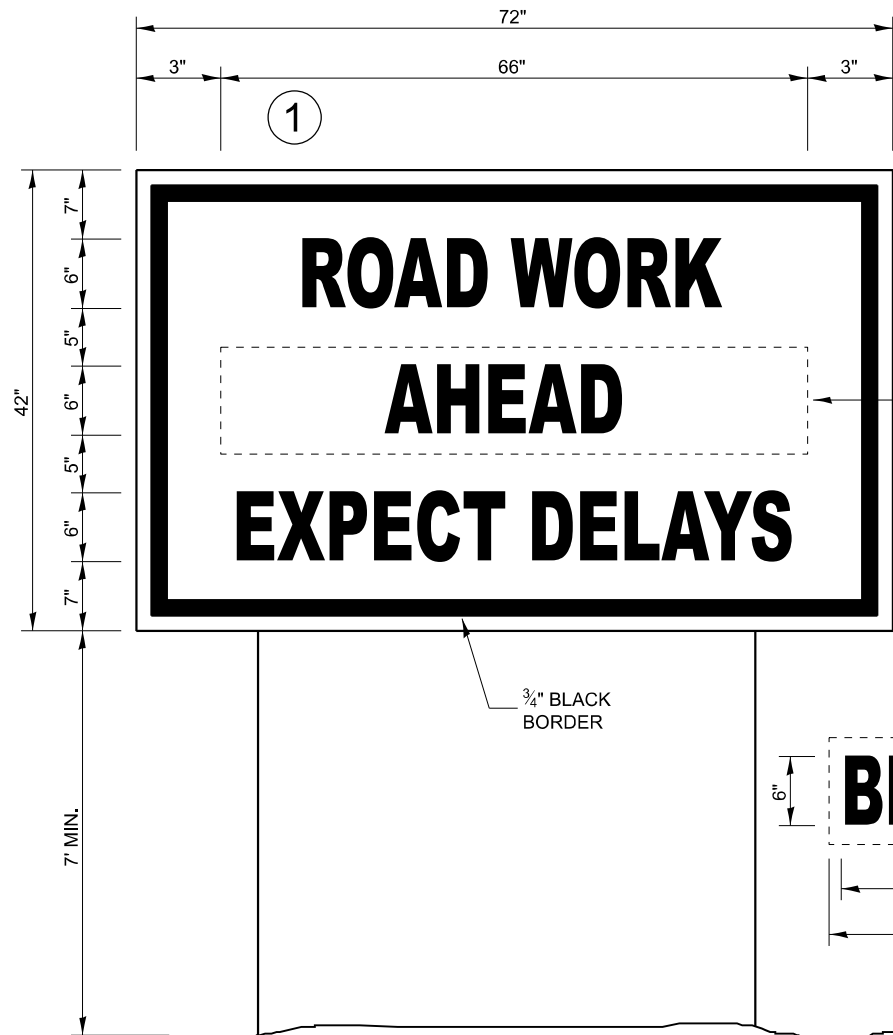

TEMPORARY INFORMATION SIGNING

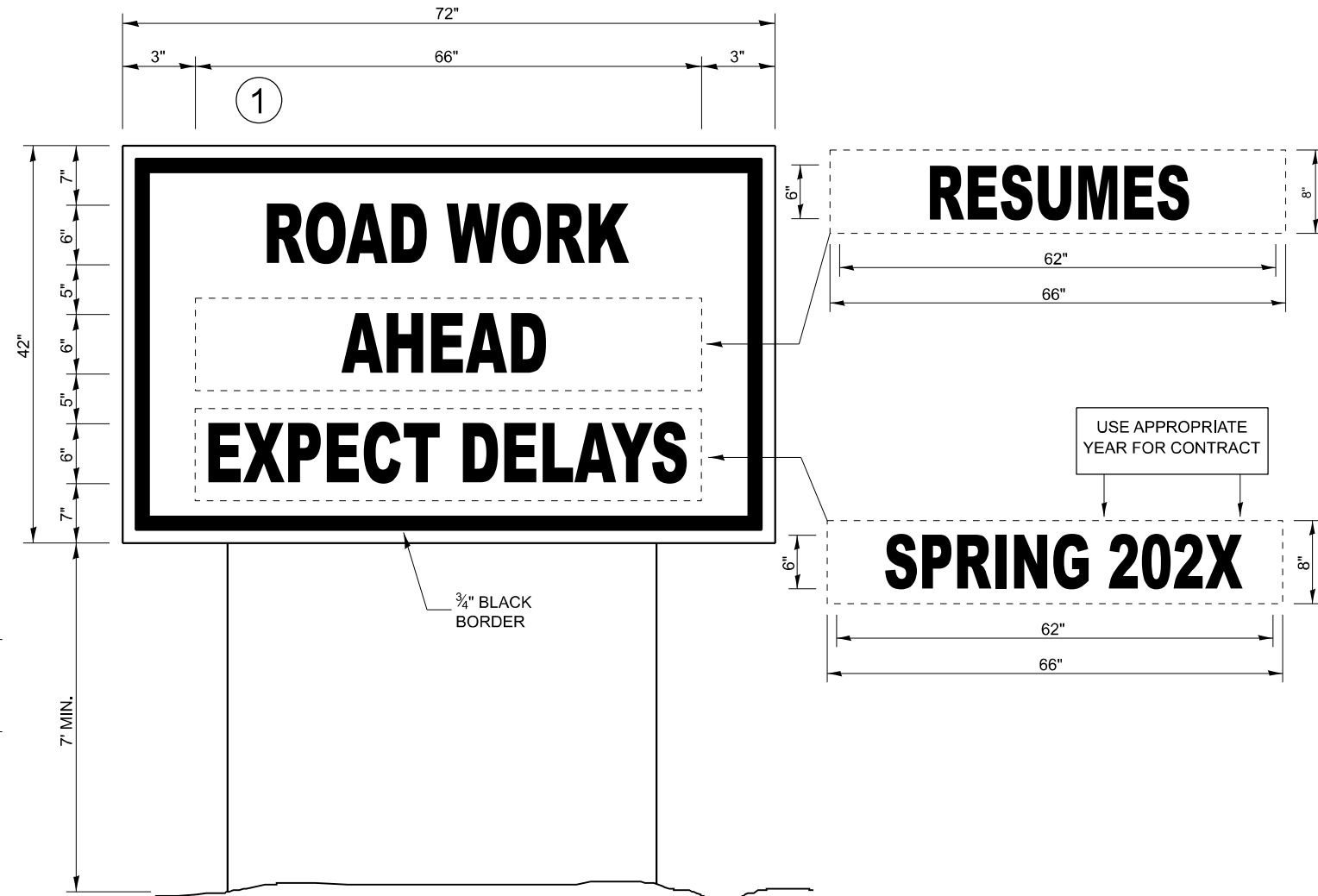

WINTER SHUT DOWN SIGNING

NOTES:

1. USE 6" D BLACK LETTERING ON FLOURESENT ORANGE BACKGROUND.
2. ERECT SIGNS AT LOCATIONS IN ADVANCE OF THE "ROAD CONSTRUCTION AHEAD" SIGNS AS DIRECTED BY THE ENGINEER.
3. ERECT SIGN ① WITH INSTALLED PANEL ② A MINIMUM OF ONE WEEK PRIOR TO THE START OF THE LANE CLOSURE.
4. REMOVE PANEL ② ON THAT DATE.
5. SEE SPECIAL PROVISION "TEMPORARY INFORMATION SIGNING" FOR ADDITIONAL INFORMATION.
6. WILL BE PAID FOR PER SQ FT AS "TEMPORARY INFORMATION SIGNING". EACH SIGN = 21 SQ FT AND THE DATE PANEL ② WILL NOT BE MEASURED SEPARATELY FOR PAYMENT.

MODEL: SHT PLAN
FILE NAME: I:\2022\22069.02\DOT D3 - PTB_205-023 - W02 - Bureau County 66N53\CAD\Sheet Borders\Sheet Borders\66N53_Sheet Borders.dgn



USER NAME = msulheard	DESIGNED -	REVISED -
PLOT SCALE = 0.16666833"/in.	DRAWN -	REVISED -
PLOT DATE = 12/28/2023	CHECKED -	REVISED -
	DATE -	REVISED -

**STATE OF ILLINOIS
DEPARTMENT OF TRANSPORTATION**

TEMPORARY INFORMATION SIGNING DETAIL

SCALE: SHEET 1 OF 1 SHEETS STA. TO STA.

F.A.S. RTE.	SECTION	COUNTY	TOTAL SHEETS	SHEET NO.
1252	(22B-1)BRR	BUREAU	24	10
CONTRACT NO. 66N53				
ILLINOIS FED. AID PROJECT				

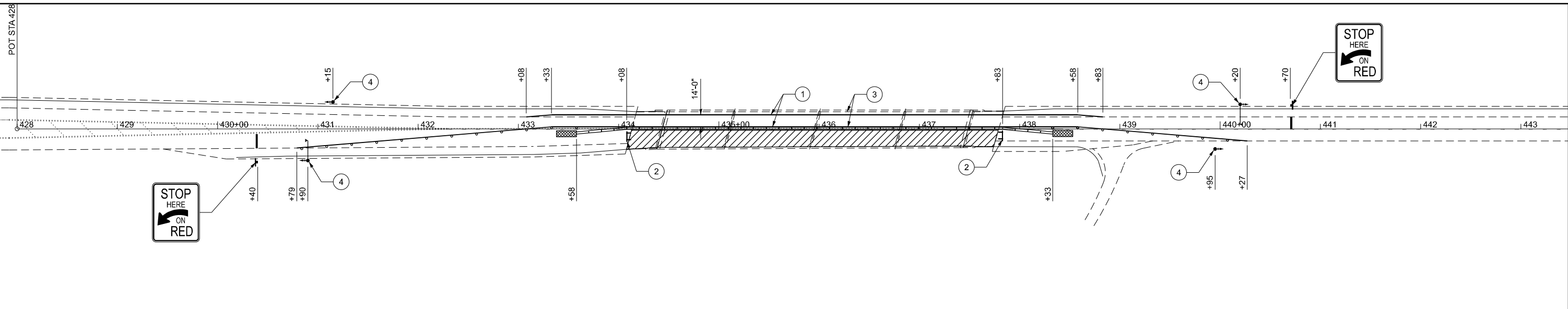

- ① TEMPORARY PAVEMENT MARKING - LINE 4" (WHITE)
- ② TYPE III BARRICADE TO BE PLACED WHEN NO WORK IS BEING PERFORMED
- ③ GUARDRAIL/BARRIER WALL REFLECTORS AT 25' CTS. SEE STANDARDS 704001 AND 782006.
- ④ THE EDGE OF THE POST MOUNTED SIGNAL HEAD SHALL BE BETWEEN 24" AND 6" FROM EDGE OF SHOULDER
- ⑤ PAVEMENT MARKING REMOVAL

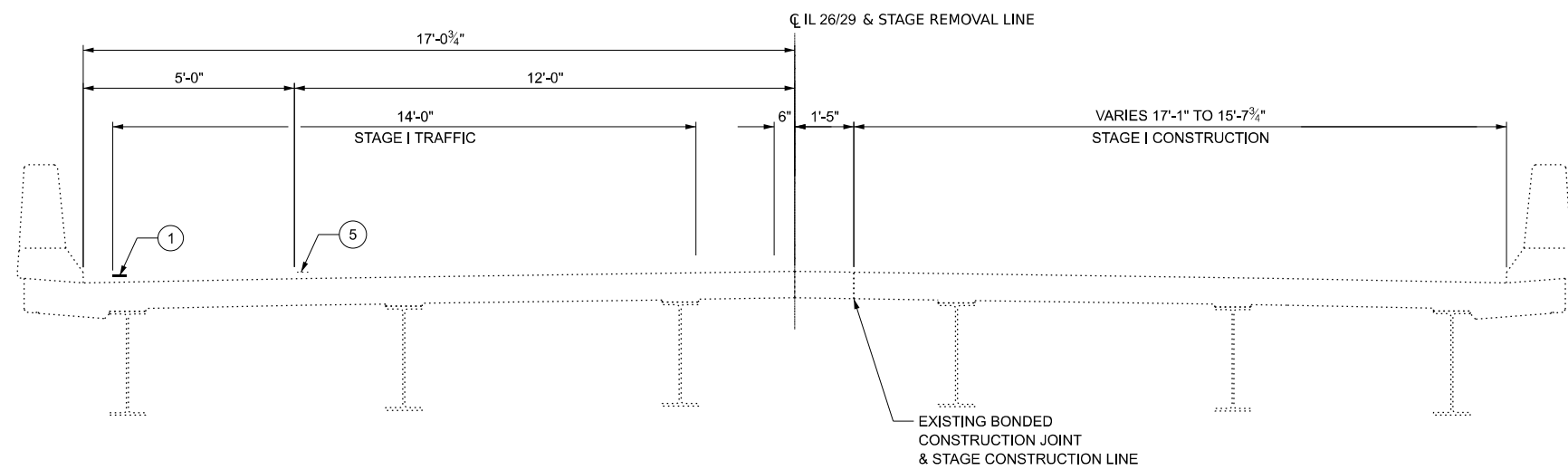

**STAGING DETAIL
STAGE I
LOOKING NORTH**

GENERAL NOTES

THIS DETAIL SHALL BE USED IN CONJUNCTION WITH TRAFFIC CONTROL AND PROTECTION, STANDARD 701321.

THIS STANDARD IS USED WHERE, AT ANY TIME, ANY VEHICLE, EQUIPMENT, WORKERS, OR THEIR ACTIVITIES WILL ENCROACH ON ONE LANE OF A BRIDGE. TRAFFIC SIGNALS AND A POSITIVE BARRIER ARE REQUIRED.

TRAFFIC SIGNALS SHALL BE OPERATIONAL ONLY WHEN ALL TRAFFIC CONTROLS ARE IN PLACE. WHEN TRAFFIC SIGNALS ARE NOT IN OPERATION, FLAGGERS SHALL BE USED AND TRAFFIC CONTROL SHALL CONFORM TO STANDARD 701201 OR 701206.

TEMPORARY CONCRETE BARRIER SHALL BE ACCORDING TO STANDARD 704001.

EXISTING OR TEMPORARY PAVEMENT MARKINGS SHALL BE ON BOTH SIDES OF OPEN LANE FROM STOP BAR TO STOP BAR.

ALL DIMENSIONS ARE IN INCHES (MILLIMETERS) UNLESS OTHERWISE SHOWN.

TEMPORARY PAVEMENT MARKING AS SHOWN ON THIS DETAIL, SHALL NOT BE PAID FOR SEPARATELY BUT SHALL BE INCLUDED IN THE COST OF THE STANDARD.

LEGEND

- WORK ZONE
- BARRICADES, TYPE III WITH STEADY BURNING LIGHT
- SIGN
- IMPACT ATTENUATOR (NON-REDIRECTIVE, NARROW) TEST LEVEL 3
- TEMPORARY CONCRETE BARRIER
- TEMPORARY BRIDGE TRAFFIC SIGNAL WITH BACKPLATE AND MICROWAVE DETECTOR (INSTALLED FOR STATE I)
- TEMPORARY BRIDGE TRAFFIC SIGNAL WITH BACKPLATE (INSTALLED FOR STATE I)

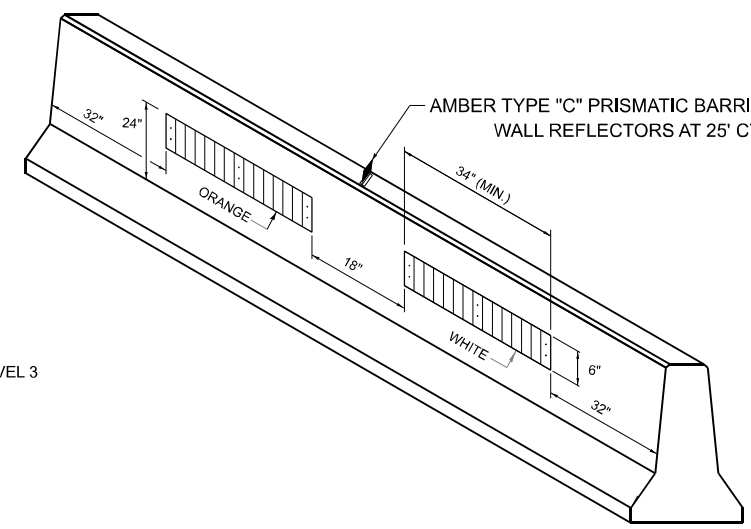

**LINEAR DELINEATOR PANELS
FOR TEMPORARY CONCRETE BARRIER**

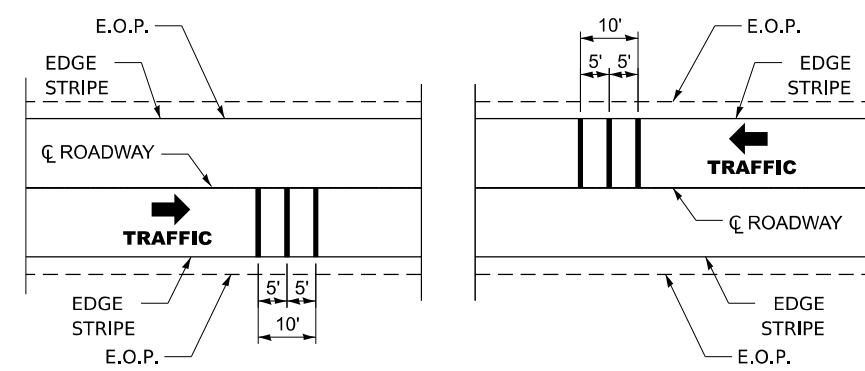

**TEMPORARY RUMBLE STRIPS (SPECIAL)
FOR PAYMENT PURPOSES, EACH LANE SHALL BE CONSIDERED "ONE EACH"**

MODEL: SHT PLAN
FILE NAME: I:\2022\22069.02\DOT D3 - PTB_205-023 - W02 - Bureau County 66N53\CAD\CAD\Sheet Borders\Sheet Borders\66N53_Sheet Borders.dgn



USER NAME = msulheard	DESIGNED -	REVISED -
PLOT SCALE = 0.16666833"/in.	DRAWN -	REVISED -
PLOT DATE = 12/28/2023	CHECKED -	REVISED -
	DATE -	REVISED -

STATE OF ILLINOIS
DEPARTMENT OF TRANSPORTATION

TRAFFIC CONTROL AND PROTECTION FOR
STAGE I CONSTRUCTION

SCALE: SHEET 1 OF 2 SHEETS STA. TO STA.

F.A.S. RTE. 1252	SECTION (22B-1)BRR	COUNTY BUREAU	TOTAL SHEETS 24	SHEET NO. 11
CONTRACT NO. 66N53			ILLINOIS FED. AID PROJECT	

MODEL: SHT PLAN
 FILE NAME: I:\2022\22069.02\DOT D3 - PTB 205-023 - W02 - Bureau County 66N53\CAD\CAD\Sheet Borders\Sheet Borders\66N53 Sheet Borders.dgn

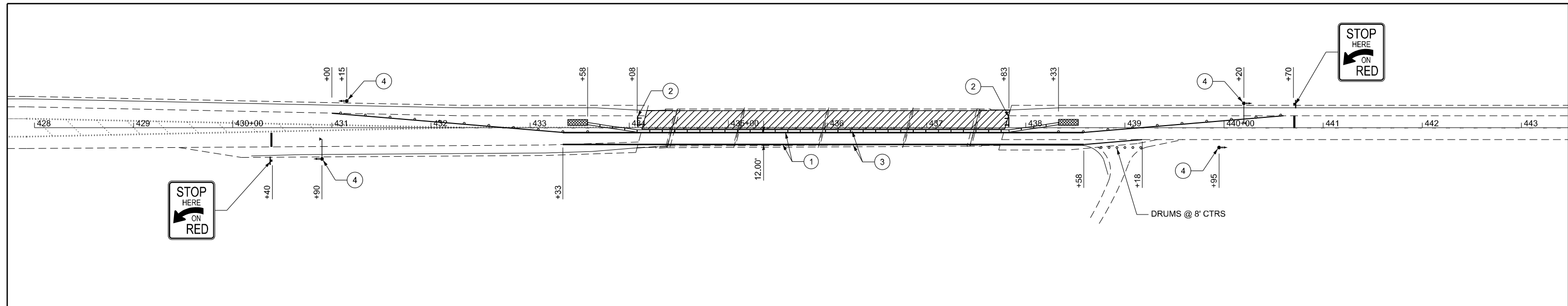

- ① TEMPORARY PAVEMENT MARKING - LINE 4" (WHITE)
- ② TYPE III BARRICADE TO BE PLACED WHEN NO WORK IS BEING PERFORMED
- ③ GUARDRAIL/BARRIER WALL REFLECTORS AT 25' CTS. SEE STANDARDS 704001 AND 782006.
- ④ THE EDGE OF THE POST MOUNTED SIGNAL HEAD SHALL BE BETWEEN 24" AND 6" FROM EDGE OF SHOULDER
- ⑤ PAVEMENT MARKING REMOVAL

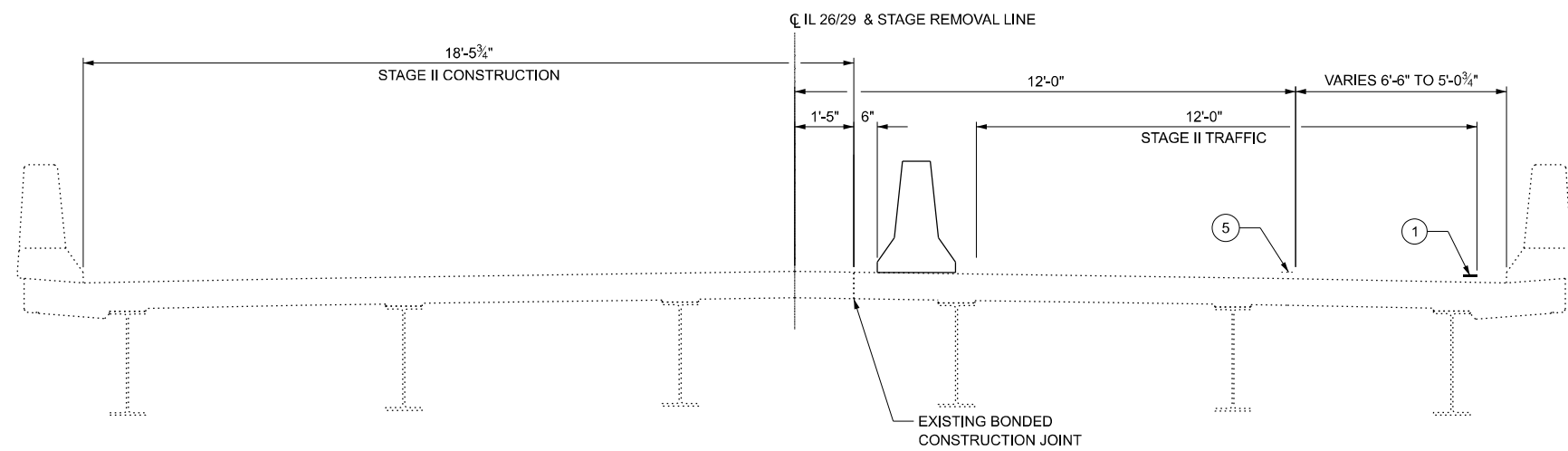

STAGING DETAIL
STAGE II
LOOKING NORTH

GENERAL NOTES

THIS DETAIL SHALL BE USED IN CONJUNCTION WITH TRAFFIC CONTROL AND PROTECTION, STANDARD 701321.

THIS STANDARD IS USED WHERE, AT ANY TIME, ANY VEHICLE, EQUIPMENT, WORKERS, OR THEIR ACTIVITIES WILL ENCOACH ON ONE LANE OF A BRIDGE. TRAFFIC SIGNALS AND A POSITIVE BARRIER ARE REQUIRED.

TRAFFIC SIGNALS SHALL BE OPERATIONAL ONLY WHEN ALL TRAFFIC CONTROLS ARE IN PLACE. WHEN TRAFFIC SIGNALS ARE NOT IN OPERATION, FLAGGERS SHALL BE USED AND TRAFFIC CONTROL SHALL CONFORM TO STANDARD 701201 OR 701206.

TEMPORARY CONCRETE BARRIER SHALL BE ACCORDING TO STANDARD 704001.

EXISTING OR TEMPORARY PAVEMENT MARKINGS SHALL BE ON BOTH SIDES OF OPEN LANE FROM STOP BAR TO STOP BAR.

ALL DIMENSIONS ARE IN INCHES (MILLIMETERS) UNLESS OTHERWISE SHOWN.

TEMPORARY PAVEMENT MARKING AS SHOWN ON THIS DETAIL, SHALL NOT BE PAID FOR SEPARATELY BUT SHALL BE INCLUDED IN THE COST OF THE STANDARD.

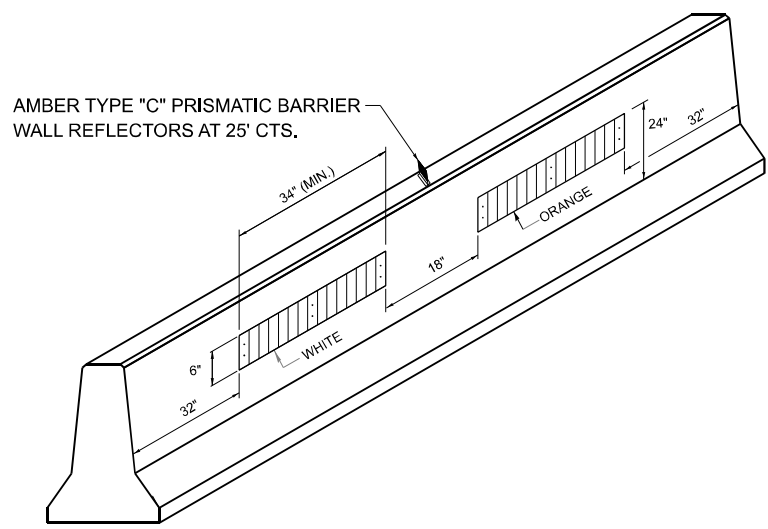

LINEAR DELINEATOR PANELS
FOR TEMPORARY CONCRETE BARRIER

LEGEND

- WORK ZONE
- BARRICADES, TYPE III WITH STEADY BURNING LIGHT
- SIGN
- IMPACT ATTENUATOR (NON-REDIRECTIVE, NARROW) TEST LEVEL 3
- TEMPORARY CONCRETE BARRIER
- TEMPORARY BRIDGE TRAFFIC SIGNAL WITH BACKPLATE AND MICROWAVE DETECTOR (INSTALLED FOR STATE I)
- TEMPORARY BRIDGE TRAFFIC SIGNAL WITH BACKPLATE (INSTALLED FOR STATE I)

KT
KUHN & TRELLO
 CONSULTING ENGINEERS
 A Limited Liability Company
 109 N. 7th Street, 3rd Floor
 Springfield, IL 62761
 Phone: 217-681-0014
 Professional Design Firm No. 184-006516

USER NAME = msulheard	DESIGNED -	REVISED -
PLOT SCALE = 0.16666833"/in.	DRAWN -	REVISED -
PLOT DATE = 12/28/2023	CHECKED -	REVISED -
	DATE -	REVISED -

STATE OF ILLINOIS
 DEPARTMENT OF TRANSPORTATION

TRAFFIC CONTROL AND PROTECTION FOR
 STAGE II CONSTRUCTION

SCALE: SHEET 2 OF 2 SHEETS STA. TO STA.

F.A.S. RTE. 1252	SECTION (22B-1)BRR	COUNTY BUREAU	TOTAL SHEETS 24	SHEET NO. 12
CONTRACT NO. 66N53				
ILLINOIS FED. AID PROJECT				

GENERAL NOTES

Plan dimensions and details relative to existing plans are subject to nominal construction variations. The Contractor shall field verify existing dimensions and details affecting new construction and make necessary approved adjustments prior to construction or ordering of materials. Such variations shall not be cause for additional compensation for a change in scope of work; however, the Contractor will be paid for the quantity actually furnished at the unit price bid for the work.

All structural steel for expansion joints shall be AASHTO M 270 Grade 36

Reinforcement bars designated (E) shall be epoxy coated.

Prior to pouring the new concrete deck, all heavy or loose rust, loose mill scale, and other loose or potentially detrimental foreign material shall be removed from the surfaces in contact with concrete. Tightly adhered paint may remain unless otherwise noted. Removal shall be accomplished by methods that will not damage the steel and the cost will be included in the pay item Concrete Removal.

As directed by the Engineer, existing construction accessories welded to the top flange of beams and girders shall be removed. The weld areas shall be ground flush and inspected for cracks using Magnetic Particle Testing (MT) or Dye Penetrant Testing (PT) by qualified personnel approved by the Engineer.

Protective Coat shall be applied to all new concrete

Existing reinforcement bars extending into the removal area shall be cleaned, straightened, and incorporated into the new construction. Any reinforcement bars that are damaged during concrete removal shall be replaced with an approved bar splicer or anchorage system. Cost included with Concrete Removal

Areas of approach slab and deck repairs are estimated. The Engineer shall show actual locations of deck and approach slab repairs on as-built plans.

Joint opening shall be adjusted according to Article 520.04 of the Standard Specifications when the deck is poured at an ambient temperature other than 50°F.

Replace expansion joint with Preformed Joint Strip Seal, both abutments

SCOPE OF WORK

1. Perform Deck Slab Repair, remove name plate, removal of deck ends at abutments, parapets and hatch blocks.
2. Perform Epoxy Crack Injection.
3. Cast deck ends, parapet ends and hatch blocks.
4. Place Preformed Joint Strip Seal at joints at abutments.
5. Remove existing slopewall, both ends. Fill scour holes with Rockfill - Embankment.
6. Install Stone Dumped Riprap, Class A4 and Filter Fabric at abutments & riprap only at piers.

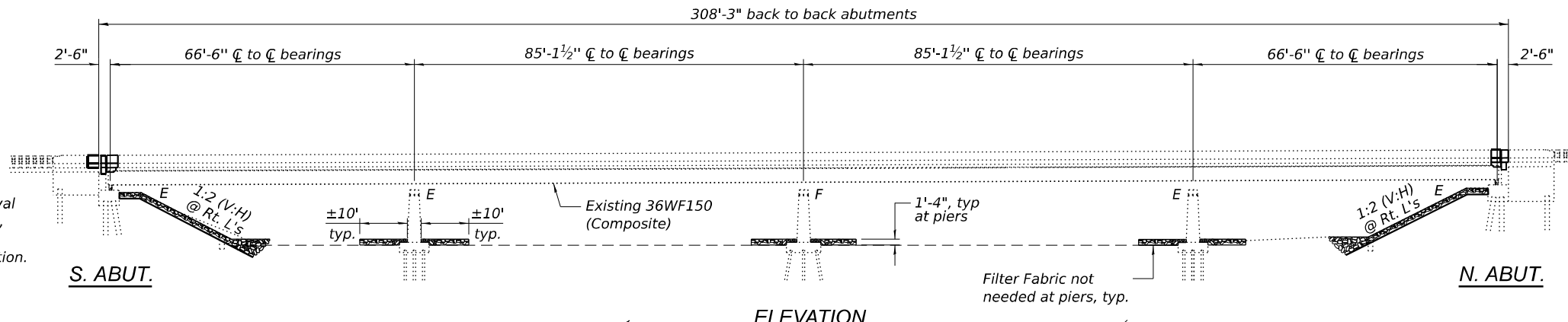

ELEVATION

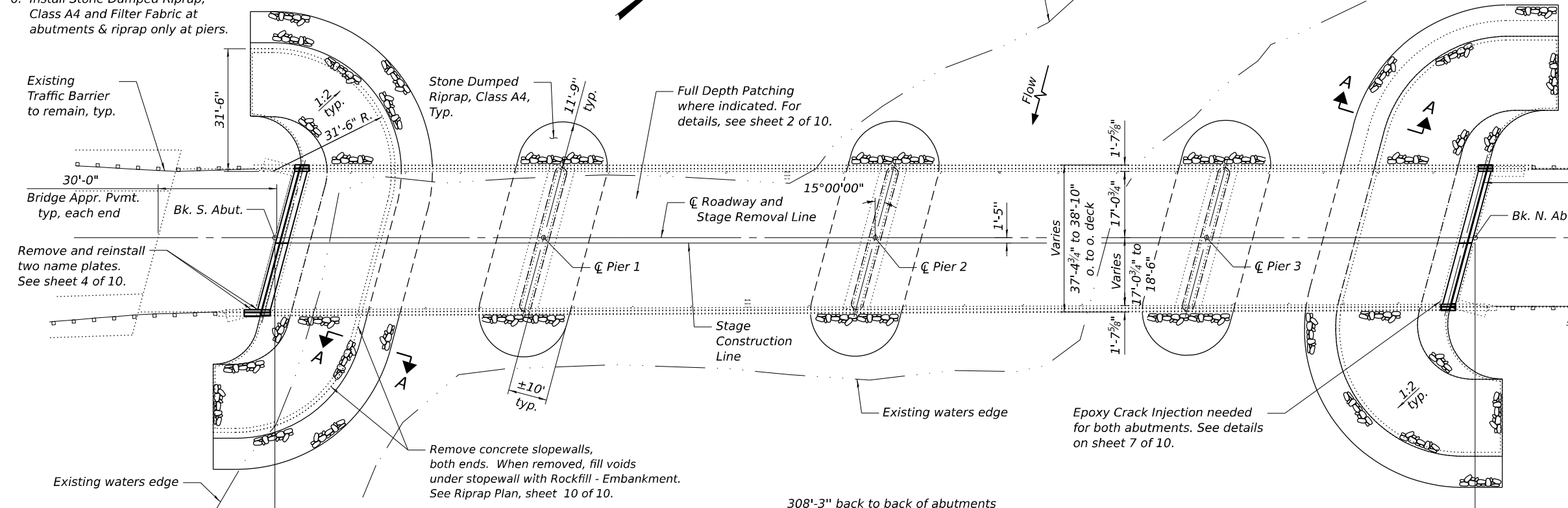

PLAN

TOTAL BILL OF MATERIAL

ITEM	UNIT	QUANTITY
Stone Dumped Riprap, Class A4	Ton	1780
Filter Fabric	Sq. Yd.	1217
Concrete Removal	Cu. Yd.	12.1
Slopewall Removal	Sq. Yd.	985
Concrete Superstructure	Cu. Yd.	12.1
Protective Coat	Sq. Yd.	30.1
Reinforcement Bars, Epoxy Coated	Pound	1380
Bar Splicers	Each	24
Preformed Joint Strip Seal	Foot	76
Approach Slab Repair (Partial Depth)	Sq. Yd.	23
Deck Slab Repair (Full Depth, Type I)	Sq. Yd.	1
Deck Slab Repair (Full Depth, Type II)	Sq. Yd.	5.0
Deck Slab Repair (Partial)	Sq. Yd.	8.7
Epoxy Crack Injection	Foot	62
Rockfill - Embankment	Ton	20

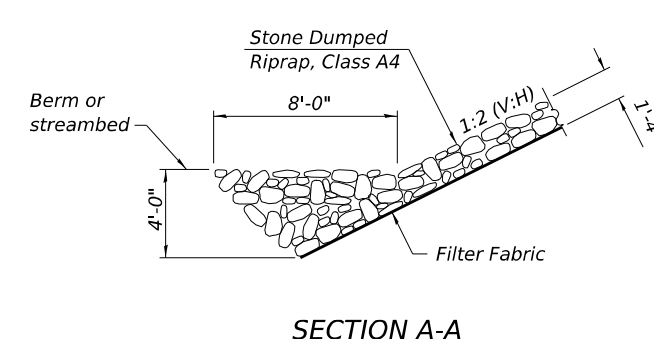

SECTION A-A

DESIGN SPECIFICATIONS

New Construction:
2002 AASHTO Standard Specifications for Highway Bridges, 17th Edition
Existing Construction:
1996 AASHTO 1997 and 1988 Interims
1995 Retrofitting Guidelines for Highway Bridges FHWA/RD 94/052

LOADING HS-20-44 (EXISTING)

No future wearing surface

DESIGN STRESSES

FIELD UNITS

New Construction
f_c = 4,000 psi (Superstructure)
f_c = 3,500 psi (Substructure)
f_y = 60,000 psi (Reinforcement)
f_y = 50,000 psi (M270 Grade 50)

Existing Construction
f_c = 3,500 psi
f_y = 60,000 psi (Reinforcement)
f_y = 36,000 psi (Structural Steel)

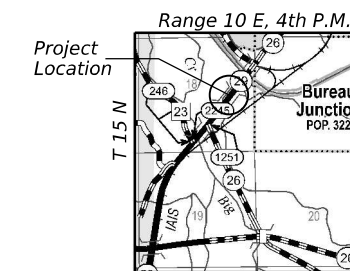

LOCATION SKETCH

**BRIDGE REPAIRS
IL RTE 26/29 OVER
BUREAU CREEK OVERFLOW
F.A.S. RTE. 1252
SEC. (22B-1)BRR
BUREAU COUNTY
STATION 435+95.00
S.N. 006-0083**

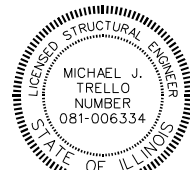

Date: 2/12/2024
Expires: 11/30/2024

KT KUHN & TRELLO CONSULTING ENGINEERS
A Limited Liability Company
109 N. 7th Street, 2nd Floor
Springfield, IL 62761
Phone: 217-679-0014
Professional Design Firm No. 284-006516

USER NAME = myoung	DESIGNED - KTCE	REVISED -
PLOT SCALE = 0.16666633' / in.	CHECKED - MJT	REVISED -
PLOT DATE = 2/12/2024	DRAWN - MMY	REVISED -
	CHECKED - MJT	REVISED -

**STATE OF ILLINOIS
DEPARTMENT OF TRANSPORTATION**

**GENERAL PLAN & ELEVATION
STRUCTURE NO. 006-0083**

SHEET 1 OF 10 SHEETS

F.A.S. RTE.	SECTION	COUNTY	TOTAL SHEETS	SHEET NO.
1252	(22B-1)BRR	BUREAU	24	13
CONTRACT NO. 66N53				
ILLINOIS FED. AID PROJECT				

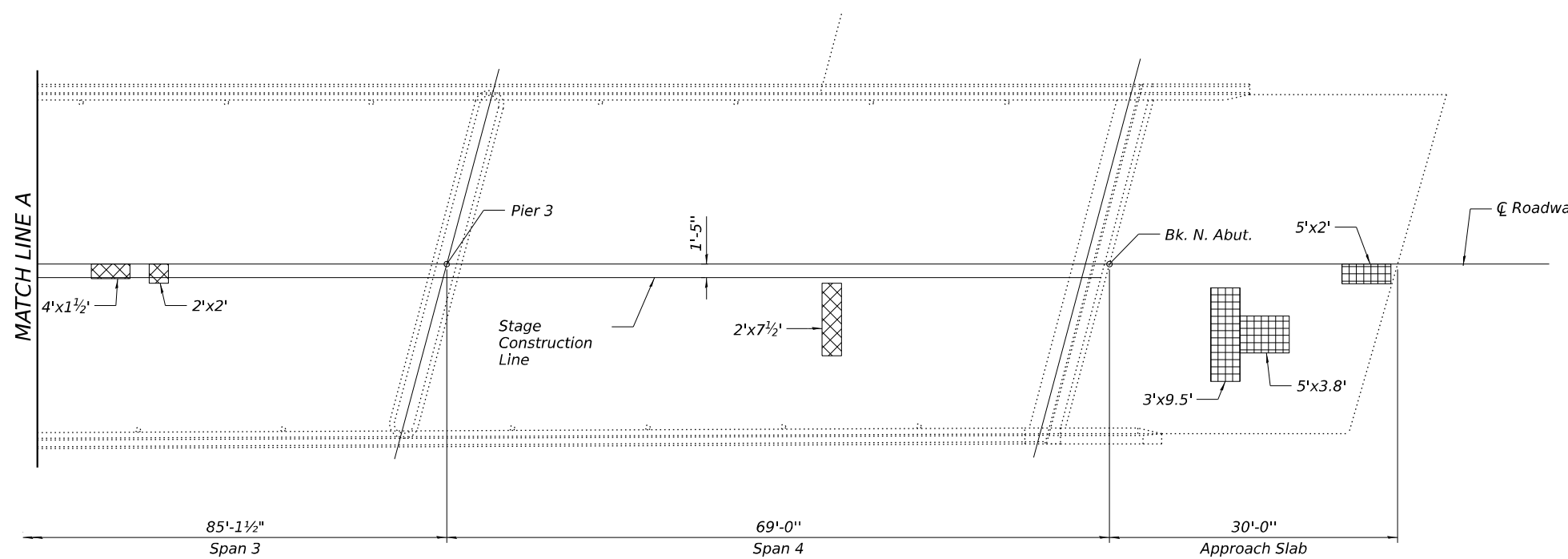
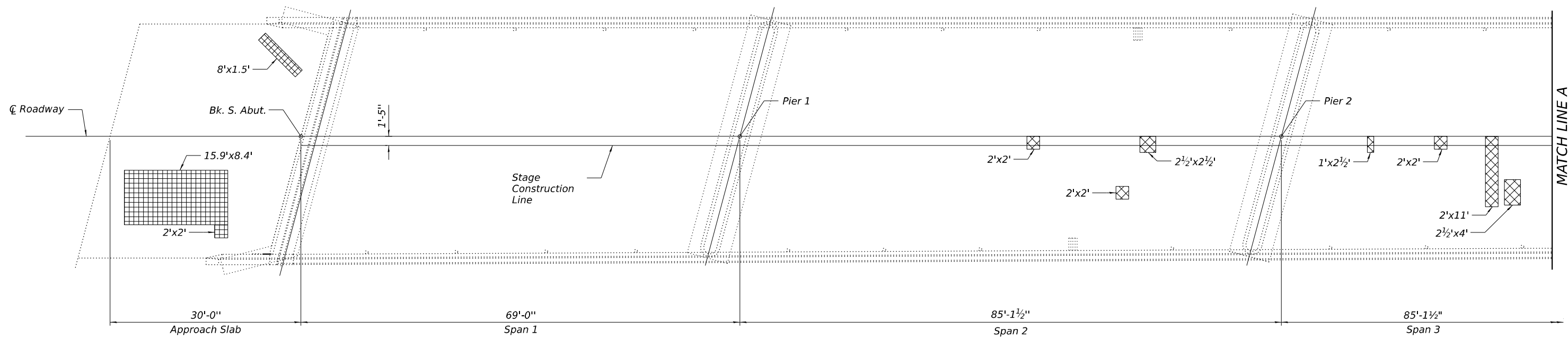

PATCHING PLAN

LEGEND

- Approach Slab Repair (Partial Depth)
- Deck Slab Repair (Partial Depth)

BILL OF MATERIAL

Item	Unit	Total
Approach Slab Repair (Partial Depth)	Sq. Yd.	23.0
Deck Slab Repair (Full Depth, Type I)	Sq. Yd.	2.1
Deck Slab Repair (Full Depth, Type II)	Sq. Yd.	6.6

MODEL: Sheet
 FILE NAME: I:\2022\22069.02 IDOT D3 - PTB 205-023 - WO2 - Bureau County 66N53\CADData\CADsheets\060083-66N53-002-Patching.dgn
 1/24/2024 11:10:29 AM

KUHN & TRELLO
 CONSULTING ENGINEERS
 A Limited Liability Company
 109 N. 7th Street, 3rd Floor
 Springfield, IL 62761
 Phone: 217-628-0014
 Professional Design Firm No. 184-006516

USER NAME = myoung	DESIGNED - KTCE	REVISED -
PLOT SCALE = 0.16666633" / in.	CHECKED - MJT	REVISED -
PLOT DATE = 1/24/2024	DRAWN - MMY	REVISED -
	CHECKED - MJT	REVISED -



STATE OF ILLINOIS
DEPARTMENT OF TRANSPORTATION

DECK PATCHING DETAILS
STRUCTURE NO. 006-0083

SHEET 2 OF 10 SHEETS

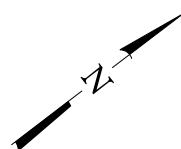
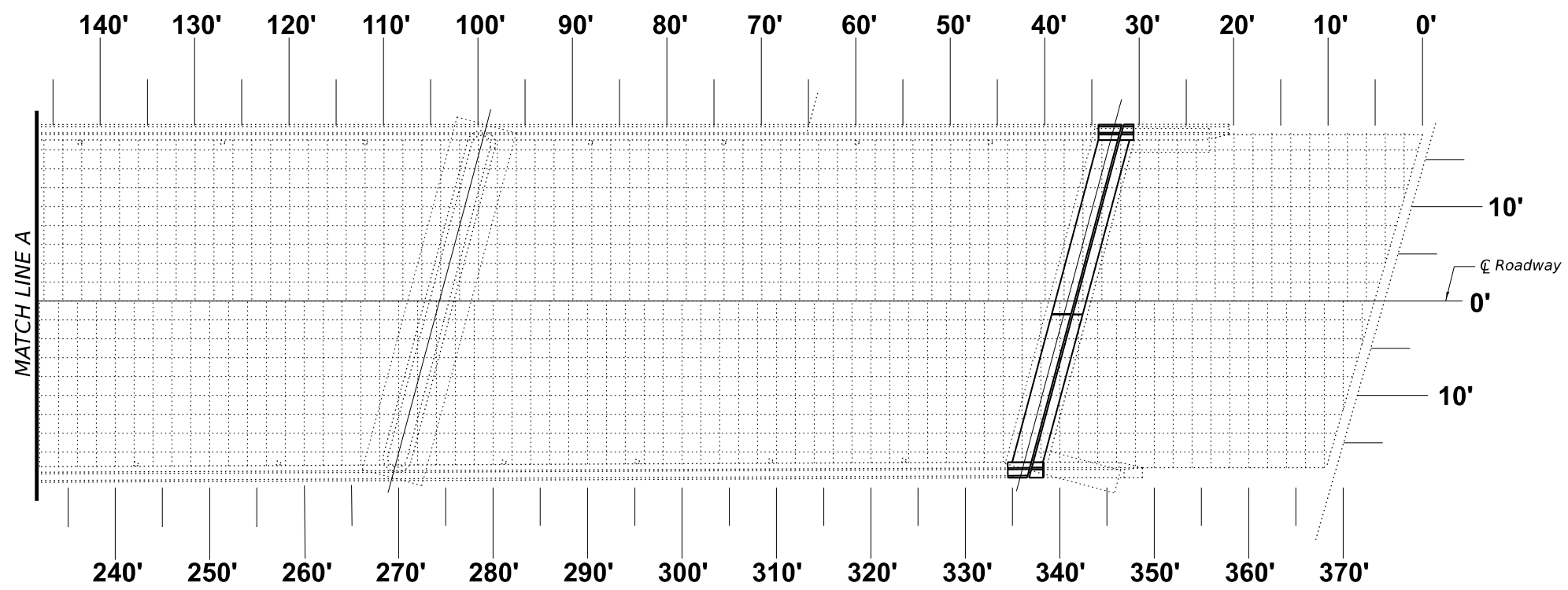
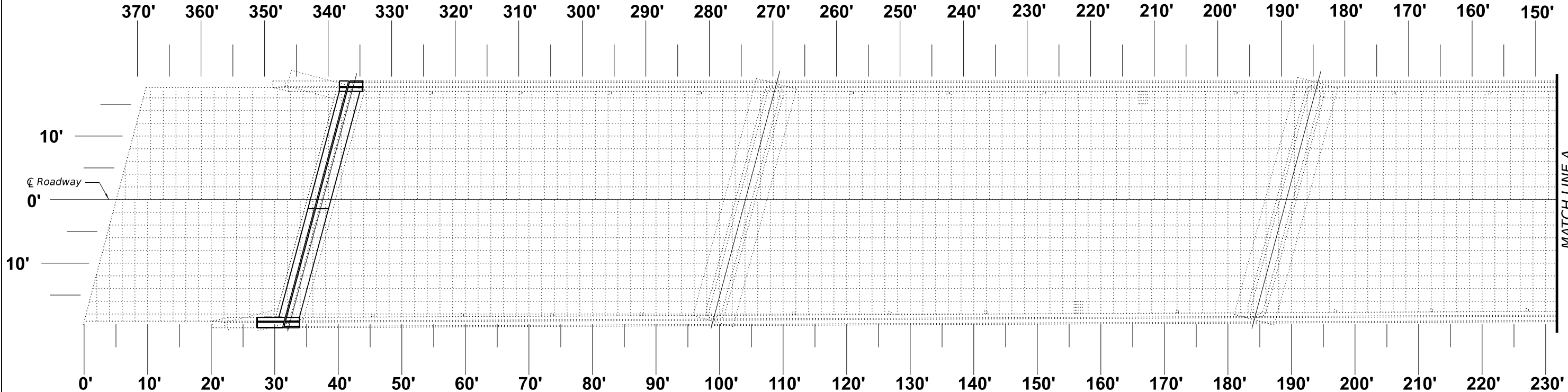
F.A.S. RTE.	SECTION	COUNTY	TOTAL SHEETS	SHEET NO.
1252	(22B-1)BRR	BUREAU	24	14
CONTRACT NO. 66N53				
ILLINOIS		FED. AID PROJECT		



- LEGEND**
-  Deck Slab Repair (Full Depth, Type I)
 -  Deck Slab Repair (Full Depth, Type II)
 -  2' x 2' Gridlines

NOTE:
 When all deck slab repairs have been completed, the Engineer shall record the actual deck slab repair locations and repair areas on this "As-Built" plan sheet. When all deck repairs have been shown on this detail, the "As-Built" deck slab repairs shall be submitted to the Bridge Office for their record. "See Commitments".

**"AS-BUILT" PLAN
 DECK PATCHING**

MODEL: Sheet
 FILE NAME: I:\2022\22069.02 IDOT D3 - PTB 205-023 - WO2 - Bureau County 66N53\CADData\CADsheets\0060083-66N53-003-Deck-AsBuilt.dgn
 2/12/2024 4:05:27 PM



USER NAME = myoung	DESIGNED - KTCE	REVISED -
PLOT SCALE = 0.16666633' / in.	CHECKED - MJT	REVISED -
PLOT DATE = 2/12/2024	DRAWN - MMY	REVISED -
	CHECKED - MJT	REVISED -

**STATE OF ILLINOIS
 DEPARTMENT OF TRANSPORTATION**

**"AS-BUILT" DECK/APPROACH SLAB REPAIR DETAILS
 STRUCTURE NO. 006-0083**

SHEET 3 OF 10 SHEETS

F.A.S. RTE. 1252	SECTION (22B-1)BRR	COUNTY BUREAU	TOTAL SHEETS 24	SHEET NO. 15
CONTRACT NO. 66N53			ILLINOIS FED. AID PROJECT	

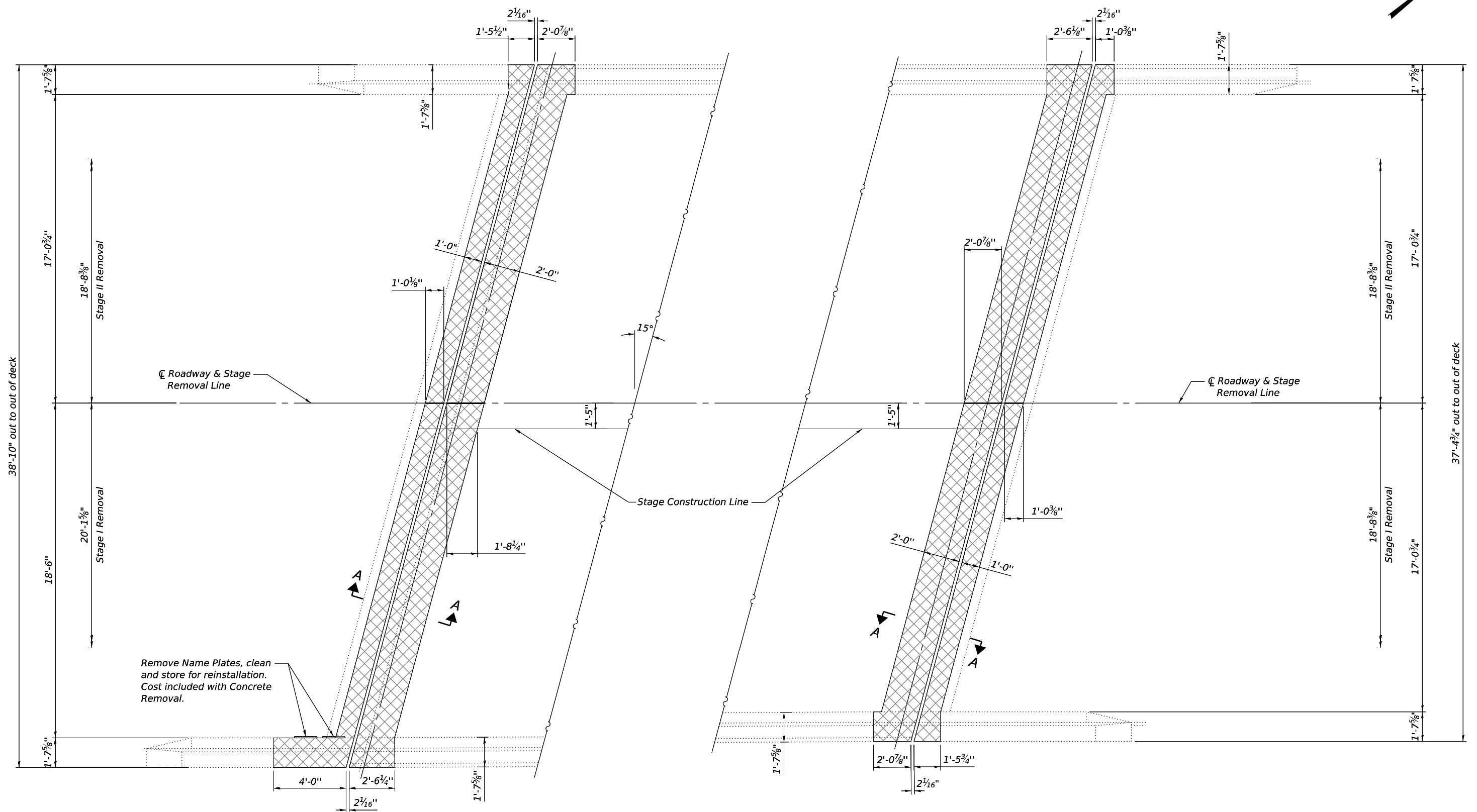
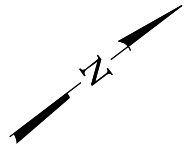

Remove Name Plates, clean and store for reinstallation. Cost included with Concrete Removal.

S. ABUT.

N. ABUT.

EXISTING PLAN

LEGEND

Concrete Removal

NOTES:
For Section A-A, See Sheet 5 of 10.

MODEL: Sheet 1; 202202069.02 IDOT D3 - PTB 205-023 - W02 - Bureau County 66N53\CADData\CADSheets\0060083-66N53-004-Removal-plan.dgn

KT KUHN & TRELLO
CONSULTING ENGINEERS
A Limited Liability Company
199 N. 7th Street, 3rd Floor
Springfield, IL 62761
Phone: 217-529-0654
Professional Design Firm No. 184-008516

USER NAME = myoung	DESIGNED - KTCE	REVISED -
PLOT SCALE = 0.16666633 / in.	CHECKED - MJT	REVISED -
PLOT DATE = 3/11/2024	DRAWN - MMY	REVISED -
	CHECKED - MJT	REVISED -

STATE OF ILLINOIS
DEPARTMENT OF TRANSPORTATION

REMOVAL DETAILS
STRUCTURE NO. 006-0083
SHEET 4 OF 10 SHEETS

F.A.S. RTE. 1252	SECTION (22B-1)BRR	COUNTY BUREAU	TOTAL SHEETS 24	SHEET NO. 16
ILLINOIS		FED. AID PROJECT		

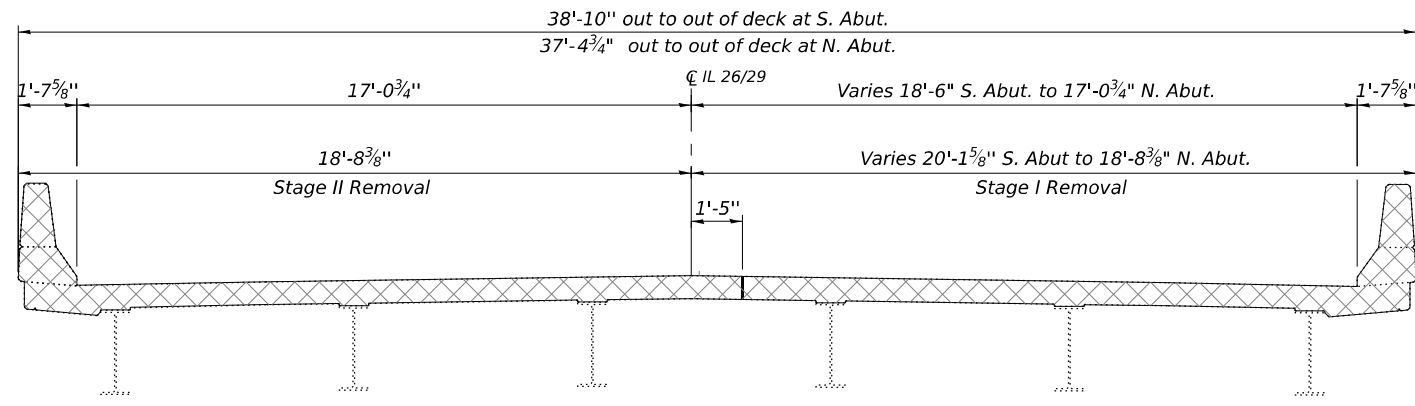

CROSS SECTION
(Looking North)

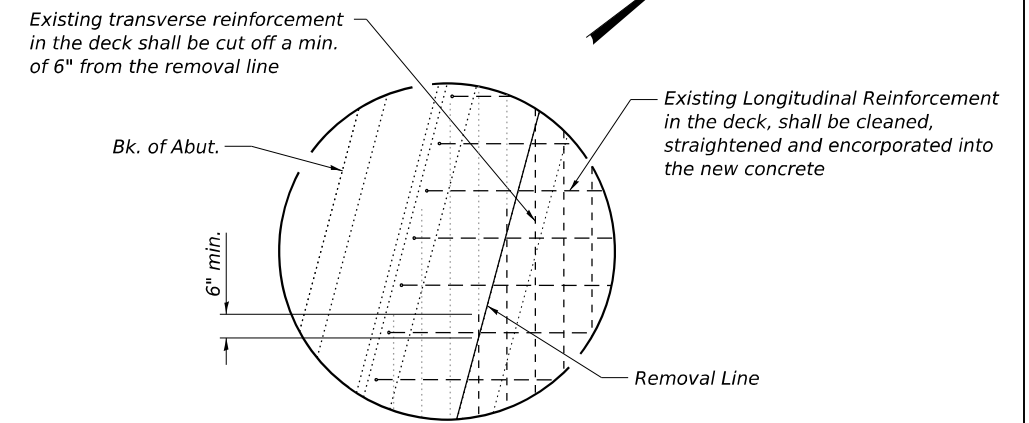

DECK REINFORCEMENT CUTTING DETAIL

LEGEND

Concrete Removal

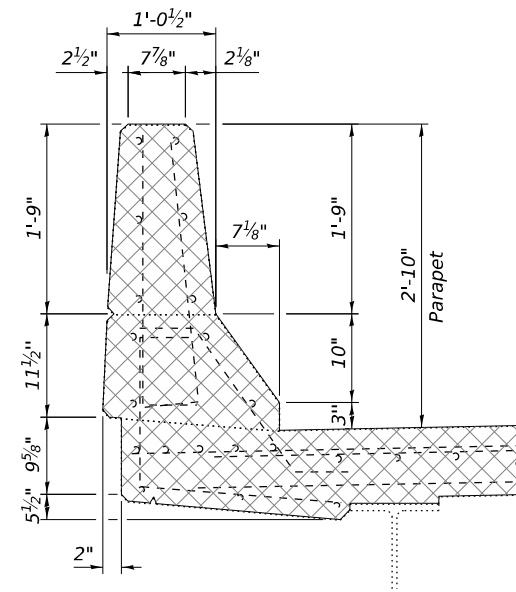

CURB SECTION

Existing reinforcement shall be cleaned, straightened and incorporated into the new concrete

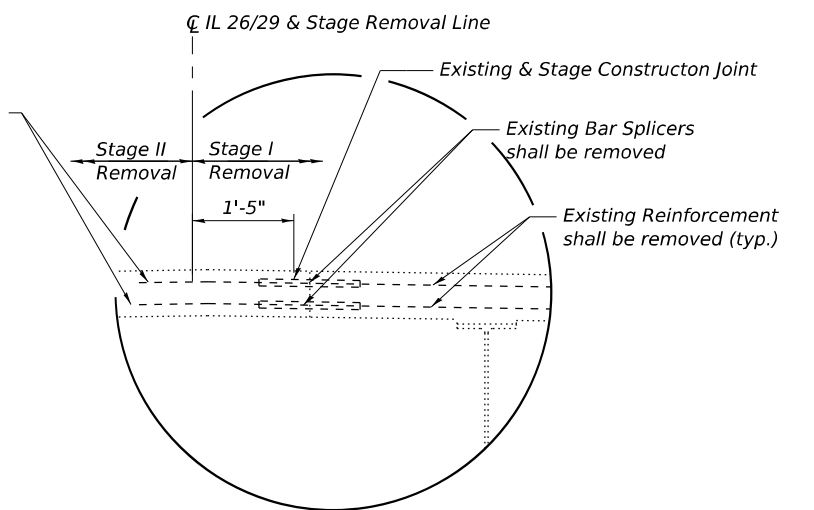

EXISTING CONSTRUCTION JOINT
At Deck

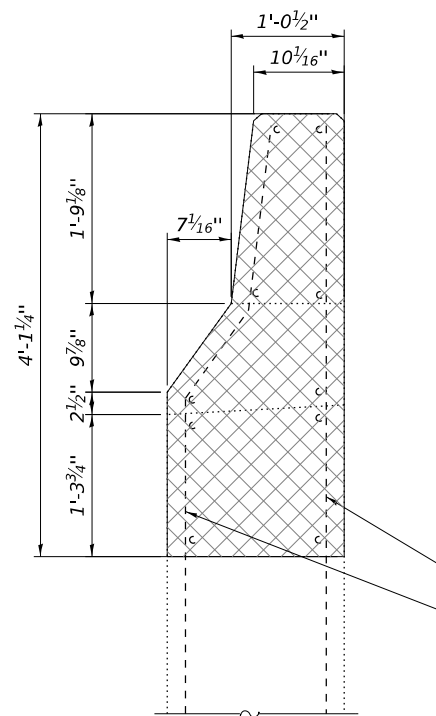

SECTION THRU WING WALL

Existing reinforcement shall be cleaned, straightened and incorporated into the new concrete

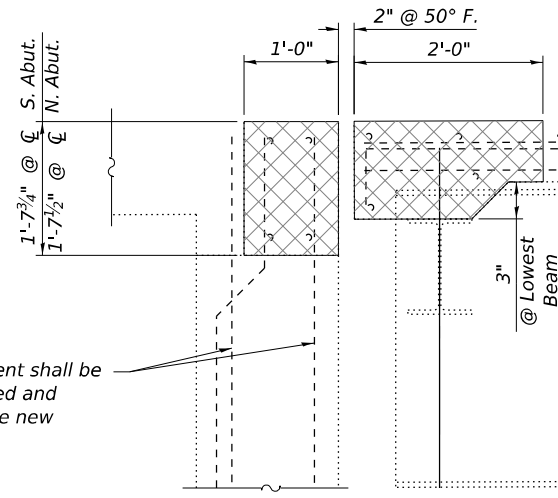

SECTION A-A
Dimensions at Rt. L's

Existing reinforcement shall be cleaned, straightened and incorporated into the new concrete

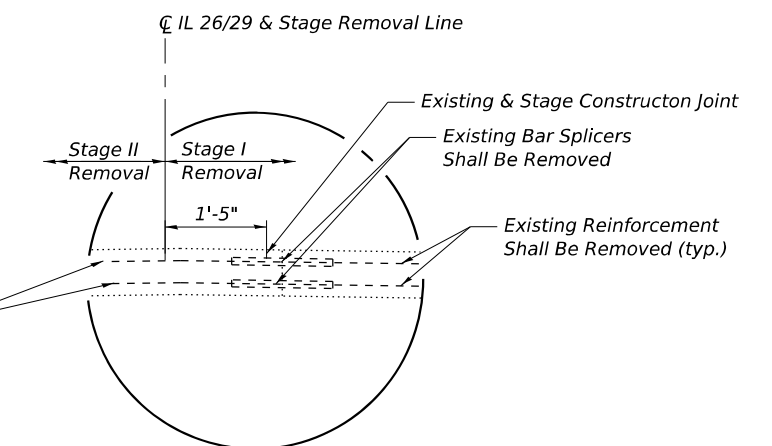

EXISTING CONSTRUCTION JOINT
At Abutment

MODEL: Sheet
FILE NAME: I:\2022\220669.02 IDOT D3 - PTB 205-023 - WO2 - Bureau County 66N53\CAD\Drawings\060083-66N53-005-Removal-del.dgn

KT KUHN & TRELLO
CONSULTING ENGINEERS
A Limited Liability Company
100 N. 7th Street, 3rd Floor
Springfield, IL 62764
Phone: 217-679-0044
Professional Design Firm No. 184-006516

USER NAME = myoung	DESIGNED - KTCE	REVISIONS
PLOT SCALE = 0.16666633' / in.	CHECKED - MJT	REVISIONS
PLOT DATE = 1/24/2024	DRAWN - MMY	REVISIONS
	CHECKED - MJT	REVISIONS

STATE OF ILLINOIS
DEPARTMENT OF TRANSPORTATION

REMOVAL DETAILS
STRUCTURE NO. 006-0083
SHEET 5 OF 10 SHEETS

F.A.S. RTE.	SECTION	COUNTY	TOTAL SHEETS	SHEET NO.
1252	(22B-1)BRR	BUREAU	24	17
CONTRACT NO. 66N53			ILLINOIS FED. AID PROJECT	

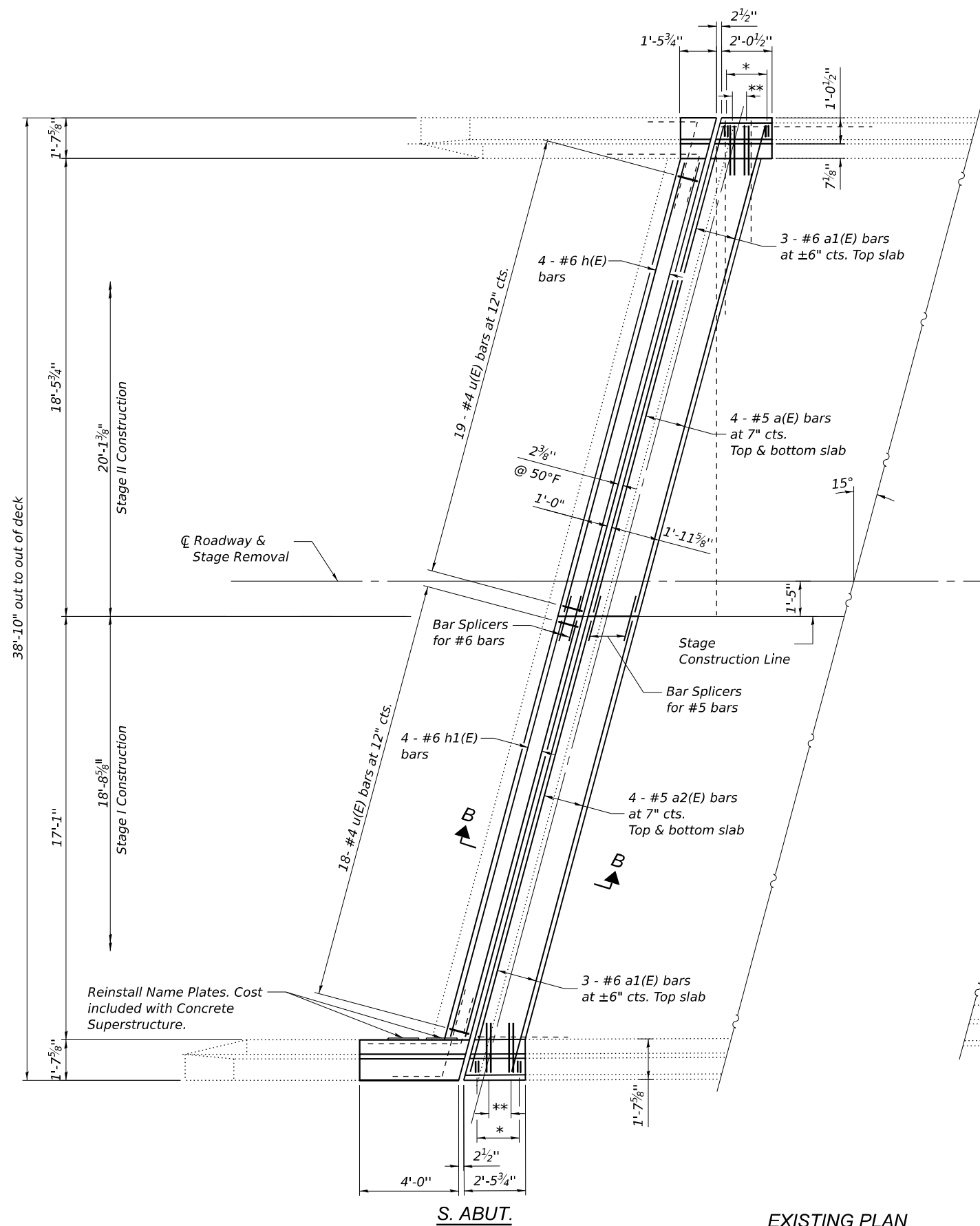
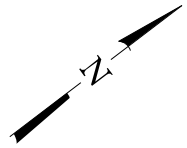

S. ABUT.

EXISTING PLAN

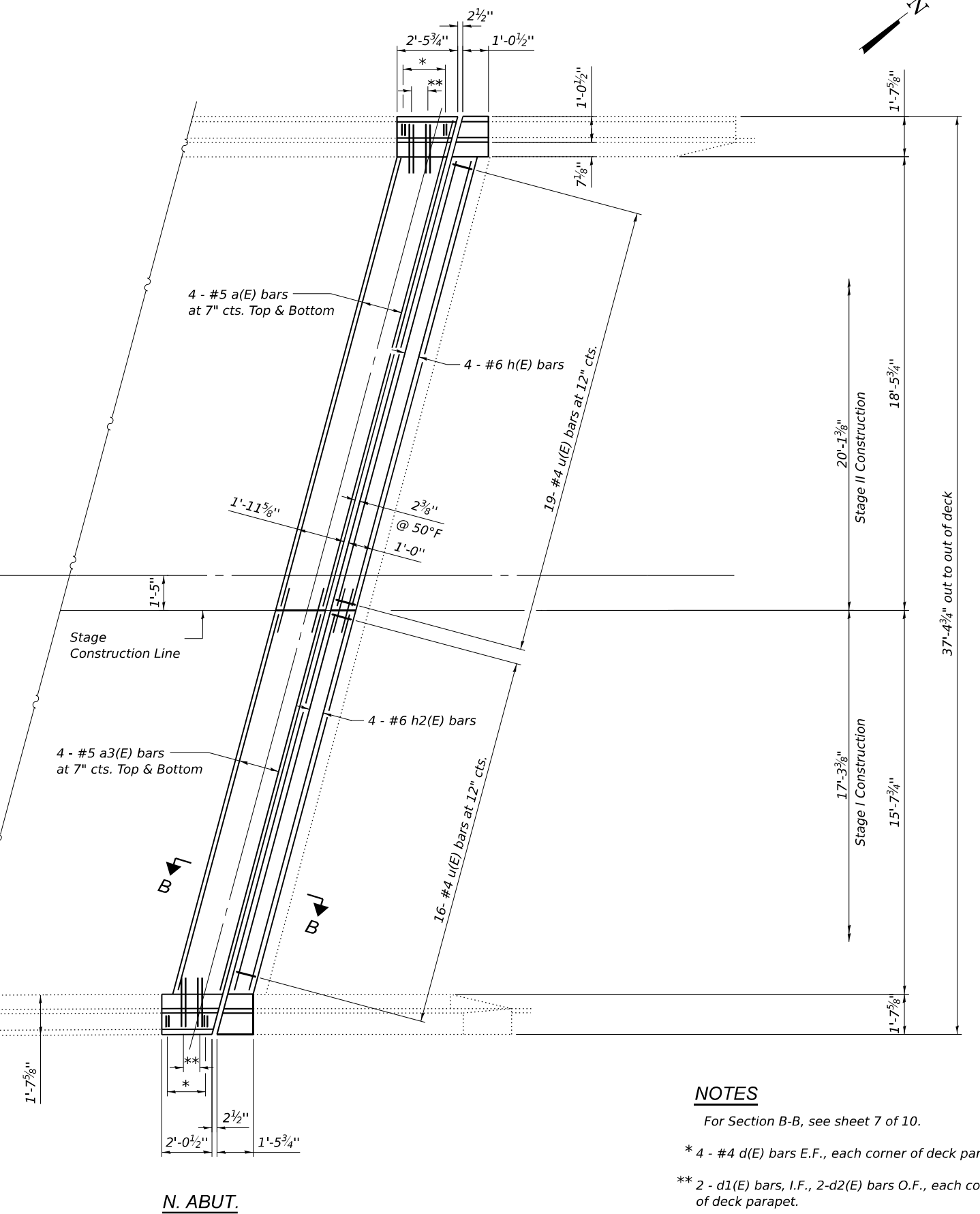

N. ABUT.

NOTES

- For Section B-B, see sheet 7 of 10.
- * 4 - #4 d(E) bars E.F., each corner of deck parapet
- ** 2 - d1(E) bars, I.F., 2-d2(E) bars O.F., each corner of deck parapet.

MODEL: Sheet
 FILE NAME: I:\2022\220693.02 IDOT D3 - PTB 205-023 - W02 - Bureau County 66N53\CADData\CADSheets\0060083-66N53-006-Prop-J-plan.dgn
 3/11/2024 6:57:42 AM



USER NAME = myoung	DESIGNED - KTCE	REVISED -
PLOT SCALE = 0.16866633 / in.	CHECKED - MJT	REVISED -
PLOT DATE = 3/11/2024	DRAWN - MMY	REVISED -
	CHECKED - MJT	REVISED -

STATE OF ILLINOIS
DEPARTMENT OF TRANSPORTATION

CONSTRUCTION DETAILS - DECK
STRUCTURE NO. 006-0083

SHEET 6 OF 10 SHEETS

F.A.S. RTE. 1252	SECTION (22B-1)BRR	COUNTY BUREAU	TOTAL SHEETS 24	SHEET NO. 18
		CONTRACT NO. 66N53		
		ILLINOIS FED. AID PROJECT		

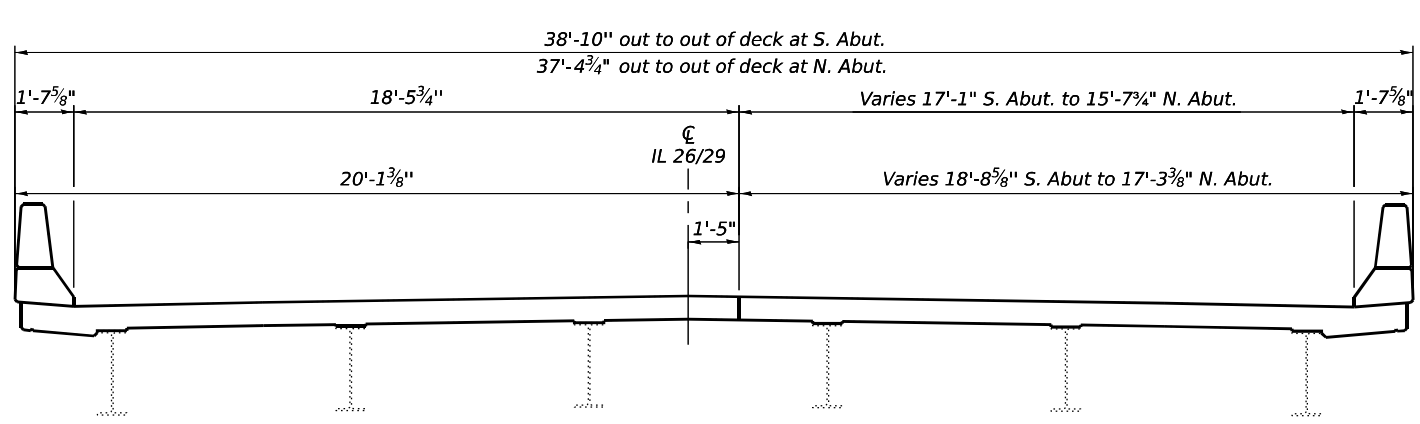

CROSS SECTION
Looking North at expansion joint

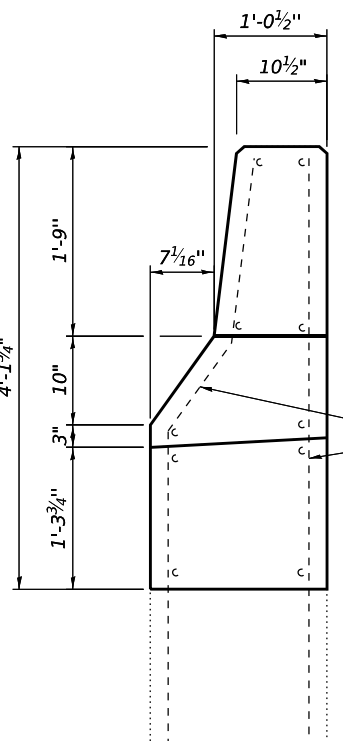

SECTION THRU WINGWALL

Existing reinforcement shall be cleaned, straightened and incorporated into the new concrete

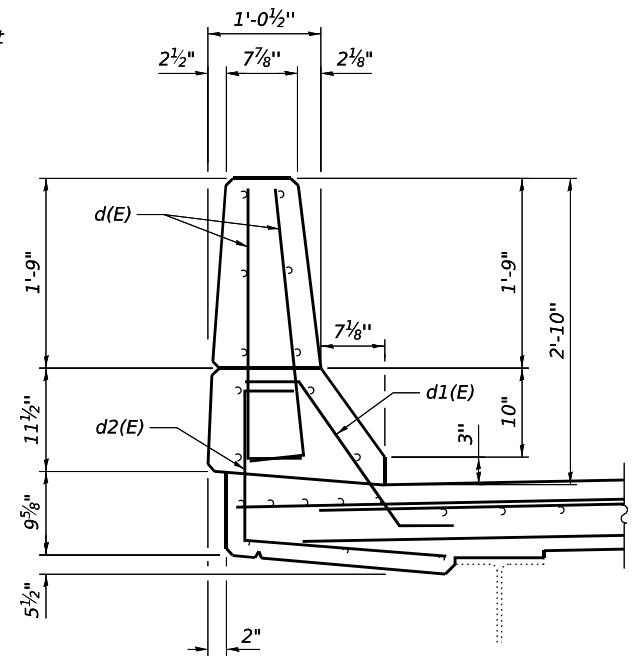

SECTION TRU PARAPET
At expansion joint

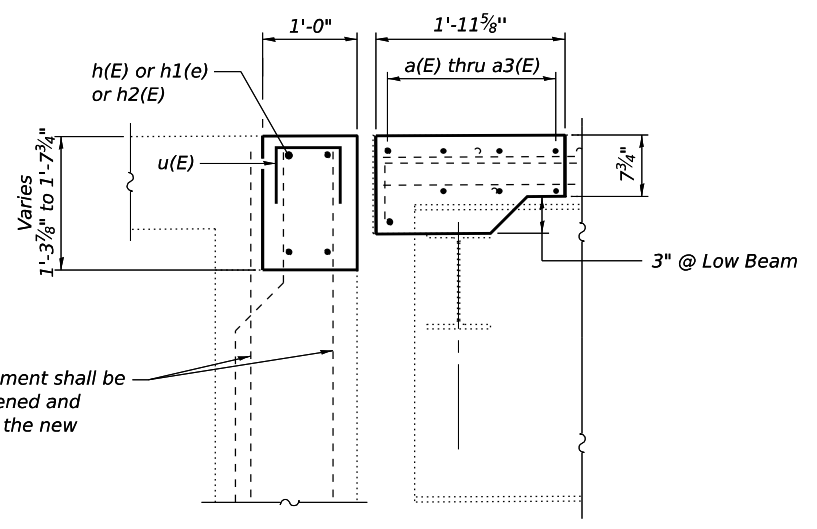

SECTION B-B

Existing reinforcement shall be cleaned, straightened and incorporated into the new concrete

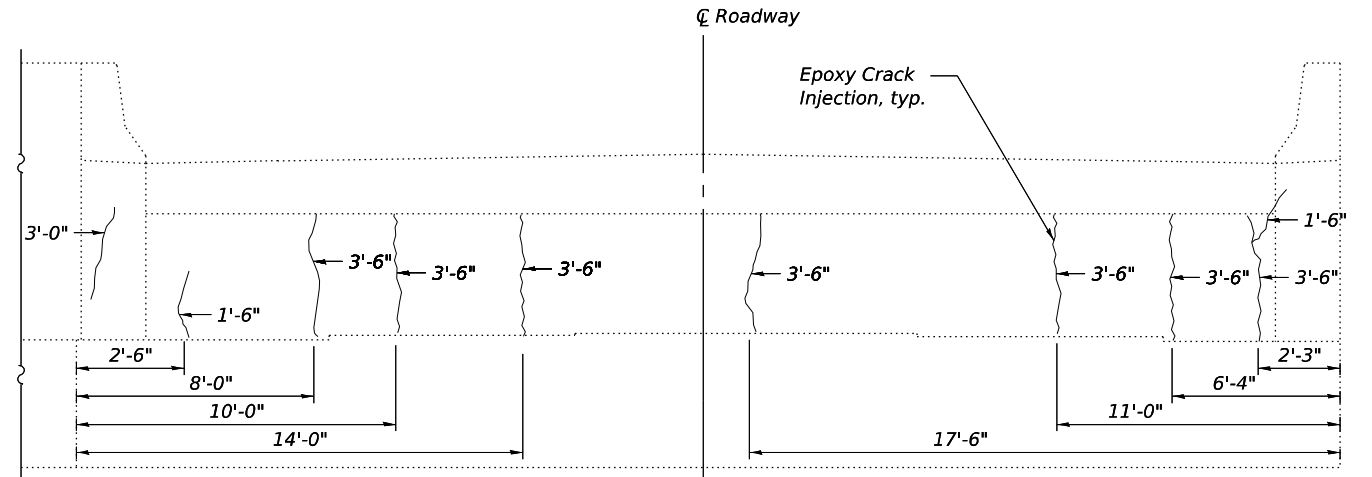

ELEVATION - SOUTH ABUTMENT REPAIR
(Looking South)

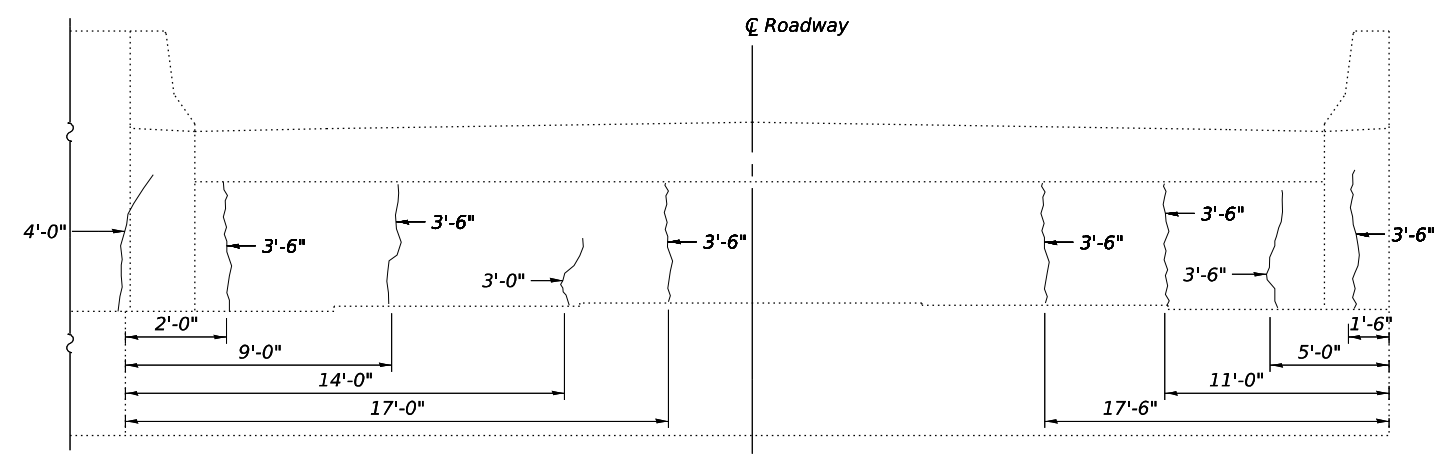

ELEVATION - NORTH ABUTMENT REPAIR
(Looking North)

BILL OF MATERIAL
TWO ABUTMENTS

Bar	No.	Size	Length	Shape
a(E)	16	#5	20'-4"	—
a1(E)	12	#6	4'-0"	—
a2(E)	8	#5	18'-10"	—
a3(E)	8	#5	17'-4"	—
d(E)	16	#5	3'-0"	L
d1(E)	8	#5	2'-8"	L
d2(E)	8	#5	4'-6"	L
h(E)	8	#6	18'-9"	—
h1(E)	4	#6	17'-4"	—
h2(E)	4	#6	15'-11"	—
u(E)	72	#4	2'-9"	□
Concrete Removal			Cu. Yd.	12.1
Concrete Superstructure			Cu. Yd.	12.1
Reinforcement Bars, Epoxy Coated			Pound	1380
Bar Splicers			Each	24
Epoxy Crack Injection			Foot	62

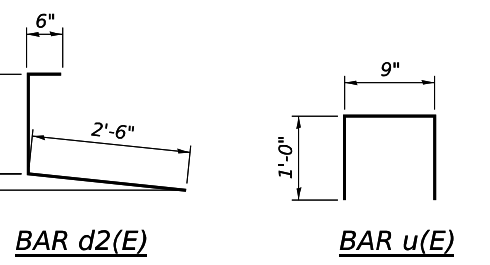
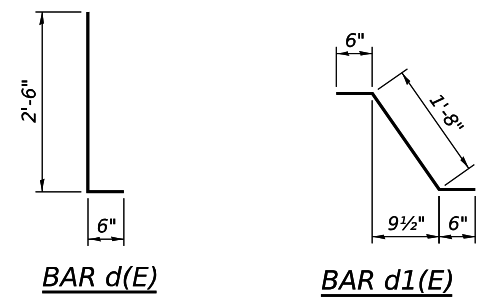

MODEL: Sheet
FILE NAME: I:\2022\22069.02 IDOT D3 - PTB 205-C23 - W02 - Bureau County 66N63\CADData\CADSheets\0060083-66N63-007-PropJct-del.dgn
2/13/2024 2:14:23 PM

KT
KUNN & TRELLO
CONSULTING ENGINEERS
A Limited Liability Company
100 N. 7th Street, 3rd Floor
Springfield, IL 62761
Phone: 217-629-0014
Professional Design Firm No. 184-006516

USER NAME = myoung	DESIGNED - KTCE	REVISED -
PLOT SCALE = 0.16666633' / in.	CHECKED - MJT	REVISED -
PLOT DATE = 2/13/2024	DRAWN - MMY	REVISED -
	CHECKED - MJT	REVISED -

STATE OF ILLINOIS
DEPARTMENT OF TRANSPORTATION

CONSTRUCTION DETAILS
STRUCTURE NO. 006-0083
SHEET 7 OF 10 SHEETS

F.A.S. RTE.	SECTION	COUNTY	TOTAL SHEETS	SHEET NO.
1252	(22B-1)BRR	BUREAU	24	19
			CONTRACT NO. 66N63	
ILLINOIS FED. AID PROJECT				

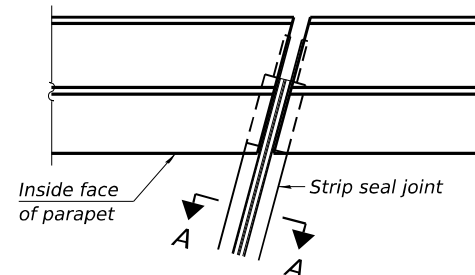

PLAN AT PARAPET

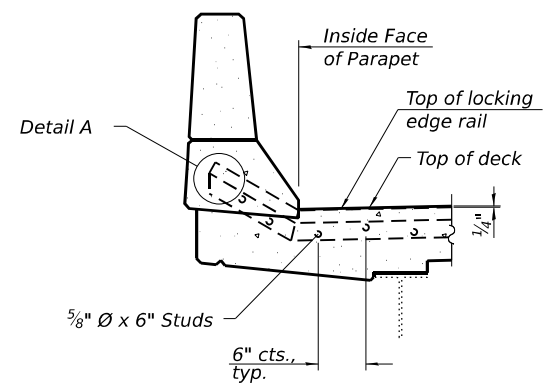

SECTION AT PARAPET
(Skews > 30° shown. Skews ≤ 30° similar except as shown in plan view.)

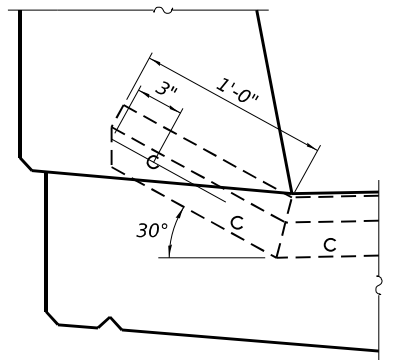

DETAIL A

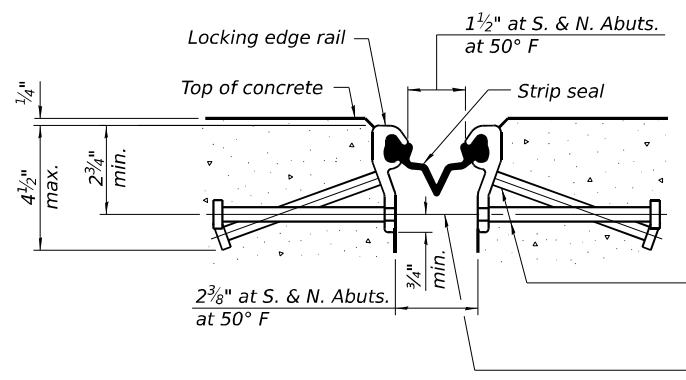

SHOWING ROLLED RAIL JOINT

* 5/8" Ø x 6" studs @ 6" cts. (alternate angled/bent studs with horizontal studs)

3/8" Ø threaded rods in 7/16" Ø holes at 4'-0" ± cts. for holding the proper joint opening based on the temperature during the deck pour. Place to miss studs. All rods shall be burned, or sawed off flush with the plates after concrete is set.

SECTION A-A

* Granular or solid flux filled headed studs conforming to Article 1006.32 of the Std. Specs., automatically end welded.

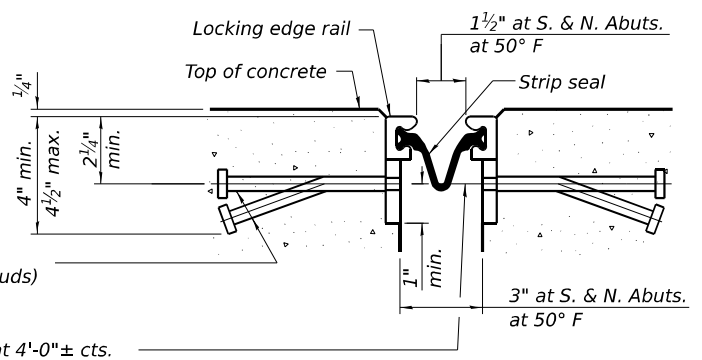

SHOWING WELDED RAIL JOINT

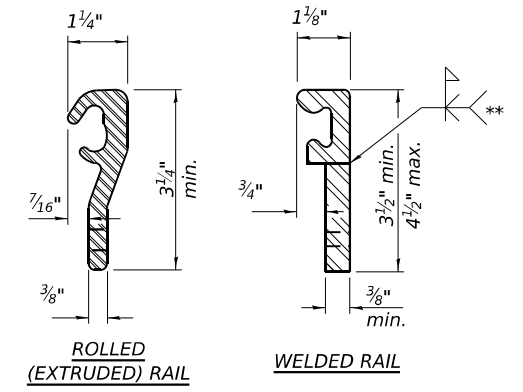

LOCKING EDGE RAILS
** Back gouge not required if complete joint penetration is verified by mock-up.

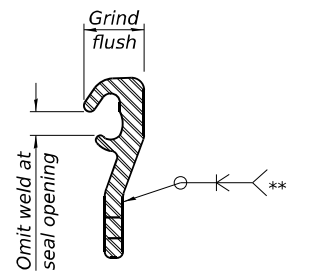

LOCKING EDGE RAIL SPLICE
The inside of the locking edge rail groove shall be free of weld residue. Rolled rail shown, welded rail similar.

BILL OF MATERIAL

Item	Unit	Total
Preformed Joint Strip Seal	Foot	76

Notes:
The strip seal shall be made continuous and shall have a minimum thickness of 1/4". The configuration of the strip seal shall match the configuration of the locking edge rails. Open or "webbed" strip seal gland configurations are not permitted. The gland shall be sized for a maximum rated movement of 4 inches.
The locking edge rails depicted are configured for typical applications and are conceptual only. The actual configuration of the locking edge rails and matching strip seal may vary from manufacturer to manufacturer provided they fit the application and meet the minimum anchorage shown. Flanged edge rails, however, will not be allowed. Locking edge rails may exceed the 4 1/2" maximum depth provided the anchorage system is revised according to the manufacturer's recommendation.
The manufacturer's recommended installation methods shall be followed.
All steel components shall be galvanized after fabrication according to Article 520.03 of the Standard Specifications.
The Maximum space between locking edge rail segments shall be C" and sealed with a suitable sealant; however, any rail joint within 10' measured perpendicular to the face of the curb or parapet shall be welded as shown in the locking edge rail splice detail.
Cost of embedded plates and anchorage studs included with Preformed Joint Strip Seal.
The concrete opening below the strip seal will vary based on the locking edge rail chosen by the Contractor. Deck and parapet lengths shown elsewhere in the plans are dimensioned to the concrete opening, not the joint opening, and are based on the rolled locking edge rail. If the Contractor elects to use a different locking edge rail, dimensional adjustments may be required. One exception to this would be the strip seal joint at the end of the precast bridge approach slab. For these cases the pavement connector length shall be adjusted, not the length of the bridge approach slab.

MODEL: Sheet
FILE NAME: I:\2022\22069.02 IDOT D3 - PTB 2015-023 - W02 - Bureau County 66N53\CADData\CADSheets\0060083-66N53-008-P-JSS.dgn
2/1/2024 10:32:07 AM

KT KUHN & TRELLO
CONSULTING ENGINEERS
A Limited Liability Company
109 N. 7th Street, 2nd Floor
Springfield, IL 62761
Phone: 217-529-0614
Professional Design Firm No. 184-006516

USER NAME = myoung	DESIGNED - KTCE	REVISED -
PLOT SCALE = 0.16866633 / in.	CHECKED - MJT	REVISED -
PLOT DATE = 2/1/2024	DRAWN - MMY	REVISED -
	CHECKED - MJT	REVISED -

STATE OF ILLINOIS
DEPARTMENT OF TRANSPORTATION

PREFORMED JOINT STRIP SEAL
STRUCTURE NO. 006-0083

SHEET 8 OF 10 SHEETS

F.A.S. RTE. 1252	SECTION (22B-1)BRR	COUNTY BUREAU	TOTAL SHEETS 24	SHEET NO. 20
ILLINOIS FED. AID PROJECT			CONTRACT NO. 66N53	

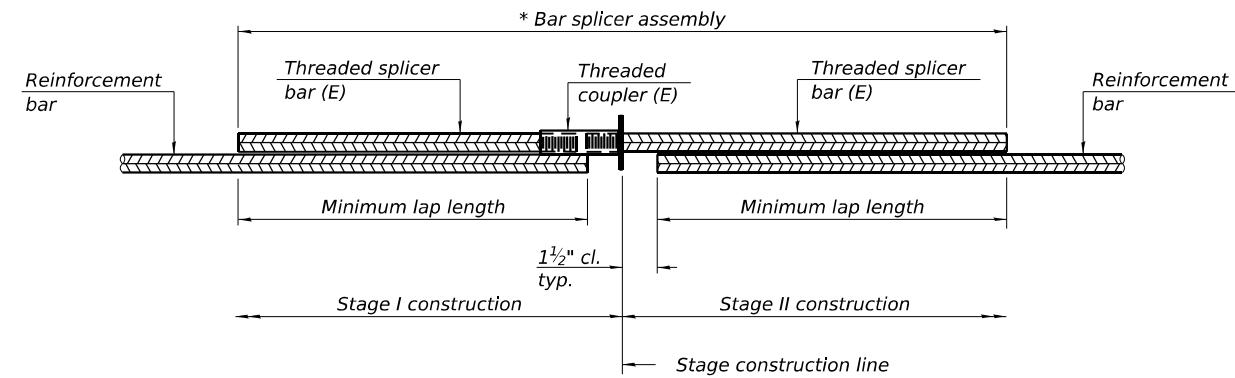

STANDARD BAR SPLICER ASSEMBLY PLAN

Only bar splicer assemblies as presented on the approved QPL list may be used.

Threaded splicer bar length = min. lap length + 1 1/2" + thread length

* Epoxy not required on Bar Splicer Assembly components used in conjunction with black bars.

Location	Bar size	No. assemblies required	Minimum lap length
S. Abut. - Deck	#5	8	3'-6"
S. Abut. - (Block out)	#6	4	4'-0"
N. Abut. - Deck	#5	8	3'-6"
N. Abut. - (Block out)	#6	4	4'-0"

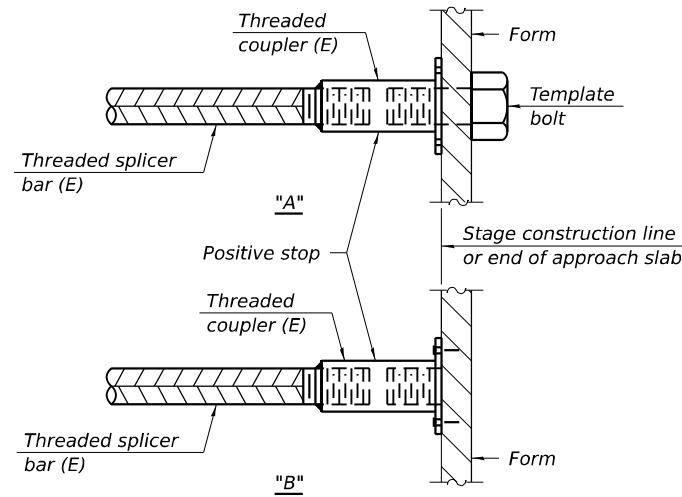

INSTALLATION AND SETTING METHODS

"A" : Set bar splicer assembly by means of a template bolt.

"B" : Set bar splicer assembly by nailing to wood forms or cementing to steel forms.

(E) : Indicates epoxy coating.

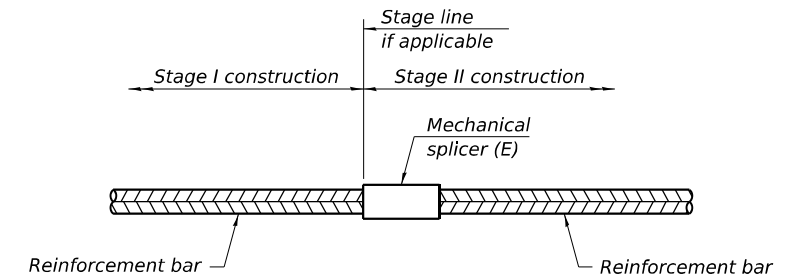

STANDARD MECHANICAL SPLICER

Location	Bar size	No. assemblies required

Notes:
 Splicer bars shall be deformed with threaded ends and have a minimum 60 ksi yield strength.
 All reinforcement shall be lapped and tied to the splicer bars.
 Bar splicer assemblies shall be epoxy coated according to the requirements for reinforcement bars. See Section 508 of the Standard Specifications.
 See approved list of bar splicer assemblies and mechanical splicers for alternatives.

MODEL: Sheet 1; 2022/22069; 02 IDOT D3 - PTB 2015-023 - W02 - Bureau County 66N53\CADData\CADSheets\006083-66N53-005-BarSplicer.dgn
 2/12/2024 4:16:55 PM

BSD-1 5-15-2023



USER NAME = myoung	DESIGNED - KTCE	REVISED -
PLOT SCALE = 0.16866633 / in.	CHECKED - MJT	REVISED -
PLOT DATE = 2/12/2024	DRAWN - MMY	REVISED -
	CHECKED - MJT	REVISED -

STATE OF ILLINOIS
 DEPARTMENT OF TRANSPORTATION

BAR SPLICER ASSEMBLY AND MECHANICAL SPLICER DETAILS
 STRUCTURE NO. 006-0083

SHEET 9 OF 10 SHEETS

F.A.S. RTE.: 1252	SECTION (22B-1)BRR	COUNTY BUREAU	TOTAL SHEETS 24	SHEET NO. 21
ILLINOIS			FED. AID PROJECT	

CONTRACT NO. 66N53

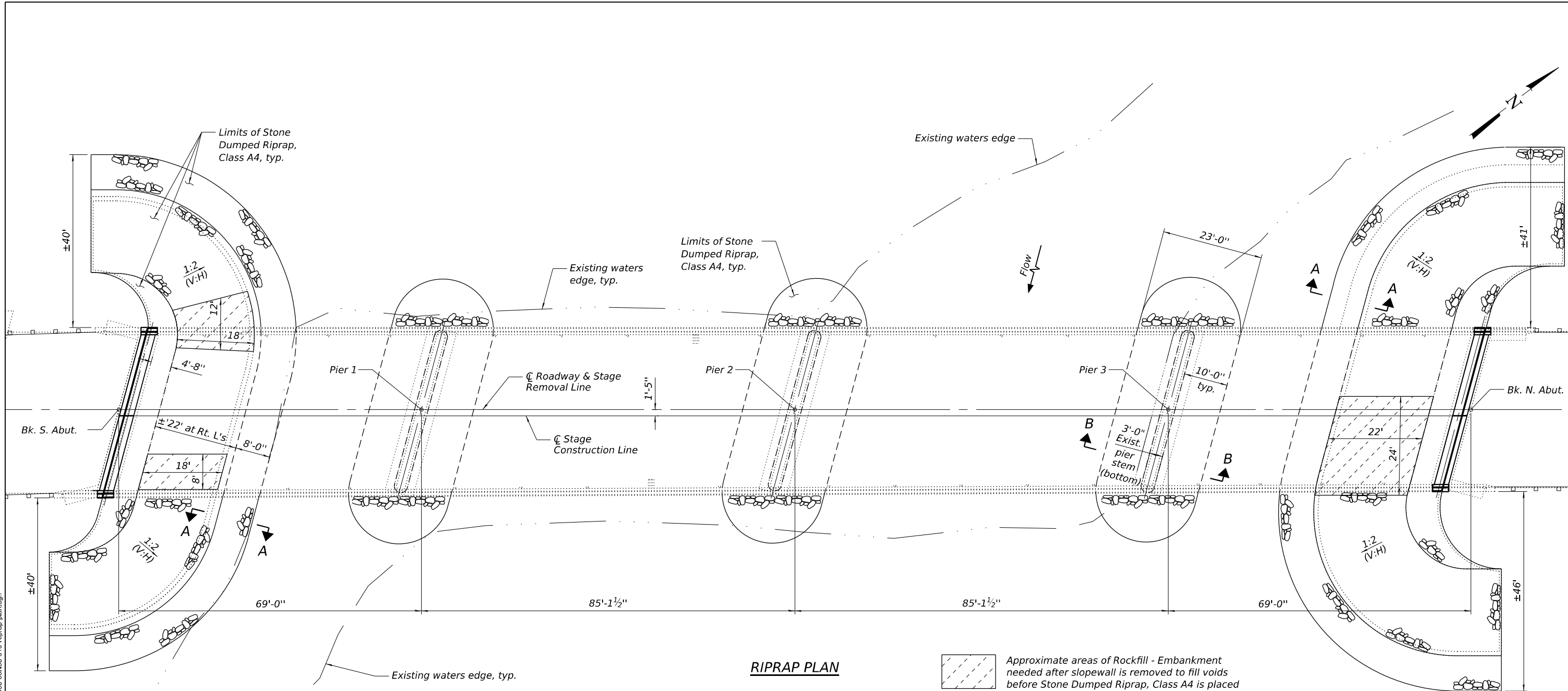

RIPRAP PLAN

Approximate areas of Rockfill - Embankment needed after slopewall is removed to fill voids before Stone Dumped Riprap, Class A4 is placed

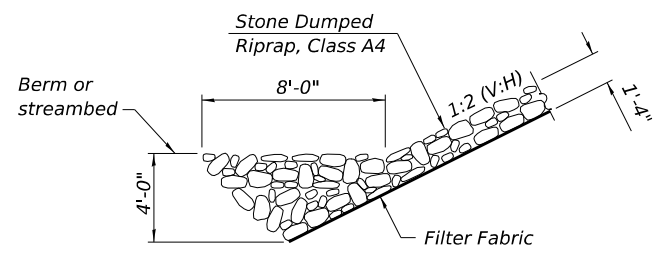

SECTION A-A

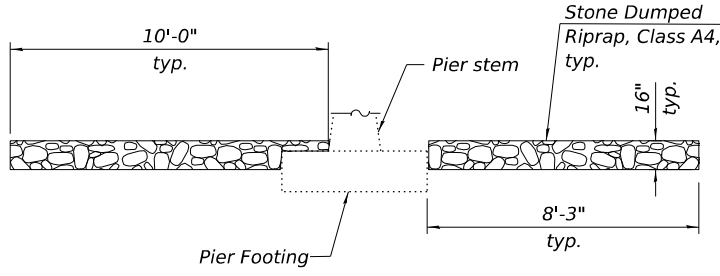

SECTION B-B
(Typical at all three pier locations)

BILL OF MATERIAL

Item	Unit	Total
Stone Dumped Riprap, Class A4	Ton	1780
Filter Fabric	Sq. Yd.	1217
Rockfill - Embankment	Ton	20

MODEL: Sheet
 FILE NAME: I:\2022\22069.02 IDOT D3 - PTB 205-023 - W02 - Bureau County 66N63\CADData\CADsheets\060083-66N63-010-Riprap-plan.dgn
 2/8/2024 12:03:27 PM

KT
KUHN & TRELLO
 CONSULTING ENGINEERS
 A Limited Liability Company
 109 N. 7th Street, 3rd Floor
 Springfield, IL 62761
 Phone: 217-629-0014
 Professional Design Firm No. 184-006516

USER NAME = myoung	DESIGNED - KTCE	REVISED -
PLOT SCALE = 0.16666633' / in.	CHECKED - MJT	REVISED -
PLOT DATE = 2/8/2024	DRAWN - MMY	REVISED -
	CHECKED - MJT	REVISED -

STATE OF ILLINOIS
DEPARTMENT OF TRANSPORTATION

RIPRAP DETAILS
STRUCTURE NO. 006-0083

SHEET 10 OF 10 SHEETS

F.A.S. RTE.	SECTION	COUNTY	TOTAL SHEETS	SHEET NO.
1252	(22B-1)BRR	BUREAU	24	22
CONTRACT NO. 66N63				
ILLINOIS FED. AID PROJECT				

Bench Mark: Sta. 5+698.96, 0.000 offset, Elev. 142.512.

Existing Structure: S.N. 006-0083 Built in 1965 as S.B.I. Rte. 29, Section 22B-1, at Sta. 5+955.600.
Existing structure consists of a 4-span reinforced concrete deck on steel WF stringers supported on concrete pile bent spill thru abutments and timber pile supported solid piers. 93.954 m Bk.-Bk. abuts. varies 11.411 m to 10.973 m O.-O. deck. Concrete deck to be removed and replaced.
One lane of traffic to be maintained utilizing stage construction.

FOR INFORMATION ONLY

ROUTE NO.	SECTION	COUNTY	TOTAL SHEETS	SHEET NO.
F.A.S. 2245	22B-1D	BUREAU	66	11
FED. ROAD DIST. NO. 7	ILLINOIS	FED. AID PROJECT		26 SHEETS

GENERAL NOTES

Fasteners shall be high strength bolts. Bolts M20, open holes 22 mm ϕ , unless otherwise noted.
Field welding of construction accessories will not be permitted to the bottom flange of beams or girders nor to the top flange for a distance equal to one-fourth the span length each way from the pier supports. Field welding in other areas will be permitted only when approved by the Engineer.
Anchor bolts shall be set before bolting diaphragms over supports.
Reinforcement bars shall conform to the requirements of AASHTO M 31M, M 42M or M 53M Grade 400. Layout of slope protection system may be varied in the field to suit ground conditions as directed by the Engineer.
Plan dimensions and details relative to existing structure have been taken from existing plans and are subject to nominal construction variations. It shall be the Contractor's responsibility to verify such dimensions and details in the field and make necessary approved adjustments prior to construction or ordering of materials. Such variations shall not be cause for additional compensation for a change in the scope of the work, however, the Contractor will be paid for the quantity actually furnished at the unit price bid for the work.
Prior to pouring the new concrete for the deck, all loose rust, loose mill scale and all other loose, detrimental foreign material shall be removed from the existing shear studs and from the portions of flanges of beams in contact with concrete. The removal shall be accomplished with appropriate hand tools. Cost shall be included with Removal of Existing Concrete Deck.
All dimensions are in millimeters (mm) except as noted.
The existing structural steel coating contains lead. The Contractor should take appropriate precautions to deal with the presence of lead on this project.
Field painting of structural steel shall be done under a separate painting contract.
All new structural steel shall be shop painted with the inorganic zinc rich primer per AASHTO M 300, Type 1.
Existing structural steel shall only be cleaned as required by the Special Provision Cleaning and Painting Adjacent Areas of Existing Steel Structures.
Bearing seat surfaces shall be constructed or adjusted to the designated elevations within a tolerance of 3 mm. Adjustment shall be made either by grinding the surface or by shimming the bearing. Two 3 mm adjusting shims, of the dimensions of the bottom bearing plate, shall be provided for each bearing in addition to all other plates or shims.

No salvage

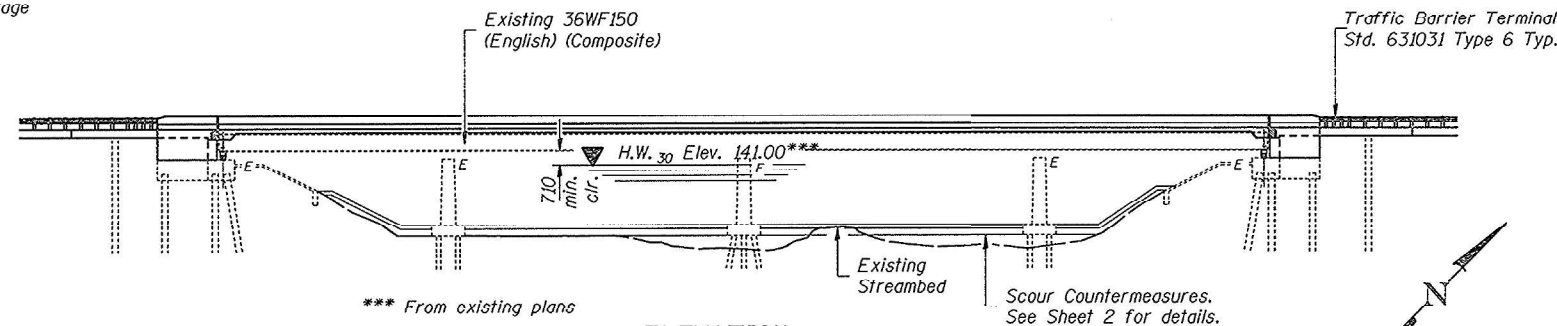

ELEVATION

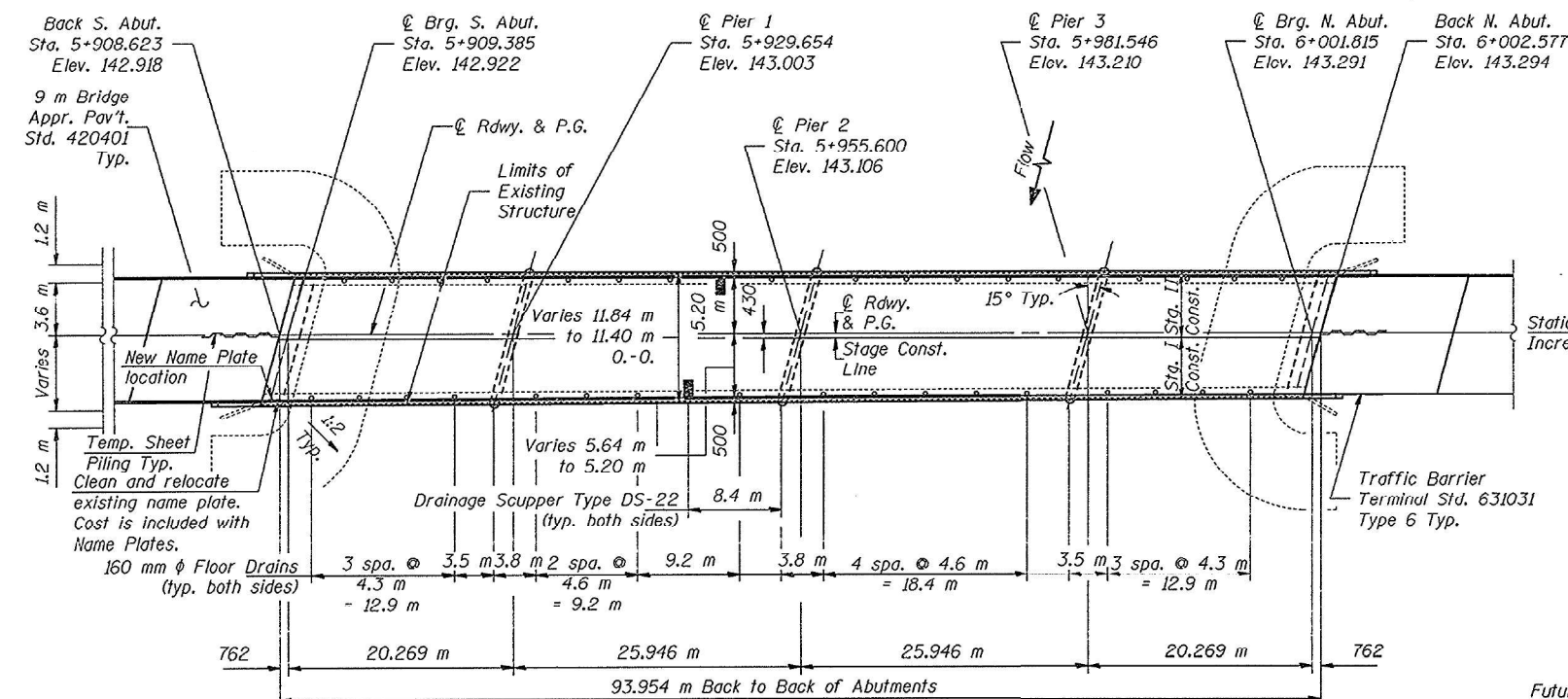

PLAN

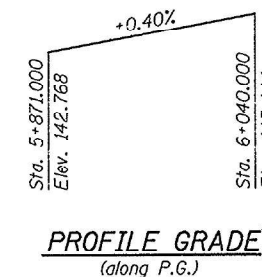

DESIGNED	Eric J. Carlson
CHECKED	C.M.E.
DRAWN	W.D.C. / M.B.M.
CHECKED	E.J.C. / C.M.E.

November 13, 1999
EXAMINED Thomas Samaluk
PASSED Ralph E. Anderson



STATION 5+955.600
REBUILT 200 BY
STATE OF ILLINOIS
F.A.S. RT. 2245 - SECT. 22B-1D
F.A. PROJECT:
LOADING MS18
STR. NO. 006-0083

NAME PLATES
See Std. 515001.

LOADING MS18

Future Wearing Surface not allowed.
DESIGN SPECIFICATIONS
1996 AASHTO with 1997 and 1998 Interims
1995 Seismic Retrofitting Guidelines for
Highway Bridges FHWA/RD-94/052

DESIGN STRESSES

Existing Structure
 $f_c = 10$ MPa
 $f_s = 140$ MPa (reinforcement)
 $f_y = 250$ MPa (structural steel)
 $v = 520$ kPa (footings)

New Construction
 $f_y = 400$ MPa (reinforcement)
 $f'_s = 24$ MPa
 $f_y = 250$ MPa (structural steel AASHTO M 270M, grade 250)

SEISMIC DATA

Seismic Performance Category (SPC) = A
Bedrock Acceleration Coefficient (A) = 0.038g
Site Coefficient (S) = 1.2

TOTAL BILL OF MATERIAL

ITEM	UNIT	SUPER	SUB	TOTAL
Removal of Existing Concrete Deck	Each	1		1
Floor Drains	Each	34		34
Elastomeric Bearing Assembly, Type II	Each	12		12
Stud Shear Connectors	Each	2382		2382
Jack and Remove Existing Bearings	Each	12		12
Name Plates	Each	1		1
* Wire Enclosed Riprap, Class A4	m ²		1297	1297
Stone Riprap, Class A5	m ²		1014	1014
Filter Fabric for use with Riprap	m ²		1014	1014
** Protective Coat	m ²	1212		1212
Concrete Removal	m ³		23.8	23.8
Structure Excavation	m ³		56	56
Neoprene Expansion Joint, 50 mm	m	22.0		22.0
Concrete Structures	m ³		28.7	28.7
Concrete Superstructure	m ³	286.0		286.0
Bridge Deck Grooving	m ²	930		930
Furnishing and Erecting Structural Steel	kg	2360		2360
Structural Steel Removal	kg	1410		1410
Reinforcement Bars, Epoxy Coated	kg	42090	2660	44750
Temporary Sheet Piling	m ²		45.5	45.5
Bar Splicers	Each	898		898
Drainage Scuppers	Each	2		2
Quarry Run Granular Embankment	m ³		103	103

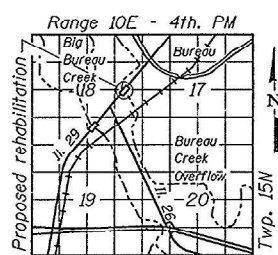

LOCATION SKETCH

GENERAL PLAN & ELEVATION
ILLINOIS ROUTE 26 AND 29 OVER
BIG BUREAU CREEK OVERFLOW
F.A.S. ROUTE 2245 - SECTION 22B-1D
BUREAU COUNTY
STATION 5+955.600
STRUCTURE NO. 006-0083

ROUTE NO.	SECTION	COUNTY	TOTAL SHEETS	SHEET NO.	SHEET NO. 12
F.A.S. 2245	22B-1D	BUREAU	66	22	26 SHEETS
FED. ROAD DIST. NO. 7	ILLINOIS	FED. AID PROJECT-			

FOR INFORMATION ONLY

* Dimension as required by Pipe Clamp

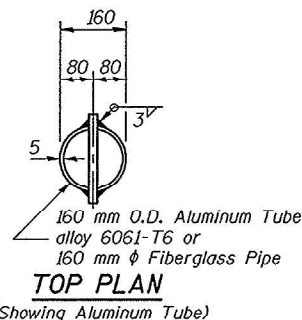
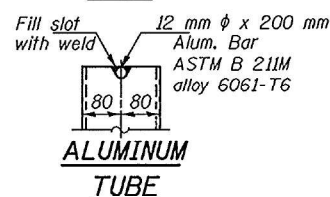
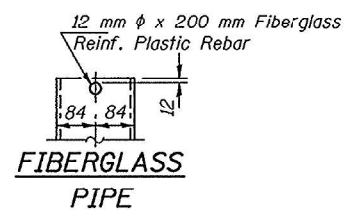
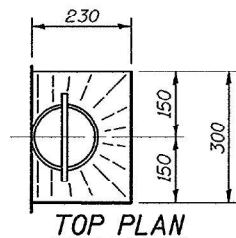
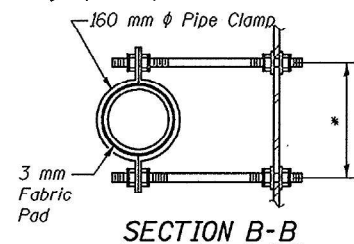

Hatched area to be poured after superstructure forms have been removed. Quantity of concrete included with Concrete Superstructure

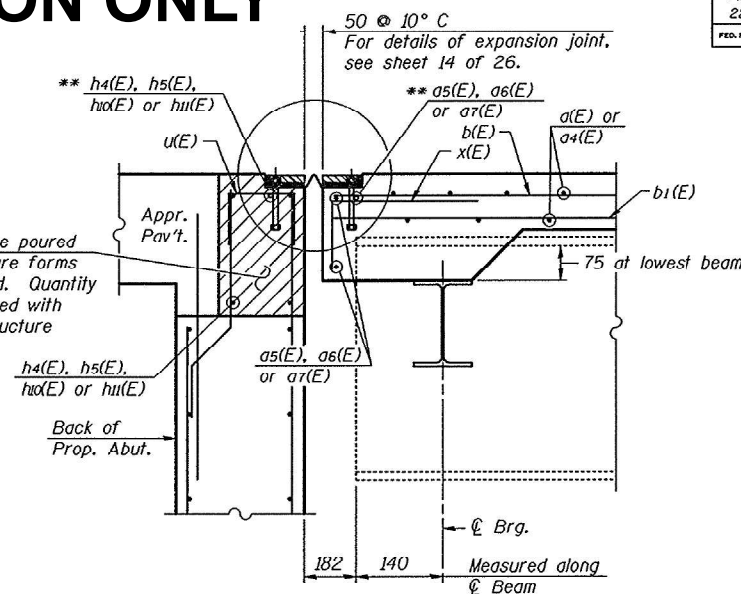

** Place bars in back of anchor bolts as shown if required to maintain 25 mm cl. (+0-3 mm). Anchor bolts should be tied to these bars.

SUPERSTRUCTURE BILL OF MATERIAL

Bar	No.	Size	Length (m)	Shape
a(E)	890	#15	5.19	—
a1(E)	439	#15	0.95	—
a2(E)	518	#20	1.20	—
a3(E)	439	#15	0.73	—
a4(E)	890	#15	6.05	—
a5(E)	2	#15	5.83	—
a6(E)	4	#15	6.27	—
a7(E)	2	#15	5.38	—
a8(E)	936	#15	0.87	—
a9(E)	16	#15	0.60	—
a10(E)	4	#15	2.03	—
b(E)	410	#15	9.75	—
b1(E)	279	#15	10.77	—
b2(E)	39	#20	11.47	—
b3(E)	39	#20	12.57	—
b4(E)	39	#20	12.39	—
d(E)	1300	#15	0.91	—
d1(E)	678	#15	0.80	—
d2(E)	622	#15	1.34	—
e(E)	96	#15	4.24	—
e1(E)	64	#15	3.20	—
e2(E)	96	#15	4.74	—
e3(E)	32	#15	3.34	—
e4(E)	16	#25	9.10	—
e5(E)	16	#25	3.20	—
e6(E)	24	#25	7.10	—
e7(E)	8	#25	3.34	—
e8(E)	16	#15	9.02	—
e9(E)	24	#15	6.98	—
x(E)	73	#15	1.28	—
Reinforcement Bars, Epoxy Coated	kg	42,090		
Concrete Superstructure	m ³	286.0		

Reinforcement bars designated (E) shall be epoxy coated.
Bars indicated thus 34 x 11-#15 etc. indicates 34 lines of bars with 11 lengths per line.

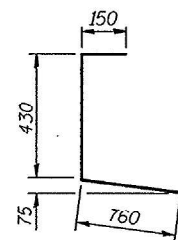
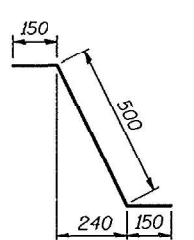
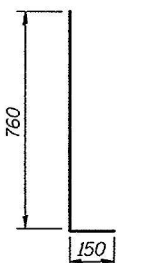
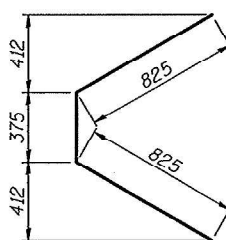
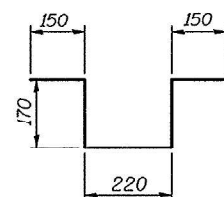
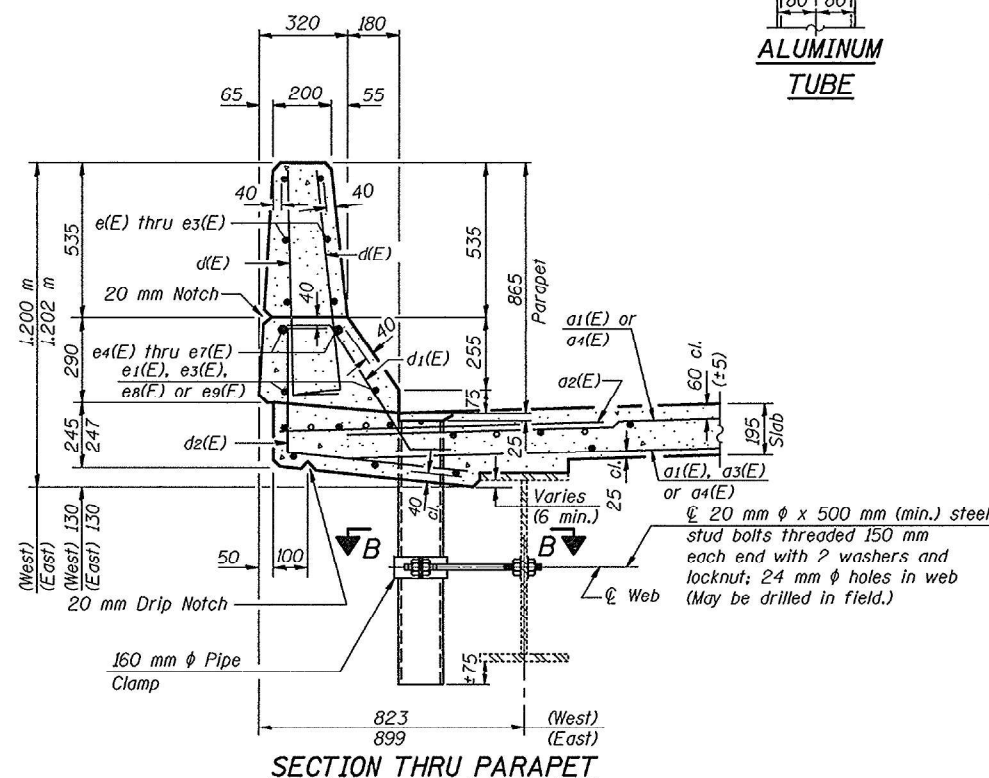

SECTION C-C

*** a8(E) bars shall be required at any other locations where fillet heights exceed 150 mm. Additional a8(E) bars may be required.

Notes:
Floor Drains need not be painted.
Fiberglass pipe shall conform to ASTM D 2996, with short-time rupture strength hoop tensile stress of 200 MPa minimum. The surface of the fiberglass pipe shall be free of bond inhibiting agents.

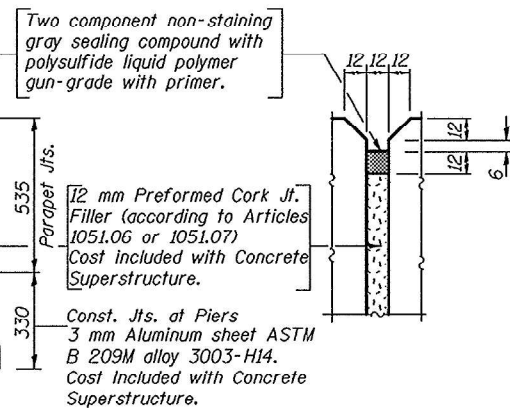
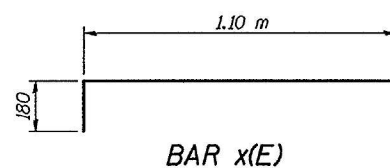

PARAPET JOINT DETAILS

DESIGNED	E.J.C.
CHECKED	C.M.E.
DRAWN	M.B.M.
CHECKED	E.J.C. / C.M.E.

November 18, 1999
EXAMINED *Thomas J. Donagale*
PASSED *Ralph E. Anderson*

MODEL: SHT PLAN
FILE NAME: I:\2022\22069.02\DOT D3 - PTB_205-023 - 1\02 - Bureau County 66N53\CADData\CADsheets\Sheet Borders\66N53_Sheet Borders.dgn



USER NAME = msulheard
DESIGNED -
DRAWN -
CHECKED -
DATE -

DESIGNED -
DRAWN -
CHECKED -
DATE -

REVISED -
REVISED -
REVISED -
REVISED -

STATE OF ILLINOIS
DEPARTMENT OF TRANSPORTATION

EXISTING STRUCTURE PLANS - FOR INFORMATION ONLY
STRUCTURE NO. 006-0083

SCALE: SHEET 2 OF 2 SHEETS STA. TO STA.

F.A.S. RTE.	SECTION	COUNTY	TOTAL SHEETS	SHEET NO.
1252	(22B-1)BRR	BUREAU	24	24
CONTRACT NO. 66N53			ILLINOIS FED. AID PROJECT	