

STATE OF ILLINOIS  
DEPARTMENT OF TRANSPORTATION

F.A.P. RTE.	SECTION	COUNTY	TOTAL SHEETS	SHEET NO.
855/328	D9 LIGHTING CONTROLLER 2019-1	WHITE	6	1
ILLINOIS			CONTRACT NO. 78690	

FOR INDEX OF SHEETS, SEE SHEET NO. 2  
FOR SUMMARY OF QUANTITIES, SEE SHEET NO. 3

**PROPOSED  
HIGHWAY PLANS**

FAP ROUTE 855 (IL 14)/FAP ROUTE 328 (US 45)  
SECTION: D9 LIGHTING CONTROLLER 2019-1

**TRAFFIC DATA**

APPROACH	ADT	% TRUCKS
IL 14 W. OF US 45	2000	13.0
IL 14 E. OF US 45	2900	8.6
US 45 N. OF IL 14	2950	12.7
US 45 S. OF IL 14	1600	16.3

**LIGHTING CONTROLLER  
WHITE COUNTY**

C-99-117-18

**TOWNSHIP**

ENFIELD

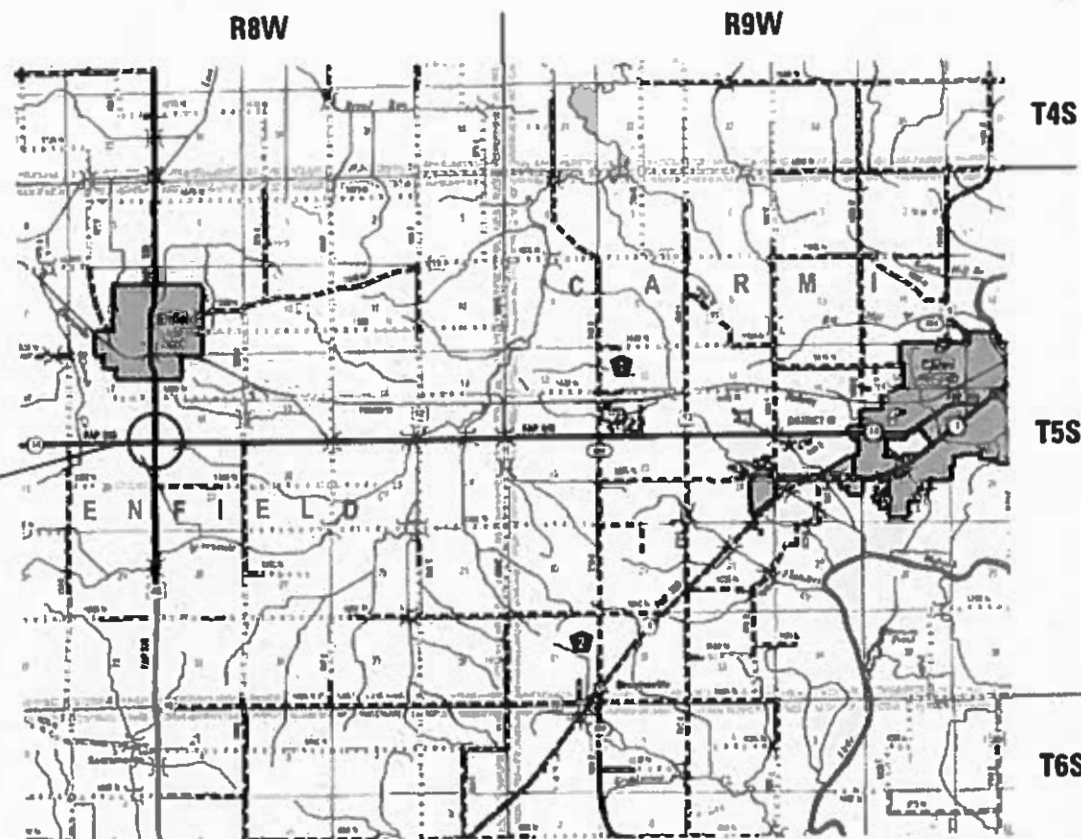

PROPOSED IMPROVEMENT  
IL 14 & US 45 INTERSECTION

POSTED SPEED : 55 MPH

J.U.L.I.E.  
JOINT UTILITY LOCATION INFORMATION FOR EXCAVATION  
1-800-892-0123  
OR 811

PROJECT ENGINEER: SUSAN POE  
PROJECT DESIGNER: DYLAN WHITE

CONTRACT NO. 78690

D-99-081-18



STATE OF ILLINOIS  
DEPARTMENT OF TRANSPORTATION

SUBMITTED Jan 9 20 19  
Keith Robertson  
REGION FIVE ENGINEER

March 22 20 19  
EA. ETK  
ENGINEER OF DESIGN AND ENVIRONMENT

March 22 20 19  
Paul P. [Signature]  
DIRECTOR OF HIGHWAYS PROJECT IMPLEMENTATION

PRINTED BY THE AUTHORITY  
OF THE STATE OF ILLINOIS



# SUMMARY OF QUANTITIES

COUNTY:	COUNTY:	WHITE
ROUTE:	ROUTE:	IL 14 / US 45
FUNDING:	FUNDING:	100% STATE
LOCATION:	LOCATION:	RURAL









CODE NUMBER	ITEM DESCRIPTION	UNIT	TOTAL QUANTITY	0021
67100100	MOBILIZATION	L SUM	1	1
70100450	TRAFFIC CONTROL AND PROTECTION, STANDARD 701201	L SUM	1	1
80500100	SERVICE INSTALLATION, TYPE A	EACH	1	1
81028350	UNDERGROUND CONDUIT, PVC, 2" DIA.	FOOT	10	10
81702450	ELECTRIC CABLE IN CONDUIT, 600V (XLP-TYPE USE) 3-1/C NO. 10	FOOT	61	61
82110008	LUMINAIRE, LED, ROADWAY, OUTPUT DESIGNATION H	EACH	2	2
82500300	LIGHTING CONTROLLER, POLE MOUNTED, 240VOLT, 30AMP	EACH	1	1
87301225	ELECTRIC CABLE IN CONDUIT, SIGNAL NO. 14 3C	FOOT	91	91
87301900	ELECTRIC CABLE IN CONDUIT, EQUIPMENT GROUNDING CONDUCTOR, NO. 6 1C	FOOT	46	46
87703000	STEEL COMBINATION MAST ARM ASSEMBLY AND POLE 55 FT	EACH	1	1
87800415	CONCRETE FOUNDATION, TYPE E 36-INCH DIAMETER	FOOT	15	15
88040410	SIGNAL HEAD, POLYCARBONATE, LED, 4-FACE, 1-SECTION, MAST ARM MOUNTED	EACH	1	1
89502375	REMOVE EXISTING TRAFFIC SIGNAL EQUIPMENT	EACH	1	1

MODEL: D:\p1\11\11848\BID\NITEG\_ILIinois.ppt\PWIDOT\Documents\DOT\_Offices\District\_9\Projects\78690\CAD\Drawings\78690-Sheets.dgn  
 FILE NAME: 11\11848\BID\NITEG\_ILIinois.ppt\PWIDOT\Documents\DOT\_Offices\District\_9\Projects\78690\CAD\Drawings\78690-Sheets.dgn

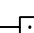
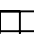
REV. - MS

USER NAME = whitee PLOT SCALE = 100.0000' / in. PLOT DATE = 1/8/2019	DESIGNED - DRAWN - CHECKED - DATE -	REVISED - REVISED - REVISED - REVISED -	<b>STATE OF ILLINOIS DEPARTMENT OF TRANSPORTATION</b>	<b>SUMMARY OF QUANTITIES</b>	SCALE:      SHEET      OF      SHEETS      STA.      TO STA.	F.A.P. RTE.      SECTION      COUNTY      TOTAL SHEETS      SHEET NO. 855/328 D9 LIGHTING CONTROLLER 2019-1      WHITE      6      3 ILLINOIS      FED. AID PROJECT      CONTRACT NO. 78690
--	--	--	---	------------------------------	--	---

**LEGEND**

-  EXISTING FLASHING CONTROLLER
-  EXISTING WOODEN SPANWIRE POLE
-  EXISTING SERVICE INSTALLATION
-  EXISTING UTILITY POLE
-  EXISTING TELECOMMUNICATION PEDESTAL
-  EXISTING UTILITY HANDHOLE
-  PROPOSED WOODEN SERVICE POLE
-  PROPOSED SERVICE INSTALLATION
-  PROPOSED LIGHTING CONTROLLER
-  PROPOSED STEEL COMBINATION MAST ARM AND POLE
-  PROPOSED 4-WAY FLASHING BEACON

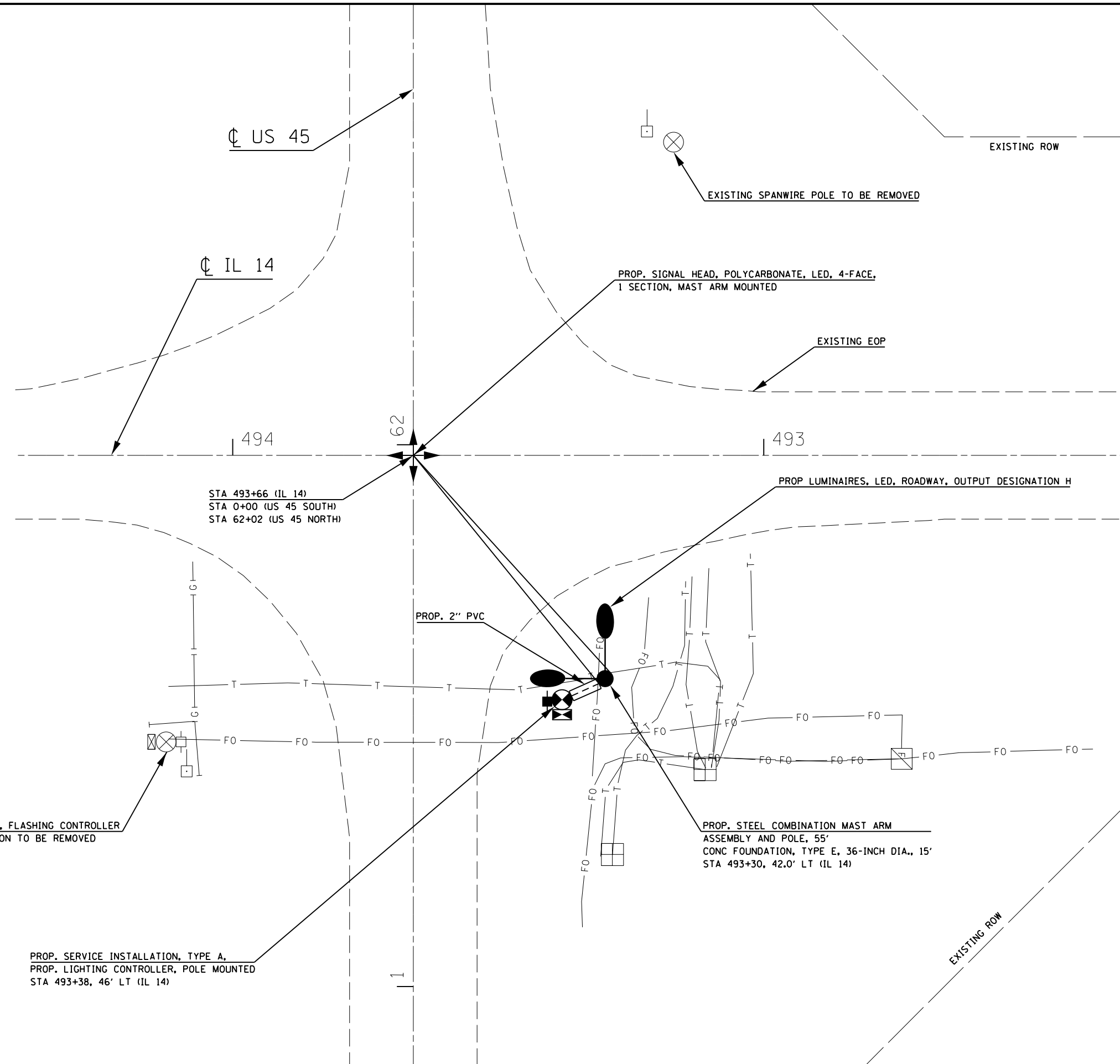
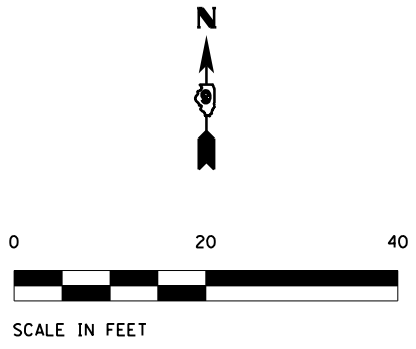

MODEL: Default  
 FILE NAME: P:\highway\com.dal\illinois\p90\DOT\Documents\DOT\_Offices\Datatxt\_9\Projects\78690\CADD\Drawings\0778690-Sheets.dwg  
 PLOT DATE = 3/20/2019

USER NAME = whitee	DESIGNED -	REVISED -
PLOT SCALE = 20.0000 ' / in.	DRAWN -	REVISED -
PLOT DATE = 3/20/2019	CHECKED -	REVISED -
	DATE -	REVISED -

**STATE OF ILLINOIS  
DEPARTMENT OF TRANSPORTATION**

**PROPOSED FOUR WAY FLASHING BEACON INSTALLATION**

F.A.P. RTE. 855/328	SECTION D9 LIGHTING CONTROLLER 2019-1	COUNTY WHITE	TOTAL SHEETS 6	SHEET NO. 4
CONTRACT NO. 78690				
ILLINOIS FED. AID PROJECT				

SCALE: SHEET OF SHEETS STA. TO STA.

# WIRING DIAGRAM

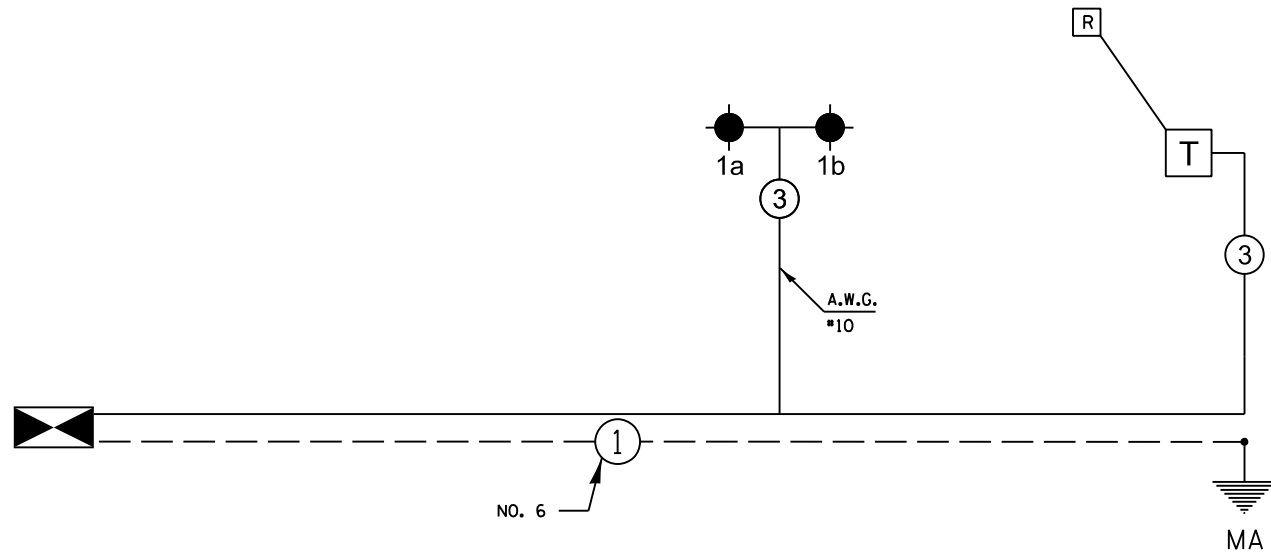

## LEGEND

- CONTROLLER
- TWIN TENON FOR TWO LUMINAIRES
- TERMINAL BLOCK
- 12" TRAFFIC SIGNAL SECTION
- NUMBER IN CIRCLE INDICATES NUMBER OF CONDUCTORS IN THAT CABLE
- MAST ARM

## NOTES

- ALL SIGNAL LENSES SHALL BE 12 INCHES.
- ELECTRIC SERVICE IS SUPPLIED BY AMEREN.
- ALL CABLES SHALL BE A.W.G. #14 UNLESS OTHERWISE NOTED.
- ELECTRIC CABLE DENOTED AS #10, 3/C BEING INSTALLED TO THE COMBINATION MAST ARM POLE SHALL NOT GO THROUGH THE TERMINAL BLOCK BUT SHOULD BE SPLICED IN POLE.

# FLASHING BEACON CLEARANCE

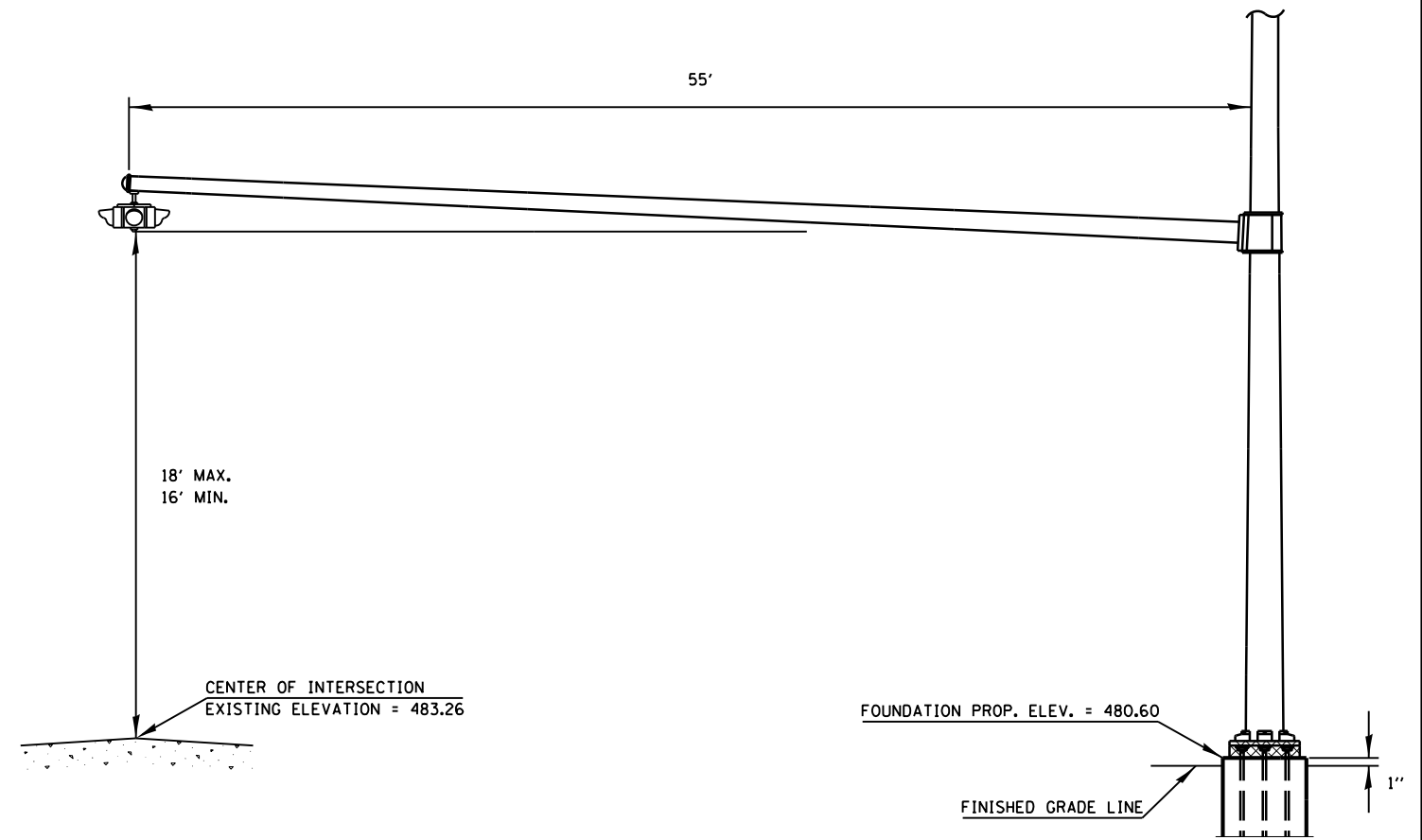

# WIRING DIAGRAM FOR LIGHTING

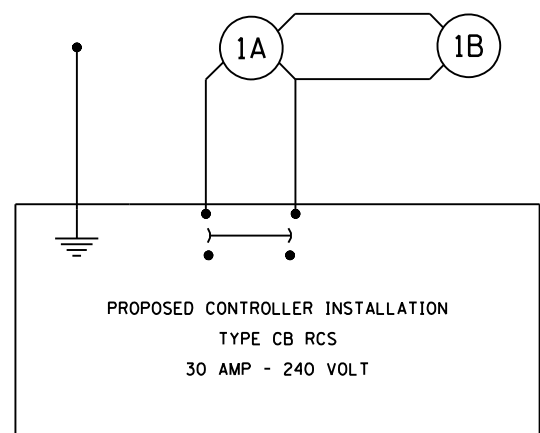

## LEGEND

- NUMBER INDICATES POSITION OF POLE IN WIRING DIAGRAM.
- INDICATES PROPOSED GROUND AT LIGHT POLE AND CONTROL INSTALLATION.
- INDICATES CONTINUOUS GROUND FROM CONTROL INSTALLATION.

MODEL: Default  
 FILE NAME: P:\PROJECTS\78690\Drawings\Sheet 5.dwg  
 PROJECT: 78690\Drawings\Sheet 5.dwg  
 USER: whitee  
 DATE: 1/8/2019

USER NAME = whitee	DESIGNED -	REVISED -
PLOT SCALE = 20.0000 ' / in.	DRAWN -	REVISED -
PLOT DATE = 1/8/2019	CHECKED -	REVISED -
	DATE -	REVISED -

STATE OF ILLINOIS  
DEPARTMENT OF TRANSPORTATION

SCALE:		SHEET OF SHEETS		STA. TO STA.		WIRING DIAGRAMS, FLASHING BEACON CLEARANCE		F.A.P. SECTION COUNTY TOTAL SHEETS SHEET NO. 855/328 D9 LIGHTING CONTROLLER 2019-1 WHITE 6 5	
								CONTRACT NO. 78690	
								ILLINOIS FED. AID PROJECT	

