

Notes:
 See sheet 11 of 26 for Sections C-C & D-D and View E-E.
 $a_6(E)$ thru $a_9(E)$ bar spacings measured along \varnothing Rdwy.
 Bars indicated thus 13 x 5-#5 etc. indicates 13 lines of #5 bars with 3 lengths per line.

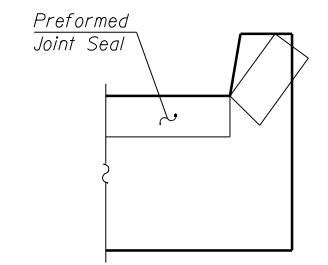
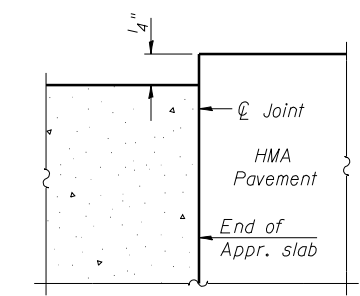
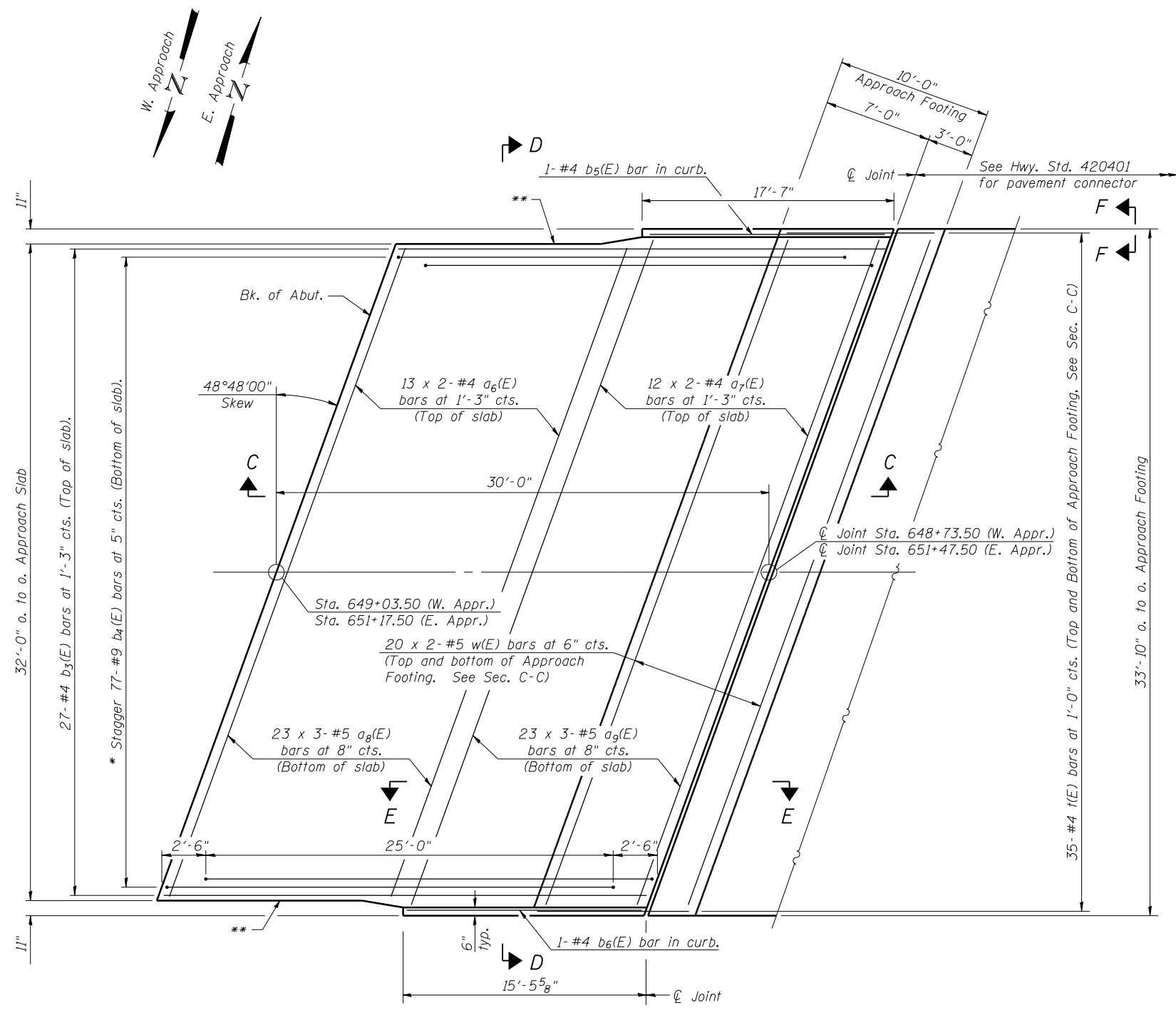

Angle Preformed Joint Seal at 45° at curbs when req'd for drainage.

PLAN

MINIMUM BAR LAP
 #4 bar - 2'-0"
 #5 bar = 2'-6"

* Tilt #9 $b_4(E)$ bars as required to maintain clearance.
 ** Closed cell joint filler according to Article 1051.09 of the Standard Specifications: full depth of slab, full length of parapet. Typ. each parapet.

FILE NAME = \sheet 10 (Appr slab d1)stdgn BERNARDINI LOGANMILLER & ASSOCIATES, INC. 3 OAK DRIVE MARYVILLE, ILLINOIS 62458 PHONE (618) 398-4888 FAX (618) 398-4888	USER NAME = bselbel Illinois Design Firm Number 184,001670	DESIGNED - BB CHECKED - ACS	REVISED - REVISED - REVISED - REVISED -	STATE OF ILLINOIS DEPARTMENT OF TRANSPORTATION	BRIDGE APPROACH SLAB DETAILS STRUCTURE NO. 079-0020	F.A.S. RTE. 858	SECTION 12VB-11	COUNTY RANDOLPH	TOTAL SHEETS 72	SHEET NO. 56
	PLOT SCALE = PLOT DATE = 11/19/58 AM 12/20/2011	DRAWN - WJS CHECKED - CJF	SHEET NO. 10 OF 26 SHEETS			CONTRACT NO. 76409 ILLINOIS FED. AID PROJECT				