

PLAN	SURVEYED EXISTING	BY	DATE
	PLOTTED		
	NOTE BOOK		
	NO.		
	CADD FILE NAME		

PROFILE	SURVEYED EXISTING	BY	DATE
	PLOTTED		
	NOTE BOOK		
	NO.		
	CADD FILE NAME		

MATCH LINE STA 635+00.00

MATCH LINE STA 641+00.00

EXISTING CURVE C-1
 PI STA. = 642+99.99
 $\Delta = 13^\circ 56' 50''$ (LT)
 $D = 2^\circ 00' 00''$
 $R = 2,864.90'$
 $T = 350.43'$
 $L = 697.39'$
 $E = 21.35'$
 P.C. STA = 639+49.56
 P.T. STA = 646+46.95

NOTE:
 SEE GUARDRAIL DETAIL SHEETS FOR EXISTING AND PROPOSED GUARDRAIL.
 FOR RIGHT OF WAY INFORMATION SEE RIGHT OF WAY PLAN SHEETS

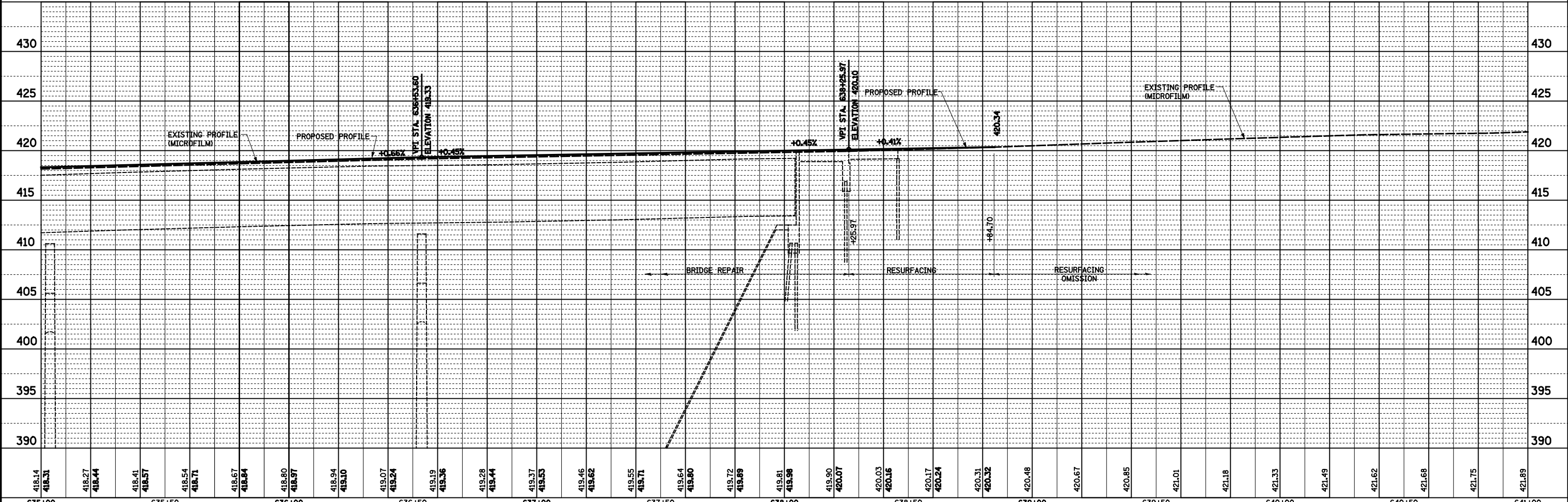
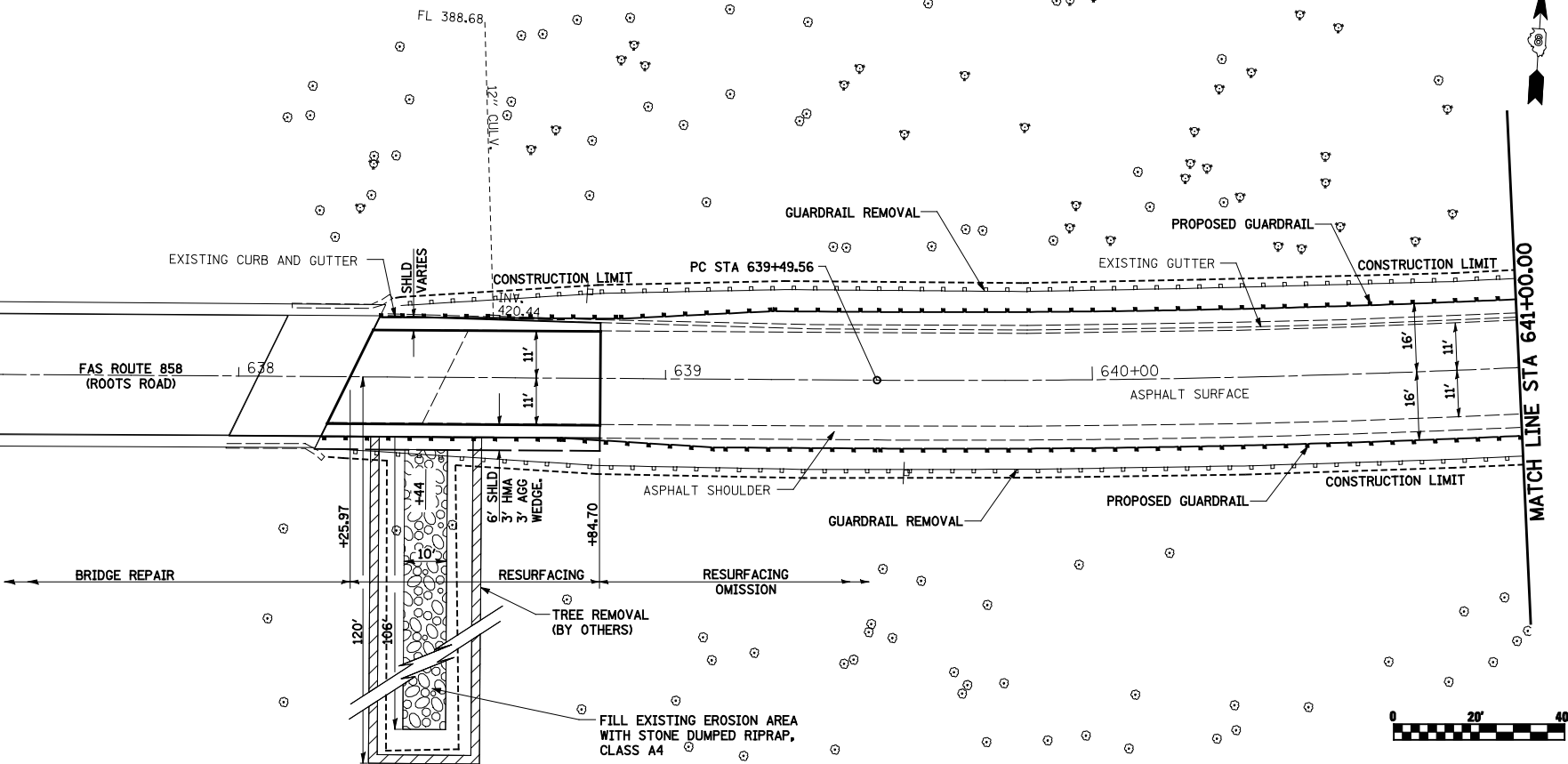

FILE NAME =	USER NAME = Paul	DESIGNED - JWS	REVISED -
SA\Projects\409-0028-DHY Route Rd Final\plans\dgn\CADD	Sheet\0876409-ahf-plan-profile.dgn	DRAWN - PDB	REVISED -
	PLOT SCALE = 40.0000' / IN.	CHECKED - BRM	REVISED -
	PLOT DATE = 12/21/2011	DATE - 3-23-11	REVISED -

**STATE OF ILLINOIS
 DEPARTMENT OF TRANSPORTATION**

PLAN AND PROFILE

SCALE: 1"=20' SHEET NO. 4 OF 6 SHEETS STA. 635+00.00 TO STA. 641+00.00

F.A.S. RTE.	SECTION	COUNTY	TOTAL SHEETS	SHEET NO.
858	12VB-II	RANDOLPH	72	12
CONTRACT NO. 76409				
FED. ROAD DIST. NO. ILLINOIS FED. AID PROJECT				