

04-26-13 LETTING ITEM 207

STATE OF ILLINOIS
DEPARTMENT OF TRANSPORTATION
DIVISION OF HIGHWAYS

**PROPOSED
CONTRACT MAINTENANCE**

F.A.I. ROUTE 72 & 172 (I 72 & I 172)
SECTION (75-1) I-2, (75-2) I-1, (75-3) I
PROJECT PATCHING
TYPE of IMPROVEMENT
ADAMS & PIKE COUNTY

C-96-079-12

FOR INDEX OF SHEETS, SEE SHEET NO. 2

F.A.I. RTE.	SECTION	COUNTY	TOTAL SHEETS	SHEET NO.
72	*	PIKE-ADAMS	7	1
ILLINOIS CONTRACT NO. 72F61				

• (75-1)-2, (75-2)-1, (75-3)-1

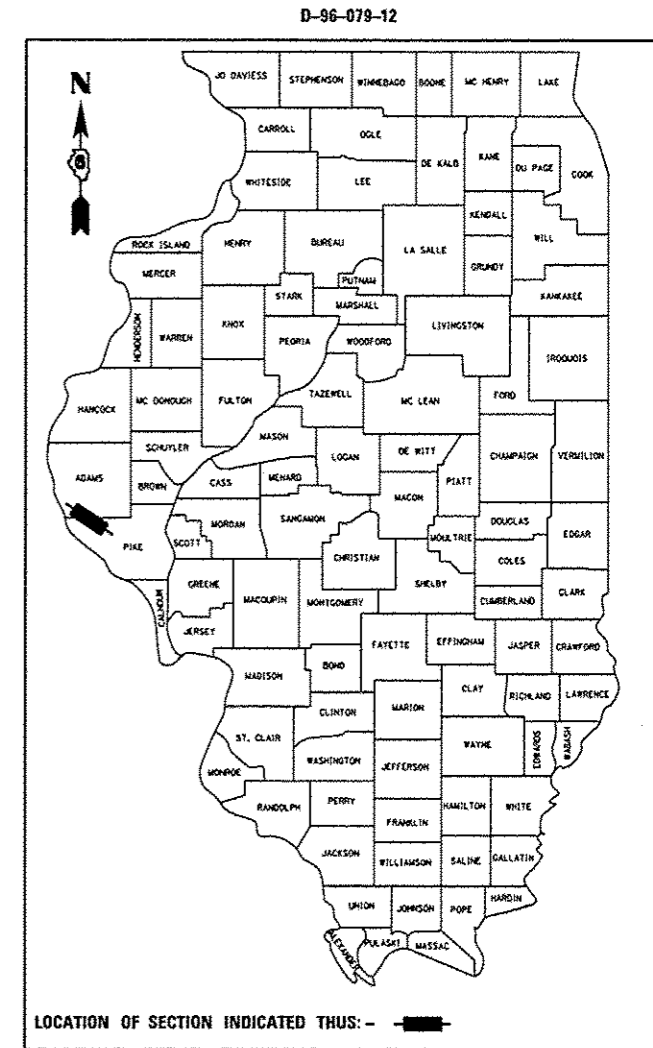

ADT: 6300 (2011)

STATE OF ILLINOIS
DEPARTMENT OF TRANSPORTATION
DIVISION OF HIGHWAYS

SUBMITTED December 19 2012
Ryan Z Ombrelli
DEPUTY DIRECTOR OF HIGHWAYS, REGION ENGINEER

Feb 1 2013
John D. Baranzollo PE
ENGINEER OF DESIGN AND ENVIRONMENT

Feb 1 2013
Chris Osborn PE
DIRECTOR OF HIGHWAYS, CHIEF ENGINEER

PRINTED BY THE AUTHORITY
OF THE STATE OF ILLINOIS

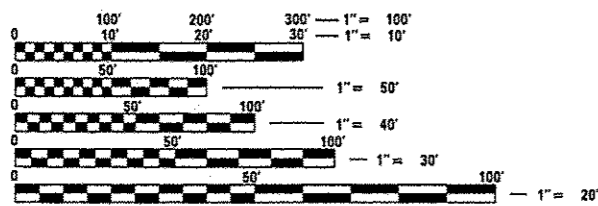
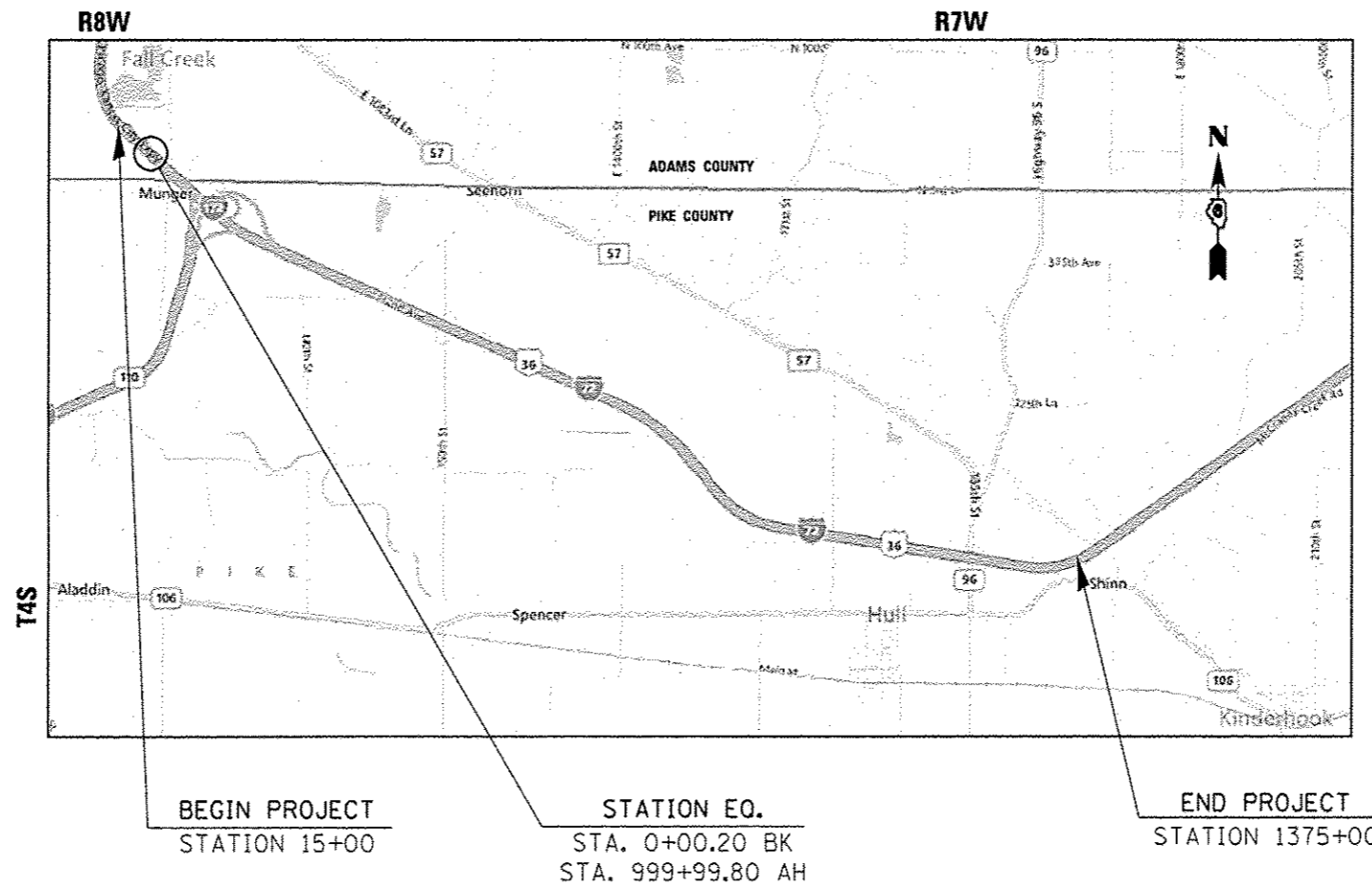

FULL SIZE PLANS HAVE BEEN PREPARED USING STANDARD ENGINEERING SCALES. REDUCED SIZED PLANS WILL NOT CONFORM TO STANDARD SCALES. IN MAKING MEASUREMENTS ON REDUCED PLANS, THE ABOVE SCALES MAY BE USED.

J.U.L.I.E.
JOINT UTILITY LOCATION INFORMATION FOR EXCAVATION
1-800-892-0123
OR 811

PLAN AND CONTRACT TECHNICIAN
TIM SHARP (217) 782-7743
DAVE SHAH
CONTRACT NO. 72F61

NET LENGTH = 3,751.20 FT. = 7.105 MILE

INDEX OF SHEETS

SHEET NO.	DESCRIPTION
1.	COVER SHEET
2.	INDEX OF SHEETS, STANDARDS, GENERAL NOTES & SIGNATURE
3-4.	SUMMARY OF QUANTITIES
5.	SCHEDULE OF QUANTITIES
6.	PROJECT LOCATION MAP
7.	PROJECT TYPICAL SECTIONS

STANDARDS

STANDARD NO.	DESCRIPTION
000001-06	STANDARD SYMBOLS, ABBREVIATIONS, AND PATTERNS
442001-04	CLASS A PATCHES
701101-03	OFF-RD OPERATIONS, MULTILANE, 15' TO 24" FROM PAVEMENT EDGE
701106-02	OFF-RD OPERATIONS, MULTILANE, MORE THAN 15' AWAY
701400-06	APPROACH TO LANE CLOSURE, FREEWAY/EXPRESSWAY
701401-07	LANE CLOSURE, FREEWAY/EXPRESSWAY
701411-08	LANE CLOSURE, MULTILANE AT ENTRANCE OR EXIT RAMP, FOR SPEEDS > 45 MPH
701446-04	TWO LANE CLOSURE, FREEWAY/EXPRESSWAY
701901-02	TRAFFIC CONTROL DEVICES
701406-07	

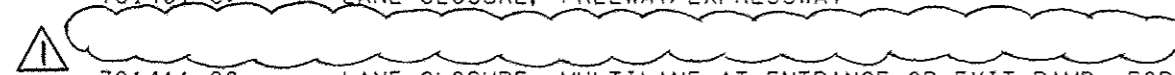

**STATE OF ILLINOIS
DEPARTMENT OF TRANSPORTATION
DIVISION OF HIGHWAYS
DISTRICT 6**

EXAMINED 11 / 20 20 12
Bill Dwyer
ENGINEER OF OPERATIONS

EXAMINED OCT 25 20 12
Jim [Signature]
ENGINEER OF PROJECT IMPLEMENTATION

EXAMINED November 2 20 12
Laura R. Macovich
ENGINEER OF PROGRAM DEVELOPMENT

MIXTURE REQUIREMENTS		
THE FOLLOWING MIXTURE REQUIREMENTS ARE APPLICABLE FOR THIS PROJECT		
LOCATION:	SHOULDER REPAIR	STRUCTURE REPAIR
MIXTURE USE(S):	LOWER LIFT	TOP LIFT
AC/PG:	PG 64-22	PG 64-22
DESIGN AIR VOIDS:	4.0% @ NS0	4.0% @ NS0
MIXTURE COMPOSITION:	IL 19.0	IL 9.5
FRICTION AGGREGATE:	N/A	MIX "C"

⚠ REVISSED 2-19-13

* (75-11)-2,(75-21)-1,(75-31)

CODE NO.	ITEM	UNIT	TOTAL QUANTITY	CONSTR. CODE	CONSTR. CODE
				ADAMS	PIKE
				ROADWAY	ROADWAY
				0005	0005
				S.N.	S.N.
44200541	CLASS A PATCHES, TYPE II, 9 INCH	SQ YD	386.9	231.5	155.4
44200545	CLASS A PATCHES, TYPE III, 9 INCH	SQ YD	139.3	74	65.3
44200547	CLASS A PATCHES, TYPE IV, 9 INCH	SQ YD	623.8	594.5	29.3
44213000	PATCHING REINFORCEMENT	SQ YD	1149.9	899.9	250
44213200	SAW CUTS	FOOT	5304	3743	1561
44213204	TIE BARS 3/4"	EACH	276	264	12
67100100	MOBILIZATION	L SUM	1	0.7	0.3
70100420	TRAFFIC CONTROL AND PROTECTION, STANDARD 701411	EACH	2	0	2
70100700	TRAFFIC CONTROL AND PROTECTION, STANDARD 701406	L SUM	1	0.7	0.3
70100800	TRAFFIC CONTROL AND PROTECTION, STANDARD 701401	L SUM	1	0.7	0.3
70100815	TRAFFIC CONTROL AND PROTECTION, STANDARD 701446	L SUM	1	0.7	0.3
70103815	TRAFFIC CONTROL SURVEILLANCE	CAL DA	15	11	4
70106800	CHANGEABLE MESSAGE SIGN	CAL MO	1	0.7	0.3
X4820110	HOT-MIX ASPHALT SHOULDER REMOVAL AND REPLACEMENT (SPECIAL)	SQ YD	100	90	10

FILE NAME * c:\pwork\pwork\shahdm\0312101\06xxxx	USER NAME * shahdm shahdm.dgn	DESIGNED - _____ DRAWN - DMS	REVISED - _____ REVISED - _____	STATE OF ILLINOIS DEPARTMENT OF TRANSPORTATION	SUMMARY OF QUANTITIES				F.A.I. RTE. 72	SECTION *	COUNTY PIKE-ADAMS	TOTAL SHEETS 7	SHEET NO. 3
Default	PLOT SCALE * 40,0000' / in.	CHECKED - _____	REVISED - _____		SCALE: _____	SHEET _____ OF _____ SHEETS	STA. _____	TO STA. _____	CONTRACT NO. 72F61				
	PLOT DATE * Apr-02-2013 11:02:52AM	DATE - _____	REVISED - _____		ILLINOIS FED. AID PROJECT								

LOCATION	PATCHING SCHEDULE, CLASS A PATCHES (SQ YD)										SAW CUTS		TIE BARS		PATCHING REINFORCEMENT	
	LENGTH (FOOT)		FOOT	SQ YD	TY II	TY III	TY IV	TY II	TY III	TY IV	(FOOT)		(EACH)		(SQ YD)	
	PASSING	DRIVING	WIDTH	FULL DEPTH	PASSING			DRIVING			PASSING	DRIVING	PASSING	DRIVING	PASSING	DRIVING
ADAMS COUNTY																
13+02	12.00		12.00	16.0		16.0					72.0				16.0	
12+74	5.00		12.00	6.7	6.7						58.0				6.7	
12+44		8.00	12.00	10.7			10.7					64.0				10.7
11+13		8.00	12.00	10.7			10.7					64.0				10.7
11+01	15.00		12.00	20.0		20.0					78.0				20.0	
10+50		5.00	12.00	6.7			6.7					58.0				6.7
8+48	48.00		12.00	64.0		64.0					144.0		25		64.0	
7+40	5.00		12.00	6.7	6.7						58.0				6.7	
7+07	8.00		12.00	10.7	10.7						64.0				10.7	
6+83		25.00	12.00	33.3						33.3		98.0		13		33.3
6+83	25.00		12.00	33.3		33.3					98.0		13		33.3	
6+31	5.00		12.00	6.7	6.7						58.0				6.7	
6+15	10.00		12.00	13.3	13.3						68.0				13.3	
2+06		32.00	12.00	42.7						42.7		112.0		17		42.7
1+74		5.00	12.00	6.7			6.7					58.0				6.7
PIKE COUNTY																
1008+11	5.00		12.00	6.7	6.7						58.0				6.7	
1015+06	6.00		12.00	8.0	8.0						60.0				8.0	
1078+64		5.00	12.00	6.7			6.7					58.0				6.7
1140+25		5.00	12.00	6.7			6.7					58.0				6.7
1140+88		5.00	12.00	6.7			6.7					58.0				6.7
1155+78		5.00	12.00	6.7			6.7					58.0				6.7
1208+66		5.00	12.00	6.7			6.7					58.0				6.7
1225+49		5.00	12.00	6.7			6.7					58.0				6.7
1227+39		5.00	12.00	6.7			6.7					58.0				6.7
1230+83		5.00	12.00	6.7			6.7					58.0				6.7
1230+83	5.00		12.00	6.7	6.7						58.0				6.7	
1237+05	5.00		12.00	6.7	6.7						58.0				6.7	
1240+18		5.00	12.00	6.7			6.7					58.0				6.7
1240+36		5.00	12.00	6.7			6.7					58.0				6.7
1240+70		5.00	12.00	6.7			6.7					58.0				6.7
1242+30		5.00	12.00	6.7			6.7					58.0				6.7
1266+96		5.00	12.00	6.7			6.7					58.0				6.7
1335+62		22.00	12.00	29.3						29.3		92.0		12		29.3
1335+62	18.00		12.00	24.0		24.0					84.0				24.0	
1359+46		8.50	12.00	11.3			11.3					65.0				11.3
1389+32		18.00	12.00	24.0					24.0			84.0				24.0
1390+79		5.00	12.00	6.7			6.7					58.0				6.7
1391+98		5.00	12.00	6.7	6.7		6.7					58.0			6.7	6.7
23+10 **		5.00	16.00	8.9			8.9					58.0				8.9
ADAMS TOTAL																
				288.2	44.1	36.0	97.3	34.8	0.0	76.0	698.0	454.0	38.0	30.0	177.4	110.8
PIKE TOTAL																
				232.7	34.7	24.0	0.0	120.7	24.0	29.3	318.0	1169.0	0.0	12.0	58.7	174.0

** ENTRANCE OF RAMP

FILE NAME *	USER NAME * shhdn	DESIGNED -	REVISED -	STATE OF ILLINOIS DEPARTMENT OF TRANSPORTATION	SCHEDULE OF QUANTITIES EASTBOUND				F.A.I. RTE.	SECTION	COUNTY	TOTAL SHEETS	SHEET NO.
c:\pwork\pwork\shhdn\08312181\06\...	shh-schedule.dgn	DRAWN -	REVISED -						72	*	PIKE-ADAMS	7	4
Default	PLOT SCALE * 48.0000 "/>												
	PLOT DATE * Apr-02-2013 11:05:36AM	DATE -	REVISED -		SCALE:	SHEET	OF	SHEETS	STA.	TO	STA.	ILLINOIS FED. AID PROJECT	

				PATCHING SCHEDULE, CLASS A PATCHES (SQ YD)						SAW CUTS		TIE BARS		PATCHING REINFORCEMENT		
LOCATION	LENGTH (FOOT)		FOOT	SQ YD	TY II	TY III	TY IV	TY II	TY III	TY IV	(FOOT)		(EACH)		(SQ YD)	
I-72, WESTBOUND	PASSING	DRIVING	WIDTH	FULL DEPTH	PASSING			DRIVING			PASSING	DRIVING	PASSING	DRIVING	PASSING	DRIVING
PIKE COUNTY																
1358+95		89.00	6.00	59.3						59.3		226.0		45		59.3
1358+90	100.00		12.00	133.3			133.3				248.0		51		133.3	
1357+00	46.00		6.00	30.7			30.7				140.0		24		30.7	
1356+10	25.00		6.00	16.7		16.7					98.0		13		16.7	
1332+58		7.00	12.00	9.3				9.3				62.0				9.3
1331+77 **		20.50	16.00	36.4						36.4		89.0		11		36.4
1310+35		5.00	12.00	6.7				6.7				58.0				6.7
1307+76		5.00	12.00	6.7				6.7				58.0				6.7
1280+81		5.00	12.00	6.7				6.7				58.0				6.7
1242+91		5.00	12.00	6.7				6.7				58.0				6.7
1242+22		5.00	12.00	6.7				6.7				58.0				6.7
1241+20		5.00	12.00	6.7				6.7				58.0				6.7
1231+41		5.00	12.00	6.7				6.7				58.0				6.7
1231+41	5.00		12.00	6.7	6.7						58.0				6.7	
1220+90		5.00	12.00	6.7				6.7				58.0				6.7
1220+90	5.00		12.00	6.7	6.7						58.0				6.7	
1214+35		5.00	12.00	6.7				6.7				58.0				6.7
1214+35	5.00		12.00	6.7	6.7						58.0				6.7	
1209+90		5.00	12.00	6.7				6.7				58.0				6.7
1209+59		5.00	12.00	6.7				6.7				58.0				6.7
1209+30		5.00	12.00	6.7				6.7				58.0				6.7
1158+65		5.00	12.00	6.7				6.7				58.0				6.7
1135+81		5.00	12.00	6.7				6.7				58.0				6.7
1133+37		5.00	12.00	6.7				6.7				58.0				6.7
1088+54		51.00	12.00	68.0						68.0		150.0		26		68.0
1089+20		5.00	12.00	6.7				6.7				58.0				6.7
1065+78 **		12.00	16.00	21.3					21.3			72.0				21.3
1028+90		7.00	12.00	9.3				9.3				62.0				9.3
1028+21		20.00	12.00	26.7						26.7		88.0				26.7
1027+88		21.00	12.00	28.0						28.0		90.0		11		28.0
1027+80	29.00		12.00	38.7			38.7				106.0		15		38.7	
1027+30	5.00		12.00	6.7	6.7						58.0				6.7	
ADAMS COUNTY																
75+77		13.0	12.00	17.3						17.3		74.0				17.3
ADAMS TOTALS				611.7	26.8	16.7	202.7	125.8	21.3	218.5	824.0	1767.0	103	93	246.2	365.6
PIKE TOTALS				17.3					17.3		74.0				17.3	
ADAMS WESTBOUND TOTAL				611.7	26.8	16.7	202.7	125.8	21.3	218.5	824.0	1767.0	103.0	93.0	246.2	365.6
PIKE WESTBOUND TOTAL				17.3	0.0	0.0	0.0	0.0	17.3	0.0	0.0	74.0	0.0	0.0	0.0	17.3
ADAMS EASTBOUND TOTAL				288.2	44.1	36.0	97.3	34.8	0.0	76.0	698.0	454.0	38.0	30.0	177.4	110.8
PIKE EASTBOUND TOTAL				232.7	34.7	24.0	0.0	120.7	24.0	29.3	318.0	1169.0	0.0	12.0	58.7	174.0
ADAMS TOTAL				899.9	TY II: 231.5	TY III: 74.0	TY IV: 594.5				3743.0		264.0		899.9	
PIKE TOTAL				250.0	TY II: 155.4	TY III: 65.3	TY IV: 29.3				1561.0		12.0		250.0	

** ENTRANCE OF RAMP

FILE NAME * c:\p\work\p\dot\shahn\d0312181\06xxxx	USER NAME * shahn shh-schedule.dgn	DESIGNED - DRAWN -	REVISED - REVISED -	STATE OF ILLINOIS DEPARTMENT OF TRANSPORTATION	SCHEDULE OF QUANTITIES WESTBOUND	F.A.I. RTE. 72	SECTION *	COUNTY PIKE-ADAMS	TOTAL SHEETS 7	SHEET NO. 5
PLOT SCALE * 40.0000 ' / in.	CHECKED -	REVISED -	SCALE:			SHEET OF SHEETS	STA. TO STA.	ILLINOIS FED. AID PROJECT CONTRACT NO. 72F61		



END PROJECT
STA. 1375+00

**STATE OF ILLINOIS
DEPARTMENT OF TRANSPORTATION**

LOCATION MAP

FILE NAME *	USER NAME * ahehdm	DESIGNED -	REVISED -
or\pw\work\p\p\dot\shahdm\0312181\08xxxx	shh-detailed.dgn	DRAWN -	REVISED -
Default	PLOT SCALE * 40.0000 / in.	CHECKED -	REVISED -
	PLOT DATE * Dec-10-2012 08:53:13AM	DATE -	REVISED -

SCALE:		SHEET OF SHEETS		STA.	TO STA.	F.A.I. RTE. 72	SECTION *	COUNTY PIKE-ADAMS	TOTAL SHEETS 6	SHEET NO. 6
ILLINOIS FED. AID PROJECT										

* (75-11)-2,175-211-1,175-311

¢ F.A.I. 72

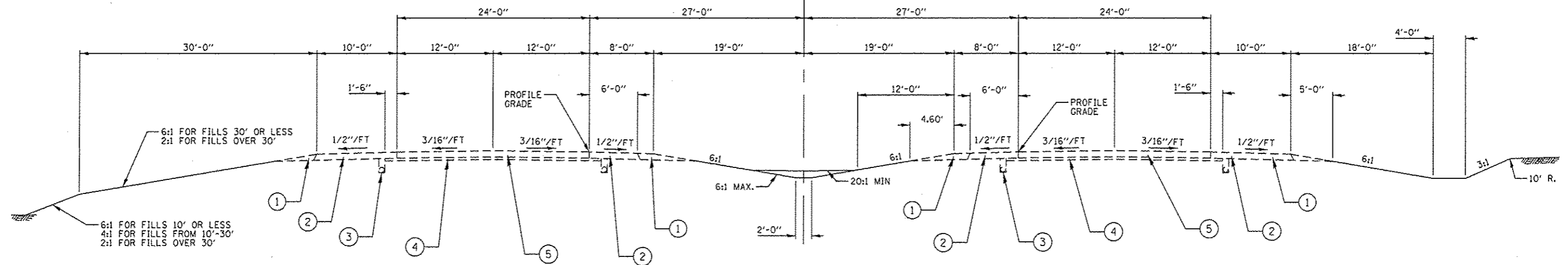

TYPICAL TANGENT SECTION

STA. 0+00.20 TO STA. 19+77.74 (F.A.I. 72 N.W.)
 STA. 48+03.02 TO STA. 76+00.00 (F.A.I. 72 N.W.)
 STA. 999+99.80 TO STA. 1024+61.86 (F.A.I. 72 S.E.)
 STA. 1092+00.00 TO STA. 1192+26.60
 STA. 1228+40.11 TO STA. 1243+82.01
 STA. 1273+64.89 TO STA. 1375+00

OMISSIONS

STA. 1071+59.32 TO 1073+10.68
 STA. 1215+30.54 TO 1220+09.45
 STA. 1232+14.65 TO 1236+27.35

EXISTING NOTES

- SEE STANDARD 2237 FOR ADDITIONAL SHOULDER DETAIL
- LT. 24' P.C. CONC. PAVM'T IS NOW EXISTING FROM STA. 5+00 (N.W.) AHEAD. RT. 24' P.C. CONC. PAVM'T IS EXISTING FROM STA 76+00 (N.W.) AHEAD

¢ F.A.I. 72

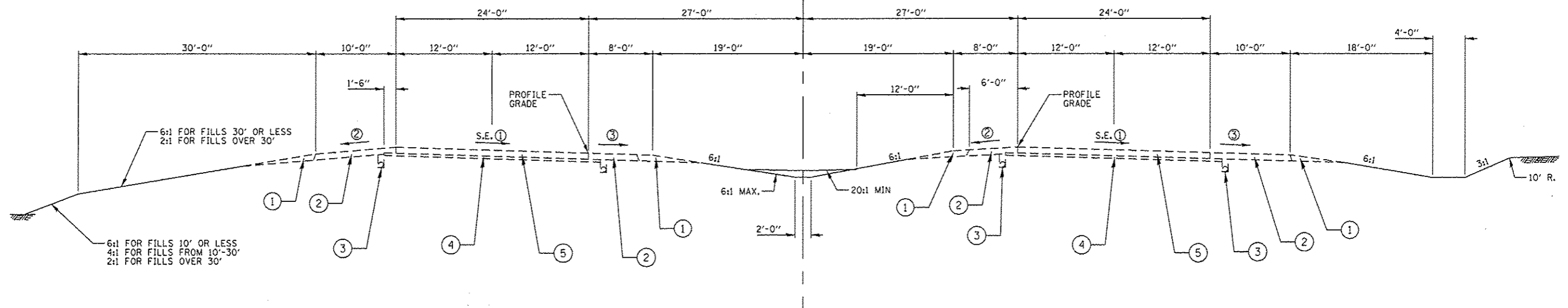

TYPICAL SUPERELEVATED SECTION

STA. 19+77.74 TO STA. 48+03.02 (F.A.I. 72 N.W.)
 STA. 1192+26.60 TO STA. 1228+40.11
 STA. 1243+82.01 TO STA. 1273+64.89
 STA. 1365+32.76 TO STA. 1375+00.00

SUPERELEVATION TABLE (FT./FT.)		
PAVEMENT	SHOULDER	SHOULDER
1	2	3
0.0260	0.0417	0.0417
0.0330	0.0037	0.0471
0.0440	0.0260	0.0440
0.0600	0.0100	0.0600

LEGEND

- 1 EXISTING AGG. SHOULDER, TY B
- 2 EXISTING BIT. SHOULDERS 9"
- 3 EXISTING PIPE UNDERDRAIN, 4"
- 4 EXISTING STABILIZED SUB-BASE, 4"
- 5 EXISTING C.R.P.C CONCRETE PAVEMENT, 9"

STATE OF ILLINOIS
 DEPARTMENT OF TRANSPORTATION

TYPICAL SECTIONS

FILE NAME *	USER NAME * shahdn	DESIGNED -	REVISED -
c:\pwwork\pwwid\shahdn\08312181\08xxxx	shh-typico1.dgn	DRAWN - D.M.S.	REVISED -
Default	PLOT SCALE * N/A	CHECKED -	REVISED -
	PLOT DATE * Dec-18-2012 08:54:52AM	DATE -	REVISED -

SCALE:	SHEET	OF	SHEETS	STA.	TO STA.
--------	-------	----	--------	------	---------

F.A.I. RTE. 72	SECTION *	COUNTY PIKE-ADAMS	TOTAL SHEETS 7	SHEET NO. 7
CONTRACT NO. 72F61				
ILLINOIS FED. AID PROJECT				