

PAVEMENT MARKING LEGEND

- ① PAINT PAVEMENT MARKING - LINE 5"
 - ② MODIFIED URETHANE PAVEMENT MARKING - LINE 5"
 - ③ MODIFIED URETHANE PAVEMENT MARKING - LINE 5" (DOUBLE YELLOW LINES @ 13" CENTERS)
 - ④ MODIFIED URETHANE PAVEMENT MARKING - LINE 8"
 - ⑤ MODIFIED URETHANE PAVEMENT MARKING - LINE 12"
 - ⑥ MODIFIED URETHANE PAVEMENT MARKING - LINE 6"
 - ⑦ PREFORMED PLASTIC PAVEMENT MARKING, TYPE B, INLAID - LINE 24"
 - ⑧ PREFORMED PLASTIC PAVEMENT MARKING, TYPE B, INLAID LETTERS & SYMBOLS
- ▷ RAISED REFLECTIVE PAVEMENT MARKER (ONE-WAY CRYSTAL)
 ◆ RAISED REFLECTIVE PAVEMENT MARKER (TWO-WAY AMBER)
- ⊗-W PAVEMENT MARKING, WHITE
 ⊗-Y PAVEMENT MARKING, YELLOW

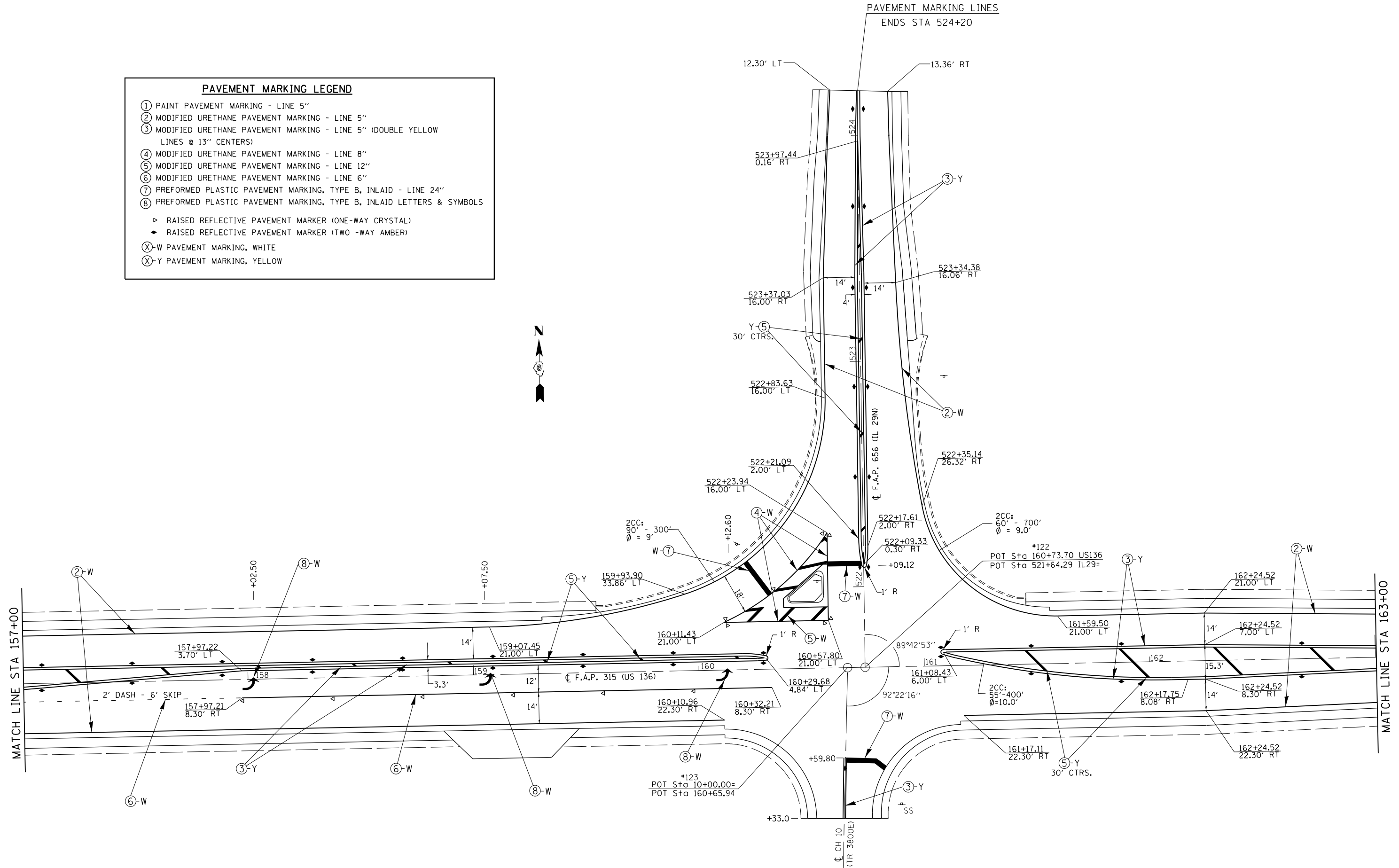

PAVEMENT MARKING LINES
 ENDS STA 524+20



FILE NAME =	USER NAME = sparksgw	DESIGNED - ML	REVISED - RTS
ei:\pw\work\p\dot\sparksgw\10239760\0672E03-sht-pmk.dgn		DRAWN - ML	REVISED -
Default	PLOT SCALE = 40.0000' / in.	CHECKED - RTS	REVISED -
	PLOT DATE = Dec-14-2012 12:01:01PM	DATE -	REVISED -

**STATE OF ILLINOIS
 DEPARTMENT OF TRANSPORTATION**

PAVEMENT MARKING DETAILS

SCALE: SHEET 4 OF 7 SHEETS STA. TO STA.

F.A.P. RTE.	SECTION	COUNTY	TOTAL SHEETS	SHEET NO.
315	(HRS-2, (124)RS-3, (116)RS	MASON	62	52
CONTRACT NO. 72E03				
ILLINOIS FED. AID PROJECT				