

**NOTES:**  
 THE PROPOSED E.O.P. STRIPING IS NOT SHOWN ON THIS PLAN SHEET. SEE THE PROPOSED PAVEMENT MARKING SHEETS AND SCHEDULES FOR MARKING LOCATIONS.  
 THE WIDTH OF PROPOSED HMA SHOULDERS IS VARIABLE, FROM ±8'-6" TO ±10'-0" AT STA. 167+25 TO STA. 247+20, LEFT AND RIGHT. SEE SCHEDULES FOR WIDTH DETAILS.  
 SEE SIDEROAD AND ENTRANCE DETAILS SCHEDULES FOR THEIR PROPOSED IMPROVEMENTS.  
 SEE HIGHWAY STD. 642006 AND THE SCHEDULE OF QUANTITIES FOR THE PLACEMENT OF PROPOSED SHOULDER RUMBLE STRIPS.

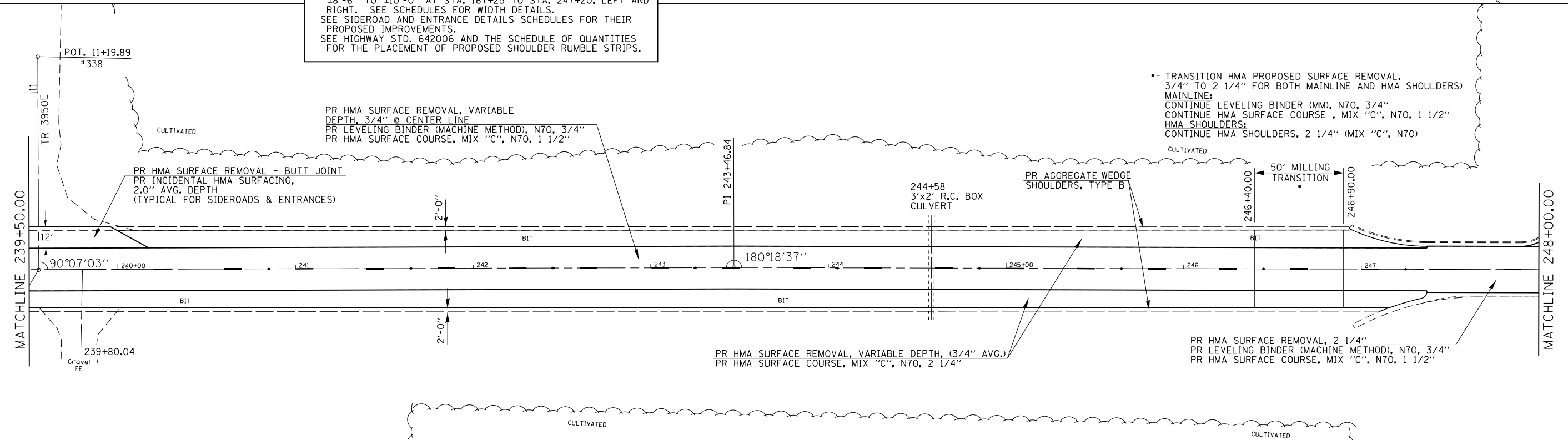

**SCALE:**  
 1"=30' FULL SIZE SHEET  
 1"=60' QUARTER SIZE SHEET

FILE NAME =	USER NAME = sparksgw	DESIGNED - ML	REVISED - RTS
Default	Default	DRAWN - ML	REVISED -
	PLOT SCALE = 60.0000' / in.	CHECKED - RTS	REVISED -
	PLOT DATE = Dec-14-2012 12:00:58PM	DATE -	REVISED -

**STATE OF ILLINOIS  
 DEPARTMENT OF TRANSPORTATION**

**PLAN SHEET**

SCALE: SHEET 15 OF 18 SHEETS STA. TO STA.

F.A.P. RTE.	SECTION	COUNTY	TOTAL SHEETS	SHEET NO.
315	.	MASON	62	45
CONTRACT NO. 72E03				
ILLINOIS FED. AID PROJECT				

•• (HRS-2, (124)RS-3, (116)RS