

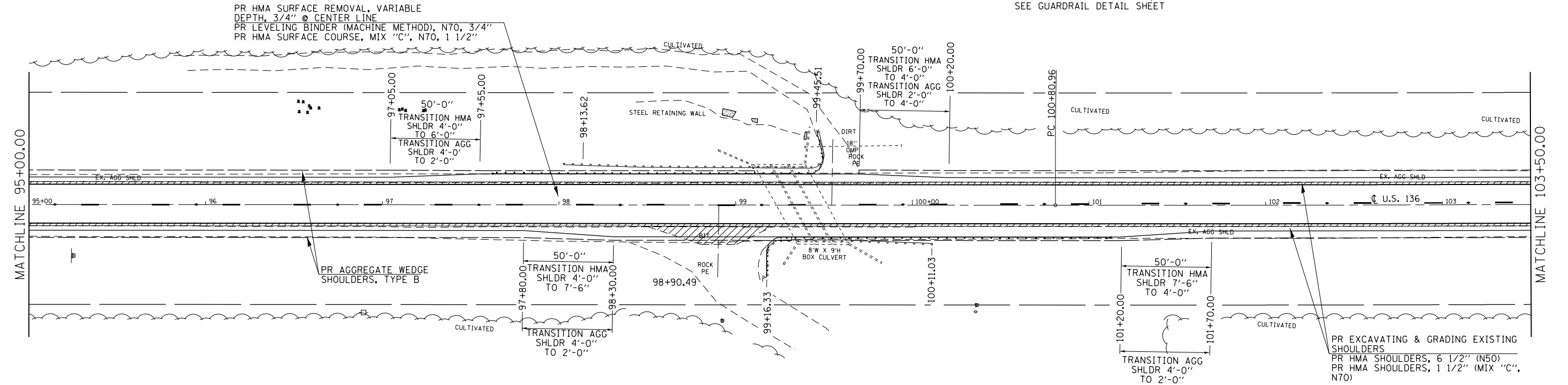

NOTE:
FOR PR GUARDRAIL DETAILS,
SEE GUARDRAIL DETAIL SHEET



NOTES:
THE PROPOSED E.O.P. STRIPING IS NOT SHOWN ON THIS PLAN SHEET. SEE THE PROPOSED PAVEMENT MARKING SHEETS AND SCHEDULES FOR MARKING LOCATIONS.
THE WIDTH OF PROPOSED HMA SHOULDERS IS 4' UNLESS OTHERWISE STATED WITHIN THESE PLANS.
THE WIDTH OF PROPOSED AGGREGATE SHOULDERS IS 4' UNLESS OTHERWISE STATED WITHIN THESE PLANS.
SEE SIDEROAD AND ENTRANCE DETAILS SCHEDULES FOR THEIR PROPOSED IMPROVEMENTS.
SEE HIGHWAY STD. 642006 AND THE SCHEDULE OF QUANTITIES FOR THE PLACEMENT OF PROPOSED SHOULDER RUMBLE STRIPS.

=====
= PROPOSED REMOVAL OF EXISTING HMA SHOULDERS IS INCLUDED IN THE COSTS FOR "EXCAVATING AND GRADING EXISTING SHOULDERS".
REMOVAL WIDTH = 1'-6"
REMOVAL DEPTH = 6 1/2" OR 8" (SEE TYPICAL CROSS SECTIONS AND SCHEDULES FOR SPECIFIED DEPTH LOCATIONS.)

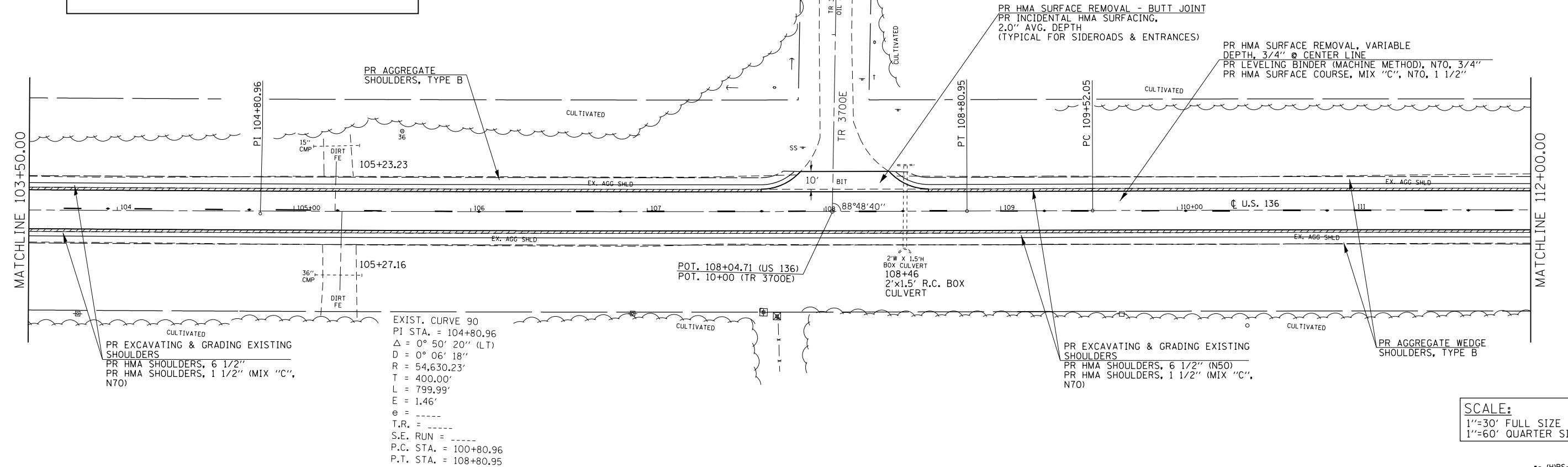

EXIST. CURVE 90
PI STA. = 104+80.96
 $\Delta = 0^\circ 50' 20''$ (LT)
 $D = 0^\circ 06' 18''$
 $R = 54,630.23'$
 $T = 400.00'$
 $L = 799.99'$
 $E = 1.46'$
 $e = \text{---}$
 $T.R. = \text{---}$
 $S.E. \text{ RUN} = \text{---}$
P.C. STA. = 100+80.96
P.T. STA. = 108+80.95

SCALE:
1"=30' FULL SIZE SHEET
1"=60' QUARTER SIZE SHEET



FILE NAME =	USER NAME = sparksgw	DESIGNED - ML	REVISED - RTS	STATE OF ILLINOIS DEPARTMENT OF TRANSPORTATION	PLAN SHEET	F.A.P. RTE.	SECTION	COUNTY	TOTAL SHEETS	SHEET NO.	
Default	Plot Date = Dec-14-2012 12:00:54PM	DRAWN - ML	REVISED -			315	.	MASON	62	37	
		CHECKED - RTS	REVISED -			CONTRACT NO. 72E03					
		DATE -	REVISED -			ILLINOIS FED. AID PROJECT					

-- (HRS-2, (124)RS-3, (116)RS

SCALE: SHEET 7 OF 18 SHEETS STA. TO STA.