

**LOCATION MAP #5**  
**F.A.P. ROUTE 711 (IL. 119)**  
**FROM IL. 1 TO INDIANA STATE LINE**  
**VERMILION COUNTY /RURAL 2 LANE**

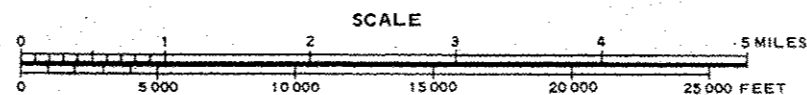
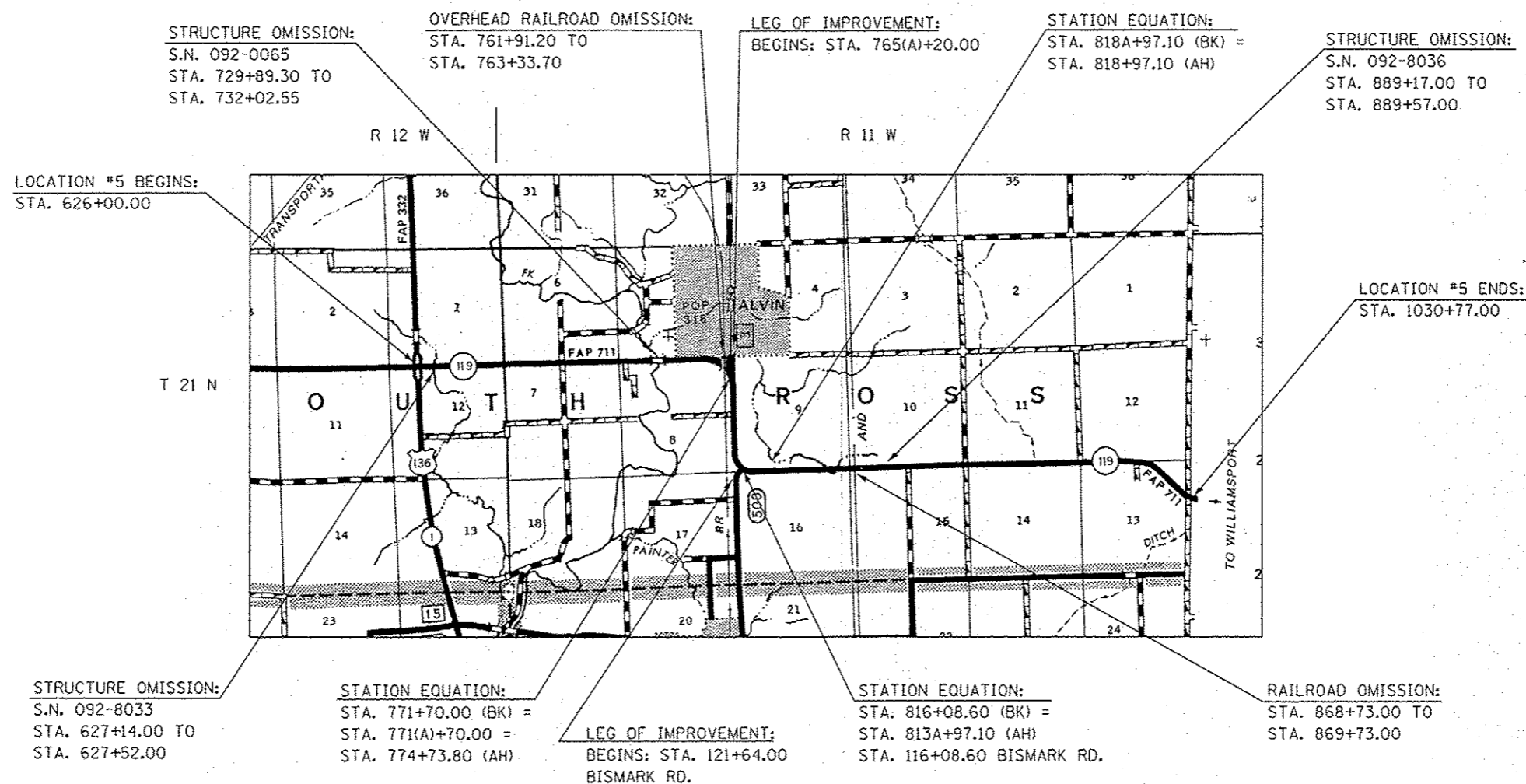

TOWNSHIP:  
SOUTH ROSS

**GROSS LENGTH OF LOCATION #5 = 40,384.70 FT = 7.649 MILES**  
**NET LENGTH OF LOCATION #5 = 39,850.95 FT = 7.548 MILES**

• D5 CRACK & JOINT SEAL 2013-2

FILE NAME: 1	USER NAME: bakercr	DESIGNED: -	REVISED: -	<b>STATE OF ILLINOIS</b>	<b>LOCATION MAP #5</b>	F.A. RTE. VAR.	SECTION	COUNTY	TOTAL SHEETS	SHEET NO.
cr:\pwork\pvidot\bakercr\108327161\0578	82\shl-location map.dgn	DRAWN: -	REVISED: -	<b>DEPARTMENT OF TRANSPORTATION</b>	SCALE: SHEET 1 OF 1 SHEETS STA. TO STA.			VARIABLES	36	7
#MODELNAME:	PLOT SCALE: 40.8000 1/4 in.	CHECKED: -	REVISED: -					CONTRACT NO. 70982		
	PLOT DATE: 1/20/2013	DATE: -	REVISED: -					ILLINOIS FED. AID PROJECT		