

PROP. HOT-MIX ASPHALT SURFACE REMOVAL, 2 1/2"
 PROP. POLYMERIZED HMA SURFACE COURSE, MIX "F", N90, 1 3/4"
 PROP. POLYMERIZED LEVELING BINDER COURSE (MACHINE METHOD), IL-4.75, N50, 3/4"

**IMPROVEMENT ENDS:
STA. 285 + 19**

- (A) PROP. THERMOPLASTIC PAVEMENT TURN LANE MARKING-LINE 6", WHITE (TYP.)
- (B) PROP. THERMOPLASTIC PAVEMENT STOP MARKING-LINE 24", WHITE (TYP.)
- (C) PROP. THERMOPLASTIC PAVEMENT MARKING LETTERS AND SYMBOLS, WHITE (TYP.)
- (D) PROP. THERMOPLASTIC PAVEMENT MARKING-LINE 8", WHITE (TYP.)
- (E) PROP. THERMOPLASTIC PAVEMENT MARKING-LINE 12", YELLOW (TYP.)
- (F) PROP. THERMOPLASTIC PAVEMENT MARKING-LINE 4", 10' DASH-30' SKIP, WHITE (TYP.)
- (G) PROP. THERMOPLASTIC PAVEMENT MARKING-LINE 12", WHITE (TYP.)
- (H) PROP. THERMOPLASTIC PAVEMENT MARKING DOUBLE LINES 4" @ 11" C-C, YELLOW (TYP.)
- (I) PROP. THERMOPLASTIC PAVEMENT SOLID AND SKIP-DASH MARKING-LINES 4" @ 5 1/2" C-C, YELLOW (TYP.)
- (J) PROP. THERMOPLASTIC PAVEMENT MARKING-LINE 4", YELLOW (TYP.)
- (K) PROP. THERMOPLASTIC PAVEMENT MARKING-LINE 4", WHITE (TYP.)
- (L) PROP. THERMOPLASTIC PAVEMENT CROSSWALK MARKING-LINE 6", 2 @ 6' SPACE, WHITE (TYP.)

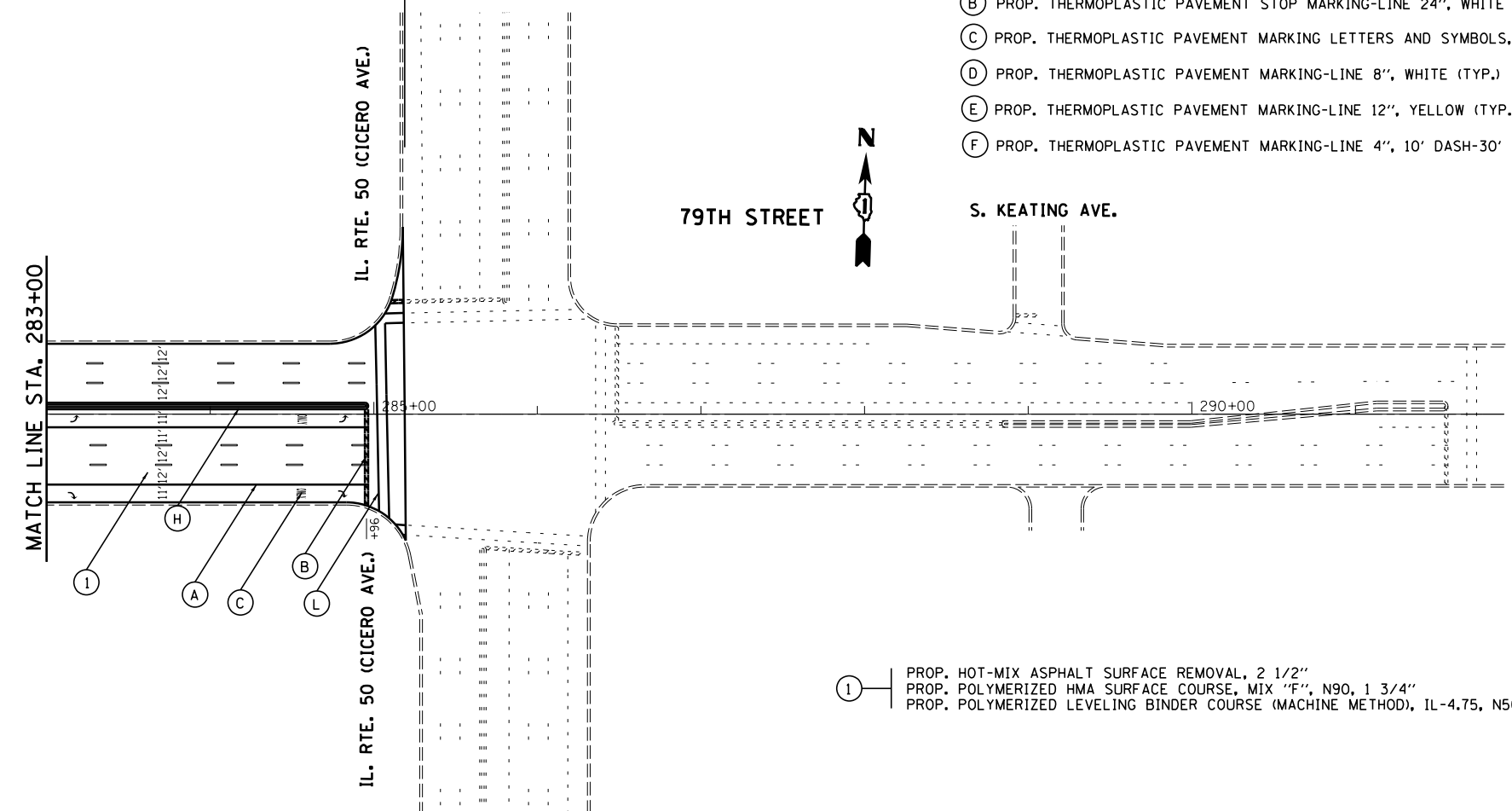

(I) PROP. HOT-MIX ASPHALT SURFACE REMOVAL, 2 1/2"
 PROP. POLYMERIZED HMA SURFACE COURSE, MIX "F", N90, 1 3/4"
 PROP. POLYMERIZED LEVELING BINDER COURSE (MACHINE METHOD), IL-4.75, N50, 3/4"

FILE NAME =	USER NAME = qureshiya	DESIGNED -	REVISED -	STATE OF ILLINOIS DEPARTMENT OF TRANSPORTATION	79TH ST. ROADWAY & PAVEMENT MARKING PLAN	F.A.U. RTE.	SECTION	COUNTY	TOTAL SHEETS	SHEET NO.	
ca:\pw_work\p1dot\qureshiya\0330876\0118413-sh-t-plan.dgn	PLOT SCALE = 100.0004' / in.	DRAWN -	REVISED -			1548	46IRS-3	COOK	38	16	
\$MODELNAME\$	PLOT DATE = 2/19/2013	CHECKED -	REVISED -			CONTRACT NO. 60W15		ILLINOIS FED. AID PROJECT			
		DATE -	REVISED -			SCALE: 1"=50'	SHEET 10 OF 10 SHEETS	STA. 268+00 TO STA. 292+00			