

**IMPROVEMENT BEGINS:
STA. 10+51**

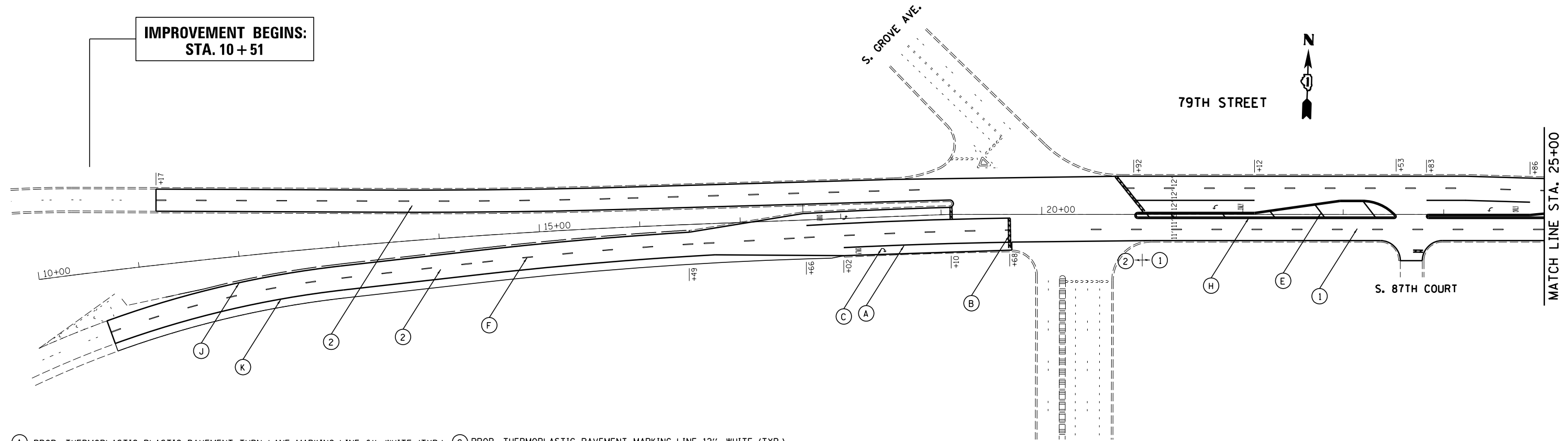

- (A) PROP. THERMOPLASTIC PLASTIC PAVEMENT TURN LANE MARKING-LINE 6", WHITE (TYP.)
- (B) PROP. THERMOPLASTIC PAVEMENT STOP MARKING-LINE 24", WHITE (TYP.)
- (C) PROP. THERMOPLASTIC PAVEMENT MARKING LETTERS AND SYMBOLS, WHITE (TYP.)
- (D) PROP. THERMOPLASTIC PAVEMENT MARKING-LINE 8", WHITE (TYP.)
- (E) PROP. THERMOPLASTIC PAVEMENT MARKING-LINE 12", YELLOW (TYP.)
- (F) PROP. THERMOPLASTIC PAVEMENT MARKING-LINE 4", 10' DASH-30' SKIP, WHITE (TYP.)
- (G) PROP. THERMOPLASTIC PAVEMENT MARKING-LINE 12", WHITE (TYP.)
- (H) PROP. THERMOPLASTIC PAVEMENT MARKING DOUBLE LINES 4" @ 11" C-C, YELLOW (TYP.)
- (I) PROP. THERMOPLASTIC PAVEMENT SOLID AND SKIP-DASH MARKING-LINES 4" @ 5 1/2" C-C, YELLOW (TYP.)
- (J) PROP. THERMOPLASTIC PAVEMENT MARKING-LINE 4", YELLOW (TYP.)
- (K) PROP. THERMOPLASTIC PAVEMENT MARKING-LINE 4", WHITE (TYP.)
- (L) PROP. THERMOPLASTIC PAVEMENT CROSSWALK MARKING-LINE 6", 2 @ 6' SPACE, WHITE (TYP.)

S. 88TH AVE.

- (1) PROP. HOT-MIX ASPHALT SURFACE REMOVAL, 2 1/2"
PROP. POLYMERIZED HMA SURFACE COURSE, MIX "F", N90, 1 3/4"
PROP. POLYMERIZED LEVELING BINDER COURSE (MACHINE METHOD), IL-4.75, N50, 3/4"
- (2) PROP. HOT-MIX ASPHALT SURFACE REMOVAL, 1 3/4"
PROP. POLYMERIZED HMA SURFACE COURSE, MIX "F", N90, 1 3/4"

79TH STREET

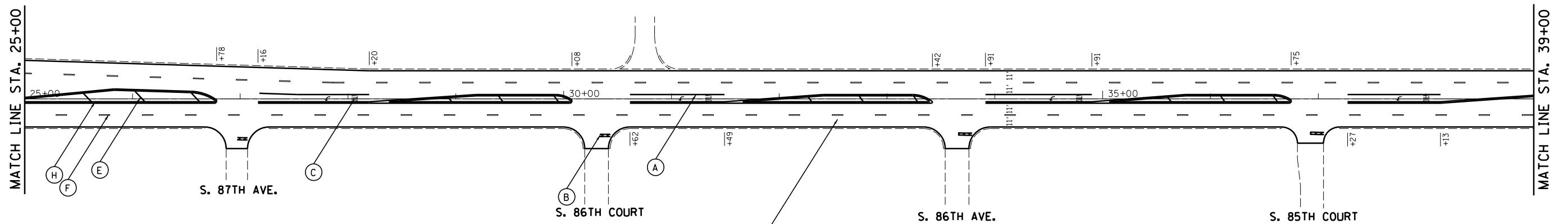

- PROP. HOT-MIX ASPHALT SURFACE REMOVAL, 2 1/2"
- PROP. POLYMERIZED HMA SURFACE COURSE, MIX "F", N90, 1 3/4"
- PROP. POLYMERIZED LEVELING BINDER COURSE (MACHINE METHOD), IL-4.75, N50, 3/4"

| | | | | | | | | | | | |
|--|------------------------------|------------|-----------|---|---|---------------------------|---------|--------|-----------------|--------------|--|
| FILE NAME = | USER NAME = qureshiya | DESIGNED - | REVISED - | STATE OF ILLINOIS DEPARTMENT OF TRANSPORTATION | 79TH ST. ROADWAY & PAVEMENT MARKING PLAN | F.A.U. RTE. | SECTION | COUNTY | TOTAL SHEETS | SHEET NO. | |
| ce:\pw_work\pilot\qureshiya\0330876\0118413-sht-plan.dgn | PLOT SCALE = 100.0004' / in. | DRAWN - | REVISED - | | | 1548 | 46IRS-3 | COOK | 38 | 7 | |
| \$MODELNAME\$ | PLOT DATE = 2/19/2013 | CHECKED - | REVISED - | | | CONTRACT NO. 60W15 | | | | | |
| | | | | | | ILLINOIS FED. AID PROJECT | | | | | |