

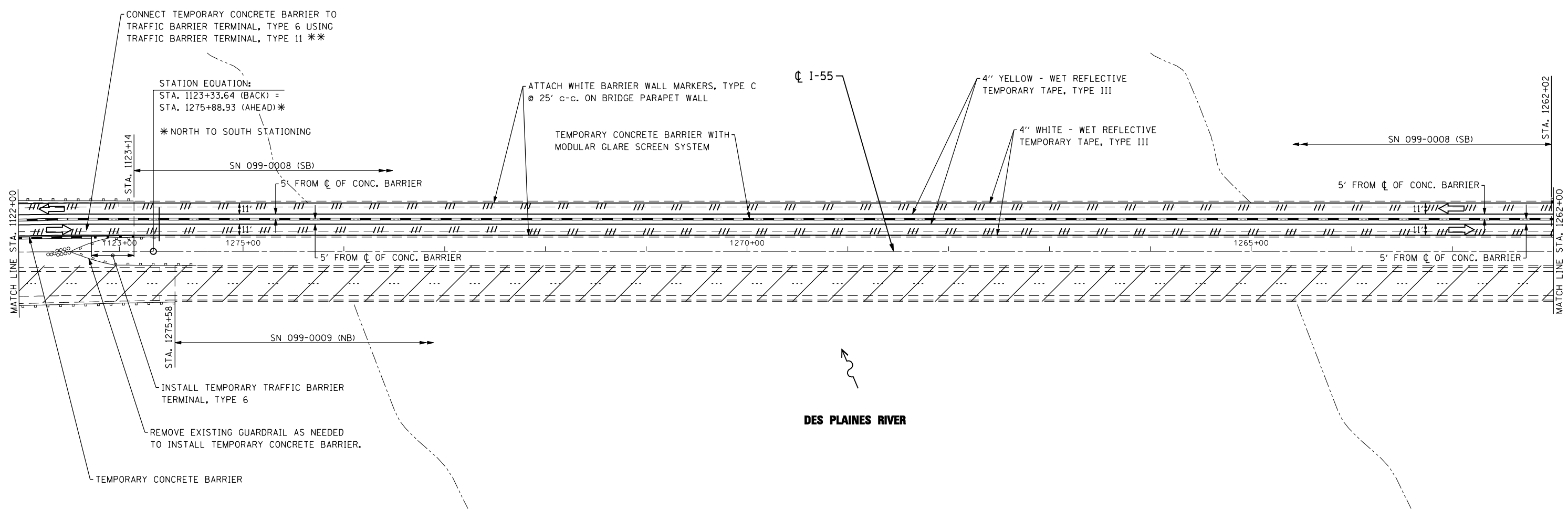

** THE BID PRICE FOR THE TRAFFIC BARRIER TERMINAL TYPE 11 SHALL INCLUDE THE COST OF THE LABOR AND HARDWARE NEEDED TO CONNECT THE TBT TYPE 11 TO THE TBT TYPE 6.



LEGEND

- WORK AREA
- ARROW BOARD
- TRAFFIC LANE
- TEMPORARY CONCRETE BARRIER
- TYPE III BARRICADES WITH FLASHING LIGHTS
- VERTICAL PANELS @ 50' c-c. UNLESS OTHERWISE SHOWN
- TEMPORARY SIGN
- DRUMS @ 50' c-c. WITH STEADY-BURN MONO-DIRECTIONAL LIGHTS
- TYPE II BARRICADES WITH STEADY-BURN MONO-DIRECTIONAL LIGHTS
- DIRECTIONAL INDICATOR BARRIER
- PAVEMENT MARKING REMOVAL

FILE NAME = D160R62-stage1-05.dgn
 USER NAME = IDOT
 PLOT SCALE = 100.0000' / IN.
 PLOT DATE = 1/18/2013

CHRISTIAN ROGE & ASSOCIATES, INC.
 ENGINEERS-PLANNERS-SURVEYORS
 211 WEST WACKER DRIVE
 CHICAGO, ILLINOIS 60606
 PHONE: (312)372-2023 FAX: (312)372-8274

DESIGNED - S.J.P.	REVISED -
DRAWN - B.K.	REVISED -
CHECKED - M.P.	REVISED -
DATE - JANUARY 17, 2013	REVISED -

**STATE OF ILLINOIS
 DEPARTMENT OF TRANSPORTATION**

**SUGGESTED TRAFFIC CONTROL AND PROTECTION
 I-55 STAGE I**

SCALE: 1" = 50' SHEET NO. 5 OF 9 SHEETS STA. 1122+00 TO STA. 1262+00

F.A.I. RTE.	SECTION	COUNTY	TOTAL SHEETS	SHEET NO.
55	87B, D-BR-1	WILL	106	20
CONTRACT NO. 60R62				
FED. ROAD DIST. NO. 1 ILLINOIS FED. AID PROJECT				