

**EXISTING TYPICAL SECTION**

STA. 1075+75 TO STA. 1123+33.64  
 STA. 1275+88.93 TO STA. 1223+00  
 BRIDGE OMISSION:  
 S.B. SN 099-0008  
 STA. 1123+14.50 TO STA. EQUATION 1123+33.64 (AH) / 1275+88.93 (BK)  
 TO STA 1262+02.11  
 N.B. SN 099-0009  
 STA. 1275+67.53 TO STA. 1261+61.53

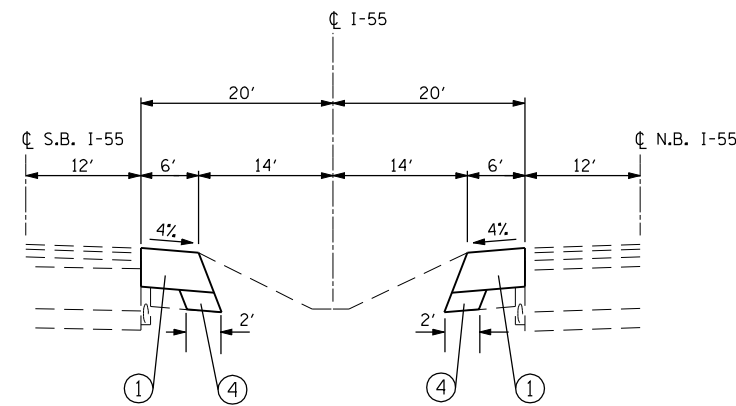

**\* PROPOSED INSIDE SHOULDER REPLACEMENT TYPICAL SECTION**

STA. 1118+00 TO STA. 1123+40  
 STA. 1261+88 TO STA. 1259+13  
 6 SQ FT OF EARTH EXCAVATION PER FOOT OF LENGTH  
 (THIS SECTION CONSTRUCTED PRIOR TO SURFACE REMOVAL AND OVERLAY)

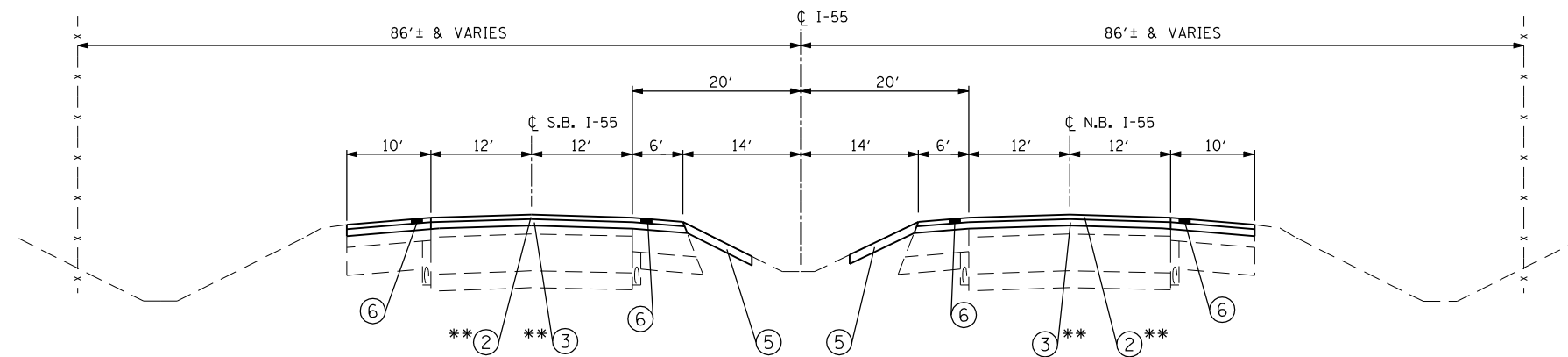

**PROPOSED TYPICAL SECTION**

\*\* OVERLAY FOR BRIDGES APPROACHES  
 STA. 1121+95.00 TO STA. 1123+55.04/STA. 1275+67.53  
 STA. 1262+02.11 TO STA. 1260+42.00

**EXISTING LEGEND**

- (A) HOT-MIX ASPHALT OVERLAY, 5" & VARIES
- (B) PORTLAND CEMENT CONCRETE PAVEMENT, 10"
- (C) EXISTING GROUND OR AGGREGATE BASE COURSE. VARIES
- (D) HOT-MIX ASPHALT SHOULDER, 12" & 10"
- (E) HOT-MIX ASPHALT SURFACE REMOVAL, 2 1/4" OR HOT-MIX ASPHALT REMOVAL, BUTT JOINT
- (F) PAVED SHOULDER REMOVAL
- (G) EARTH EXCAVATION FOR 12" HMA SHOULDER

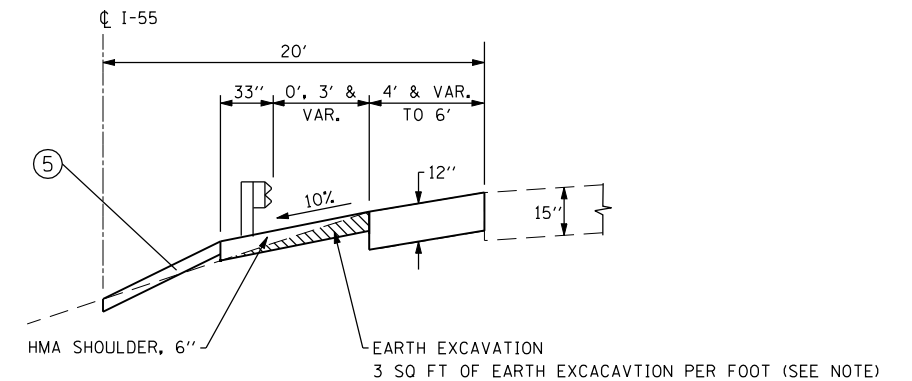

**SHOULDER SECTION AT PROPOSED MEDIAN GUARDRAIL**

STA. 1261+02 TO STA. 1258+78 (S.B.)  
 STA. 1120+27 TO STA. 1123+40 (N.B.)

**PROPOSED LEGEND**

- (1) HOT-MIX ASPHALT SHOULDERS, 12"
- (2) POLYMERIZED HOT-MIX ASPHALT SURFACE COURSE, MIX "F", N90, 1 3/4"
- (3) POLYMERIZED HOT-MIX ASPHALT BINDER COURSE, IL-19.0, N90, 2 1/4"
- (4) AGGREGATE SUBGRADE IMPROVEMENT, 12"
- (5) TOPSOIL, FURNISH & PLACEMENT, 4" & SEEDING, CLASS 2A & EROSION CONTROL BLANKET
- (6) SHOULDER RUMBLE STRIP, 16"

FILE NAME = D160R62-sht-typrcoll.dgn  
 USER NAME = IDOT  
 PLOT SCALE = 20,0000' / IN.  
 PLOT DATE = 1/18/2013

**CHRISTIAN-ROGE & ASSOCIATES, INC.**  
 ENGINEERS-PLANNERS-SURVEYORS  
 211 WEST WACKER DRIVE  
 CHICAGO, ILLINOIS 60606  
 PHONE: (312)372-2023 FAX: (312)372-8274

DESIGNED - S.J.P.  
 DRAWN - B.K.  
 CHECKED - M.P.  
 DATE - JANUARY 17, 2013

REVISED -  
 REVISED -  
 REVISED -  
 REVISED -

**STATE OF ILLINOIS  
 DEPARTMENT OF TRANSPORTATION**

**TYPICAL SECTIONS AND DETAILS  
 I-55**

SCALE: NONE SHEET NO. 1 OF 2 SHEETS STA. TO STA.

F.A.I. RTE.	SECTION	COUNTY	TOTAL SHEETS	SHEET NO.
55	87B, D-BR-1	WILL	106	12
CONTRACT NO. 60R62				
FED. ROAD DIST. NO. 1 ILLINOIS FED. AID PROJECT				