

**NOTES:**

1. NO ROADWAY CLOSURES OF COUNTY HIGHWAY 21 ARE ALLOWED DURING CONSTRUCTION OF THE PROPOSED IMPROVEMENTS.
2. REFER TO TRAFFIC CONTROL STANDARDS 701001, 701006-03, 701011-02 & BLR 21-9 FOR DETAILS OF SIGN AND BARRICADE LOCATION.
3. ACCESS TO THE EXISTING ALTA PARKING AREAS SHALL BE CLOSED DURING CONSTRUCTION.
4. WORK AT THIS SITE SHALL NOT BEGIN UNTIL AUGUST 19, 2013 AND ALL WORK SHALL BE COMPLETED BY OCTOBER 31, 2013.

**LEGEND**

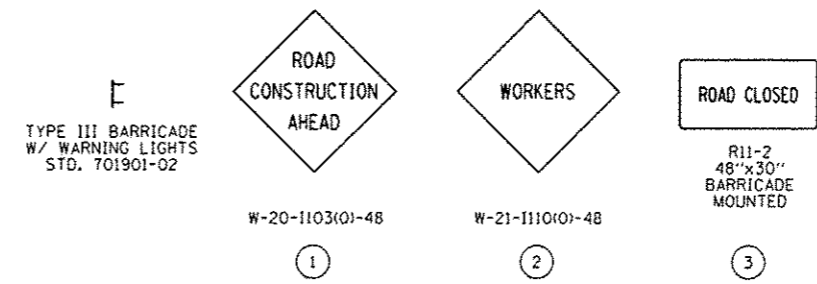

FILE NAME :	USER NAME : Kristin Timmons	DESIGNED - KLT	REVISED -
L:\DOT\1186618\WD-Draw\CRDD-Sheets\Traffic Control Plan-Altadgn		DRAWN - GLD	REVISED -
Default	PLOT SCALE = 100.0000 / in.	CHECKED - SPH	REVISED -
	PLOT DATE = 2/5/2013	DATE = 2/1/2013	REVISED -

**STATE OF ILLINOIS  
DEPARTMENT OF TRANSPORTATION**

**TRAFFIC CONTROL PLAN - ALTA  
ROCK ISLAND TRAIL STATE PARK**

SCALE: 1" = 30'    SHEET    OF    SHEETS    STA.    TO STA.

F.A. RTE.	SECTION	COUNTY	TOTAL SHEETS	SHEET NO.
	PARK ROADS	PEORIA/STARK	37	29
CONTRACT NO. 46256				
ILLINOIS FED. AID PROJECT				