

F.A.P. RTE.	SECTION	COUNTY	TOTAL SHEETS	SHEET NO.
N/A	PARK ROADS	PEORIA/STARK	37	1
FED. ROAD DIST. NO.	ILLINOIS	CONTRACT NO. 46256		

P-30-001-12

INDEX OF SHEETS

- 1 COVER SHEET
- 2 GENERAL NOTES
- 3-8 SUMMARY OF QUANTITIES
- 9-10 TYPICAL SECTIONS AND PAVEMENT STRUCTURE DETAILS
- 11-15 ALTA PLAN SHEETS
- 16-17 KICKAPOO CREEK PLAN SHEETS
- 18-21 PARKS SCHOOL ROAD PLAN SHEETS
- 22-23 COUNTY LINE ROAD PLAN SHEETS
- 24-25 WYOMING PLAN SHEETS
- 26-27 TOULON PLAN SHEETS
- 28 SITE PLAN - PRINCEVILLE AND WYOMING KIOSKS
- 29-32 TRAFFIC CONTROL PLANS
- 33-37 MISCELLANEOUS CONSTRUCTION DETAILS

HIGHWAY STANDARDS

- 000001-06 STANDARD SYMBOLS, ABBREVIATIONS AND PATTERNS
- 001006 DECIMAL OF AN INCH AND OF A FOOT
- 280001-07 TEMPORARY EROSION CONTROL SYSTEMS
- 442201-03 CLASS C AND D PATCHES
- 542401-01 METAL END SECTION FOR PIPE CULVERTS
- 701001-02 OFF-ROAD OPERATIONS, 2L, 2W, MORE THAN 15' AWAY
- 701006-04 OFF-ROAD OPERATIONS, 2L, 2W, 15' TO 24" FROM PAVEMENT EDGE
- 701011-03 OFF-ROAD OPERATIONS, 2L, 2W, DAY ONLY
- 701301-04 LANE CLOSURE, 2L, 2W, SHORT TIME OPERATIONS
- 701501-06 URBAN LANE CLOSURE, 2L, 2W, UNDIVIDED
- 701901-02 TRAFFIC CONTROL DEVICES
- 720001-01 SIGN PANEL MOUNTING DETAILS
- 720006-03 SIGN PANEL ERECTION DETAILS
- 780001-03 TYPICAL PAVEMENT MARKINGS
- BLR 18-5 TRAFFIC CONTROL DEVICES - DAY LABOR CONSTRUCTION
- BLR 21-9 TYPICAL APPLICATION OF TRAFFIC CONTROL DEVICES FOR CONSTRUCTION ON RURAL LOCAL HIGHWAYS

PROJECT DESCRIPTION

THE PROPOSED PROJECT CONSISTS OF PARKING LOT AND SITE IMPROVEMENTS AT THE SIX IDNR ROCK ISLAND TRAIL STATE PARK SITES: ALTA, KICKAPOO CREEK, PARKS SCHOOL ROAD, COUNTY LINE ROAD, WYOMING DEPOT AND TOULON. THE IMPROVEMENTS CONSIST OF HMA PAVING, BITUMINOUS SURFACE TREATMENTS, ENTRANCE RECONSTRUCTION, WIDENING AND PARKING LOT EXPANSION, PAVEMENT MARKING AND SIGNING. ALSO INCLUDED ARE KIOSKS AT THE TRAIL INTERSECTIONS AT 6TH STREET IN WYOMING AND AT MENDENHALL ROAD/WALNUT STREET IN PRINCEVILLE.

0 30' 60' 100' 1" = 30'
 (SURVEY CONTROL, TIES, AND BENCHMARKS)
 (SITE PLAN)
 (GRADING AND STAKING PLAN)
 (PAVEMENT MARKING/SIGNING PLANS)

0 20' 50' 100' 1" = 20'
 (SURVEY CONTROL, TIES, AND BENCHMARKS)
 (SITE PLAN)
 (GRADING AND STAKING PLAN)
 (PAVEMENT MARKING/SIGNING PLANS)

0 10' 20' 30' 1" = 10'
 (SURVEY CONTROL, TIES, AND BENCHMARKS)
 (SITE PLAN)
 (GRADING AND STAKING PLAN)
 (PAVEMENT MARKING/SIGNING PLANS)

FULL SIZE PLANS HAVE BEEN PREPARED USING STANDARD ENGINEERING SCALES. REDUCED SIZED PLANS WILL NOT CONFORM TO STANDARD SCALES. IN MAKING MEASUREMENTS ON REDUCED PLANS, THE ABOVE SCALES MAY BE USED.

J.U.L.I.E.
 JOINT UTILITY LOCATION INFORMATION FOR EXCAVATION
 1-800-892-0123
 OR 811

PROJECT ENGINEER: LANCE KIDD (217) 785-2933
CONTRACT NO. 46256

STATE OF ILLINOIS
DEPARTMENT OF TRANSPORTATION
DIVISION OF HIGHWAYS
IDOT / IDNR STATEWIDE
ROCK ISLAND TRAIL STATE PARK
SITE IMPROVEMENTS
PEORIA / STARK COUNTY
IDOT PROJECT NO.
IDNR PROJECT NO. 1-13-001
C-30-003-13

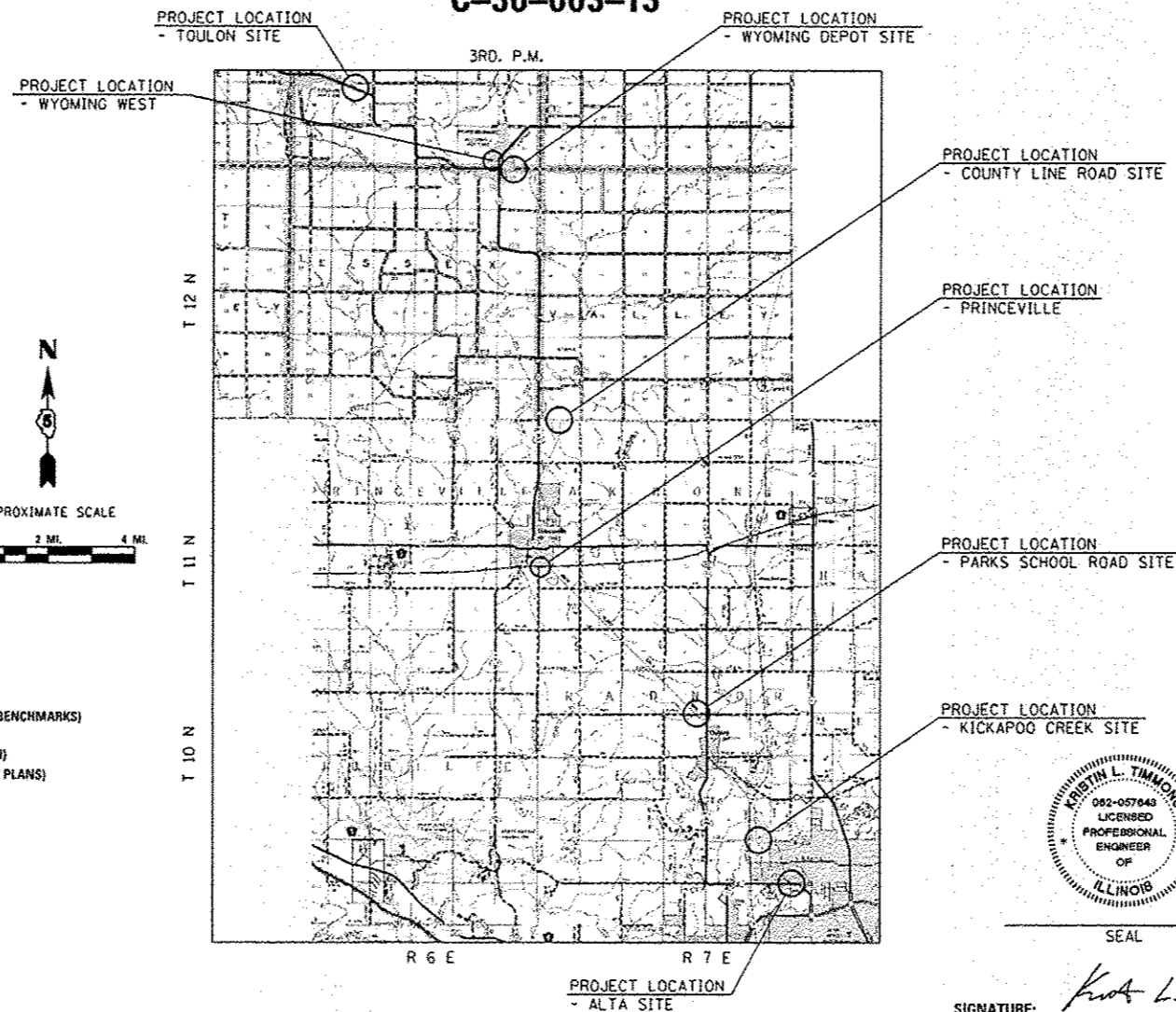

LOCATION MAP

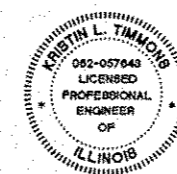
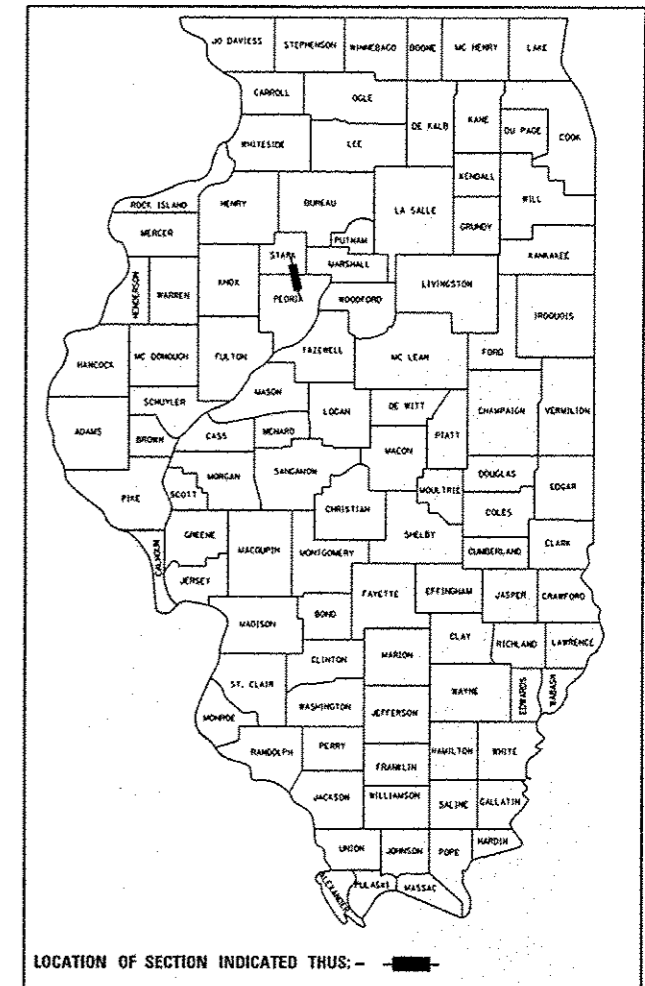

SEAL

SIGNATURE: *Kristin L. Timmons*
 DATE SIGNED: 2/5/2013
 LICENSE EXPIRATION DATE: 11/30/2013

STATE OF ILLINOIS
 DEPARTMENT OF TRANSPORTATION
 DIVISION OF HIGHWAYS

SUBMITTED: *March 22 2013*
William B. Frazer
 DEPUTY DIRECTOR OF HIGHWAYS, REGIONAL ENGINEER

March 22 2013
John D. Baranzoli, P.E.
 ENGINEER OF DESIGN AND ENVIRONMENT

March 22 2013
Omer Osman, P.E.
 DIRECTOR OF HIGHWAYS, CHIEF ENGINEER

CMT
 CRAWFORD, MURPHY & TILLY, INC.
 CONSULTING ENGINEERS
 License No. 184-000613

PRINTED BY THE AUTHORITY OF THE STATE OF ILLINOIS