

DATE	
BY	
SURVEYED	
FINAL SURVEY	
NOTE BOOK	
NO.	
TEMP. AREAS CHECKED	
PERM. AREAS CHECKED	

DATE	
BY	
SURVEYED	
ORIGINAL SURVEY	
NOTE BOOK	
NO.	
TEMP. AREAS CHECKED	
PERM. AREAS CHECKED	

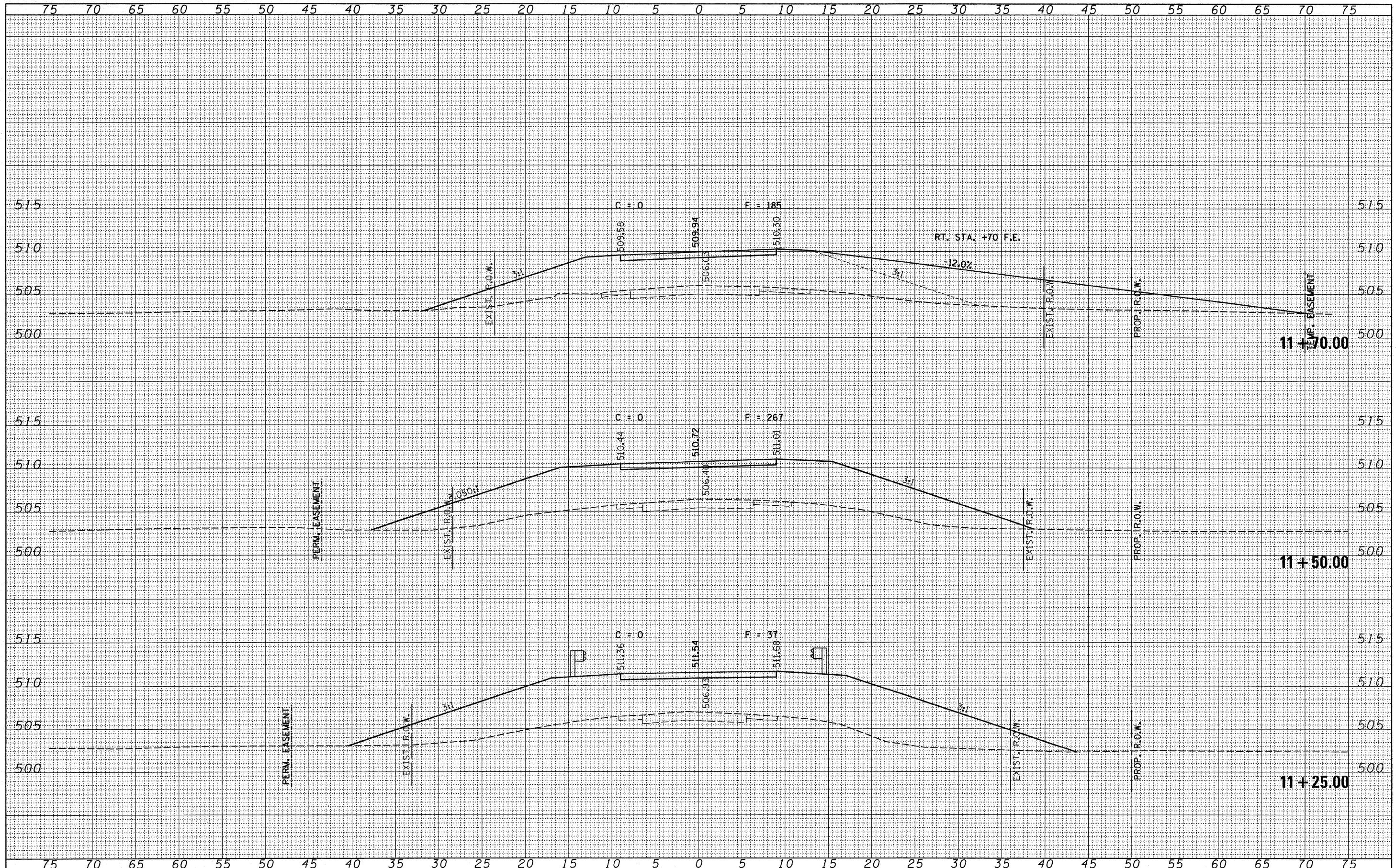

FILE NAME = 080126-shr-xxx.dgn

USER NAME =
 PLOT SCALE =
 PLOT DATE = 12/18/2008

DESIGNED - J.W.F.
 DRAWN - D.T.M.
 CHECKED - S.W.M.
 DATE - 10/15/08

REVISED -
 REVISED -
 REVISED -
 REVISED -

STATE OF ILLINOIS
 JEFFERSON COUNTY HIGHWAY DEPARTMENT



HAMPTON, LENZINI & RENWICK, INC.
 CIVIL & STRUCTURAL ENGINEERS
 LAND SURVEYORS

CROSS SECTIONS
 MALECKI ROAD

SCALE: 5 SHEET NO. OF SHEETS STA. 11+25.00 TO STA. 11+70.00

T.R.	SECTION	COUNTY	TOTAL SHEETS	SHEET NO.
131	07-06121-00-BR	JEFFERSON	30	15
FARRINGTON ROAD DISTRICT			CONTRACT NO. 99350	
FED. ROAD DIST. NO.			ILLINOIS FED. AID PROJECT	