

| F.A.E. RTE. | SECTION | COUNTY     | TOTAL SHEETS | SHEET NO. |
|-------------|---------|------------|--------------|-----------|
| 331         |         | WILLIAMSON | 8            | 1         |

D9 PAVEMENT PRESERVATION FY09-1

STATE OF ILLINOIS  
DEPARTMENT OF TRANSPORTATION  
DIVISION OF HIGHWAYS

**PROPOSED  
HIGHWAY PLANS**

FAP ROUTE 331 (IL 13)  
SECTION D9 PAVT PRESERVATION FY09-1

WILLIAMSON AND SALINE COUNTIES  
C-99-069-08

FOR INDEX OF SHEETS, SEE SHEET NO. 3

ADT (2007) 8700  
PV = 7975  
MU = 375  
SU = 350  
TRUCK % = 8.3%

D-99-051-08

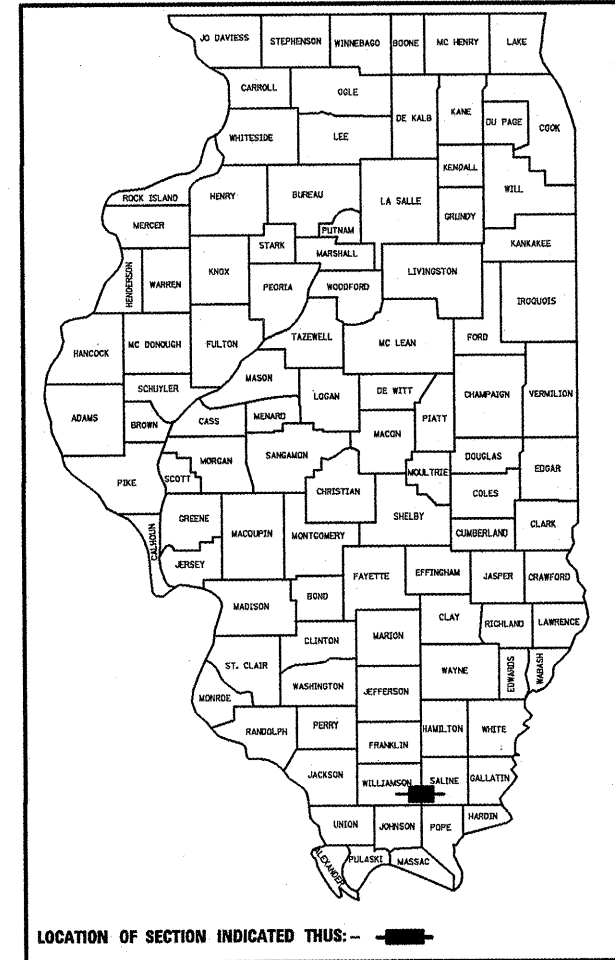

PROP. PROJECT - IL 13 (EBL) STA. 510+00 TO STA. 538+50  
IN WILLIAMSON COUNTY (EBL'S ONLY);  
STA. 538+50 TO STA. 754+07 IN SALINE COUNTY (EBL'S ONLY)

EQUATION STATIONS:  
Eq. Sta. 724+21.21 (Bk.) =  
Sta. 725+01.02 (Ah.)

TOWNSHIPS: CRAB ORCHARD, CARRIER MILLS

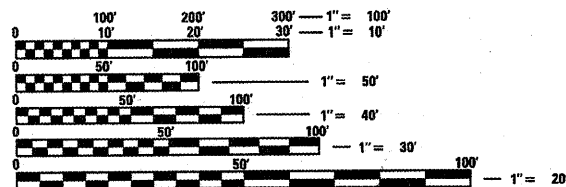

FULL SIZE PLANS HAVE BEEN PREPARED USING STANDARD  
ENGINEERING SCALES. REDUCED SIZED PLANS WILL NOT  
CONFORM TO STANDARD SCALES. IN MAKING MEASUREMENTS  
ON REDUCED PLANS, THE ABOVE SCALES MAY BE USED.

J.U.L.I.E.  
JOINT UTILITY LOCATION INFORMATION FOR EXCAVATION  
1-800-892-0123

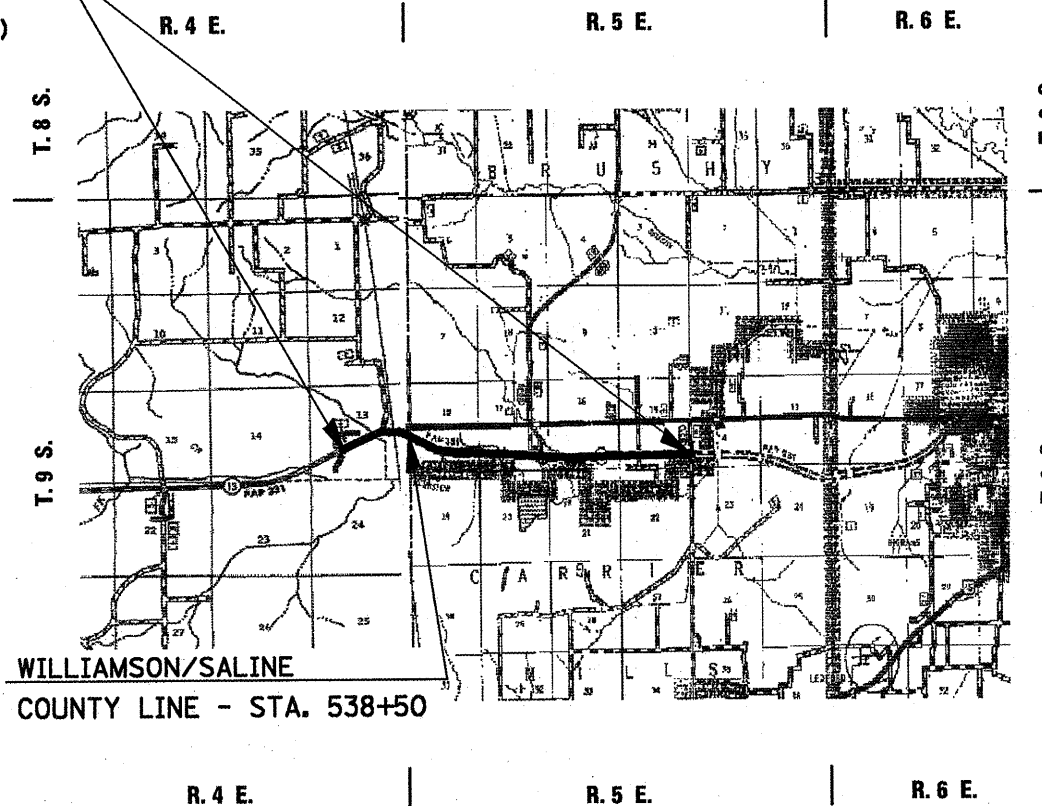

PROJECT ENGINEER: CHARLES STEIN - (618) 351-5210  
DESIGNER: KATHI MCCORD - (618) 351-5216

CONTRACT NO. 78082

LENGTH OF PROJECT: 24,182 FT. = 4.58 MILES

STATE OF ILLINOIS  
DEPARTMENT OF TRANSPORTATION  
DIVISION OF HIGHWAYS

SUBMITTED Jan 9, 2009  
Ma Chami  
DEPUTY DIRECTOR OF HIGHWAYS, REGION ENGINEER

March 27, 2009  
Charles J. Ingersoll  
ENGINEER OF DESIGN AND ENVIRONMENT

March 27, 2009  
Christine M. Reed  
DIRECTOR OF HIGHWAYS, CHIEF ENGINEER

**PRINTED BY THE AUTHORITY  
OF THE STATE OF ILLINOIS**

| FAP RTE | SECTION | COUNTY     | TOTAL SHEETS | SHEET NO |
|---------|---------|------------|--------------|----------|
| 331     | •       | WILLIAMSON | 8            | 2        |

STA. TO STA.

| FED. ROAD DIST. NO. | SECTION | FED. AID PROJECT |
|---------------------|---------|------------------|
|                     |         |                  |

\*D9 PAVEMENT PRESERVATION FY 07

Prepared By: *Ace Zdenekiewicz*  
DISTRICT STUDIES & PLANS ENGINEER

Examined By: *James Lewis Emery*  
DISTRICT LAND ACQUISITION ENGINEER

Examined By: *Carrie Nelson*  
DISTRICT PROGRAM DEVELOPMENT ENGINEER

Examined By: *Verdell P. Kelly*  
DISTRICT OPERATIONS ENGINEER

Examined By: *John Smother*  
DISTRICT CONSTRUCTION ENGINEER

Examined By: *Brian S. Stobley*  
DISTRICT MATERIALS ENGINEER

Examined By: *John Smother*  
DISTRICT PROJECT IMPLEMENTATION ENGINEER

Examined By: *James D. Denton*  
ASSISTANT REGIONAL ENGINEER

Approved By: *Wesley C. Palmer*  
DEPUTY DIRECTOR OF HIGHWAYS, REGION ENGINEER

DATE *Jan 9* 20 *09*

| F.A.P. RTE.                   | SECTION | COUNTY                    | TOTAL SHEETS | SHEET NO. |
|-------------------------------|---------|---------------------------|--------------|-----------|
| 331                           | 2       | WILLIAMSON                | 8            | 3         |
| STA. _____                    |         | TO STA. _____             |              |           |
| FED. ROAD DIST. NO. _____     |         | ILLINOIS FED. AID PROJECT |              |           |
| 09_PAVEMENT_PRESERVATION_EYQ7 |         |                           |              |           |

INDEX OF SHEETS

| SHEET NO. | DESCRIPTION  |
|-----------|--|
| 1         | COVER SHEET  |
| 2         | SIGNATURE BLOCK  |
| 3         | INDEX OF SHEETS; HIGHWAY STANDARDS; STRUCTURE RATINGS; GENERAL NOTES               |
| 4         | TYPICAL SECTIONS   |
| 5         | SUMMARY OF QUANTITIES  |
| 6         | RESURFACING SCHEDULE   |
| 7         | THERMOPLASTIC PAVEMENT MARKING SCHEDULE  |
| 8         | LOCATION MAP - FAP 331 (IL. 13) EASTBOUND LANES NEAR WILLIAMSON/SALINE COUNTY LINE |

HIGHWAY STANDARDS

- 701400-03
- 701406-05
- 701426-03
- 701901-01
- 780001-02
- 781001-03

STRUCTURE RATINGS

| STRUCTURE NO.                                    | INV. RATING | OPER. RATING | SUFF. RATING |
|--|-------------|--------------|--------------|
| FAI 331 (IL. 13) EASTBOUND LANES - SALINE COUNTY |             |              |              |
| 083-0050   | 24.0        | 40.2         | 99.8         |

GENERAL NOTES

THE AGGREGATE TO BE USED IN THE MICRO-SURFACING SHALL BE TYPE II APPLIED AT 16 LB/SQ YD PER PASS.

BITUMINOUS MATERIAL (PRIME COAT) SHALL BE APPLIED PRIOR TO PLACING THE FIRST PASS OF MICRO-SURFACING AT A RATE OF 0.05 - 0.10 GAL/SQ. YD.

THE QUANTITY OF SHORT TERM PAVEMENT MARKING SHOWN IN THE PLANS WAS BASED ON ONE APPLICATION EACH FOR 1 LAYER FOR THE PRIME COAT AND 1 LAYER OF SURFACE TREATMENT.

PRIOR TO PLACEMENT OF THE FINAL PAVEMENT MARKINGS THE RESIDENT ENGINEER SHOULD CONTACT THE BUREAU OF OPERATIONS AND ARRANGE FOR INSPECTION AND APPROVAL OF THE PAVEMENT MARKING LAYOUT.

THE CONTRACTOR SHALL PRESERVE EXISTING STAMPED STATIONING.

THE CONTRACTOR SHOULD FOLLOW THE EXISTING HOT-MIX LAYOUT AS CLOSELY AS POSSIBLE. EACH INDIVIDUAL LANE SHOULD BE DONE EDGE TO EDGE IN ONE PASS. SHOULDERS SHALL BE DONE SEPARATELY.

THE FRICTION AGGREGATE SHALL BE MIXTURE D.





|                                |          |                  |              |           |
|--------------------------------|----------|------------------|--------------|-----------|
| F.A.B. RTE.                    | SECTION  | COUNTY           | TOTAL SHEETS | SHEET NO. |
| 331                            | *        | WILLIAMSON       | 8            | 6         |
| STA.                           | TO STA.  |                  |              |           |
| FED. ROAD DIST. NO.            | ILLINOIS | FED. AID PROJECT |              |           |
| *D9_PAVEMENT_PRESERVATION_EY01 |          |                  |              |           |

## RESURFACING SCHEDULE EASTBOUND FAP 331

| LOCATION - STATION TO STATION                         | LENGTH<br>(FT) | PAVEMENT WIDTH<br>(FT) | PAVEMENT AREA<br>(SQ YD) | SHOULDER WIDTH                         |      | MICRO-SURF., SINGLE PASS, TY. 2<br>SHOULDER AREA |      | MICRO-SURF.,<br>SINGLE PASS, TY. 2<br>PAVEMENT AREA<br>(SQ YD) | BIT. MATLS.<br>(PR. CT.) (SEE<br>NOTE 2)<br>(GAL) | FIBER-MOD. ASPHALT<br>CR. SEAL (SEE NOTE<br>1)<br>(FOOT) | NOTES         |                      |         |         |
|---|----------------|------------------------|--------------------------|--|------|--|------|--|---|--|---------------|----------------------|---------|---------|
|   |                |                        |                          | FOR INFORMATIONAL PURPOSE ONLY         |      |  | LEFT |  |   |  |               | RIGHT                | LEFT    | RIGHT   |
|   |                |                        |                          | (FT)                                   | (FT) | (SQ YD)  | (FT) |  |   |  |               | (FT)                 | (SQ YD) | (SQ YD) |
| <b>FAP 331 (IL 13) Williamson Co. Eastbound Lanes</b> |                |                        |                          |  |      |  |      |  |   |  |               |                      |         |         |
|   | 510+00         | TO                     | 538+50                   | 2850                                   | 24.0 | 7600   |      |  | 7600  | 684.0  | 5,700         | Mainline             |         |         |
| LT  | 510+00         | TO                     | 518+26                   | 826                                    |      |  | 6.0  | 551  |   | 50   | 826           | Lt Shld              |         |         |
| LT  | 518+26         | TO                     | 522+68                   | 442                                    |      |  | 4.0  | 196  |   | 18   | 442           | Rt Shld              |         |         |
| LT  | 524+61         | TO                     | 538+50                   | 1389                                   |      |  | 6.0  | 926  |   | 83   | 1,389         | Lt Shld              |         |         |
| RT  | 510+00         | TO                     | 538+50                   | 2850                                   |      |  |      |  | 10.0  | 285  | 2,850         | Rt Shld              |         |         |
| TR 608 LTL  | 518+28.00      | TO                     | 524+61.00                | 633                                    | 12.0 | 690  |      |  |   | 62   | 633           | Side Road            |         |         |
| <b>SUB-TOTALS WILLIAMSON CO. EBL</b>                  |                |                        |                          |  |      |  |      | <b>1673</b>  | <b>3167</b>                                       | <b>8290</b>  | <b>1182</b>   | <b>11,840</b>        |         |         |
| <b>FAP 331 (IL 13) Saline Co. Eastbound Lanes</b>     |                |                        |                          |  |      |  |      |  |   |  |               |                      |         |         |
|   | 538+50         | TO                     | 652+25                   | 11375                                  | 24.0 | 30,333   |      |  | 30333   | 2730   | 22,750        | Mainline             |         |         |
| LT  | 538+50         | TO                     | 541+74                   | 324                                    |      |  | 6.0  | 216  |   | 19   | 324           | Lt Shld              |         |         |
| RT  | 538+50         | TO                     | 633+80                   | 9530                                   |      |  |      |  | 10.0  | 953  | 9,530         | Rt Shld              |         |         |
| LT  | 541+74         | TO                     | 546+08                   | 434                                    |      |  | 4.0  | 193  |   | 17   | 434           | Lt Shld              |         |         |
| RT  | 633+80         | TO                     | 638+34                   | 454                                    |      |  | 4.0  |  | 202   | 18   | 454           | Lt Shld              |         |         |
| WEST CONN. LTL  | 541+74.09      | TO                     | 548+01.00                | 627                                    | 12.0 | 652  |      |  |   | 59   | 627           | Turn lane            |         |         |
| LT  | 548+01.00      | TO                     | 632+25.00                | 8424                                   |      |  | 10.0 | 9360   |   | 842  | 8,424         | Lt Shld              |         |         |
| LT  | 632+26         | TO                     | 638+40                   | 614                                    |      |  | 4.0  | 273  |   | 25   | 614           | Lt Shld              |         |         |
| DANNIE RD. LTL  | 632+25.00      | TO                     | 640+20.00                | 795                                    | 12.0 | 835  |      |  |   | 75   | 795           | Turn lane            |         |         |
| TR 420 RTL  | 632+21.00      | TO                     | 640+20.00                | 799                                    | 12.0 | 835  |      |  |   | 75   | 799           | Turn lane            |         |         |
| LT  | 640+20         | TO                     | 652+25                   | 1205                                   |      |  | 6.0  | 803  |   | 72   | 1,205         | Lt Shld              |         |         |
| RT  | 639+99         | TO                     | 652+25                   | 1226                                   |      |  |      |  | 10.0  | 123  | 1,226         | Rt Shld              |         |         |
| <b>S. N. 083+0050</b>                                 |                |                        |                          | <b>OMIT STA. 652+25 TO STA. 653+70</b> |      |  |      |  |   |  |               | <b>Ex. Structure</b> |         |         |
|   | 653+70         | TO                     | 714+00                   | 6030                                   | 24.0 | 16,080   |      |  | 16080   | 1447   | 12,060        | Mainline             |         |         |
| LT  | 653+70         | TO                     | 707+83                   | 5413                                   |      |  | 6.0  | 3609   |   | 325  | 5,413         | Lt Shld              |         |         |
| RT  | 653+70         | TO                     | 708+80                   | 5510                                   |      |  |      |  | 10.0  | 551  | 5,510         | Rt Shld              |         |         |
| LT  | 707+83         | TO                     | 712+18                   | 435                                    |      |  | 4.0  | 193  |   | 17   | 435           | Lt Shld              |         |         |
| RT  | 708+80         | TO                     | 712+12                   | 332                                    |      |  |      |  | 4.0   | 13   | 332           | Rt Shld              |         |         |
| HAWKINS RD. LTL                                       | 707+83         | TO                     | 714+00                   | 617                                    | 12.0 | 667  |      |  |   | 60   | 617           | Turn lane            |         |         |
| HAWKINS RD. RTL                                       | 707+77         | TO                     | 714+00                   | 623                                    | 12.0 | 674  |      |  |   | 61   | 623           | Turn lane            |         |         |
|   | 714+00         | TO                     | 724+21                   | 1021                                   | 24.0 | 2,723  |      |  |   | 245  | 2,042         | Mainline             |         |         |
|   | 725+01         | TO                     | 754+07                   | 2906                                   | 24.0 | 7,749  |      |  |   | 697  | 5,812         | Mainline             |         |         |
| CARRIER MILLS LTL                                     | 747+00         | TO                     | 754+07                   | 707                                    | 12.0 | 743  |      |  |   | 67   | 707           | Turn lane            |         |         |
|   | 747+00         | TO                     | 753+50                   | 650                                    |      |  | 4.0  | 289  |   | 26   |               |                      |         |         |
| CARRIER MILLS RTL                                     | 747+00         | TO                     | 754+07                   | 707                                    | 12.0 | 743  |      |  |   | 67   | 707           | Turn lane            |         |         |
|   | 747+00         | TO                     | 753+50                   | 650                                    |      |  |      |  | 4.0   | 26   |               |                      |         |         |
| LT  | 714+00         | TO                     | 724+21                   | 1021                                   |      |  | 6.0  | 681  |   | 61   | 1,021         | Lt Shld              |         |         |
| LT  | 725+01         | TO                     | 747+00                   | 2199                                   |      |  | 6.0  | 1466   |   | 132  | 2,199         | Lt Shld              |         |         |
| RT  | 714+00         | TO                     | 724+21                   | 1021                                   |      |  |      |  | 10.0  | 102  | 1,021         | Rt Shld              |         |         |
| RT  | 725+01         | TO                     | 747+00                   | 2199                                   |      |  |      |  | 10.0  | 2443   | 2,199         | Rt Shld              |         |         |
| <b>SUB-TOTALS SALINE CO. EBL</b>                      |                |                        |                          |  |      |  |      | <b>17,083</b>  | <b>22,290</b>                                     | <b>62,035</b>  | <b>9,127</b>  | <b>89,180</b>        |         |         |
| <b>TOTALS EASTBOUND LANES</b>                         |                |                        |                          |  |      |  |      |  | <b>114,537</b>                                    |  | <b>10,309</b> | <b>101,020</b>       |         |         |

Note 1: Fiber-Modified Asphalt Crack Seal is calculated using 1 lb. of material per 2.8 lineal foot. Use 1 strip each for each lane, shoulder and turn lane on IL 13 through the length of the project, unless otherwise noted on plans.

Note 2: Bituminous Materials (Prime Coat) quantity includes shoulder and pavement areas.

PLOT DATE = 12/24/2008  
 FILE NAME = c:\pwworkspace\10001\PROJECTS\10001\FAP331\12/24/08\FAP331.dgn  
 PLOT SCALE = 1/8"=1'-0"  
 USER NAME = mcorcoran

| F.A.P. RTE.               | SECTION | COUNTY                    | TOTAL SHEETS | SHEET NO. |
|---------------------------|---------|---------------------------|--------------|-----------|
| 331                       | 2       | WILLIAMSON                | 8            | 7         |
| STA. _____                |         | TO STA. _____             |              |           |
| FED. ROAD DIST. NO. _____ |         | ILLINOIS FED. AID PROJECT |              |           |

=09\_PAVEMENT\_PRESERVATION\_EY07

PAVEMENT MARKING SCHEDULE EASTBOUND LANES

| STATION TO STATION                               | THPL PAVEMENT MARKING |               |                         |  | TEMPORARY     |                   | NOTES                         |
|--|-----------------------|---------------|-------------------------|--|---------------|-------------------|-------------------------------|
|  | 4 INCH WHITE          | 4 INCH YELLOW | 4 INCH SKIP-DASH YELLOW | LETTERS & SYMBOLS  | 4 INCH        | LETTERS & SYMBOLS |                               |
|  | FOOT                  | FOOT          | FOOT                    | SQ FT  | FOOT          | SQ FT             |                               |
| <b>Williamson Co. Eastbound Lanes</b>            |                       |               |                         |  |               |                   |                               |
| <b>CL IL 13 EBL - STA. 510+00 TO STA. 538+50</b> |                       |               |                         |  |               |                   |                               |
|  | 510+00.0              | TO            | 538+50.0                |  |               | 713               |                               |
| LT   | 510+00.0              | TO            | 522+68.0                |  |               | 1,268             | Left Edgeline                 |
| LT   | 524+61.0              | TO            | 538+50.0                |  |               | 1,389             | Left Edgeline                 |
| RT   | 510+00.0              | TO            | 538+50.0                | 2,850  |               | 2,850             | Right Edgeline                |
| LT   | 520+61.0              | TO            | 523+10.0                | 249  |               | 249               | Left Turn Lane T.R. 608       |
| T.R. 608   | 520+70.0              |               |                         |  | 20.8          |                   | "ONLY"                        |
| T.R. 608   | 520+98.0              |               |                         |  | 15.6          |                   | Left Turn Arrow               |
| <b>Sub-Totals EBL's Williamson Co.</b>           |                       |               |                         | <b>3,099</b>   | <b>2,657</b>  | <b>713</b>        | <b>36.4</b>                   |
| <b>Saline County Eastbound Lanes</b>             |                       |               |                         |  |               |                   |                               |
| <b>CL IL 13 EBL - STA. 538+50 TO STA. 714+00</b> |                       |               |                         |  |               |                   |                               |
|  | 538+50.0              | TO            | 652+25.0                |  |               | 2,844             |                               |
| LT   | 538+50.0              | TO            | 546+09.0                |  |               | 759               | Left Edgeline                 |
| RT   | 538+50.0              | TO            | 638+34.0                | 9,984  |               | 9,984             | Right Edgeline                |
| LT   | 544+04.0              | TO            | 546+54.0                | 250  |               | 250               | Left Turn Lane West Conn.     |
| LT   | 548+01.0              | TO            | 638+39.0                |  | 9,038         | 9,038             | Left Edgeline                 |
| LT   | 635+25.0              | TO            | 638+81.0                | 356  |               | 356               | Left Turn Lane Dannie Rd.     |
| RT   | 635+20.0              | TO            | 638+34.0                | 314  |               | 314               | Right Turn Lane T.R. 420      |
| LT   | 640+20.0              | TO            | 652+25.0                |  | 1,205         | 1,205             | Left Edgeline                 |
| RT   | 639+99.0              | TO            | 652+25.0                | 1,226  |               | 1,226             | Right Edgeline                |
| <b>EXIST. STRUCTURE</b>                          |                       |               |                         | <b>OMIT STR. NO. 083-0050 - STA. 652+25 TO STA. 653+70</b> |               |                   |                               |
|  | 653+70.0              | TO            | 714+00.0                |  |               | 1508              |                               |
|  | 714+00.0              | TO            | 724+21.0                |  |               | 255               |                               |
|  | 725+01.0              | TO            | 754+07.0                |  |               | 727               |                               |
| LT   | 653+70.0              | TO            | 712+18.0                |  | 5848          | 5848              | Left Edgeline                 |
| RT   | 653+70.0              | TO            | 712+12.0                | 5842   |               | 5842              | Right Edgeline                |
| LT   | 710+13.0              | TO            | 712+60.0                | 247  |               | 247               | Left Turn Lane Hawkins Rd.    |
| RT   | 710+08.0              | TO            | 712+13.0                | 205  |               | 205               | Right Turn Lane Hawkins Rd.   |
| LT   | 714+00.0              | TO            | 724+21.0                | 1021   |               | 1021              | Left Edgeline                 |
| LT   | 725+01.0              | TO            | 753+50.0                | 2849   |               | 2849              | Left Edgeline                 |
| RT   | 714+00.0              | TO            | 724+21.0                |  | 1021          | 1021              | Right Edgeline                |
| RT   | 725+01.0              | TO            | 753+50.0                |  | 2849          | 2849              | Right Edgeline                |
| LT   | 750+00.0              | TO            | 753+50.0                | 350  |               | 350               | Left Turn Lane Carrier Mills  |
| RT   | 750+00.0              | TO            | 753+50.0                | 350  |               | 350               | Right Turn Lane Carrier Mills |
| WEST CONN.                                       | 544+14.0              |               |                         |  | 20.8          | 20.8              | "ONLY"                        |
| WEST CONN.                                       | 554+42.0              |               |                         |  | 15.6          | 15.6              | Left Turn Arrow               |
| DANNIE RD.                                       | 635+35.0              |               |                         |  | 20.8          | 20.8              | "ONLY"                        |
| DANNIE RD.                                       | 637+63.0              |               |                         |  | 15.6          | 15.6              | Left Turn Arrow               |
| TR 420   | 635+30.0              |               |                         |  | 20.8          | 20.8              | "ONLY"                        |
| TR 420   | 635+58.0              |               |                         |  | 15.6          | 15.6              | Right Turn Arrow              |
| DANNIE RD.                                       | 637+21.0              |               |                         |  | 20.8          | 20.8              | "ONLY"                        |
| DANNIE RD.                                       | 637+49.0              |               |                         |  | 15.6          | 15.6              | Left Turn Arrow               |
| TR 420   | 637+16.0              |               |                         |  | 20.8          | 20.8              | "ONLY"                        |
| TR 420   | 637+44.0              |               |                         |  | 15.6          | 15.6              | Right Turn Arrow              |
| HAWKINS RD.                                      | 710+23.0              |               |                         |  | 20.8          | 20.8              | "ONLY"                        |
| HAWKINS RD.                                      | 710+51.0              |               |                         |  | 15.6          | 15.6              | Left Turn Arrow               |
| HAWKINS RD.                                      | 710+23.0              |               |                         |  | 20.8          | 20.8              | "ONLY"                        |
| HAWKINS RD.                                      | 710+51.0              |               |                         |  | 15.6          | 15.6              | Right Turn Arrow              |
| CARRIER MILLS RD.                                | 750+10.0              |               |                         |  | 20.8          | 20.8              | "ONLY"                        |
| CARRIER MILLS RD.                                | 750+38.0              |               |                         |  | 15.6          | 15.6              | Left Turn Arrow               |
| CARRIER MILLS RD.                                | 752+00.0              |               |                         |  | 20.8          | 20.8              | "ONLY"                        |
| CARRIER MILLS RD.                                | 752+28.0              |               |                         |  | 15.6          | 15.6              | Left Turn Arrow               |
| CARRIER MILLS RD.                                | 750+10.0              |               |                         |  | 20.8          | 20.8              | "ONLY"                        |
| CARRIER MILLS RD.                                | 750+38.0              |               |                         |  | 15.6          | 15.6              | Right Turn Arrow              |
| CARRIER MILLS RD.                                | 752+00.0              |               |                         |  | 20.8          | 20.8              | "ONLY"                        |
| CARRIER MILLS RD.                                | 752+28.0              |               |                         |  | 15.6          | 15.6              | Right Turn Arrow              |
| <b>Sub-Totals EBL's Saline Co.</b>               |                       |               |                         | <b>22,994</b>  | <b>20,720</b> | <b>5,334</b>      | <b>400.4</b>                  |
| <b>TOTALS EASTBOUND LANES</b>                    |                       |               |                         | <b>55,517</b>  | <b>436.8</b>  | <b>55,517</b>     | <b>436.8</b>                  |

PLOT DATE = 12/29/2008  
 FILE NAME = c:\pwworkspace\PROJECTS\2008\DRWING\98995\98995.dwg  
 USER = jmm  
 PLOT DEVICE = HP DesignJet 5000 Series



| F.A.P. RTE.               | SECTION | COUNTY                    | TOTAL SHEETS | SHEET NO. |
|---------------------------|---------|---------------------------|--------------|-----------|
| 331                       | 2       | WILLIAMSON                | 8            | 8         |
| STA. _____                |         | TO STA. _____             |              |           |
| FED. ROAD DIST. NO. _____ |         | ILLINOIS FED. AID PROJECT |              |           |

#09\_PAVEMENT\_PRESERVATION\_EYQZ

LOCATION MAP  
 FAP 331 (IL 13) AT WILLIAMSON/SALINE CO. LINE  
 EASTBOUND LANES ONLY

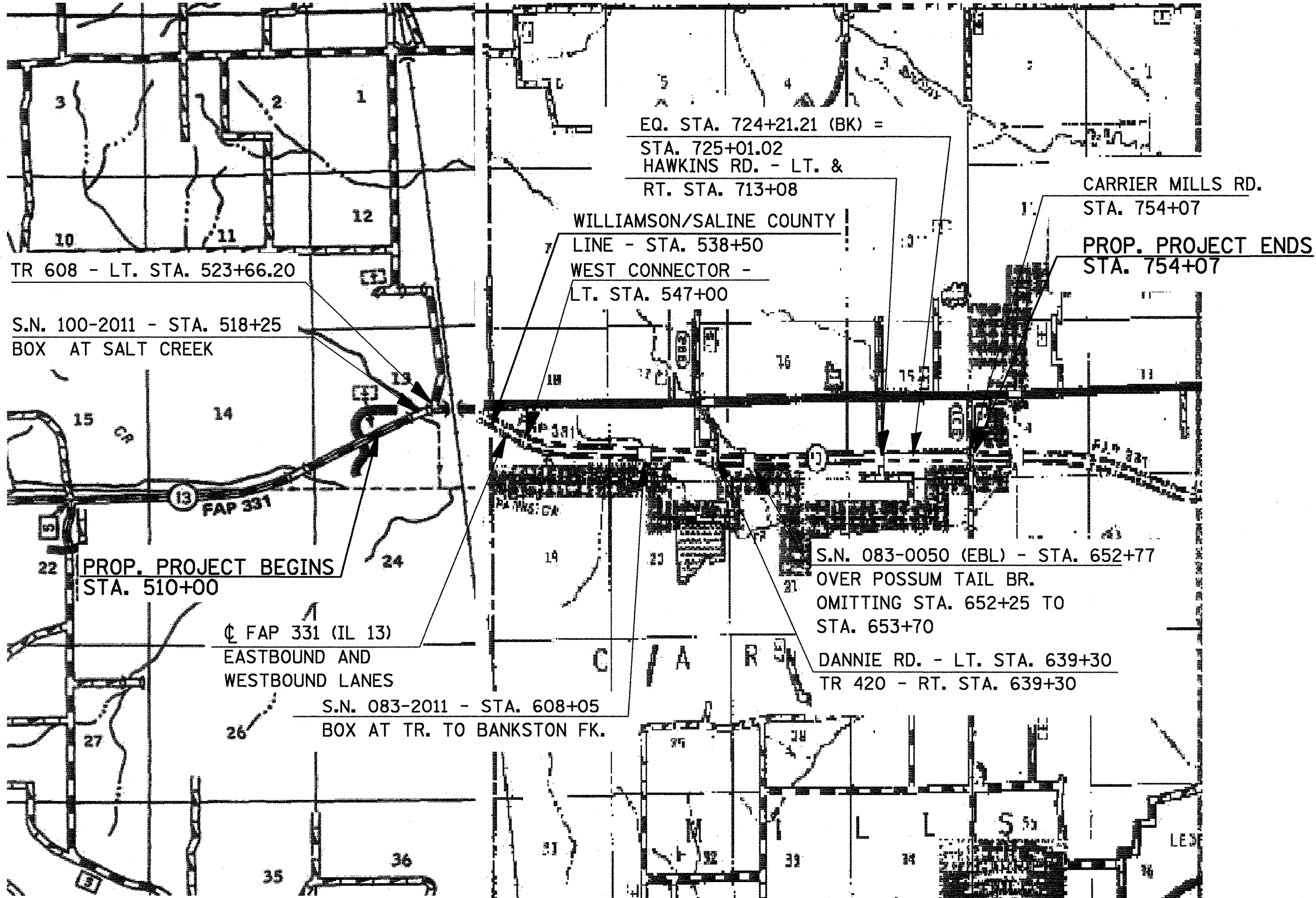

PLOT DATE = 12/29/2008  
 PLOT SCALE = 1/8" = 100'  
 USER NAME = mcorcoran

FAP 331 (IL 13) EASTBOUND LANES PROJECT LOCATION MAP