

F.A.P. RTE.	SECTION	COUNTY	TOTAL SHEETS	SHEET NO.
331		WILLIAMSON	8	1

D9 PAVEMENT PRESERVATION FY09-1

STATE OF ILLINOIS
DEPARTMENT OF TRANSPORTATION
DIVISION OF HIGHWAYS

**PROPOSED
HIGHWAY PLANS**

FAP ROUTE 331 (IL 13)
SECTION D9 PAVT PRESERVATION FY09-1

WILLIAMSON AND SALINE COUNTIES
C-99-069-08

D-99-051-08

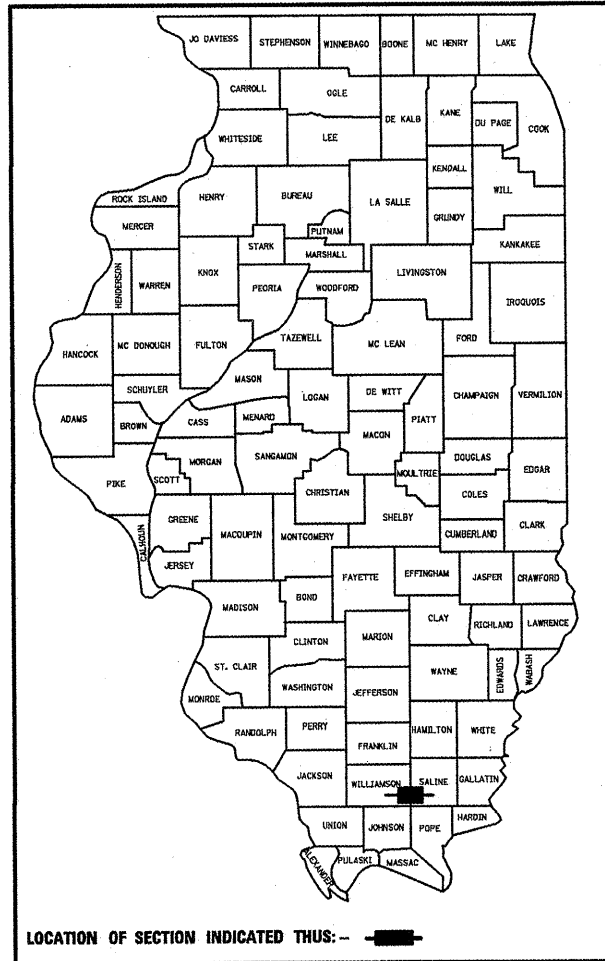

FOR INDEX OF SHEETS, SEE SHEET NO. 3

ADT (2007) 8700
PV = 7975
MU = 375
SU = 350
TRUCK % = 8.3%

PROP. PROJECT - IL 13 (EBL) STA. 510+00 TO STA. 538+50
IN WILLIAMSON COUNTY (EBL'S ONLY);
STA. 538+50 TO STA. 754+07 IN SALINE COUNTY (EBL'S ONLY)

EQUATION STATIONS:
Eq. Sta. 724+21.21 (Bk.) =
Sta. 725+01.02 (Ah.)

TOWNSHIPS: CRAB ORCHARD, CARRIER MILLS

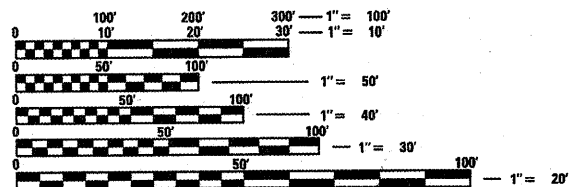

FULL SIZE PLANS HAVE BEEN PREPARED USING STANDARD ENGINEERING SCALES. REDUCED SIZED PLANS WILL NOT CONFORM TO STANDARD SCALES. IN MAKING MEASUREMENTS ON REDUCED PLANS, THE ABOVE SCALES MAY BE USED.

J.U.L.I.E.
JOINT UTILITY LOCATION INFORMATION FOR EXCAVATION
1-800-892-0123

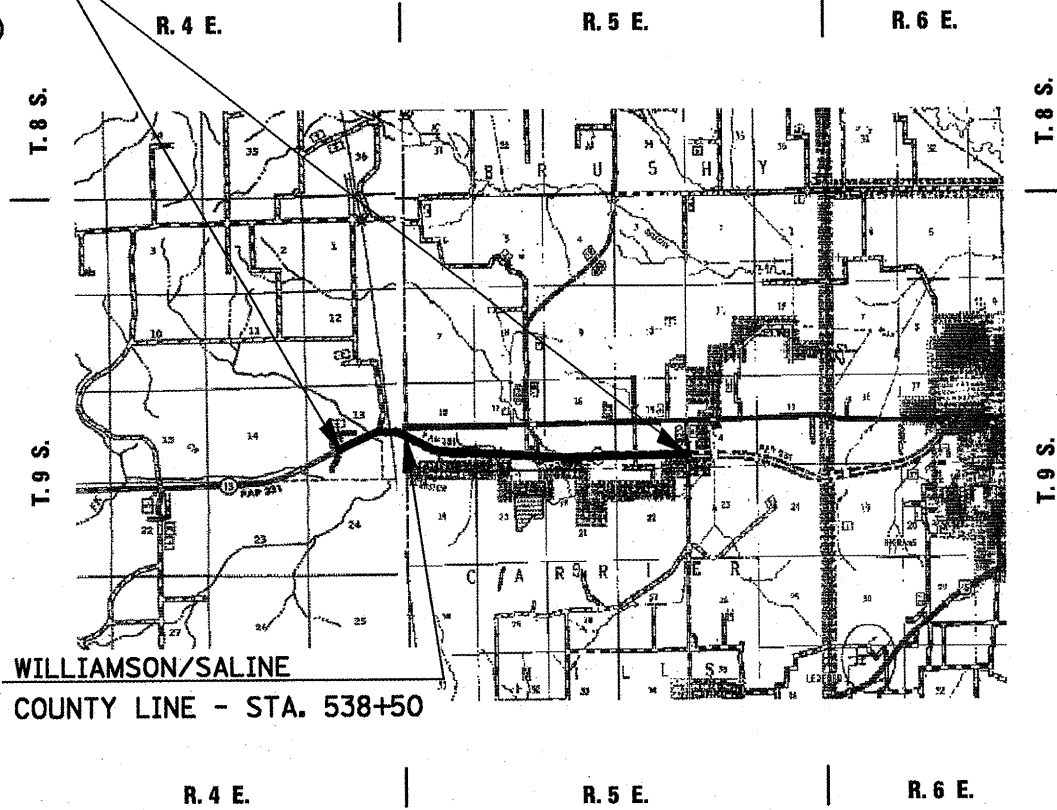

STATE OF ILLINOIS
DEPARTMENT OF TRANSPORTATION
DIVISION OF HIGHWAYS

SUBMITTED *Jan 9, 2009*
Ma Chami
DEPUTY DIRECTOR OF HIGHWAYS, REGION ENGINEER

March 27, 2009
Charles J. Ingersoll
ENGINEER OF DESIGN AND ENVIRONMENT

March 27, 2009
Christine M. Reed
DIRECTOR OF HIGHWAYS, CHIEF ENGINEER

**PRINTED BY THE AUTHORITY
OF THE STATE OF ILLINOIS**

PROJECT ENGINEER: CHARLES STEIN - (618) 351-5210
DESIGNER: KATHI MCCORD - (618) 351-5216

CONTRACT NO. 78082

LENGTH OF PROJECT: 24,182 FT. = 4.58 MILES