

STATE OF ILLINOIS  
DEPARTMENT OF TRANSPORTATION  
DIVISION OF HIGHWAYS

PROPOSED  
HIGHWAY PLANS

FAI ROUTE 74  
SECTION (57-21B)BR  
PROJECT IM-074-5 (159) 137  
BRIDGE REHABILITATION  
LITTLE KICKPOO CREEK 1.1 MI E OF US 51  
MCLEAN COUNTY

C-95-011-07  
R2E, 3RD P.M.

F.A.I. RTE.	SECTION	COUNTY	TOTAL SHEETS	SHEET NO.
74	(57-21B)BR	MCLEAN	61	1
		ILLINOIS	CONTRACT NO. 70641	

\* 61 + 1 = 62

D-95-011-07

FOR INDEX OF SHEETS, SEE SHEET NO. 2



SECTION (57-21B)BR  
PROJECT BEGINS  
STA. 779+00.00

SECTION (57-21B)BR  
PROJECT ENDS  
STA. 782+28.40

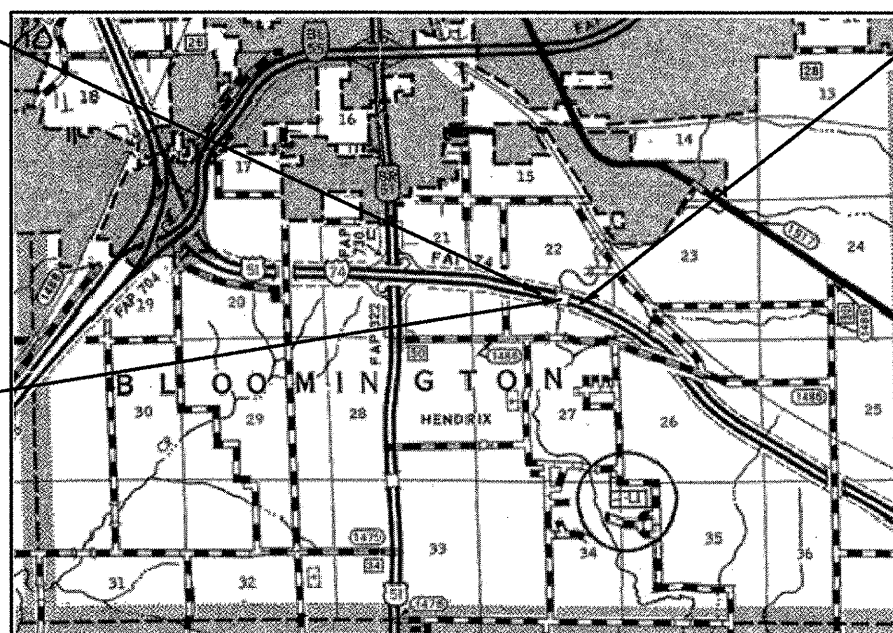

SUPERSTRUCTURE REPLACEMENTS  
EX. S.N. 057-0120 (EB), 057-0121 (WB)  
STA. 780+48.43  
161'-7" BK. TO BK. ABUT.  
EX. 42'-0" 0-0, PR. 43'-2" 0-0  
0° SKEW

GROSS LENGTH = 328.40 FT. = 0.062 MILE  
NET LENGTH = 328.40 FT. = 0.062 MILE

TRAFFIC:  
ADT(2008) = 18,000  
P.C. = 52.9%  
S.U. = 6.6%  
M.U. = 40.5%

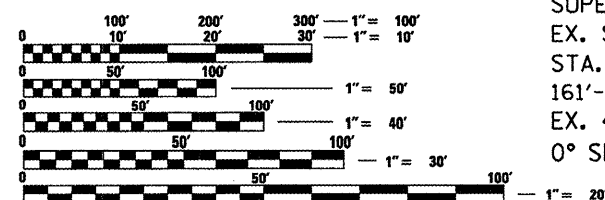

FULL SIZE PLANS HAVE BEEN PREPARED USING STANDARD  
ENGINEERING SCALES. REDUCED SIZED PLANS WILL NOT  
CONFORM TO STANDARD SCALES. IN MAKING MEASUREMENTS  
ON REDUCED PLANS, THE ABOVE SCALES MAY BE USED.

J.U.L.I.E.  
JOINT UTILITY LOCATION INFORMATION FOR EXCAVATION  
1-800-892-0123  
OR 811  
BLOOMINGTON TOWNSHIP

PROJECT ENGINEER: NANCY FASIG (217) 465-4181  
SQUAD LEADER: JASON STULTS

CONTRACT NO. 70641

STATE OF ILLINOIS  
DEPARTMENT OF TRANSPORTATION  
DIVISION OF HIGHWAYS

SUBMITTED 1/30 20 09  
Joseph E. Cooney  
DEPUTY DIRECTOR OF HIGHWAYS, REGION ENGINEER  
March 27, 20 09  
Charles J. Ingersoll  
ENGINEER OF DESIGN AND ENVIRONMENT  
March 27, 20 09  
Christine M. Reed  
DIRECTOR OF HIGHWAYS, CHIEF ENGINEER

PRINTED BY THE AUTHORITY  
OF THE STATE OF ILLINOIS