

| | | | | |
|-----------------------|-----------|---------------------------|--------------|-----------|
| F.A.I. RTE. | SECTION | COUNTY | TOTAL SHEETS | SHEET NO. |
| 57 | 1920.1B-R | COOK | 101 | 018 |
| STA. | | TO STA. | | |
| FED. ROAD DIST. NO. 1 | | ILLINOIS FED. AID PROJECT | | |
| CONTRACT NO. 62533 | | | | |

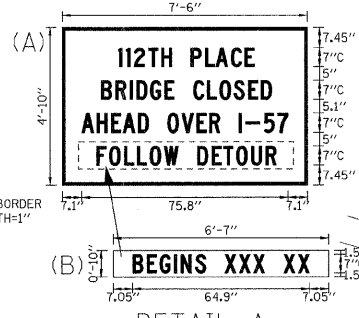

1. ERECT SIGN (A) WITH INSTALLED PANEL (B) TWO WEEKS PRIOR TO THE START OF CONSTRUCTION.
2. REMOVE PANEL (B) SOON AFTER THE START OF CONSTRUCTION
3. SEE SPECIAL PROVISIONS FOR "TEMPORARY INFORMATION SIGNING" FOR ADDITIONAL INFORMATION.
4. ONE SIGN ASSEMBLY EQUALS 41.75 SQ FT.
5. USE APPROPRIATE MONTH AND DATE FOR CONTRACT ON SIGN PANEL (B).
6. SHALL BE PAID FOR AS TEMPORARY INFORMATION SIGNING.

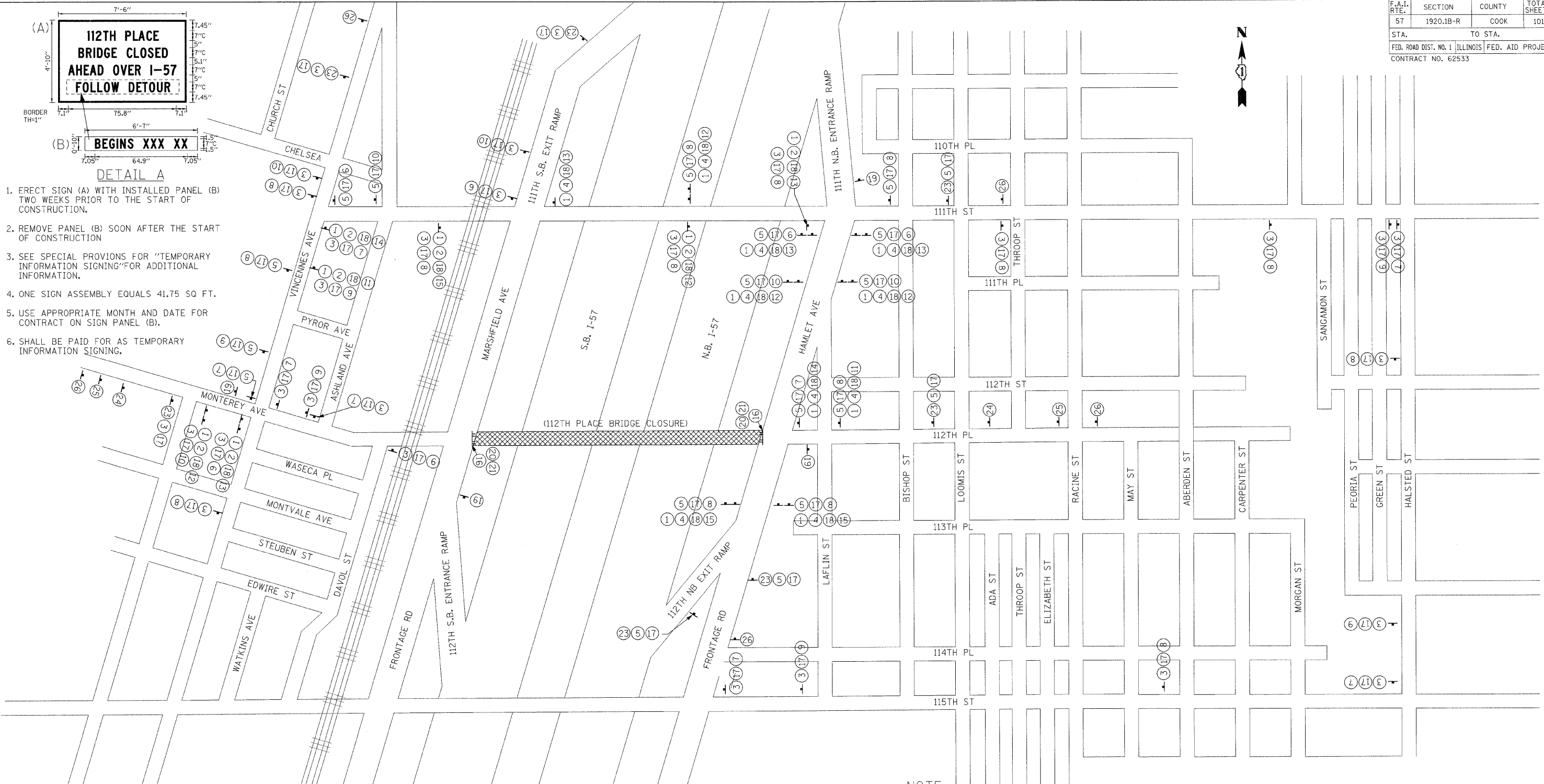

HECHTER
 1-6-2009, 13:46:54
 T:\DOCUMENT\930806\CIVIL\IGN\MOT0005X-DGN
 1 2 3 4 5 6 7 8 9 10 11 12 13 14 15 16 17 18 19 20 21 22 23 24 25 26 27 28 29 30 31 32 33 34 35 36 37 38 39 40 41 42 43 44 45 46 47 48 49 50 51 52 53 54 55 56 57 58 59 60 61 62

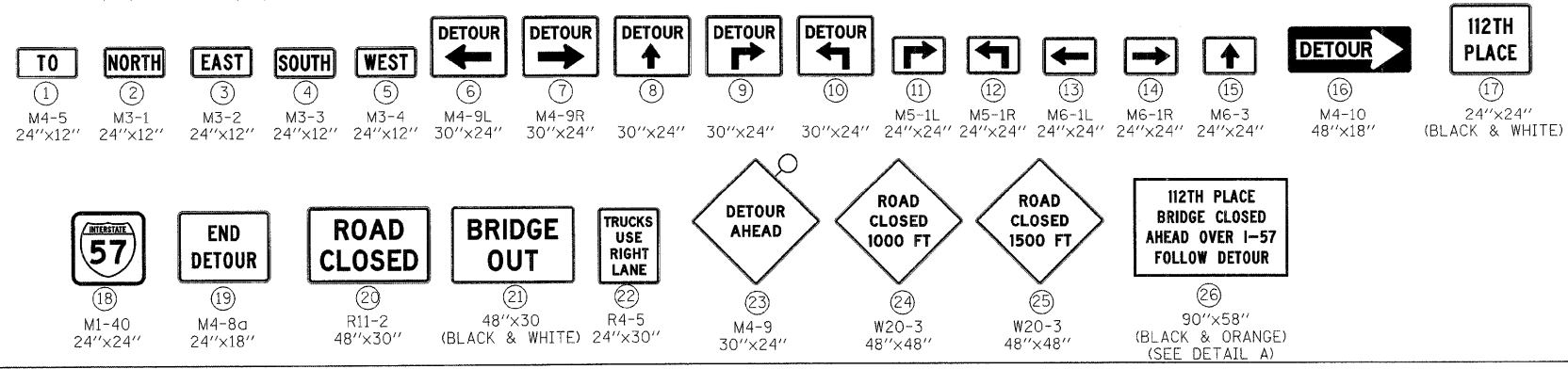

- NOTE:**
- 1) DISTANCE BETWEEN DETOUR SIGN PLACEMENT SHALL PER THE FINAL APPROVAL OF THE ENGINEER.
 - 2) FIRST TWO "WARNING" SIGNS IN A SEQUENCE SHALL HAVE A MONODIRECTIONAL LIGHT.
 - 3) SIGN SEQUENCES READ LEFT TO RIGHT REPRESENT TOP TO BOTTOM STACKING. IF TWO STACKS OF DETOURS SIGNS ARE TO BE MOUNTED AT THE SAME LOCATION THE TOP SIGN SEQUENCE SHALL BE PLACED ON THE LEFT.
 - 4) THE COST OF DETOUR SIGNING WILL NOT BE PAID FOR SEPARATELY BUT SHALL BE CONSIDERED AS INCLUDED IN THE CONTRACT UNIT PRICE FOR MAINTENANCE OF TRAFFIC UNLESS OTHERWISE NOTED.
 - 5) SIGN SHALL BE FURNISHED AND INSTALLED TWO (2) WEEKS PRIOR TO CLOSING 112TH PLACE BRIDGE.

LEGEND
 F TYPE III BARRICADE WITH TWO FLASHING LIGHTS
 T TRAFFIC SIGN (AS NOTED)

| REVISIONS | |
|-----------|------|
| NAME | DATE |
| | |
| | |
| | |
| | |
| | |
| | |
| | |

ILLINOIS DEPARTMENT OF TRANSPORTATION
 112TH PLACE OVER
 F.A.I. ROUTE 57 (INTERSTATE 57)
**112TH PL BRIDGE DECK
 RECONSTRUCTION
 SUGGESTED DETOUR PLANS**
 SCALE: N.T.S. DRAWN BY: BRH
 DATE: 01/16/09 CHECKED BY: ACL

TENG TENG & ASSOCIATES, INC.
 ENGINEERS/ARCHITECTS/PLANNERS
 208 N. MICHIGAN AVE., CHICAGO, IL 60601
 TELEPHONE: 312/616-0000