

DATE: \_\_\_\_\_ BY: \_\_\_\_\_  
 SURVEYED: \_\_\_\_\_ PLOTTED: \_\_\_\_\_  
 G.M. NOTED: \_\_\_\_\_ RT. OF WAY CHECKED: \_\_\_\_\_  
 STRUCTURE NOTATIONS: \_\_\_\_\_ CADD FILE NAME: \_\_\_\_\_  
 PROFILE: \_\_\_\_\_ PLAN: \_\_\_\_\_  
 NOTE BOOK NO.: \_\_\_\_\_  
 CHRISTOPHER B. BURKE ENGINEERING LTD.  
 8575 West Higgins Road, Suite 600  
 Rosemont, Illinois 60018  
 (847) 823-0500

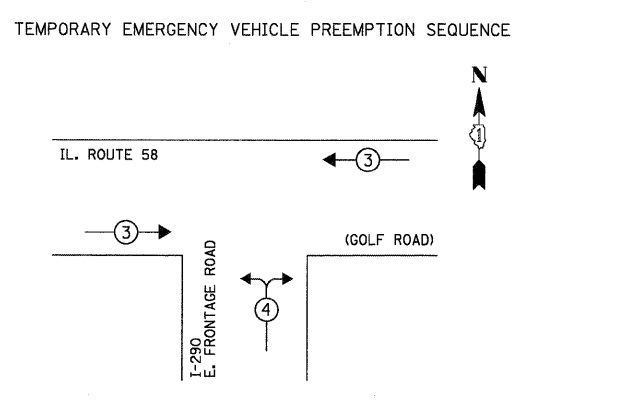

TEMPORARY EMERGENCY VEHICLE PREEMPTORS		
EMERGENCY VEHICLE PREEMPTOR	3	4
MOVEMENT	← →	↔

- CONSTRUCTION NOTES:
- UTILIZE EXISTING ADVANCED DETECTOR AND CONFIRMATION BEACON WITH TEMPORARY TRAFFIC SIGNAL INSTALLATION.
  - UTILIZED EXISTING TRAFFIC SIGNAL HEAD FOR TEMPORARY TRAFFIC SIGNAL INSTALLATION.

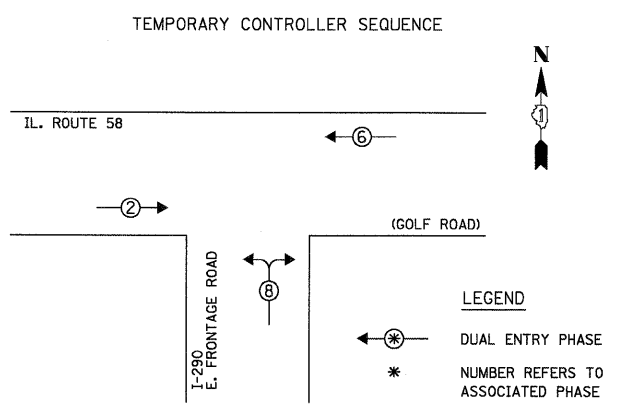
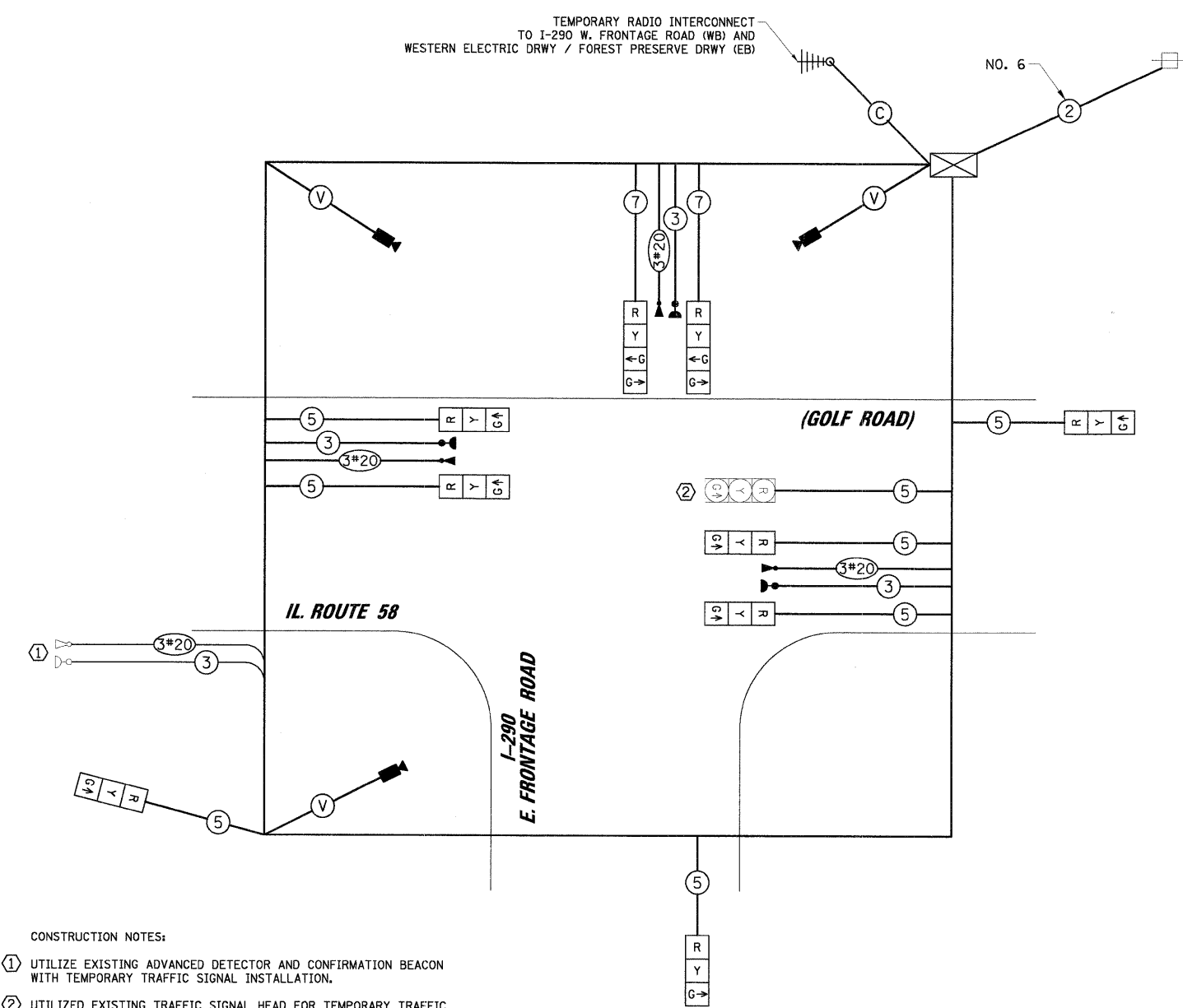

- TEMPORARY CABLE DIAGRAM LEGEND
- R TEMPORARY TRAFFIC SIGNAL SECTION OR PEDESTRIAN SIGNAL SECTION 12" (300mm)
  - X TEMPORARY CONTROLLER CABINET
  - TEMPORARY SERVICE INSTALLATION
  - ⑤ INDICATES NUMBER OF CONDUCTORS IN CABLE. ALL CONDUCTORS TO BE NUMBER 14 AWG WIRE UNLESS OTHERWISE NOTED.
  - ▶ EMERGENCY VEHICLE LIGHT DETECTOR
  - ▶ CONFIRMATION BEACON
  - VEHICLE DETECTOR, INDUCTION LOOP
  - ⊙ PEDESTRIAN PUSHBUTTON DETECTOR
  - ⊙ 12" (300mm) PEDESTRIAN SIGNAL SECTION
  - ▶ VIDEO DETECTION CAMERA
  - ⊙ VENDOR CABLE
  - ⊕ TEMPORARY RADIO INTERCONNECT
  - ⊙ COAXIAL CABLE

I.D.O.T. TRAFFIC SIGNAL INSTALLATION ELECTRICAL SERVICE REQUIREMENTS					TOTAL WATTAGE
TYPE	NO. OF LAMPS	WATTAGE INCAND.	LED % OPERATION		
SIGNAL (RED)	10	17	0.50	85.00	
(YELLOW)	10	25	0.25	62.50	
(GREEN)	12	15	0.25	45.00	
ARROW	2	12	0.10	2.40	
PED. SIGNAL	-	25	1.00	-	
CONTROLLER	1	100	1.00	100.00	
ILLUM. SIGN	-	25	0.05	-	
VIDEO SYSTEM	1	150	1.00	150.00	
FLASHER			0.50		

ENERGY COSTS TO: TOTAL = 444.90

ILLINOIS DEPARTMENT OF TRANSPORTATION  
 DIVISION OF HIGHWAY/DISTRICT 1  
 201 WEST CENTER COURT/SCHAUMBURG, ILLINOIS 60196-1096

ENERGY SUPPLY: CONTACT: MARK GLOECK  
 PHONE: (630) 691-4529  
 COMPANY: COMED

FOUNDATION (DEPTH)	FT. (m)	CABLE SLACK	FT. (m)	VERTICAL	FT. (m)
TYPE A - POST	4 (1.2)	HANDHOLE	6.5 (2.0)	ALL FOUNDATIONS	3.5 (1.0)
C - CONTROLLER W/ UPS	4 (1.2)	DOUBLE HANDHOLE	13 (4.0)	MAST ARM (L) POLE	20'±L-2=
D - CONTROLLER	4 (1.2)	SIGNAL POST	2 (1.0)	(6m±L-0.6m)=	
E - M. ARM POLE		CONTROLLER CAB.	1 (0.5)	BRACKET MOUNTED	13 (4.0)
30" (750mm)	15 (4.6)	FIBER OPTIC	13 (4.0)	PED. PUSHBUTTON	6 (1.8)
36" (900mm)	15 (4.6)	ELECTRIC SERVICE	1 (0.5)	ELECTRIC SERVICE	13.5 (4.1)
42" (1050mm)	25 (7.6)	GROUND CABLE	1 (0.5)	SERVICE TO GROUND	13.5 (4.1)
				POST MOUNTED	6 (1.8)

TEMPORARY CABLE PLAN

NOTE:  
 THE TRAFFIC SIGNAL CONTROLLER EQUIPMENT FOR THIS PROJECT SHALL BE "ECONOLITE" TO MATCH THE EXISTING ADJACENT SYSTEM.

RESTORATION OF WORK AREA. RESTORATION OF THE TRAFFIC SIGNAL WORK AREA SHALL BE INCIDENTAL TO THE RELATED PAY ITEM SUCH AS FOUNDATION, CONDUIT, HANDHOLE, TRENCH AND BACKFILL, ETC., AND NO EXTRA COMPENSATION SHALL BE ALLOWED. ALL ROADWAY SURFACES SUCH AS SHOULDERS, MEDIANS, SIDEWALKS, PAVEMENT, ETC. SHALL BE REPLACED IN KIND. ALL DAMAGE TO MOWED LAWNS SHALL BE REPLACED WITH AN APPROVED SOD, AND ALL DAMAGE TO UNMOWED FIELDS SHALL BE SEEDING IN ACCORDANCE WITH STANDARD SPECIFICATIONS 252 AND 250 RESPECTIVELY.