

**EXISTING EQUIPMENT TO BE REMOVED**

- ◀ EXISTING TRAFFIC SIGNAL HEAD TO BE REMOVED
- "E" ■ EXISTING SERVICE INSTALLATION TO BE REMOVED
- "E" ○ EXISTING SIGNAL POST AND FOUNDATION TO BE REMOVED
- ◀ "E" ○ EXISTING ALUMINUM MAST ARM POLE AND FOUNDATION TO BE REMOVED
- ⊠ EXISTING CONTROLLER AND FOUNDATION TO BE REMOVED
- "E" □ EXISTING HANDHOLE TO BE REMOVED
- EXISTING PEDESTRIAN SIGNAL HEAD TO BE REMOVED
- ⊙ EXISTING PEDESTRIAN PUSHBUTTON TO BE REMOVED
- ◀ ○ EXISTING EMERGENCY VEHICLE LIGHT DETECTOR TO BE REMOVED
- ○ EXISTING CONFIRMATION BEACON TO BE REMOVED
- "E" ■ EXISTING HEAVY-DUTY HANDHOLE TO BE REMOVED
- "E" EXISTING STEEL MAST ARM POLE AND FOUNDATION TO BE REMOVED

**TEMPORARY TRAFFIC SIGNAL LEGEND**

- ◀ TEMPORARY TRAFFIC SIGNAL HEAD SPAN WIRE MOUNTED ORIGINAL LOCATION
- ◀ TEMPORARY TRAFFIC SIGNAL HEAD SPAN WIRE MOUNTED SECONDARY LOCATION
- ⊗ TEMPORARY WOOD POLE (CLASS 5 OR BETTER) 45 FOOT (13.7m) MINIMUM.
- ⊠ TEMPORARY CONTROLLER CABINET
- TEMPORARY SPAN WIRE, TETHER WIRE, AND CABLE
- TEMPORARY SERVICE INSTALLATION
- TEMPORARY PEDESTRIAN SIGNAL HEAD, BRACKET MOUNTED
- ⊙ PEDESTRIAN PUSHBUTTON DETECTOR
- ◀ ○ EMERGENCY VEHICLE LIGHT DETECTOR
- ◀ ○ CONFIRMATION BEACON
- VEHICLE DETECTOR, INDUCTION LOOP
- G.S. CONDUIT IN GROUND
- HANDHOLE
- HEAVY DUTY HANDHOLE
- ⊗ LUMINAIRE
- VIDEO DETECTION CAMERA
- DOME PAN/TILT/ZOOM (PTZ) CAMERA
- "A" ABANDON

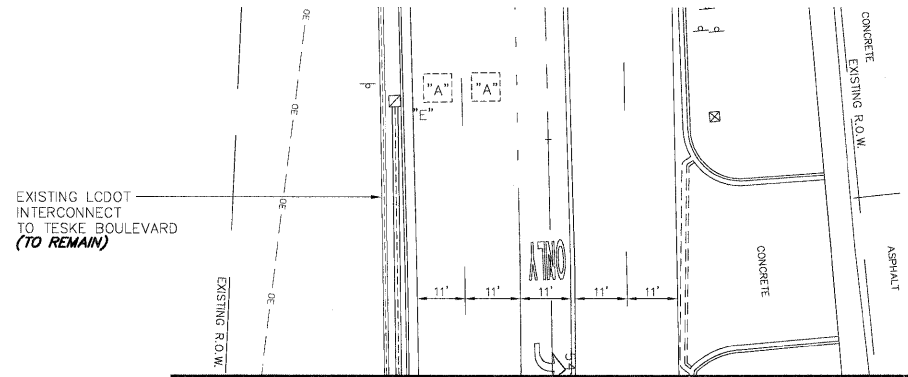

**WASHINGTON STREET  
MATCH LINE STA. 54+00  
(SEE SHEET 15)**

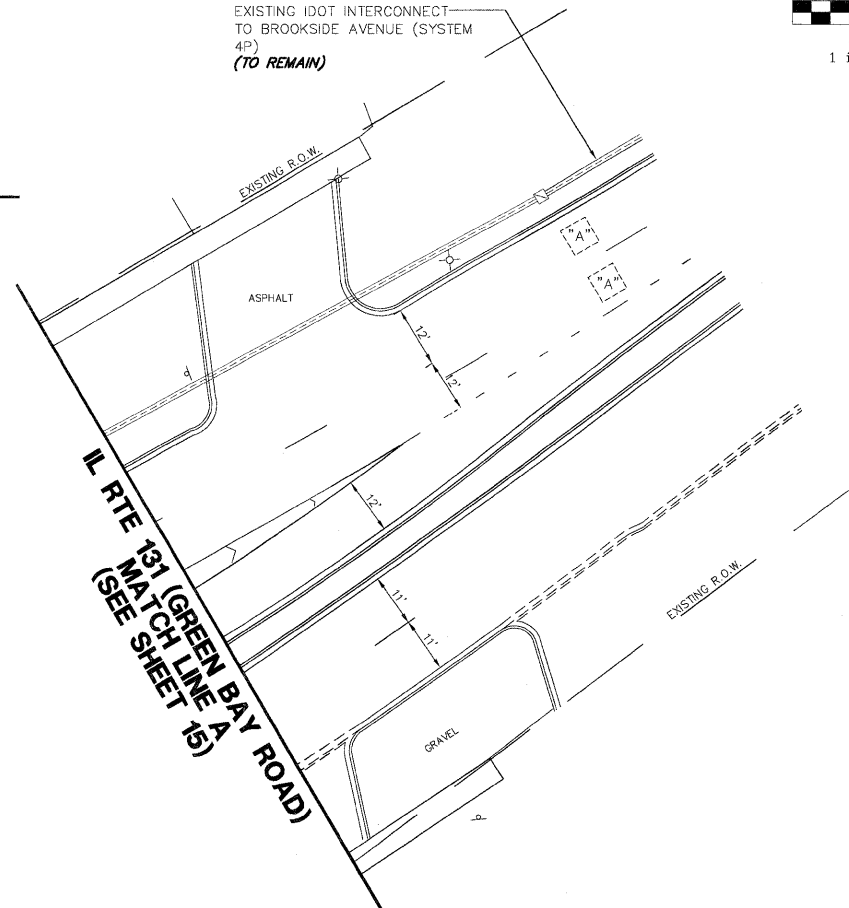

**IL RTE 131 (GREEN BAY ROAD)  
MATCH LINE A  
(SEE SHEET 15)**

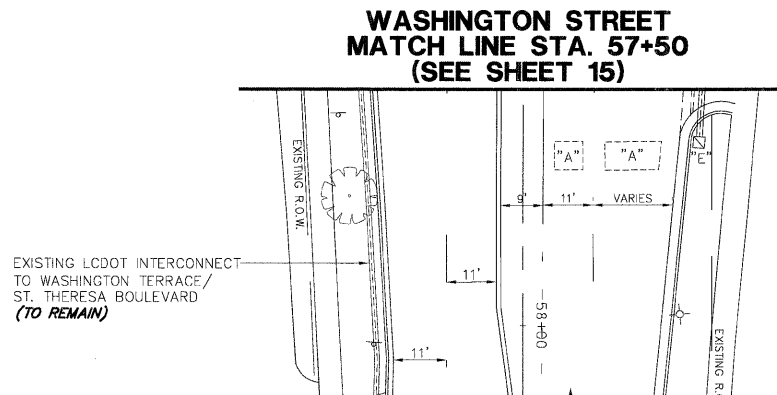

**WASHINGTON STREET  
MATCH LINE STA. 57+50  
(SEE SHEET 15)**

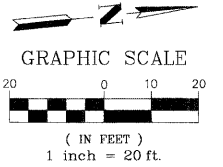

THE TRAFFIC SIGNAL CONTROL EQUIPMENT FOR THIS PROJECT SHALL BE "NTCIP" COMPLIANT.

FILE NAME = 4085.800-TR1.dgn	USER NAME =	DESIGNED - JRD	REVISED -	STATE OF ILLINOIS DEPARTMENT OF TRANSPORTATION	TEMPORARY TRAFFIC SIGNAL INSTALLATION AND REMOVAL OF EXISTING TRAFFIC SIGNAL EQUIPMENT ILL RTE 131 (GREEN BAY RD.) AND WASHINGTON STREET	F.A.U. RTE. 2711	SECTION 2009-005 TS	COUNTY 097(LAKE)K	TOTAL SHEETS 21	SHEET NO. 16	
	PLOT SCALE = 1"=20'	CHECKED - KLB	REVISED -		SCALE: 1"=20'	SHEET NO. 16 OF 21 SHEETS	STA.	TO STA.	CONTRACT NO. 60601		
	PLOT DATE = 1/29/09	DATE - 1/29/09	REVISED -		GHA #4085.806						
ILLINOIS FED. AID PROJECT											