

PREPARED BY:
CEMCOON, Ltd.
 Consulting Engineers, Land Surveyors & Planners
 2170 Highway 111/101, Unit 100
 Aurora, Ontario M0A 1A6
 Tel: 416-754-1100 Fax: 416-754-1101
 Ph: 630.862.2100 Fax: 630.862.2199
 E-Mail: cee@cemcoon.com Website: www.cemcoon.com

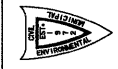

FOR INFORMATION ONLY

INTERCONNECT SCHEMATIC LEGEND

| | |
|----------------------------------------------------------------------------------------------|-------------------------------------|
| EXISTING INTERSECTION CONTROLLER | <input checked="" type="checkbox"/> |
| PROPOSED INTERSECTION CONTROLLER | <input checked="" type="checkbox"/> |
| EXISTING MASTER CONTROLLER | EMC |
| PROPOSED MASTER CONTROLLER | MC |
| MASTER MASTER CONTROLLER | MMC |
| EXISTING INTERSECTION & SAMPLING (SYSTEM) DETECTORS | <input type="checkbox"/> |
| PROPOSED INTERSECTION & SAMPLING (SYSTEM) DETECTORS | <input type="checkbox"/> |
| EXISTING INTERSECTION LOOP DETECTORS | P |
| PROPOSED SAMPLING (SYSTEM) DETECTORS | PS |
| EXISTING SAMPLING (SYSTEM) DETECTORS | ES |
| PROPOSED SAMPLING (SYSTEM) DETECTORS | PS |
| EXISTING SAMPLING (SYSTEM) DETECTORS, PROPOSED INTERSECTION AND SAMPLING (SYSTEM) DETECTORS. | ESP |
| EXISTING SAMPLING (SYSTEM) DETECTORS, PROPOSED SAMPLING (SYSTEM) DETECTORS. | ESPS |
| EXISTING PREFORMED INTERSECTION & SAMPLING (SYSTEM) DETECTORS | IPD |
| PROPOSED PREFORMED INTERSECTION & SAMPLING (SYSTEM) DETECTORS | PD |
| EXISTING SAMPLING (SYSTEM) PREFORMED DETECTORS | ESPD |
| PROPOSED SAMPLING (SYSTEM) PREFORMED DETECTORS | PSPD |
| EXISTING FIBER OPTIC CABLE IN CONDUIT, NO. 62.5/125, MM12F SM24F | 36 |
| PROPOSED FIBER OPTIC CABLE IN CONDUIT, NO. 62.5/125, MM12F SM24F | 36 |
| EXISTING FIBER OPTIC CABLE IN CONDUIT, NO. 62.5/125, MM12F SM12F | 24 |
| PROPOSED FIBER OPTIC CABLE IN CONDUIT, NO. 62.5/125, MM12F SM12F | 24 |
| EXISTING INTERCONNECT CABLE - NO. 62.5/125 12F FIBER OPTIC CABLE | 12 |
| PROPOSED INTERCONNECT CABLE - NO. 62.5/125 12F FIBER OPTIC CABLE | 12 |
| EXISTING INTERCONNECT CABLE - NO. 18 3 PAIR TWISTED, SHIELDED | 6 |
| PROPOSED INTERCONNECT CABLE - NO. 18 3 PAIR TWISTED, SHIELDED | 6 |
| EXISTING LOOP DETECTOR CABLE 2/C TWISTED, SHIELDED | 2 |
| PROPOSED LOOP DETECTOR CABLE 2/C TWISTED, SHIELDED | 2 |
| EXISTING ELECTRIC CABLE, 1/C (AS SPECIFIED) | 1 |
| PROPOSED ELECTRIC CABLE, 1/C (AS SPECIFIED) | 1 |
| EXISTING TELEPHONE CONNECTION | T |
| PROPOSED TELEPHONE CONNECTION | T |

MATCHLINE D-D
(SEE SHEET NO. 54)

MATCHLINE E-E

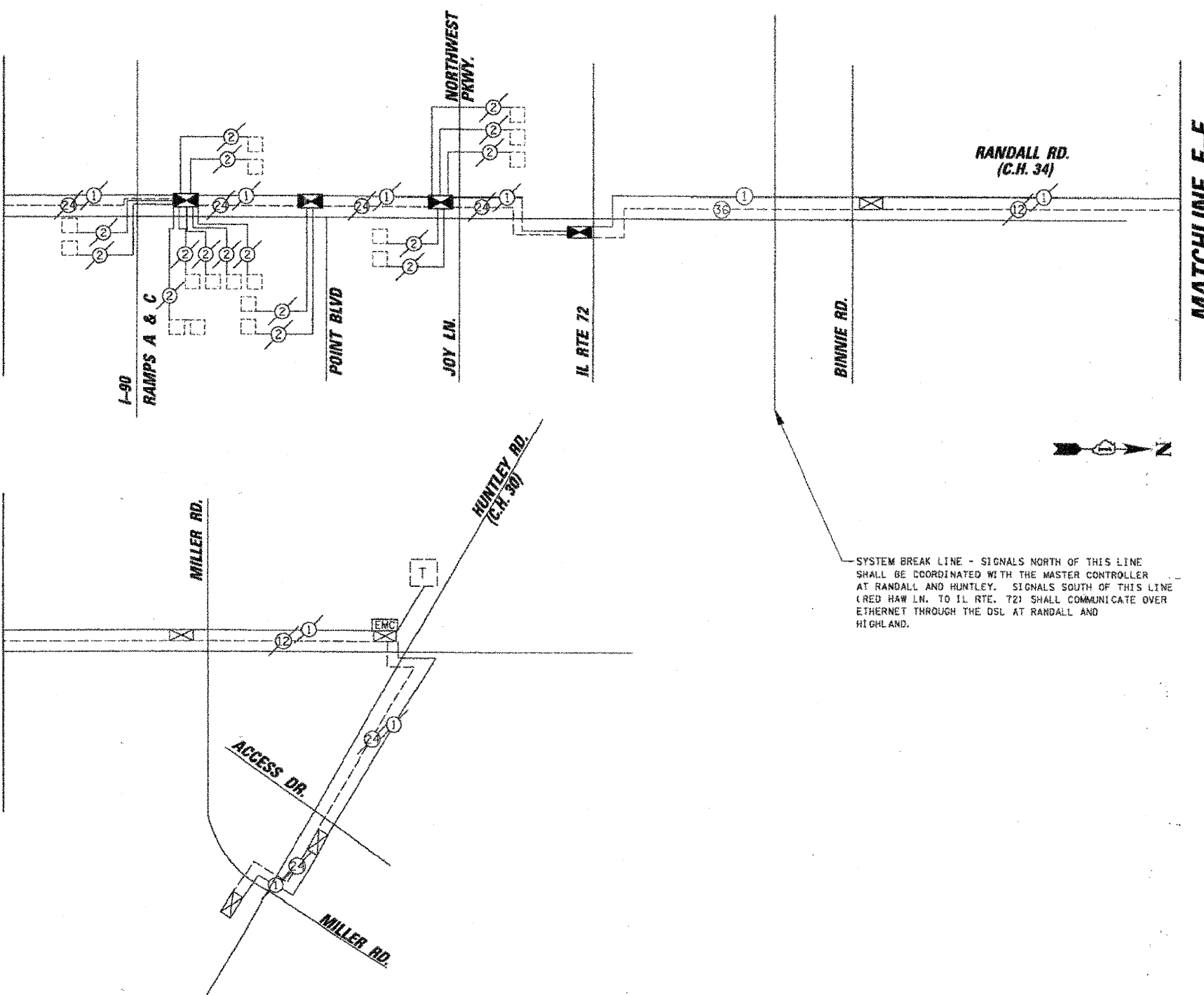

SYSTEM BREAK LINE - SIGNALS NORTH OF THIS LINE SHALL BE COORDINATED WITH THE MASTER CONTROLLER AT RANDALL AND HUNTLEY. SIGNALS SOUTH OF THIS LINE (RED HAW LN. TO IL RTE. 72) SHALL COMMUNICATE OVER ETHERNET THROUGH THE DSL AT RANDALL AND HIGHLAND.

| PROFILE | DATE | BY |
|----------|------|----|
| DESIGNED | DATE | BY |
| DRAWN | DATE | BY |
| CHECKED | DATE | BY |
| NOTED | DATE | BY |

| PLAN | DATE | BY |
|----------|------|----|
| DESIGNED | DATE | BY |
| DRAWN | DATE | BY |
| CHECKED | DATE | BY |
| NOTED | DATE | BY |

| PLAN | DATE | BY |
|----------|------|----|
| DESIGNED | DATE | BY |
| DRAWN | DATE | BY |
| CHECKED | DATE | BY |
| NOTED | DATE | BY |

| | | | |
|---------------------------------------------------|----------------------|------------|-----------|
| FILE NAME = N:\mancounty\078616\Traffic\ISCH2.dgn | USER NAME = NWILLIAM | DESIGNED - | REVISED - |
| | | DRAWN - | REVISED - |
| PLOT SCALE = 28' | | CHECKED - | REVISED - |
| PLOT DATE = 1/28/2008 | | DATE - | REVISED - |

STATE OF ILLINOIS
DEPARTMENT OF TRANSPORTATION

INTERCONNECT SCHEMATIC

RANDALL ROAD FROM RED HAW LN. TO IL ROUTE 72

SCALE:

| F.A.P. RTE. | SECTION | COUNTY | TOTAL SHEETS | SHEET NO. |
|-----------------------------------------------|----------------|--------|--------------|-----------|
| 336 | 06-00346-00-TL | KANE | 69 | 55 |
| CONTRACT NO. 63011 | | | | |
| FED. ROAD DIST. NO. ILLINOIS FED. AID PROJECT | | | | |

| | | | |
|-----------------------------------------------------|-----------------|------------|-----------|
| FILE NAME = J:\MICROST\352869\XX-INTERCONNECT02.dgn | USER NAME = JGC | DESIGNED - | REVISED - |
| | | DRAWN - | REVISED - |
| PLOT SCALE = 1"=20' | | CHECKED - | REVISED - |
| PLOT DATE = 01-23-09 | | DATE - | REVISED - |

STATE OF ILLINOIS
DEPARTMENT OF TRANSPORTATION

INTERCONNECT SCHEMATIC

RANDALL ROAD FROM RED HAW LN. TO IL ROUTE 72

SCALE: N.T.S.

SHEET NO. OF SHEETS STA. TO STA.

| F.A.P. RTE. | SECTION | COUNTY | TOTAL SHEETS | SHEET NO. |
|-----------------------------------------------|-------------|--------|--------------|-----------|
| | 2009-003 TS | KANE | 28 | 15 |
| CONTRACT NO. 60F98 | | | | |
| FED. ROAD DIST. NO. ILLINOIS FED. AID PROJECT | | | | |