

|                     |                 |                      |              |           |
|---------------------|-----------------|----------------------|--------------|-----------|
| FAP NO.             | SECTION         | COUNTY               | TOTAL SHEETS | SHEET NO. |
| 338                 | (113 & 114) R-5 | WILL                 | 260          | 217       |
| STA.                | TO STA.         |                      |              |           |
| FED. ROAD DIST. NO. | MILES           | FAP 338 (IL RTE. 59) |              |           |

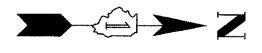

- DENOTES LABORATORY TEST
- ▼ GROUNDWATER FIRST ENCOUNTER
- ▽ GROUNDWATER UPON COMPLETION

THE PROPOSED PLAN AND PROFILE GEOMETRY CONTAINED IN THIS SHEET IS REPRESENTATIVE OF THE STATUS OF THE DESIGN AT THE TIME OF THE SOILS REPORT WAS AUTHORED IN JANUARY 2004. SEE THE ROADWAY PLAN AND PROFILE SHEETS FOR THE LATEST GEOMETRY.

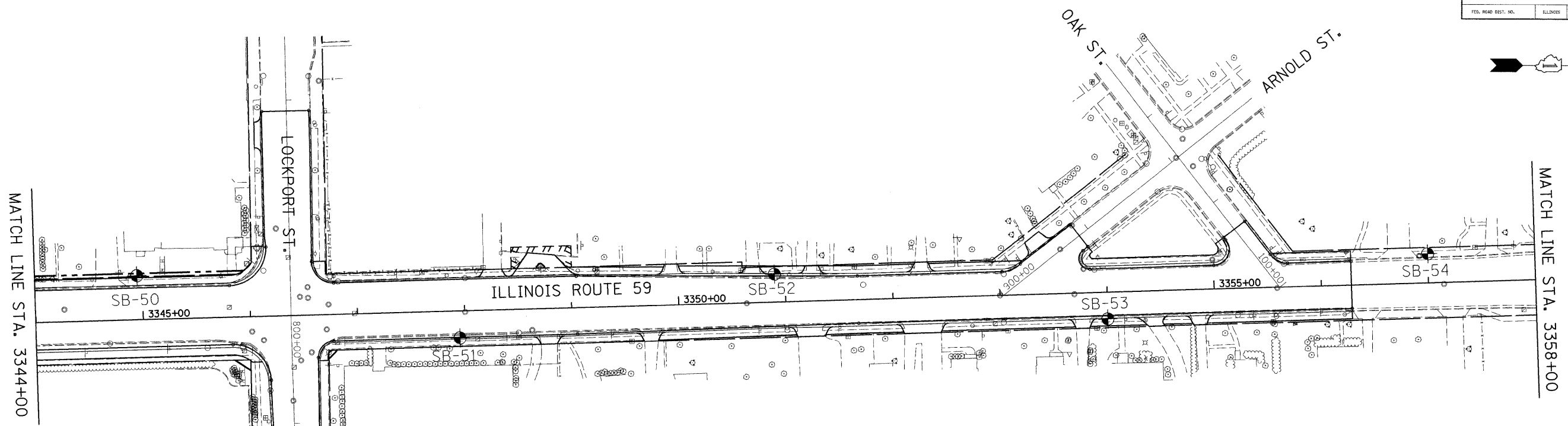
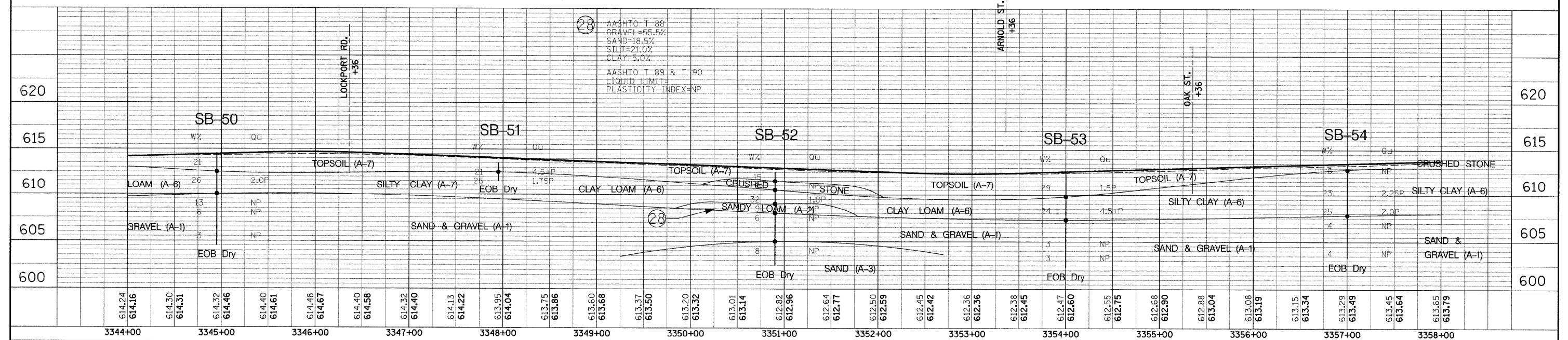
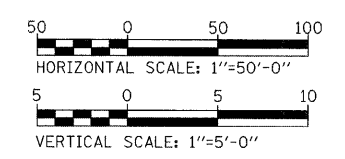

28 AASHTO T 88  
GRAVEL = 55.5%  
SAND = 18.5%  
SILT = 21.0%  
CLAY = 5.0%  
AASHTO T 89 & T 90  
LIQUID LIMIT =  
PLASTICITY INDEX = NP