

NOTES FOR TEMPORARY TRAFFIC SIGNALS

1. ALL CONTROL EQUIPMENT INCLUDING EMERGENCY PRE-EMPTION AND COMMUNICATION DEVICES FOR THE TEMPORARY TRAFFIC SIGNAL(S) SHALL BE FURNISHED BY THE CONTRACTOR.
2. ONLY CONTROLLERS SUPPLIED BY ONE OF THE DISTRICT APPROVED CLOSED LOOP EQUIPMENT MANUFACTURERS WILL BE APPROVED FOR USE AT TEMPORARY SIGNAL LOCATIONS. ALL CONTROLLERS USED FOR TEMPORARY TRAFFIC SIGNALS SHALL BE FULLY ACTUATED NEMA MICROPROCESSOR BASED WITH RS232 DATA ENTRY PORTS COMPATIBLE WITH EXISTING MONITORING SOFTWARE APPROVED BY IDOT DISTRICT 1. INSTALLED IN A NEMA TS1 OR TS2 CABINET. ONLY ONE BRAND OF CONTROLLER WILL BE ACCEPTED FOR ANY ONE CONTRACT.
3. ALL TRAFFIC SIGNAL SECTIONS AND PEDESTRIAN SIGNAL SECTIONS SHALL BE 12". HEADS SHALL BE PLACED AS INDICATED ON THE TEMPORARY TRAFFIC SIGNAL PLAN OR AS DIRECTED BY THE ENGINEER. THE CONTRACTOR SHALL FURNISH ENOUGH CABLE SLACK TO RELOCATE HEADS TO ANY POSITION ON THE SPAN WIRE OR AT LOCATIONS ILLUSTRATED ON THE PLANS FOR CONSTRUCTION STAGING. THE TEMPORARY TRAFFIC SIGNAL SHALL REMAIN IN OPERATION DURING ALL SIGNAL HEAD RELOCATIONS. EACH TEMPORARY TRAFFIC SIGNAL HEAD SHALL HAVE ITS OWN CABLE FROM THE CONTROLLER CABINET TO THE SIGNAL HEAD.
4. ALL EXISTING STREET NAME AND INTERSECTION REGULATORY SIGNS SHALL BE REMOVED FROM EXISTING POLES, RELOCATED AND SECURELY FASTENED TO THE SIGNAL SPAN WIRE OR WOOD POLE AS DIRECTED BY THE ENGINEER.
5. ANY TEMPORARY SIGNAL WITHIN AN EXISTING CLOSED LOOP TRAFFIC SIGNAL SYSTEM SHALL BE INTERCONNECTED TO THAT SYSTEM USING SIMILAR BRAND CONTROL EQUIPMENT.
6. THE TEMPORARY TRAFFIC SIGNAL SHALL HAVE THE SIGNAL HEAD DISPLAYS, SIGNAL HEAD PLACEMENTS AND CONTROLLER PHASING MATCH THE EXISTING TRAFFIC SIGNAL. AT THE TIME OF THE TURN ON, IF NO TRAFFIC STAGING IS IN PLACE OR WILL NOT BE STAGED ON THE DAY OF THE TURN ON.

THE FOLLOWING ITEMS SHALL BE REMOVED BY THE CONTRACTOR AND SHALL BE DISPOSED OF BY THEM OUTSIDE THE RIGHT-OF-WAY AT THEIR EXPENSE. THE SALVAGE VALUE OF THE REMOVED EQUIPMENT SHALL BE REFLECTED IN THE CONTRACT BID PRICE.

1	EACH	CONTROLLER AND CABINET, COMPLETE
1	EACH	MASTER CONTROLLER
2	EACH	STEEL MAST ARM ASSEMBLY AND POLE
1	EACH	SIGNAL HEAD 1-FACE, 3-SECTION, MAST ARM MOUNTED
3	EACH	SIGNAL HEAD, OPTICALLY PROGRAMMED, 1-FACE, 3-SECTION, MAST ARM MOUNTED
1	EACH	COMBINATION SIGNAL HEAD, 3-FACE, 2-3 SECTION OPTICALLY PROGRAMMED, 1-3 SECTION, BRACKET MOUNTED
1	EACH	SIGNAL HEAD, OPTICALLY PROGRAMMED, 1-FACE, 3-SECTION, BRACKET MOUNTED
2	EACH	SIGNAL HEAD, 2-FACE, 3-SECTION, BRACKET MOUNTED
1	EACH	SIGNAL HEAD, 1-FACE, 3-SECTION, BRACKET MOUNTED
1	EACH	SIGNAL HEAD, 2-FACE, 1-3 SECTION, 1-4 SECTION, BRACKET MOUNTED
5	EACH	TRAFFIC SIGNAL POST
1	EACH	SERVICE INSTALLATION

THE FOLLOWING EXISTING TRAFFIC SIGNAL EQUIPMENT SHALL BE REMOVED BY THE CONTRACTOR, SHALL REMAIN THE PROPERTY OF THE AGENCY LISTED BELOW. THE CONTRACTOR SHALL SAFELY STORE AND ARRANGE FOR PICK UP OF ALL EQUIPMENT TO BE RETURNED TO THE LISTED AGENCY AS PER THE TRAFFIC SIGNAL SPECIFICATIONS.

AGENCY: VILLAGE OF PLAINFIELD

1	EACH	LIGHT DETECTOR AMPLIFIER
2	EACH	LIGHT DETECTORS

TEMPORARY RADIO INTERCONNECT TO FORT BEGGS RD. AND TO LOCKPORT ST. (SEE TEMPORARY INTERCONNECT PLAN)

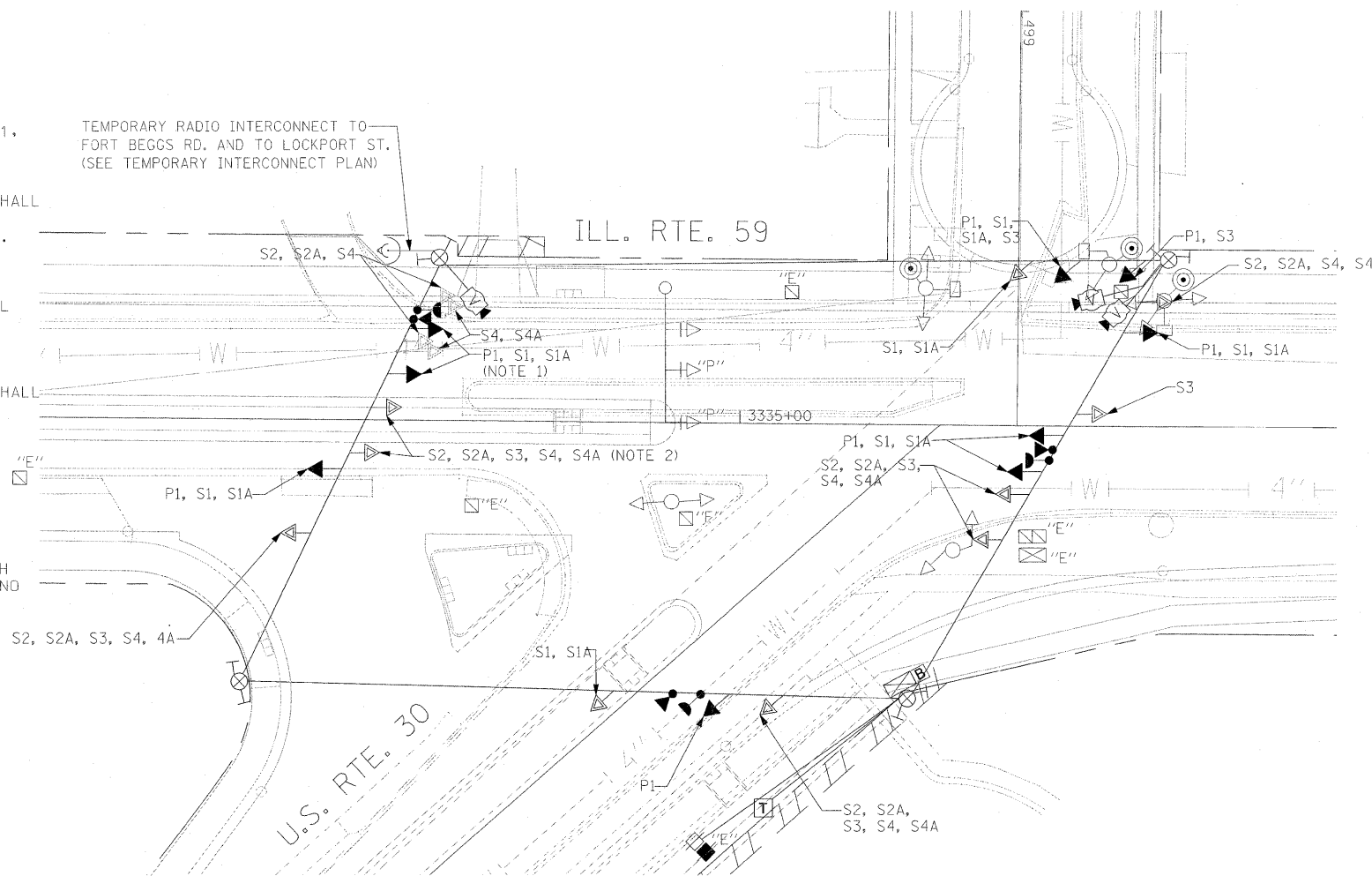

TEMPORARY TRAFFIC SIGNAL PLAN

STAGES: PRE-STAGE 1, STAGE 1, STAGE 1A, STAGE 2, STAGE 2A, STAGE 3, STAGE 4 AND STAGE 4A

TEMPORARY TRAFFIC SIGNAL PLAN NOTES:

- NOTE 1: THE LEFT TURN YELLOW AND GREEN ARROW INDICATION SECTIONS IN THE 5-SECTION SIGNAL HEADS FOR THE SOUTHBOUND DIRECTION OF TRAFFIC SHALL BE BAGGED AND DISCONNECTED DURING CONSTRUCTION STAGE 2, STAGE 2A, STAGE 4, AND STAGE 4A.
- NOTE 2: THESE SIGNAL HEADS WITH RED, YELLOW AND GREEN LEFT TURN ARROW INDICATIONS FOR THE SOUTHBOUND DIRECTION OF TRAFFIC ARE NEEDED DURING STAGES STAGE 2, STAGE 2A, STAGE 4, AND STAGE 4A. THEY SHALL BE DISCONNECTED AND BAGGED DURING OTHER CONSTRUCTION STAGES WHEN THEY ARE NOT NEEDED

THE TRAFFIC SIGNAL WORK IN THIS CONTRACT SHALL BE COORDINATED WITH IDOT CONTRACT 62417.

THE TRAFFIC SIGNAL CONTROL EQUIPMENT FOR THIS PROJECT SHALL BE "ECONOLITE" TO MATCH THE EXISTING ADJACENT SYSTEM.



TEMPORARY TRAFFIC SIGNAL LEGEND

- ◀ TEMPORARY TRAFFIC SIGNAL HEAD SPAN WIRE MOUNTED ORIGINAL LOCATION
- ◀ TEMPORARY TRAFFIC SIGNAL HEAD SPAN WIRE MOUNTED SECONDARY LOCATION
- ⊗ TEMPORARY WOOD POLE (CLASS 5 OR BETTER) 45 FOOT (13.7m) MINIMUM
- ⊠ TEMPORARY CONTROLLER CABINET
- TEMPORARY SPAN WIRE, TETHER WIRE, AND CABLE
- ⊕ TEMPORARY SERVICE INSTALLATION
- TEMPORARY PEDESTRIAN SIGNAL HEAD, BRACKET MOUNTED
- ⊞ MICROWAVE VEHICLE SENSOR
- ⊙ PEDESTRIAN PUSHBUTTON DETECTOR
- ⊙ EMERGENCY VEHICLE LIGHT DETECTOR
- ⊙ CONFIRMATION BEACON
- ⊙ VEHICLE DETECTOR, INDUCTION LOOP
- CT COMMON TRENCH
- UD UNIT DUCT
- G.S. CONDUIT IN GROUND
- HANDHOLE
- HEAVY DUTY HANDHOLE
- T TELEPHONE CONNECTION
- ⊙ WIRELESS INTERCONNECT (ANTENNA)
- ⊙ VIDEO CAMERA ASSEMBLY
- ⊙ UPS-BATTERY BACK-UP

EXISTING EQUIPMENT TO BE REMOVED LEGEND

- ◀ EXISTING SIGNAL TO BE REMOVED
- "E" EXISTING SERVICE INSTALLATION TO BE REMOVED
- ⊙ EXISTING SIGNAL POST AND FOUNDATION TO BE REMOVED
- ◀ EXISTING MAST ARM POLE AND FOUNDATION TO BE REMOVED
- ⊠ "E" EXISTING CONTROLLER AND FOUNDATION TO BE REMOVED
- ⊠ "E" EXISTING HANDHOLE TO BE REMOVED
- ⊠ "E" EXISTING DOUBLE HANDHOLE TO BE REMOVED
- ⊕ PEDESTRIAN SIGNAL TO BE REMOVED
- ⊙ EXISTING PEDESTRIAN PUSH-BUTTON TO BE REMOVED
- ⊙ EMERGENCY VEHICLE LIGHT DETECTOR TO BE REMOVED
- ⊙ CONFIRMATION BEACON TO BE REMOVED
- ⊠ "E" EXISTING HEAVY DUTY HANDHOLE TO BE REMOVED
- ⊙ EXISTING STEEL MAST ARM POLE AND FOUNDATION TO BE REMOVED



FILE NAME =	USER NAME = #USER#	DESIGNED - PKG, RRM	REVISED -	STATE OF ILLINOIS DEPARTMENT OF TRANSPORTATION	TEMPORARY TRAFFIC SIGNAL INSTALLATION AND REMOVAL PLAN ILLINOIS ROUTE 59 AT US. ROUTE 30 PRE-STAGE, STAGE 1, STAGE 1A, STAGE 2, STAGE 2A, STAGE 3, STAGE 4 AND STAGE 4A (SHEET 1 OF 3)	F.A. RTE.	SECTION	COUNTY	TOTAL SHEETS	SHEET NO.	
#FILE#		DRAWN - BB,ME,YB	REVISED -			338	113 N-2	WILL	260	181	
		CHECKED - PKG, RRM	REVISED -			CONTRACT NO. 60E73					
		DATE - 10/15/2008	REVISED -			FED. ROAD DIST. NO. ILLINOIS FAP 338 (IL RTE. 59)					