

| PIPE UNDERDRAINS, FABRIC LINED TRENCH 4" |              |              |                           |            |                      |                |
|--|--------------|--------------|---------------------------|------------|----------------------|----------------|
| UP STATION                               | DOWN STATION | RUN LOCATION | P UNDR FAB LINE TR 4 (FT) | DEPTH (IN) | OUTLET STRUCTURE NO. | NOTES          |
| 3327+30                                  | 3327+44      | LT           | 14                        |            | 100                  |                |
| 3327+46                                  | 3328+43      | LT           | 97                        |            | 101                  |                |
| 3328+47                                  | 299+43       | LT           | 45                        |            | 106                  | IL59 / UNION   |
| 3327+30                                  | 3328+83      | RT           | 153                       |            | 108                  |                |
| 3329+70                                  | 299+43       | LT           | 77                        |            | 107                  | IL59 / UNION   |
| 3329+74                                  | 3329+83      | LT           | 9                         |            | 114                  |                |
| 3328+87                                  | 3329+70      | RT           | 83                        |            | 112                  |                |
| 3329+85                                  |              | ACROSS       | 27                        |            | 114                  |                |
| 3329+85                                  |              | ACROSS       | 27                        |            | 115                  |                |
| 3329+83                                  | 3329+74      | RT           | 9                         |            | 112                  |                |
| 3330+64                                  | 3329+87      | LT           | 77                        |            | 114                  |                |
| 3330+63                                  | 3329+87      | RT           | 76                        |            | 115                  |                |
| 3331+76                                  | 3330+67      | RT           | 109                       |            | 117                  |                |
| 3331+80                                  | 3330+67      | LT           | 115                       |            | 116                  |                |
| 3331+80                                  | 399+43       | LT           | 42                        |            | 120                  | IL59 / NEWKIRK |
| SUBTOTAL                                 |              |              | 960                       |            |                      |                |

| PIPE UNDERDRAINS, FABRIC LINED TRENCH 4" |              |              |                           |            |                      |                |
|--|--------------|--------------|---------------------------|------------|----------------------|----------------|
| UP STATION                               | DOWN STATION | RUN LOCATION | P UNDR FAB LINE TR 4 (FT) | DEPTH (IN) | OUTLET STRUCTURE NO. | NOTES          |
| 3332+68                                  | 399+43       | LT           | 38                        |            | 121                  | IL59 / NEWKIRK |
| 3333+80                                  | 3331+80      | RT           | 180                       |            | 118                  |                |
| 3333+80                                  | 3769+65      | RT           | 54                        |            | 137                  | IL59 / US 30   |
| 3769+65                                  | 3769+57      | LT           | 10                        |            | 138                  | US 30          |
| 3769+00                                  | 3769+55      | LT           | 57                        |            | 138                  | US 30          |
| 3770+08                                  |              | ACROSS       | 25                        |            | 127                  | US 30          |
| 3333+57                                  | 3332+72      | LT           | 85                        |            | 125                  |                |
| 3333+57                                  | 3335+00      | LT           | 143                       |            | 128                  |                |
| 3769+00                                  | 3770+50      | RT           | 150                       |            | 139                  | US 30          |
| 3770+93                                  | 3770+54      | RT           | 41                        |            | 139                  | US 30          |
| 3335+04                                  | 3335+66      | LT           | 62                        |            | 130                  |                |
| 3335+80                                  | 3335+70      | LT           | 10                        |            | 130                  |                |
| 3336+48                                  | 3335+84      | LT           | 64                        |            | 132                  |                |
| 3336+48                                  | 3335+53      | RT           | 96                        |            | 140                  |                |
| 3337+66                                  | 3336+52      | LT           | 114                       |            | 134                  |                |
| SUBTOTAL                                 |              |              | 1129                      |            |                      |                |

| PIPE UNDERDRAINS, FABRIC LINED TRENCH 4" |              |              |                           |            |                      |                  |
|--|--------------|--------------|---------------------------|------------|----------------------|------------------|
| UP STATION                               | DOWN STATION | RUN LOCATION | P UNDR FAB LINE TR 4 (FT) | DEPTH (IN) | OUTLET STRUCTURE NO. | NOTES            |
| 3337+66                                  | 3336+52      | RT           | 114                       |            | 136                  |                  |
| 3339+00                                  | 3337+70      | LT           | 130                       |            | 200                  |                  |
| 3338+85                                  | 3337+70      | RT           | 115                       |            | 202                  |                  |
| 3339+00                                  | 600+50       | LT           | 37                        |            | 204                  | IL 59 / LOCKPORT |
| 3339+92                                  | 600+50       | LT           | 40                        |            | 205                  | IL 59 / LOCKPORT |
| 3340+97                                  | 3339+96      | LT           | 101                       |            | 208                  |                  |
| 3340+97                                  | 3339+96      | RT           | 101                       |            | 206                  |                  |
| 3342+34                                  | 3340+99      | LT           | 135                       |            | 209                  |                  |
| 3342+27                                  | 3340+99      | RT           | 128                       |            | 210                  |                  |
| 3342+34                                  | 700+53       | LT           | 35                        |            | 211                  | IL 59 / CHICAGO  |
| 3342+27                                  | 710+43       | RT           | 37                        |            | 212                  | IL 59 / CHICAGO  |
| 3343+39                                  | 700+53       | LT           | 35                        |            | 214                  | IL 59 / CHICAGO  |
| 3343+39                                  | 710+43       | RT           | 39                        |            | 215                  | IL 59 / CHICAGO  |
| 3344+47                                  | 3343+43      | LT           | 104                       |            | 217                  |                  |
| 3344+46                                  | 3343+43      | RT           | 103                       |            | 218                  |                  |
| SUBTOTAL                                 |              |              | 1254                      |            |                      |                  |

| PIPE UNDERDRAINS, FABRIC LINED TRENCH 4" |              |              |                           |            |                      |                  |
|--|--------------|--------------|---------------------------|------------|----------------------|------------------|
| UP STATION                               | DOWN STATION | RUN LOCATION | P UNDR FAB LINE TR 4 (FT) | DEPTH (IN) | OUTLET STRUCTURE NO. | NOTES            |
| 3345+76                                  | 3344+49      | LT           | 129                       |            | 219                  |                  |
| 3345+74                                  | 3344+50      | RT           | 125                       |            | 220                  |                  |
| 3345+76                                  | 800+40       | LT           | 49                        |            | 223                  | IL 59 / LOCKPORT |
| 3345+74                                  | 810+70       | RT           | 65                        |            | 224                  | IL 59 / LOCKPORT |
| 3346+79                                  | 800+40       | LT           | 38                        |            | 226                  | IL 59 / LOCKPORT |
| 3346+76                                  | 810+70       | RT           | 50                        |            | 227                  | IL 59 / LOCKPORT |
| 3346+79                                  | 3347+90      | LT           | 111                       |            | 228                  |                  |
| 3346+76                                  | 3347+90      | RT           | 114                       |            | 230                  |                  |
| 3347+94                                  | 3349+13      | LT           | 119                       |            | 232                  |                  |
| 3347+94                                  | 3349+13      | RT           | 119                       |            | 233                  |                  |
| 3349+17                                  | 3350+48      | LT           | 131                       |            | 234                  |                  |
| 3349+17                                  | 3350+48      | RT           | 131                       |            | 236                  |                  |
| SUBTOTAL                                 |              |              | 1181                      |            |                      |                  |
| SHT. TOTAL                               |              |              | 4524                      |            |                      |                  |

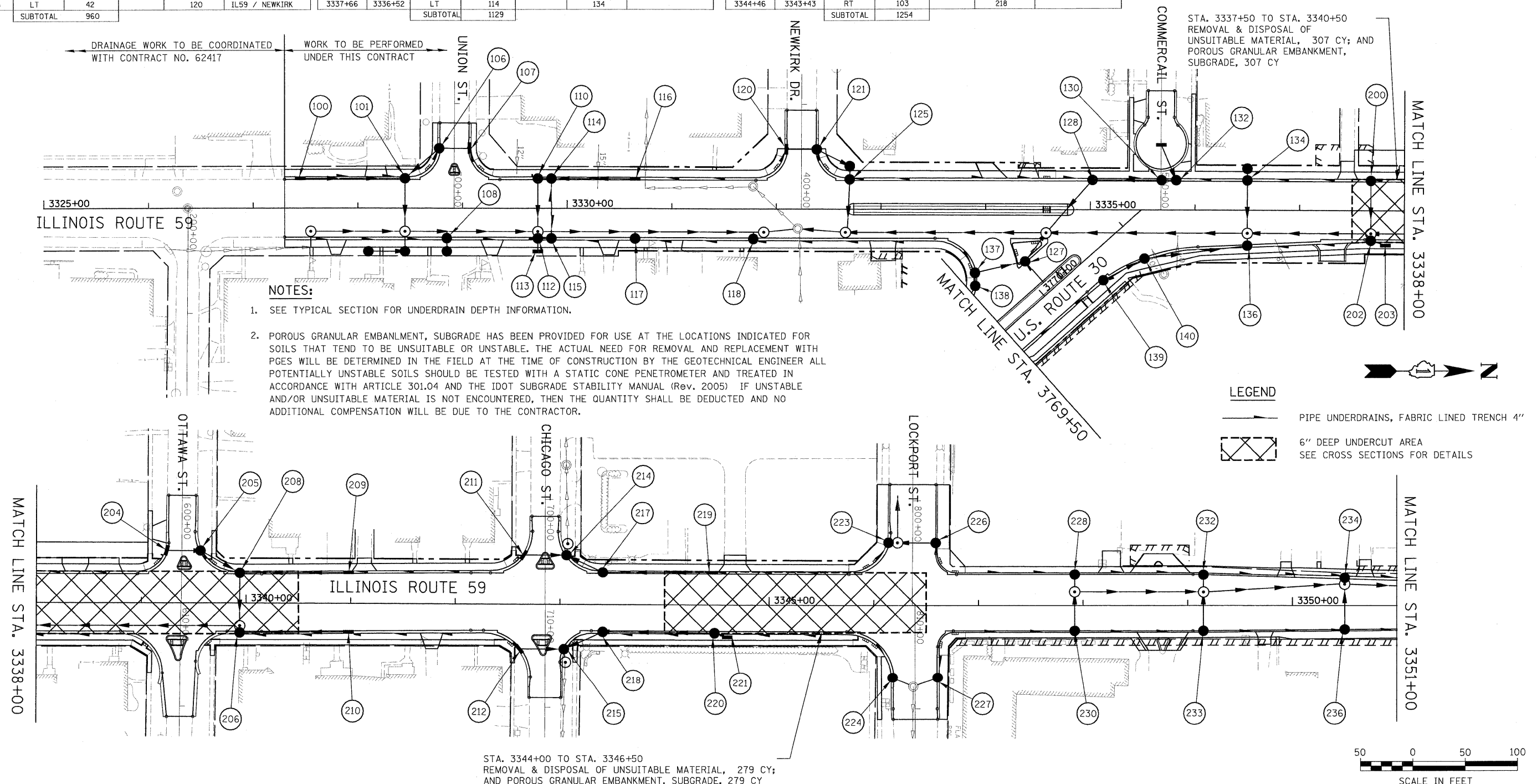

**NOTES:**

- SEE TYPICAL SECTION FOR UNDERDRAIN DEPTH INFORMATION.
- POROUS GRANULAR EMBANKMENT, SUBGRADE HAS BEEN PROVIDED FOR USE AT THE LOCATIONS INDICATED FOR SOILS THAT TEND TO BE UNSUITABLE OR UNSTABLE. THE ACTUAL NEED FOR REMOVAL AND REPLACEMENT WITH PGES WILL BE DETERMINED IN THE FIELD AT THE TIME OF CONSTRUCTION BY THE GEOTECHNICAL ENGINEER ALL POTENTIALLY UNSTABLE SOILS SHOULD BE TESTED WITH A STATIC CONE PENETROMETER AND TREATED IN ACCORDANCE WITH ARTICLE 301.04 AND THE IDOT SUBGRADE STABILITY MANUAL (Rev. 2005) IF UNSTABLE AND/OR UNSUITABLE MATERIAL IS NOT ENCOUNTERED, THEN THE QUANTITY SHALL BE DEDUCTED AND NO ADDITIONAL COMPENSATION WILL BE DUE TO THE CONTRACTOR.

STA. 3337+50 TO STA. 3340+50  
REMOVAL & DISPOSAL OF  
UNSUITABLE MATERIAL, 307 CY; AND  
POROUS GRANULAR EMBANKMENT,  
SUBGRADE, 307 CY

STA. 3344+00 TO STA. 3346+50  
REMOVAL & DISPOSAL OF UNSUITABLE MATERIAL, 279 CY;  
AND POROUS GRANULAR EMBANKMENT, SUBGRADE, 279 CY