

PLAN	DATE
BY	
NO.	
NO.	
NO.	
NO.	
NO.	
NO.	

PROFILE	DATE
BY	
NO.	
NO.	
NO.	
NO.	
NO.	
NO.	

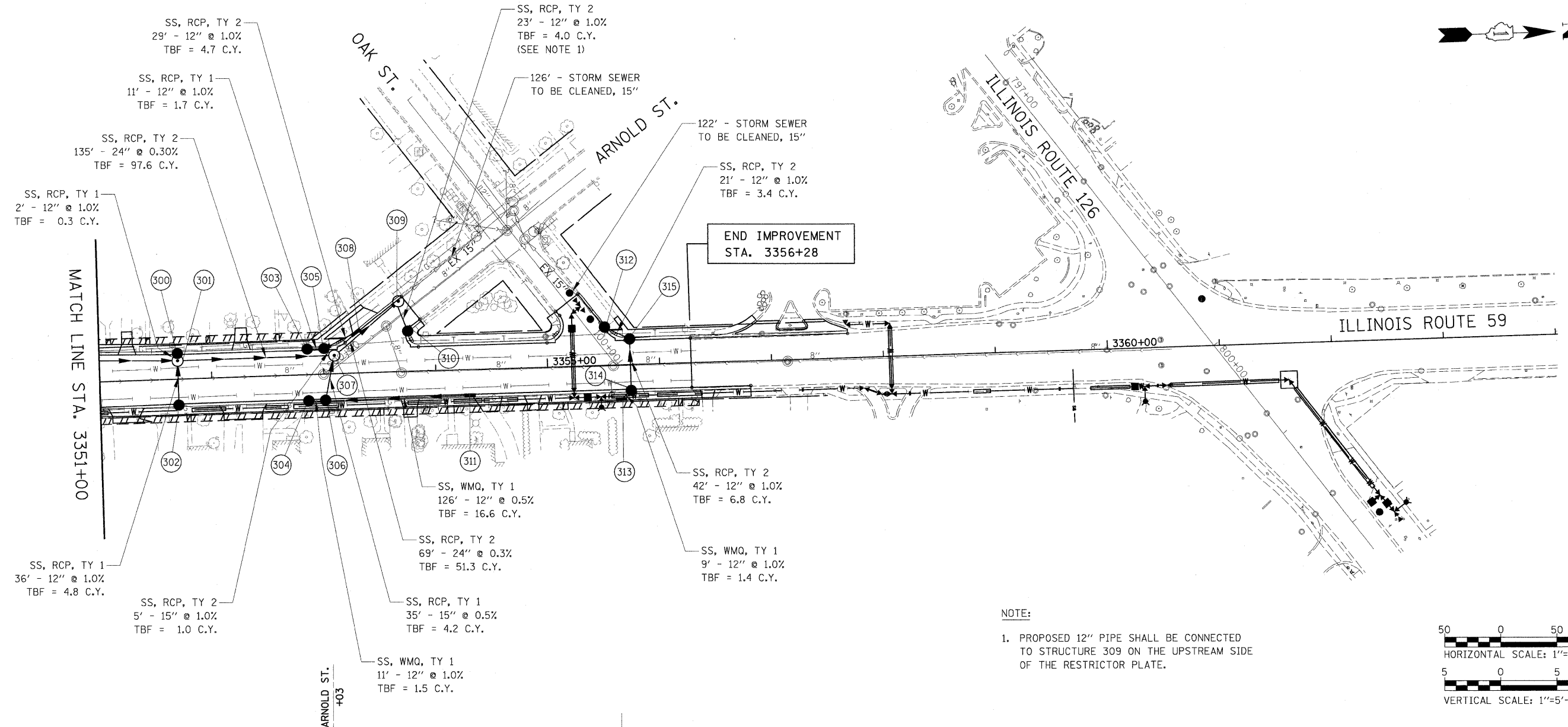

NOTE:
1. PROPOSED 12" PIPE SHALL BE CONNECTED TO STRUCTURE 309 ON THE UPSTREAM SIDE OF THE RESTRICTOR PLATE.

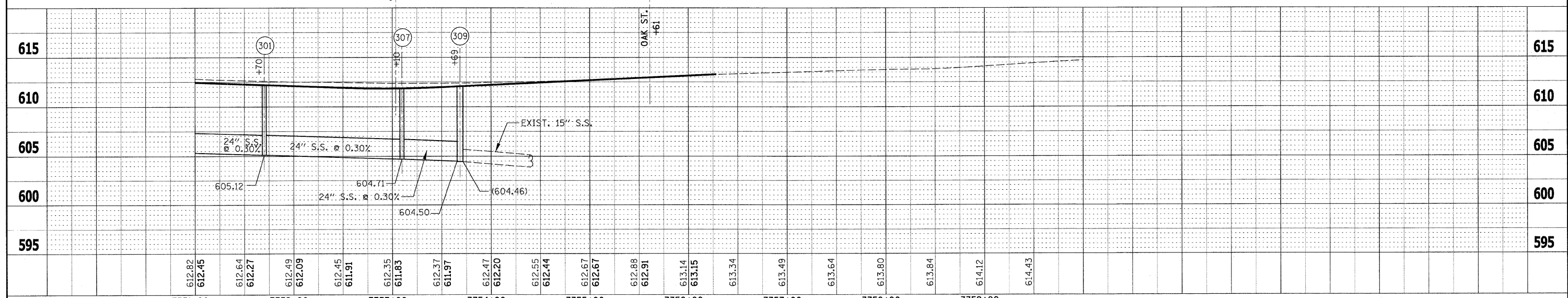
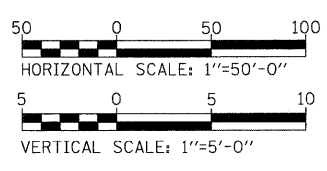

FILE NAME =	USER NAME = #USER#	DESIGNED - PJO	REVISED -	STATE OF ILLINOIS DEPARTMENT OF TRANSPORTATION	ILLINOIS ROUTE 59 DRAINAGE PLAN & PROFILE	F.A. RTE. 338	SECTION 113 N-2	COUNTY WILL	TOTAL SHEETS 260	SHEET NO. 111	
#FILEL#	PLOT SCALE = #SCALE#	DRAWN - RTA	REVISED -			SCALE: AS SHOWN	SHEET NO. 3 OF 3 SHEETS	STA. 3351+00 TO STA. 3356+28	FED. ROAD DIST. NO. ILLINOIS	FAP 338 (IL RTE. 59)	CONTRACT NO. 60E73
	PLOT DATE = #DATE#	CHECKED - JCM	REVISED -								
		DATE - JANUARY 16, 2009	REVISED -								