

| | | |
|---------------|---------------|------|
| FINAL SURVEY | SURVEYED | DATE |
| NOTE BOOK NO. | PLOTTED | BY |
| | TEMPLATE | |
| | AREAS CHECKED | |

| | | |
|-----------------|---------------|------|
| ORIGINAL SURVEY | SURVEYED | DATE |
| NOTE BOOK NO. | PLOTTED | BY |
| | TEMPLATE | |
| | AREAS CHECKED | |

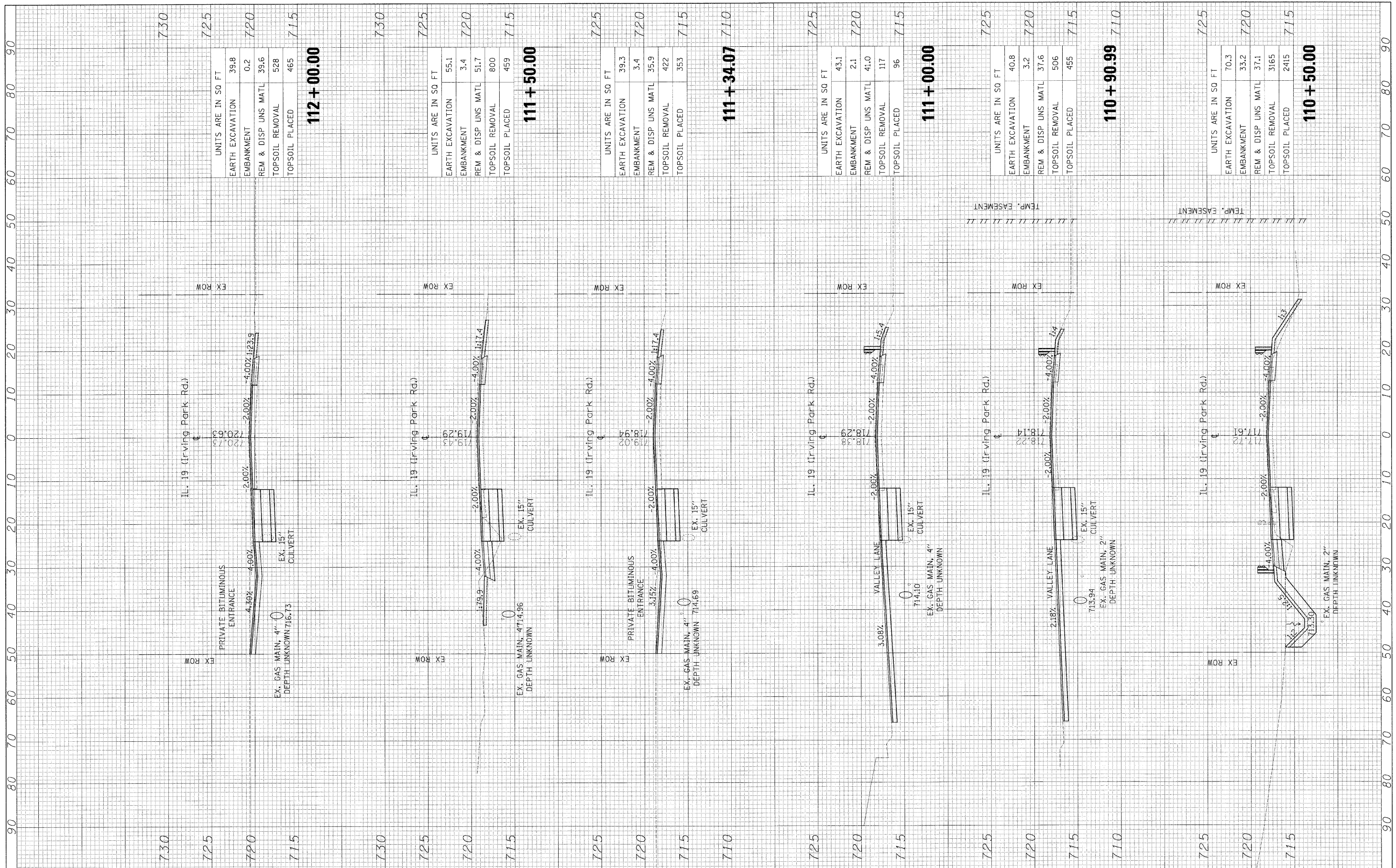

| | | | | | | | | | | | |
|----------------------------|--------------------------------------|----------------|-----------|---|---|-------|--------------------|---------|--------|--------------|-----------|
| FILE NAME = | USER NAME = Plotted by Administrator | DESIGNED - ST | REVISED - | STATE OF ILLINOIS DEPARTMENT OF TRANSPORTATION | CROSS SECTIONS IL ROUTE 19 (IRVING PARK ROAD) OVER MEACHAM CREEK | | F.A.U. RTE. | SECTION | COUNTY | TOTAL SHEETS | SHEET NO. |
| ...\\160090-sht-xssht.dgn | | DRAWN - ST | REVISED - | | 1321 | 31T-2 | DUPAGE | 59 | 57 | | |
| PLT SCALE = 10.0000' / IN. | | CHECKED - FML | REVISED - | | SCALE: 1"=5'V, 10'H SHEET NO. OF SHEETS STA. 103+95.00 TO STA. 114+60.00 | | CONTRACT NO. 60A90 | | | | |
| PLT DATE = 1/19/2009 | | DATE - 09/2008 | REVISED - | | FED. ROAD DIST. NO. ILLINOIS FED. AID PROJECT | | | | | | |