

DATE	BY

PLAN	SURVEYED	NOTED

DATE	BY

PROFILE	SURVEYED	NOTED

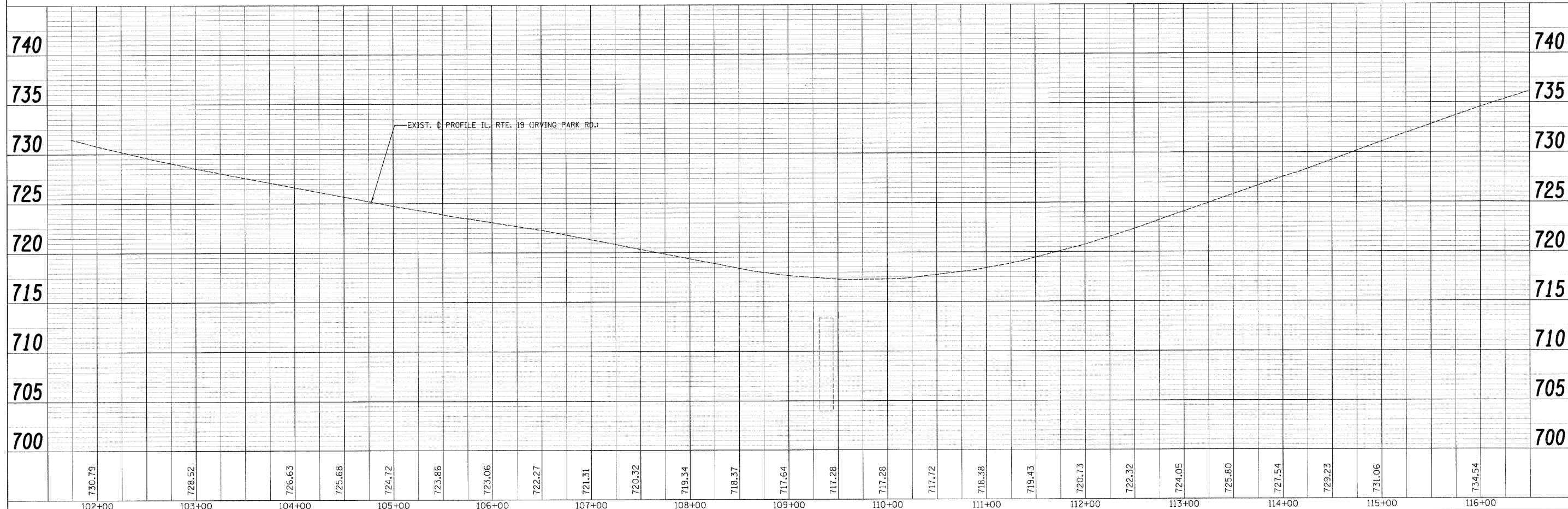
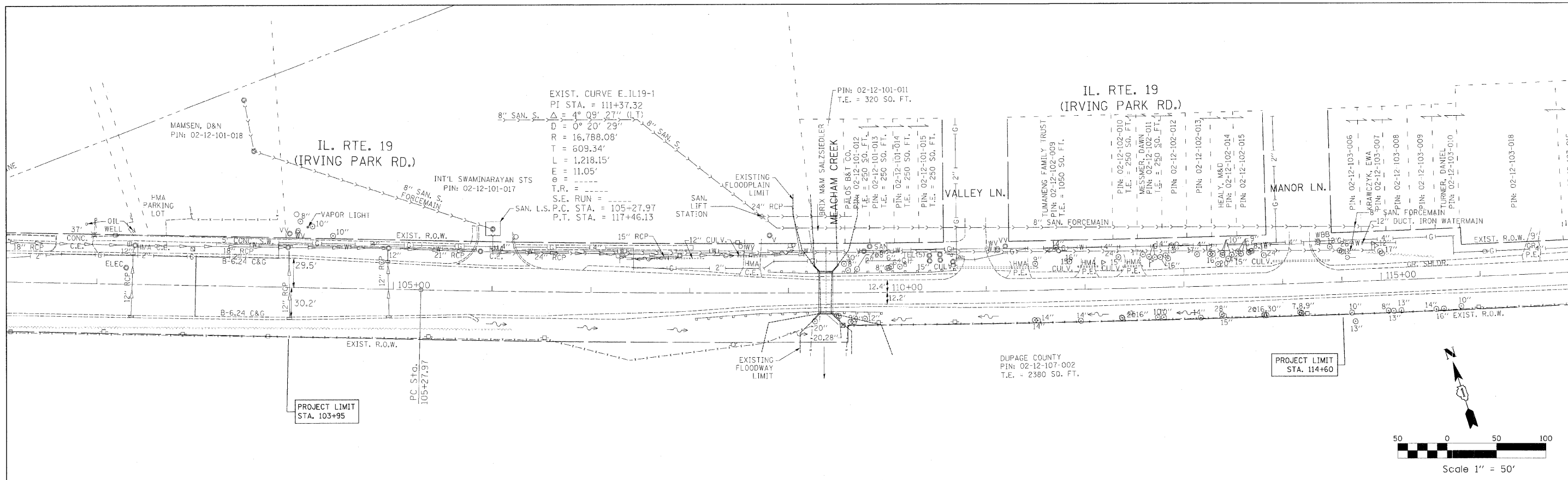

FILE NAME = ...\\D168A98-sht-plnprf\Exist.dgn	USER NAME = Plotted by Administrator	DESIGNED - ST	REVISED -	STATE OF ILLINOIS DEPARTMENT OF TRANSPORTATION	EXISTING PLAN & PROFILE SHEET IL ROUTE 19 (IRVING PARK RD.) OVER MEACHAM CREEK		F.A.U. RTE. 1321	SECTION 31T-2	COUNTY DUPAGE	TOTAL SHEETS 59	SHEET NO. 19	
		DRAWN - ST	REVISED -		SCALE: 1"=50'H, 5'V	SHEET NO. OF SHEETS	STA. 103+95.00 TO STA. 114+60.00	FED. ROAD DIST. NO.	ILLINOIS FED. AID PROJECT	CONTRACT NO. 60A90		
		CHECKED - DMM	REVISED -									
		DATE - 09/2008	REVISED -									