

P.A. SEC.	SECTION	COUNTY	TOTAL SHEETS	SHEET NO.
24	*	JOHNSON	150	87
STA. TO STA.				
FED. ROAD DIST. NO.				
ILLINOIS				
FED. AID PROJECT				

\* (44-5,6)RS, BSMRT FY04-3  
98836

EXIST. CURVE 1  
PI STA. = 434+84.24  
 $\Delta = 48^\circ 20' 06''$  (LT)  
 $D = 1^\circ 29' 55''$   
 $R = 3,823.47'$   
 $T = 1,715.73'$   
 $L = 3,225.49'$   
 $E = 367.31'$   
 $S.E. = 4.2\%$   
P.C. STA. = 417+68.51  
P.T. STA. = 449+94.00

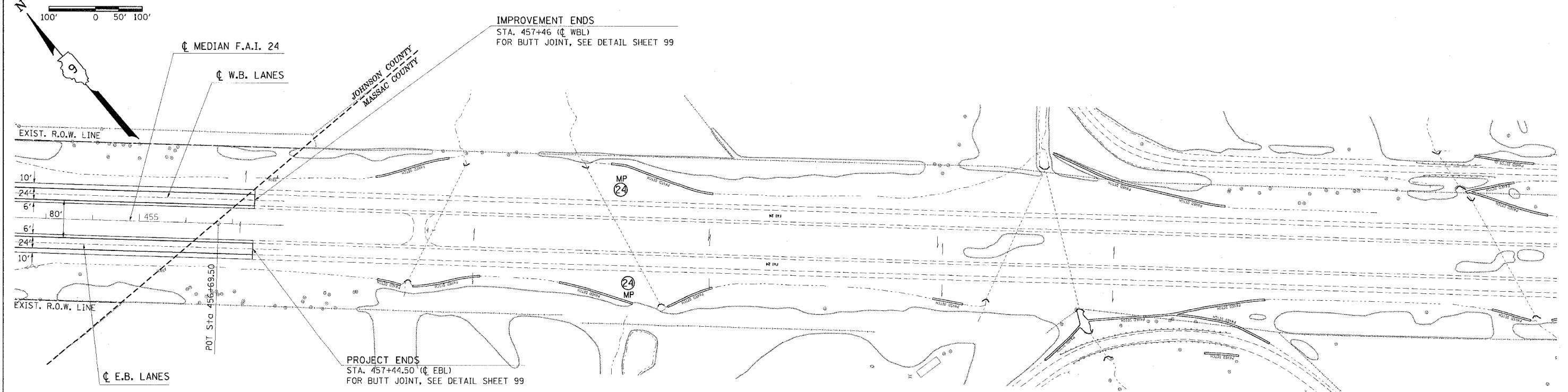
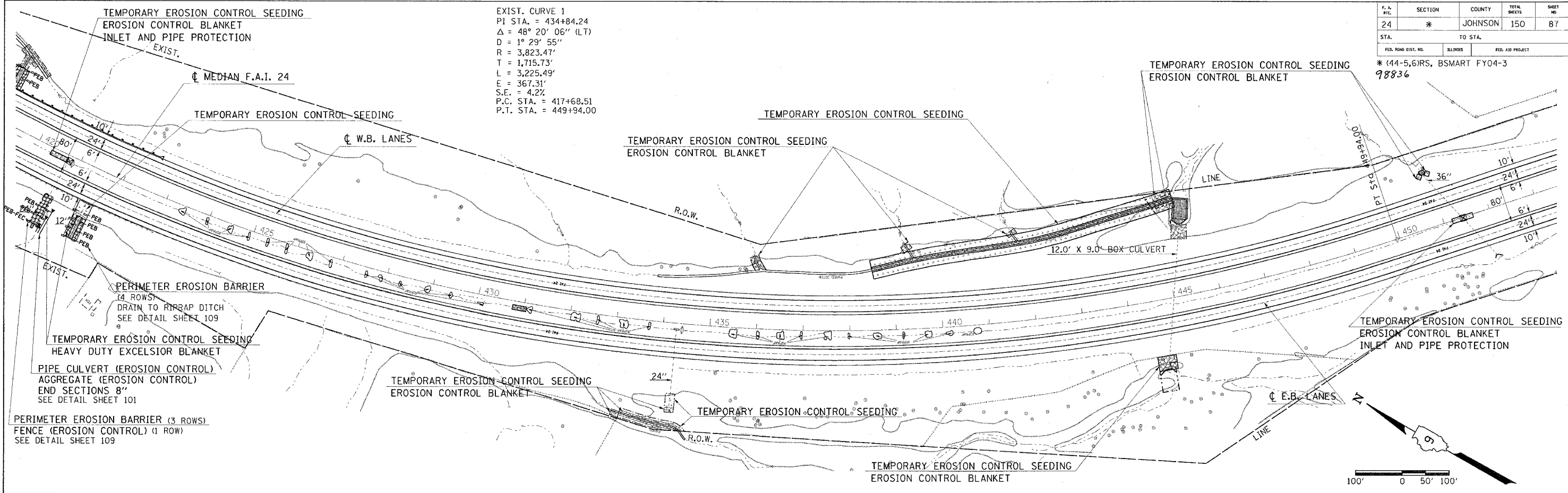

TEMPORARY EROSION CONTROL STA. 420+00 TO STA. 456+69.50

Tue Jan 27 07:16:17 2004  
 c:\p\projects\848020\2\980202.dgn LV:2,4,35,37-47,49,52-63  
 D:\S:\D90202\848020\2\980202.dgn LV:2,4,35,37-48,51-62  
 D:\S:\D90202\848020\2\980202.dgn LV:2,4,35,37-48,51-62

Tue Jan 27 07:16:17 2004  
 c:\p\projects\848020\2\980202.dgn LV:2,4,35,37-47,49,52-63  
 D:\S:\D90202\848020\2\980202.dgn LV:2,4,35,37-48,51-62  
 D:\S:\D90202\848020\2\980202.dgn LV:2,4,35,37-48,51-62