

F.A. NO.	SECTION	COUNTY	TOTAL SHEETS	SHEET NO.
24	*	JOHNSON	150	65
STA.		TO STA.		
FED. ROAD DIST. NO.		BLINDS	FED. AID PROJECT	

* (44-5,6)RS, BSMART FY04-3
98836

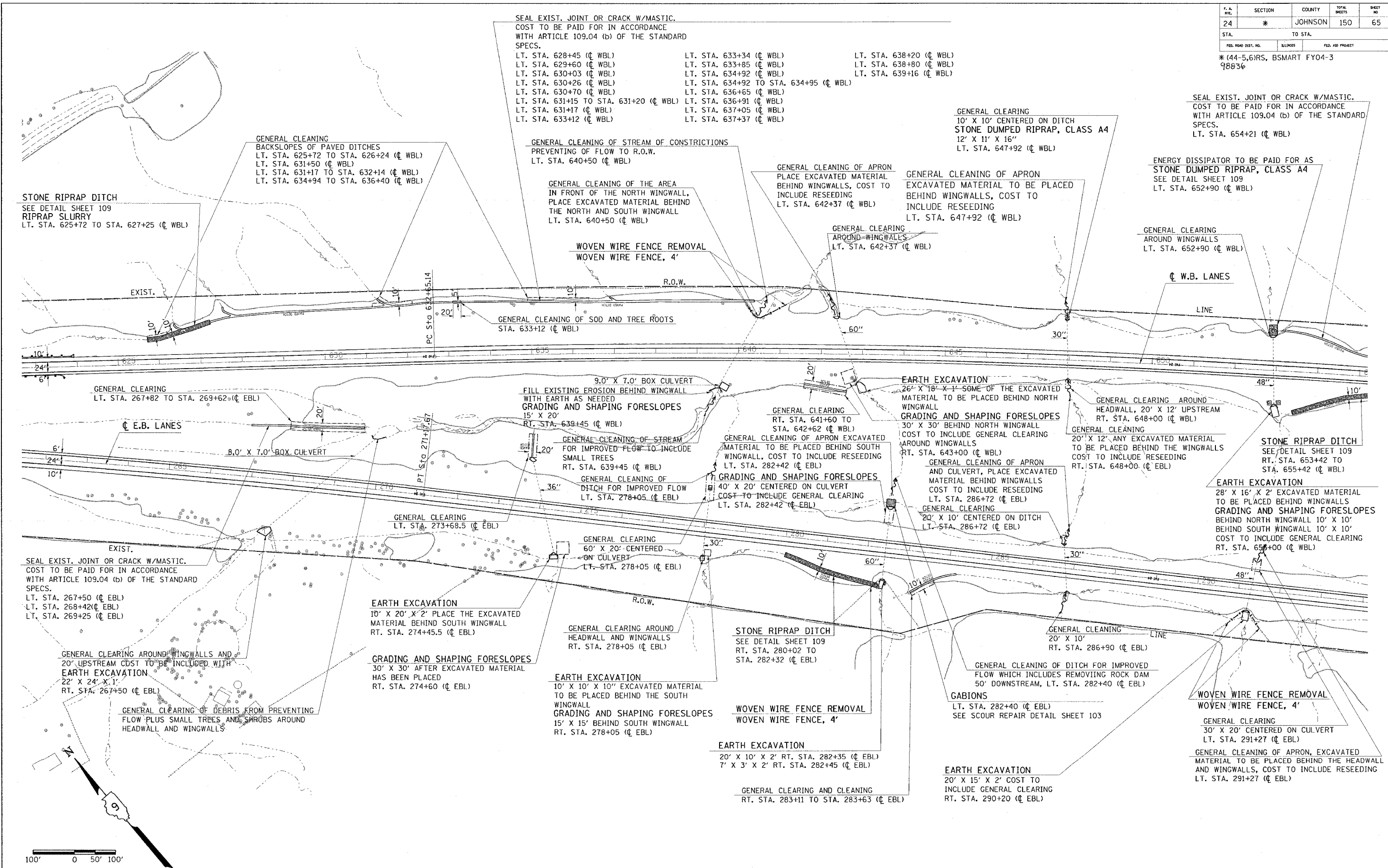

SEAL EXIST. JOINT OR CRACK W/MASTIC.
COST TO BE PAID FOR IN ACCORDANCE
WITH ARTICLE 109.04 (b) OF THE STANDARD
SPECS.
LT. STA. 628+45 (C WBL)
LT. STA. 629+60 (C WBL)
LT. STA. 630+03 (C WBL)
LT. STA. 630+26 (C WBL)
LT. STA. 630+70 (C WBL)
LT. STA. 631+15 TO STA. 631+20 (C WBL)
LT. STA. 631+17 (C WBL)
LT. STA. 633+12 (C WBL)

LT. STA. 633+34 (C WBL)
LT. STA. 633+85 (C WBL)
LT. STA. 634+92 (C WBL)
LT. STA. 634+92 TO STA. 634+95 (C WBL)
LT. STA. 636+65 (C WBL)
LT. STA. 636+91 (C WBL)
LT. STA. 637+05 (C WBL)
LT. STA. 637+37 (C WBL)

LT. STA. 638+20 (C WBL)
LT. STA. 638+80 (C WBL)
LT. STA. 639+16 (C WBL)

GENERAL CLEANING
10' X 10' CENTERED ON DITCH
STONE DUMPED RIPRAP, CLASS A4
12' X 11' X 16"
LT. STA. 647+92 (C WBL)

SEAL EXIST. JOINT OR CRACK W/MASTIC.
COST TO BE PAID FOR IN ACCORDANCE
WITH ARTICLE 109.04 (b) OF THE STANDARD
SPECS.
LT. STA. 654+21 (C WBL)

ENERGY DISSIPATOR TO BE PAID FOR AS
STONE DUMPED RIPRAP, CLASS A4
SEE DETAIL SHEET 109
LT. STA. 652+90 (C WBL)

GENERAL CLEANING OF APRON
EXCAVATED MATERIAL TO BE PLACED
BEHIND WINGWALLS, COST TO
INCLUDE RESEEDING
LT. STA. 647+92 (C WBL)

GENERAL CLEANING OF APRON
PLACE EXCAVATED MATERIAL
BEHIND WINGWALLS, COST TO
INCLUDE RESEEDING
LT. STA. 642+37 (C WBL)

GENERAL CLEANING OF STREAM OF CONSTRUCTIONS
PREVENTING OF FLOW TO R.O.W.
LT. STA. 640+50 (C WBL)

GENERAL CLEANING OF THE AREA
IN FRONT OF THE NORTH WINGWALL,
PLACE EXCAVATED MATERIAL BEHIND
THE NORTH AND SOUTH WINGWALL
LT. STA. 640+50 (C WBL)

WOVEN WIRE FENCE REMOVAL
WOVEN WIRE FENCE, 4'

GENERAL CLEANING OF SOD AND TREE ROOTS
STA. 633+12 (C WBL)

GENERAL CLEANING
AROUND WINGWALLS
LT. STA. 642+37 (C WBL)

GENERAL CLEANING
AROUND WINGWALLS
LT. STA. 652+90 (C WBL)

GENERAL CLEANING
LT. STA. 267+82 TO STA. 269+62 (C EBL)

9.0' X 7.0' BOX CULVERT
FILL EXISTING EROSION BEHIND WINGWALL
WITH EARTH AS NEEDED
GRADING AND SHAPING FORESLOPES
15' X 20'
RT. STA. 639+45 (C WBL)

EARTH EXCAVATION
26' X 18' X 1' SOME OF THE EXCAVATED
MATERIAL TO BE PLACED BEHIND NORTH
WINGWALL
GRADING AND SHAPING FORESLOPES
30' X 30' BEHIND NORTH WINGWALL
COST TO INCLUDE GENERAL CLEANING
AROUND WINGWALLS
RT. STA. 643+00 (C WBL)

GENERAL CLEANING AROUND
HEADWALL, 20' X 12' UPSTREAM
RT. STA. 648+00 (C WBL)

STONE RIPRAP DITCH
SEE DETAIL SHEET 109
RT. STA. 653+42 TO
STA. 655+42 (C WBL)

EARTH EXCAVATION
28' X 16' X 2' EXCAVATED MATERIAL
TO BE PLACED BEHIND WINGWALLS
GRADING AND SHAPING FORESLOPES
BEHIND NORTH WINGWALL 10' X 10'
BEHIND SOUTH WINGWALL 10' X 10'
COST TO INCLUDE GENERAL CLEANING
RT. STA. 655+00 (C WBL)

GENERAL CLEANING OF APRON EXCAVATED
MATERIAL TO BE PLACED BEHIND SOUTH
WINGWALL, COST TO INCLUDE RESEEDING
LT. STA. 282+42 (C EBL)

GENERAL CLEANING OF APRON
AND CULVERT, PLACE EXCAVATED
MATERIAL BEHIND WINGWALLS
COST TO INCLUDE RESEEDING
LT. STA. 286+72 (C EBL)

GENERAL CLEANING OF STREAM
FOR IMPROVED FLOW TO INCLUDE
SMALL TREES
RT. STA. 639+45 (C WBL)

GRADING AND SHAPING FORESLOPES
40' X 20' CENTERED ON CULVERT
COST TO INCLUDE GENERAL CLEANING
LT. STA. 282+42 (C EBL)

GENERAL CLEANING
LT. STA. 273+68.5 (C EBL)

GENERAL CLEANING
60' X 20' CENTERED
ON CULVERT
LT. STA. 278+05 (C EBL)

EARTH EXCAVATION
10' X 20' X 2' PLACE THE EXCAVATED
MATERIAL BEHIND SOUTH WINGWALL
RT. STA. 274+45.5 (C EBL)

GENERAL CLEANING AROUND
HEADWALL AND WINGWALLS
RT. STA. 278+05 (C EBL)

STONE RIPRAP DITCH
SEE DETAIL SHEET 109
RT. STA. 280+02 TO
STA. 282+32 (C EBL)

GENERAL CLEANING
20' X 10'
RT. STA. 286+90 (C EBL)

GENERAL CLEANING OF DITCH FOR IMPROVED
FLOW WHICH INCLUDES REMOVING ROCK DAM
50' DOWNSTREAM, LT. STA. 282+40 (C EBL)

SEAL EXIST. JOINT OR CRACK W/MASTIC.
COST TO BE PAID FOR IN ACCORDANCE
WITH ARTICLE 109.04 (b) OF THE STANDARD
SPECS.
LT. STA. 267+50 (C EBL)
LT. STA. 268+42 (C EBL)
LT. STA. 269+25 (C EBL)

GENERAL CLEANING AROUND WINGWALLS AND
20' UPSTREAM COST TO BE INCLUDED WITH
EARTH EXCAVATION
22' X 24' X 1'
RT. STA. 267+50 (C EBL)

GRADING AND SHAPING FORESLOPES
30' X 30' AFTER EXCAVATED MATERIAL
HAS BEEN PLACED
RT. STA. 274+60 (C EBL)

EARTH EXCAVATION
10' X 10' X 10" EXCAVATED MATERIAL
TO BE PLACED BEHIND THE SOUTH
WINGWALL
GRADING AND SHAPING FORESLOPES
15' X 15' BEHIND SOUTH WINGWALL
RT. STA. 278+05 (C EBL)

WOVEN WIRE FENCE REMOVAL
WOVEN WIRE FENCE, 4'

EARTH EXCAVATION
20' X 10' X 2' RT. STA. 282+35 (C EBL)
7' X 3' X 2' RT. STA. 282+45 (C EBL)

GABIONS
LT. STA. 282+40 (C EBL)
SEE SCOUR REPAIR DETAIL SHEET 103

WOVEN WIRE FENCE REMOVAL
WOVEN WIRE FENCE, 4'

GENERAL CLEANING
30' X 20' CENTERED ON CULVERT
LT. STA. 291+27 (C EBL)

GENERAL CLEANING OF APRON, EXCAVATED
MATERIAL TO BE PLACED BEHIND THE HEADWALL
AND WINGWALLS, COST TO INCLUDE RESEEDING
LT. STA. 291+27 (C EBL)

GENERAL CLEANING AND CLEANING
RT. STA. 283+11 TO STA. 283+63 (C EBL)

EARTH EXCAVATION
20' X 15' X 2' COST TO
INCLUDE GENERAL CLEANING
RT. STA. 290+20 (C EBL)

Wed Feb 10 08:00:00 2004
 C:\PROJECTS\2002\200202\FPS\200202\FPS.dwg
 DMS-D980202020202\FPS.dwg
 L:\FR\2003\958161

100' 0 50' 100'

STA. 262+00 TO STA. 294+00 (EB)
STA. 623+00 TO STA. 655+00 (WB)