

F.A.I. REL.	SECTION	COUNTY	TOTAL SHEETS	SHEET NO.
24	*	JOHNSON	150	57

FED. ROAD DIST. NO. ILLINOIS PROJECT  
 \* (44-5,6)RS, BSMRT FY04-3

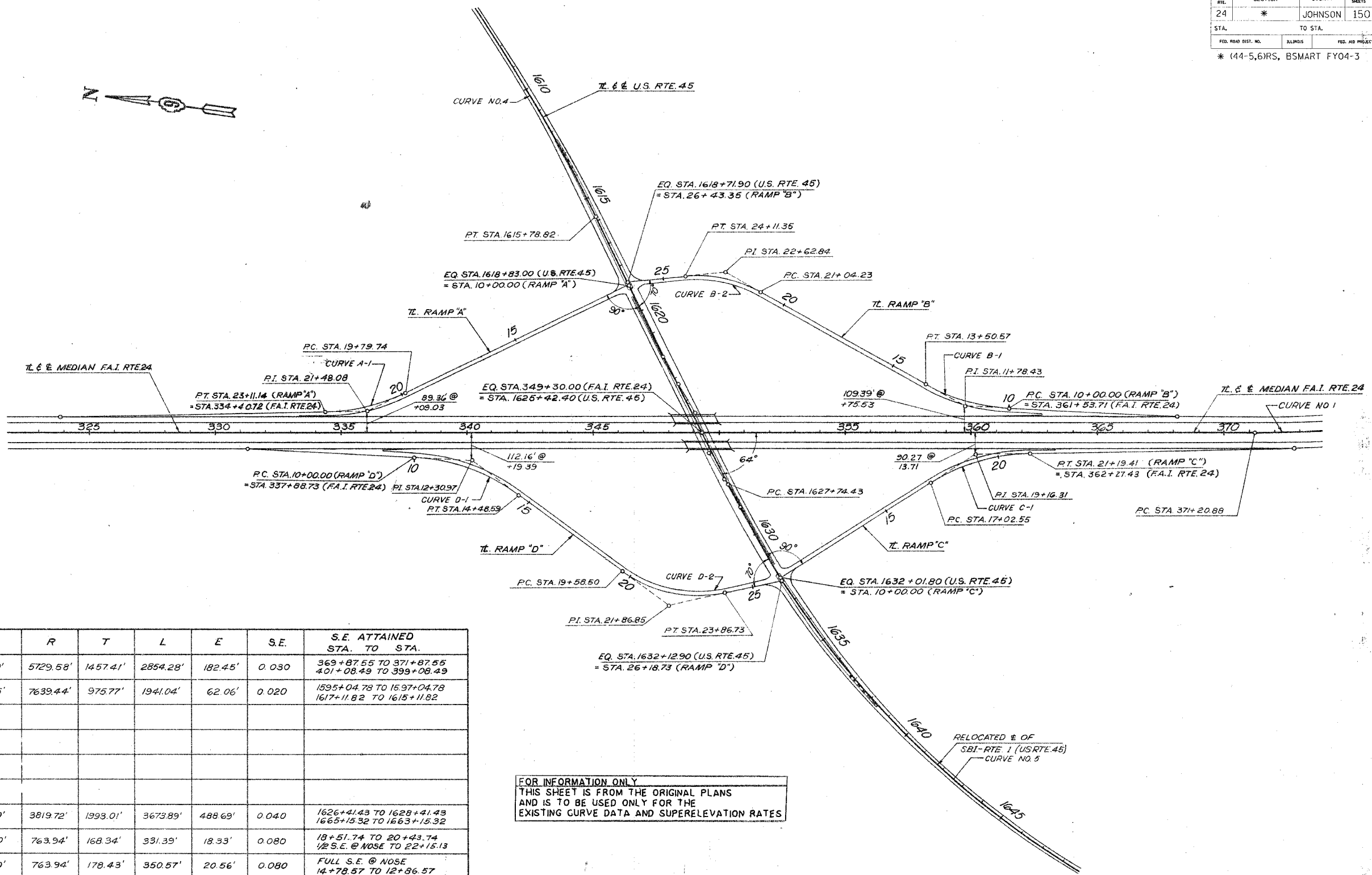

ROUTE	PI	CURVE NO.	Δ	D	R	T	L	E	S.E.	S.E. ATTAINED STA. TO STA.
FAI-24	385+78.29	1	28°32'34"	1°00'	5729.58'	1457.41'	2854.28'	182.45'	0.030	369+87.55 TO 371+87.55 401+08.49 TO 399+08.49
US 45 E	1606+13.55	4	14°33'28"	0°45'	7639.44'	975.77'	1941.04'	62.06'	0.020	1595+04.78 TO 15.97+04.78 1617+11.82 TO 1615+11.82
US 45 E	1647+674.4	5	55°06'30"	1°30'	3819.72'	1993.01'	3673.89'	488.69'	0.040	1626+41.43 TO 1628+41.43 1665+15.32 TO 1663+15.32
RAMP "A"	21+48.09	A-1	24°51'15"	7°30'	763.94'	168.34'	331.39'	18.33'	0.080	18+51.74 TO 20+43.74 1/2 S.E. @ NOSE TO 22+15.13
RAMP "B"	11+78.43	B-1	26°17'35"	7°30'	763.94'	178.43'	350.57'	20.56'	0.080	FULL S.E. @ NOSE 14+78.57 TO 12+86.57
RAMP "B"	22+62.84	B-2	35°19'08"	11°30'	498.22'	158.61'	307.12'	24.64'	0.080	19+92.23 TO 21+60.23 25+23.35 TO 23+55.35
RAMP "C"	19+16.31	C-1	31°15'53"	7°30'	763.94'	213.76'	416.86'	29.34'	0.080	15+74.55 TO 17+06.55 1/2 S.E. @ NOSE TO 20+23.41
RAMP "D"	12+30.97	D-1	33°38'40"	7°30'	763.94'	230.97'	448.59'	34.15'	0.080	FULL S.E. @ NOSE 15+76.59 TO 13+84.59
RAMP "D"	21+86.85	D-2	49°14'50"	11°30'	498.22'	228.35'	428.23'	49.84'	0.080	18+46.60 TO 20+14.50 24+98.73 TO 23+90.73

FOR INFORMATION ONLY  
 THIS SHEET IS FROM THE ORIGINAL PLANS  
 AND IS TO BE USED ONLY FOR THE  
 EXISTING CURVE DATA AND SUPERELEVATION RATES