

STATE OF ILLINOIS
DEPARTMENT OF TRANSPORTATION

ROUTE NO.	SECTION	COUNTY	SHEET NO.	SHEET	SHEET NO.
F.A.P. 595	1-3-K	Rock Island	476	281	5 SHEETS
FED. ROAD DIST. NO. 7	ILLINOIS	FED. AID PROJECT-			

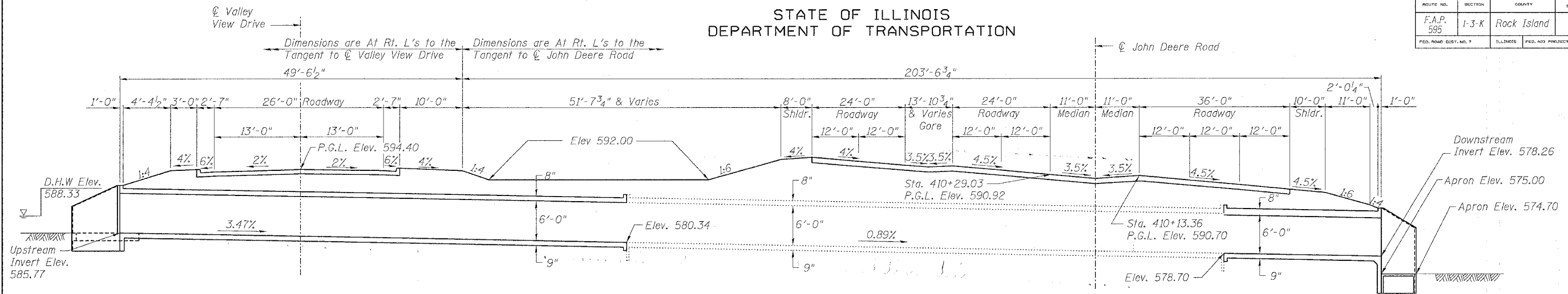

LONGITUDINAL SECTION

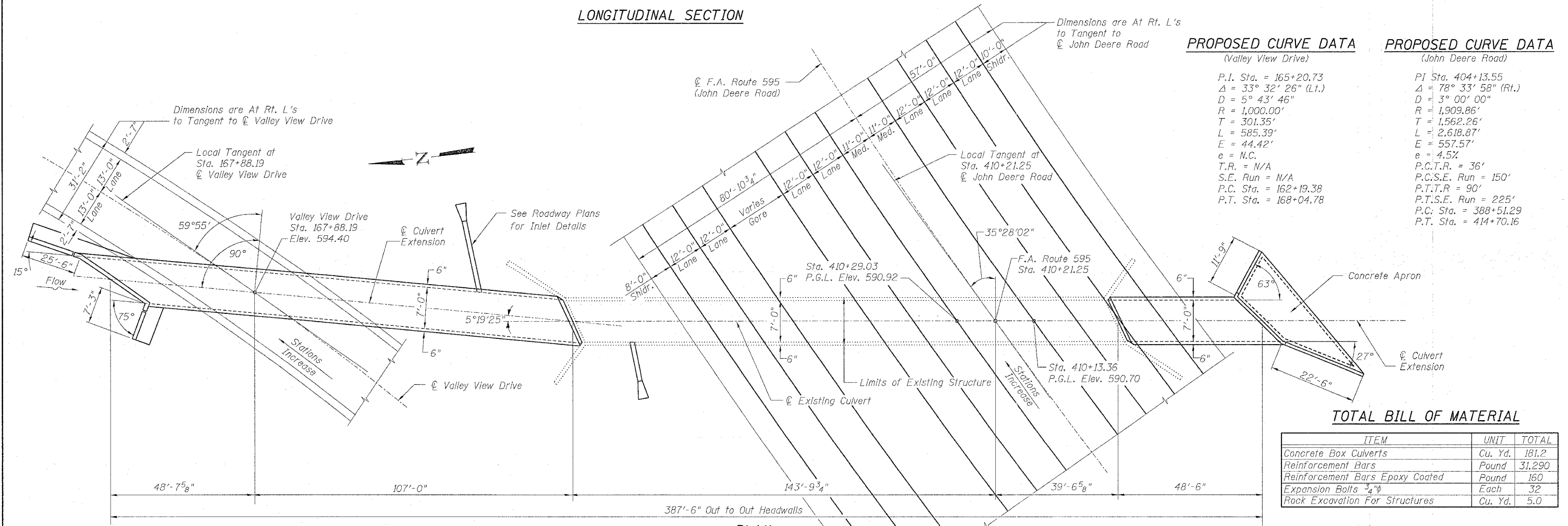

PROPOSED CURVE DATA
(Valley View Drive)

Dimensions are At Rt. L's to Tangent to John Deere Road

P.I. Sta.	= 165+20.73
Δ	= 33° 32' 26" (Lt.)
D	= 5° 43' 46"
R	= 1,000.00'
T	= 301.35'
L	= 585.39'
E	= 44.42'
e	= N.C.
T.R.	= N/A
S.E. Run	= N/A
P.C. Sta.	= 162+19.38
P.T. Sta.	= 168+04.78

PROPOSED CURVE DATA
(John Deere Road)

PI Sta.	= 404+13.55
Δ	= 78° 33' 58" (Rt.)
D	= 3° 00' 00"
R	= 1,909.86'
T	= 1,562.26'
L	= 2,618.87'
E	= 557.57'
e	= 4.5%
P.C.T.R.	= 36'
P.C.S.E. Run	= 150'
P.T.T.R.	= 90'
P.T.S.E. Run	= 225'
P.C. Sta.	= 388+51.29
P.T. Sta.	= 414+70.16

TOTAL BILL OF MATERIAL

ITEM	UNIT	TOTAL
Concrete Box Culverts	Cu. Yd.	181.2
Reinforcement Bars	Pound	31,290
Reinforcement Bars Epoxy Coated	Pound	160
Expansion Bolts 3/4"	Each	32
Rock Excavation For Structures	Cu. Yd.	5.0

WATERWAY INFORMATION

Drainage Area = 160 Acres Low Grade Elev. 594.12 @ Sta. 168+64.2

Flood	Freq. Yr.	Q C.F.S.	Opening Sq. Ft.		Nat. H.W.E.	Head - Ft.		Headwater El.
			Exist.	Prop.		Exist.	Prop.	
Design	50	281.6	-	39.8	588.33	-	3.13	591.46
Base	100	313.6	-	42.0	588.46	-	3.47	591.93
Overtopping	-	-	-	-	-	-	-	-
Max. Calc.	500	434	-	-	-	-	-	-

500 year Q is estimated

DESIGN STRESSES

FIELD UNITS
f_c = 3,500 psi
f_y = 60,000 psi (Reinforcement)

LOADING HS20-44 & ALT.

GENERAL PLAN
MILAN BELTWAY AND JOHN DEERE ROAD
OVER UNNAMED STREAM
FA ROUTE 595 SECTION 1-3-K
ROCK ISLAND COUNTY
STATION 410+21.25 (JOHN DEERE ROAD)
STATION 167+88.19 (VALLEY VIEW DRIVE)

DESIGNED	BDF
CHECKED	BDF
DRAWN	RAP
CHECKED	BDF