

F.A.P. RTE.	SECTION	COUNTY	TOTAL SHEETS	SHEET NO.
595	1-3-K	ROCK ISLAND	476	246
STA.		TO STA.		
FED. ROAD DIST. NO.		ILLINOIS FED. AID PROJECT		

** = QUANTITIES INCLUDED IN 52nd Ave./ RAMP 3 & 4 INTERSECTION

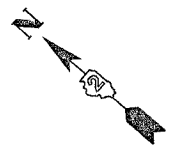

LEFT ON GREEN ARROW ONLY
R10-5
2 REQ'D

THIS SIGN SHALL BE LOCATED 12 INCHES TO THE RIGHT OF EACH 3 SECTION MAST ARM MOUNTED LEFT TURN SIGNAL. THIS SIGN SHALL BE LOCATED DIRECTLY BELOW EACH BRACKET MOUNTED LEFT TURN ARROW SIGNAL

* = QUANTITIES INCLUDED IN VALLEY VIEW DR. INTERSECTION

NO TURN ON RED
R-10-11b
2 REQ'D.

THIS SIGN SHALL BE MOUNTED DIRECTLY BELOW EACH OF THE BRACKET MOUNTED RIGHT TURN SIGNALS LOCATED IN THE MEDIAN

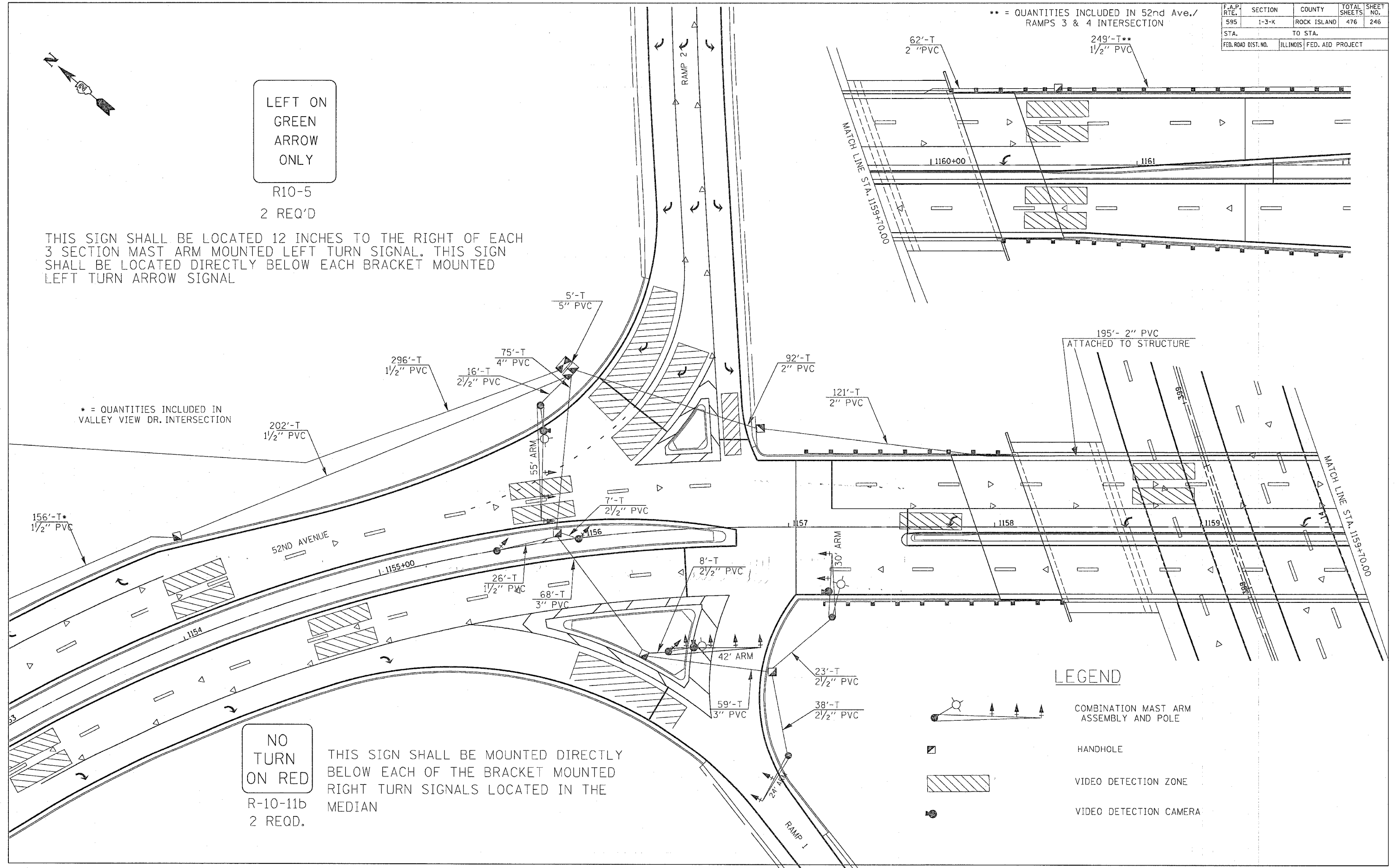

LEGEND

- COMBINATION MAST ARM ASSEMBLY AND POLE
- HANDHOLE
- VIDEO DETECTION ZONE
- VIDEO DETECTION CAMERA