

ROUTE	SECTION	COUNTY	TOTAL SHEETS	SHEET NUMBER
VARIOUS	2008-013 PP	KANE	34+1=35	1

STATE OF ILLINOIS
DEPARTMENT OF TRANSPORTATION
DIVISION OF HIGHWAYS
DISTRICT ONE
PROPOSED HIGHWAY PLANS

CONTRACT NO. 60E39

D-91-364-08

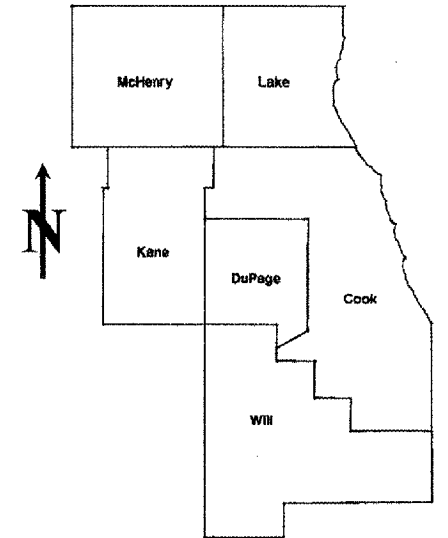

LOCATION OF IMPROVEMENT INDICATED THUS:

FOR INDEX OF SHEETS SEE SHEET 2

VARIOUS ROUTES
 SECTION: 2008-013 PP
 VARIOUS LOCATIONS IN KANE COUNTY
 PAVEMENT PATCHING
 KANE COUNTY
 C-91-364-08

DISTRICT ONE - DESIGN - PLAN PREPARATION ENGINEER:
 KEN ENG / (847) 705-4247

CONTRACT NO. 60E39

STATE OF ILLINOIS
DEPARTMENT OF TRANSPORTATION
DIVISION OF HIGHWAYS
 SUBMITTED: MARCH 14, 2008
Diane M. O'Keefe or
 DEPUTY DIRECTOR OF HIGHWAYS, REGION ENGINEER
March 20, 2008
Eric E. Horn
 INTERIM ENGINEER OF DESIGN AND ENVIRONMENT
March 20, 2008
Christine M. Reed
 DIRECTOR, DIVISION OF HIGHWAYS

PRINTED BY THE AUTHORITY
OF THE STATE OF ILLINOIS

J.U.L.I.E.: JOINT UTILITY LOCATION
INFORMATION FOR EXCAVATION
(312) 744-7000

INDEX OF SHEETS

<u>SHEET NO.</u>	<u>DESCRIPTION</u>
1	TITLE SHEET
2	INDEX OF SHEETS, STATE STANDARDS AND GENERAL NOTES
3	SUMMARY OF QUANTITIES
4	GENERAL LOCATION MAP
5	SUMMARY OF PATCHING SCHEDULE
6-28	PATCHING SCHEDULE
29	PAVEMENT PATCHING FOR HMA SURFACED PAVEMENT
30	BUTT JOINT AND HMA TAPER DETAILS
31	TYPICAL APPLICATIONS: RAISED REFLECTIVE PAVEMENT MARKERS (SNOW-PLOW RESISTANT)
32	DISTRICT ONE TYPICAL PAVEMENT MARKINGS
33	TRAFFIC CONTROL AND PROTECTION OF TURN BAYS (TO REMAIN OPEN TO TRAFFIC)
34	ARTERIAL ROAD INFORMATION SIGN
34A	TRAFFIC CONTROL AND PROTECTION FOR SIDE ROADS, INTERSECTIONS AND DRIVEWAYS

STATE STANDARDS

<u>STANDARD NO.</u>	<u>DESCRIPTION</u>
000001-05	TYPICAL SYMBOLS, ABBREVIATIONS AND PATTERNS
442201-03	CLASS C AND D PATCHES
701201-02	LANE CLOSURE, 2L, 2W, DAY ONLY
701306-01	LANE CLOSURE, 2L, 2W, SLOW MOVING OPERATIONS - DAY ONLY
701336-04	LANE CLOSURE, 2L, 2W, WORK AREAS IN SERIES
701501-04	URBAN LANE CLOSURE, 2L, 2W, UNDIVIDED
701601-05	URBAN LANE CLOSURE, MULTILANE, 1W OR 2W WITH NONTRAVERSABLE MEDIAN
701606-05	URBAN LANE CLOSURE, MULTILANE, 2W WITH MOUNTABLE MEDIAN
701701-05	URBAN LANE CLOSURE, MULTILANE INTERSECTION
701901	TRAFFIC CONTROL DEVICES

GENERAL NOTES

BEFORE STARTING ANY EXCAVATION, THE CONTRACTOR SHALL CALL "JULIE" AT (800) 892-0123 OR 811 FOR FIELD LOCATIONS OF BURIED ELECTRIC, TELEPHONE AND GAS FACILITIES. (48 HOUR NOTIFICATION REQUIRED)

THE CONTRACTOR WILL NOT BE ALLOWED TO SET UP A YARD OR FIELD OFFICE ON STATE (OR TOLLWAY) PROPERTY WITHOUT WRITTEN PERMISSION FROM THE DEPARTMENT (OR ISTHA)

WHEN ARTIFICIAL LIGHTING IS UTILIZED IN NIGHT OPERATIONS, THE CONTRACTOR SHALL EXERCISE THE UTMOST PRECAUTIONS IN PREVENTING ADVERSE VISIBILITY TO THE MOTORING PUBLIC AND ADJOINING RESIDENTIAL AREAS.

ANY PAVEMENT MARKINGS AND RAISED REFLECTIVE PAVEMENT MARKERS OBLITERATED BY MILLING AND RESURFACING OPERATIONS ON SIDE STREETS AND ENTRANCES SHALL BE REPLACED AND PAID FOR IN KIND.

BEFORE BEGINNING ANY WORK, THE CONTRACTOR SHALL RETAIN AND RECORD FOR FUTURE REFERENCE, ALL EXISTING PAVEMENT MARKING LINES (AND RAISED REFLECTIVE PAVEMENT MARKERS) IN ORDER THAT THESE LOCATIONS CAN BE RE-ESTABLISHED FOR STRIPING. EXACT LOCATIONS OF ALL PAVEMENT MARKINGS SHALL BE AS DIRECTED BY THE ENGINEER.

ALL PAVEMENT PATCHING LOCATIONS WILL BE DETERMINED IN THE FIELD BY THE ENGINEER.

DRAINAGE ADJUSTMENT OR RECONSTRUCTION LOCATIONS WILL BE DETERMINED IN THE FIELD BY THE ENGINEER.

THE CONTRACTOR SHALL CONTACT THE DISTRICT ONE TRAFFIC CONTROL SUPERVISOR AT (847) 705-4470 A MINIMUM OF 72 HOURS IN ADVANCE OF BEGINNING WORK.

THE ENGINEER SHALL CONTACT MS. CORA MATHIS, AREA TRAFFIC FIELD ENGINEER AT (815) 485-6475 MINIMUM OF TWO (2) WEEKS PRIOR TO PLACEMENT OF PERMANENT PAVEMENT MARKINGS.

DOUBLE LANE MARKERS ARE TO BE USED AS SHOWN ON THE DISTRICT ONE DETAIL "TYPICAL APPLICATIONS - RAISED REFLECTIVE PAVEMENT MARKERS (SNOW-PLOW RESISTANT)" SHOWN IN THE PLANS.

THE EXISTING ROADWAY TYPICAL SECTION IS ASSUMED TO HAVE A 3 INCH HOT-MIX ASPHALT OVERLAY ON TOP OF A TEN INCH CONCRETE BASE.

HOT-MIX ASPHALT MIXTURE REQUIREMENTS

MIXTURE TYPE	AC TYPE	AIR VOIDS (%)
HOT-MIX ASPHALT SURFACE COURSE, MIX "D", N70 (IL 9.5 MM)	PG 64-22	4% @ 70 GYR
LEVELING BINDER (MM), N70	PG 64-22/58-22	4% @ 70 GYR
CLASS D PATCHES, (HMA BINDER IL-19.0 MM)	PG 64-22 *	4% @ 70 GYR
HOT-MIX ASPHALT REPLACEMENT OVER PATCHES, (HMA BINDER IL-19.0 MM)	PG 64-22 *	4% @ 70 GYR

THE UNIT WEIGHT USED TO CALCULATE ALL HOT-MIX ASPHALT SURFACE MIXTURE QUANTITIES IS 112 LBS/SY/IN.

* WHEN RAP EXCEEDS 20%, THE NEW ASPHALT BINDER IN THE MIX SHALL BE PG 58-22

SUMMARY OF QUANTITIES			URBAN 100% STATE TOTAL QUANTITIES		CONSTRUCTION TYPE CODE				
CODE NO	ITEM	UNIT			1000-2A				
40600200	BITUMINOUS MATERIALS (PRIME COAT)	TON	9	9					
40600300	AGGREGATE (PRIME COAT)	TON	48	48					
40600400	MIXTURE FOR CRACKS, JOINTS, AND FLANGEWAYS	TON	10	10					
40600635	LEVELING BINDER (MACHINE METHOD), N70	TON	770	770					
40600982	HOT-MIX ASPHALT SURFACE REMOVAL - BUTT JOINT	SO YD	4560	4560					
40601005	HOT-MIX ASPHALT REPLACEMENT OVER PATCHES	TON	1080	1080					
40603340	HOT-MIX ASPHALT SURFACE COURSE, MIX "D", N70	TON	1550	1550					
44000158	HOT-MIX ASPHALT SURFACE REMOVAL, 2 1/4"	SO YD	18261	18261					
44002212	HOT-MIX ASPHALT REMOVAL OVER PATCHES, 3"	SO YD	22000	22000					
44201761	CLASS D PATCHES, TYPE I, 10 INCH	SO YD	844	844					
44201765	CLASS D PATCHES, TYPE II, 10 INCH	SO YD	2413	2413					
44201769	CLASS D PATCHES, TYPE III, 10 INCH	SO YD	668	668					
44201771	CLASS D PATCHES, TYPE IV, 10 INCH	SO YD	1387	1387					
67000400	ENGINEER'S FIELD OFFICE, TYPE A	CAL MO	3	3					
67100100	MOBILIZATION	L SUM	1	1					
70100450	TRAFFIC CONTROL AND PROTECTION, STANDARD 701201	L SUM	1	1					
70100460	TRAFFIC CONTROL AND PROTECTION, STANDARD 701306	L SUM	1	1					
70100600	TRAFFIC CONTROL AND PROTECTION, STANDARD 701336	L SUM	1	1					
70102620	TRAFFIC CONTROL AND PROTECTION, STANDARD 701501	L SUM	1	1					
70102625	TRAFFIC CONTROL AND PROTECTION, STANDARD 701606	L SUM	1	1					
70102630	TRAFFIC CONTROL AND PROTECTION, STANDARD 701601	L SUM	1	1					
70102635	TRAFFIC CONTROL AND PROTECTION, STANDARD 701701	L SUM	1	1					
* 78000200	THERMOPLASTIC PAVEMENT MARKING - LINE 4"	FOOT	32640	32640					

SUMMARY OF QUANTITIES			URBAN 100% STATE TOTAL QUANTITIES		CONSTRUCTION TYPE CODE				
CODE NO	ITEM	UNIT			1000-2A				
* 78100100	RAISED REFLECTIVE PAVEMENT MARKER	EACH	592	592					
78300200	RAISED REFLECTIVE PAVEMENT MARKER REMOVAL	EACH	592	592					
X0322256	TEMPORARY INFORMATION SIGNING	SO FT	720	720					

* SPECIALTY ITEM

REVISIONS	
NAME	DATE

ILLINOIS DEPARTMENT OF TRANSPORTATION
SUMMARY OF QUANTITIES

Rev.

PLOT DATE: 3/14/2008

3/14/2008 10:35:09 AM User:wilgreendp

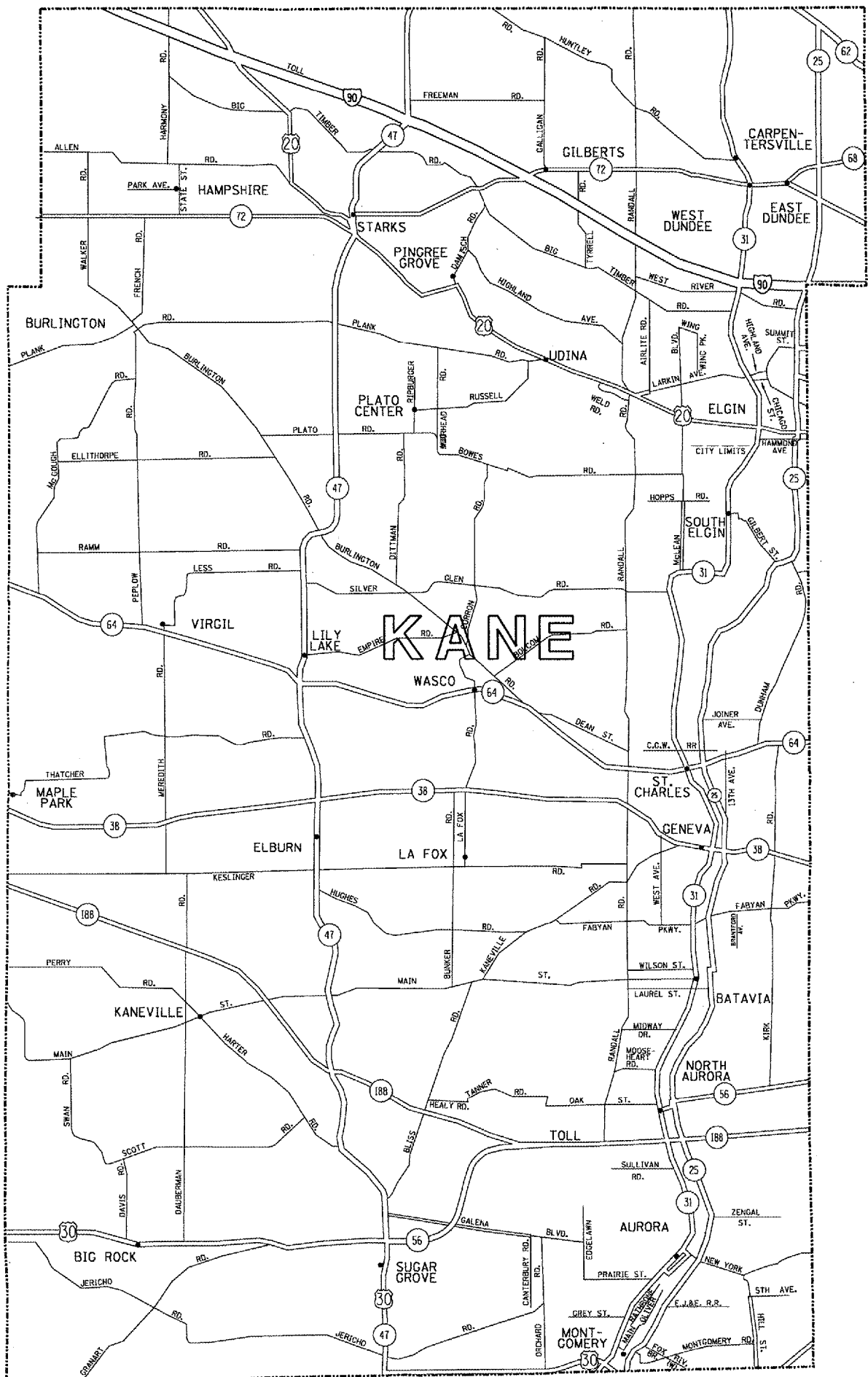

FILE NAME =	ci:\projects\113408\sh_rdwg.dgn
USER NAME =	smithkl
PLOT SCALE =	100.0000' / IN.
PLOT DATE =	3/14/2008

DESIGNED -	REVISOR -
DRAWN -	REVISOR -
CHECKED -	REVISOR -
DATE -	REVISOR -

**STATE OF ILLINOIS
DEPARTMENT OF TRANSPORTATION**

GENERAL LOCATION MAP - KANE COUNTY			
SCALE:	SHEET NO.	OF SHEETS	STA. TO STA.

F.A. RTE.	SECTION	COUNTY	TOTAL SHEETS	SHEET NO.
VAR.	2008-013 PP	KANE	34	4
FED. ROAD DIST. NO. 1 (ILLINOIS) FED. AID PROJECT				
CONTRACT NO. 60E39				

KANE COUNTY ROUTE SEGMENT	MILL & RESURF (SY)	CLASS D PATCH TYPE I (SY)	CLASS D PATCH TYPE II (SY)	CLASS D PATCH TYPE III (SY)	CLASS D PATCH TYPE IV (SY)	PAVT MARKING 4" (FT)	RAISED REFL PAVT MKS (EACH)
GALENA BLVD (IL 56 TO HANKES ROAD)	653	46	104	20	90	1800	35
IL 31 (LOVEDALE LANE TO IL 56)	577	32	14			2100	30
IL 47 (MAIN STREET TO DEAN STREET)	534	185	103			3500	35
IL 47 (ROLLING OAKS ROAD TO GALENA BLVD)	1955	164	282	120	361	5400	95
IL 47 (US 30 TO JERICHO ROAD)	2027		300	20		4500	50
IL 47 AT IL 56 RAMPS	335	49	194			750	0
IL 58 IN ELGIN	299	27	59			1000	8
IL 64 (8TH AVENUE TO IL 59)	2129	267	742	96		4700	50
IL 64 (LAFOX ROAD TO DEAN STREET)	1291	19	53	42		3500	25
US 20 AT I-90 (HAMPSHIRE)		21	286	88	67	480	24
US 20 RIGHT TURN LANE TO SB IL 47					347	300	6
US 30 (DOUGLASS TO US 34)	798	7	46	151	212	340	16
US 30 (US 34 TO HEGGS ROAD)	6889	8	128	111	310	3500	180
IL 25 (HAZEL AVE TO KANE / KENDALL COUNTY LINE)	774	19	102	20		770	38
SUMMARY TOTALS:	18261	844	2413	668	1387	32640	592

FILE NAME =	USER NAME = wilgrands	DESIGNED -	REVISED -
cr\projects\1136408\design.ea.dgn		DRAWN -	REVISED -
		CHECKED -	REVISED -
		DATE -	REVISED -

**STATE OF ILLINOIS
DEPARTMENT OF TRANSPORTATION**

**SUMMARY OF PATCHING SCHEDULE
KANE COUNTY**

SCALE: SHEET NO. OF SHEETS STA. TO STA.

F.A.P. RTE.	SECTION	COUNTY	TOTAL SHEETS	SHEET NO.
VAR.	2008-013 PP	KANE	34	5
CONTRACT NO. 60E39				

ROUTE: US 20 at I-90 (Hampshire)

CROSS STREETS		DIRECTION (EB/WB) (NB/SB)	LANE NO. (1, 2, 3)	PAVEMENT PATCH WIDTH	PAVEMENT PATCH LENGTH	REPAIR AREA (SQ FT)	REPAIR AREA (SQ YD)	MILL & RESURF	CLASS D PATCH TYPE I	CLASS D PATCH TYPE II	CLASS D PATCH TYPE III	CLASS D PATCH TYPE IV	PAVT MARKING 4"	RAISED REFL PAVT MARKERS
FROM	TO													
500' e/o Higgins Rd.	700' w/o I-90 ramp	WB	1	6	8		5			5				
500' e/o Higgins Rd.	700' w/o I-90 ramp	WB	1	6	6		4		5					
500' e/o Higgins Rd.	700' w/o I-90 ramp	WB	1	12	12		16				16			
500' e/o Higgins Rd.	700' w/o I-90 ramp	WB	1	12	8		11			11				
500' e/o Higgins Rd.	700' w/o I-90 ramp	WB	1	12	12		16				16			
500' e/o Higgins Rd.	700' w/o I-90 ramp	WB	1	4	4		2		2					
500' e/o Higgins Rd.	700' w/o I-90 ramp	WB	1	12	6		8			8				
500' e/o Higgins Rd.	700' w/o I-90 ramp	WB	1	12	6		8			8				
500' e/o Higgins Rd.	700' w/o I-90 ramp	WB	1	12	12		16				16			
500' e/o Higgins Rd.	700' w/o I-90 ramp	WB	1	12	6		8			8				
500' e/o Higgins Rd.	700' w/o I-90 ramp	WB	1	12	10		13			13				
500' e/o Higgins Rd.	700' w/o I-90 ramp	WB	1	6	10		7			7				
500' e/o Higgins Rd.	700' w/o I-90 ramp	WB	1	12	20		27					27		
500' e/o Higgins Rd.	700' w/o I-90 ramp	WB	1	6	30		20				20			
500' e/o Higgins Rd.	700' w/o I-90 ramp	WB	1	12	30		40					40		
500' e/o Higgins Rd.	700' w/o I-90 ramp	WB	1	12	15		20				20			
500' e/o Higgins Rd.	700' w/o I-90 ramp	WB	1	6	20		13			13				
500' e/o Higgins Rd.	700' w/o I-90 ramp	WB	1	12	6		8			8				
500' e/o Higgins Rd.	700' w/o I-90 ramp	WB	1	6	12		8			8				
500' e/o Higgins Rd.	700' w/o I-90 ramp	WB	1	12	8		11			11				
500' e/o Higgins Rd.	700' w/o I-90 ramp	WB	1	12	8		11			11				
500' e/o Higgins Rd.	700' w/o I-90 ramp	EB	1	12	6		8			8				
500' e/o Higgins Rd.	700' w/o I-90 ramp	EB	2	6	4		3		3					
500' e/o Higgins Rd.	700' w/o I-90 ramp	EB	2	12	4		5			5				
500' e/o Higgins Rd.	700' w/o I-90 ramp	EB	2	12	6		8			8				
500' e/o Higgins Rd.	700' w/o I-90 ramp	EB	2	12	6		8			8				
500' e/o Higgins Rd.	700' w/o I-90 ramp	EB	2	6	8		5			5				
500' e/o Higgins Rd.	700' w/o I-90 ramp	EB	2	6	4		3		3					
500' e/o Higgins Rd.	700' w/o I-90 ramp	EB	2	6	10		7			7				
500' e/o Higgins Rd.	700' w/o I-90 ramp	EB	2	6	6		4		4					
500' e/o Higgins Rd.	700' w/o I-90 ramp	EB	2	6	6		4		4					
500' e/o Higgins Rd.	700' w/o I-90 ramp	EB	1	12	8		11			11				
500' e/o Higgins Rd.	700' w/o I-90 ramp	EB	1	12	8		11			11				
500' e/o Higgins Rd.	700' w/o I-90 ramp	EB	1	6	15		10			10				
500' e/o Higgins Rd.	700' w/o I-90 ramp	EB	1	12	8		11			11				
500' e/o Higgins Rd.	700' w/o I-90 ramp	EB	1	12	10		13			13				
500' e/o Higgins Rd.	700' w/o I-90 ramp	EB	1	12	8		11			11				
500' e/o Higgins Rd.	700' w/o I-90 ramp	EB	1	12	6		8			8				
500' e/o Higgins Rd.	700' w/o I-90 ramp	EB	1	12	6		8			8				
500' e/o Higgins Rd.	700' w/o I-90 ramp	EB	1	12	8		11			11				
500' e/o Higgins Rd.	700' w/o I-90 ramp	EB	1	12	8		11			11				
500' e/o Higgins Rd.	700' w/o I-90 ramp	EB	1	12	6		8			8				
500' e/o Higgins Rd.	700' w/o I-90 ramp	EB	1	6	8		5			5				
500' e/o Higgins Rd.	700' w/o I-90 ramp	EB	1	12	6		8			8				
500' e/o Higgins Rd.	700' w/o I-90 ramp	EB	1	12	6		8			8				

TOTALS: 459 SY 21 SY 286 SY 88 SY 67 SY 480 FT 24 EACH

ROUTE: EB US 20 Right Turn Lane to SB IL 47 (Starks)

CROSS STREETS		DIRECTION (EB/WB) (NB/SB)	LANE NO. (1, 2, 3)	PAVEMENT PATCH WIDTH	PAVEMENT PATCH LENGTH	REPAIR AREA (SQ FT)	REPAIR AREA (SQ YD)	MILL & RESURF	CLASS D PATCH TYPE I	CLASS D PATCH TYPE II	CLASS D PATCH TYPE III	CLASS D PATCH TYPE IV	PAVT MARKING 4"	RAISED REFL PAVT MKS
FROM	TO													
U.S. 20, 60' w/o IL 47	U.S. 20 at IL 47	EB	2	12	60		80					80		
IL 47 at u.s. 20	200' s/o U.S. 20	SB	2	12	200		267					267		

TOTALS: 347 SY 347 SY 300 FT 6 EACH

FILE NAME = c:\projects\136489\design\...
 USER NAME = wjgroendp
 PLOT SCALE = 1/8" = 1' IN.
 PLOT DATE = 3/14/2008

DESIGNED -
 DRAWN -
 CHECKED -
 DATE -
 REVISED -
 REVISED -
 REVISED -
 REVISED -

STATE OF ILLINOIS
 DEPARTMENT OF TRANSPORTATION

PATCHING SCHEDULE
 US 20

SCALE: SHEET NO. OF SHEETS STA TO STA

F.A.P. SECTION COUNTY TOTAL SHEETS SHEET NO.
 VAR. 2008-013 PP KANE 34 6
 CONTRACT NO. 60E39

ROUTE: US. RTE. 30 FROM US.34 TO HEGGS RD

CROSS STREETS		DIRECTION (EB/WB) (NB/SB)	LANE NO. (1, 2, 3)	PAVEMENT PATCH WIDTH	PAVEMENT PATCH LENGTH	REPAIR AREA (SQ. FT)	REPAIR AREA (SQ. YD)	MILL & RESURF	CLASS C PATCH TYPE I	CLASS C PATCH TYPE II	CLASS C PATCH TYPE III	CLASS C PATCH TYPE IV	PAVT MARKING 4"	RAISED REFL PAVT MKS
FROM	TO													
US. 34		SB	2	11	30	330	37					37		
LINCOLN ST	PROCLAMATION	SB	2	10	75	750	83	83						
	HARVEY RD	SB	2	6	80	480	53	53						
PROCLAMATION		SB	2	8	300	2400	267	267						
	60' NORTH OF HARVEY RD	SB	2	6	6	36	4		4					
		SB	2	11	12	132	15				15			
AT HARVEY & US. 30 INTERSECTION		SB	2	16	100	1600	178	178						
		SB	2	6	12	72	8			8				
100' N OF HARVEY TO SOUTH OF HARVEY	CENTER LINE JOINT	SB	1	4	500	2000	222	222						
HARVEY	MITCHEL/ E.O.P	SB	2	6	500	3000	333	333						
	E.O.P / JOINT	SB	1	6	300	1800	200	200						
	SB/ SHOULDER	SB	1	6	20	120	13			13				
100' NORTH OF TREASURE		MIDDLE		6	200	1200	133	133						
S. OF TREASURE DR		SB	1	6	300	1800	200	133						
300' SOUTH OF TREASURE DR.	JOINT FAILURE	SB	1	6	200	1200	133	133						
1000' SOUTH OF TREASURE DR	3' WIDENING JOINT	SB	1	6	600	3600	400	400						
	CENTER LINE JOINT	SB	2	6	1000	6000	667	667						
100' NORTH OF BOX CULVERT	E.O.P	SB	1	8	40	320	36	36						
SOUTH & NORTH OF PIPE CULVERT		SB	1	12	100	1200	133	133						
100' SOUTH OF PIPE CULVERT		SB	1	6	40	240	27	27						
200' S OF PIPE CULVERT		SB	1	12	150	1800	200	200						
500' N. OF WOLF RD		SB	1	12	200	2400	267	267						
350' N. OF WOLF RD		SB	1	12	30	360	40				40			
300' N. OF WOLF RD		SB	1	12	60	720	80	80						
250' N. OF WOLF RD		SB	1	12	12	144	16				16			
150' N. OF WOLF RD		SB	1	12	20	240	27					27		
20' S. OF WOLF RD		SB	1	6	12	72	8			8				
100' S. OF WOLF RD	NEAR E.O.P	SB	1	6	100	600	67	67						
200' S OF WOLF RD		SB	1	12	8	96	11			11				
220' S. OF WOLF RD	NEAR E.O.P	SB	1	6	6	36	4		4					
250' S. OF WOLF RD		SB	1	6	10	60	7			7				
280' S. OF WOLF RD		SB	1	8	12	96	11			11				
350' S OF WOLF RD		SB	1	12	80	960	107	107						
500' S OF WOLF RD		SB	1	12	30	360	40				40			
600' S OF WOLF RD		SB	2	12	80	960	107	107						
700' S. OF WOLF RD		SB	1	12	40	480	53				53			
800' S. OF WOLF RD		SB	1	12	150	1800	200	200						
SOUTH OF WOLF RD		SB	1	12	6	72	8			8				
100' N. OF HEGGS RD		SB	1	12	60	720	80	80						

CONTINUED ON THE NEXT SHEET

ROUTE: US. RTE. 30 FROM US.34 TO HEGGS RD

CROSS STREETS		DIRECTION (EB/WB) (NB/SB)	LANE NO. (1, 2, 3)	PAVEMENT PATCH WIDTH	PAVEMENT PATCH LENGTH	REPAIR AREA (SQ FT)	REPAIR AREA (SQ YD)	MILL & RESURF	CLASS C PATCH TYPE I	CLASS C PATCH TYPE II	CLASS C PATCH TYPE III	CLASS C PATCH TYPE IV	PAVT MARKING 4"	RAISED REFL PAVT MKS
FROM	TO													
AT HEGGS RD & US. 30		NB	1	22	50	1100	122	122						
50' N. OF HEGGS RD		NB	1	8	120	960	107	107						
100' N OF HEGGS RD		NB	1	6	60	360	40	40						
		NB	1	8	80	640	71	71						
		NB	1	8	80	640	71	71						
		NB	1	11	30	330	37					37		
		NB	1	8	200	1600	178	178						
		NB	1	11	160	1760	196	196						
		NB	1	8	16	128	14			14				
		NB	1	11	32	352	39					39		
		NB	1	11	50	550	61	61						
		NB	1	11	50	550	61	61						
300' S. OF WOLF RD		NB	1	11	200	2200	244	244						
200' S. OF WOLF RD		NB	1	11	100	1100	122	122						
INTERSECTION OF WOLF & US. 30		NB	1	12	60	720	80	80						
50' N. OF WOLF RD		NB	1	8	60	480	53	53						
100' N. OF WOLF RD		NB	1	10	40	400	44	44						
NORTH OF WOLF RD BY US. 30 MOTEL		NB	1	6	30	180	20				20			
		NB	1	6	10	60	7			7				
		NB	1	11	6	66	7			7				
		NB	1	10	100	1000	111	111						
		NB	1	11	100	1100	122	122						
		NB	1	8	300	2400	267	267						
		NB	1	8	120	960	107	107						
		NB	1	10	12	120	13			13				
		NB	1	6	300	1800	200	200						
		NB	1	10	60	600	67	67						
		NB	1	6	12	72	8			8				
		NB	1	6	20	120	13			13				
		NB	1	11	16	176	20				20			
N. OF GASTVILE		NB	1	11	60	660	73	73						
		NB	1	11	30	330	37					37		
		NB	1	6	25	150	17				17			
S. OF US. 34	E.O.P FAILURE	NB	1	6	230	1380	153	153						
	NORTH OF US. 34	NB	1	6	35	210	23				23			

TOTALS: 6889 SY 8 SY 128 SY 111 SY 310 SY 3500 FT 180 EACH

ROUTE: US. RTE. 30 FROM DOUGLASS TO US. RTE. 34

CROSS STREETS		DIRECTION (EB/WB) (NB/SB)	LANE NO. (1, 2, 3)	PAVEMENT PATCH WIDTH	PAVEMENT PATCH LENGTH	REPAIR AREA (SQ FT)	REPAIR AREA (SQ YD)	MILL & RESURF	CLASS C PATCH TYPE I	CLASS C PATCH TYPE II	CLASS C PATCH TYPE III	CLASS C PATCH TYPE IV	PAVT MARKING 4"	RAISED REFL PAVT MKS	
FROM	TO														
DOGLASS	5th Street	NB	1	6	6	36	4		4						
		NB	1	6	10	60	7			7					
		NB	1	6	11	66	7			7					
		NB	1	6	22	132	15				15				
		AT 5TH ST & US. 30 EAST OF 5TH ST.		NB	1	11	60	660	73	73					
				NB	1	10	100	1000	111	111					
				NB	1	8	80	640	71	71					
				NB	1	6	11	66	7			7			
				NB	1	6	11	66	7			7			
				NB	1	8	20	160	18				18		
				NB	1	12	12	144	16				16		
				NB,SB	1,1	22	8	176	20				20		
				NB,SB	1,1	22	8	176	20				20		
NB,SB	1,1			22	8	176	20				20				
NB,SB	1,1			22	40	880	98	98							
NB,SB	1,1			22	50	1100	122	122							
SB	1			11	20	220	24				24				
SB,NB	1,1			22	20	440	49					49			
5TH ST	US. RTE. 34	CENTER LINE JOINT		4	70	280	31	31				31			
		SB	1	11	16	176	20				20				
		SB	1	4	12	48	5			5					
		NB	1	4	6	24	3		3						
		NB	1	11	60	660	73	73							
		NB,SB	1,1	22	12	264	29					29			
		SB	1	6	50	300	33	33							
		NB,SB	1,1	22	36	792	88	88							
		NB,SB	1,1	22	12	264	29					29			
		SB	1	11	10	110	12				12				
BRIDGE DECK SURFACE		NB,SB	1,1	22	40	880	98	98							
NB,SB BRIDGE APPROACH, SOUTH OF US. 34		NB,SB	1,1	22	30	660	73				73				

TOTALS: 851 798 SY 7 SY 46 SY 151 SY 212 SY 340 FT 16 EACH

FILE NAME =
c:\projects\dl36408\design.ee.dgn

USER NAME = wjgreendp
PLOT SCALE = 100.0000' / IN.
PLOT DATE = 3/14/2008

DESIGNED -
DRAWN -
CHECKED -
DATE -

REVISED -
REVISED -
REVISED -
REVISED -

STATE OF ILLINOIS
DEPARTMENT OF TRANSPORTATION

PATCHING SCHEDULE
US 30

SCALE: SHEET NO. OF SHEETS STA. TO STA.

F.A.P. RTE.	SECTION	COUNTY	TOTAL SHEETS	SHEET NO.
VAR.	2008-013 PP	KANE	34	9
CONTRACT NO. 60E39				

FFD. ROAD DIST. NO. 1 ILLINOIS FED. AID PROJECT

ROUTE: ILL 25 (Hazel to Kane / Kendall County Line)

CROSS STREETS		DIRECTION (EB/WB) (NB/SB)	LANE NO. (1, 2, 3)	PAVEMENT PATCH WIDTH	PAVEMENT PATCH LENGTH	REPAIR AREA (SQ FT)	REPAIR AREA (SQ YD)	MILL & RESURF	CLASS C PATCH TYPE I	CLASS C PATCH TYPE II	CLASS C PATCH TYPE III	CLASS C PATCH TYPE IV	PAVT MARKING 4"	RAISED REFL PAVT MKS
FROM	TO													
Hazel	1000' south	SB	1	4	5	20	2		2					
	1500' South	SB	1	10	100	1000	111	111						
Ashland	250' South	SB	1	4	30	120	13			13				
Keck	100 North	SB	1	6	4	24	3		3					
Marsch	200' South	SB	1	4	26	104	12			12				
Hartway	100' South	SB	1	4	5	20	2		2					
	1000' South	SB	1	4	100	400	44	44						
River Rd	At	SB	1	4	200	800	89	89						
Mill St	1000' South	SB	1	4	20	80	9			9				
	1500' South	SB	1	4	140	560	62	62						
	2000' South	SB	1	4	200	800	89	89						
	2300' South	SB	1	4	60	240	27	27						
Kane Line	1000' North	NB	1	4	10	40	4		4					
	1200' North	NB	1	4	6	24	3		3					
Mill St	At	NB	1	4	200	800	89	89						
	500' North	NB	1	4	100	400	44	44						
River Road	400' South	NB	1	4	100	400	44	44						
	20' South	NB	1	4	5	20	2		2					
	100' North	NB	1	4	6	24	3		3					
	1000' North	NB	1	4	30	120	13			13				
Hartway	400' South	NB	1	4	75	300	33	33						
	200 North	NB	1	4	30	120	13			13				
Marsch	At	NB	1	6	16	96	11			11				
Keck	400' South	NB	1	4	20	80	9			9				
	400' North	NB	1	12	30	360	40							
	400' North	NB	1	4	120	480	53	53						
Ashland	At	NB	1	4	200	800	89	89						
	2000' North	NB	1	4	20	80	9			9				
	2200' North	NB	1	4	45	180	20				20			
Hazel	At	NB	1	4	30	120	13			13				

TOTAL: 1933 774 SY 19 SY 102 SY 20 SY 770 FT 38 EACH

ROUTE: IL 31 (Lovedale Lane to IL 56) in North Aurora

CROSS STREETS		DIRECTION (EB/WB) (NB/SB)	LANE NO. (1, 2, 3)	PAVEMENT PATCH WIDTH	PAVEMENT PATCH LENGTH	REPAIR AREA (SQ FT)	REPAIR AREA (SQ YD)	MILL & RESURF	CLASS D PATCH TYPE I	CLASS D PATCH TYPE II	CLASS D PATCH TYPE III	CLASS D PATCH TYPE IV	PAVT MARKING 4"	RAISED REFL PAVT MKS
FROM	TO													
Lovedale Lane	Rt. 56	EB	2	4	4	16	2	2						
		EB		3	15	45	5	5						
		EB		3	10	30	3	3						
		EB		3	10	30	3	3						
		EB		3	5	15	2	2						
		EB		3	20	60	7	7						
		EB		3	5	15	2	2						
		EB		3	20	60	7	7						
		WB	2	3	6	18	2	2						
		WB	2	4	4	16	2	2						
		WB	2	3	60	180	20	20						
		WB	1	3	3	9	1		1					
		WB	1	3	5	15	2	2						
		WB	2	3	4	12	1	1						
		WB	2	4	4	16	2	2						
		WB	2	4	30	120	13	13						
		WB	2	4	15	60	7	7						
		WB	1	8	50	400	44	44						
		WB	2	4	50	200	22	22						
		WB	1	4	25	100	11	11						
		WB	2	3	5	15	2	2						
		WB	1	3	25	75	8	8						
		WB	1	3	5	15	2	2						
		WB	1	3	3	9	1		1					
		WB	1	3	3	9	1		1					
		WB	2	4	4	16	2	2						
		WB		3	75	225	25	25						
		WB	3	3	3	9	1		1					
		WB	3	5	3	15	2	2						
		WB	3	5	3	15	2	2						
		WB	3	5	3	15	2	2						
		WB	3	5	3	15	2	2						
		WB	3	5	3	15	2	2						
		WB	3	5	3	15	2	2						
		WB	3	3	3	9	1	1						
		WB	3	3	5	15	2	2						
		WB	1	3	3	9	1	1						
		WB		3	15	45	5	5						
		WB	2	4	100	400	44	44						

TOTALS: 620 SY 577 SY 32 SY 14 SY 2100 FT 30 EACH

ROUTE: IL 47 (Main Street to Dean Street) in Huntley

CROSS STREETS		DIRECTION	LANE	PAVEMENT	PAVEMENT	REPAIR	REPAIR	MILL	CLASS D	CLASS D	CLASS D	CLASS D	PAVT	RAISED
FROM	TO	(EB/WB)	NO.	PATCH	PATCH	AREA	AREA	&	PATCH	PATCH	PATCH	PATCH	MARKING	REFL PAVT
		(NB/SB)	(1, 2, 3)	WIDTH	LENGTH	(SQ FT)	(SQ YD)	RESURF	TYPE I	TYPE II	TYPE III	TYPE IV	4"	MARKERS
Main St.	400' S of Dean St.	SB	1	4	4	16	2		2					
Main St.	400' S of Dean St.	SB	1	3	3	9	1		1					
Main St.	400' S of Dean St.	SB		1.5	20	30	3	3						
Main St.	400' S of Dean St.	SB	1	3	3	9	1		1					
Main St.	400' S of Dean St.	SB	1	3	3	9	1		1					
Main St.	400' S of Dean St.	SB		1.5	275	412.5	46	46						
Main St.	400' S of Dean St.	SB		1.5	7	10.5	1	1	1					
Main St.	400' S of Dean St.	SB	1	4	12	48	5			5				
Main St.	400' S of Dean St.	SB		1.5	300	450	50	50						
Main St.	400' S of Dean St.	SB	1	3	3	9	1		1					
Main St.	400' S of Dean St.	SB	1	10	3	30	3		3					
Main St.	400' S of Dean St.	SB	1	3	3	9	1		1					
Main St.	400' S of Dean St.	SB	1	3	3	9	1		1					
Main St.	400' S of Dean St.	SB		1.5	100	150	17	17						
Main St.	400' S of Dean St.	SB	1	3	3	9	1		1					
Main St.	400' S of Dean St.	SB	1	3	3	9	1		1					
Main St.	400' S of Dean St.	SB	1	4	10	40	4		4					
Main St.	400' S of Dean St.	SB	1	4	4	16	2		2					
Main St.	400' S of Dean St.	SB		1.5	50	75	8	8						
Main St.	400' S of Dean St.	SB		1.5	50	75	8	8						
Main St.	400' S of Dean St.	SB	1	6	5	30	3		3					
Main St.	400' S of Dean St.	SB	1	4	5	20	2		2					
Main St.	400' S of Dean St.	SB	1	3	3	9	1		1					
Main St.	400' S of Dean St.	SB	1	3	6	18	2		2					
Main St.	400' S of Dean St.	SB	1	10	4	40	4		4					
Main St.	400' S of Dean St.	SB	1	4	5	20	2		2					
Main St.	400' S of Dean St.	SB	1	4	4	16	2		2					
Main St.	400' S of Dean St.	SB		1.5	500	750	83	83						
Main St.	400' S of Dean St.	SB	1	10	4	40	4		4					
Main St.	400' S of Dean St.	SB	1	7	5	35	4		4					
Main St.	400' S of Dean St.	SB	1	4	4	16	2		2					
Main St.	400' S of Dean St.	SB	1	3	3	9	1		1					
Main St.	400' S of Dean St.	SB	1	3	3	9	1		1					
Main St.	400' S of Dean St.	SB	1	3	5	15	2		2					
Main St.	400' S of Dean St.	SB	1	12	4	48	5			5				
Main St.	400' S of Dean St.	SB	1	4	4	16	2		2					
Main St.	400' S of Dean St.	SB	1	3	3	9	1		1					
Main St.	400' S of Dean St.	SB	1	12	4	48	5			5				
Main St.	400' S of Dean St.	SB	1	1.5	220	330	37	37						
Main St.	400' S of Dean St.	SB	1	12	4	48	5			5				
Main St.	400' S of Dean St.	SB	1	8	6	48	5			5				
Main St.	400' S of Dean St.	SB	1	3	3	9	1		1					
Main St.	400' S of Dean St.	SB	1	3	3	9	1		1					
Main St.	400' S of Dean St.	SB		1.5	12	18	2	2						
Main St.	400' S of Dean St.	SB	1	3	3	9	1		1					
Main St.	400' S of Dean St.	SB		1.5	50	75	8	8						
Main St.	400' S of Dean St.	SB	1	4	4	16	2		2					
Main St.	400' S of Dean St.	SB	1	5	3	15	2		2					
Main St.	400' S of Dean St.	SB	1	3	4	12	1		1					
Main St.	400' S of Dean St.	SB	1	4	4	16	2		2					
Main St.	400' S of Dean St.	SB	1	3	3	9	1		1					
Main St.	400' S of Dean St.	SB	1	3	3	9	1		1					
Main St.	400' S of Dean St.	SB	1	12	3	36	4		4					
Main St.	400' S of Dean St.	SB	1	4	4	16	2		2					
Main St.	400' S of Dean St.	SB	1	3	3	9	1		1					
Main St.	400' S of Dean St.	SB	1	3	400	1200	133	133						
Main St.	400' S of Dean St.	SB	1	3	3	9	1		1					
Main St.	400' S of Dean St.	SB	1	4	4	16	2		2					
Main St.	400' S of Dean St.	SB	1	4	4	16	2		2					
Main St.	400' S of Dean St.	SB	1	12	4	48	5			5				
Main St.	400' S of Dean St.	SB	1	3	3	9	1		1					
Main St.	400' S of Dean St.	SB		1.5	80	120	13	13						
Main St.	400' S of Dean St.	SB	1	3	3	9	1		1					
Main St.	400' S of Dean St.	SB	1	12	3	36	4		4					
Main St.	400' S of Dean St.	SB	1	3	10	30	3		3					
Main St.	400' S of Dean St.	SB	1	12	3	36	4		4					
Main St.	400' S of Dean St.	SB	1	4	4	16	2		2					
Main St.	400' S of Dean St.	NB		1.5	80	120	13	13						

CONTINUED ON THE NEXT SHEET

FILE NAME = c:\proj\jct\136488\design_ae.dgn	USER NAME = wilgrandp	DESIGNED -	REVISED -	STATE OF ILLINOIS DEPARTMENT OF TRANSPORTATION	PATCHING SCHEDULE IL 47				F.A.P. RTE.	SECTION	COUNTY	TOTAL SHEETS	SHEET NO.
		DRAWN -	REVISED -		SCALE:	SHEET NO.	OF	SHEETS	STA.	TO STA.	KANE	34	13
		CHECKED -	REVISED -								FED. ROAD DIST. NO. 1	ILLINOIS FED. AID PROJECT	
		DATE -	REVISED -								CONTRACT NO. 60E39		

ROUTE: IL 47 (Main Street to Dean Street) in Huntley

CROSS STREETS		DIRECTION (EB/WB) (NB/SB)	LANE NO. (1, 2, 3)	PAVEMENT PATCH WIDTH	PAVEMENT PATCH LENGTH	REPAIR AREA (SQ FT)	REPAIR AREA (SQ YD)	MILL & RESURF	CLASS D PATCH TYPE I	CLASS D PATCH TYPE II	CLASS D PATCH TYPE III	CLASS D PATCH TYPE IV	PAVT MARKING 4"	RAISED REFL PAVT MARKERS
FROM	TO													
Main St.	400' S of Dean St.	NB		1.5	50	75	8	8						
Main St.	400' S of Dean St.	NB		1.5	50	75	8	8						
Main St.	400' S of Dean St.	NB	1	12	4	48	5			5				
Main St.	400' S of Dean St.	NB		1.5	100	150	17	17						
Main St.	400' S of Dean St.	NB	1	4	4	16	2		2					
Main St.	400' S of Dean St.	NB	1	10	4	40	4		4					
Main St.	400' S of Dean St.	NB	1	4	4	16	2		2					
Main St.	400' S of Dean St.	NB	1	3	3	9	1		1					
Main St.	400' S of Dean St.	NB	1	4	4	16	2		2					
Main St.	400' S of Dean St.	NB	1	4	3	12	1		1					
Main St.	400' S of Dean St.	NB	1	5	4	20	2		2					
Main St.	400' S of Dean St.	NB	1	3	3	9	1		1					
Main St.	400' S of Dean St.	NB	1	3	4	12	1		1					
Main St.	400' S of Dean St.	NB	1	12	4	48	5			5				
Main St.	400' S of Dean St.	NB	1	3	3	9	1		1					
Main St.	400' S of Dean St.	NB	1	4	4	16	2		2					
Main St.	400' S of Dean St.	NB	1	4	4	16	2		2					
Main St.	400' S of Dean St.	NB	1	6	3	18	2		2					
Main St.	400' S of Dean St.	NB	1	5	5	25	3		3					
Main St.	400' S of Dean St.	NB	1	4	30	120	13			13				
Main St.	400' S of Dean St.	NB	1	12	4	48	5		5					
Main St.	400' S of Dean St.	NB	1	12	3	36	4		4					
Main St.	400' S of Dean St.	NB	1	3	4	12	1		1					
Main St.	400' S of Dean St.	NB	1	3	4	12	1		1					
Main St.	400' S of Dean St.	NB	1	5	75	375	42	42						
Main St.	400' S of Dean St.	NB	1	12	4	48	5			5				
Main St.	400' S of Dean St.	NB	1	4	3	12	1		1					
Main St.	400' S of Dean St.	NB	1	12	5	60	7			7				
Main St.	400' S of Dean St.	NB	1	12	4	48	5			5				
Main St.	400' S of Dean St.	NB	1	3	3	9	1		1					
Main St.	400' S of Dean St.	NB	1	6	30	180	20	20						
Main St.	400' S of Dean St.	NB	1	3	3	9	1		1					
Main St.	400' S of Dean St.	NB	1	12	3	36	4		4					
Main St.	400' S of Dean St.	NB	1	5	10	50	6			6				
Main St.	400' S of Dean St.	NB	1	3	8	24	3		3					
Main St.	400' S of Dean St.	NB	1	3	3	9	1		1					
Main St.	400' S of Dean St.	NB	1	3	3	9	1		1					
Main St.	400' S of Dean St.	NB	1	3	4	12	1		1					
Main St.	400' S of Dean St.	NB	1	3	4	12	1		1					
Main St.	400' S of Dean St.	NB	1	4	4	16	2		2					
Main St.	400' S of Dean St.	NB	1	4	4	16	2		2					
Main St.	400' S of Dean St.	NB	1	12	3	36	4		4					
Main St.	400' S of Dean St.	NB	1	12	3	36	4		4					
Main St.	400' S of Dean St.	NB	1	3	10	30	3		3					
Main St.	400' S of Dean St.	NB	1	4	4	16	2		2					
Main St.	400' S of Dean St.	NB	1	5	20	100	11			11				
Main St.	400' S of Dean St.	NB	1	4	4	16	2		2					
Main St.	400' S of Dean St.	NB	1	5	20	100	11			11				
Main St.	400' S of Dean St.	NB	1	4	4	16	2		2					
Main St.	400' S of Dean St.	NB	1	3	3	9	1		1					
Main St.	400' S of Dean St.	NB	1	12	3	36	4		4					
Main St.	400' S of Dean St.	NB	1	4	3	12	1		1					
Main St.	400' S of Dean St.	NB	1	4	4	16	2		2					
Main St.	400' S of Dean St.	NB	1	4	4	16	2		2					
Main St.	400' S of Dean St.	NB	1	12	4	48	5			5				
Main St.	400' S of Dean St.	NB	1	4	4	16	2		2					
Main St.	400' S of Dean St.	NB	1	4	4	16	2		2					
Main St.	400' S of Dean St.	NB	1	3	3	9	1		1					
Main St.	400' S of Dean St.	NB	1	3	4	12	1		1					
Main St.	400' S of Dean St.	NB	1	10	4	40	4		4					
Main St.	400' S of Dean St.	NB	1	3	3	9	1		1					
Main St.	400' S of Dean St.	NB	1	5	30	150	17	17						

TOTALS: 826 SY 534 SY 185 SY 103 SY 3500 FT 35 EACH

FILE NAME = c:\proje\ts\dl35408\design.as.dgn	USER NAME = wlgreendp	DESIGNED -	REVISED -	STATE OF ILLINOIS DEPARTMENT OF TRANSPORTATION	PATCHING SCHEDULE IL 47				F.A.P. RTE.	SECTION	COUNTY	TOTAL SHEETS	SHEET NO.
PLOT SCALE = 1/32" = 1' / IN.	CHECKED -	REVISED -	REVISED -		SCALE:	SHEET NO.	OF	SHEETS	STA.	TO STA.	KANE	34	14
PLOT DATE = 3/14/2008	DATE -	REVISED -	REVISED -		CONTRACT NO. 60E39								
FED. ROAD DIST. NO. 1 ILLINOIS FED. AID PROJECT													

ROUTE: IL 47 (Rolling Oaks Road to Galena Blvd) in Sugar Grove

CROSS STREETS		DIRECTION (EB/WB) (NB/SB)	LANE NO. (1, 2, 3)	PAVEMENT PATCH WIDTH	PAVEMENT PATCH LENGTH	REPAIR AREA (SQ FT)	REPAIR AREA (SQ YD)	MILL & RESURF	CLASS D PATCH TYPE I	CLASS D PATCH TYPE II	CLASS D PATCH TYPE III	CLASS D PATCH TYPE IV	PAVT MARKING 4"	RAISED REFL PAVT MARKERS
FROM	TO													
0.2 miles S. of Rolling Oaks Rd	Galena Blvd.	NB	1	5	105	525	58	58						
0.2 miles S. of Rolling Oaks Rd	Galena Blvd.	NB	1	5	65	325	36	65						
0.2 miles S. of Rolling Oaks Rd	Galena Blvd.	NB	1	5	20	100	11			11				
0.2 miles S. of Rolling Oaks Rd	Galena Blvd.	NB	1	3	3	9	1		1					
0.2 miles S. of Rolling Oaks Rd	Galena Blvd.	NB	1	3	12	36	4		4					
0.2 miles S. of Rolling Oaks Rd	Galena Blvd.	NB	1	3	8	24	3		3					
0.2 miles S. of Rolling Oaks Rd	Galena Blvd.	NB	1	4	10	40	4		4					
0.2 miles S. of Rolling Oaks Rd	Galena Blvd.	NB	1	3	5	15	2		2					
0.2 miles S. of Rolling Oaks Rd	Galena Blvd.	NB	1	1.5	170	255	28	28						
0.2 miles S. of Rolling Oaks Rd	Galena Blvd.	NB	1	5	15	75	8			8				
0.2 miles S. of Rolling Oaks Rd	Galena Blvd.	NB	1	4	4	16	2		2					
0.2 miles S. of Rolling Oaks Rd	Galena Blvd.	NB	1	4	15	60	7			7				
0.2 miles S. of Rolling Oaks Rd	Galena Blvd.	NB	1	4	4	16	2		2					
0.2 miles S. of Rolling Oaks Rd	Galena Blvd.	NB	1	3	45	135	15	15						
0.2 miles S. of Rolling Oaks Rd	Galena Blvd.	NB	1	4	8	32	4		4					
0.2 miles S. of Rolling Oaks Rd	Galena Blvd.	NB	1	4	8	32	4		4					
0.2 miles S. of Rolling Oaks Rd	Galena Blvd.	NB	1	12	4	48	5			5				
0.2 miles S. of Rolling Oaks Rd	Galena Blvd.	NB	1	3	3	9	1		1					
0.2 miles S. of Rolling Oaks Rd	Galena Blvd.	NB	1	5	4	20	2		2					
0.2 miles S. of Rolling Oaks Rd	Galena Blvd.	NB	1	3	3	9	1		1					
0.2 miles S. of Rolling Oaks Rd	Galena Blvd.	NB	1	12	3	36	4		4					
0.2 miles S. of Rolling Oaks Rd	Galena Blvd.	NB	1	3	5	15	2		2					
0.2 miles S. of Rolling Oaks Rd	Galena Blvd.	NB	1	12	35	420	47	47						
0.2 miles S. of Rolling Oaks Rd	Galena Blvd.	NB	1	7	5	35	4		4					
0.2 miles S. of Rolling Oaks Rd	Galena Blvd.	NB	1	12	60	720	80	80						
0.2 miles S. of Rolling Oaks Rd	Galena Blvd.	NB	1	3	3	9	1		1					
0.2 miles S. of Rolling Oaks Rd	Galena Blvd.	NB	1	5	20	100	11			11				
0.2 miles S. of Rolling Oaks Rd	Galena Blvd.	NB	1	12	20	240	27					27		
0.2 miles S. of Rolling Oaks Rd	Galena Blvd.	NB	1	3	125	375	42	42						
0.2 miles S. of Rolling Oaks Rd	Galena Blvd.	NB	1	6	10	60	7			7				
0.2 miles S. of Rolling Oaks Rd	Galena Blvd.	NB	1	6	25	150	17					17		
0.2 miles S. of Rolling Oaks Rd	Galena Blvd.	NB	1	3	30	90	10	10						
0.2 miles S. of Rolling Oaks Rd	Galena Blvd.	NB	1	12	30	360	40					40		
0.2 miles S. of Rolling Oaks Rd	Galena Blvd.	NB	1	3	50	150	17	17						
0.2 miles S. of Rolling Oaks Rd	Galena Blvd.	NB	1	3	12	36	4		4					
0.2 miles S. of Rolling Oaks Rd	Galena Blvd.	NB	1	3	62	186	21	21						
0.2 miles S. of Rolling Oaks Rd	Galena Blvd.	NB	1	12	90	1080	120	120						
0.2 miles S. of Rolling Oaks Rd	Galena Blvd.	NB	1	3	40	120	13	13						
0.2 miles S. of Rolling Oaks Rd	Galena Blvd.	NB	1	10	25	250	28					28		
0.2 miles S. of Rolling Oaks Rd	Galena Blvd.	NB	1	7	25	175	19			19				
0.2 miles S. of Rolling Oaks Rd	Galena Blvd.	NB	1	12	60	720	80	80						
0.2 miles S. of Rolling Oaks Rd	Galena Blvd.	NB	1	6	40	240	27					27		
0.2 miles S. of Rolling Oaks Rd	Galena Blvd.	NB	1	4	4	16	2		2					
0.2 miles S. of Rolling Oaks Rd	Galena Blvd.	NB	1	4	4	16	2		2					
0.2 miles S. of Rolling Oaks Rd	Galena Blvd.	NB	1	4	20	80	9			9				
0.2 miles S. of Rolling Oaks Rd	Galena Blvd.	NB	1	5	30	150	17					17		
0.2 miles S. of Rolling Oaks Rd	Galena Blvd.	NB	1	6	28	168	17					17		
0.2 miles S. of Rolling Oaks Rd	Galena Blvd.	NB	1	4	6	24	3		3					
0.2 miles S. of Rolling Oaks Rd	Galena Blvd.	NB	1	3	12	36	4		4					
0.2 miles S. of Rolling Oaks Rd	Galena Blvd.	NB	1	3	12	36	4		4					
0.2 miles S. of Rolling Oaks Rd	Galena Blvd.	NB	1	3	3	9	1		1					
0.2 miles S. of Rolling Oaks Rd	Galena Blvd.	NB	1	12	65	780	87	87						
0.2 miles S. of Rolling Oaks Rd	Galena Blvd.	NB	1	3	930	2790	310	310						
0.2 miles S. of Rolling Oaks Rd	Galena Blvd.	NB	1	6	4	24	3							
0.2 miles S. of Rolling Oaks Rd	Galena Blvd.	NB	1	3	30	90	10	10						
0.2 miles S. of Rolling Oaks Rd	Galena Blvd.	NB	1	4	20	80	9			9				
0.2 miles S. of Rolling Oaks Rd	Galena Blvd.	NB	1	3	25	75	8	8						
0.2 miles S. of Rolling Oaks Rd	Galena Blvd.	NB	1	12	35	420	47	47						
0.2 miles S. of Rolling Oaks Rd	Galena Blvd.	NB	1	4	4	16	2		2					
0.2 miles S. of Rolling Oaks Rd	Galena Blvd.	NB	1	12	20	240	27					27		
0.2 miles S. of Rolling Oaks Rd	Galena Blvd.	NB	1	3	3	9	1		1					
0.2 miles S. of Rolling Oaks Rd	Galena Blvd.	NB	1	8	18	144	16					16		

CONTINUED ON THE NEXT SHEET

FILE NAME =	USER NAME = wlgreendp	DESIGNED -	REVISED -	STATE OF ILLINOIS DEPARTMENT OF TRANSPORTATION	PATCHING SCHEDULE IL 47	F.A.P. RTE.	SECTION	COUNTY	TOTAL SHEETS	SHEET NO.
cs\projects\036408\design\ee.dgn	DRAWN -	REVISED -	VAR.			2008-013 PP	KANE	34	15	
PLOT SCALE = 103.7051' / IN.	CHECKED -	REVISED -	SCALE:			SHEET NO. OF SHEETS	STA. TO STA.	FED. ROAD DIST. NO. 1 ILLINOIS FED. AID PROJECT		
PLOT DATE = 3/14/2008	DATE -	REVISED -						CONTRACT NO. 60E39		

ROUTE: IL 47 (Rolling Oaks Road to Galena Blvd) in Sugar Grove

CROSS STREETS		DIRECTION (EB/WB) (NB/SB)	LANE NO. (1, 2, 3)	PAVEMENT PATCH WIDTH	PAVEMENT PATCH LENGTH	REPAIR AREA (SQ FT)	REPAIR AREA (SQ YD)	MILL & RESURF	CLASS D PATCH TYPE I	CLASS D PATCH TYPE II	CLASS D PATCH TYPE III	CLASS D PATCH TYPE IV	PAVT MARKING 4"	RAISED REFL PAVT MARKERS
FROM	TO													
0.2 miles S. of Rolling Oaks Rd	Galena Blvd.	NB		3	25	75	8	8						
0.2 miles S. of Rolling Oaks Rd	Galena Blvd.	NB	1	6	12	72	8			8				
0.2 miles S. of Rolling Oaks Rd	Galena Blvd.	NB	1	6	15	90	10			8				
0.2 miles S. of Rolling Oaks Rd	Galena Blvd.	NB		3	100	300	33	33						
0.2 miles S. of Rolling Oaks Rd	Galena Blvd.	NB	1	6	100	600	67	67						
0.2 miles S. of Rolling Oaks Rd	Galena Blvd.	NB	1	12	5	60	7			7				
0.2 miles S. of Rolling Oaks Rd	Galena Blvd.	NB	1	3	6	18	2		2					
0.2 miles S. of Rolling Oaks Rd	Galena Blvd.	NB	1	8	20	160	18				18			
0.2 miles S. of Rolling Oaks Rd	Galena Blvd.	NB	1	12	30	360	40	40						
0.2 miles S. of Rolling Oaks Rd	Galena Blvd.	NB	1	12	4	48	5			5				
0.2 miles S. of Rolling Oaks Rd	Galena Blvd.	NB	1	3	20	60	7			7				
0.2 miles S. of Rolling Oaks Rd	Galena Blvd.	NB	1	12	40	480	53	53						
0.2 miles S. of Rolling Oaks Rd	Galena Blvd.	NB	2	12	40	480	53	53						
0.2 miles S. of Rolling Oaks Rd	Galena Blvd.	NB	2	4	4	16	2		2					
0.2 miles S. of Rolling Oaks Rd	Galena Blvd.	NB	1	12	12	144	16				16			
0.2 miles S. of Rolling Oaks Rd	Galena Blvd.	NB	3	12	20	240	27					27		
0.2 miles S. of Rolling Oaks Rd	Galena Blvd.	NB	2	12	10	120	13			13				
0.2 miles S. of Rolling Oaks Rd	Galena Blvd.	NB	2	6	15	90	10			10				
0.2 miles S. of Rolling Oaks Rd	Galena Blvd.	NB	2	12	10	120	13			13				
0.2 miles S. of Rolling Oaks Rd	Galena Blvd.	NB	2	6	15	90	10			10				
0.2 miles S. of Rolling Oaks Rd	Galena Blvd.	NB	2	3	3	9	1		1					
0.2 miles S. of Rolling Oaks Rd	Galena Blvd.	NB	2	4	3	12	1		1					
0.2 miles S. of Rolling Oaks Rd	Galena Blvd.	NB	2	12	6	72	8		1	8				
0.2 miles S. of Rolling Oaks Rd	Galena Blvd.	NB	2	12	6	72	8			8				
0.2 miles S. of Rolling Oaks Rd	Galena Blvd.	NB	2	4	4	16	2		2					
0.2 miles S. of Rolling Oaks Rd	Galena Blvd.	NB		3	18	54	6	6						
0.2 miles S. of Rolling Oaks Rd	Galena Blvd.	NB	2	3	5	15	2		2					
0.2 miles S. of Rolling Oaks Rd	Galena Blvd.	NB	2	3	4	12	1		1					
0.2 miles S. of Rolling Oaks Rd	Galena Blvd.	SB	3	6	10	60	7			7				
0.2 miles S. of Rolling Oaks Rd	Galena Blvd.	SB	3	5	3	15	2		2					
0.2 miles S. of Rolling Oaks Rd	Galena Blvd.	SB	3	5	3	15	2		2					
0.2 miles S. of Rolling Oaks Rd	Galena Blvd.	SB		3	10	30	3	3						
0.2 miles S. of Rolling Oaks Rd	Galena Blvd.	SB	3	8	15	120	13			13				
0.2 miles S. of Rolling Oaks Rd	Galena Blvd.	SB	3	12	4	48	5			5				
0.2 miles S. of Rolling Oaks Rd	Galena Blvd.	SB		3	25	75	8	8						
0.2 miles S. of Rolling Oaks Rd	Galena Blvd.	SB		3	5	15	2	2						
0.2 miles S. of Rolling Oaks Rd	Galena Blvd.	SB	2	3	7	21	2		2					
0.2 miles S. of Rolling Oaks Rd	Galena Blvd.	SB	2	3	3	9	1		1					
0.2 miles S. of Rolling Oaks Rd	Galena Blvd.	SB	2	3	4	12	1		1					
0.2 miles S. of Rolling Oaks Rd	Galena Blvd.	SB	3	8	10	80	9			9				
0.2 miles S. of Rolling Oaks Rd	Galena Blvd.	SB	2	12	5	60	7			7				
0.2 miles S. of Rolling Oaks Rd	Galena Blvd.	SB	1	3	5	15	2		2					
0.2 miles S. of Rolling Oaks Rd	Galena Blvd.	SB	1	3	5	15	2		2					
0.2 miles S. of Rolling Oaks Rd	Galena Blvd.	SB	2	12	25	300	33					33		
0.2 miles S. of Rolling Oaks Rd	Galena Blvd.	SB	2	3	4	12	1		1					
0.2 miles S. of Rolling Oaks Rd	Galena Blvd.	SB	2	3	3	9	1		1					
0.2 miles S. of Rolling Oaks Rd	Galena Blvd.	SB	2	3	3	9	1		1					
0.2 miles S. of Rolling Oaks Rd	Galena Blvd.	SB	2	4	6	24	3		3					
0.2 miles S. of Rolling Oaks Rd	Galena Blvd.	SB	1	3	15	45	5			5				
0.2 miles S. of Rolling Oaks Rd	Galena Blvd.	SB	2	3	10	30	3		3					
0.2 miles S. of Rolling Oaks Rd	Galena Blvd.	SB		3	150	450	50	50						
0.2 miles S. of Rolling Oaks Rd	Galena Blvd.	SB	1	3	5	15	2		2					
0.2 miles S. of Rolling Oaks Rd	Galena Blvd.	SB		3	25	75	8			8				
0.2 miles S. of Rolling Oaks Rd	Galena Blvd.	SB	2	5	25	125	14	14						
0.2 miles S. of Rolling Oaks Rd	Galena Blvd.	SB	1	3	5	15	2		2					
0.2 miles S. of Rolling Oaks Rd	Galena Blvd.	SB	1	4	12	48	5			5				
0.2 miles S. of Rolling Oaks Rd	Galena Blvd.	SB	1	6	15	90	10			10				
0.2 miles S. of Rolling Oaks Rd	Galena Blvd.	SB	2	4	4	16	2		2					
0.2 miles S. of Rolling Oaks Rd	Galena Blvd.	SB	1	12	25	300	33	33						
0.2 miles S. of Rolling Oaks Rd	Galena Blvd.	SB	2	3	4	12	1		1					
0.2 miles S. of Rolling Oaks Rd	Galena Blvd.	SB	2	12	20	240	27					27		
0.2 miles S. of Rolling Oaks Rd	Galena Blvd.	SB		3	30	90	10	10						

CONTINUED ON THE NEXT SHEET

FILE NAME : o:\projects\136488\design\ss.dgn	USER NAME : wlgreendp	DESIGNED -	REVISED -	STATE OF ILLINOIS DEPARTMENT OF TRANSPORTATION	PATCHING SCHEDULE IL 47				F.A.P. RTE. VAR.	SECTION 2008-013 PP	COUNTY KANE	TOTAL SHEETS 34	SHEET NO. 16	
	PLOT SCALE = 103.7851' / IN.	CHECKED -	REVISED -		SCALE:	SHEET NO.	OF	SHEETS	STA.	TO STA.	CONTRACT NO. 60E39			
	PLOT DATE = 3/14/2008	DATE -	REVISED -		FED. ROAD DIST. NO. 1 ILLINOIS FED. AID PROJECT									

ROUTE: IL 47 (Rolling Oaks Road to Galena Blvd) in Sugar Grove

CROSS STREETS		DIRECTION (EB/WB) (NB/SB)	LANE NO. (1, 2, 3)	PAVEMENT PATCH WIDTH	PAVEMENT PATCH LENGTH	REPAIR AREA (SQ FT)	REPAIR AREA (SQ YD)	MILL & RESURF	CLASS D PATCH TYPE I	CLASS D PATCH TYPE II	CLASS D PATCH TYPE III	CLASS D PATCH TYPE IV	PAVT MARKING 4"	RAISED REFL PAVT MARKERS
FROM	TO													
0.2 miles S. of Rolling Oaks Rd	Galena Blvd.	SB	2	3	12	36	4		4					
0.2 miles S. of Rolling Oaks Rd	Galena Blvd.	SB	1	3	3	9	1		1					
0.2 miles S. of Rolling Oaks Rd	Galena Blvd.	SB	1	12	20	240	27					27		
0.2 miles S. of Rolling Oaks Rd	Galena Blvd.	SB	1	7	40	280	31					31		
0.2 miles S. of Rolling Oaks Rd	Galena Blvd.	SB	1	3	65	195	22	22						
0.2 miles S. of Rolling Oaks Rd	Galena Blvd.	SB	1	3	4	12	1		1					
0.2 miles S. of Rolling Oaks Rd	Galena Blvd.	SB	1	3	8	24	3		3					
0.2 miles S. of Rolling Oaks Rd	Galena Blvd.	SB	1	6	80	480	53	53						
0.2 miles S. of Rolling Oaks Rd	Galena Blvd.	SB	1	3	3	9	1		1					
0.2 miles S. of Rolling Oaks Rd	Galena Blvd.	SB	1	3	10	30	3		3					
0.2 miles S. of Rolling Oaks Rd	Galena Blvd.	SB	1	5	12	60	7			7				
0.2 miles S. of Rolling Oaks Rd	Galena Blvd.	SB	1	4	10	40	4		4					
0.2 miles S. of Rolling Oaks Rd	Galena Blvd.	SB	1	4	10	40	4		4					
0.2 miles S. of Rolling Oaks Rd	Galena Blvd.	SB	1	3	15	45	5			5				
0.2 miles S. of Rolling Oaks Rd	Galena Blvd.	SB	1	3	10	30	3		3					
0.2 miles S. of Rolling Oaks Rd	Galena Blvd.	SB	1	5	3	15	2		2					
0.2 miles S. of Rolling Oaks Rd	Galena Blvd.	SB	1	12	20	240	27					27		
0.2 miles S. of Rolling Oaks Rd	Galena Blvd.	SB	1	12	15	180	20					20		
0.2 miles S. of Rolling Oaks Rd	Galena Blvd.	SB	1	6	6	36	4		4					
0.2 miles S. of Rolling Oaks Rd	Galena Blvd.	SB	1	4	6	24	3		3					
0.2 miles S. of Rolling Oaks Rd	Galena Blvd.	SB	1	3	15	45	5			5				
0.2 miles S. of Rolling Oaks Rd	Galena Blvd.	SB	1	3	20	60	7			7				
0.2 miles S. of Rolling Oaks Rd	Galena Blvd.	SB	1	3	20	60	7			7				
0.2 miles S. of Rolling Oaks Rd	Galena Blvd.	SB	1	6	200	1200	133	133						
0.2 miles S. of Rolling Oaks Rd	Galena Blvd.	SB	1	3	7	21	2		2					
0.2 miles S. of Rolling Oaks Rd	Galena Blvd.	SB	1	3	3	9	1		1					
0.2 miles S. of Rolling Oaks Rd	Galena Blvd.	SB	1	3	3	9	1		1					
0.2 miles S. of Rolling Oaks Rd	Galena Blvd.	SB	1	3	3	9	1		1					
0.2 miles S. of Rolling Oaks Rd	Galena Blvd.	SB	1	3	3	9	1		1					
0.2 miles S. of Rolling Oaks Rd	Galena Blvd.	SB	1	6	30	180	20					20		
0.2 miles S. of Rolling Oaks Rd	Galena Blvd.	SB	1	3	100	300	33	33						
0.2 miles S. of Rolling Oaks Rd	Galena Blvd.	SB	1	3	150	450	50	50						
0.2 miles S. of Rolling Oaks Rd	Galena Blvd.	SB	1	3	40	120	13	13						
0.2 miles S. of Rolling Oaks Rd	Galena Blvd.	SB	1	3	30	90	10	10						
0.2 miles S. of Rolling Oaks Rd	Galena Blvd.	SB	1	5	20	100	11			11				
0.2 miles S. of Rolling Oaks Rd	Galena Blvd.	SB	1	3	3	9	1		1					
0.2 miles S. of Rolling Oaks Rd	Galena Blvd.	SB	1	3	3	9	1		1					
0.2 miles S. of Rolling Oaks Rd	Galena Blvd.	SB	1	3	3	9	1		1					
0.2 miles S. of Rolling Oaks Rd	Galena Blvd.	SB	1	3	10	30	3	3						
0.2 miles S. of Rolling Oaks Rd	Galena Blvd.	SB	1	3	50	150	17	17						
0.2 miles S. of Rolling Oaks Rd	Galena Blvd.	SB	1	3	10	30	3		3					
0.2 miles S. of Rolling Oaks Rd	Galena Blvd.	SB	1	4	4	16	2		2					
0.2 miles S. of Rolling Oaks Rd	Galena Blvd.	SB	1	3	50	150	17	17						
0.2 miles S. of Rolling Oaks Rd	Galena Blvd.	SB	1	3	10	30	3		3					
0.2 miles S. of Rolling Oaks Rd	Galena Blvd.	SB	1	4	3	12	1		1					
0.2 miles S. of Rolling Oaks Rd	Galena Blvd.	SB	1	3	45	135	15	15						
0.2 miles S. of Rolling Oaks Rd	Galena Blvd.	SB	1	4	5	20	2		2					
0.2 miles S. of Rolling Oaks Rd	Galena Blvd.	SB	1	3	3	9	1		1					
0.2 miles S. of Rolling Oaks Rd	Galena Blvd.	SB	1	3	8	24	3		3					
0.2 miles S. of Rolling Oaks Rd	Galena Blvd.	SB	1	3	4	12	1		1					
0.2 miles S. of Rolling Oaks Rd	Galena Blvd.	SB	1	3	20	60	7			7				
0.2 miles S. of Rolling Oaks Rd	Galena Blvd.	SB	1	3	6	18	2		2					
0.2 miles S. of Rolling Oaks Rd	Galena Blvd.	SB	1	3	50	150	17	17						
0.2 miles S. of Rolling Oaks Rd	Galena Blvd.	SB	1	12	50	600	67	67						
0.2 miles S. of Rolling Oaks Rd	Galena Blvd.	SB	1	3	200	600	67	67						

TOTALS: 2853 SY 1955 SY 164 SY 282 SY 120 SY 361 SY 5400 FT 95 EACH

ROUTE: IL 47 at IL 56 Ramps (Sugar Grove)

CROSS STREETS		DIRECTION (EB/WB) (NB/SB)	LANE NO. (1, 2, 3)	PAVEMENT PATCH WIDTH	PAVEMENT PATCH LENGTH	REPAIR AREA (SQ FT)	REPAIR AREA (SQ YD)	MILL & RESURF	CLASS D PATCH TYPE I	CLASS D PATCH TYPE II	CLASS D PATCH TYPE III	CLASS D PATCH TYPE IV	PAVT MARKING 4"	RAISED REFL PAVT MARKERS
FROM	TO													
NB IL 47 ENTR RAMP	TO EB IL 56		1	6	15	90	10							
NB IL 47 ENTR RAMP	TO EB IL 56		1	8	5	40	4		4					
NB IL 47 ENTR RAMP	TO EB IL 56		1	3	3	9	1		1					
NB IL 47 ENTR RAMP	TO EB IL 56		1	8	5	40	4		4					
NB IL 47 ENTR RAMP	TO EB IL 56		1	16	4	64	7			7				
NB IL 47 ENTR RAMP	TO EB IL 56		1	3	500	1500	167	167						
NB IL 47 ENTR RAMP	TO EB IL 56		1	8	3	24	3		3					
NB IL 47 ENTR RAMP	TO EB IL 56		1	8	3	24	3		3					
NB IL 47 ENTR RAMP	TO EB IL 56		1	16	5	80	9			9				
NB IL 47 ENTR RAMP	TO EB IL 56		1	4	4	16	2		2					
NB IL 47 ENTR RAMP	TO EB IL 56		1	6	20	120	13			13				
NB IL 47 ENTR RAMP	TO EB IL 56		1	12	4	48	5			5				
NB IL 47 ENTR RAMP	TO EB IL 56		1	12	4	48	5			5				
NB IL 47 ENTR RAMP	TO EB IL 56		1	12	6	72	8			8				
NB IL 47 ENTR RAMP	TO EB IL 56		1	16	4	64	7			7				
NB IL 47 ENTR RAMP	TO EB IL 56		1	16	4	64	7			7				
NB IL 47 ENTR RAMP	TO EB IL 56		1	16	4	64	7			7				
NB IL 47 ENTR RAMP	TO EB IL 56		1	16	4	64	7			7				
NB IL 47 ENTR RAMP	TO EB IL 56		1	16	10	160	18			18				
NB IL 47 ENTR RAMP	TO EB IL 56		1	16	5	80	9			9				
NB IL 47 ENTR RAMP	TO EB IL 56		1	3	10	30	3		3					
NB IL 47 ENTR RAMP	TO EB IL 56		1	3	5	15	2		2					
NB IL 47 ENTR RAMP	TO EB IL 56		1	5	3	15	2		2					
NB IL 47 ENTR RAMP	TO EB IL 56		1	3	3	9	1		1					
NB IL 47 ENTR RAMP	TO EB IL 56		1	3	3	9	1		1					
NB IL 47 ENTR RAMP	TO EB IL 56		1	3	8	24	3		3					
NB IL 47 ENTR RAMP	TO EB IL 56		1	5	5	25	3		3					
NB IL 47 ENTR RAMP	TO EB IL 56		1	3	15	45	5			5				
NB IL 47 ENTR RAMP	TO EB IL 56		1	8	5	40	4		4					
WB IL 56 EXIT RAMP	NB & SB IL 47		1	6	20	120	13			13				
WB IL 56 EXIT RAMP	NB & SB IL 47		1	8	10	80	9			9				
WB IL 56 EXIT RAMP	NB & SB IL 47		1	16	25	400	44	44						
WB IL 56 EXIT RAMP	NB & SB IL 47		1	4	4	16	2		2					
WB IL 56 EXIT RAMP	NB & SB IL 47		1	6	15	90	10			10				
WB IL 56 EXIT RAMP	NB & SB IL 47		1	16	70	1120	124	124						
WB IL 56 EXIT RAMP	NB & SB IL 47		1	8	6	48	5			5				
WB IL 56 EXIT RAMP	NB & SB IL 47		1	5	8	40	4		4					
WB IL 56 EXIT RAMP	NB & SB IL 47		1	5	6	30	3		3					
WB IL 56 EXIT RAMP	NB & SB IL 47		1	3	5	15	2		2					
WB IL 56 EXIT RAMP	NB & SB IL 47		1	8	15	120	13			13				
WB IL 56 EXIT RAMP	NB & SB IL 47		1	6	3	18	2		2					
WB IL 56 EXIT RAMP	NB & SB IL 47		1	16	5	80	9			9				
WB IL 56 EXIT RAMP	NB & SB IL 47		1	16	5	80	9			9				

TOTALS: 578 SY 335 SY 49 SY 194 SY 750 FT 0 EACH

ROUTE: IL 64 (8TH Ave to IL 59) in St. Charles & West Chicago

CROSS STREETS		DIRECTION (EB/WB) (NB/SB)	LANE NO. (1, 2, 3)	PAVEMENT PATCH WIDTH	PAVEMENT PATCH LENGTH	REPAIR AREA (SQ FT)	REPAIR AREA (SQ YD)	MILL & RESURF	CLASS D PATCH TYPE I	CLASS D PATCH TYPE II	CLASS D PATCH TYPE III	CLASS D PATCH TYPE IV	PAVT MARKING 4"	RAISED REFL PAVT MARKERS
FROM	TO													
Kautz Rd.	0.4 miles W of Powis Rd.	EB	2	3	50	150	17	17						
0.3 miles E of Powis rd.	Rt. 59	EB	2	5	5	25	3		3					
0.3 miles E of Powis rd.	Rt. 59	EB	2	3	150	450	50	50						
0.3 miles E of Powis rd.	Rt. 59	EB	2	6	15	90	10			10				
0.3 miles E of Powis rd.	Rt. 59	EB	2	3	250	750	83	83			83			
0.3 miles E of Powis rd.	Rt. 59	EB	2	3	100	300	33	33			33			
0.3 miles E of Powis rd.	Rt. 59	EB	1	5	5	25	3		3					
0.3 miles E of Powis rd.	Rt. 59	EB	2	3	10	30	3		3					
0.3 miles E of Powis rd.	Rt. 59	EB	2	4	4	16	2		2					
0.3 miles E of Powis rd.	Rt. 59	EB	2	4	6	24	3		3					
0.3 miles E of Powis rd.	Rt. 59	EB	2	1.5	80	120	13	13						
0.3 miles E of Powis rd.	Rt. 59	EB	2	3	100	300	33	33						
0.3 miles E of Powis rd.	Rt. 59	EB	2	3	200	600	67	67						
0.3 miles E of Powis rd.	Rt. 59	EB	2	3	7	21	2		2					
0.3 miles E of Powis rd.	Rt. 59	EB	1	5	6	30	3		3					
0.3 miles E of Powis rd.	Rt. 59	EB	2	1.5	15	22.5	3	3						
0.3 miles E of Powis rd.	Rt. 59	EB	1	3	25	75	8			8				
0.3 miles E of Powis rd.	Rt. 59	EB	2	1.5	20	30	3	3						
0.3 miles E of Powis rd.	Rt. 59	EB	2	1.5	30	45	5	5						
0.3 miles E of Powis rd.	Rt. 59	EB	2	3	200	600	67	67						
Rt. 59	0.3 miles E of Powis Rd.	WB	2	4	120	480	53	53						
Rt. 59	0.3 miles E of Powis Rd.	WB	2	12	10	120	13			13				
Rt. 59	0.3 miles E of Powis Rd.	WB	2	4	250	1000	111	111						
Rt. 59	0.3 miles E of Powis Rd.	WB	1	3	3	9	1		1					
Rt. 59	0.3 miles E of Powis Rd.	WB	2	12	4	48	5			5				
Rt. 59	0.3 miles E of Powis Rd.	WB	2	3	3	9	1		1					
Rt. 59	0.3 miles E of Powis Rd.	WB	2	3	4	12	1		1					
Rt. 59	0.3 miles E of Powis Rd.	WB	2	4	4	16	2		2					
Rt. 59	0.3 miles E of Powis Rd.	WB	1	3	3	9	1		1					
Rt. 59	0.3 miles E of Powis Rd.	WB	2	3	30	90	10			10				
Rt. 59	0.3 miles E of Powis Rd.	WB	2	3	4	12	1		1					
Rt. 59	0.3 miles E of Powis Rd.	WB	2	1.5	30	45	5	5						
Rt. 59	0.3 miles E of Powis Rd.	WB	2	3	3	9	1		1					
Rt. 59	0.3 miles E of Powis Rd.	WB	1	3	30	90	10			10				
Rt. 59	0.3 miles E of Powis Rd.	WB	2	3	30	90	10			10				
Rt. 59	0.3 miles E of Powis Rd.	WB	2	12	4	48	5			5				
Rt. 59	0.3 miles E of Powis Rd.	WB	2	3	100	300	33	33						
Rt. 59	0.3 miles E of Powis Rd.	WB	2	3	15	45	5			5				
Rt. 59	0.3 miles E of Powis Rd.	WB	2	3	50	150	17				17			
Rt. 59	0.3 miles E of Powis Rd.	WB	2	3	25	75	8			8				
Rt. 59	0.3 miles E of Powis Rd.	WB	1	1.5	12	18	2	2						
Rt. 59	0.3 miles E of Powis Rd.	WB	1	3	3	9	1		1					
Rt. 59	0.3 miles E of Powis Rd.	WB	2	12	3	36	4		4					
Rt. 59	0.3 miles E of Powis Rd.	WB	2	3	20	60	7			7				
Rt. 59	0.3 miles E of Powis Rd.	WB	2	3	15	45	5			5				
Rt. 59	0.3 miles E of Powis Rd.	WB	2	3	100	300	33	33						
Rt. 59	0.3 miles E of Powis Rd.	WB	2	3	250	750	83	83						
Rt. 59	0.3 miles E of Powis Rd.	WB	2	3	10	30	3		3					
Rt. 59	0.3 miles E of Powis Rd.	WB	1	12	5	60	7			7				
Rt. 59	0.3 miles E of Powis Rd.	WB	2	12	5	60	7			7				
Rt. 59	0.3 miles E of Powis Rd.	WB	2	3	12	36	4		4					
Rt. 59	0.3 miles E of Powis Rd.	WB	2	1.5	70	105	12	12						
Rt. 59	0.3 miles E of Powis Rd.	WB	2	3	60	180	20	20						
Rt. 59	0.3 miles E of Powis Rd.	WB	2	3	70	210	23	23						
Rt. 59	0.3 miles E of Powis Rd.	WB	2	1.5	150	225	25	25						
Rt. 59	0.3 miles E of Powis Rd.	WB	2	3	3	9	1		1					
Rt. 59	0.3 miles E of Powis Rd.	WB	2	3	15	45	5			5				
0.4 miles W of Powis Rd.	Kirk Road	WB	2	3	25	75	8			8				
0.4 miles W of Powis Rd.	Kirk Road	WB	2	3	150	450	50	50						
0.4 miles W of Powis Rd.	Kirk Road	WB	2	3	10	30	3		3					

CONTINUED ON THE NEXT SHEET

ROUTE: IL 64 (8TH Ave to IL 59) in St. Charles & West Chicago

CROSS STREETS		DIRECTION (EB/WB) (NB/SB)	LANE NO. (1, 2, 3)	PAVEMENT PATCH WIDTH	PAVEMENT PATCH LENGTH	REPAIR AREA (SQ FT)	REPAIR AREA (SQ YD)	MILL & RESURF	CLASS D PATCH TYPE I	CLASS D PATCH TYPE II	CLASS D PATCH TYPE III	CLASS D PATCH TYPE IV	PAVT MARKING 4"	RAISED REFL PAVT MARKERS
FROM	TO													
0.4 miles W of Powis Rd.	Kirk Road	WB	2	3	10	30	3		3					
0.4 miles W of Powis Rd.	Kirk Road	WB	2	3	5	15	2		2					
0.4 miles W of Powis Rd.	Kirk Road	WB	2	3	25	75	8			8				
0.4 miles W of Powis Rd.	Kirk Road	WB	2	3	5	15	2		2					
0.4 miles W of Powis Rd.	Kirk Road	WB	2	3	3	9	1		1					
0.4 miles W of Powis Rd.	Kirk Road	WB	2	3	100	300	33	33						
0.4 miles W of Powis Rd.	Kirk Road	WB	1	12	4	48	5			5				
0.4 miles W of Powis Rd.	Kirk Road	WB	2	12	5	60	7			7				
0.4 miles W of Powis Rd.	Kirk Road	WB	2	3	25	75	8			8				
0.4 miles W of Powis Rd.	Kirk Road	WB	2	12	4	48	5			5				
0.4 miles W of Powis Rd.	Kirk Road	WB	2	3	3	9	1		1					
0.4 miles W of Powis Rd.	Kirk Road	WB	2	3	250	750	83	83						
0.4 miles W of Powis Rd.	Kirk Road	WB	2	1.5	20	30	3	3						
0.4 miles W of Powis Rd.	Kirk Road	WB	2	3	80	240	27	27						
0.4 miles W of Powis Rd.	Kirk Road	WB	2	1.5	15	22.5	3	3						
0.4 miles W of Powis Rd.	Kirk Road	WB	2	3	30	90	10			10				
0.4 miles W of Powis Rd.	Kirk Road	WB	2	3	50	150	17	17						
0.4 miles W of Powis Rd.	Kirk Road	WB	2	3	10	30	3		3					
0.4 miles W of Powis Rd.	Kirk Road	WB	2	15	5	75	8			8				
0.4 miles W of Powis Rd.	Kirk Road	WB	2	4	5	20	2		2					
0.4 miles W of Powis Rd.	Kirk Road	WB	2	12	4	48	5			5				
0.4 miles W of Powis Rd.	Kirk Road	WB	2	4	10	40	4		4					
0.4 miles W of Powis Rd.	Kirk Road	WB	2	4	3	12	1		1					
0.4 miles W of Powis Rd.	Kirk Road	WB	1	3	3	9	1		1					
0.4 miles W of Powis Rd.	Kirk Road	WB	2	4	4	16	2		2					
0.4 miles W of Powis Rd.	Kirk Road	WB	2	3	3	9	1		1					
0.4 miles W of Powis Rd.	Kirk Road	WB	2	3	3	9	1		1					
0.4 miles W of Powis Rd.	Kirk Road	WB	2	4	4	16	2		2					
0.4 miles W of Powis Rd.	Kirk Road	WB	2	5	60	300	33	33						
0.4 miles W of Powis Rd.	Kirk Road	WB	1	8	3	24	3		3					
0.4 miles W of Powis Rd.	Kirk Road	WB	2	4	3	12	1		1					
0.4 miles W of Powis Rd.	Kirk Road	WB	2	6	15	90	10			10				
0.4 miles W of Powis Rd.	Kirk Road	WB	2	1.5	125	187.5	21	21						
0.4 miles W of Powis Rd.	Kirk Road	WB	2	3	20	60	7			7				
0.4 miles W of Powis Rd.	Kirk Road	WB	1	12	4	48	5			5				
0.4 miles W of Powis Rd.	Kirk Road	WB	2	12	4	48	5			5				
0.4 miles W of Powis Rd.	Kirk Road	WB	2	12	4	48	5			5				
0.4 miles W of Powis Rd.	Kirk Road	WB	1	6	4	24	3		3					
0.4 miles W of Powis Rd.	Kirk Road	WB	2	12	4	48	5			5				
0.4 miles W of Powis Rd.	Kirk Road	WB	1	3	4	12	1		1					
0.4 miles W of Powis Rd.	Kirk Road	WB	1	12	10	120	13			13				
0.4 miles W of Powis Rd.	Kirk Road	WB	2	12	10	120	13			13				
0.4 miles W of Powis Rd.	Kirk Road	WB	1	4	3	12	1		1					
0.4 miles W of Powis Rd.	Kirk Road	WB	1	12	3	36	4		4					
0.4 miles W of Powis Rd.	Kirk Road	WB	2	12	3	36	4		4					
0.4 miles W of Powis Rd.	Kirk Road	WB	1	12	3	36	4		4					
0.4 miles W of Powis Rd.	Kirk Road	WB	2	12	3	36	4		4					
0.4 miles W of Powis Rd.	Kirk Road	WB	1	12	3	36	4		4					
0.4 miles W of Powis Rd.	Kirk Road	WB	2	12	3	36	4		4					
0.4 miles W of Powis Rd.	Kirk Road	WB	1	12	3	36	4		4					
0.4 miles W of Powis Rd.	Kirk Road	WB	2	12	3	36	4		4					
0.4 miles W of Powis Rd.	Kirk Road	WB	1	12	3	36	4		4					
0.4 miles W of Powis Rd.	Kirk Road	WB	2	12	5	60	7			7				
0.4 miles W of Powis Rd.	Kirk Road	WB	3	3	3	9	1		1					
0.4 miles W of Powis Rd.	Kirk Road	WB	1	12	3	36	4		4					
0.4 miles W of Powis Rd.	Kirk Road	WB	2	12	3	36	4		4					
0.4 miles W of Powis Rd.	Kirk Road	WB	2	12	8	96	11			11				
0.4 miles W of Powis Rd.	Kirk Road	WB	2	3	20	60	7			7				
0.4 miles W of Powis Rd.	Kirk Road	WB	2	4	20	80	9			9				
Kirk Road	8th Ave	WB	3	4	12	48	5			5				
Kirk Road	8th Ave	WB	2	3	3	9	1		1					
Kirk Road	8th Ave	WB	2	6	4	24	3		3					
Kirk Road	8th Ave	WB	2	1.5	300	450	50	50						

CONTINUED ON THE NEXT SHEET

FILE NAME =
c:\projects\136400\design_aa.dgn

USER NAME = w1greendp
DESIGNED -
DRAWN -
CHECKED -
DATE -
PLOT SCALE = 100.0000' / 1" IN.
PLOT DATE = 3/14/2008

DESIGNED -
DRAWN -
CHECKED -
DATE -
REVISED -
REVISED -
REVISED -
REVISED -

REVISED -
REVISED -
REVISED -
REVISED -

STATE OF ILLINOIS
DEPARTMENT OF TRANSPORTATION

PATCHING SCHEDULE
IL 64

SCALE: SHEET NO. OF SHEETS STA. TO STA.

F.A.P. RTE.	SECTION	COUNTY	TOTAL SHEETS	SHEET NO.
VAR.	2008-013 PP	KANE	34	24
			CONTRACT NO. 60E39	

ROUTE: IL 64 (8TH Ave to IL 59) in St. Charles & West Chicago

CROSS STREETS		DIRECTION (EB/WB) (NB/SB)	LANE NO. (1, 2, 3)	PAVEMENT PATCH WIDTH	PAVEMENT PATCH LENGTH	REPAIR AREA (SQ FT)	REPAIR AREA (SQ YD)	MILL & RESURF	CLASS D PATCH TYPE I	CLASS D PATCH TYPE II	CLASS D PATCH TYPE III	CLASS D PATCH TYPE IV	PAVT MARKING 4"	RAISED REFL PAVT MARKERS
FROM	TO													
Kirk Road	8th Ave	WB		3	10	30	3		3					
Kirk Road	8th Ave	WB		1.5	15	22.5	3	3						
Kirk Road	8th Ave	WB		1.5	30	45	5	5						
Kirk Road	8th Ave	WB		3	30	90	10			10				
Kirk Road	8th Ave	WB	2	6	12	72	8			8				
Kirk Road	8th Ave	WB	2	4	6	24	3		3					
Kirk Road	8th Ave	WB	2	3	4	12	1		1					
Kirk Road	8th Ave	WB	2	3	3	9	1		1					
Kirk Road	8th Ave	WB	2	3	4	12	1		1					
Kirk Road	8th Ave	WB	2	3	3	9	1		1					
Kirk Road	8th Ave	WB	1	3	3	9	1		1					
Kirk Road	8th Ave	WB	1	3	3	9	1		1					
Kirk Road	8th Ave	WB	1	3	30	90	10			10				
Kirk Road	8th Ave	WB	1	12	4	48	5			5				
Kirk Road	8th Ave	WB	2	12	4	48	5			5				
Kirk Road	8th Ave	WB	2	6	3	18	2		2					
Kirk Road	8th Ave	WB	2	3	400	1200	133	133						
Kirk Road	8th Ave	WB	2	6	3	18	2		2					
Kirk Road	8th Ave	WB	2	12	4	48	5			5				
Kirk Road	8th Ave	WB	2	12	4	48	5			5				
Kirk Road	8th Ave	WB	2	3	20	60	7			7				
Kirk Road	8th Ave	WB	2	3	40	120	13			13				
Kirk Road	8th Ave	WB	1	12	15	180	20				20			
Kirk Road	8th Ave	WB	2	6	30	180	20				20			
Kirk Road	8th Ave	WB		1.5	30	45	5	5						
Kirk Road	8th Ave	WB	2	3	20	60	7			7				
Kirk Road	8th Ave	WB	1	3	3	9	1		1					
Kirk Road	8th Ave	WB	2	3	30	90	10			10				
Kirk Road	8th Ave	WB		3	30	90	10			10				
Kirk Road	8th Ave	WB	2	3	70	210	23				23			
Kirk Road	8th Ave	WB	2	3	5	15	2		2					
Kirk Road	8th Ave	WB		1.5	50	75	8	8						
Kirk Road	8th Ave	WB	1	12	3	36	4		4					
Kirk Road	8th Ave	WB		1.5	50	75	8	8						
Kirk Road	8th Ave	WB	2	3	3	9	1		1					
Kirk Road	8th Ave	WB		1.5	25	37.5	4		4					
Kirk Road	8th Ave	WB		1.5	60	90	10	10						
Kirk Road	8th Ave	WB	2	5	100	500	56	56						
Kirk Road	8th Ave	WB	2	5	15	75	8			8				
Kirk Road	8th Ave	WB	1	3	25	75	8			8				
Kirk Road	8th Ave	WB	2	3	20	60	7			7				
Kirk Road	8th Ave	WB	2	3	35	105	12			12				
Kirk Road	8th Ave	WB	2	3	25	75	8			8				
Kirk Road	8th Ave	WB	2	3	4	12	1		1					
Kirk Road	8th Ave	WB	1	12	10	120	13			13				
Kirk Road	8th Ave	WB	2	5	3	15	2		2					
Kirk Road	8th Ave	WB	2	12	20	240	27	27						
Kirk Road	8th Ave	WB	2	6	3	18	2		2					
Kirk Road	8th Ave	WB	2	3	3	9	1		1					
Kirk Road	8th Ave	WB	2	3	3	9	1		1					
Kirk Road	8th Ave	WB	2	6	15	90	10			10				

TOTALS:

3125 SY 2129 SY 267 SY 742 SY 96 SY 4700 FT 50 EACH

FILE NAME = c:\projects\136408\design_00.dgn
 USER NAME = wilgreendp
 PLOT SCALE = 100.0000' / IN.
 PLOT DATE = 3/14/2008

DESIGNED -	REVISED -
DRAWN -	REVISED -
CHECKED -	REVISED -
DATE -	REVISED -

**STATE OF ILLINOIS
 DEPARTMENT OF TRANSPORTATION**

**PATCHING SCHEDULE
 IL 64**

SCALE: SHEET NO. OF SHEETS STA. TO STA.

F.A.P. RTE.	SECTION	COUNTY	TOTAL SHEETS	SHEET NO.
VAR.	2008-013 PP	KANE	34	25
FED. ROAD DIST. NO. 1 ILLINOIS FED. AID PROJECT			CONTRACT NO. 60E39	

ROUTE: IL 64 (LaFox Rd to Dean St) in St. Charles

CROSS STREETS		DIRECTION (EB/WB) (NB/SB)	LANE NO. (1, 2, 3)	PAVEMENT PATCH WIDTH	PAVEMENT PATCH LENGTH	REPAIR AREA (SQ FT)	REPAIR AREA (SQ YD)	MILL & RESURF	CLASS D PATCH TYPE I	CLASS D PATCH TYPE II	CLASS D PATCH TYPE III	CLASS D PATCH TYPE IV	PAVT MARKING 4"	RAISED REFL PAVT MKS
FROM	TO													
LaFox	800' E of Dean St.	EB	1	3	5	15	2		2					
		EB	1	3	5	15	2		2					
		EB		1.5	100	150	17	17						
		EB		1.5	30	45	5	5						
		EB		1.5	200	300	33	33						
		EB		1.5	30	45	5	5						
		EB		1.5	15	22.5	3	3						
		EB		1.5	400	600	67	67						
		EB		1.5	100	150	17	17						
		EB		1.5	20	30	3	3						
		EB	1	3	3	9	1	1						
		EB		1.5	15	22.5	3	3						
		EB		1.5	250	375	42	42						
		EB	1	3	7	21	2		2					
		EB	1	12	80	960	107	107						
		EB		1.5	80	120	13	13						
		EB	1	4	5	20	2		2					
		EB	1	3	3	9	1		1					
		EB	1	3	4	12	1		1					
		EB	1	4	50	200	22	22						
		EB	1	4	200	800	89	89						
		EB		1.5	50	75	8	8						
		EB	1	3	30	90	10	10						
		EB		1.5	35	52.5	6	6						
		EB	1	4	25	100	11	11						
		EB	1	12	25	300	33	33						
		EB		1.5	200	300	33	33						
		EB	1	4	15	60	7			7				
		EB		1.5	40	60	7	7						
		EB	1	4	30	120	13	13						
		EB	1	6	15	90	10			10				
		EB		1.5	20	30	3	3						
		EB		1.5	20	30	3	3						
		EB	1	3	3	9	1		1					
		EB		1.5	30	45	5	5						
		EB		1.5	80	120	13	13						
		EB	1	3	20	60	7			7				
		EB	1	3	15	45	5			5				
		EB	1	4	20	80	9			9				
		EB		1.5	25	37.5	4	4						
		WB	1	4	4	16	2		2					
		WB	1	3	30	90	10			10				
		WB	1	6	40	240	27	27						
		WB	1	6	60	360	40	40						
		WB	1	3	3	9	1		1					
		WB	1	12	150	1800	200	200						
		WB	1	5	150	750	83	83						
		WB		1.5	20	30	3	3						
		WB	1	5	45	225	25				25			
		WB	1	3	3	9	1		1					
		WB		1.5	150	225	25	25						
		WB	1	6	7	42	5			5				
		WB		1.5	25	37.5	4	4						
		WB	1	3	3	9	1		1					
		WB	1	5	30	150	17				17			
		WB		1.5	120	180	20	20						
		WB		1.5	40	60	7	7						
		WB		1.5	25	37.5	4	4						
		WB		1.5	150	225	25	25						
		WB		1.5	10	15	2	2						
		WB	1	3	4	12	1	1						
		WB		1.5	50	75	8	8						
		WB		1.5	500	750	83	83						
		WB		1.5	1100	1650	183	183						
		WB	1	3	3	9	1		1					
		WB	1	4	4	16	2		2		SH			

TOTALS: 1405 SY 1291 SY 19 SY 53 SY 42 SY 1405 SY 3500 FT 25 EACH

FILE NAME = c:\pave\joc\td\36488\design\...
 USER NAME = wjgroendp
 PLT SCALE = 100.0000 / IN.
 PLT DATE = 3/14/2008

DESIGNED -
 DRAWN -
 CHECKED -
 DATE -

REVISED -
 REVISED -
 REVISED -
 REVISED -

STATE OF ILLINOIS
 DEPARTMENT OF TRANSPORTATION

PATCHING SCHEDULE
 IL 64

SCALE: SHEET NO. OF SHEETS STA. TO STA.

F.A.P. RTE. SECTION COUNTY TOTAL SHEETS SHEET NO.
 VAR. 2008-013 PP KANE 34 26
 CONTRACT NO. 60E39
 ILL. ROAD DIST. NO. 1 ILL. INDUSTR. AND PROJECT

ROUTE: Galena Blvd (IL 56 to Hankes Road) in Aurora

CROSS STREETS		DIRECTION (EB/WB) (NB/SB)	LANE NO. (1, 2, 3)	PAVEMENT PATCH WIDTH	PAVEMENT PATCH LENGTH	REPAIR AREA (SQ FT)	REPAIR AREA (SQ YD)	MILL & RESURF	CLASS D PATCH TYPE I	CLASS D PATCH TYPE II	CLASS D PATCH TYPE III	CLASS D PATCH TYPE IV	PAVT MARKING 4"	RAISED REFL PAVT MKS
FROM	TO													
Rt. 56	Barnes Road	EB	1	6	15	90	10	10						
Rt. 56	Barnes Road	EB		3	50	150	17	17						
Rt. 56	Barnes Road	EB	1	3	5	15	2		2					
Rt. 56	Barnes Road	EB		3	15	45	5			5				
Rt. 56	Barnes Road	EB	1	3	3	9	1		1					
Rt. 56	Barnes Road	EB	1	12	25	300	33	33						
Rt. 56	Barnes Road	EB	2	6	30	180	20	20						
Rt. 56	Barnes Road	EB		3	50	150	17	17						
Rt. 56	Barnes Road	EB	1	4	40	160	18	18						
Rt. 56	Barnes Road	EB	1	6	30	180	20	20						
Rt. 56	Barnes Road	EB	1	6	10	60	7			7				
Rt. 56	Barnes Road	EB	1	3	3	9	1		1					
Rt. 56	Barnes Road	EB	1	3	3	9	1		1					
Rt. 56	Barnes Road	EB		3	15	45	5	5						
Rt. 56	Barnes Road	EB		3	5	15	2		2					
Rt. 56	Barnes Road	EB		3	20	60	7	7						
Rt. 56	Barnes Road	EB	1	5	12	60	7			7				
Rt. 56	Barnes Road	EB		3	20	60	7	7						
Rt. 56	Barnes Road	EB	1	6	60	360	40					40		
Rt. 56	Barnes Road	EB		3	20	60	7	7						
Rt. 56	Barnes Road	EB	1	6	75	450	50					50		
Rt. 56	Barnes Road	EB		3	30	90	10	10						
Rt. 56	Barnes Road	EB	1	5	15	75	8			8				
Rt. 56	Barnes Road	EB		3	150	450	50	50						
Rt. 56	Barnes Road	EB	1	5	40	200	22	22						
Rt. 56	Barnes Road	EB	1	3	20	60	7	7						
Rt. 56	Barnes Road	EB		3	25	75	8	8						
Rt. 56	Barnes Road	EB	1	6	30	180	20				20			
Rt. 56	Barnes Road	EB	1	3	15	45	5		5					
Rt. 56	Barnes Road	EB	1	4	4	16	2		2					
Rt. 56	Barnes Road	EB	1	3	3	9	1		1					
Rt. 56	Barnes Road	EB	1	3	4	12	1		1					
Rt. 56	Barnes Road	EB	1	8	70	560	62	62						
Rt. 56	Barnes Road	EB	1	12	20	240	27	27						
Rt. 56	Barnes Road	EB	1	4	4	16	2		2					
Rt. 56	Barnes Road	EB		3	30	90	10	10						
Rt. 56	Barnes Road	EB	1	5	10	50	6	6						
Rt. 56	Barnes Road	EB	1	3	3	9	1		1					
Rt. 56	Barnes Road	EB	1	5	15	75	8			8				
Rt. 56	Barnes Road	EB	1	3	3	9	1		1					
Rt. 56	Barnes Road	EB	1	4	12	48	5			5				
Rt. 56	Barnes Road	EB	1	4	12	48	5			5				
Rt. 56	Barnes Road	EB	1	6	15	90	10			10				
Rt. 56	Barnes Rd.	EB	1	6	15	90	10			10				
Barnes Rd.	Hankes Rd.	EB		3	40	120	13	13						
Barnes Rd.	Hankes Rd.	EB		3	20	60	7	7						
Barnes Rd.	Hankes Rd.	EB	1	4	20	80	9			9				
Barnes Rd.	Hankes Rd.	EB	1	6	20	120	13	13						
Barnes Rd.	Hankes Rd.	EB		3	50	150	17	17						
Barnes Rd.	Hankes Rd.	EB		3	30	90	10	10						
Hankes Rd.	Barnes Rd.	WB	1	3	5	15	2		2					
Hankes Rd.	Barnes Rd.	WB	1	4	5	20	2		2					
Hankes Rd.	Barnes Rd.	WB	1	3	30	90	10			10				
Hankes Rd.	Barnes Rd.	WB	1	4	4	16	2	2						
Hankes Rd.	Barnes Rd.	WB	1	4	5	20	2		2					

CONTINUED ON THE NEXT SHEET

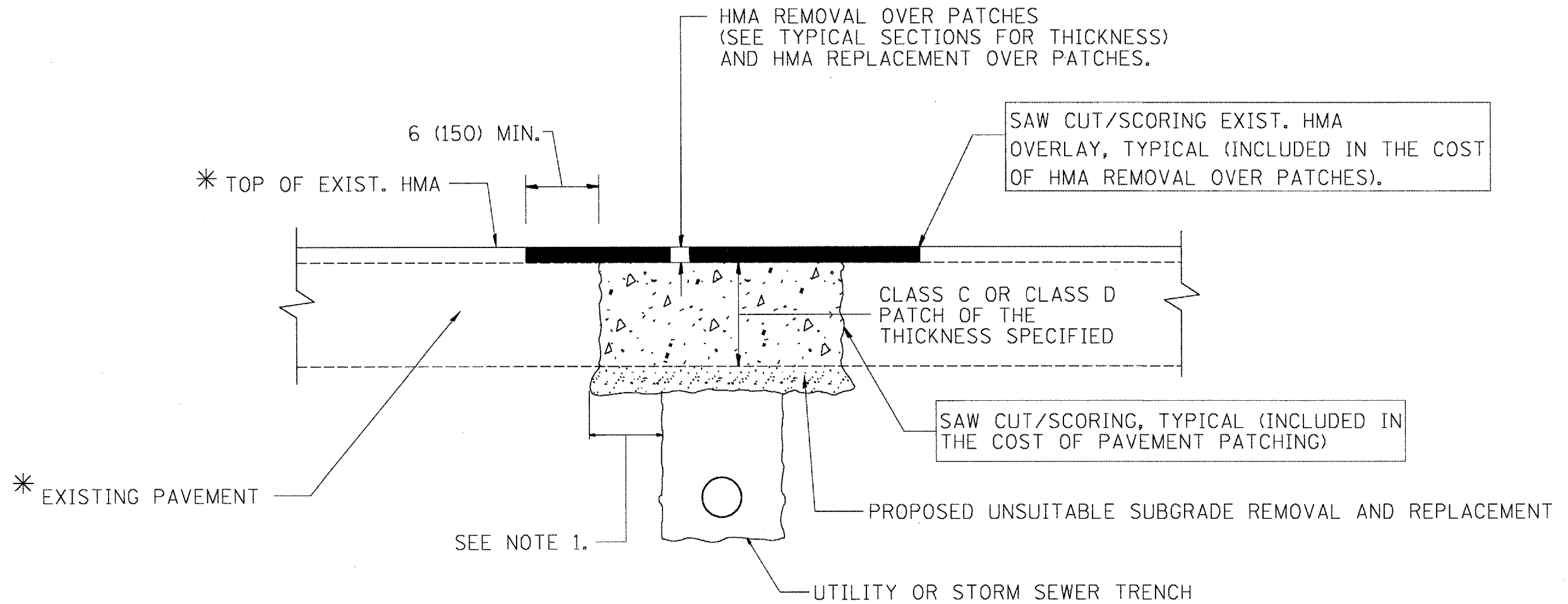

* SEE TYPICAL SECTIONS FOR THICKNESS AND MATERIALS

NOTES:

1. THE WIDTH OF THE FULL DEPTH PATCH OVER A TRENCH SHALL BE 12 (300) WIDER ON EACH SIDE OF THE TRENCH.
2. FOR METHOD OF MEASUREMENT AND BASIS OF PAYMENT, SEE RECURRING SPECIAL PROVISION "PATCHING WITH HOT-MIX ASPHALT OVERLAY REMOVAL".

SEQUENCE OF CONSTRUCTION

1. REMOVE THE EXISTING HMA MATERIAL OVER THE AREA TO BE PATCHED.
2. REMOVE AND REPLACE FULL DEPTH PATCHES
3. REPLACE HMA MATERIAL OVER THE AREA TO BE PATCHED.

ALL DIMENSIONS ARE IN INCHES (MILLIMETERS) UNLESS OTHERWISE SHOWN.

FILE NAME = W:\distsd\22x34\bd22.dgn	USER NAME = amthk1	DESIGNED - R. SHAH	REVISED - A. ABBAS 01-20-98	STATE OF ILLINOIS DEPARTMENT OF TRANSPORTATION	PAVEMENT PATCHING FOR HMA SURFACED PAVEMENT			F.A. RTE. VAK	SECTION 2008-013PP	COUNTY KANE	TOTAL SHEETS 39	SHEET NO. 29
	PLOT SCALE = 1/8" = 1' / IN.	DRAWN -	REVISED - A. ABBAS 04-27-98		SCALE: NONE	SHEET NO. 1 OF 1 SHEETS	STA.	TO STA.	BD400-04 (BD-22)	CONTRACT NO. 60E39	FED. ROAD DIST. NO. 1 ILLINOIS FED. AID PROJECT	
	PLOT DATE = 3/14/2008	CHECKED -	REVISED - R. BORO 01-01-07									
		DATE = 10-25-94	REVISED - R. BORO 09-04-07									

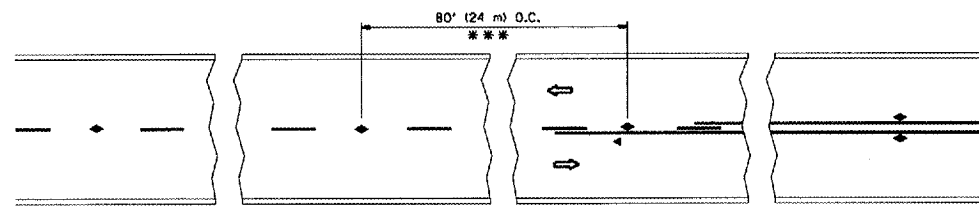

*** REDUCE TO 40' (12 m) O.C. ON CURVES WITH POSTED OR ADVISORY SPEED 45 M.P.H. (70 km/h) OR LESS.

TWO-LANE/TWO-WAY

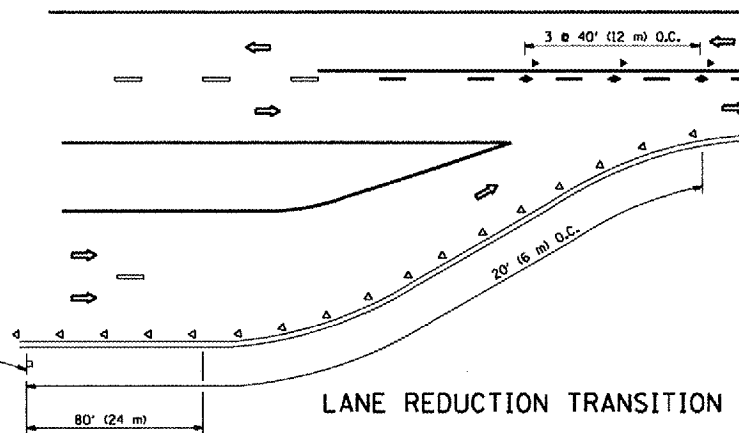

LANE REDUCTION TRANSITION

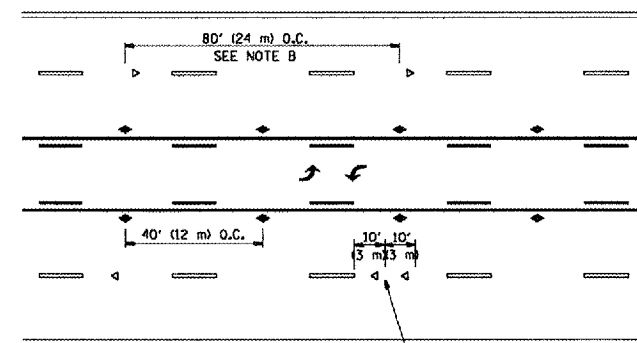

TWO-WAY LEFT TURN

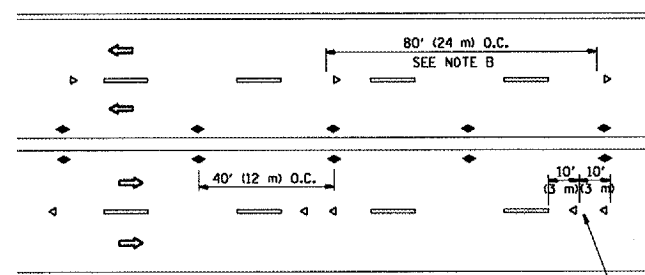

MULTI-LANE/UNDIVIDED

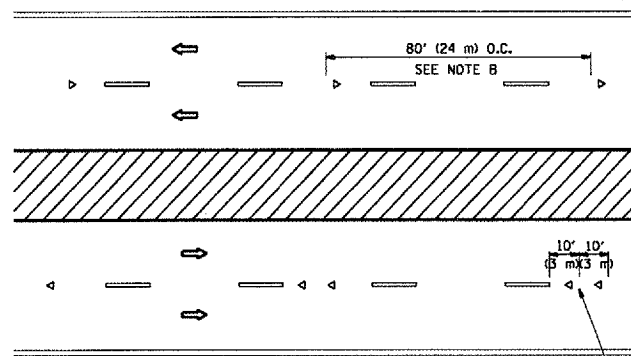

MULTI-LANE/DIVIDED

GENERAL NOTES

1. MARKERS USED WITH DASHED LINES SHALL BE CENTERED IN THE GAP BETWEEN SEGMENTS.
2. MARKERS USED ADJACENT TO SOLID LINES SHALL BE OFFSET 2 TO 3 (50 TO 75) TOWARD TRAFFIC AS SHOWN.
3. MARKERS THROUGH TANGENTS LESS THAN 500' (150 m) IN LENGTH BETWEEN CURVES SHALL BE INSTALLED AT THE LESSER OF THE TWO CURVE SPACINGS.

SYMBOLS

- YELLOW STRIPE
- WHITE STRIPE
- ◄ ONE-WAY AMBER MARKER
- ◄ ONE-WAY CRYSTAL MARKER (W/O)
- ◆ TWO-WAY AMBER MARKER

LANE MARKER NOTES

- B. REDUCE TO 40' (12 m) O.C. ON CURVES WHERE ADVISORY SPEEDS ARE 10 M.P.H. (16 km/h) LOWER THAN POSTED SPEEDS.
- A. USE DOUBLE LANE LINE MARKERS SPACED AS SHOWN.

DESIGN NOTES

1. DOUBLE LANE LINE MARKERS SHALL BE USED UNLESS SPECIFIED OTHERWISE.
2. EXCEPT AS SHOWN ON THE LANE REDUCTION TRANSITION AND FREEWAY EXIT RAMP DETAIL, MARKERS ARE NOT TO BE SPECIFIED ON RIGHT EDGE LINES.
3. THE EXACT MARKER LIMITS, SPACING, AND COLOR SHOULD BE INCLUDED IN THE PLANS.
4. MARKERS SHOULD NOT BE USED ALONGSIDE CURBS EXCEPT FOR EXTREMELY SHORT SECTIONS OF CURBS WHERE NOT MORE THAN TWO MARKERS WOULD BE INVOLVED.

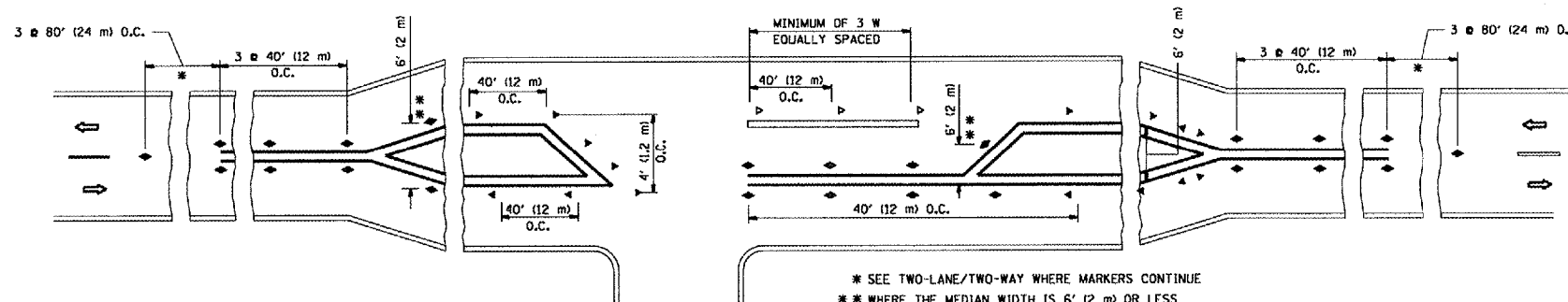

LEFT TURN

* SEE TWO-LANE/TWO-WAY WHERE MARKERS CONTINUE
 ** WHERE THE MEDIAN WIDTH IS 6' (2 m) OR LESS USE TWO-WAY MARKERS.

All dimensions are in inches (millimeters) unless otherwise shown.

FILE NAME = M:\disto\td\22x34\tell1.dgn	USER NAME = smthk1	DESIGNED -	REVISED - T. RAMMACHER 09-19-94	STATE OF ILLINOIS DEPARTMENT OF TRANSPORTATION	TYPICAL APPLICATIONS RAISED REFLECTIVE PAVEMENT MARKERS (SNOW-PLOW RESISTANT)			F.A. RTE.	SECTION	COUNTY	TOTAL SHEETS	SHEET NO.
	PLOT SCALE = 103.785' / IN.	CHECKED -	REVISED - T. RAMMACHER 03-12-99		SCALE: NONE	SHEET NO. 1 OF 1 SHEETS	STA.	TO STA.	VAR. 2008-013 PP	KANE	34	31
PLOT DATE = 3/14/2008	DATE -	REVISED - T. RAMMACHER 01-06-00	REVISED -	FED. ROAD DIST. NO. 1 ILLINOIS FED. AID PROJECT			TC-11		CONTRACT NO. 60E39			

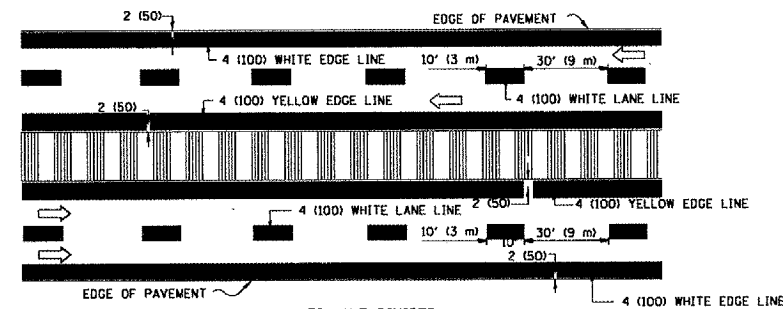
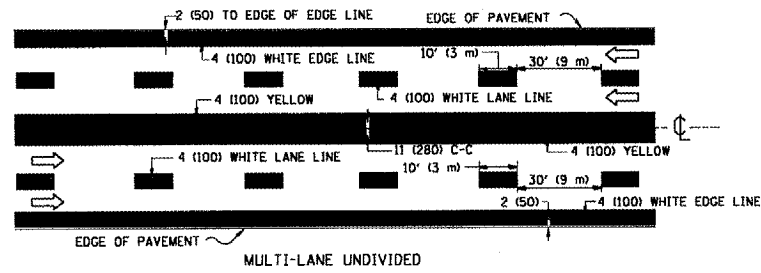
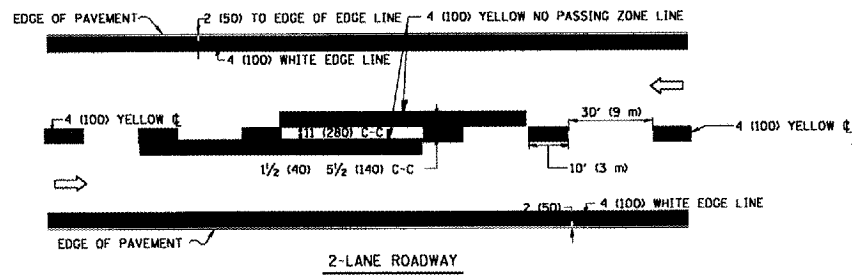

NOTE: MEDIANS WITH BARRIER CURB DO NOT REQUIRE AN EDGE LINE

TYPICAL LANE AND EDGE LINE MARKING

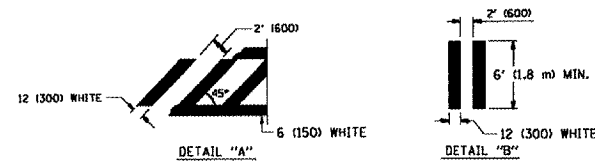
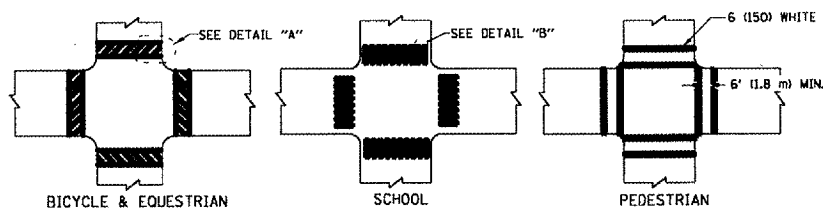

TYPICAL CROSSWALK MARKING

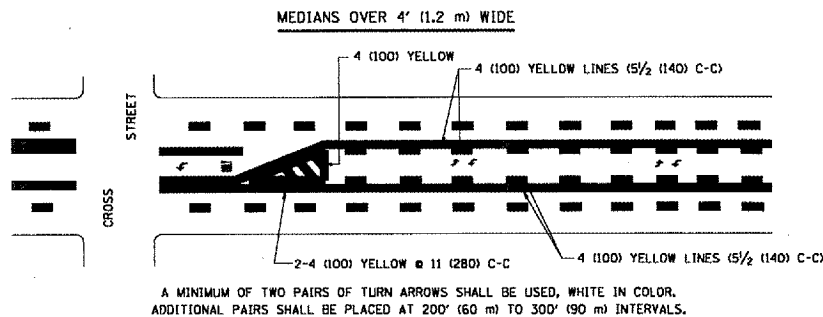
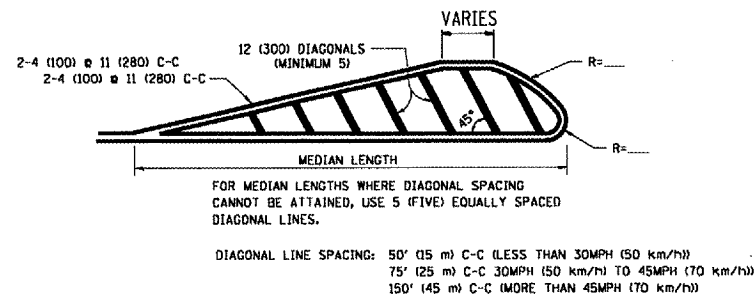
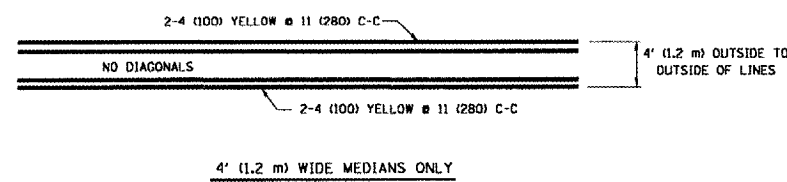

TYPICAL PAINTED MEDIAN MARKING

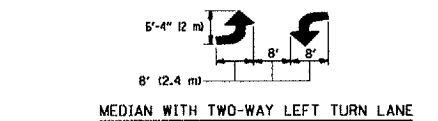

TYPICAL TURN LANE MARKING

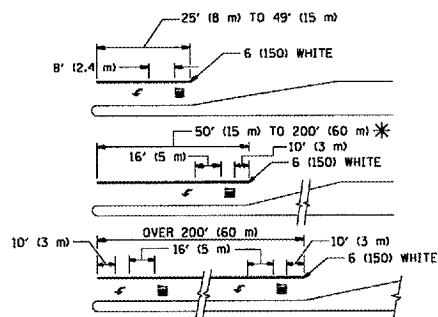

FULL SIZE LETTERS 8' (2.4 m) AND ARROWS SHALL BE USED. AREA = 15.6 SQ. FT. (1.5 m²) ONLY AREA = 20.8 SQ. FT. (1.9 m²) * TURN LANES IN EXCESS OF 400' (120 m) IN LENGTH MAY HAVE AN ADDITIONAL SET OF ARROW - "ONLY" INSTALLED MIDWAY BETWEEN THE OTHER TWO SETS OF ARROW - "ONLY".

TYPICAL LEFT (OR RIGHT) TURN LANE

TYPICAL TURN LANE MARKING

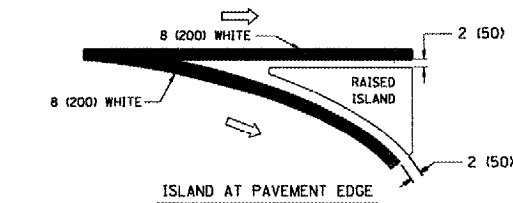
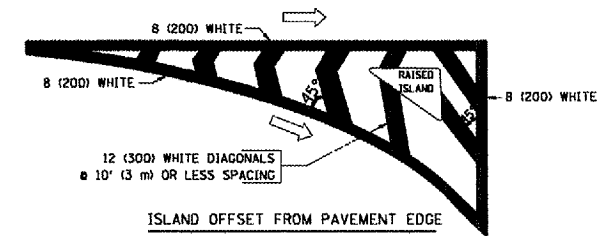

TYPICAL ISLAND MARKING

TYPE OF MARKING	WIDTH OF LINE	PATTERN	COLOR	SPACING / REMARKS
CENTERLINE ON 2 LANE PAVEMENT	4 (100)	SKIP-DASH	YELLOW	10' (3 m) LINE WITH 30' (9 m) SPACE
CENTERLINE ON MULTI-LANE UNDIVIDED PAVEMENT	2 # 4 (100)	SOLID	YELLOW	11 (280) C-C
NO PASSING ZONE LINES: FOR ONE DIRECTION	4 (100)	SOLID	YELLOW	5 1/2 (140) C-C FROM SKIP-DASH CENTERLINE
NO PASSING ZONE LINES: FOR BOTH DIRECTIONS	2 # 4 (100)	SOLID	YELLOW	11 (280) C-C OMIT SKIP-DASH CENTERLINE BETWEEN
LANE LINES	4 (100)	SKIP-DASH	WHITE	10' (3 m) LINE WITH 30' (9 m) SPACE
LANE LINES	5 (125) ON FREEWAYS	SKIP-DASH	WHITE	
DOTTED LINES (EXTENSIONS OF CENTER, LANE OR TURN LANE MARKINGS)	SAME AS LINE BEING EXTENDED	SKIP-DASH	SAME AS LINE BEING EXTENDED	2' (600) LINE WITH 6' (1.8 m) SPACE
EDGE LINES	4 (100)	SOLID	YELLOW-LEFT WHITE-RIGHT	OUTLINE MOUNTABLE MEDIANS IN YELLOW; EDGE LINES ARE NOT USED NEXT TO BARRIER CURB
TURN LANE MARKINGS	6 (150) LINE; FULL SIZE LETTERS & SYMBOLS (8' (2.4m))	SOLID	WHITE	SEE TYPICAL TURN LANE MARKING DETAIL
TWO WAY LEFT TURN MARKING	2 # 4 (100) EACH DIRECTION	SKIP-DASH AND SOLID	YELLOW	10' (3 m) LINE WITH 30' (9 m) SPACE FOR SKIP-DASH; 5 1/2 (140) C-C BETWEEN SOLID LINE AND SKIP-DASH LINE
TWO WAY LEFT TURN MARKING	8' (2.4m) LEFT ARROW	IN PAIRS	WHITE	SEE TYPICAL TWO-WAY LEFT TURN MARKING DETAIL
CROSSWALK LINES (PEDESTRIAN)	2 # 6 (150)	SOLID	WHITE	NOT LESS THAN 6' (1.8 m) APART
CROSSWALK LINES (BIKE & EQUESTRIAN)	12 (300) @ 45°	SOLID	WHITE	2' (600) APART
CROSSWALK LINES (LONGITUDINAL BARS (SCHOOL))	12 (300) @ 90°	SOLID	WHITE	SEE TYPICAL CROSSWALK MARKING DETAILS.
STOP LINES	24 (600)	SOLID	WHITE	PLACE 4' (1.2 m) IN ADVANCE OF AND PARALLEL TO CROSSWALK, IF PRESENT. OTHERWISE PLACE AT DESIRED STOPPING POINT. PARALLEL TO CROSSROAD CENTERLINE, WHERE POSSIBLE
PAINTED MEDIANS	2 # 4 (100) WITH 12 (300) DIAGONALS @ 45°	SOLID	YELLOW: TWO WAY TRAFFIC WHITE: ONE WAY TRAFFIC	11 (280) C-C FOR THE DOUBLE LINE SEE TYPICAL PAINTED MEDIAN MARKING.
CORE MARKING AND CHANNELIZING LINES	8 (200) WITH 12 (300) DIAGONALS @ 45°	SOLID	WHITE	DIAGONALS: 15' (4.5 m) C-C (LESS THAN 30MPH (50 km/h)) 20' (6 m) C-C (30MPH (50 km/h) TO 45MPH (70 km/h)) 30' (9 m) C-C (OVER 45MPH (70 km/h))
RAILROAD CROSSING	24 (600) TRANSVERSE LINES; "RR" IS 6' (1.8 m) LETTERS; 16 (400) LINE FOR "X"	SOLID	WHITE	SEE STATE STANDARD 780001 AREA OF: "R"=3.6 SQ. FT. (0.33 m ²) EACH "X"=54.0 SQ. FT. (5.0 m ²)
SHOULDER DIAGONALS	12 (300) @ 45°	SOLID	WHITE - RIGHT YELLOW - LEFT	50' (15 m) C-C (LESS THAN 30MPH (50 km/h)) 75' (25 m) C-C (30 MPH (50 km/h) TO 45MPH (70 km/h)) 150' (45 m) C-C (OVER 45MPH (70 km/h))

FOR FURTHER DETAILS ON PAVEMENT MARKING REFER TO STANDARD SPECIFICATIONS FOR ROAD AND BRIDGE CONSTRUCTION AND STATE STANDARD 780001.



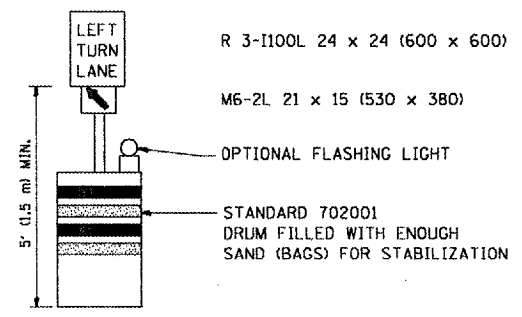
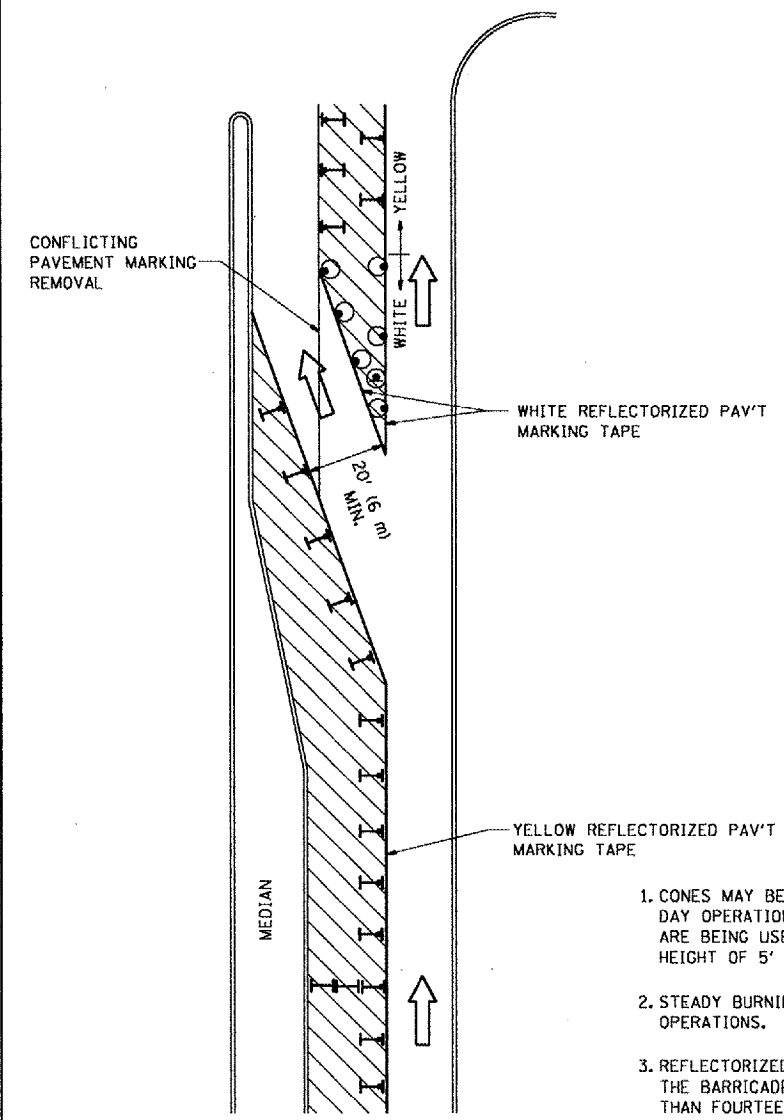

All dimensions are in inches (millimeters) unless otherwise shown.

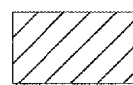
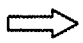

GENERAL NOTES

1. CONES MAY BE SUBSTITUTED FOR BARRICADES OR DRUMS AT HALF THE SPACING DURING DAY OPERATIONS. CONES SHALL BE A MINIMUM OF 28 (710) IN HEIGHT. WHEN CONES ARE BEING USED, THE "LEFT TURN LANE" SIGN MAY BE SKID MOUNTED AT A MINIMUM HEIGHT OF 5' (1.5 m).
2. STEADY BURNING LIGHTS WILL NOT BE REQUIRED ON BARRICADES OR DRUMS FOR DAY OPERATIONS. ALL LIGHTS SHALL BE MONODIRECTIONAL.
3. REFLECTORIZED TEMPORARY PAVEMENT MARKING TAPE SHALL BE PLACED THROUGHOUT THE BARRICADED AREA OF EACH TURN BAY WHERE THE CLOSURE TIME IS GREATER THAN FOURTEEN DAYS.
4. THIS APPLICATION ALSO APPLIES WHEN WORK IS BEING PERFORMED IN THE RIGHT LANE(S) AND THE RIGHT TURN BAY IS TO REMAIN OPEN. UNDER THIS CONDITION, "RIGHT TURN LANE" R3-100 24 x 24 (600 x 600) AND M6-2R 21 x 15 (530 x 380) SHALL BE USED.
5. THESE CONTROLS SHALL SUPPLEMENT MAINLINE TRAFFIC CONTROL FOR LANE CLOSURES.
6. LONGITUDINAL DIMENSIONS MAY BE ADJUSTED TO FIT FIELD CONDITIONS.
7. FORM BT 725 IS REQUIRED.
8. TRAFFIC CONTROL AND PROTECTION AT TURN BAYS (TO REMAIN OPEN TO TRAFFIC) SHALL BE INCLUDED IN THE COST SPECIFIED TRAFFIC CONTROL STANDARDS OR ITEMS.

LEGEND

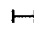
-  WORK AREA
-  LANE OPEN TO TRAFFIC
-  TYPE I OR II BARRICADE WITH STEADY BURN LIGHT
-  DRUM WITH STEADY BURN LIGHT
-  DRUM WITH SIGN (WITH OPTIONAL FLASHING LIGHT) SEE DETAIL
-  TYPE I OR II CHECK BARRICADE WITH FLASHING LIGHT

All dimensions are in inches (millimeters) unless otherwise shown.

FILE NAME =	USER NAME = amj.thkl	DESIGNED -	REVISED -T. RAMMACHER 09-08-94
W:\dist\td\22x34\col4.dgn		DRAWN -	REVISED - A. HOUSEH 11-07-95
		PLOT SCALE = 103.7849' / IN.	REVISED - A. HOUSEH 10-12-96
		PLOT DATE = 3/14/2008	REVISED -T. RAMMACHER 01-06-00

**STATE OF ILLINOIS
DEPARTMENT OF TRANSPORTATION**

TRAFFIC CONTROL AND PROTECTION AT TURN BAYS (TO REMAIN OPEN TO TRAFFIC)			
SCALE: NONE	SHEET NO. 1 OF 1 SHEETS	STA.	TO STA.

F.A. RTE.	SECTION	COUNTY	TOTAL SHEETS	SHEET NO.
VAR	2008-013 PP	KANE	34	33
TC-14			CONTRACT NO. 60E39	
FED. ROAD DIST. NO. 1 ILLINOIS FED. AID PROJECT				

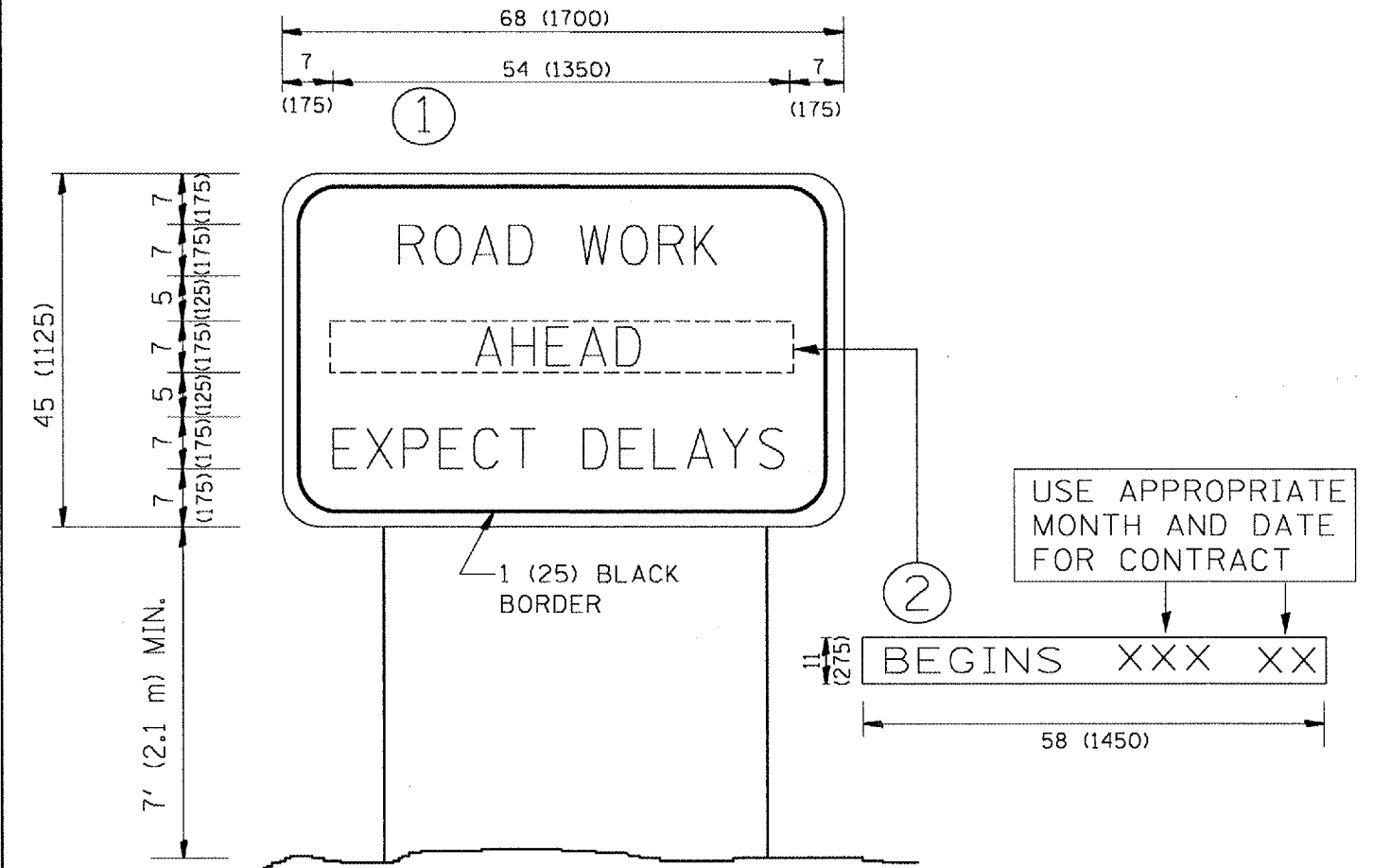

NOTES:

1. USE BLACK LETTERING ON ORANGE BACKGROUND.
2. ERECT SIGNS IN ADVANCE OF THE LOCATION FOR THE "ROAD CONSTRUCTION AHEAD" SIGN AT LOCATIONS AS DIRECTED BY THE ENGINEER.
3. ERECT SIGN ① WITH INSTALLED PANEL ② ONE WEEK PRIOR TO THE START OF CONSTRUCTION.
4. REMOVE PANEL ② SOON AFTER THE START OF CONSTRUCTION.
5. SEE SPECIAL PROVISION FOR "TEMPORARY INFORMATION SIGNING" FOR ADDITIONAL INFORMATION.
6. ONE SIGN ASSEMBLY EQUALS 25.70 SQ. FT. (2.3 SQ. M.)
7. SHALL BE PAID FOR AS TEMPORARY INFORMATION SIGNING.

ALL DIMENSIONS ARE IN INCHES (MILLIMETERS) UNLESS OTHERWISE SHOWN.

FILE NAME = W:\distatd\22x34\to22.dgn	USER NAME = smu.thk1	DESIGNED -	REVISED - R. MIRS 09-15-97	STATE OF ILLINOIS DEPARTMENT OF TRANSPORTATION	ARTERIAL ROAD INFORMATION SIGN		F.A. - RTE.	SECTION	COUNTY	TOTAL SHEETS	SHEET NO.		
	PLOT SCALE = 103.795' / IN.	DRAWN -	REVISED - R. MIRS 12-11-97		SCALE: NONE	SHEET NO. 1 OF 1 SHEETS	STA.	TO STA.	VAR	2008-013PP	KANE	34	34
	PLOT DATE = 3/14/2008	CHECKED -	REVISED - T. RAMMACHER 02-02-99						TC-22				
		DATE -	REVISED - C. JUCIUS 01-31-07						FED. ROAD DIST. NO. 1	ILLINOIS	FED. AID PROJECT		

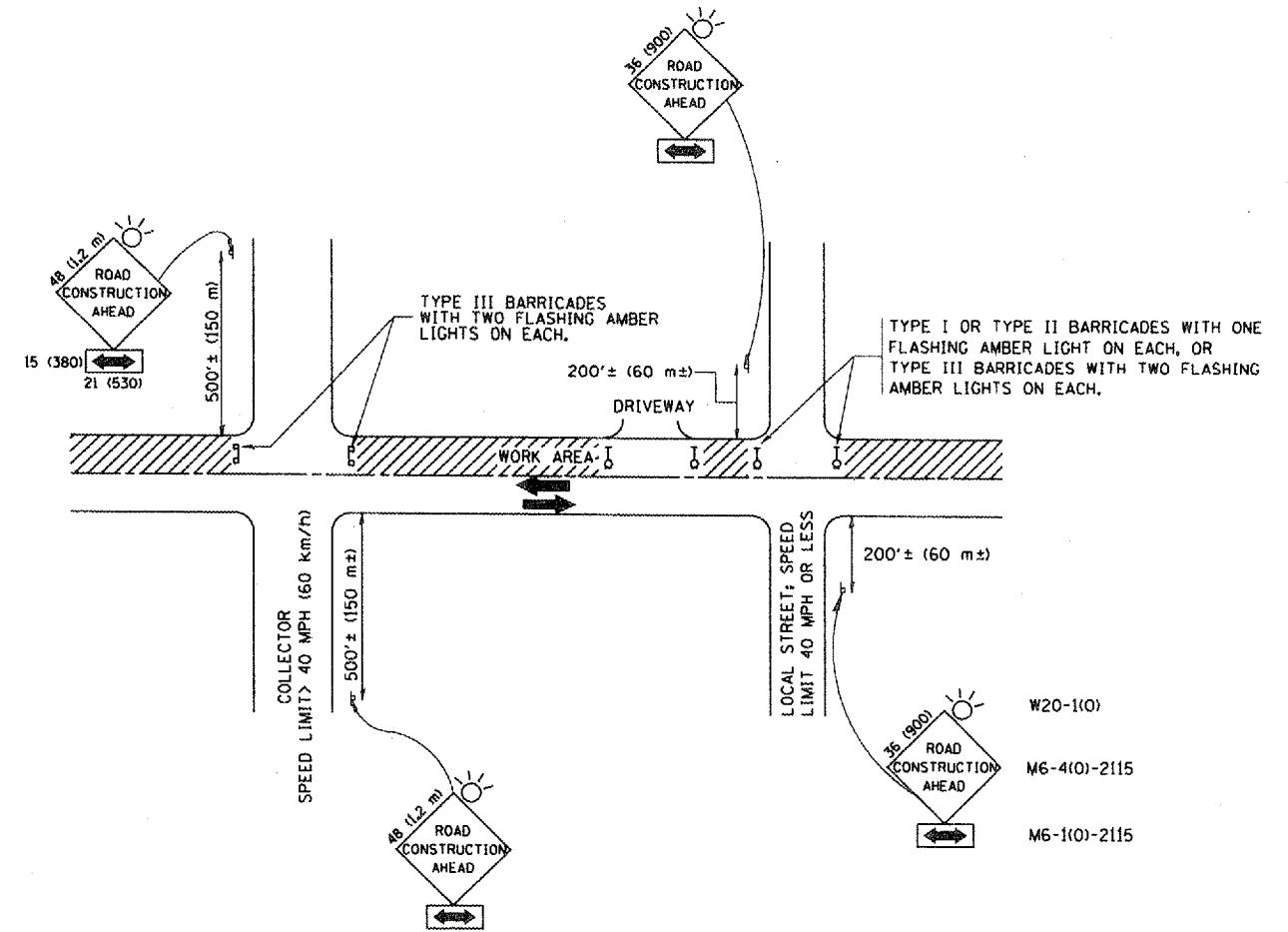

TRAFFIC CONTROL AND PROTECTION FOR SIDE ROADS, INTERSECTIONS, AND DRIVEWAYS

NOTES:

A. FOR NO LANE RESTRICTION ON THE SIDE ROAD OR DRIVEWAYS

1. SIDE ROAD WITH A SPEED LIMIT OF 40 MPH (60 km/h) OR LESS AS SHOWN ON THE DRAWING AND AS DIRECTED BY THE ENGINEER:
 - a) ONE ROAD CONSTRUCTION AHEAD SIGN 36 x 36 (900x900) WITH A FLASHER AND FLAG MOUNTED ON IT APPROXIMATELY 200' (60 m) IN ADVANCE OF THE MAIN ROUTE.
 - b) THE CLOSED PORTION OF THE MAIN ROUTE SHALL BE PROTECTED BY BLOCKING WITH TYPE I, TYPE II OR TYPE III BARRICADES, 1/3 OF THE CROSS SECTION OF THE CLOSED PORTION.
2. SIDE ROAD WITH A SPEED LIMIT GREATER THAN 40 MPH (60 km/h) AS SHOWN ON THE DRAWING AND AS DIRECTED BY THE ENGINEER:
 - a) ONE ROAD CONSTRUCTION AHEAD SIGN 48 x 48 (1.2 m x 1.2 m) WITH A FLASHER MOUNTED ON IT APPROXIMATELY 500' (150 m) IN ADVANCE OF THE MAIN ROUTE.
 - b) THE CLOSED PORTION OF THE MAIN ROUTE SHALL BE PROTECTED BY BLOCKING WITH TYPE III BARRICADES, 1/2 OF THE CROSS SECTION OF THE CLOSED PORTION.
3. WHEN THE SIDE ROAD LIES BETWEEN THE BEGINNING OF THE MAINLINE SIGNING AND THE WORK ZONE, A SINGLE HEADED ARROW (M6-1) SHALL BE USED IN LIEU OF THE DOUBLE HEADED ARROW (M6-4).

B. FOR A LANE CLOSURE ON A SIDE ROAD OR DRIVEWAY:

USE APPLICABLE PORTIONS OF THE TYPICAL APPLICATION OF TRAFFIC CONTROL DEVICES (STD. 701501, STD. 701606 OR THE APPROPRIATE STANDARD). THE SPACING OF SIGNS AND BARRICADES SHALL BE ADJUSTED FOR FIELD CONDITIONS AS DIRECTED BY THE ENGINEER. THE DIRECTIONAL ARROW SHALL BE COVERED OR REMOVED WHEN NO LONGER CONSISTENT WITH THE SIDE ROAD LANE CLOSURE.

C. ADVANCE WARNING SIGNS ARE TO BE OMITTED ON DRIVEWAY UNLESS OTHERWISE NOTED.

D. THE TRAFFIC CONTROL AND PROTECTION FOR SIDE ROADS, INTERSECTIONS, AND DRIVEWAYS SHALL BE INCIDENTAL TO THE COST OF SPECIFIED TRAFFIC CONTROL STANDARDS OR ITEMS.

All dimensions are in millimeters (Inches) unless otherwise shown.

FILE NAME = W:\distrtd\22x34\to18.dgn	USER NAME = geglanoht	DESIGNED - LHA	REVISED - J. OBERLE 10-18-95
		DRAWN -	REVISED - A. HOUSEH 03-06-96
		PLOT SCALE = 50,000 / IN.	REVISED - A. HOUSEH 10-15-96
		PLOT DATE = 1/4/2008	REVISED - T. RAMMACHER 01-06-00

STATE OF ILLINOIS
DEPARTMENT OF TRANSPORTATION

TRAFFIC CONTROL AND PROTECTION FOR
SIDE ROADS, INTERSECTIONS, AND DRIVEWAYS

SCALE: NONE SHEET NO. 1 OF 1 SHEETS STA. TO STA.

F.A. RTE.	SECTION	COUNTY	TOTAL SHEETS	SHEET NO.
VAR 2008-013 PP	KANE	34	34	
TC-10	CONTRACT NO. 60E39			
FED. ROAD DIST. NO. 1 ILLINOIS FED. AID PROJECT				