

F.A.P. RTE.	SECTION	COUNTY	TOTAL SHEETS	SHEET NO.
741	12RS-3	MACON	26	1
		ILLINOIS	CONTRACT NO. 74378	

STATE OF ILLINOIS
DEPARTMENT OF TRANSPORTATION
DIVISION OF HIGHWAYS

**PROPOSED
HIGHWAY PLANS**

FAP ROUTE 741 (IL ROUTE 105)
SECTION 12RS-3
PROJECT: *ESP-0741(094)*
HMA RESURFACING
MACON COUNTY

C-97-063-09

FOR INDEX OF SHEETS, SEE SHEET NO.

ADT 2007 = 9,700

BRIDGE OMISSION
STATION 1102 + 42.96 TO STATION 1106 + 29.38

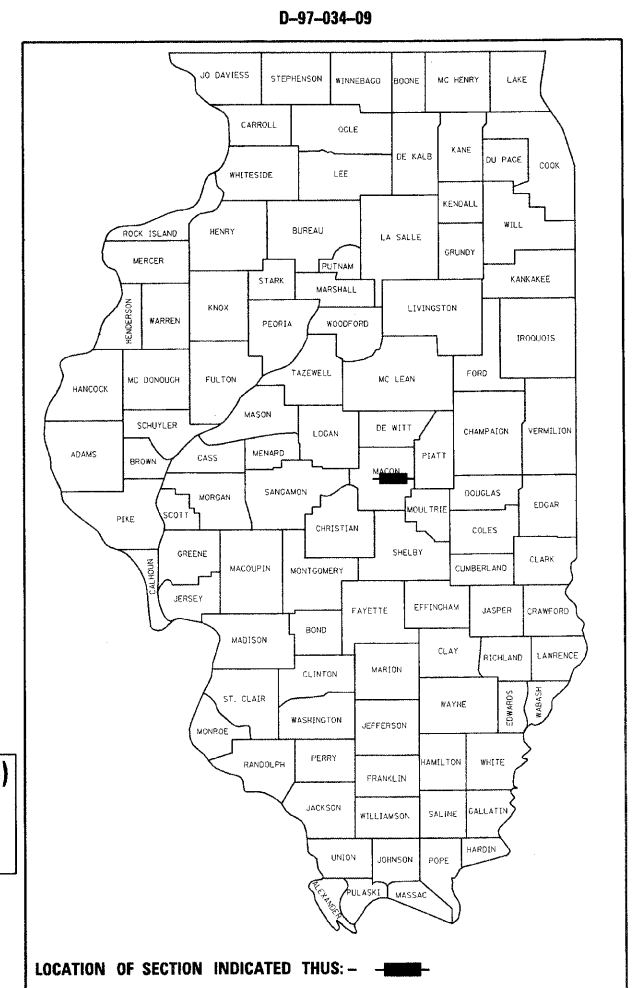

FAP ROUTE 741 (IL 105)
SECTION 12RS-3
PROJECT ENDS
STATION 1167 + 13.39

FAP ROUTE 741 (IL 105)
SECTION 12RS-3
PROJECT BEGINS
STATION 1007 + 00

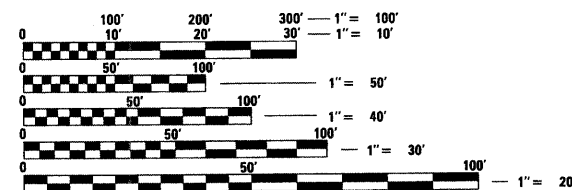

FULL SIZE PLANS HAVE BEEN PREPARED USING STANDARD ENGINEERING SCALES. REDUCED SIZED PLANS WILL NOT CONFORM TO STANDARD SCALES. IN MAKING MEASUREMENTS ON REDUCED PLANS, THE ABOVE SCALES MAY BE USED.

J.U.L.I.E.
JOINT UTILITY LOCATION INFORMATION FOR EXCAVATION
1-800-892-0123
OR 811

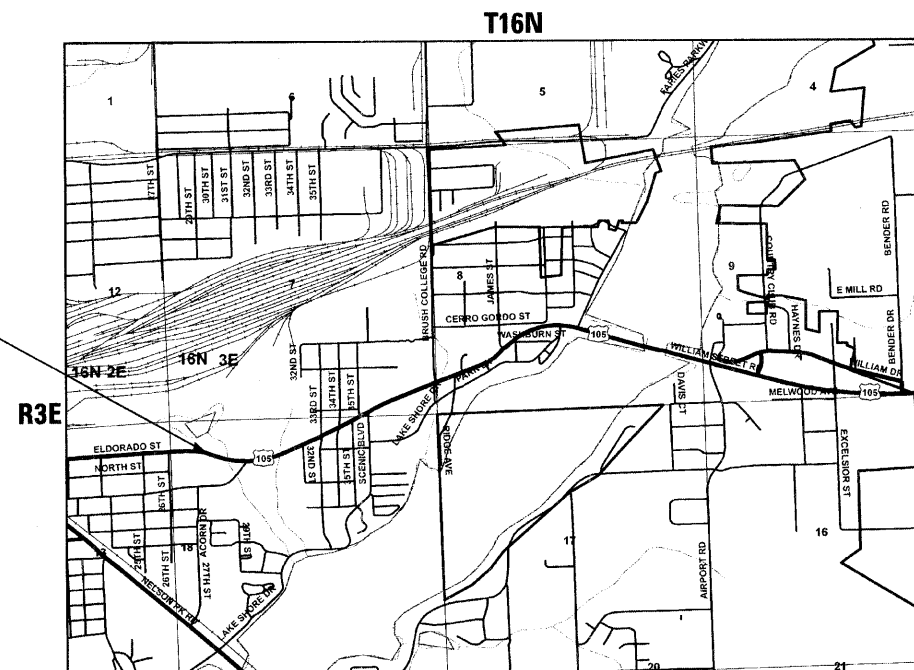

PROJECT ENGINEER: MARK DAUGHERTY
PROJECT MANAGER: MYRA OLTMAN

GROSS LENGTH = 15,723 FT. = 2.98 MILE
NET LENGTH = 15,723 FT. = 2.98 MILE

CONTRACT NO. 74378

STATE OF ILLINOIS
DEPARTMENT OF TRANSPORTATION
DIVISION OF HIGHWAYS

SUBMITTED February 6, 20 09

Roger L. Dinkels
DEPUTY DIRECTOR OF HIGHWAYS, REGION ENGINEER

March 13, 20 09
Charles J. Ingersoll
ENGINEER OF DESIGN AND ENVIRONMENT

March 13, 20 09
Christina M. Reed
DIRECTOR OF HIGHWAYS, CHIEF ENGINEER

**PRINTED BY THE AUTHORITY
OF THE STATE OF ILLINOIS**

INDEX OF SHEETS

SHEET NO	TITLE
1	COVER SHEET
2	INDEX OF SHEETS
3	GENERAL NOTES
4	SUMMARY OF QUANTITIES
5-8	TYPICAL SECTIONS
9	FURNISHING & INSTALLING PROPERTY MARKER SCHEDULE
10	BUTT JOINT DETAILS
11-12	RESURFACING SCHEDULE
13	MISCELLANEOUS SCHEDULES
14	ENTRANCE SCHEDULE & DETAILS
15-20	PLAN SHEETS
21	DETECTOR LOOP DETAIL - COUNTRY CLUB ROAD
22	TYPICAL APPLICATION OF DETECTOR LOOPS
23	CORRUGATED MEDIAN (DOWELLED) DETAIL
24	SURVEY MONUMENT COVER ASSEMBLY
25-26	PAVEMENT MARKING DETAIL

THE FOLLOWING STANDARDS ARE A PART OF THESE PLANS AND ARE INCLUDED AFTER SHEET NO 26.

STD. NO.	DESCRIPTION
000001-05	STANDARD SYMBOLS, ABBREVIATIONS, AND PATTERNS
001001-02	AREAS OF REINFORCEMENT BARS
420701-02	PAVEMENT FABRIC
442201-03	CLASS C AND D PATCHES
701201-03	LANE CLOSURE, 2L, 2W, FOR SPEEDS > 45 MPH
701301-03	LANE CLOSURE, 2L, 2W SHORT TIME OPERATIONS
701311-03	LANE CLOSURE, 2L, 2W MOVING OPERATIONS - DAY ONLY
701426-03	LANE CLOSURE, MULTILANE, INTERMITTENT OR MOVING OPERATIONS FOR SPEEDS OF > 45 MPH
701601-06	URBAN LANE CLOSURE, MULTILANE, 1W OR 2W WITH NON-TRAVERSABLE MEDIAN
701606-06	URBAN LANE CLOSURE, 2W WITH MOUNTABLE MEDIAN
701701-06	URBAN LANE CLOSURE MULTILANE INTERSECTION
701801-04	LANE CLOSURE MULTILANE 1 W OR 2 WAY CROSSWALK OR SIDE CLOSURE
701901-01	TRAFFIC CONTROL DEVICES
780001-02	TYPICAL PAVEMENT MARKINGS
781001-03	TYPICAL APPLICATIONS RAISED REFLECTIVE PAVEMENT MARKERS
886001-01	DETECTOR LOOP INSTALLATIONS
886006-01	TYPICAL LAYOUT FOR DETECTION LOOPS

GENERAL NOTES

THIS SECTION SHALL BE CONSTRUCTED IN ACCORDANCE WITH THE PLANS; THE "STANDARD SPECIFICATIONS FOR ROAD AND BRIDGE CONSTRUCTION", ADOPTED JANUARY 1, 2007; THE "SUPPLEMENTAL SPECIFICATIONS AND RECURRING SPECIAL PROVISIONS" INDICATED ON THE CHECK SHEET, AND "THE SPECIAL PROVISIONS" INCLUDED IN THE PROPOSAL.

THIS PROJECT IS LOCATED ON ILLINOIS ROUTE 105 IN MACON COUNTY BEGINNING EAST OF 26TH STREET AND EXTENDING FOR 3.0 MILES TO EAST OF BENDER ROAD. THE WORK INCLUDED IN SECTION 12RS-3 CONSISTS OF PAVEMENT PATCHING, HOT-MIX ASPHALT RESURFACING, DETECTOR LOOPS, MEDIAN REMOVAL, CORRUGATED MEDIAN REMOVAL, CORRUGATED MEDIAN REPLACEMENT, PAVEMENT MARKING, AND ANY OTHER WORK NECESSARY TO COMPLETE THE SECTION. THERE IS A BRIDGE OMISSION FROM STATION 1102+42.96 TO STATION 1106+29.38.

THE EXISTING PAVEMENT SHALL BE PATCHED IN ACCORDANCE WITH SECTION 442 OF THE STANDARD SPECIFICATIONS AND THE SPECIAL PROVISIONS. THE QUANTITY OF PATCHING SHOWN ON THE PLANS IS AN ESTIMATE ONLY. THE FINAL LOCATIONS AND QUANTITY SHALL BE DETERMINED BY THE ENGINEER IN THE FIELD.

THE MATERIAL USED FOR AGGREGATE SHOULDERS, TYPE B AND AGGREGATE SURFACE COURSE, TYPE B SHALL BE CRUSHED STONE, OR CRUSHED CONCRETE.

PAVEMENT MARKING SHALL BE APPLIED IN ACCORDANCE WITH SECTION 780 OF THE STANDARD SPECIFICATIONS. SHORT TERM PAVEMENT MARKING SHALL BE APPLIED TO THE MILLED SURFACE, BITUMINOUS MATERIALS (PRIME COAT), HOT-MIX ASPHALT LEVELING BINDER, AND HOT-MIX ASPHALT SURFACE COURSE AS SPECIFIED IN SECTION 703 OF THE STANDARD SPECIFICATIONS. TEMPORARY TAPE SHALL BE USED ON THE SURFACE COURSE AND PAINT SHALL BE USED ON MILLED SURFACES.

THE TOTAL QUANTITY OF THERMOPLASTIC PAVEMENT MARKING - LINE 4" CONSISTS OF 35465 FEET OF YELLOW AND 6186 FEET OF WHITE.

THE TOTAL QUANTITY OF THERMOPLASTIC PAVEMENT MARKING - LINE 6" CONSISTS OF 11417 FEET OF WHITE.

THE TOTAL QUANTITY OF THERMOPLASTIC PAVEMENT MARKING - LINE 12" CONSISTS OF 866 FEET OF YELLOW AND 250 FEET OF WHITE.

THE TOTAL QUANTITY OF THERMOPLASTIC PAVEMENT MARKING - LINE 24" CONSISTS OF 316 FEET OF WHITE

THE TOTAL QUANTITY OF THERMOPLASTIC PAVEMENT MARKING - LETTERS AND SYMBOLS CONSISTS OF 328 SQUARE FEET OF WHITE.

THE TOTAL QUANTITY OF RAISED REFLECTIVE PAVEMENT MARKERS IS 476 ONE-WAY CRYSTAL AND 159 TWO-WAY AMBER.

THE CONTRACTOR SHALL USE EITHER RC-70 OR AN EMULSIFIED POLYMER PRIME SS-1HP FOR THE PAY ITEM BITUMINOUS MATERIALS (PRIME COAT).

THE CONTRACTOR SHALL PROVIDE INTERNET ACCESSIBILITY TO THE HOT-MIX ASPHALT PLANT QUALITY CONTROL LAB SO THAT HOT-MIX ASPHALT PLANT REPORTS CAN BE E-MAILED TO THE DISTRICT HEADQUARTERS. THIS WORK SHALL BE INCLUDED IN THE COST OF ALL HOT-MIX ASPHALT ITEMS.

THE PAY ITEM TEMPORARY RAMP HAS BEEN INCLUDED FOR THE CONSTRUCTION OF TEMPORARY RAMPS IN ACCORDANCE WITH ARTICLE 406.08 OF THE STANDARD SPECIFICATIONS. THE COST SHALL INCLUDE BOTH THE INSTALLATION AND THE REMOVAL OF THE TEMPORARY RAMPS.

TEMPORARY HMA TAPERS WILL BE REQUIRED AT THE MANHOLES AND VALVE VAULTS WHICH ARE TO BE ADJUSTED. THIS WORK SHALL INCLUDE BOTH THE INSTALLATION AND THE REMOVAL OF THE TEMPORARY HMA TAPERS. THIS WORK WILL BE CONSIDERED INCLUDED IN THE COST OF THE INCIDENTAL SURFACING AND NO EXTRA COMPENSATION WILL BE ALLOWED.

A UNIFORMLY STRAIGHT SAW CUT SHALL BE MADE AT LOCATIONS WHERE PROPOSED NEW CONSTRUCTION WILL ABUT EXISTING HOT-MIX ASPHALT SURFACES. THE SAW CUT SHALL BE MADE THE SAME DEPTH AS THE HOT-MIX ASPHALT SURFACE REMOVAL. THIS WORK WILL BE CONSIDERED INCLUDED IN THE COST OF THE CONTRACT ITEMS INVOLVED AND NO EXTRA COMPENSATION WILL BE ALLOWED.

THE RESIDENT ENGINEER SHALL BE THE SOLE JUDGE CONCERNING THE CURING TIME FOR THE HOT-MIX ASPHALT LEVELING BINDER AND SURFACE COURSE.

THE FOLLOWING MIXTURE REQUIREMENTS ARE APPLICABLE TO THIS PROJECT:

SURFACE MIX (1 1/2")

APPLICATION: POLYMERIZED HOT-MIX ASPHALT SURFACE COURSE, MIX "D" N90
 PG GRADE: SBS PG 70-22
 DESIGN AIR VOIDS: 4.0% @ NDESIGN = 90
 MIXTURE COMPOSITION: IL-9.5
 FRICTION AGGREGATE: MIXTURE D

LEVEL BINDER (1")

APPLICATION: LEVELING BINDER (MACHINE METHOD) N90
 PG GRADE: PG 64-22
 DESIGN AIR VOIDS: 4.0% @ NDESIGN = 90
 MIXTURE COMPOSITION: IL- 9.5
 FRICTION AGGREGATE: N/A

BITUMINOUS SHOULDERS (2 1/2")

APPLICATION: HOT-MIX BITUMINOUS SHOULDERS
 PG GRADE: PG 58-22
 DESIGN AIR VOIDS: 4.0% @ NDESIGN = 30
 MIXTURE COMPOSITION: IL- 19.0L
 FRICTION AGGREGATE: N/A

CLASS D PATCHING (10")

APPLICATION: HOT-MIX ASPHALT BINDER COURSE, IL-19.0, N70
 PG GRADE: PG 64-22
 DESIGN AIR VOIDS: 4.0% @ NDESIGN = 70
 MIXTURE COMPOSITION: IL- 19.0
 FRICTION AGGREGATE: N/A

INCIDENTAL HMA SURFACING

APPLICATION: HOT-MIX ASPHALT SURFACE COURSE, MIX "C" N70
 PG GRADE: PG 64-22
 DESIGN AIR VOIDS: 4.0% @ NDESIGN = 70
 MIXTURE COMPOSITION: IL- 9.5
 FRICTION AGGREGATE: MIXTURE C

PARTIAL DEPTH PATCHING (2")

APPLICATION: HOT-MIX ASPHALT SURFACE COURSE, MIX "C", N90
 PG GRADE: PG 64-22
 DESIGN AIR VOIDS: 4.0% @ NDESIGN = 90
 MIXTURE COMPOSITION: IL- 9.5
 FRICTION AGGREGATE: N/A

HMA BASE COURSE WIDENING (10")

APPLICATION: HOT-MIX ASPHALT BINDER COURSE, IL-19.0, N70
 PG GRADE: PG 64-22
 DESIGN AIR VOIDS: 4.0% @ NDESIGN = 70
 MIXTURE COMPOSITION: IL- 19.0
 FRICTION AGGREGATE: N/A

THE FOLLOWING RATES OF APPLICATION HAVE BEEN USED IN CALCULATING PLAN QUANTITIES:

BITUMINOUS MATERIALS (PRIME COAT)	0.10 GAL/SQ YD
AGGREGATE (PRIME COAT)	4 LBS/SQ YD
HOT-MIX ASPHALT	112 LBS/SQ YD/INCH
AGGREGATE SHOULDERS	2.05 TONS/CL. YD.

DETECTOR LOOP GENERAL NOTES

THE SIZE OF THE CABLE SUPPLIED SHALL BE EQUAL TO OR GREATER THAN THE SIZE OF THE CABLE REQUIRED TO CARRY THE LOAD BETWEEN THE CONTROLLER AND THE SERVICE INSTALLATION.

ALL HARDWARE SHALL BE TIGHTENED AND WELL SECURED. CABLES SHALL BE NEATLY WOUND IN HANDHOLES. CABLES SHALL BE NEATLY TRAINED IN THE CONTROLLER CABINET.

NO ADDITIONAL COMPENSATION WILL BE ALLOWED FOR PLACING CONDUIT AT GREATER THAN 2 FOOT MINIMUM DEPTH TO AVOID OBSTACLES SUCH AS UNDERGROUND UTILITIES.

THE CONTRACTOR IS RESPONSIBLE FOR UNCOVERING OR HAND DIGGING AROUND UTILITIES AS NECESSARY. THE COST OF THIS WORK IS TO BE INCLUDED WITH THE TRENCH AND BACKFILL FOR ELECTRICAL WORK PAY ITEM.

THE NUMBER OF CONDUCTORS FOR ELECTRIC CABLES AS SHOWN ON THE PLANS SHALL BE THE MINIMUM NUMBER OF CONDUCTORS FURNISHED FOR EACH LOCATION. THE CONTRACTOR MAY SUBSTITUTE AN ELECTRIC CABLE WITH MORE CONDUCTORS THAN SPECIFIED BUT NO ADDITIONAL COMPENSATION WILL BE MADE FOR THE EXTRA CONDUCTORS.

ALL NEW LEAD-IN WIRING SHALL EXTEND FROM CONTROLLER TO THE LOOP WIRE. SPLICES IN HANDHOLES WILL NOT BE ALLOWED.

FILE NAME =	USER NAME = teasleyk	DESIGNED -	REVISED -	STATE OF ILLINOIS DEPARTMENT OF TRANSPORTATION	GENERAL NOTES				F.A. RTE.	SECTION	COUNTY	TOTAL SHEETS	SHEET NO.
ca:\pwork\PWIDOT\TEASLEYK\40123454\0	74378-shr-cover.dgn	DRAWN -	REVISED -		SCALE:	SHEET NO.	OF	SHEETS	STA.	TO STA.	ILLINOIS FED. AID PROJECT	26	3
	PLOT SCALE = 50.0000' / IN.	CHECKED -	REVISED -		CONTRACT NO.								
	PLOT DATE = 2/6/2009	DATE -	REVISED -										

SUMMARY OF QUANTITIES

SUMMARY OF QUANTITIES			URBAN 100% FED.	CONSTRUCTION TYPE CODE			SUMMARY OF QUANTITIES			URBAN 100% FED.	CONSTRUCTION TYPE CODE		
CODE NO	ITEM	UNIT	TOTAL QUANTITIES	1000			CODE NO	ITEM	UNIT	TOTAL QUANTITIES	1000		
35600716	HOT-MIX ASPHALT BASE COURSE WIDENING, 10"	SQ YD	14	14			70300210	TEMPORARY PAVEMENT MARKING - LETTERS AND SYMBOLS	SQ FT	328	328		
40200800	AGGREGATE SURFACE COURSE, TYPE B	TON	16.4	16.4			70300220	TEMPORARY PAVEMENT MARKING - LINE 4"	FOOT	41651	41651		
40600100	BITUMINOUS MATERIALS (PRIME COAT)	GALLON	10951	10951			70300240	TEMPORARY PAVEMENT MARKING - LINE 6"	FOOT	11417	11417		
40600300	AGGREGATE (PRIME COAT)	TON	219	219			70300260	TEMPORARY PAVEMENT MARKING - LINE 12"	FOOT	1116	1116		
40600645	LEVELING BINDER (MACHINE METHOD), N90	TON	5920	5920			70300280	TEMPORARY PAVEMENT MARKING - LINE 24"	FOOT	316	316		
40600982	HOT-MIX ASPHALT SURFACE REMOVAL - BUTT JOINT	SQ YD	213	213			70301000	WORK ZONE PAVEMENT MARKING REMOVAL	SQ FT	3072	3072		
40600985	PORTLAND CEMENT CONCRETE SURFACE REMOVAL - BUTT JOINT	SQ YD	53	53			*78000100	THERMOPLASTIC PAVEMENT MARKING - LETTERS AND SYMBOLS	SQ FT	328	328		
40600990	TEMPORARY RAMP	SQ YD	181.5	181.5			*78000200	THERMOPLASTIC PAVEMENT MARKING - LINE 4"	FOOT	41651	41651		
40600995	TEMPORARY RAMP, SPECIAL	SQ YD	1253	1253			*78000400	THERMOPLASTIC PAVEMENT MARKING - LINE 6"	FOOT	11417	11417		
40603545	POLYMERIZED HOT-MIX ASPHALT SURFACE COURSE, MIX "D", N90	TON	8881	8881			*78000600	THERMOPLASTIC PAVEMENT MARKING - LINE 12"	FOOT	1116	1116		
40800050	INCIDENTAL HOT-MIX ASPHALT SURFACING	TON	503.5	503.5			*78000650	THERMOPLASTIC PAVEMENT MARKING - LINE 24"	FOOT	316	316		
44000155	HOT-MIX ASPHALT SURFACE REMOVAL, 1 1/2"	SQ YD	831	831			*78100100	RAISED REFLECTIVE PAVEMENT MARKER	EACH	634	634		
44000500	COMBINATION CURB AND GUTTER REMOVAL	FOOT	46	46			78300200	RAISED REFLECTIVE PAVEMENT MARKER REMOVAL	EACH	476	476		
44003800	MEDIAN SURFACE REMOVAL	SQ FT	59	59			*87301305	ELECTRIC CABLE IN CONDUIT, LEAD-IN, NO. 14 1 PAIR	FOOT	4275	4275		
44201761	CLASS D PATCHES, TYPE I, 10 INCH	SQ YD	21	21			*88500100	INDUCTIVE LOOP DETECTOR	EACH	20	20		
44201765	CLASS D PATCHES, TYPE II, 10 INCH	SQ YD	1709	1709			*88600100	DETECTOR LOOP, TYPE I	FOOT	1509	1509		
44201769	CLASS D PATCHES, TYPE III, 10 INCH	SQ YD	16	16			*89502300	REMOVE ELECTRIC CABLE FROM CONDUIT	FOOT	3781	3781		
44213100	PAVEMENT FABRIC	SQ YD	416	416			X0321020	PORTLAND CEMENT CONCRETE SURFACE REMOVAL (COLD MILLING) VARIABLE DEPTH	SQ YD	2261	2261		
48101200	AGGREGATE SHOULDERS, TYPE B	TON	31	31			X4421000	PARTIAL DEPTH PATCHING	TON	198	198		
48203100	HOT-MIX ASPHALT SHOULDERS	TON	530	530			X4422025	PARTIAL DEPTH REMOVAL 2"	SQ YD	1768	1768		
60255500	MANHOLES TO BE ADJUSTED	EACH	19	19			Z0025500	FURNISHING AND INSTALLING PROPERTY MARKERS	EACH	15	15		
60265700	VALVE VAULTS TO BE ADJUSTED	EACH	13	13			Z0070100	SURVEY MONUMENT COVER ASSEMBLY	EACH	15	15		
60624610	CORRUGATED MEDIAN (DOWELLED)	SQ FT	3740	3740									
67000500	ENGINEER'S FIELD OFFICE, TYPE B	CAL MO	4	4									
67100100	MOBILIZATION	L SUM	1	1									
70100450	TRAFFIC CONTROL AND PROTECTION, STANDARD 701201	L SUM	1	1									
70102625	TRAFFIC CONTROL AND PROTECTION, STANDARD 701606	L SUM	1	1									
70102635	TRAFFIC CONTROL AND PROTECTION, STANDARD 701701	L SUM	1	1									
70102640	TRAFFIC CONTROL AND PROTECTION, STANDARD 701801	L SUM	1	1									
70300100	SHORT-TERM PAVEMENT MARKING	FOOT	27649	27649									

* SPECIALTY ITEMS

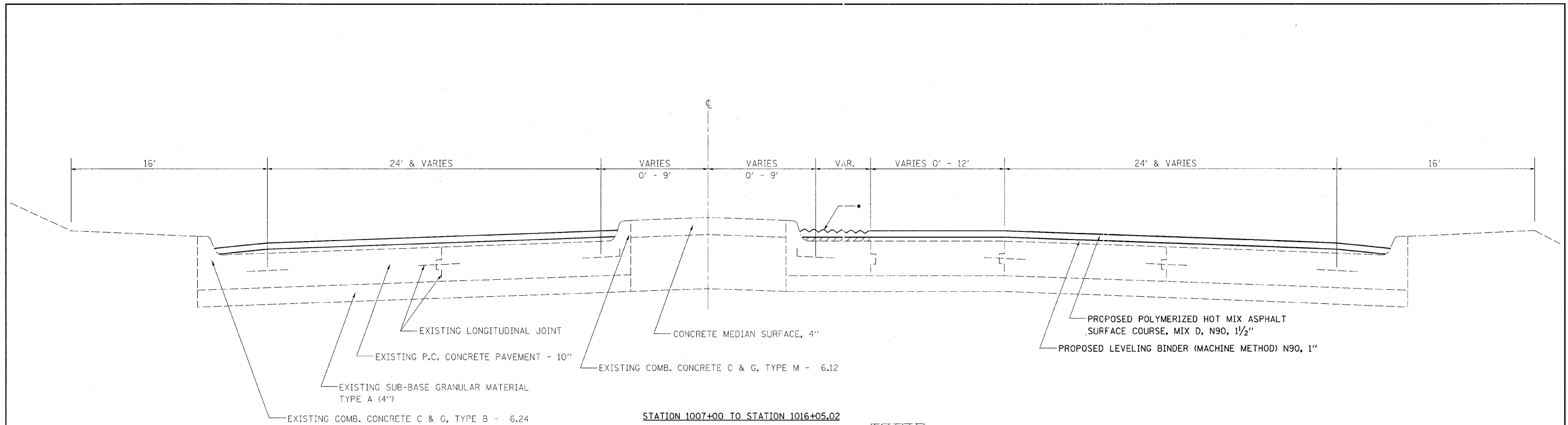

STATION 1007+00 TO STATION 1016+05.02

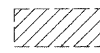
 PCC SURFACE REMOVAL
 (COLD MILLING) VARIABLE DEPTH

• SEE STANDARD DETAIL NO. 60624610 FOR DETAIL
 OF PROPOSED CORRUGATED MEDIAN
 STATION 1008+09.79 TO STATION 1009+64

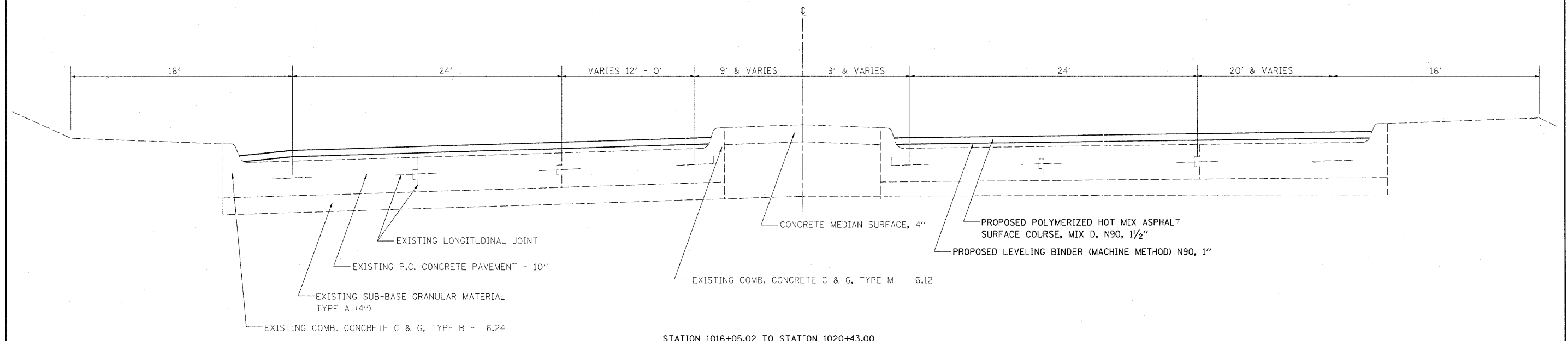

STATION 1016+05.02 TO STATION 1020+43.00

FILE NAME =	USER NAME = teasleyck	DESIGNED -	REVISED -	STATE OF ILLINOIS DEPARTMENT OF TRANSPORTATION	TYPICAL SECTION			F.A.P. RTE.	SECTION	COUNTY	TOTAL SHEETS	SHEET NO.
et:\pw_work\PW\DDT\TEASLEYCK\0123454\74378-shr-typical.dgn		DRAWN -	REVISED -		741	12RS-3	Macon	26	5			
PLOT SCALE = 5/8" = 1' / IN.		CHECKED -	REVISED -					CONTRACT NO. 74378				
PLOT DATE = 2/6/2009		DATE -	REVISED -		SCALE:	SHEET NO. OF SHEETS	STA. TO STA.	ILLINOIS FED. AID PROJECT				

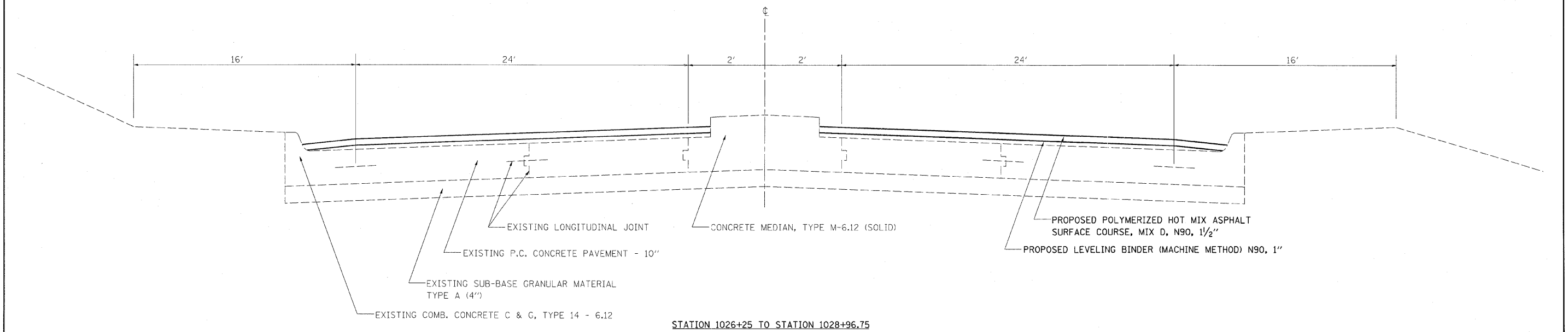
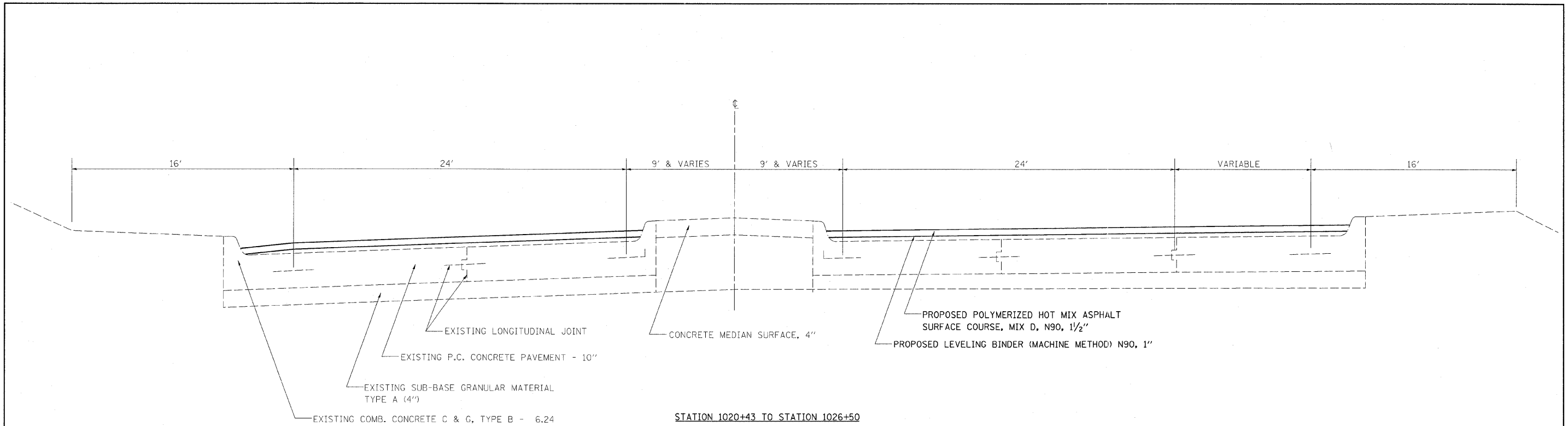

FILE NAME =	USER NAME = teasleyck	DESIGNED -	REVISED -	STATE OF ILLINOIS DEPARTMENT OF TRANSPORTATION	TYPICAL SECTION			F.A.P. RTE.	SECTION	COUNTY	TOTAL SHEETS	SHEET NO.
ca:\pvt\work\PW100T\TEASLEYCK\d0123454\d	74378-shr-typicals.dgn	DRAWN -	REVISED -		SCALE:	SHEET NO. OF SHEETS	STA. TO STA.	741	12RS-3	Macon	26	6
	PLOT SCALE = 50.0000' / IN.	CHECKED -	REVISED -									
	PLOT DATE = 2/6/2009	DATE -	REVISED -									
ILLINOIS FED. AID PROJECT											CONTRACT NO. 74378	

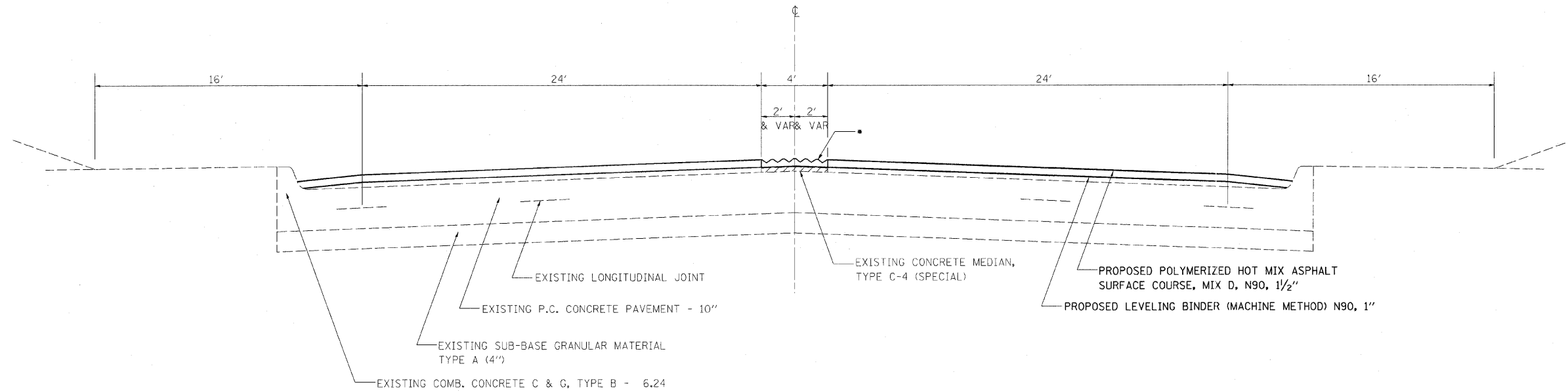

STATION 1028+96.75 TO STATION 1050+93.00
 STATION 1058+82.27 TO STATION 1074+71.82

PCC SURFACE REMOVAL
 (COLD MILLING) VARIABLE DEPTH

• SEE STANDARD DETAIL NO. 60624610 FOR DETAIL
 OF PROPOSED CORRUGATED MEDIAN
 STATION 1072+16 TO STATION 1074+73

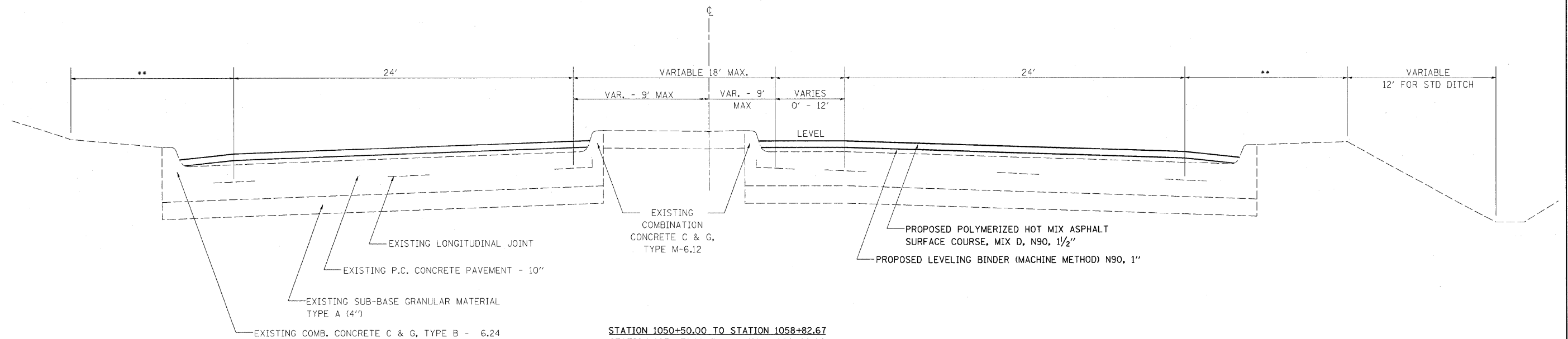

STATION 1050+50.00 TO STATION 1058+82.67
 STATION 1074+71.82 TO STATION 1086+00.00

FILE NAME =	USER NAME = teasleyck	DESIGNED -	REVISED -	STATE OF ILLINOIS DEPARTMENT OF TRANSPORTATION	TYPICAL SECTION			F.A.P. RTE.	SECTION	COUNTY	TOTAL SHEETS	SHEET NO.			
ca:\pv_work\PW\DOT\TEASLEYCK\0123454\074378-shr-typicals.dgn		DRAWN -	REVISED -		SCALE:	SHEET NO.	OF	SHEETS	STA.	TO STA.	741	12RS-3	Macon	26	7
		CHECKED -	REVISED -												
		DATE -	REVISED -												
													CONTRACT NO. 74378		
											ILLINOIS FED. AID PROJECT				

FURNISHING & INSTALLING PROPERTY MARKERS SURVEY MONUMENT COVER ASSEMBLY			
STATION	OFFSET	DESCRIPTION	
1009+20.17	0'	P. T. FOUND BRASS IDOT DISK IN PCC CORRUGATED MEDIAN	1
1010+60.25	0'	P. C. FOUND BRASS IDOT DISK IN RAISED CONCRETE MEDIAN	1
1023+59.68	0'	P. T. DISK APPEARS TO BE GONE -NEAR BROKEN UP MEDIAN AND INLET AREA	1
1031+44.58	0'	P. C. FOUND BRASS IDOT DISK FLUSH WITH PCC PAVEMENT	1
1037+31.54	0'	P. T. FOUND BRASS IDOT DISK IN PCC CORRUGATED MEDIAN	1
1043+10.89	0'	P. C. FOUND BRASS IDOT DISK IN PCC CORRUGATED MEDIAN	1
1047+99.82	0'	P. T. FOUND BRASS IDOT DISK IN PCC CORRUGATED MEDIAN	1
1056+12.49	0'	FOUND I. P. WITH YELLOW CAP - FLUSH @ INTERSECTION 105 & BRUSH COLLEGE ROAD	1
1065+20.11	0'	P. C. FOUND BRASS IDOT DISK IN PCC CORRUGATED MEDIAN	1
1070+91.20	0'	P. T. FOUND BRASS IDOT DISK IN PCC CORRUGATED MEDIAN	1
1072+86.60	0'	P. C. FOUND BRASS IDOT DISK IN PCC CORRUGATED MEDIAN	1
1087+61.47	0'	P. T. FOUND BRASS IDOT DISK IN PCC PAVEMENT TURN LANE	1
1127+86.37	0'	P. C. FOUND BRASS IDOT DISK IN PCC CORRUGATED MEDIAN	1
1151+46.45	0'	P. T. FOUND BRASS IDOT DISK IN PCC PAVEMENT TURN LANE	1
TOTAL			15

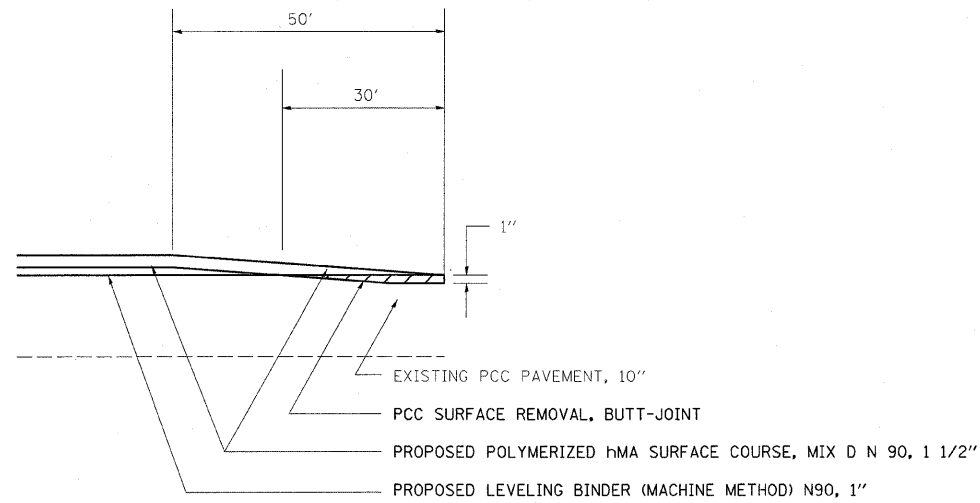

BUTT JOINT DETAIL AT APPROACH TURN LANE WILLIAMS STREET
STATION 1017+00 TO STATION 1017+50

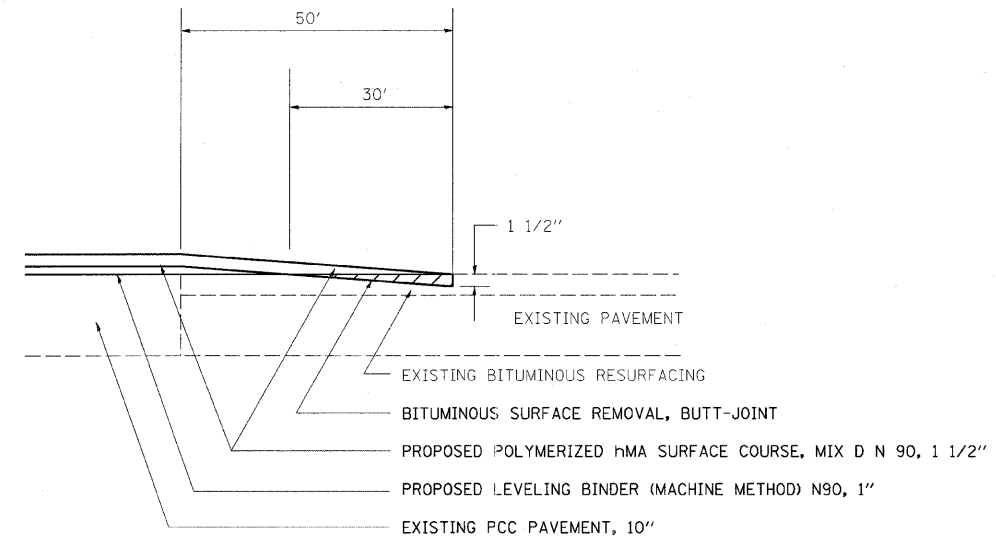

BUTT JOINT DETAIL
STATION 1006+50 TO STATION 1007+00
STATION 1067+33.39 TO STATION 1067+63.39

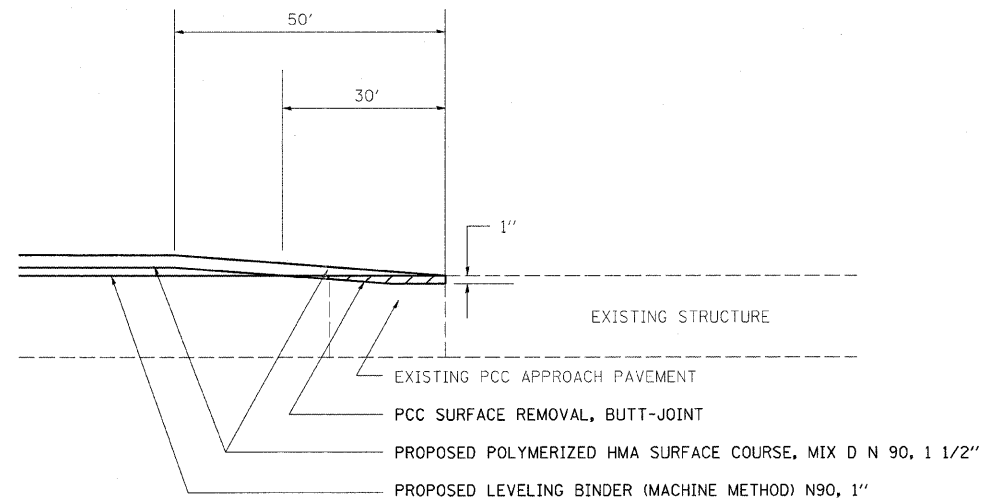

BUTT JOINT DETAIL
WESTBOUND STRUCTURE 058-0048
STATION 1102+12.96 TO STATION 1102+42.96
STATION 1106+29.38 TO STATION 1106+59.38

FILE NAME =	USER NAME = teasleyck	DESIGNED -	REVISED -	STATE OF ILLINOIS DEPARTMENT OF TRANSPORTATION	BUTT JOINT DETAIL				F.A.P. RTE.	SECTION	COUNTY	TOTAL SHEETS	SHEET NO.
ct:\pw_work\PWIDOT\TEASLEYCK\0123454.D	74378-sht-detail.dgn	DRAWN -	REVISED -		741	12RS-3	Macon	26	18				
	PLOT SCALE = 50,0000' / IN.	CHECKED -	REVISED -						CONTRACT NO. 74378				
	PLOT DATE = 2/6/2009	DATE -	REVISED -		SCALE:	SHEET NO. OF SHEETS	STA. TO STA.	ILLINOIS FED. AID PROJECT					

RESURFACING SCHEDULE

STATION TO STATION	LENGTH FEET	PAVEMENT WIDTH FEET	AREA SQ YD	BITUMINOUS MATERIALS (PRIME COAT) GALLON	AGGREGATE (PRIME COAT) TON	LEVELING BINDER (MACNINE METHOD), N90 TON	POLYMERIZED HOT-MIX ASPHALT SURFACE COURSE, MIX "D", N90 TON	TEMPORARY RAMP SQ YD	HOT-MIX ASPHALT SHOULDERS TON	AGGREGATE SHOULDERS, TYPE B TON	HOT-MIX ASPHALT SURFACE REMOVAL, 1 1/2" SQ YD
1007+00.00 TO 1008+09.79	109.79	45.75	558	56	1.10	31.3	46.9	60.5			
1008+09.79 TO 1009+20.00	110.21	49.75	609	61	1.20	34.1	51.2				
1009+20.00 TO 1010+60.25	140.25	52.00	810	81	1.60	45.4	68.1				
1010+60.25 TO 1012+35.25	175.00	62.25	1210	121	2.40	67.8	101.7				
1012+35.25 TO 1014+10.43	175.18	69.00	1343	134	2.70	75.2	112.8				
1014+10.43 TO 1014+48.62	38.19	62.25	264	26	0.50	14.8	22.2				
1014+48.62 TO 1015+28.09	79.47	54.00	477	48	1.00	26.7	40.1				
1015+28.09 TO 1015+59.59	31.50	72.00	252	25	0.50	14.1	21.2				
1015+59.59 TO 1016+29.00	69.41	66.00	509	51	1.00	28.5	42.8				
1016+29.00 TO 1017+50.00	121.00	82.00	1102	110	2.20	61.7	92.6				
1017+50.00 TO 1018+43.00	93.00	82.00	847	85	1.70	47.5	71.2				
1018+43.00 TO 1020+43.00	200.00	70.00	1556	156	3.10	87.1	130.7				
1020+43.00 TO 1022+00.00	157.00	69.00	1204	120	2.40	67.4	101.1				
1022+00.00 TO 1023+59.00	159.00	67.00	1184	118	2.40	66.3	99.4				
1023+59.00 TO 1026+87.00	328.00	54.00	1968	197	3.90	110.2	165.3				
1026+87.00 TO 1027+64.00	77.00	58.00	496	50	1.00	27.8	41.7				
1027+64.00 TO 1028+94.75	130.75	54.00	785	79	1.60	43.9	65.9				
1028+94.75 TO 1030+86.00	191.25	58.00	1233	123	2.50	69.0	103.5				
1030+86.00 TO 1032+05.00	119.00	58.00	767	77	1.50	42.9	64.4				
1032+05.00 TO 1034+36.00	231.00	58.00	1489	149	3.00	83.4	125.0				
1034+36.00 TO 1035+98.84	162.84	58.00	1049	105	2.10	58.8	88.2				
1035+98.84 TO 1037+66.26	167.42	58.00	1079	108	2.20	60.4	90.6				
1037+66.26 TO 1038+59.69	93.43	58.00	602	60	1.20	33.7	50.6	60.5			
1038+59.69 TO 1039+47.11	87.42	58.00	563	56	1.10	31.5	47.3				
1039+47.11 TO 1040+38.74	91.63	58.00	591	59	1.20	33.1	49.6				
1040+38.74 TO 1041+20.64	81.90	58.00	528	53	1.10	29.6	44.3				
1041+20.64 TO 1042+13.17	92.53	58.00	596	60	1.20	33.4	50.1				
1042+13.17 TO 1046+00.00	386.83	58.00	2493	249	5.00	139.6	209.4	60.5			
1046+00.00 TO 1048+93.00	293.00	58.00	1888	189	3.80	105.7	158.6				
1048+93.00 TO 1052+00.00	307.00	68.00	2320	232	4.60	129.9	194.8				
1052+00.00 TO 1052+59.40	59.40	68.00	449	45	0.90	25.1	37.7				
1052+59.40 TO 1055+62.67	303.27	68.00	2291	229	4.60	128.3	192.5				
1055+62.67 TO 1056+63.31	100.64	80.00	895	90	1.80	50.1	75.1				
1056+63.31 TO 1060+82.00	418.69	68.00	3163	316	6.30	177.2	265.7				
1060+82.00 TO 1064+00.00	318.00	58.00	2049	205	4.10	114.8	172.1				
1064+00.00 TO 1066+72.00	272.00	58.00	1753	175	3.50	98.2	147.2				
1066+72.00 TO 1067+48.00	76.00	58.00	490	49	1.00	27.4	41.1				
1067+48.00 TO 1070+00.00	252.00	58.00	1624	162	3.20	90.9	136.4				

FILE NAME =
c:\pwwork\pwwid01\TEASLEYCK\0123454.D

USER NAME = teasleyck
74378-shr-schedule.dgn
PLOT SCALE = 50.0000' / IN.
PLOT DATE = 2/6/2009

DESIGNED -
DRAWN -
CHECKED -
DATE -

REVISED -
REVISED -
REVISED -
REVISED -

STATE OF ILLINOIS
DEPARTMENT OF TRANSPORTATION

RESURFACING SCHEDULE

SCALE: SHEET NO. OF SHEETS STA. TO STA.

F.A.P. RTE. 741	SECTION 12RS-3	COUNTY Macon	TOTAL SHEETS 26	SHEET NO. 11
CONTRACT NO. 74378			ILLINOIS FED. AID PROJECT	

RESURFACING SCHEDULE

STATION TO STATION	LENGTH	PAVEMENT WIDTH	AREA	BITUMINOUS MATERIALS (PRIME COAT)	AGGREGATE (PRIME COAT)	LEVELING BINDER (MACHINE METHOD), N90	POLYMERIZED HOT-MIX ASPHALT SURFACE COURSE, MIX "D", N90	TEMPORARY RAMP	HOT-MIX ASPHALT SHOULDERS	AGGREGATE SHOULDERS, TYPE B	HOT-MIX ASPHALT SURFACE REMOVAL, 1 1/2"
	FEET	FEET	SQ YD	GALLON	TON	TON	TON	SQ YD	TON	TON	SQ YD
1070+00.00 TO 1071+40.00	140.00	58.00	902	90	1.80	50.5	75.8				
1071+40.00 TO 1072+16.00	76.00	54.00	456	46	0.90	25.5	38.3				
1072+16.00 TO 1074+73.00	257.00	54.00	1542	154	3.10	86.4	129.5				
1074+73.00 TO 1083+78.76	905.76	54.00	5435	544	10.90	304.3	456.5				
1083+78.76 TO 1086+04.10	225.34	72.00	1803	180	3.60	101.0	151.4				
1086+04.10 TO 1088+22.00	217.90	74.00	1792	179	3.60	100.3	150.5				
1088+22.00 TO 1089+00.00	78.00	78.00	676	68	1.40	37.9	56.8				
1089+00.00 TO 1102+42.96	1342.96	78.00	11639	1373	27.50	651.8	977.7		293		416
1102+42.96 TO 1106+29.83	386.87	BRIDGE OMISSION									
1106+29.83 TO 1110+00.00	370.17	78.00	3208	378	7.60	179.7	269.5		81		416
1110+00.00 TO 1113+93.35	393.35	60.00	2622	323	6.50	146.9	220.3		86		
1113+93.35 TO 1115+51.00	157.65	60.00	1051	130	2.60	58.9	88.3		34		
1115+51.00 TO 1116+50.00	99.00	74.00	814	89	1.80	45.6	68.4		11		
1116+50.00 TO 1118+00.00	150.00	54.00	900	90	1.80	50.4	75.6				
1118+00.00 TO 1118+25.00	25.00	64.00	178	18	0.40	10.0	14.9				
1118+25.00 TO 1121+00.00	275.00	54.00	1650	165	3.30	92.4	138.6				
1121+00.00 TO 1124+45.00	345.00	64.00	2453	245	4.90	137.4	206.1				
1124+45.00 TO 1125+20.00	75.00	72.00	600	60	1.20	33.6	50.4				
1125+20.00 TO 1135+39.00	1019.00	54.00	6114	611	12.20	342.4	513.6				
1135+39.00 TO 1140+06.00	467.00	66.00	3425	343	6.80	191.8	287.7				
1140+06.00 TO 1141+12.12	106.12	66.00	778	78	1.60	43.6	65.4				
1141+12.12 TO 1143+80.00	267.88	72.00	2143	214	4.30	120.0	180.0				
1143+80.00 TO 1149+00.00	520.00	54.00	3120	312	6.20	174.7	262.1				
1149+00.00 TO 1150+81.71	181.71	60.00	1211	121	2.40	67.8	101.8				
1150+81.71 TO 1153+50.00	268.29	66.00	1967	197	3.90	110.2	165.3				
1153+50.00 TO 1154+04.00	54.00	72.00	432	43	0.90	24.2	36.3				
1154+04.00 TO 1155+00.00	96.00	54.00	576	58	1.20	32.3	48.4				
1155+00.00 TO 1157+46.53	246.53	54.00	1479	148	3.00	82.8	124.3				
1157+46.53 TO 1160+13.00	266.47	42.00	1244	124	2.50	69.6	104.5				
1160+13.00 TO 1162+17.36	204.36	33.00	749	75	1.50	42.0	62.9				
1162+17.36 TO 1165+75.88	358.52	33.00	1315	132	2.60	73.6	110.4				
1165+75.88 TO 1167+13.39	137.51	24.00	367	55	1.10	20.5	30.8		26	31	
TOTAL	16013.4	4201.0	105726.6	10950.9	219.3	5920.9	8881.2	181.47	529.5	31.3	831.1

MAN HOLES TO BE ADJUSTED	
STATION	EASTBOUND
1015+08	1
1025+09	1
1027+60	1
1027+70	1
1030+30	1
1034+50	1
1044+70	1
1086+00	1
1114+93	1
1156+00	1
TOTAL EB	10
STATION	WESTBOUND
1014+49	1
1022+42	1
1022+40	1
1024+50	1
1029+80	1
1037+32	1
1044+13	1
1044+75	1
1114+09	1
TOTAL WB	9
TOTAL	19

VALVE VAULTS TO BE ADJUSTED	
STATION	EASTBOUND
1015+08	1
1027+46	1
1031+57	1
1035+40	1
1035+96	1
1038+21	1
1038+43	1
1039+73	1
1040+23	1
1040+65	1
1041+66	2
1060+50	1
TOTAL	13

PAVEMENT PATCHING SCHEDULE	
PARTIAL DEPTH PATCHING	
198	TON
PARTIAL DEPTH REMOVAL 2"	
1768	SQ YD
CLASS D PAVEMENT PATCHING	
TYPE I	21 SQ YD
TYPE II	1709 SQ YD
TYPE III	16 SQ YD

PORTLAND CEMENT CONCRETE SURFACE REMOVAL (COLD MILLING) VARIABLE DEPTH					
STATION	TO	STATION	LENGTH	WIDTH	AREA
1008+09.8	TO	1009+20.0	106.6		SQ YD
1028+94.8	TO	1030+86.0	85.2		SQ YD
1032+05.0	TO	1034+36.0	104.1		SQ YD
1035+98.8	TO	1037+66.3	74.9		SQ YD
1038+59.7	TO	1039+47.1	39.2		SQ YD
1040+38.7	TO	1041+20.6	36.0		SQ YD
1042+13.2	TO	1046+00.0	171.8		SQ YD
1046+00.0	TO	1048+93.0	130.3		SQ YD
1048+93.0	TO	1052+00.0	233.8		SQ YD
1052+59.4	TO	1055+62.7	211.7		SQ YD
1055+62.7	TO	1056+63.3	6.6		SQ YD
1056+63.3	TO	1060+82.0	315.8		SQ YD
1060+82.0	TO	1064+00.0	141.1		SQ YD
1064+00.0	TO	1066+72.0	111.8		SQ YD
1067+48.0	TO	1070+00.0	120.7		SQ YD
1070+00.0	TO	1071+40.0	62.0		SQ YD
1072+16.0	TO	1074+73.0	137.9		SQ YD
1157+46.5	TO	1160+13.0	171.1		SQ YD
TOTAL					2260.4 SQ YD

CORRUGATED MEDIAN (DOWELLED)					
LOCATION	LENGTH	WIDTH	AREA		
	FEET	FEET	SQ YD		
1008+08.8	TO	1009+64.0	155.2	VAR.	959.0
1072+16.0	TO	1074+73.0	257.0	VAR.	1241.0
1157+46.5	TO	1160+13.4	266.9	VAR.	1540.0
TOTAL					3740.0

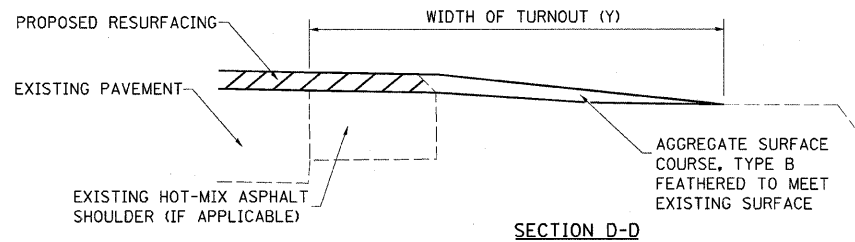
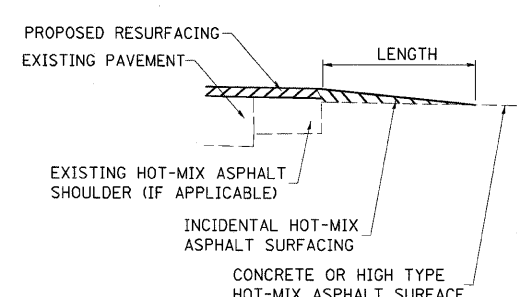
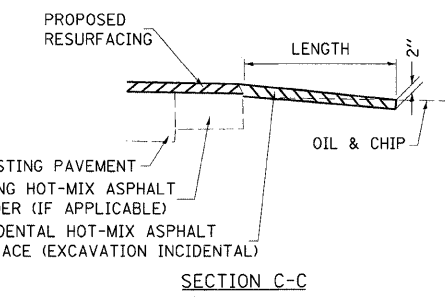
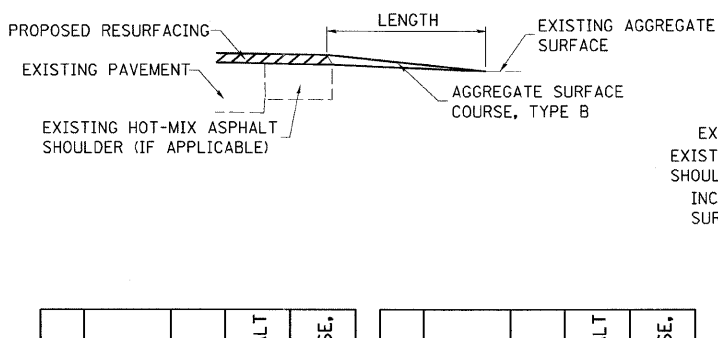
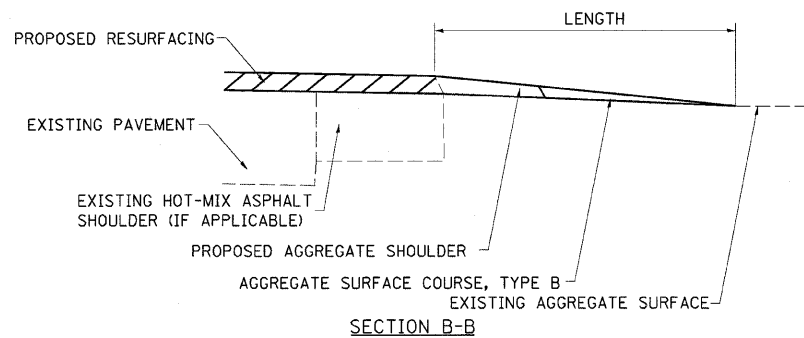
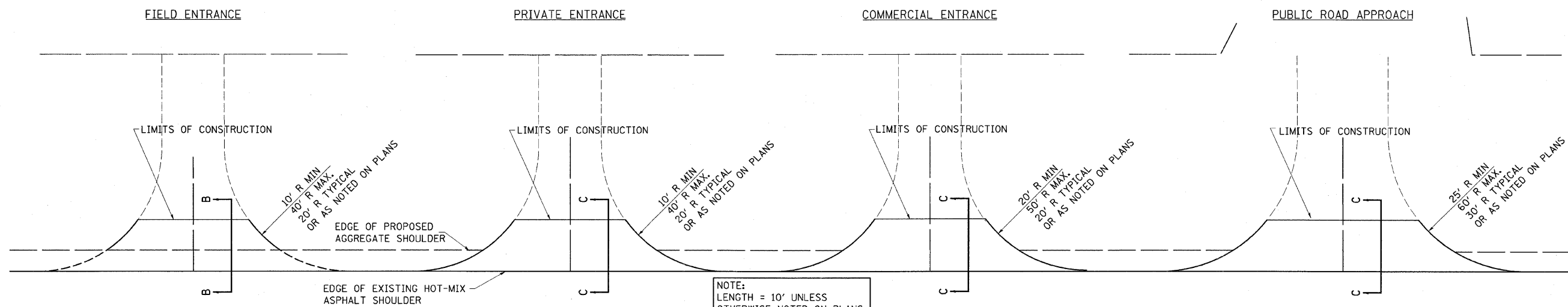

TYPICAL SECTION AT MAILBOX TURNOUT
NOTE: SEE STANDARD 406201 FOR MAILBOX TURNOUT DETAILS

NOTES

THE COST OF THE ASPHALT MATERIALS, AND AGGREGATE (PRIME COAT) FOR ENTRANCES AND PUBLIC ROADS AND APPROACHES SHALL BE INCLUDED IN THE PAY ITEM INCIDENTAL HOT-MIX ASPHALT SURFACING.

THE COST OF EXCAVATION IS INCLUDED IN THE PAY ITEM INCIDENTAL HOT-MIX ASPHALT SURFACING.

IF THERE IS NOT EXISTING HOT-MIX ASPHALT SHOULDER THEN THE ENTRANCE TAPER STARTS AT THE EDGE OF EXISTING PAVEMENT.

THE COST OF THE BITUMINOUS MATERIALS AND AGGREGATE (PRIME COAT) FOR ENTRANCES AND PUBLIC ROAD APPROACHES SHALL BE INCLUDED IN THE PAY ITEM INCIDENTAL HOT-MIX ASPHALT SURFACING.

SIDE	STATION	TYPE	INCIDENTAL HOT-MIX ASPHALT SURFACING	
			TON	TON
RT	1016+40	PRA	15.2	
RT	1027+27	PRA	9.8	
RT	1031+45	PRA	9.8	
RT	1035+18	PRA	9.8	
RT	1038+28	PRA	8.7	
RT	1041+84	PRA	10.9	
RT	1042+73	CE	8.4	
RT	1043+28	CE	12.2	
RT	1044+25	CE	5.6	
RT	1044+98	CE	5.1	
RT	1045+70	CE	5.1	
RT	1047+12	CE	4.2	
RT	1048+85	FE	2.6	
RT	1050+00	CE	4.4	
RT	1053+43	CE	5.1	
RT	1056+12	PRA	15.2	
RT	1066+30	PE	2.6	
RT	1067+54	PRA	9.0	
RT	1068+85	PE	2.6	
RT	1069+17	PE	2.6	
RT	1069+66	PE	2.6	
RT	1072+03	PE	2.6	

SIDE	STATION	TYPE	INCIDENTAL HOT-MIX ASPHALT SURFACING	
			TON	TON
RT	1072+93	PE	2.6	
RT	1073+35	PE	2.6	
RT	1081+18	PE	2.6	
RT	1082+78	PE	2.6	
RT	1084+41	PRA	9.8	
RT	1114+84	PRA	19.1	
RT	1117+05	PE	2.6	
RT	1119+35	FE	3.3	
RT	1124+90	FE	2.6	
RT	1140+59	PRA	9.0	
RT	1145+07	FE	2.6	
RT	1152+70	FE	3.3	
RT	1160+45	FE		4.4
LT	1166+80	PE		2.3
LT	1163+89	PE		2.3
LT	1160+20	FE		2.3
LT	1153+88	PRA	14.5	
LT	1140+59	PRA	7.4	
LT	1137+61	FE		2.3
LT	1135+67	FE	2.4	
LT	1124+90	PRA	17.5	
LT	1114+84	PRA	10.1	

SIDE	STATION	TYPE	INCIDENTAL HOT-MIX ASPHALT SURFACING	
			TON	TON
LT	1087+92	PRA	7.9	
LT	1086+64	PE	2.1	
LT	1085+94	PE	2.3	
LT	1085+09	PE	1.9	
LT	1076+25	PE	2.3	
LT	1075+34	PE	2.3	
LT	1073+75	PE	3.0	
LT	1073+28	PE	2.3	
LT	1072+37	PE	3.0	
LT	1072+10	PE		2.8
LT	1071+78	PRA	8.7	
LT	1070+01	PE	2.3	
LT	1068+85	PE	2.6	
LT	1068+04	PE	2.6	
LT	1066+97	PE	4.7	
LT	1066+25	PE	2.6	
LT	1065+79	PE	2.6	
LT	1064+34	PE	2.6	
LT	1063+38	PE	2.6	
LT	1062+33	PRA	6.0	
LT	1058+65	CE	5.4	
LT	1056+12	PRA	16.9	

SIDE	STATION	TYPE	INCIDENTAL HOT-MIX ASPHALT SURFACING	
			TON	TON
LT	1055+24	CE	5.1	
LT	1053+70	FE	2.6	
LT	1052+29	PE	2.6	
LT	1051+57	CE	13.1	
LT	1050+92	CE	4.0	
LT	1050+40	CE	4.7	
LT	1049+40	CE	4.9	
LT	1048+50	CE	4.4	
LT	1047+61	CE	4.9	
LT	1046+70	CE	5.8	
LT	1045+98	CE	4.7	
LT	1045+38	CE	3.7	
LT	1044+84	CE	4.7	
LT	1043+77	CE	3.0	
LT	1043+28	CE	3.5	
LT	1042+82	CE	3.5	
LT	1042+10	CE	3.5	
LT	1041+58	CE	3.5	
LT	1040+88	CE	5.1	
LT	1040+36	CE	3.5	
LT	1039+77	PRA	8.3	
LT	1038+86	CE	4.9	

SIDE	STATION	TYPE	INCIDENTAL HOT-MIX ASPHALT SURFACING	
			TON	TON
LT	1038+11	CE	4.9	
LT	1036+51	PE	4.2	
LT	1035+18	PRA	12.0	
LT	1033+74	FE	2.6	
LT	1031+46	PRA	9.8	
LT	1030+45	PE	2.6	
LT	1029+66	PE	2.6	
LT	1027+22	PE	2.6	
LT	1013+7	CE	3.5	
TOTAL			503.5	16.4

FE=FIELD ENTRANCE PE=PRIVATE ENTRANCE
PRA - PUBLIC ROAD APPROACH MBT - MAILBOX TURNOUT
CE=COMMERCIAL ENTRANCE

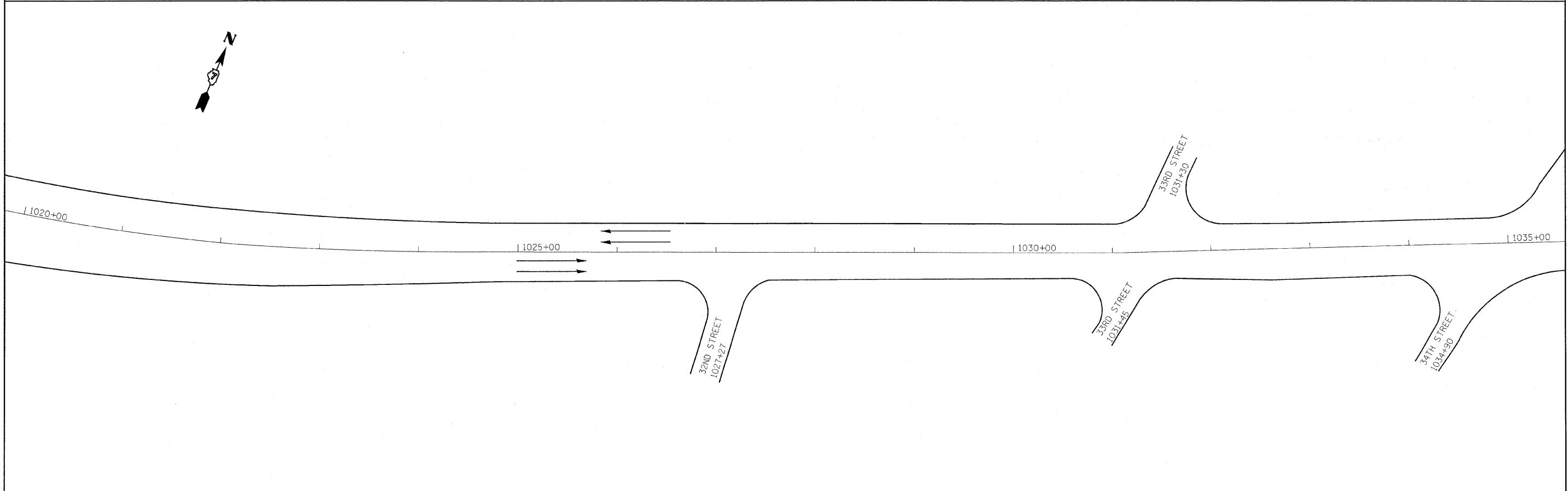
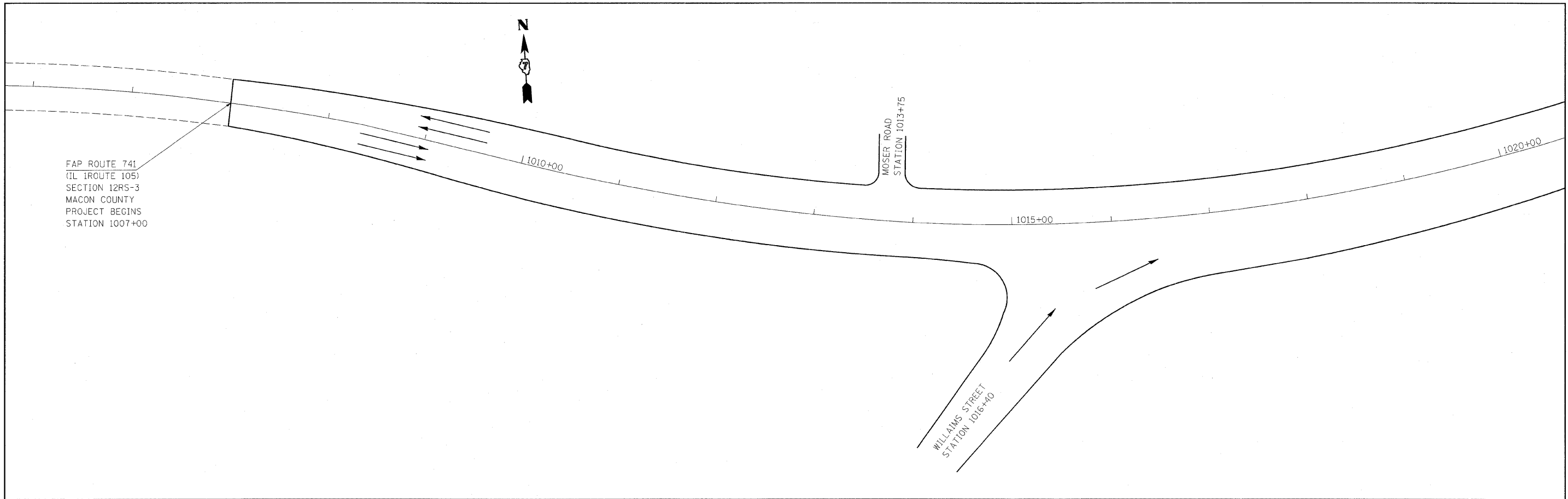

FILE NAME = c:\pw_work\pwwidot\TEASLEYCK\d0123454\	USER NAME = teasleyck 74378-shr-plan.dgn	DESIGNED - DRAWN -	REVISED - REVISED -	STATE OF ILLINOIS DEPARTMENT OF TRANSPORTATION	STATION 1007+00 TO STATION 1035+00		F.A.P. RTE. 741	SECTION 12RS-3	COUNTY Macon	TOTAL SHEETS 26	SHEET NO. 15	
	PLOT SCALE = 50.0000' / IN.	CHECKED -	REVISED -		SCALE:	SHEET NO.	OF SHEETS	STA.	TO STA.	CONTRACT NO. 74378		
	PLOT DATE = 2/6/2009	DATE -	REVISED -		ILLINOIS FED. AID PROJECT							

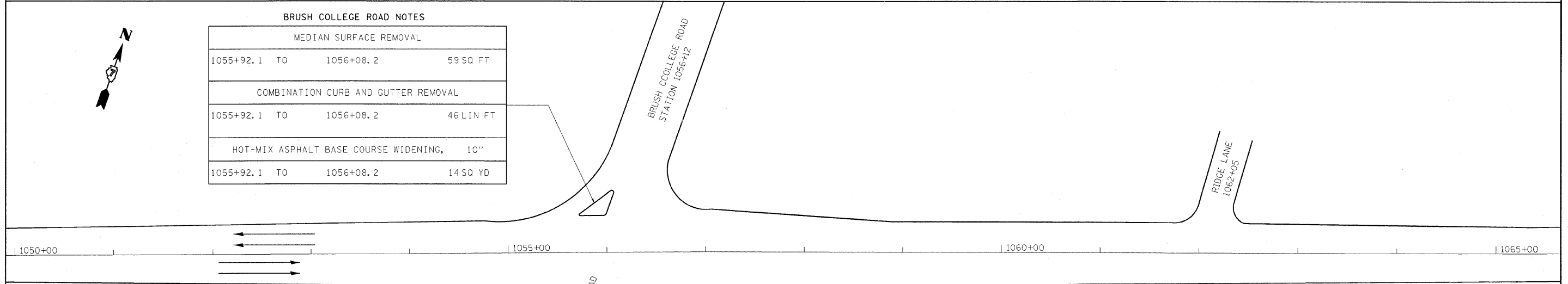
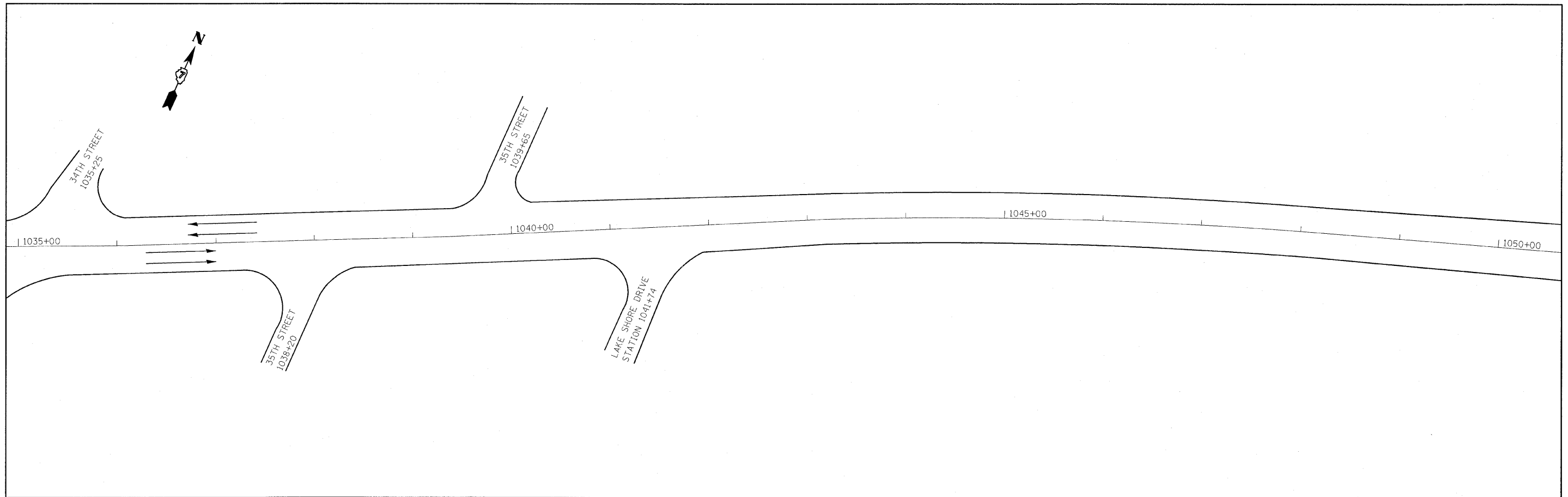

BRUSH COLLEGE ROAD NOTES

MEDIAN SURFACE REMOVAL		
1055+92.1	TO	1056+08.2 59 SQ FT
COMBINATION CURB AND GUTTER REMOVAL		
1055+92.1	TO	1056+08.2 46 LIN FT
HOT-MIX ASPHALT BASE COURSE WIDENING, 10"		
1055+92.1	TO	1056+08.2 14 SQ YD

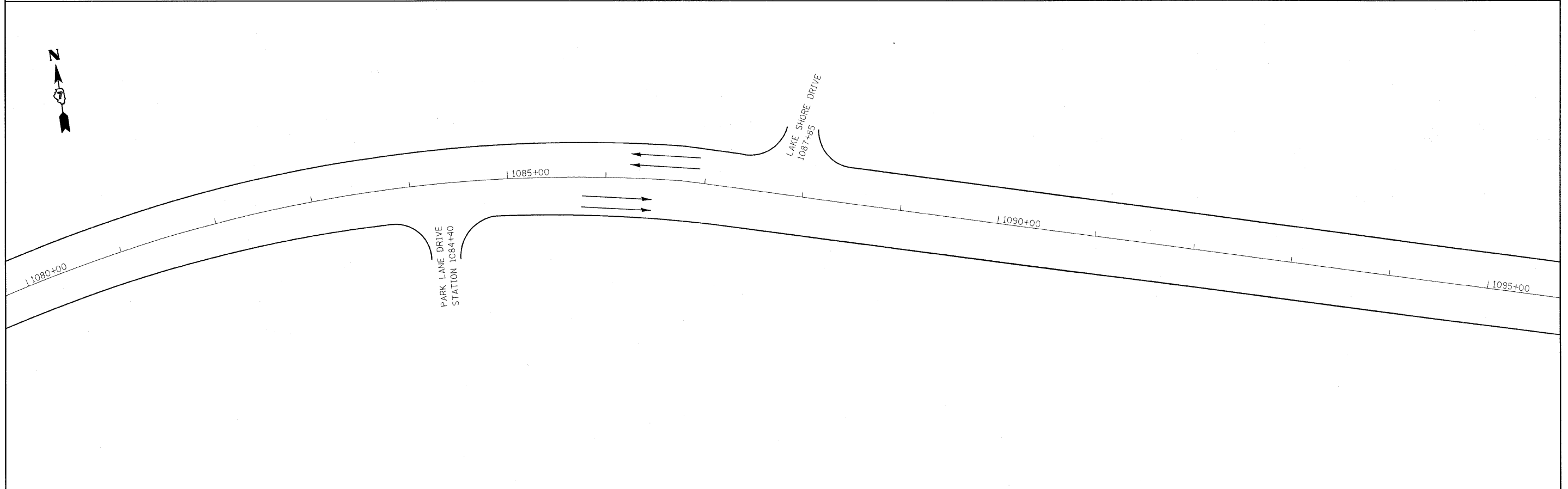
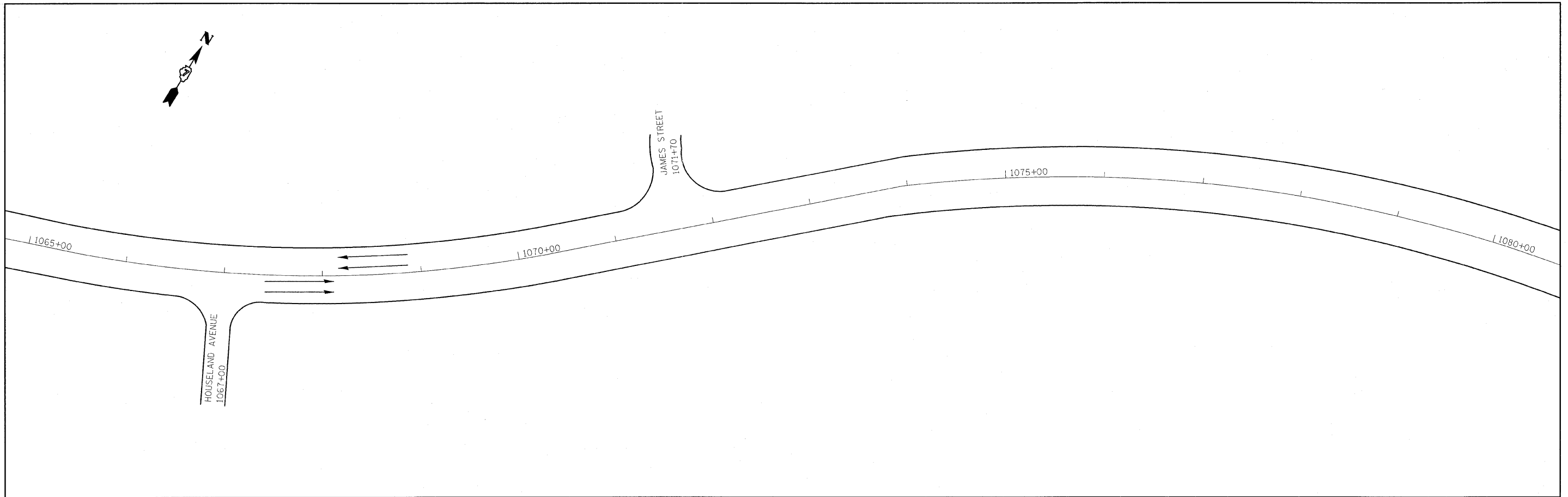

FILE NAME = c:\pwwork\pwidot\TEASLEYCK\08123454\0	USER NAME = teasleyck	DESIGNED - DRAWN -	REVISED - REVISED -	STATE OF ILLINOIS DEPARTMENT OF TRANSPORTATION	STATION 1065+00 TO STATION 1095+00			F.A.P. RTE. 741	SECTION 12RS-3	COUNTY Macon	TOTAL SHEETS 26	SHEET NO. 19
	PLOT SCALE = 50,0000' / IN.	CHECKED -	REVISED -		SCALE:	SHEET NO.	OF	SHEETS	STA.	TO STA.	CONTRACT NO. 74378	
	PLOT DATE = 2/6/2009	DATE -	REVISED -		ILLINOIS FED. AID PROJECT							

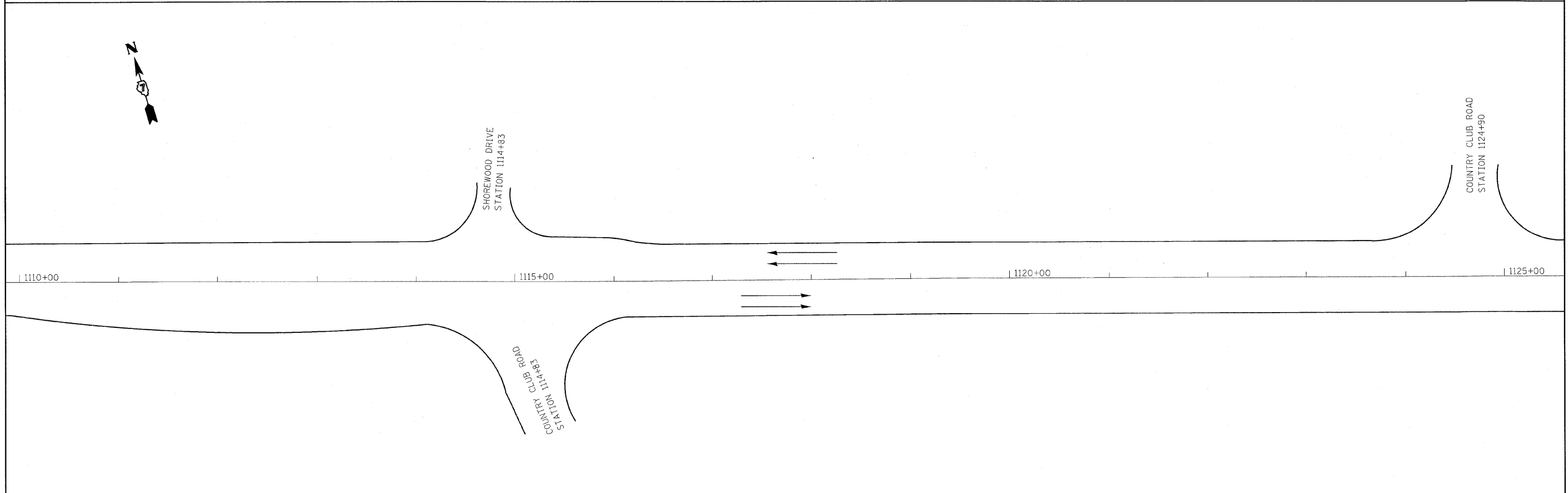
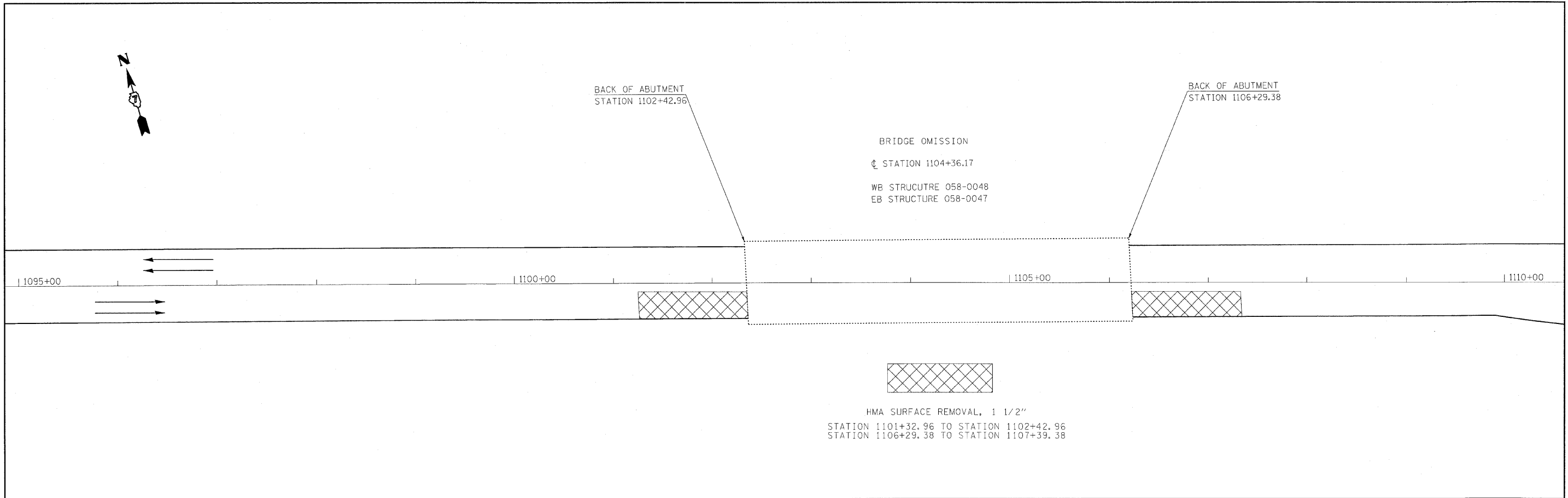

FILE NAME =	USER NAME = teasleyck	DESIGNED -	REVISED -	STATE OF ILLINOIS DEPARTMENT OF TRANSPORTATION	STATION 1095 + 00 TO STATION 1125 + 00			F.A.P. RTE.	SECTION	COUNTY	TOTAL SHEETS	SHEET NO.
et:\pw_wor\k\p\IDOT\TEASLEYCK\123454\074378-shr-plan.dgn	PLOT SCALE = 50.0000' / IN.	DRAWN -	REVISED -					741	12RS-3	Macon	26	18
	PLOT DATE = 2/6/2009	CHECKED -	REVISED -		SCALE: SHEET NO. OF SHEETS STA. TO STA.			CONTRACT NO. 74378				
		DATE -	REVISED -		ILLINOIS FED. AID PROJECT							

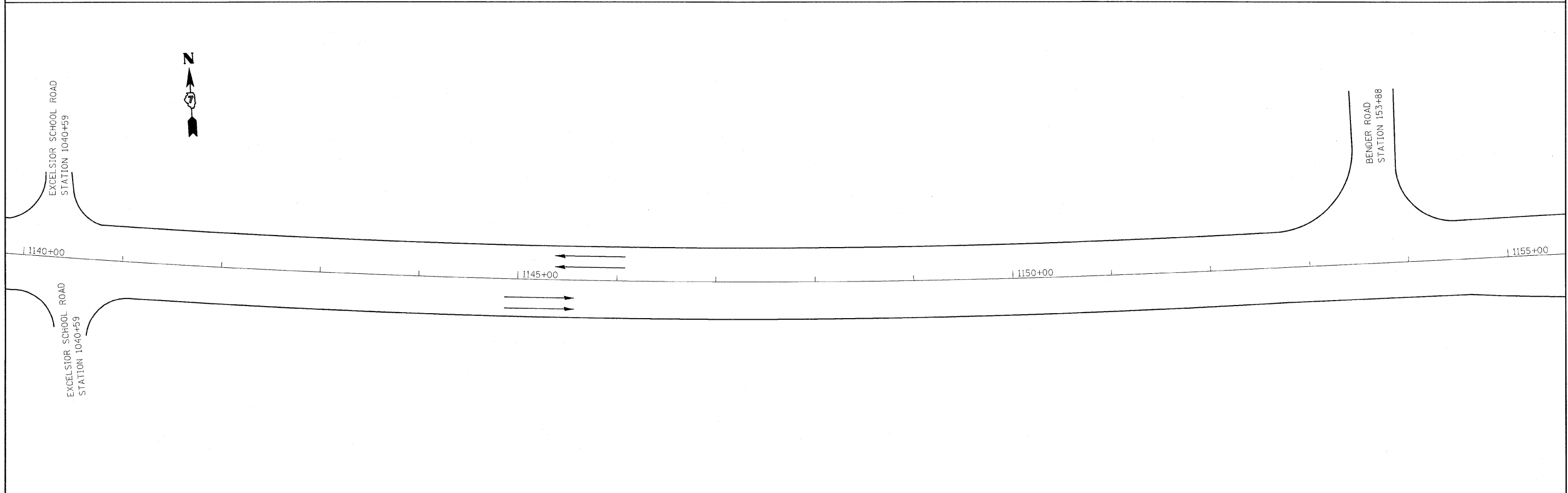
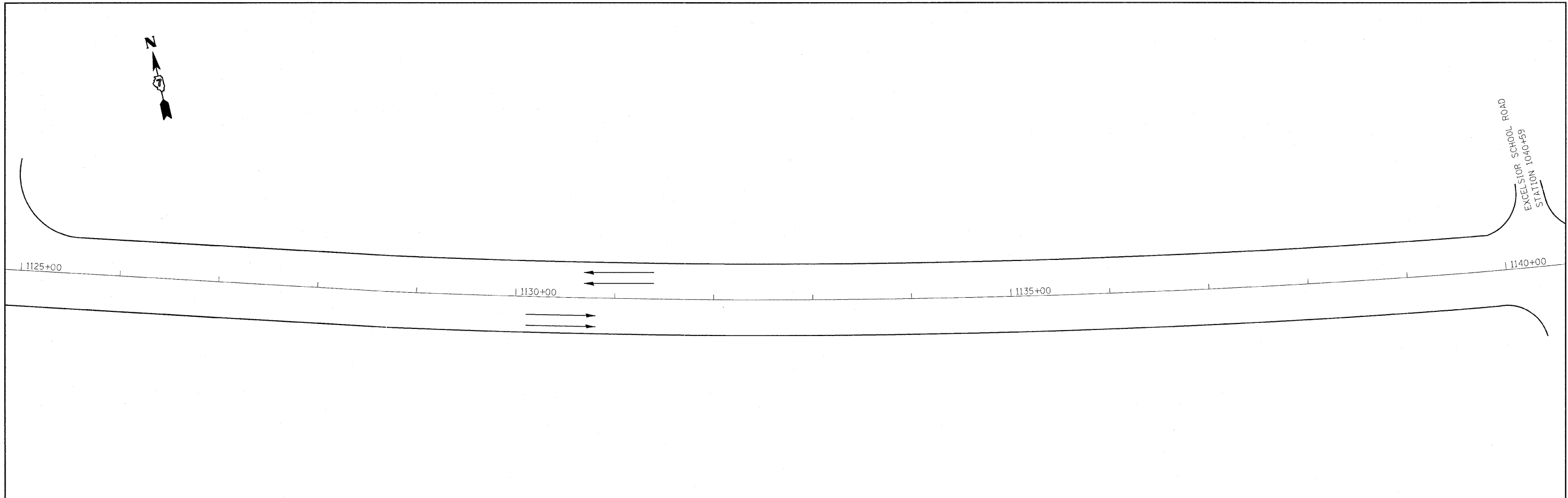

FILE NAME =	USER NAME = teasleyck	DESIGNED -	REVISED -	STATE OF ILLINOIS DEPARTMENT OF TRANSPORTATION	STATION 1125+00 TO STATION 1155+00		F.A.P. RTE. 741	SECTION 12RS-3	COUNTY Macon	TOTAL SHEETS 26	SHEET NO. 19	
ct:\pw_work\PW\DOT\TEASLEYCK\02123454\074378-sht.pln.dgn		DRAWN -	REVISED -		SCALE:	SHEET NO.	OF	SHEETS	STA.	TO STA.	CONTRACT NO. 74378	ILLINOIS FED. AID PROJECT
	PLOT SCALE = 50,0000' / IN.	CHECKED -	REVISED -									
	PLOT DATE = 2/6/2009	DATE -	REVISED -									



FAP ROUTE 741
 (IL ROUTE 105)
 SECTION 12RS-3
 MACON COUNTY
 PROJECT ENDS
 STATION 1167+13

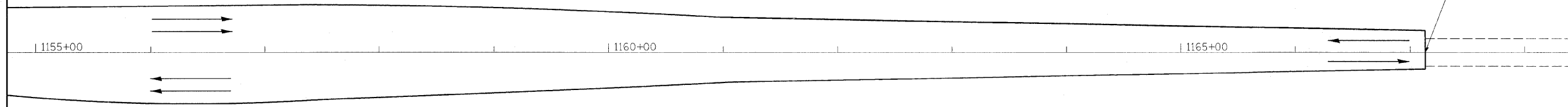

FILE NAME = c:\pwork\pwork\TEASLEYCK\d0123454\0	USER NAME = teasleyck 74378-shr-plan.dgn	DESIGNED - DRAWN -	REVISED - REVISED -	STATE OF ILLINOIS DEPARTMENT OF TRANSPORTATION	STATION 1155+00 TO STATION 1168+00		F.A.P. RTE. 741	SECTION 12RS-3	COUNTY Macon	TOTAL SHEETS 26	SHEET NO. 26	
	PLOT SCALE = 50,000' / 1" IN.	CHECKED -	REVISED -		SCALE:	SHEET NO. OF SHEETS	STA. TO STA.	ILLINOIS FED. AID PROJECT				
	PLOT DATE = 2/6/2009	DATE -	REVISED -		CONTRACT NO. 74378							

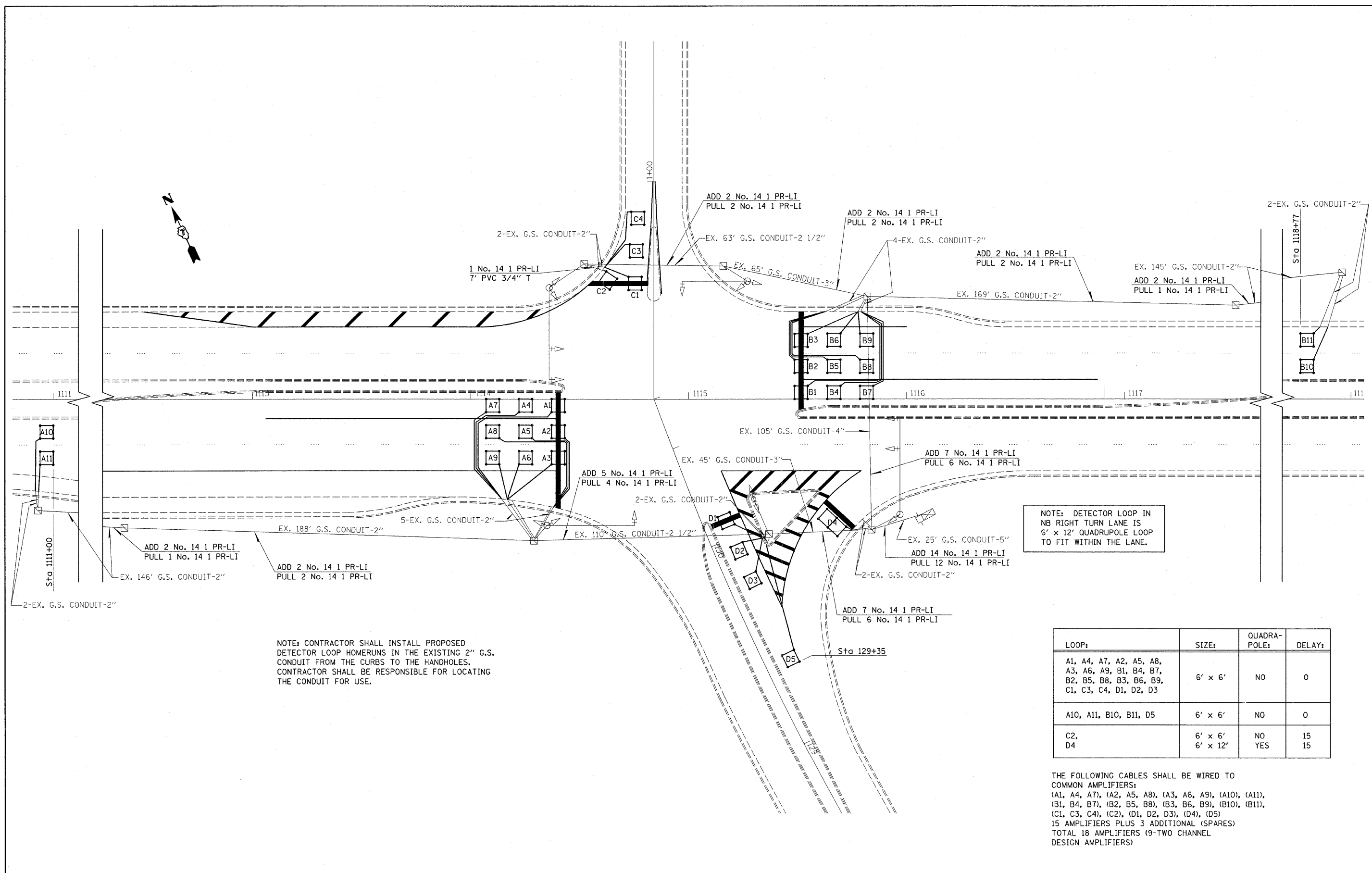

NOTE: CONTRACTOR SHALL INSTALL PROPOSED DETECTOR LOOP HOMERUNS IN THE EXISTING 2" G.S. CONDUIT FROM THE CURBS TO THE HANDHOLES. CONTRACTOR SHALL BE RESPONSIBLE FOR LOCATING THE CONDUIT FOR USE.

NOTE: DETECTOR LOOP IN NB RIGHT TURN LANE IS 6' x 12' QUADRUPOLE LOOP TO FIT WITHIN THE LANE.

LOOP:	SIZE:	QUADRA-POLE:	DELAY:
A1, A4, A7, A2, A5, A8, A3, A6, A9, B1, B4, B7, B2, B5, B8, B3, B6, B9, C1, C3, C4, D1, D2, D3	6' x 6'	NO	0
A10, A11, B10, B11, D5	6' x 6'	NO	0
C2, D4	6' x 6' 6' x 12'	NO YES	15 15

THE FOLLOWING CABLES SHALL BE WIRED TO COMMON AMPLIFIERS:
 (A1, A4, A7), (A2, A5, A8), (A3, A6, A9), (A10), (A11),
 (B1, B4, B7), (B2, B5, B8), (B3, B6, B9), (B10), (B11),
 (C1, C3, C4), (C2), (D1, D2, D3), (D4), (D5)
 15 AMPLIFIERS PLUS 3 ADDITIONAL (SPARES)
 TOTAL 18 AMPLIFIERS (9-TWO CHANNEL DESIGN AMPLIFIERS)

TYPICAL APPLICATION OF DETECTOR LOOPS

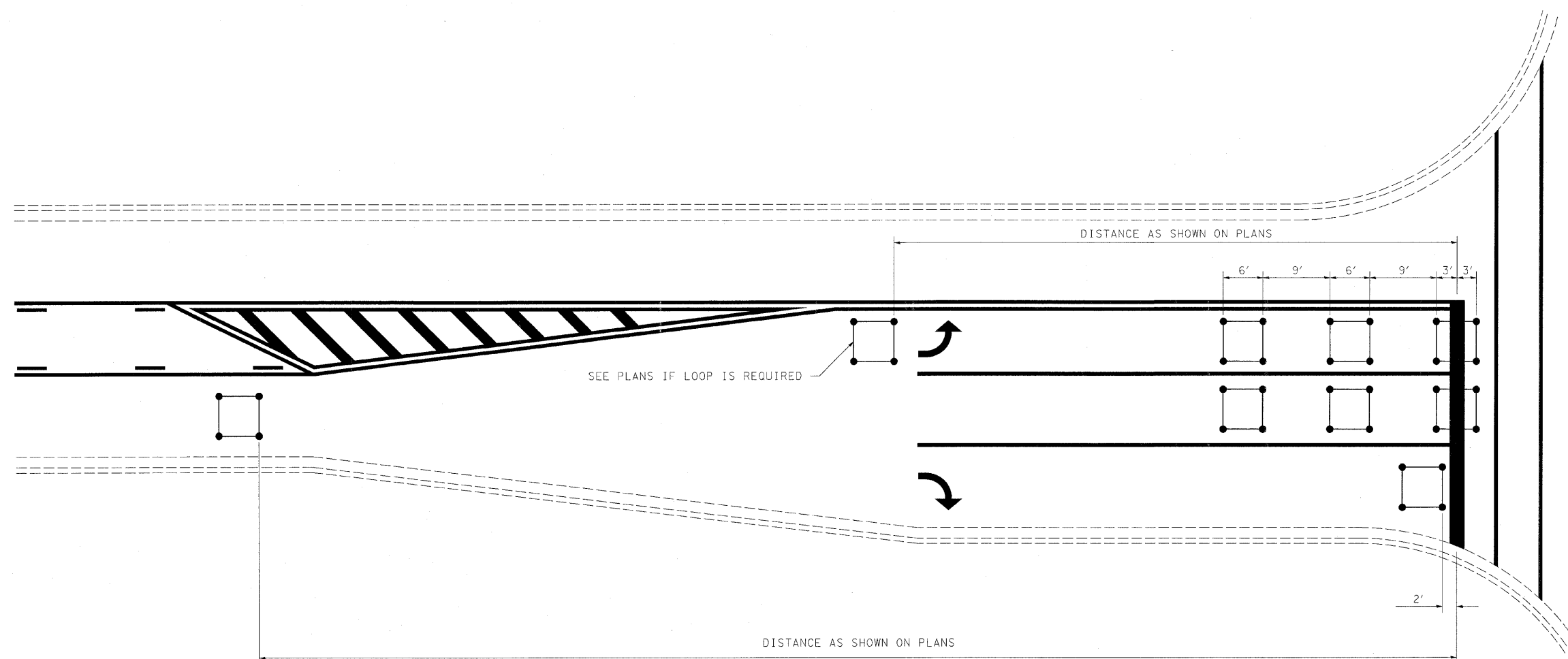

NOTE:

1. EACH LOOP SHALL HAVE ITS OWN HOMERUN TO THE GULFBOX/HANDHOLE.
2. LOOPS SHOULD BE CENTERED IN EACH LANE.
3. USE 6' BY 6' LOOPS FOR LANE WIDTHS OF 11' OR GREATER.
4. USE 5' BY 5' LOOPS IF LANE WIDTH IS LESS THAN 11'.

NOT TO SCALE

FILE NAME =	USER NAME = teasleyck	DESIGNED -	REVISED - MKS 4-08	STATE OF ILLINOIS DEPARTMENT OF TRANSPORTATION	TYPICAL APPLICATIONS OF DETECTOR LOOPS	F.A.P. RTE.	SECTION	COUNTY	TOTAL SHEETS	SHEET NO.	
es:\pw\work\VPWIDOT\TEASLEYCK\0123454\0	74378-sht-details.dgn	DRAWN -	REVISED -			741	12RS-3	Macon	26	22	
	PLOT SCALE = 50,0000' / IN.	CHECKED -	REVISED -			CONTRACT NO. 74378					
	PLOT DATE = 2/6/2009	DATE -	REVISED -			SCALE:		SHEET NO. OF SHEETS		STA. TO STA.	

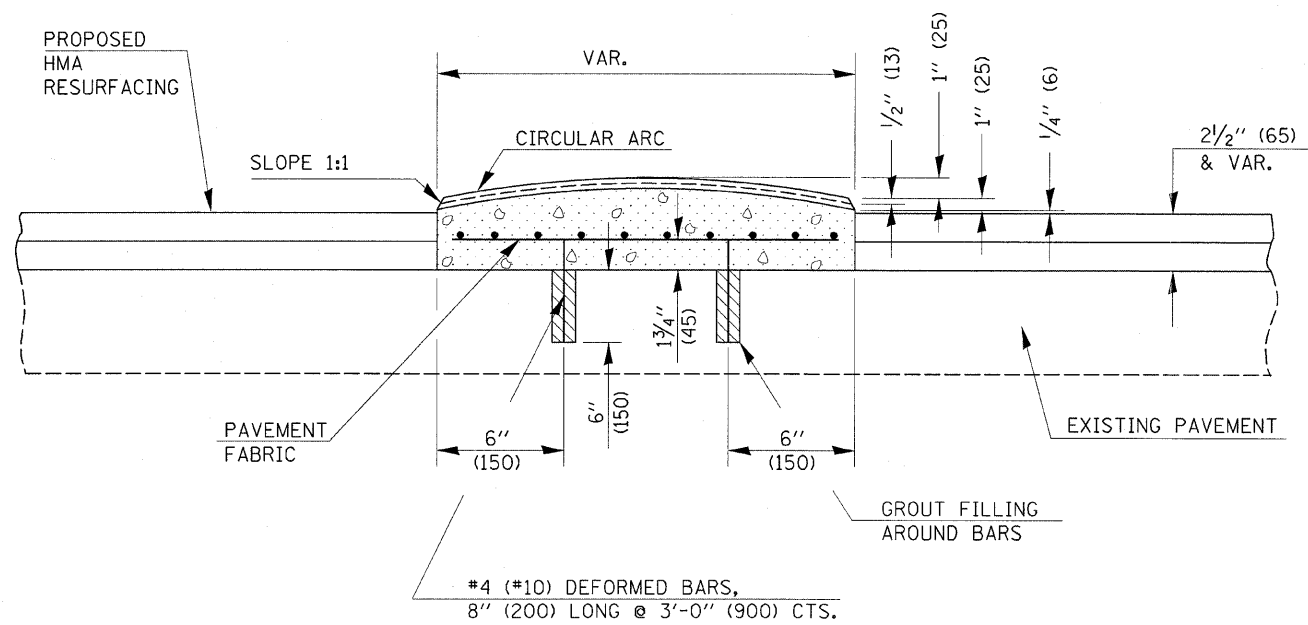

TRANSVERSE SECTION

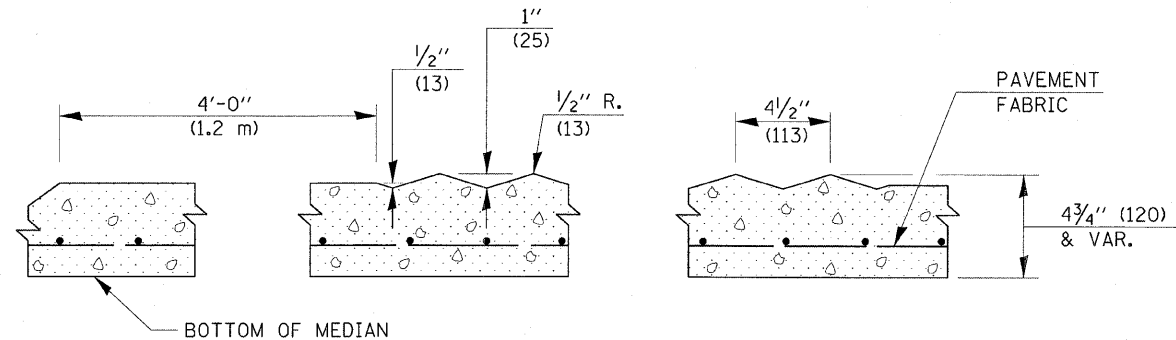

SECTION A-A

GENERAL NOTES

1. DOWELS AT 3'-0" (900) INTERVALS OR AS DIRECTED BY THE ENGINEER.
2. SEE STANDARD 420701 FOR PAVEMENT FABRIC DETAILS.

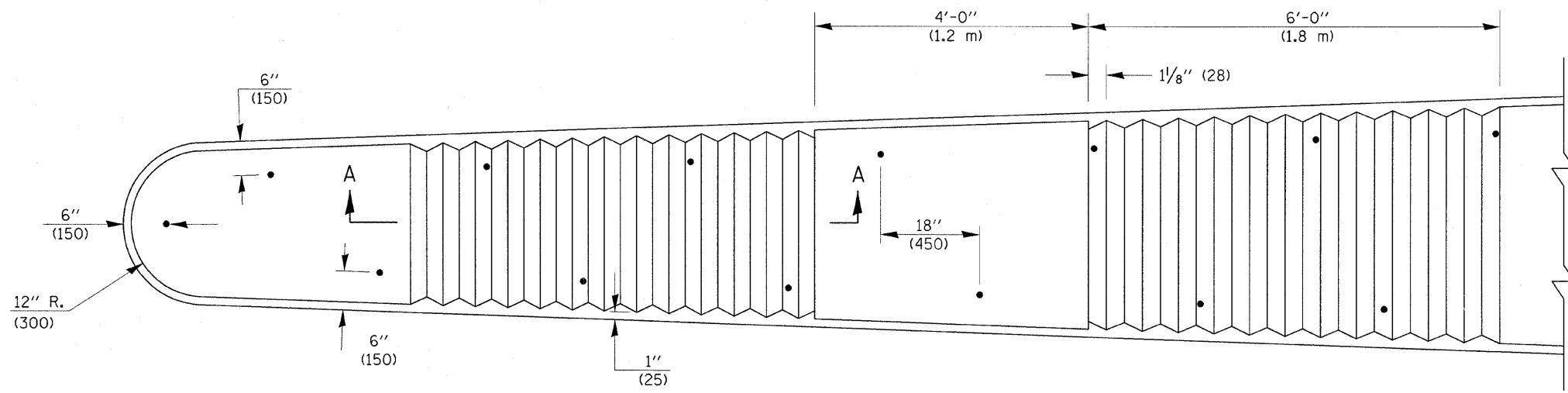

PLAN

Note: All dimensions are in INCHES (millimeters) unless otherwise shown.

FILE NAME =	USER NAME = teasleyck	DESIGNED -	REVISED - DRM 1/09	STATE OF ILLINOIS DEPARTMENT OF TRANSPORTATION	CORRUGATED MEDIAN (DOWELLED)			F.A.P. RTE.	SECTION	COUNTY	TOTAL SHEETS	SHEET NO.
ci:\pw_work\PWIDOT\TEASLEYCK\0123454\0	74378-shd-details.dgn	DRAWN -	REVISED -					742	12RS-4	Macon	26	23
	PLOT SCALE = 50.0000' / IN.	CHECKED -	REVISED -					CONTRACT NO. 74379				
	PLOT DATE = 2/6/2009	DATE -	REVISED -					ILLINOIS FED. AID PROJECT				

TO BE INSTALLED IN ALL PAVEMENT TYPES FOR PRESERVING PERMANENT SURVEY MARKERS (PI'S, PT'S, PC'S, POC'S, & POT'S) AND LAND SURVEY MONUMENTS (SECTION OR SUBSECTION CORNERS)

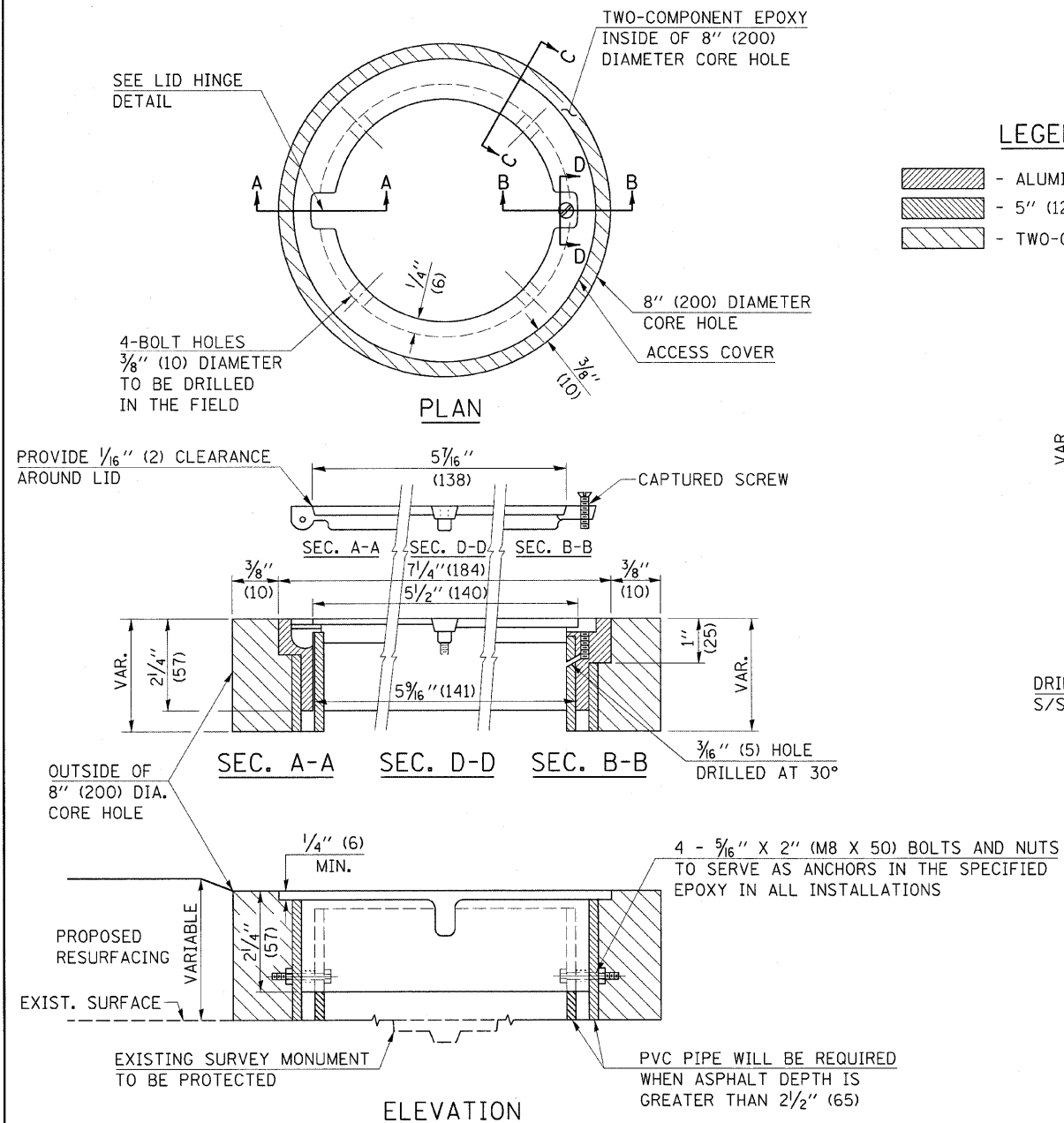

LEGEND

- ALUMINUM CASTING
- 5" (125) OR 6" (150) P.V.C. PIPE
- TWO-COMPONENT EPOXY

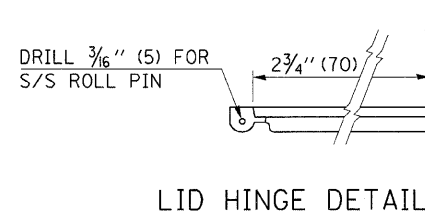
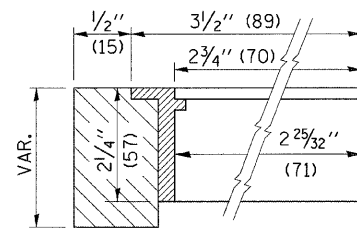

SPECIFICATIONS FOR ACCESS COVER FOR USE WITH SURVEY MARKER VAULT(S) AND SURVEY MARKER COVER ASSEMBLY(S): THE ACCESS COVER WILL BE CAST FROM A SPECIAL ALUMINUM ALLOY THAT IS COMPARABLE TO BRONZE IN HARDNESS. THE ACCESS COVER SHALL BE SPECIALLY ENGINEERED AND DESIGNED TO PROVIDE A SNUG FIT, INCORPORATING EQUIDISTANT LOCKING RIDGES, INSIDE A STANDARD 6" (150 mm) DIAMETER, OR OUTSIDE A STANDARD 5" (125 mm) DIAMETER, SCHEDULE 40 PVC PIPE. THE ACCESS COVER SHALL HAVE SPECIAL UNIFORM 1" (25 mm) THICK TOP SURFACE TO PERMIT INFORMATION TO BE EASILY MACHINE-STAMPED INTO IT. THE ACCESS COVER SHALL INCLUDE A STAINLESS CAPTURED SCREW AND AN OPPOSING RECESSED HINGE ASSEMBLY AS ITS LOCKING MECHANISM. THE ACCESS COVER SHALL INCORPORATE A SPECIAL ACCESS HOLE FOR CLEANING AND DRAINAGE, DRILLED AT 30° INSIDE THE RING OF THE ACCESS COVER, TO THE DRILLED AND TAPPED HOLE PROVIDED FOR THE STAINLESS CAPTURED SCREW. COMPOSITION: ALUMINUM 92-93%; MAGNESIUM 6.5-7.5%. STRENGTH: YIELD - 19,000-21,000 PSI (131-145 MPa); TENSILE - 38,000-44,000 PSI (262-303 MPa); ELONGATION - 10-15% IN 2" (50 mm). SPECIFICATIONS: ALLOY 535.0; QQ-A-601Es. NO EXCEPTIONS.

BILL OF MATERIAL

ALUMINUM CASTING OF THE DIMENSIONS AND SPECIFICATIONS SHOWN OR OTHER SUBJECT TO ENGINEER'S APPROVAL OF SHOP DRAWINGS, 4 EACH - 5/16" X 2" (M8 X 50) BOLTS WITH NUTS, EPOXY, 5" OR 6" (125 mm OR 150 mm) DIAMETER P.V.C. PIPE, SCHEDULE 40 (WHEN REQUIRED).

GENERAL NOTES

1. WORK SHALL NOT START ON THIS ITEM UNTIL THE FINAL LIFT OF SURFACE HAS BEEN COMPLETED.
2. THE SURVEY MONUMENT COVER ASSEMBLY SHALL BE CENTERED ABOVE THE SURVEY MONUMENT TO BE PROTECTED.
3. MODIFICATION OF THE ALUMINUM CASTING SHALL BE DONE BY GRINDING OR SAWING WHEN HEIGHT REDUCTION IS REQUIRED.
4. ALL SURVEY MONUMENT COVER ASSEMBLIES SHALL BE PLACED 1/4" (6 mm) ± BELOW THE FINAL SURFACE.
5. ALUMINUM CASTING SHALL BE PLACED OVER A 5" (125 mm) P.V.C. PIPE OR INSIDE OF A 6" (150 mm) P.V.C. PIPE WHEN AN INCREASE IN HEIGHT IS REQUIRED.
6. THE CASTING SHALL BE ANCHORED IN THE 8" (200 mm) DIAMETER CORE HOLE WITH TWO-COMPONENT EPOXY CONFORMING TO APPLICABLE PORTIONS OF ARTICLE 1025.01 OF THE STANDARD SPECIFICATIONS.
7. THIS WORK WILL BE PAID FOR AT THE CONTRACT UNIT PRICE EACH FOR SURVEY MONUMENT COVER ASSEMBLY WHICH PRICE SHALL INCLUDE ALL LABOR AND MATERIAL AS SPECIFIED INCLUDING CORING THE NEW PAVEMENT SURFACE AND EPOXY. NO ADDITIONAL COMPENSATION WILL BE ALLOWED.
8. THE 8" (200 mm) DIAMETER CORE HOLE SHALL BE SUBJECT TO THE APPROVAL OF THE ENGINEER.

Note: All dimensions are in INCHES (millimeters) unless otherwise shown.

DISTRICT 7 DETAIL NO. Z0070100

FILE NAME =	USER NAME = teasleyck	DESIGNED -	REVISED -	STATE OF ILLINOIS DEPARTMENT OF TRANSPORTATION	SURVEY MONUMENT COVER ASSEMBLY	F.A.P. RTE.	SECTION	COUNTY	TOTAL SHEETS	SHEET NO.	
cd:\pw\work\FWIDOT\TEASLEYCK\0123454\	74378-shr-details.dgn	DRAWN -	REVISED -			741	12RS-3	Macon	22	24	
	PLOT SCALE = 50,000' / IN.	CHECKED -	REVISED -			CONTRACT NO. 74378					
	PLOT DATE = 2/6/2009	DATE -	REVISED -			ILLINOIS FED. AID PROJECT					
					SCALE:	SHEET NO.	OF	SHEETS	STA.	TO STA.	

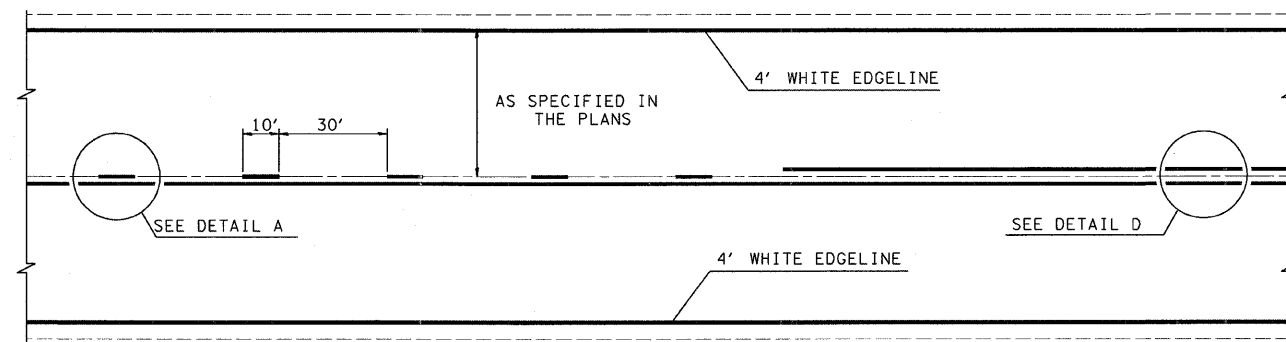

TYPICAL CENTERLINE, NO PASSING ZONE LINE (NPZ) & EDGELINE MARKINGS
2-LANE PAVEMENT

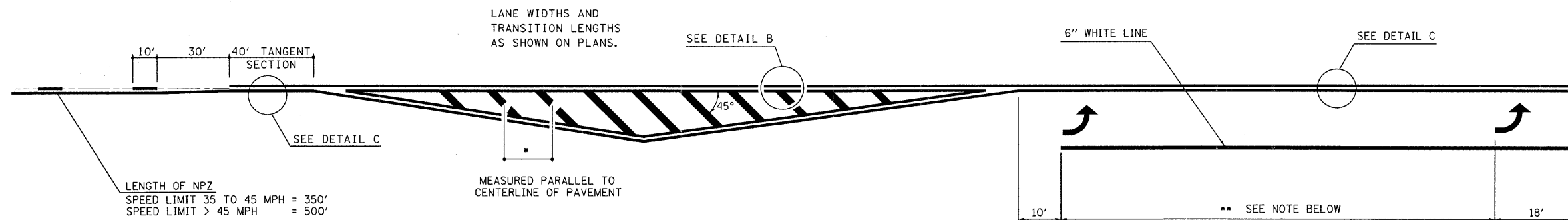

LENGTH OF NPZ
SPEED LIMIT 35 TO 45 MPH = 350'
SPEED LIMIT > 45 MPH = 500'

•DIAGONAL SPACING
SPEED LIMIT < 30 MPH = 15'
SPEED LIMIT 30 TO 45 MPH = 20'
SPEED LIMIT > 45 MPH = 30'

** PLACE THE FIRST ARROW EVEN WITH THE BEGINNING OF THE TURN BAY.
PLACE ANOTHER ARROW 18' BACK FROM THE STOP BAR, IF REQUIRED,
ADD ADDITIONAL ARROWS TO MAINTAIN A MAXIMUM OF 80' SPACING.

NOTES:

1. OMIT EDGELINE THRU SIDE ROADS.
2. TAPER RATES, LANE WIDTHS, AND STORAGE LENGTHS AS SHOWN ON THE PLANS.
3. WHEN MEDIANS ARE PRESENT, PLACE A SINGLE YELLOW STRIPE AROUND ITS PERIMETER.

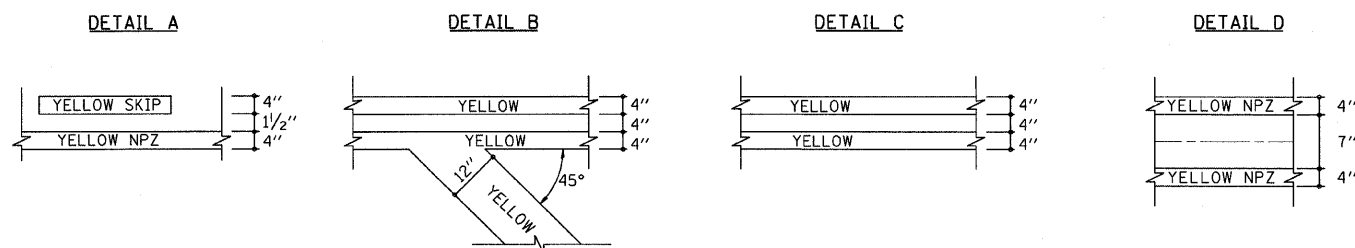

NOT TO SCALE

FILE NAME =	USER NAME = teasleyck	DESIGNED -	REVISED - MMO 12-99	STATE OF ILLINOIS DEPARTMENT OF TRANSPORTATION	TYPICAL APPLICATIONS OF PAVEMENT MARKINGS SHEET 1 OF 2			F.A.P. RTE.	SECTION	COUNTY	TOTAL SHEETS	SHEET NO.			
ct:\pw_work\pwork\TEASLEYCK\0123454.D	74378-ahd-details.dgn	DRAWN -	REVISED - DRM 08-04		SCALE:	SHEET NO.	OF	SHEETS	STA.	TO STA.	741	12RS-3	Macon	26	25
	PLOT SCALE = 50.0000' / IN.	CHECKED -	REVISED - MKS 04-08								CONTRACT NO. 74378				
	PLOT DATE = 2/6/2009	DATE -	REVISED -								ILLINOIS FED. AID PROJECT				

•• PLACE THE FIRST ARROW EVEN WITH THE BEGINNING OF THE TURN BAY.
 PLACE ANOTHER ARROW 18' BACK FROM THE STOP BAR. IF REQUIRED,
 ADD ADDITIONAL ARROWS TO MAINTAIN A MAXIMUM OF 80' SPACING.

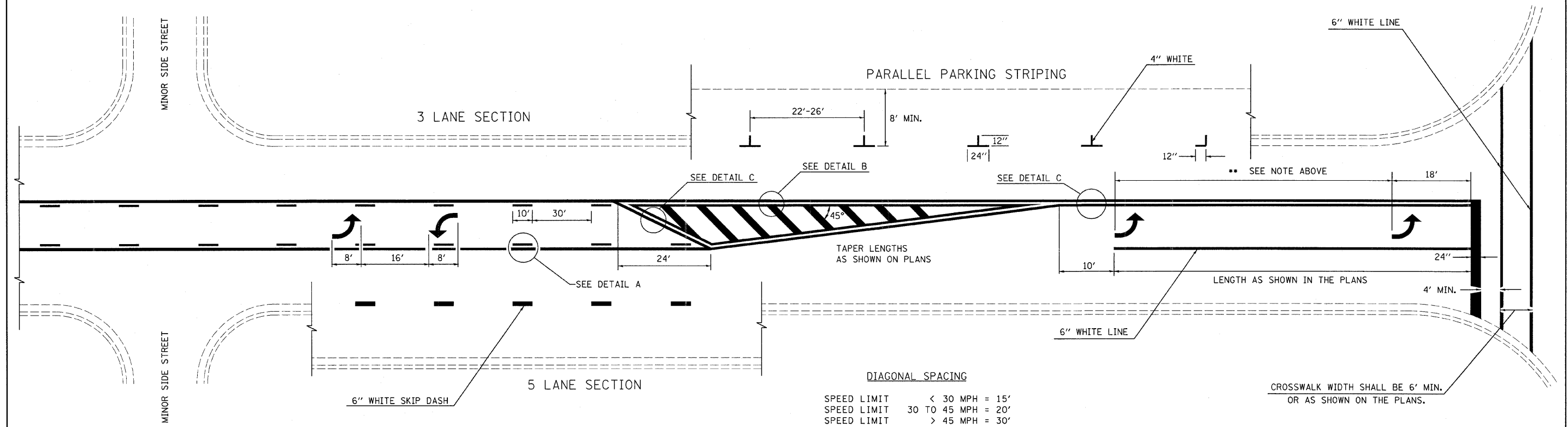

DIAGONAL SPACING
 SPEED LIMIT < 30 MPH = 15'
 SPEED LIMIT 30 TO 45 MPH = 20'
 SPEED LIMIT > 45 MPH = 30'

TYPICAL BI-DIRECTIONAL TURN LANE MARKINGS
 (SHOWING TRANSITION TO EXCLUSIVE LEFT TURN LANE)

- NOTE:**
1. NO LESS THAN 2 ARROWS SHALL BE USED.
 2. TAPER RATES, LANE WIDTHS, AND STORAGE LENGTHS AS SHOWN ON THE PLANS.
 3. AVOID PLACING BI-DIRECTIONAL ARROWS IN INTERSECTIONS.
 4. BI-DIRECTIONAL ARROWS SHALL BE SPACED A MAXIMUM OF 250'.

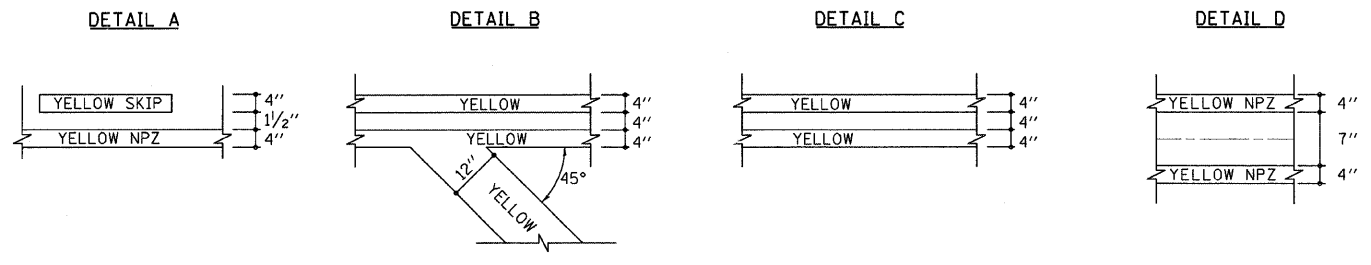

NOT TO SCALE

FILE NAME =	USER NAME = teasleyck	DESIGNED -	REVISED - MMO 12-99	STATE OF ILLINOIS DEPARTMENT OF TRANSPORTATION	TYPICAL APPLICATIONS OF PAVEMENT MARKINGS SHEET 2 OF 2			F.A.P. RTE.	SECTION	COUNTY	TOTAL SHEETS	SHEET NO.
es:\pwwork\NPWIDOT\TEASLEYCK\08123454\074378-sh1-deta1.s.dgn		DRAWN -	REVISED - DRM 08-04		741	12RS-3	Macon	26	26			
		CHECKED -	REVISED - MKS 04-08		CONTRACT NO. 74378							
		DATE -	REVISED -		SCALE:	SHEET NO.	OF SHEETS	STA.	TO STA.	FED. ROAD DIST. NO.	ILLINOIS FED. AID PROJECT	