

F.A.P. RTE.	SECTION	COUNTY	TOTAL SHEETS	SHEET NO.
781	2ZRS-1	CRAWFORD	191	117
STA.		TO STA.		
FED. ROAD DIST. NO.		ILLINOIS	FED. AID PROJECT	

**LEGEND**

- CONTRACTION JOINT PER STD. 420001
- /— LONGITUDINAL JOINT PER STD. 420001  
THE LONGITUDINAL METAL JOINT TYPE C MAY BE USED FOR SEPERATE LANE POURS, THE LONGITUDINAL JOINT WILL NOT BE SAWED WITH SEPERATE LANE POURS.
- 555.555 PROPOSED SURFACE ELEVATION

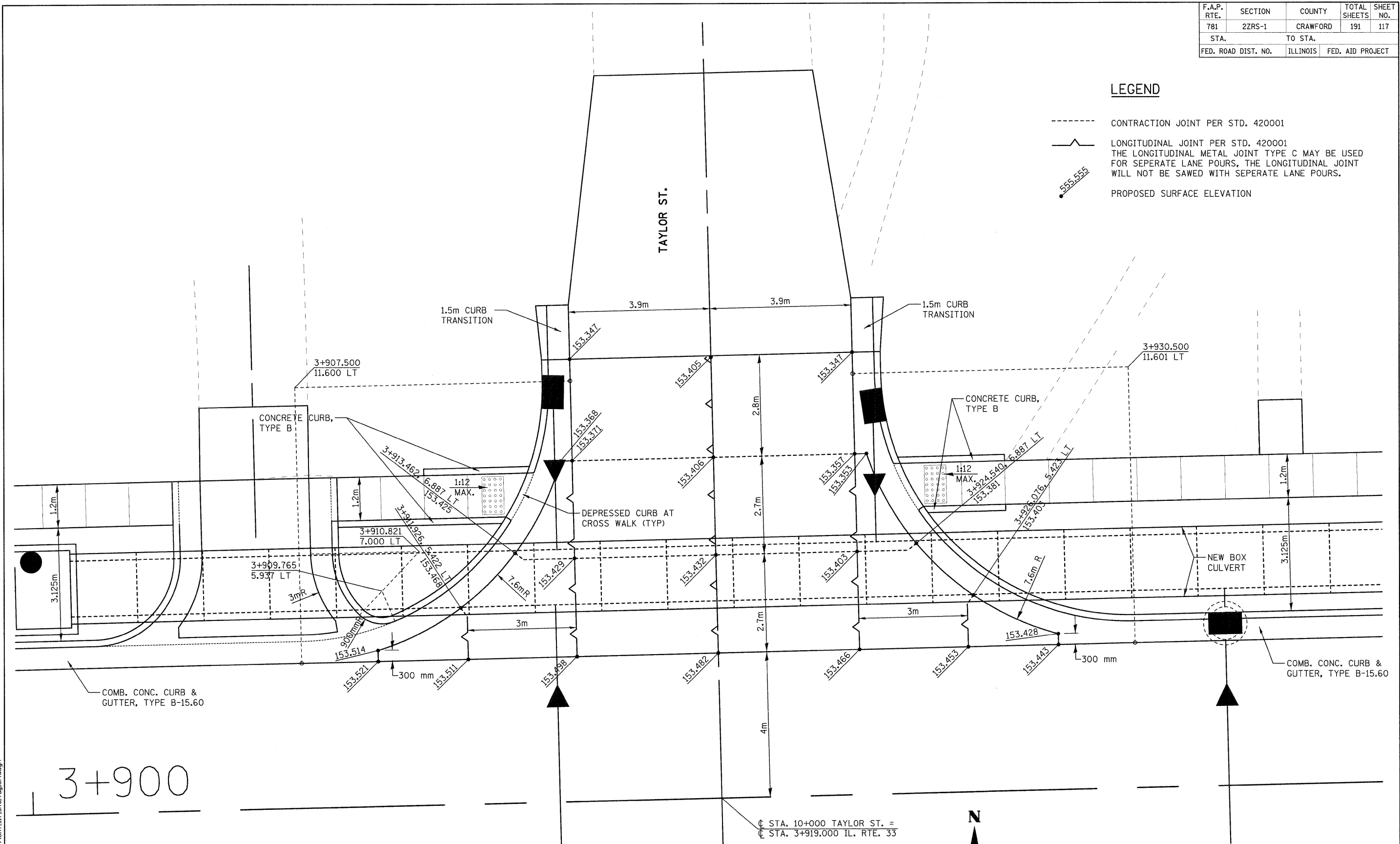

PLOT DATE = 2/5/2009  
 FILE NAME = H:\V4420\Contract 74349\SH1.117.inl\_Taylor-N.dgn

REVISIONS	
NAME	DATE

ILLINOIS DEPARTMENT OF TRANSPORTATION

**INTERSECTION DETAIL  
TAYLOR ST.**

SCALE AS SHOWN      DRAWN BY EDW  
 DATE FEBRUARY 6, 2009      CHECKED BY LWJ

H. M. & G. NO. 4420