

F.A.P. RTE.	SECTION	COUNTY	TOTAL SHEETS	SHEET NO.
781	2ZRS-1	CRAWFORD	191	77
STA. 2+975		TO STA. 3+150		
FED. ROAD DIST. NO.		ILLINOIS	FED. AID PROJECT	

- | | | |
|--|--|--|
| P169 STORM SEWER, CL.A, TY.1, 300
13.553m @ 0.50% | P163 STORM SEWER, CL.A, TY.1, 300
8.496m @ 1.00% | P157 STORM SEWER, CL.A, TY.1, 900
2.706m @ 0.54% |
| P168 STORM SEWER, CL.A, TY.1, 300
1.498m @ 2.00% | P162 STORM SEWER, CL.A, TY.1, 300
1.498m @ 2.00% | P156 STORM SEWER, CL.A, TY.1, 900
7.384m @ 0.54% |
| P167 STORM SEWER, CL.A, TY.1, 300
8.496m @ 1.00% | P161 STORM SEWER, CL.A, TY.1, 900
52.300m @ 0.50% | T15 REINFORCED CONC. PIPE TEE
900 PIPE WITH 300 RISER |
| P166 STORM SEWER, CL.A, TY.1, 300
1.498m @ 2.00% | P160 STORM SEWER, CL.A, TY.1, 300
5.372m @ 1.00% | T14 REINFORCED CONC. PIPE TEE
900 PIPE WITH 300 RISER |
| P165 STORM SEWER, CL.A, TY.1, 900
90.347m @ 0.50% | P159 STORM SEWER, CL.A, TY.1, 300
11.099m @ 0.50% | T13 REINFORCED CONC. PIPE TEE
900 PIPE WITH 300 RISER |
| P164 STORM SEWER, CL.A, TY.1, 300
0.606m @ 2.00% | P158 STORM SEWER, CL.A, TY.1, 300
13.067m @ 0.50% | |

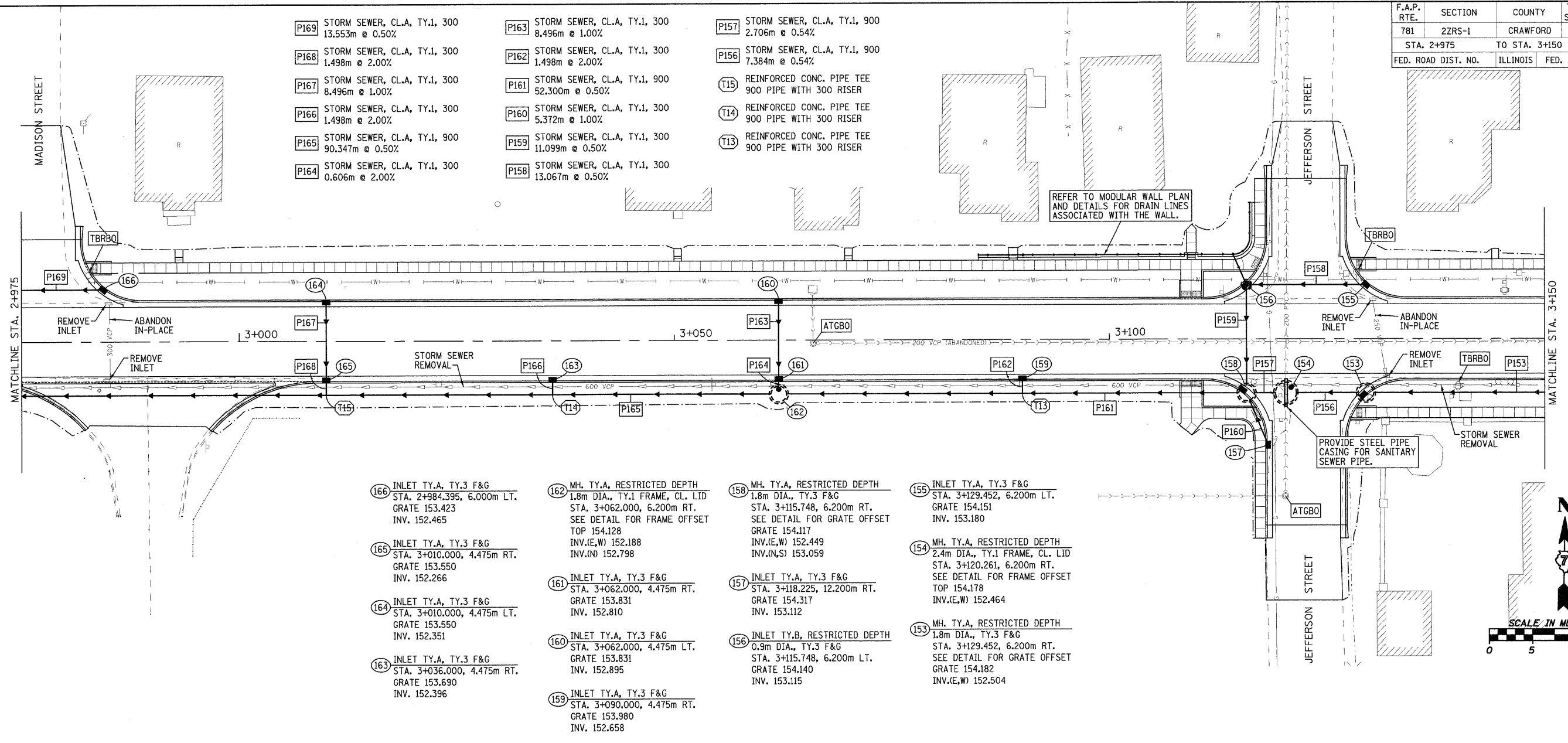

- | | | | |
|---|--|---|---|
| 166 INLET TY.A, TY.3 F&G
STA. 2+984.395, 6.000m LT.
GRATE 153.423
INV. 152.465 | 162 MH. TY.A, RESTRICTED DEPTH
1.8m DIA., TY.1 FRAME, CL. LID
STA. 3+062.000, 6.200m RT.
SEE DETAIL FOR FRAME OFFSET
TOP 154.128
INV.(E,W) 152.188
INV.(N) 152.798 | 158 MH. TY.A, RESTRICTED DEPTH
1.8m DIA., TY.3 F&G
STA. 3+115.748, 6.200m RT.
SEE DETAIL FOR GRATE OFFSET
GRATE 154.117
INV.(E,W) 152.449
INV.(N,S) 153.059 | 155 INLET TY.A, TY.3 F&G
STA. 3+129.452, 6.200m LT.
GRATE 154.151
INV. 153.180 |
| 165 INLET TY.A, TY.3 F&G
STA. 3+010.000, 4.475m RT.
GRATE 153.550
INV. 152.266 | 161 INLET TY.A, TY.3 F&G
STA. 3+062.000, 4.475m RT.
GRATE 153.831
INV. 152.810 | 157 INLET TY.A, TY.3 F&G
STA. 3+118.225, 12.200m RT.
GRATE 154.317
INV. 153.112 | 154 MH. TY.A, RESTRICTED DEPTH
2.4m DIA., TY.1 FRAME, CL. LID
STA. 3+120.261, 6.200m RT.
SEE DETAIL FOR FRAME OFFSET
TOP 154.178
INV.(E,W) 152.464 |
| 164 INLET TY.A, TY.3 F&G
STA. 3+010.000, 4.475m LT.
GRATE 153.550
INV. 152.351 | 160 INLET TY.A, TY.3 F&G
STA. 3+062.000, 4.475m LT.
GRATE 153.831
INV. 152.895 | 156 INLET TY.B, RESTRICTED DEPTH
0.9m DIA., TY.3 F&G
STA. 3+115.748, 6.200m LT.
GRATE 154.140
INV. 153.115 | 153 MH. TY.A, RESTRICTED DEPTH
1.8m DIA., TY.3 F&G
STA. 3+129.452, 6.200m RT.
SEE DETAIL FOR GRATE OFFSET
GRATE 154.182
INV.(E,W) 152.504 |
| 163 INLET TY.A, TY.3 F&G
STA. 3+036.000, 4.475m RT.
GRATE 153.690
INV. 152.396 | 159 INLET TY.A, TY.3 F&G
STA. 3+090.000, 4.475m RT.
GRATE 153.980
INV. 152.658 | | |

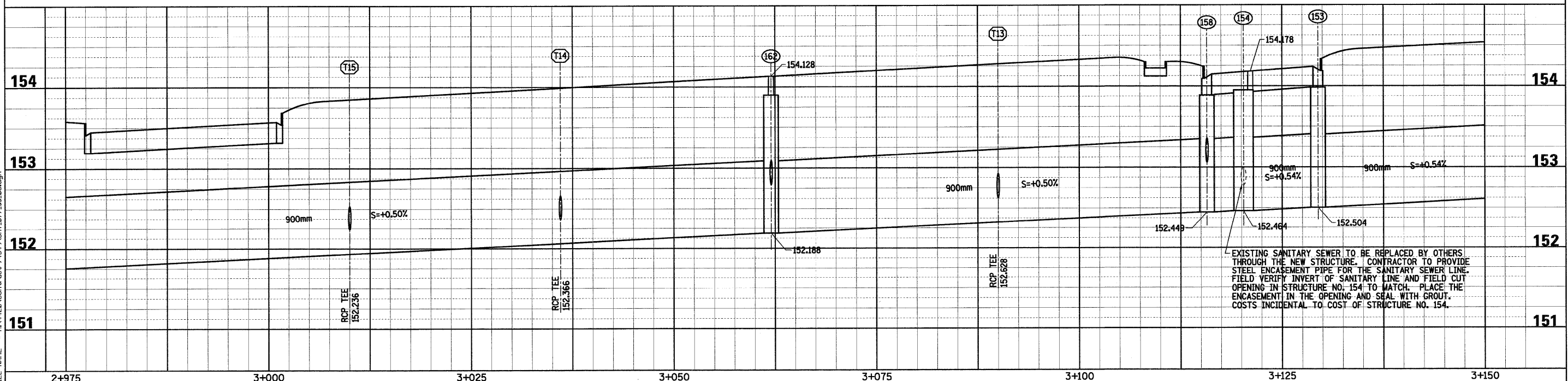
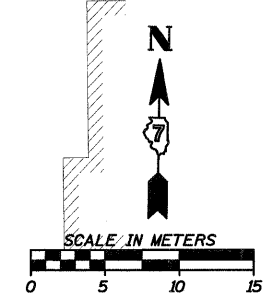

EXISTING SANITARY SEWER TO BE REPLACED BY OTHERS THROUGH THE NEW STRUCTURE. CONTRACTOR TO PROVIDE STEEL ENCASUREMENT PIPE FOR THE SANITARY SEWER LINE. FIELD VERIFY INVERT OF SANITARY LINE AND FIELD CUT OPENING IN STRUCTURE NO. 154 TO MATCH. PLACE THE ENCASUREMENT IN THE OPENING AND SEAL WITH GROUT. COSTS INCIDENTAL TO COST OF STRUCTURE NO. 154.

PLOT DATE = 2/5/2009
 FILE NAME = H:\4420\Contract 74349\SH1_077_03.dgn

Sheet: 3
 Angle: 0.9788
 Chain: P_IL33

HMG JOB NO. 4420